



SALTO IQ3.0 Gateway Device System Installation Guide

[Home](#) » [SALTO](#) » SALTO IQ3.0 Gateway Device System Installation Guide 

SALTO IQ3.0 Gateway Device System



Contents

- [1 Dimension](#)
- [2 Installation](#)
- [3 DESKTOP
INSTALLATION](#)
- [4 Wiring](#)
- [5 Product Overview](#)
- [6 Electrical Features](#)
- [7 Configuration](#)
- [8 Installation example](#)
- [9 Signals](#)
- [10 Operational test](#)
- [11 Documents / Resources](#)
 - [11.1 References](#)

Dimension



The IQ3 is a Gateway device that ensures the communication between Nebula and the SALTO Bulent devices providing the SVN (SALTO Virtual Network) features.

It is equipped with an Ethernet, WIFI (*), Bluetooth and RS-485 interface. (*) Depending on the model.

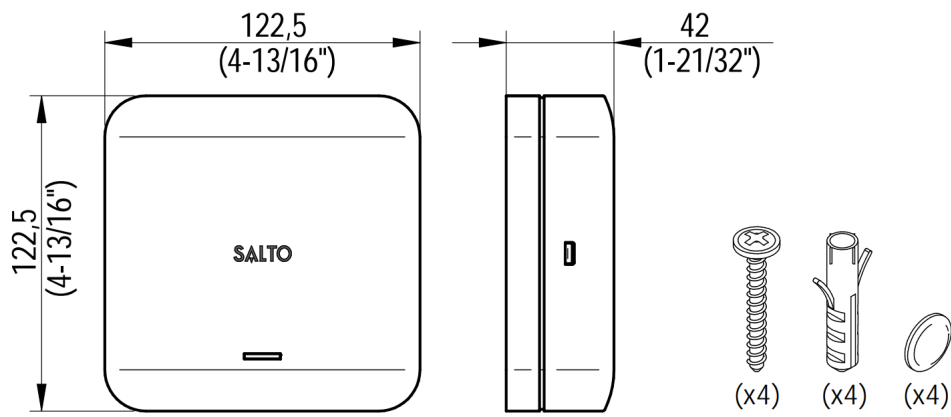

Installation

EUROPE EUROPA

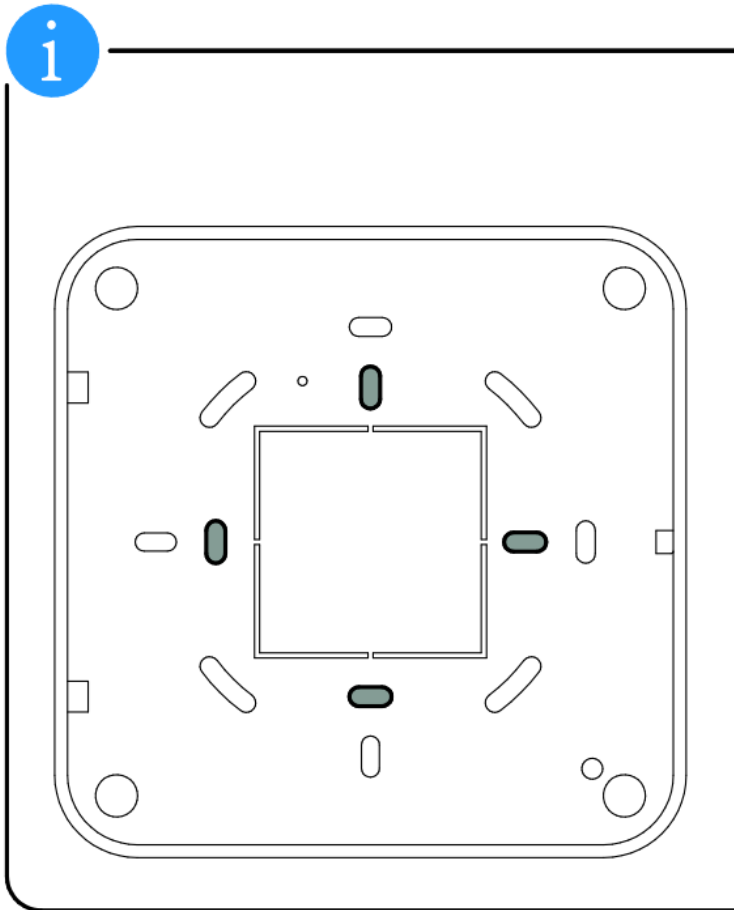

NORTH AMERICA

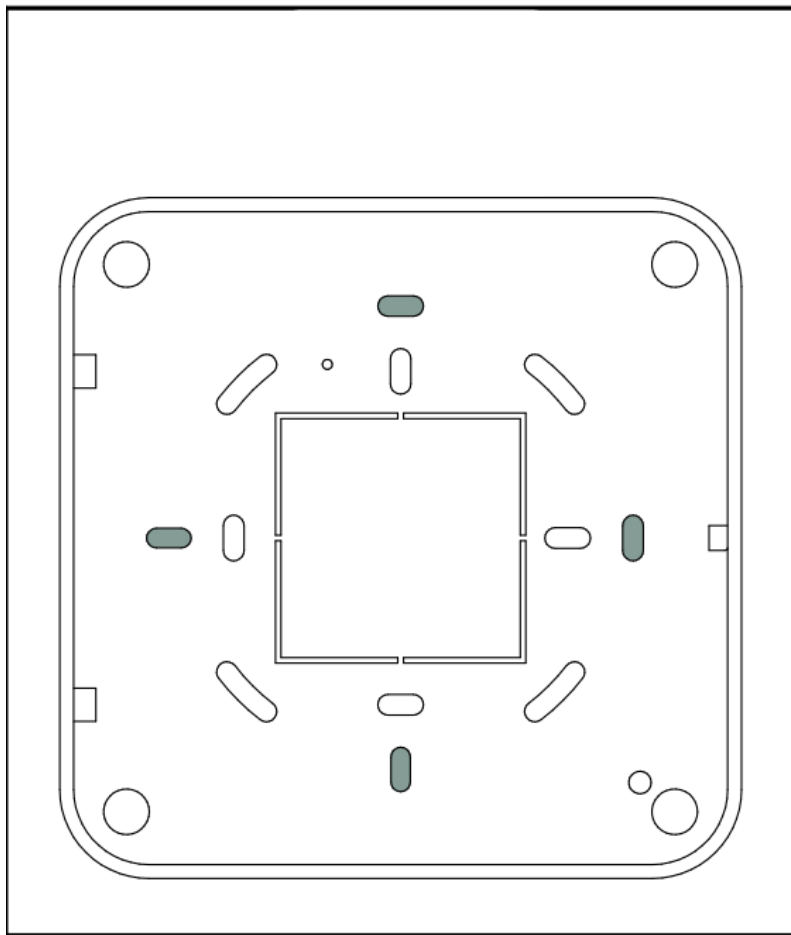

SWISS

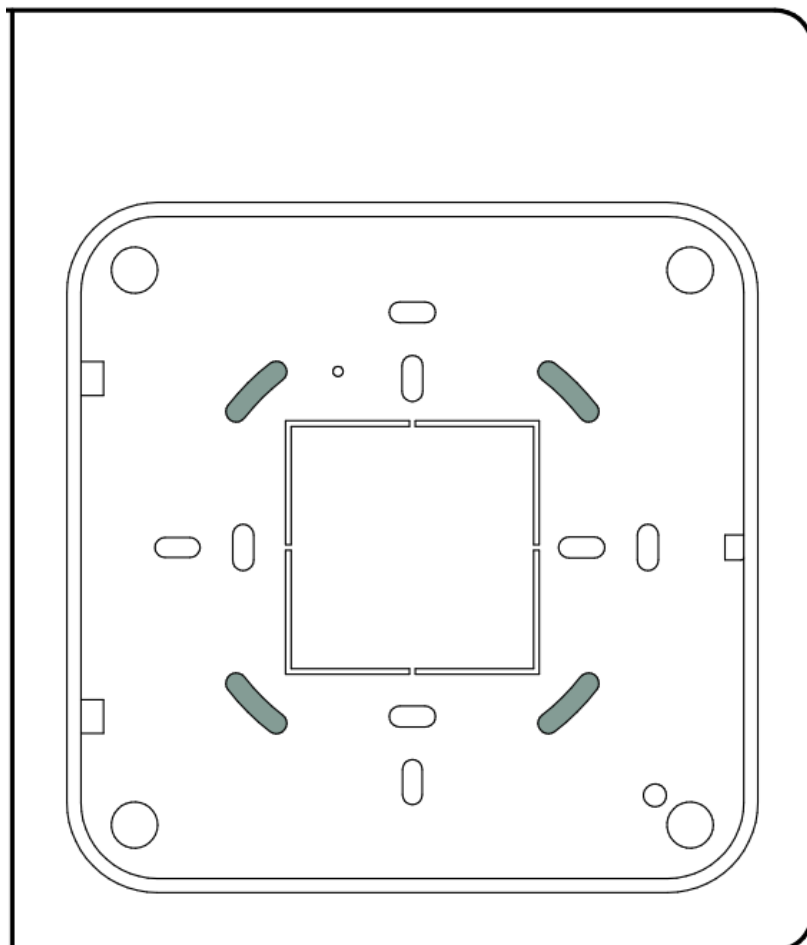

CEILING/WALL INSTALLATION WITH HIDDEN CABLE

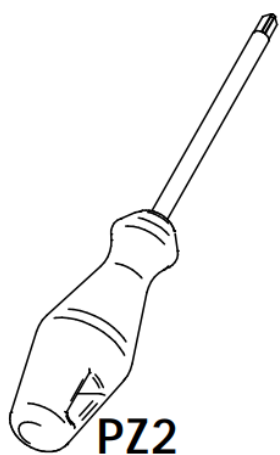

Remove!

1

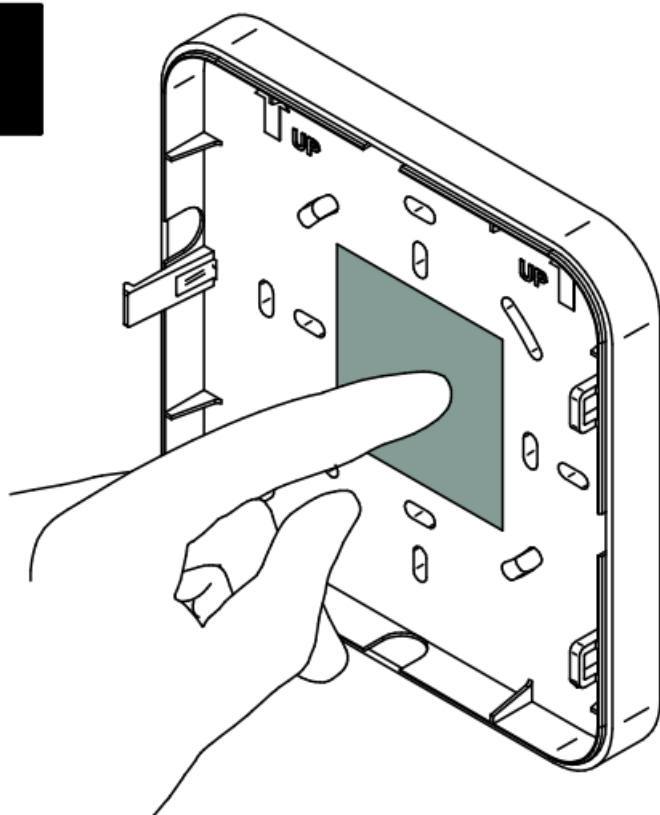

2

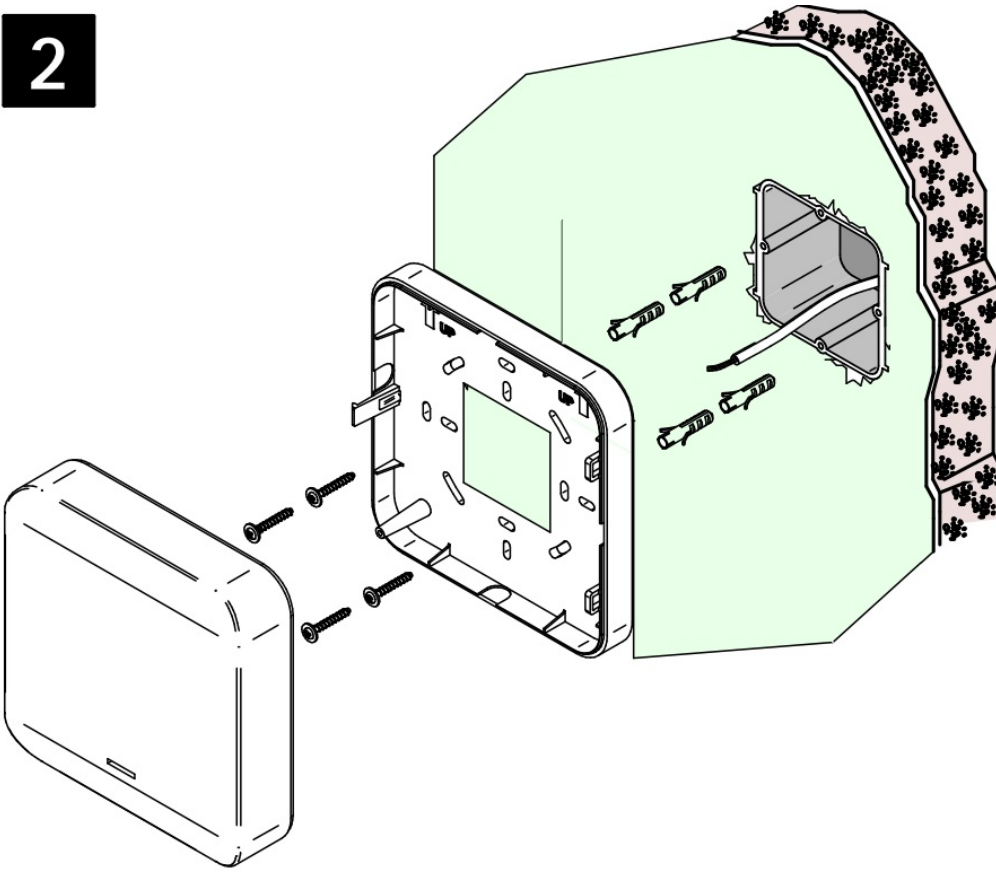

CEILING/WALL INSTALLATION WITH EXPOSED CABLE

PZ2

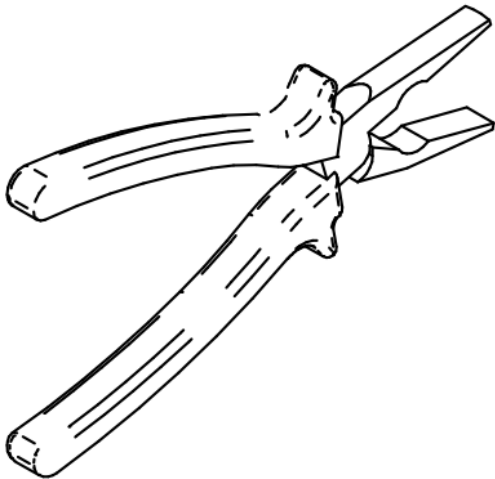

1

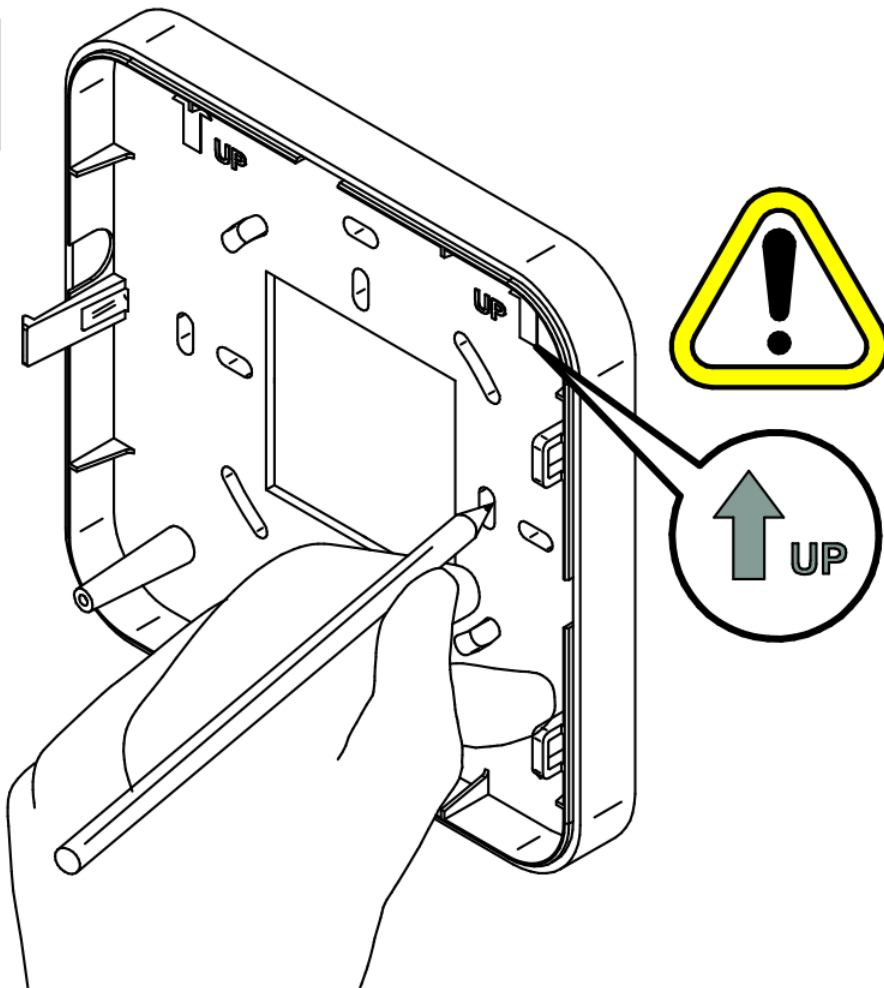

2

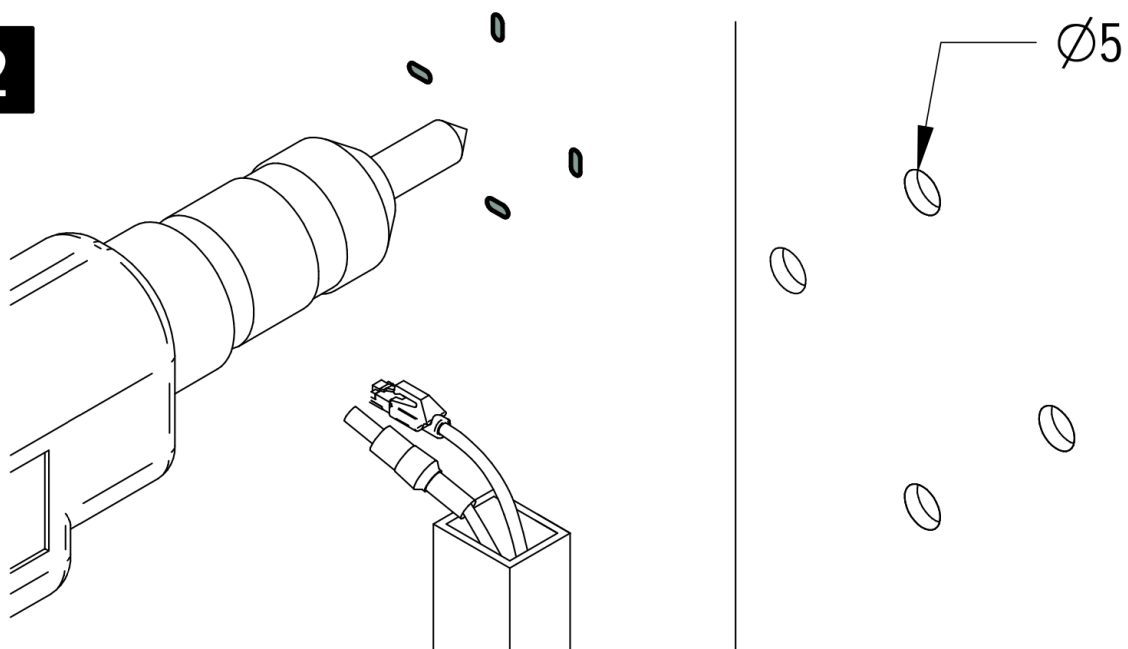

3

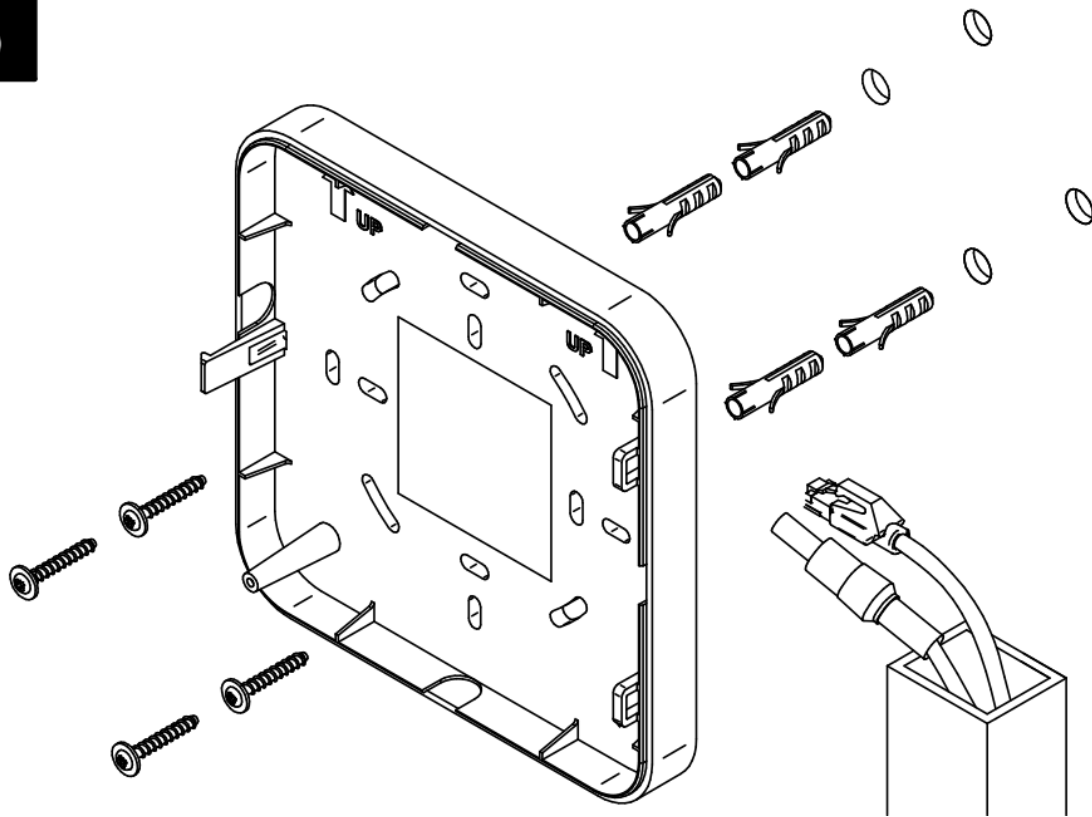

4

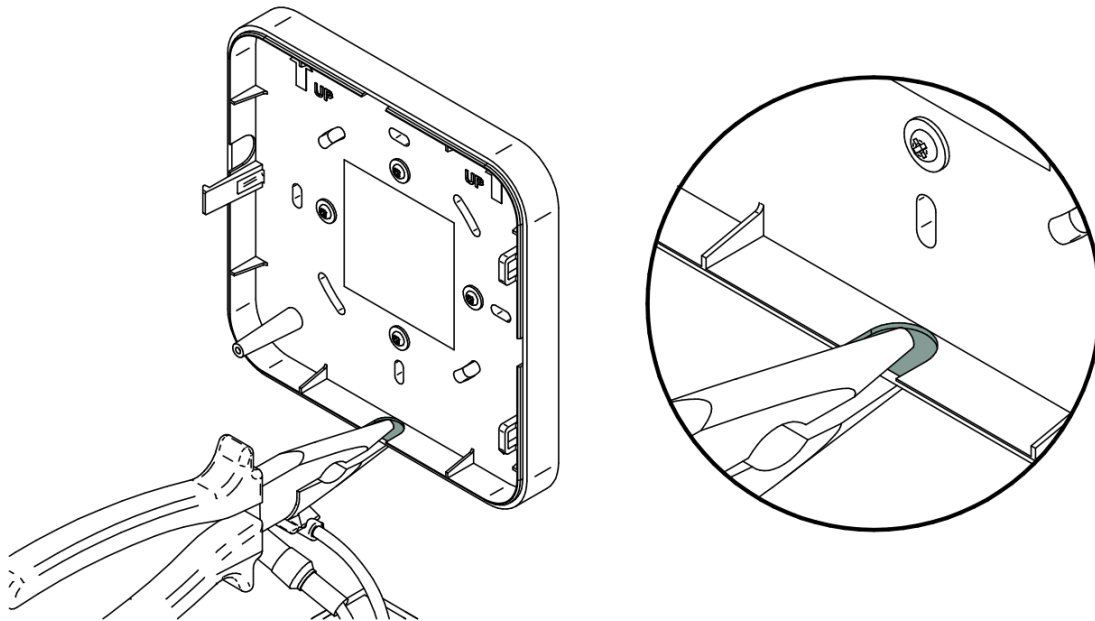

5

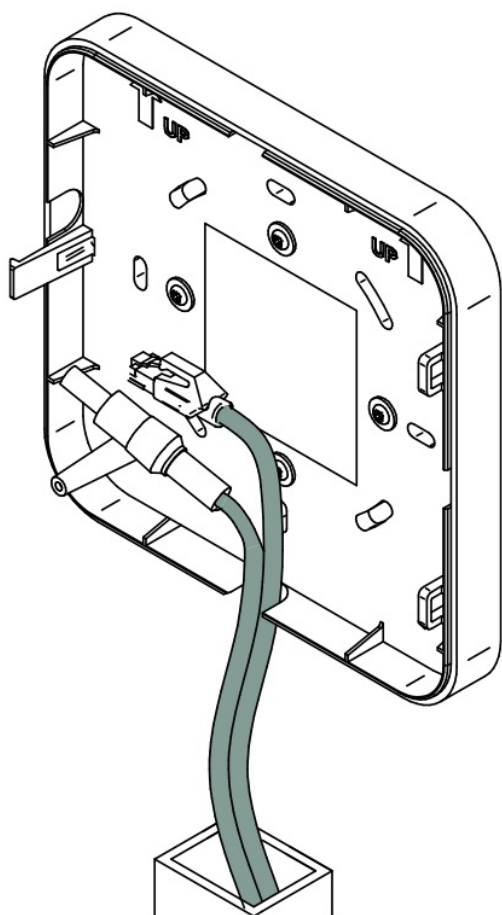

6

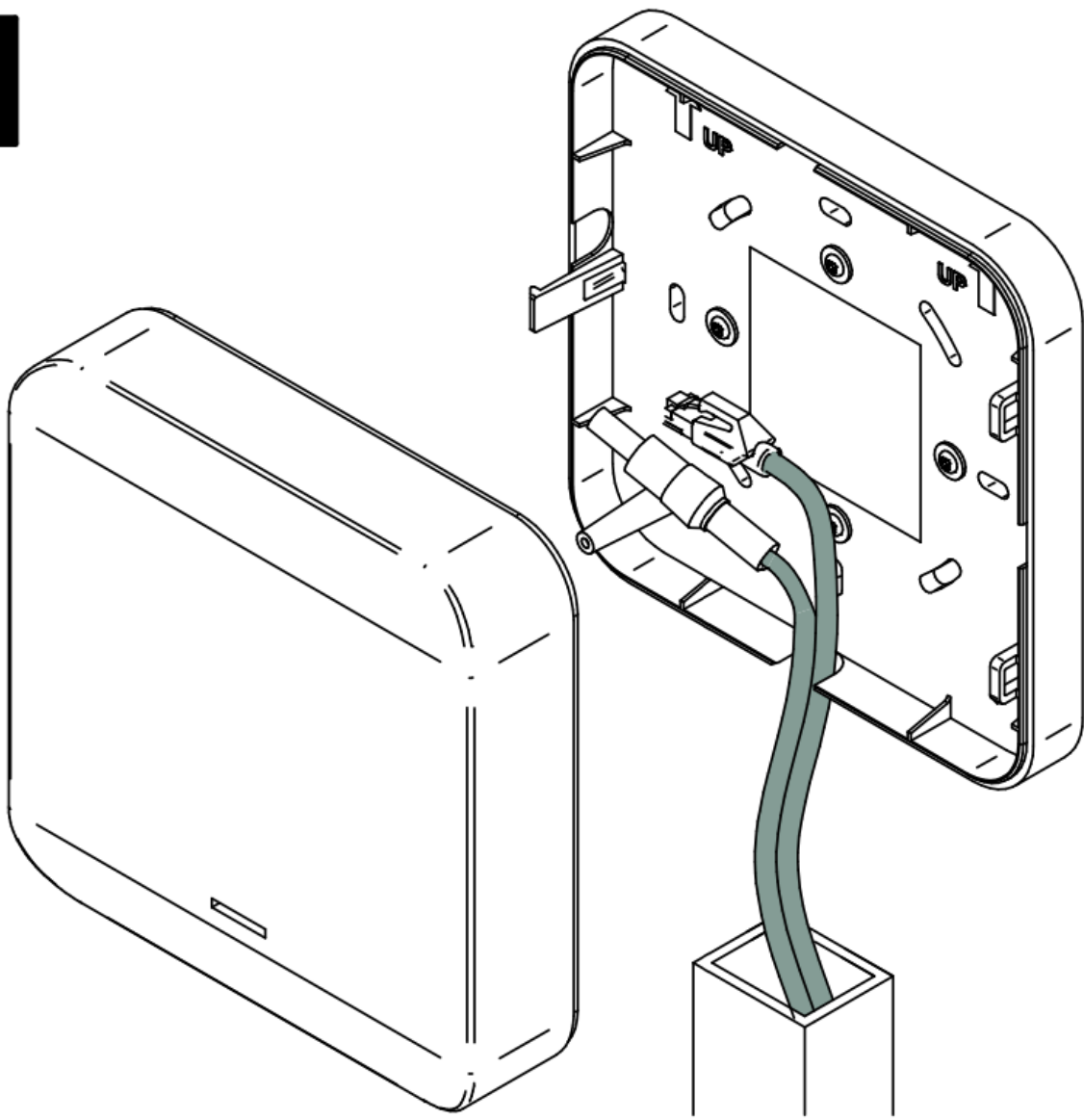

DESKTOP INSTALLATION

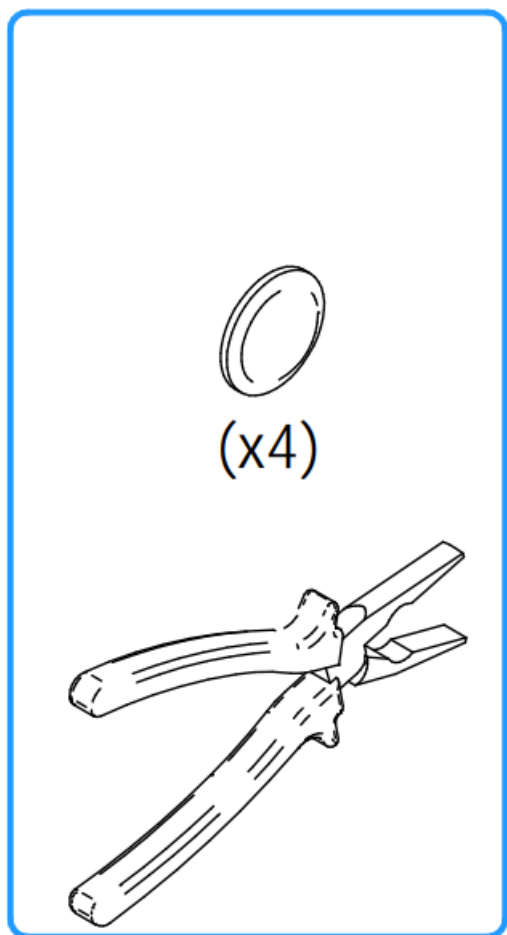

1

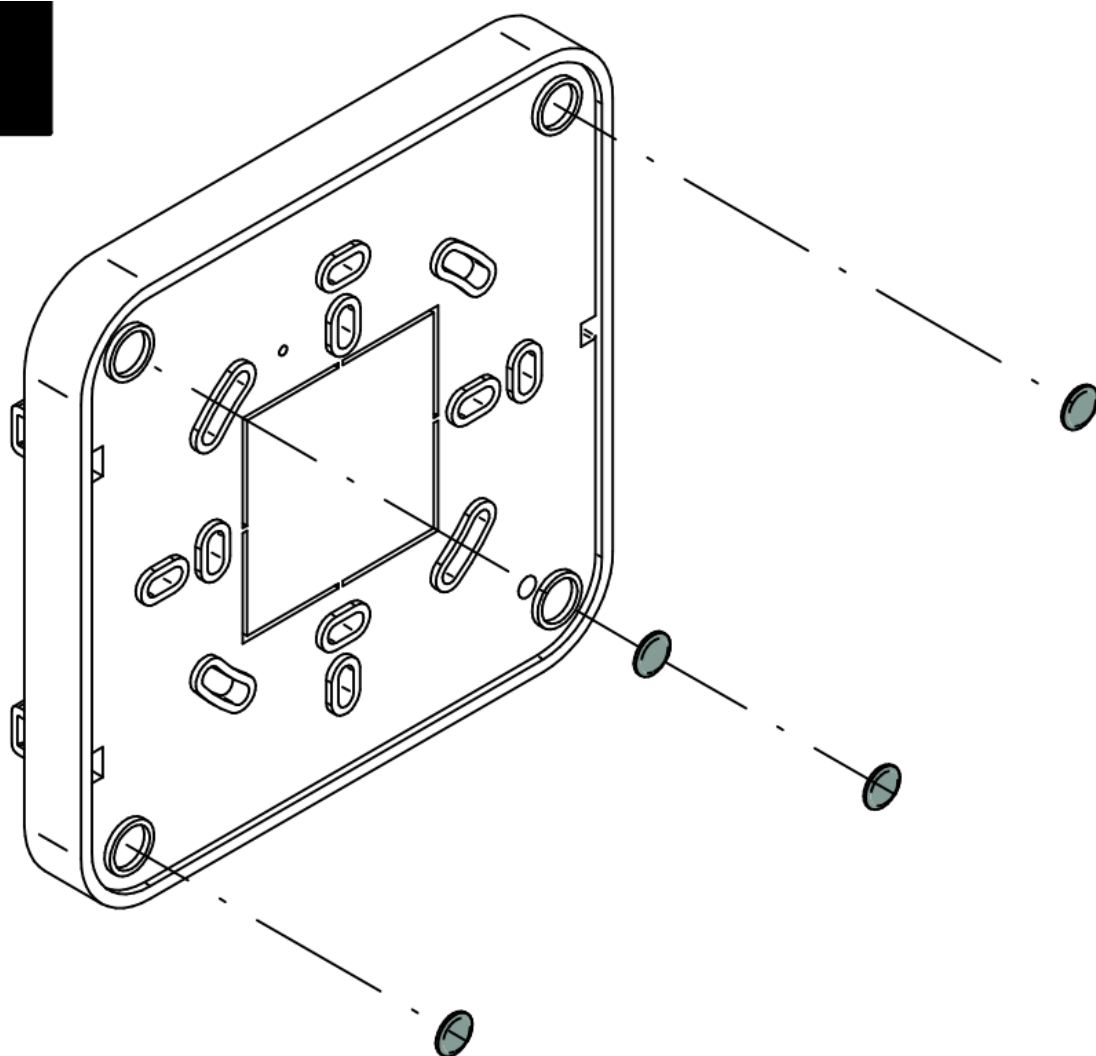

2

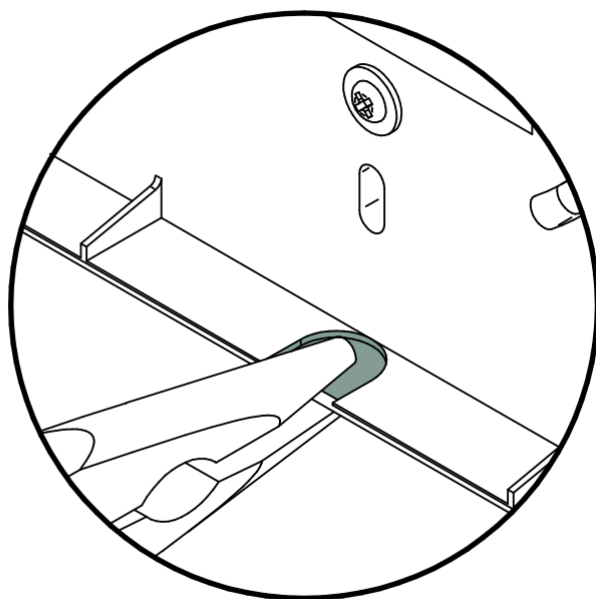
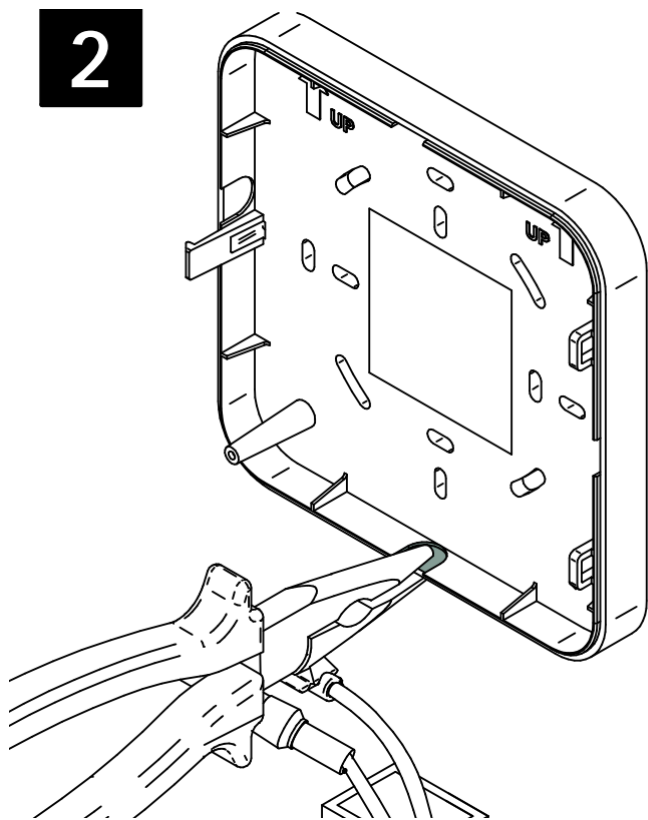

3

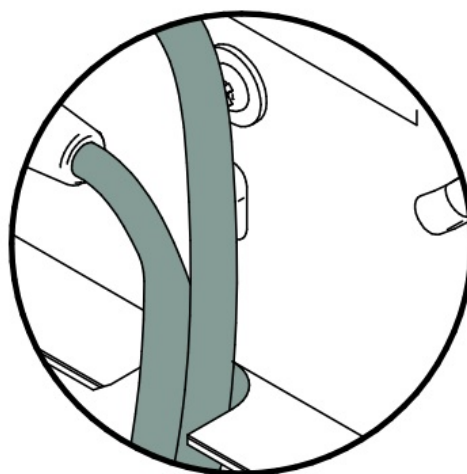
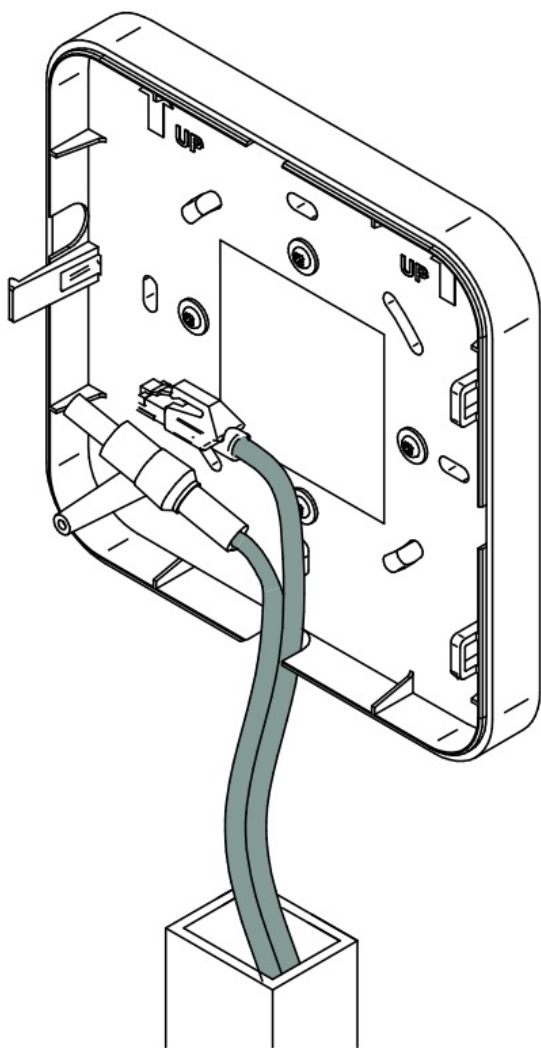

4

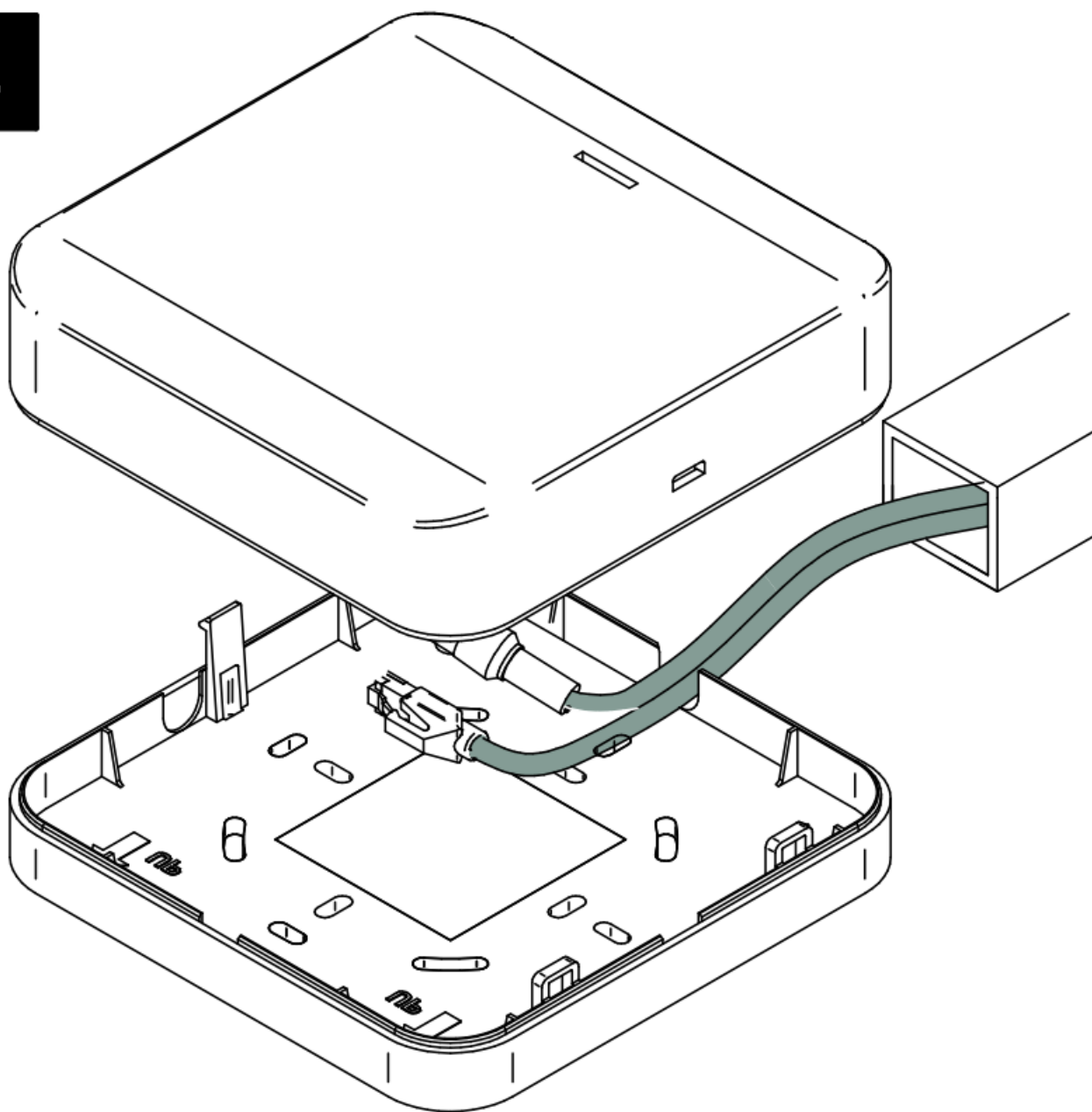

SEE WIRING DIAGRAM

Wiring

A. ETHERNET MODEL

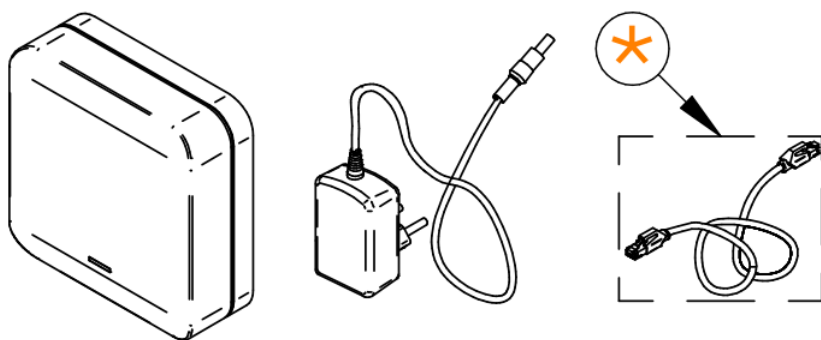

B. ETHERNET + POE MODEL

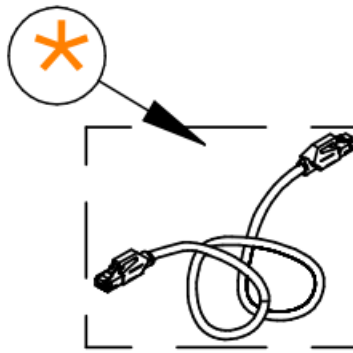
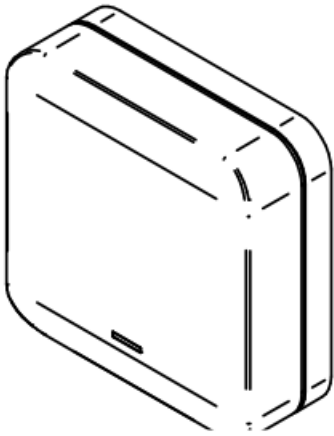

C. ETHERNET + WIFI MODEL

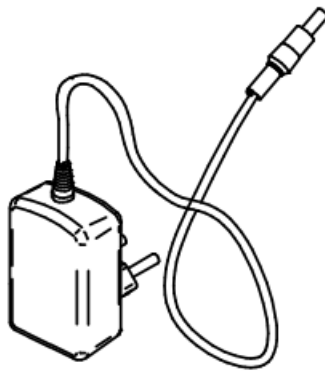
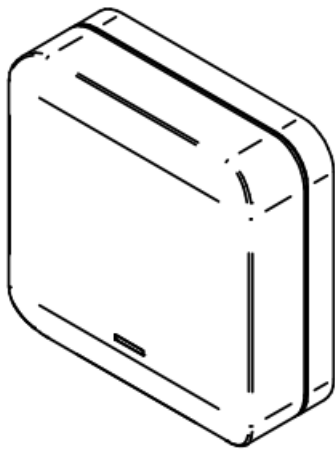

(*)Not included



ETHERNET MODEL

Plug

1-a

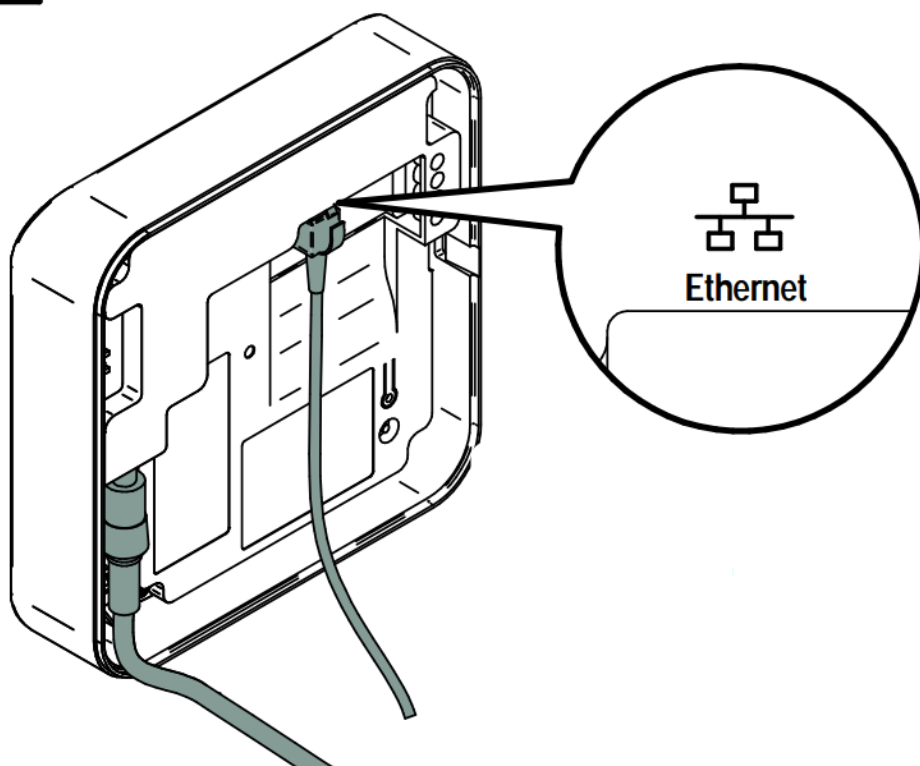

2-a

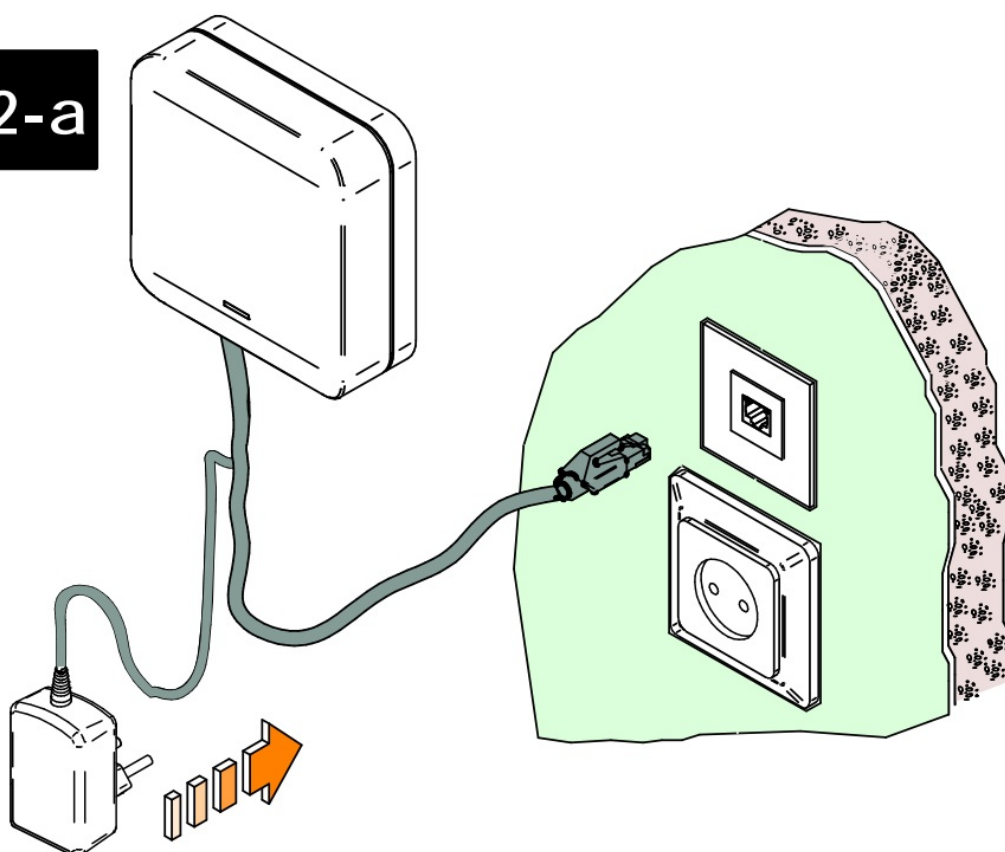

ETHERNET + POE MODEL

Plug

1-b

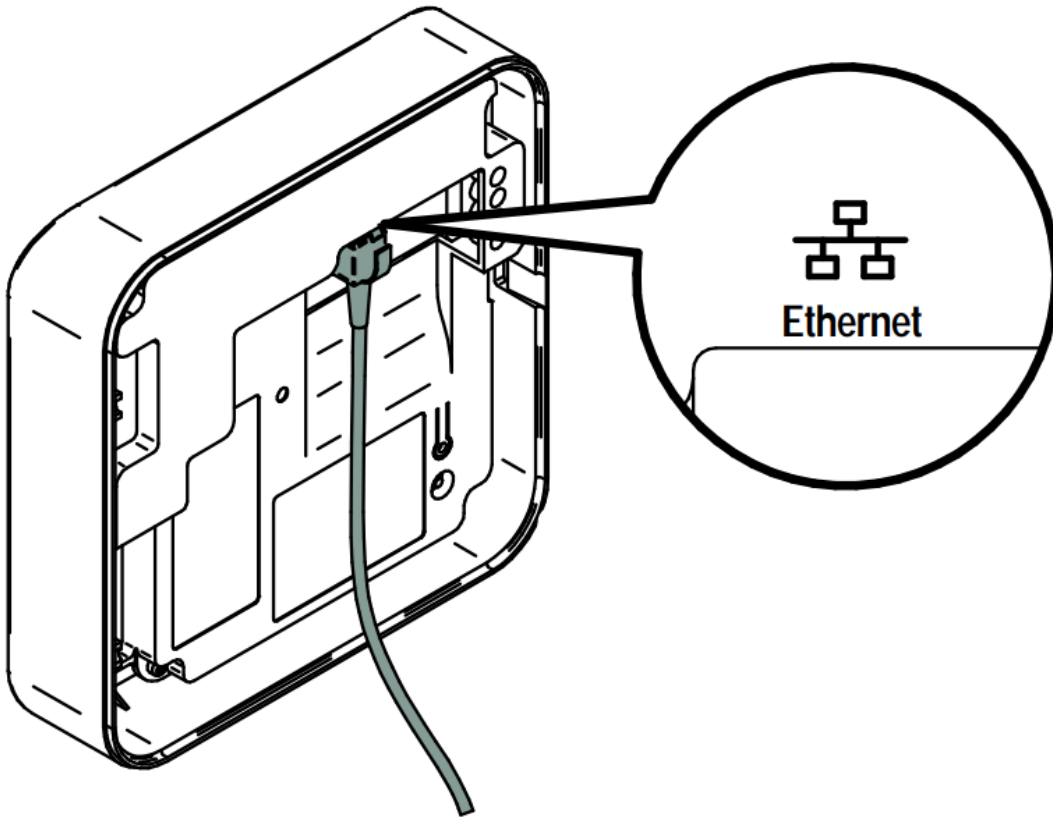

2-b

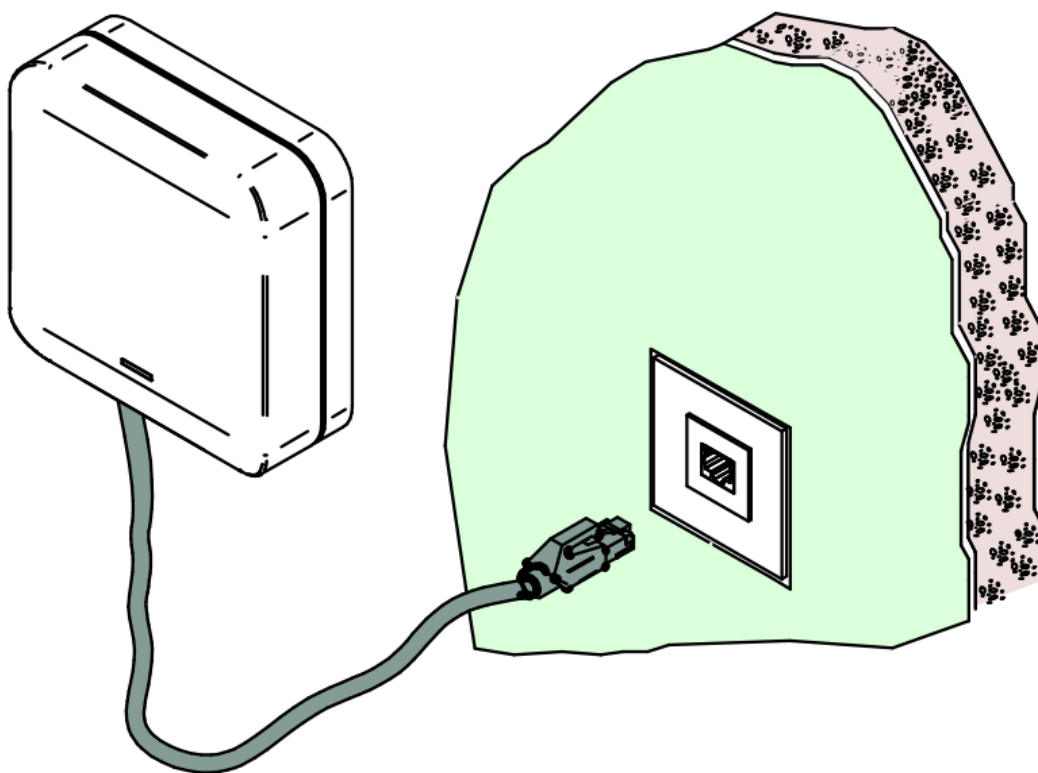

If there is no PoE infrastructure, use auxiliary power supply

Plug

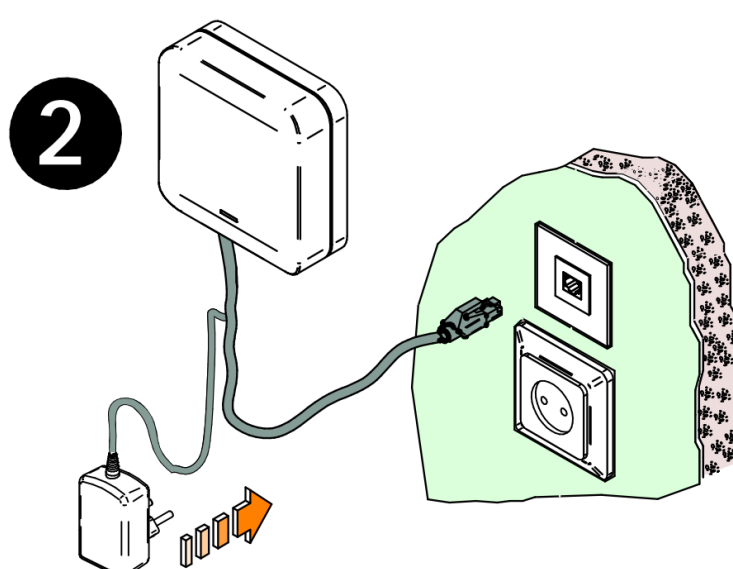
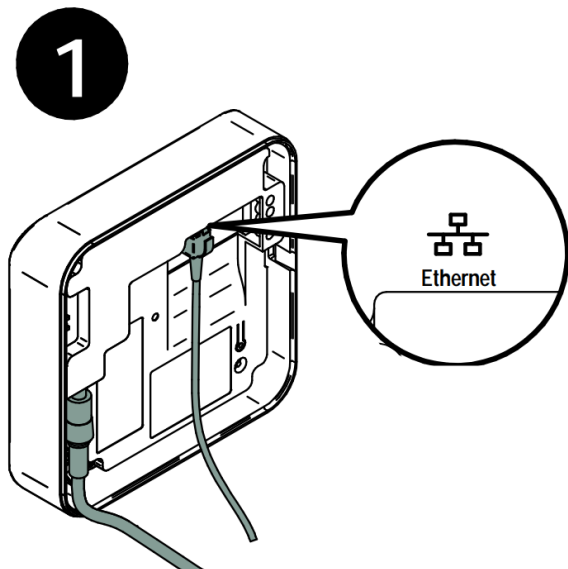

ETHERNET + WIFI MODEL

Plug



1-a

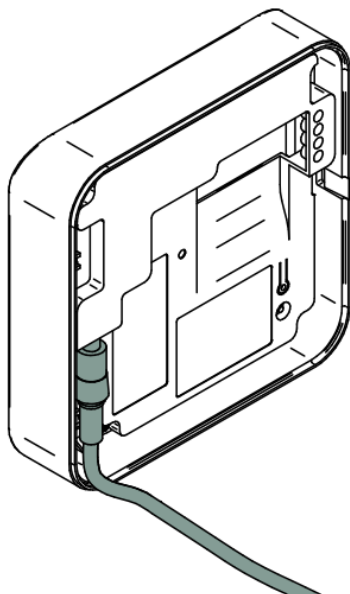

WiFi

2-a

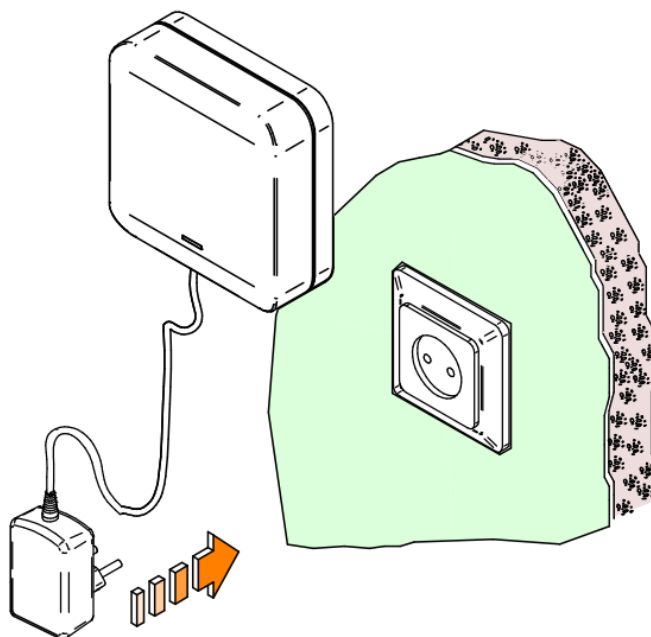

If you do not connect to a WIFI network, connect the Ethernet cable.

Plug

1

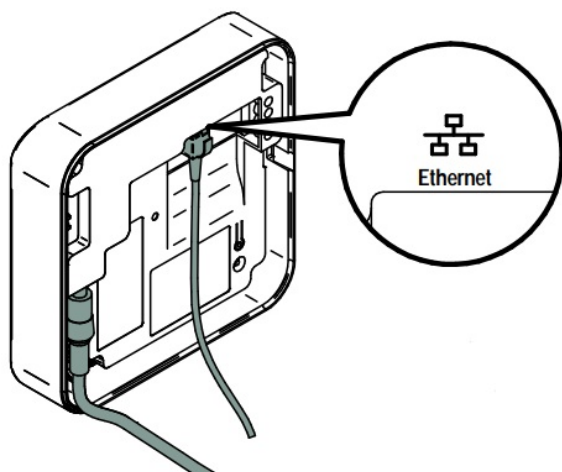

2

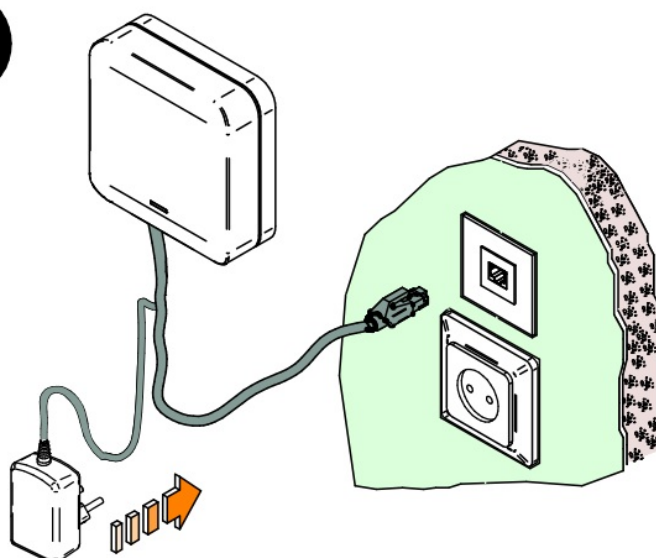

COMMUNICATION WIRING DIAGRAM IN IQ3/SALTO Node

RS485 CONNECTION TO TERMINAL

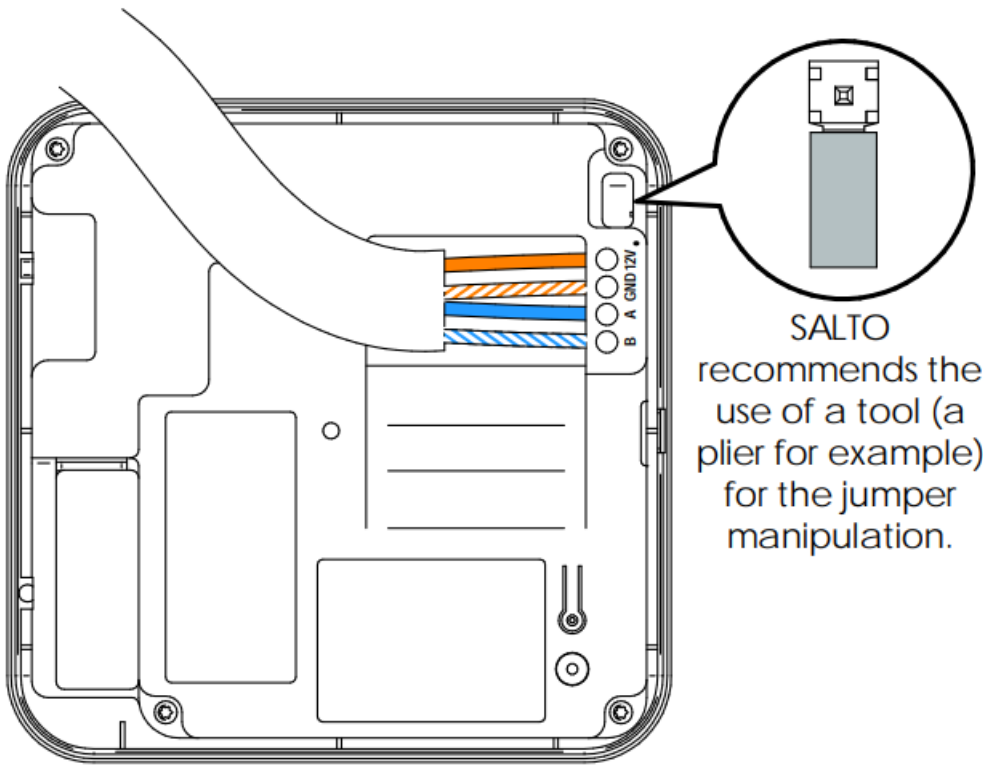

SALTO
recommends the
use of a tool (a
plier for example)
for the jumper
manipulation.



RS485 bus termination resistor is needed (ON position) when the node is located at the end of the bus.

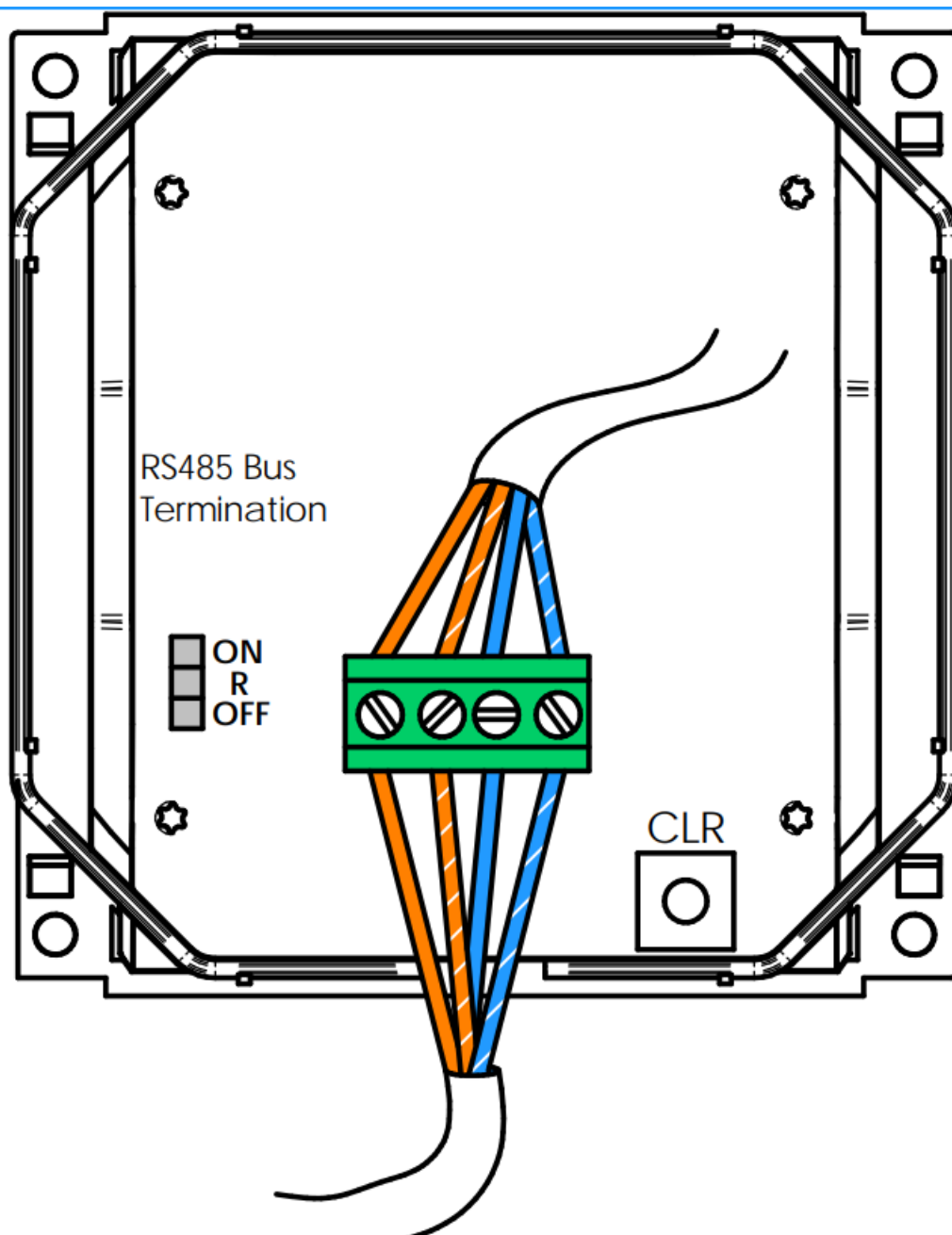

RS485 CONNECTION WITH CABLE JACK

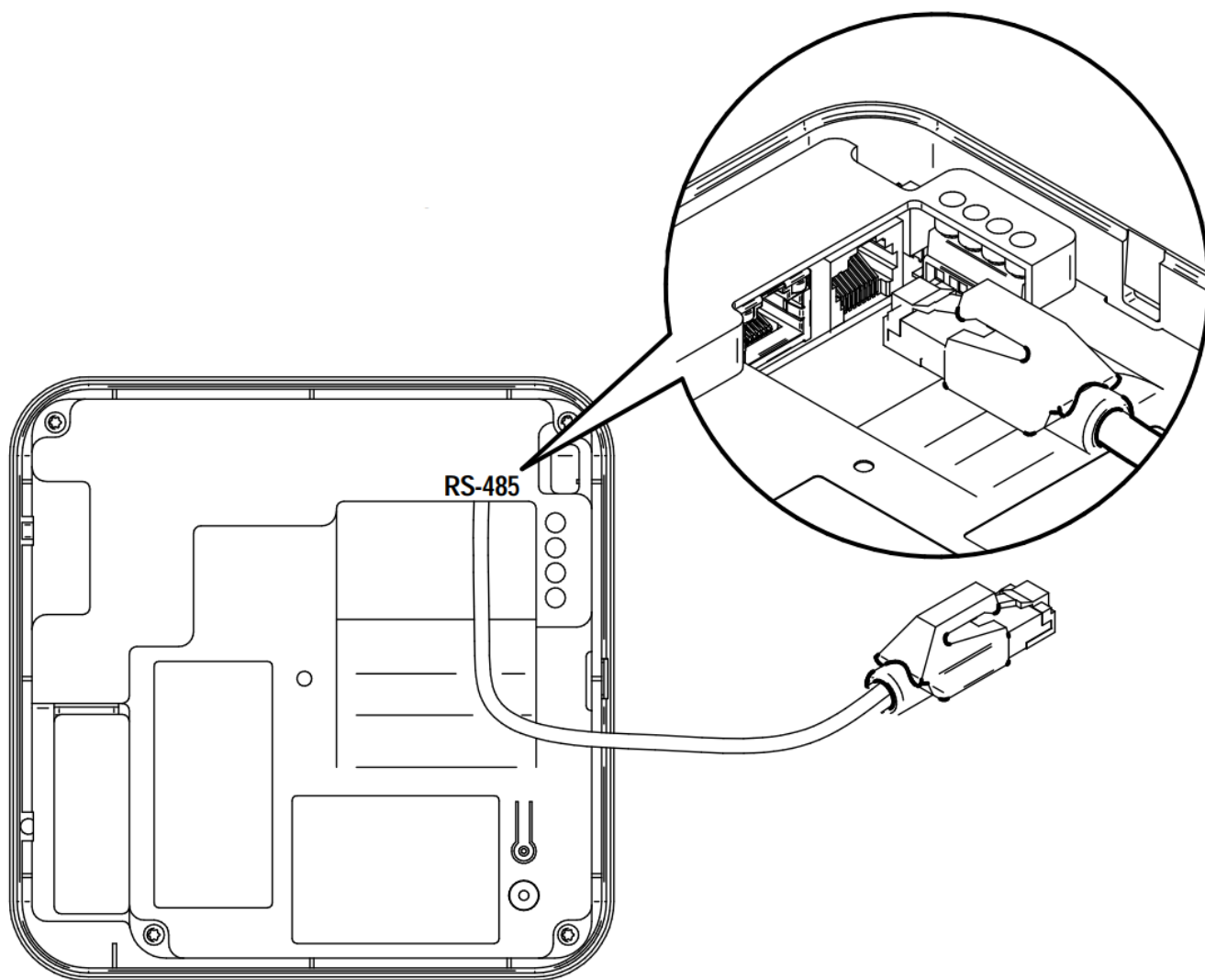

Only with SP226159

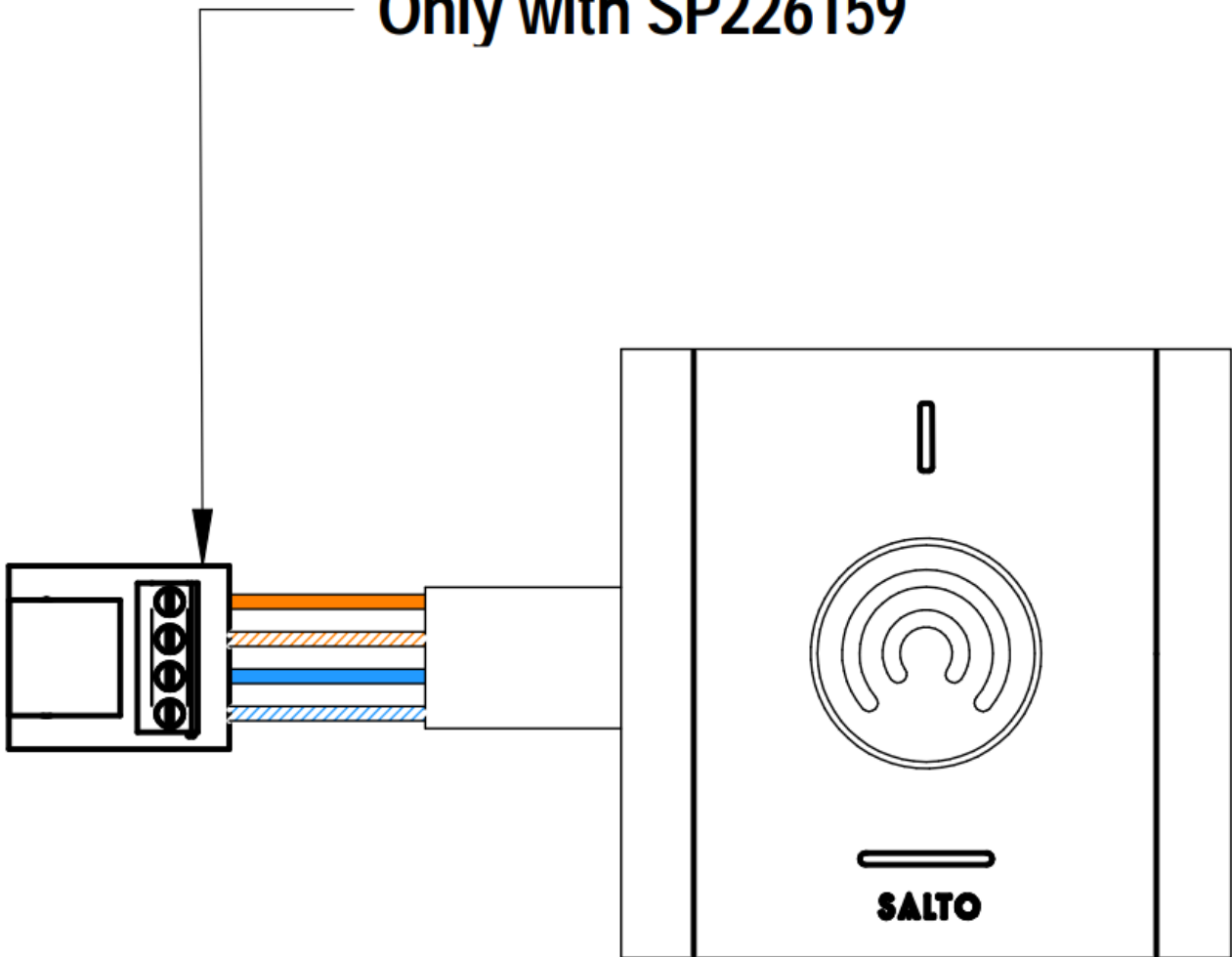

Product Overview

1. Power (except PoE).
2. Ethernet.
3. RS485 (Jack cable).
4. RS485.

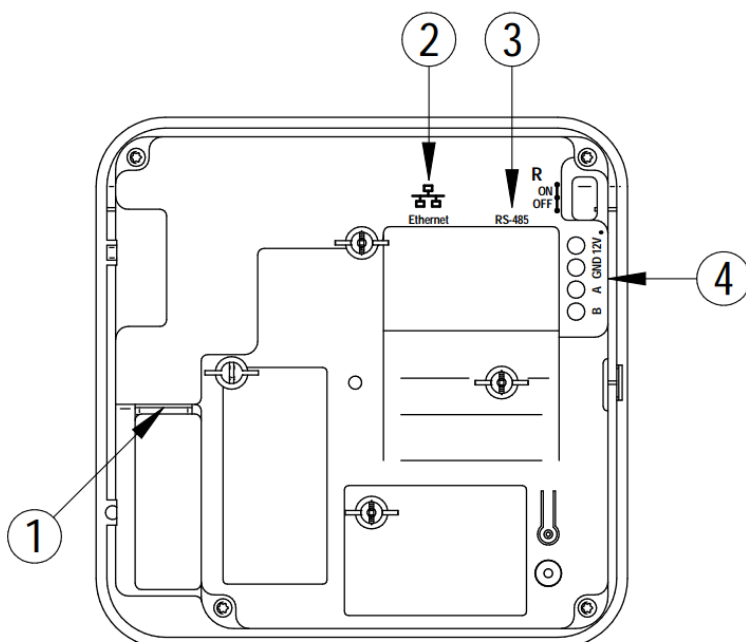

Electrical Features

EXTERNAL POWER SUPPLY CHARACTERISTICS			
	Min	Max	Typ
Input Voltage	12-5%V	12+5%V	12V
Max Input Power	15w		
Current Consumption*		200mA	60mA

* Excluding RS485 Nodes.

Power supply must be calculated taking into account SALTO Nodes current consumption.

PoE
PoE Norms: IEEE 802.3af / IEEE 802.3at
PoE Class0

OPERATING CONDITIONS		
	Min	Max
Temperature	0°C	60°C
Humidity	0	95% (Non condensing)

WIFI CHARACTERISTICS	
Frequency Range	2400 MHz to 2483.5 MHz
Standard	IEEE 802.11b/g/n compliant
TX power	16dBm
Range	25-30m *

- Depending upon installed environment. To ensure correct operation, do not install the device near a metallic surface.

SALTO Bulent CHARACTERISTICS	
Frequency Range: 2400 MHz to 2483.5 MHz	
Standard	Bluetooth 5.2 Compliant
TX power	8dBm
Indoor Range	5-10m *

- Depending upon installed environment. To ensure correct operation, do not install the device near a metallic surface.

MAX. NUMBER OF DEVICES TO BE CONNECTED
SALTO Nodes: 6
Access points: 112

Configuration

1. The device is configured using the Nebula App.
2. Ethernet test: without any type of set up, the IQ3 is a DHCP ready device. If your network supports it, it is possible to check the Ethernet connectivity by pinging the address SALTO-IQ3-XXXXXX(XXXXXX corresponds to the final 6 digits of MAC).

Installation example

Maximum number of SALTO Nodes: 6
Maximum number of access points: 112

SALTO' s Software

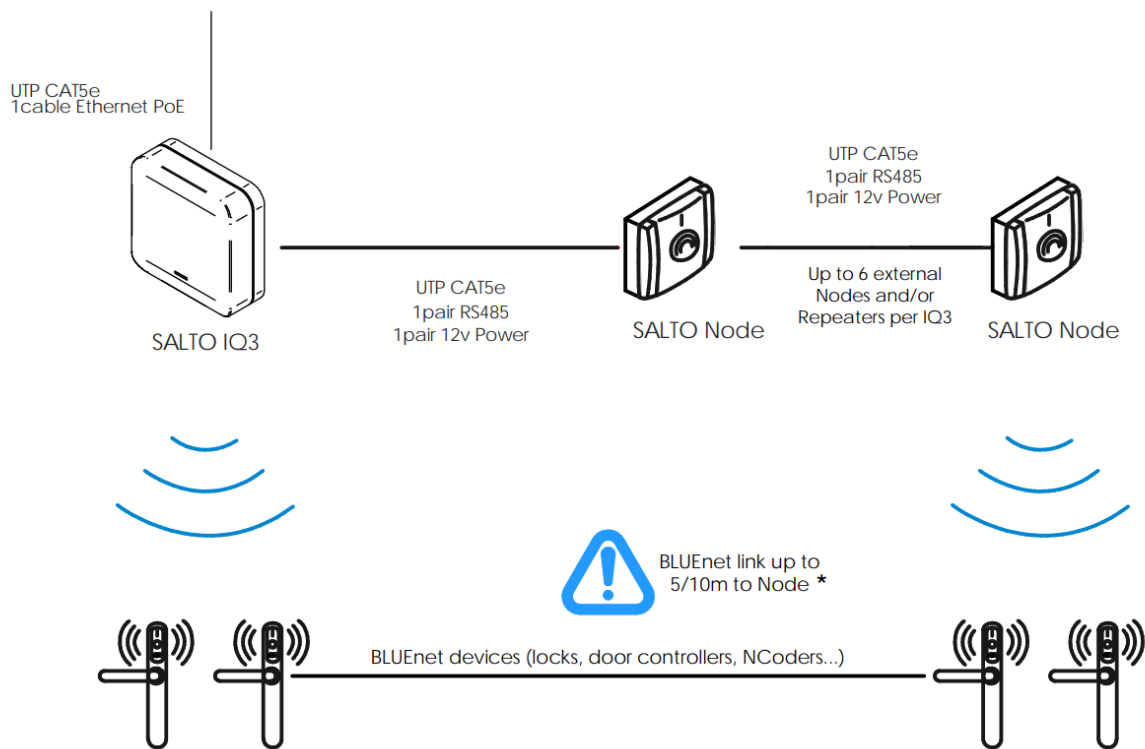

(*) Depending upon installed environment.

Signals

LED MODE	LED COLOUR	STATUS INDICATION
Blink long RED		Device ex works. It will be doing advertising.
Blink short RED (3 seconds)		Identification signal when selected from a mobile phone. The signal lasts 3 second.
Blink long BLUE		Device initialized with communication to the server.
Blink short YELLOW		Device not communicating with the server.
Blink long GREEN		Connection established to a mobile phone.
Blink short GREEN		Initialized and in programming mode. It is doing advertising while waiting for a mobile connection.

Operational test

1. Check that the red light turns on.
2. If you have connected to Ethernet, check that the lights on the RJ45 turn on.

All contents current at time of publication.

SALTO Systems S.L. reserves the right to change availability of any item in this catalog, its design, construction, and/or materials.



Documents / Resources

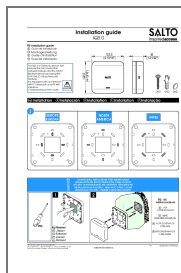

[SALTO IQ3.0 Gateway Device System](#) [pdf] Installation Guide

IQ3.0 Gateway Device System, IQ3.0, Gateway Device System, Device System, System

References

- [User Manual](#)