



SALTO GATEWAYW3CAUS Bluenet Wireless Gateway Installation Guide

[Home](#) » [SALTO](#) » SALTO GATEWAYW3CAUS Bluenet Wireless Gateway Installation Guide 



Installation guide
SALTO Gateway

MODEL: ELECTRONIC INFO. RFnet Gateway – BLUEnet Gateway

Contents

- [1 Description](#)
- [2 Electrical characteristics](#)
- [3 Cable requirements](#)
- [4 Mechanical installation](#)
- [5 Electrical installation](#)
- [6 Configuration](#)
- [7 Installation example](#)
- [8 Signalling](#)
- [9 Operational test](#)
- [10 Documents / Resources](#)
 - [10.1 References](#)
- [11 Related Posts](#)

Description

The Gateway is the link between the PC and SALTO's wireless network SALTO RFnet or SALTO BLUEnet (wireless escutcheons). It gives real-time information to the PC. Gateways are completely managed through the SALTO Software, it collects all the information sent by escutcheons that belong to the Gateway. It has been designed with PoE technology, capable of power the SALTO Gateway through Ethernet infrastructure.

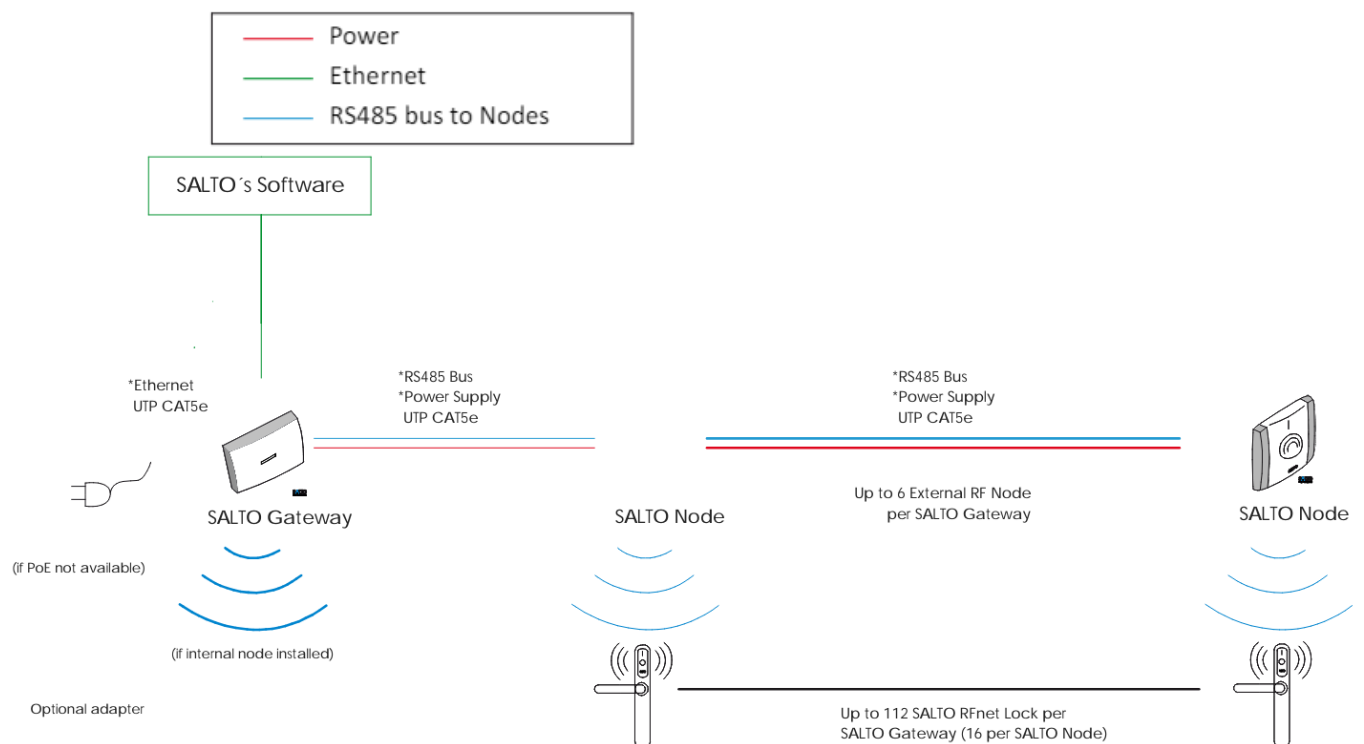
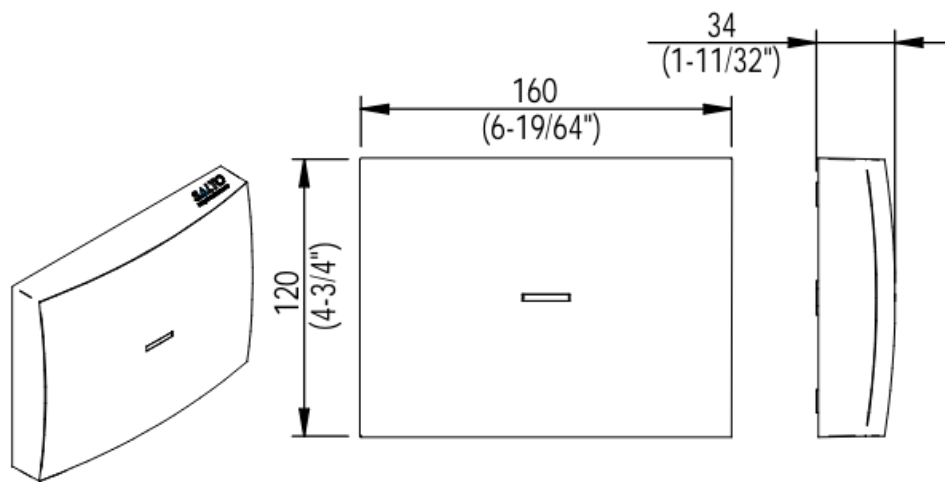

Electrical characteristics

Operation conditions

	Min	Typ	Max	Unit
Temperature	0	25	60	°C
Humidity	35		85	%

PoE (IEEE 802.3af)

		Unit
Class	2	
MaxPower	5	W
Ethernet Standard	10BASE-T/100BASE-TX	

Cable requirements

Ethernet UTP CAT5e

Complies with IEC 60332, IEC 60695-11-21 or VW-1 (UL 2556)

SALTO BLUEnet Characteristics (if internal node installed)

Frequency Range	2400-2483,5 Mhz
RF Standard	Bluetooth Low Energy
Indoor Radio Range	10m/15m*
Max output power	8dBm

Auxiliary Power Supply

	Min	Typ	Max	Unit
InputVoltage Note 2	10	12	15	V
Currentconsumption 75 Note 3			500 Note 4	mA

SALTO RFnet Characteristics (if internal node installed)

Frequency Range	2400-2483 Mhz
RF Standard	IEEE 802.15.4
Indoor Radio Range	10/15m*
Max output power	5dBm

(*) Depending upon installed environment.

Note 1: 1x2x24AWG or UTP CAT5e recommended

Note 2: Use provided AC-DC power supply

Note 3: No external/internal node connected

Note 4: 6 external node connected

(*) The environment has a direct impact on the BLUEnet range radiation (metal, concrete walls...)

The receiver device must be located facing the product antenna. Please check your product's BLUEnet antenna position.

Recommended connectivity distance: 10m – 15m

UL Statement

Comply with UL/CSA 62368-1:

Product could be connected to PoE networks without routing to the outside plant

Mechanical installation

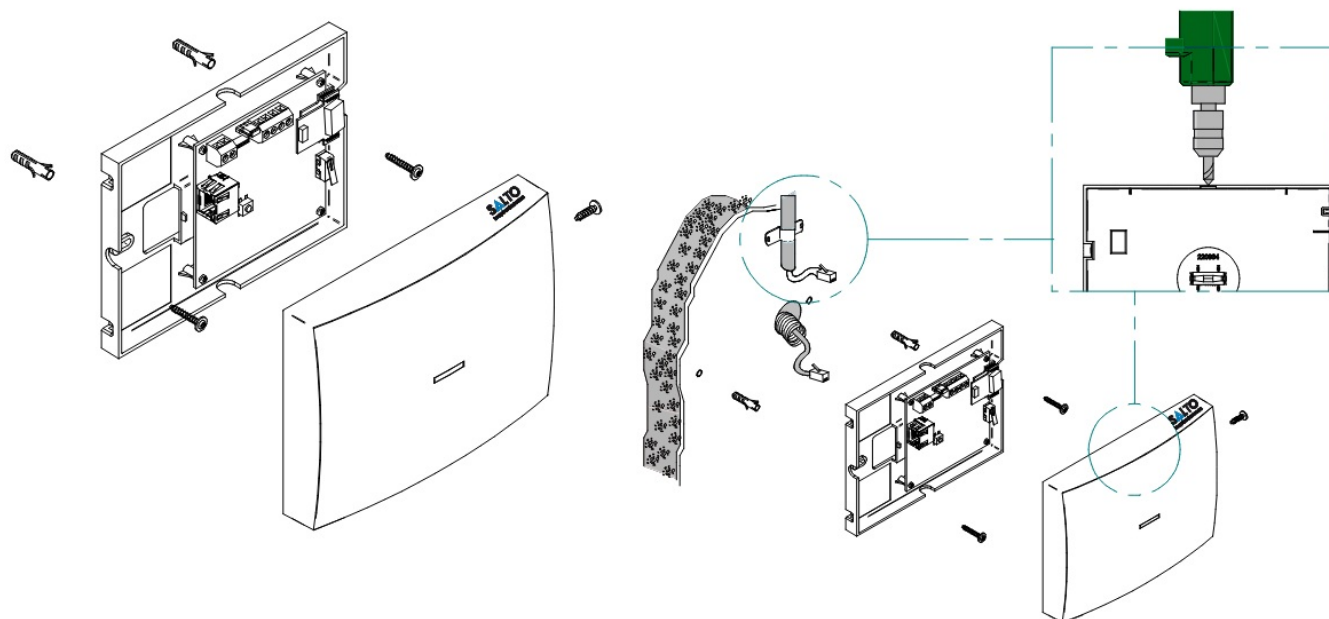

Electrical installation

- When PoE and auxiliary power supplies are connected at the same time, PoE is disconnected.
- Pressing CLR button 5 seconds, Gateway enters in addressing mode.

 Auxiliary power supply needed when Ethernet infrastructure is not PoE (Power over Ethernet).

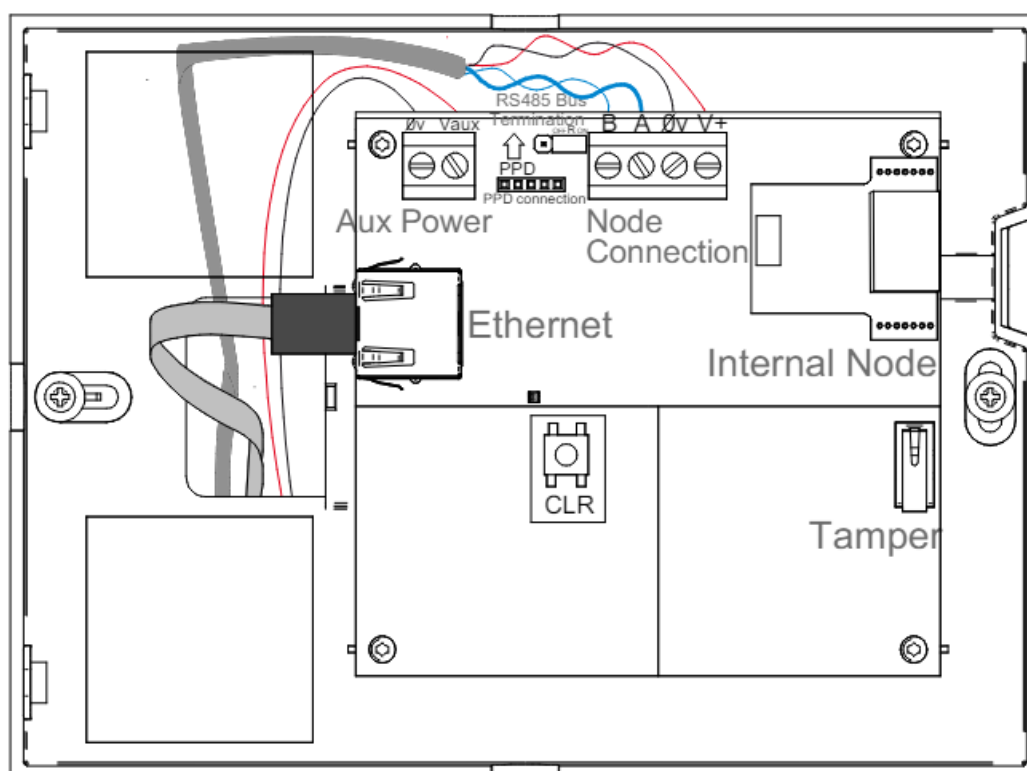

Configuration

Addressing and configuration

Gateway is a DHCP ready device. If there is no DHCP server on the local Ethernet network, user can manually configure a fixed IP address changing different parameter using SALTO Gateway Web Server:

1. Pressing CLR button for 5 seconds, SALTO Gateway enters in addressing mode (green LED turns to orange).
2. Access to 192.168.0.234 IP address with a standard browser and configure network parameters as needed.
3. Pressing again CLR button for 5 seconds or confirming the configuration, the device is going to quit the addressing mode.

When addressing process success, configure the wireless network with SALTO's software (check the help of the application).

The image displays three sequential screenshots of the SALTO Gateway web interface, accessed via a browser at 192.168.0.234. The interface features the SALTO logo and the text 'inspiredaccess'.

Top Screenshot: The 'Gateway02' configuration page. The 'Address configuration' section shows 'Static' selected. The IP address is set to 192.168.0.233, the subnet mask to 255.255.255.000, and the gateway to 192.168.0.001. A 'Send' button is at the bottom right.

Middle Screenshot: The 'Gateway02' configuration page. The 'Address configuration' section shows 'Dynamic' selected. The 'Mac Number' is 000A83000010, and the 'Network Name' is SALTO-GW02-000010. A 'Send' button is at the bottom right.

Bottom Screenshot: A confirmation message stating 'Configuration successfully sent.' displayed within a dashed border.

Installation example

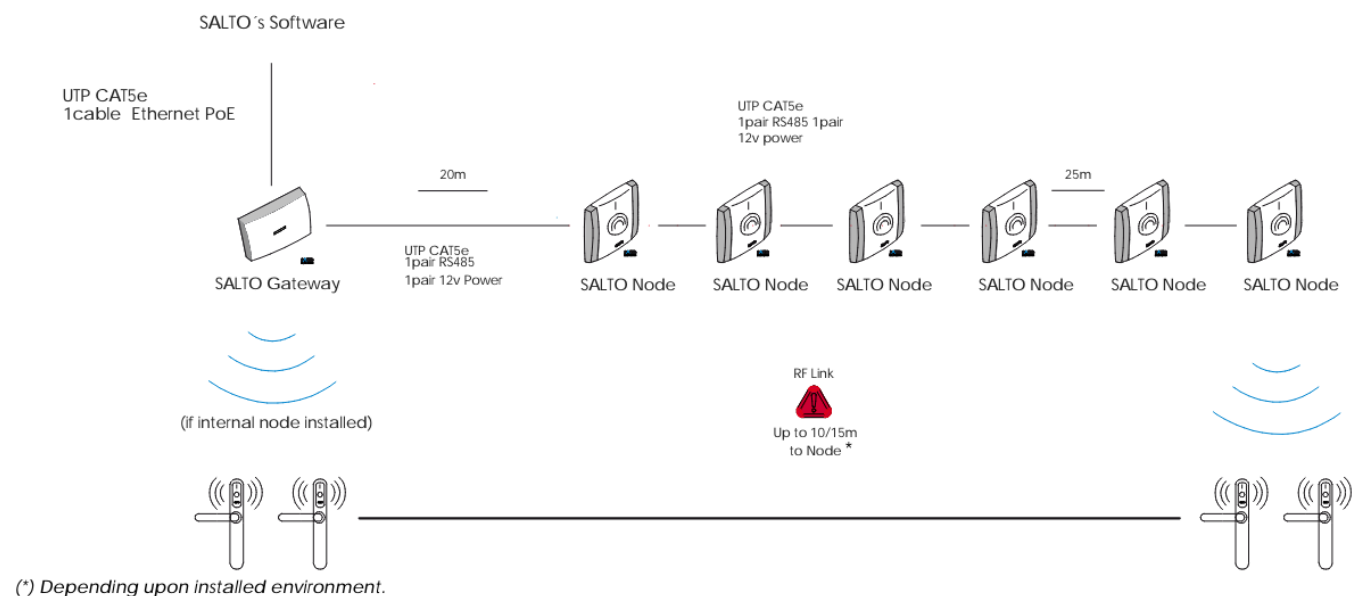

Signalling

LED COLOR	DESCRIPTION
No light	Lack of power supply
Green	Everything is OK
Orange	Gateway in "Addressing mode"
Red	Gateway in "Bootloader mode" state
Flashing Green	No initialized by SALTO's software

The LEDs on the Ethernet Connector show the state of the Ethernet communication

LED COLOR	DESCRIPTION
No light	No Ethernet Connection
Green	Ethernet active
Flashing Orange	Data transfer taking place through Ethernet

Operational test

Once the product is installed, follow these steps to check the correct operation:

- Visually check that the LED is active after power on.
- When nodes and locks are installed, check that the LED is green.
- Check Ethernet connector LED to know communication state.

This unit should be tested at least once a year as described in "Operational Test".

Documents / Resources

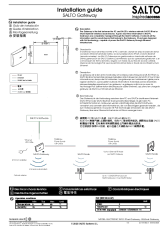
	<p>SALTO GATEWAYW3CAUS Bluenet Wireless Gateway [pdf] Installation Guide GATEWAYW3CAUS Bluenet Wireless Gateway, GATEWAYW3CAUS, Bluenet Wireless Gateway, Wireless Gateway, Gateway</p>
---	---

References

- [User Manual](#)

Manuals+, Privacy Policy

This website is an independent publication and is neither affiliated with nor endorsed by any of the trademark owners. The "Bluetooth®" word mark and logos are registered trademarks owned by Bluetooth SIG, Inc. The "Wi-Fi®" word mark and logos are registered trademarks owned by the Wi-Fi Alliance. Any use of these marks on this website does not imply any affiliation with or endorsement.