



SAKOBS SB925D 2.1 Ch SoundBar with Wireless Subwoofer User Manual

[Home](#) » [SAKOBS](#) » SAKOBS SB925D 2.1 Ch SoundBar with Wireless Subwoofer User Manual 

SAKOBS SB925D 2.1 Ch SoundBar with Wireless Subwoofer User Manual



Contents

- 1 Important Safety Instruction
- 2 What's in the Box
- 3 Identifying the Parts
- 4 Instructions
 - 4.1 Replace the Remote Control Battery
 - 4.2 Placement and Mounting
 - 4.3 Precautions Concerning Batteries
 - 4.4 Wall Mounting (if using option-B)
 - 4.5 Connections
 - 4.6 Connect Power
- 5 Documents / Resources
- 6 Related Posts

Important Safety Instruction



Caution



Risk of electric shock Do not open



The lightning flash with arrowhead symbol, within an equilateral triangle, is intended to alert the user to the presence of uninsulated "dangerous voltage" within the product's enclosure that may be of sufficient magnitude as to constitute a risk of electric shock to persons.



The exclamation point within an equilateral triangle is intended to alert the user to the presence of important operating and maintenance (servicing) instructions in the literature accompanying the appliance.

Safety

1. Read these instructions — All the safety and operating instructions should be read before this unit is operated.
2. Keep these instructions — The safety and operating instructions should be retained for future reference.
3. Heed all warnings — All warnings on the appliance and in the operating instructions should be adhered to.
4. Follow all instructions — All operating and usage instructions should be followed.
5. Do not use this unit near water — The appliance should not be used near water or moisture — for example, in a wet basement or near a swimming pool or similar location.
6. Clean only with a dry cloth.
7. Do not block any ventilation openings. Install in accordance with the manufacturer's instructions.
8. Do not install near any heat sources such as radiators, heaters, stoves, or other apparatus (including amplifiers) that produce heat.
9. The unit is supplied with a standard mains lead and molded plug which for safety reason must not be modified.
If the provided plug does not fit into your wall socket, consult an electrician for replacement of the obsolete mains socket.
10. Protect the power cord from being walked on or pinched particularly at plugs, convenience receptacles, and the point where they exit from the apparatus.
11. Only use attachments/accessories specified by the manufacturer.



12. Use only with the cart, stand, tripod, bracket or table specified by the manufacturer, or sold with the unit.
When a cart or rack is used, use caution when moving the cart/unit combination to avoid injury from tip-over.
13. Unplug the unit during lightning storms or when unused for long periods of time.
14. Refer all servicing to personnel. Servicing is required when the unit has been damaged in any way, such as power supply cord or plug is damaged, liquid has been spilled or objects have fallen into the unit, the unit has been exposed to rain or moisture, does not operate normally, or has been dropped.



15. This equipment is a Class II or double insulated electrical appliance. It has been designed in such a way that it does not require a safety connection to electrical earth.
16. Do not place liquid filled objects such as vases on the unit.
17. Minimum distance around the unit for sufficient ventilation is 5cm.
18. The ventilation should not be impeded by covering the ventilation openings with items, such as newspapers, table-cloths, curtains, etc.
19. No naked sources, such as lighted candles, should be placed on the unit.
20. Batteries should be recycled or disposed of as per state and local guidelines.
21. The unit can be used in moderate or tropical climates.

Caution:

- To reduce the risk of fire or electric shock, do not expose this unit to rain or moisture. The unit must not be exposed to dripping or splashing and objects with liquids, such as vases, must not be placed on unit.
- The mains plug/appliance coupler is used as the disconnect device, the disconnect device must remain readily operable.
- Danger of explosion if battery is incorrectly replaced. Replace only with the same or equivalent type.

Warning

- The battery (batteries or battery pack) shall not be exposed to excessive heat such fires, or other direct heat sources.
- Before operating this unit, check the voltage of this unit to see if it is identical to the voltage of your local power supply.
- Do not place this unit close to strong magnetic fields
- Do not place this unit on the or amplifier or receiver.
- If any solid object or liquid falls into the system, unplug the system and have it checked by qualified personnel before operating it any further.
- Do not attempt to clean the unit with chemical solvents as this may damage the finish. Use a clean, dry or slightly damp cloth.
- When removing the power plug from the wall outlet, always pull directly on the plug, never yank on the cord.
- Changes or actions to this unit not expressly approved by the party responsible for compliance will void the user's authority to operate the equipment.
- The rating label is pasted on the bottom or back of the equipment.

Battery usage Caution

To prevent battery leakage which may result in bodily injury, property damage, or damage to the apparatus:

- Install all batteries correctly, + and – as marked on the apparatus.
- Do not mix old and new batteries.
- Do not mix alkaline, standard (Carbon-Zinc) or rechargeable (Ni-Cd, Ni-MH, etc.) batteries.
- Remove batteries when the unit is not used for a long time.



Correct Disposal of this product. This marking indicates that this product should not be disposed with other household wastes throughout the EU. To prevent possible harm to the environment or human health from uncontrolled waste disposal, recycle it responsibly to promote the sustainable reuse of material resources. To return your used device, please use the return and collection systems or contact the retailer where the product was purchased. They can take this product for environmental safe recycling.

CE Hereby, Shenzhen Yicheng Technology Co., Ltd declares that the 2.1 channel soundbar with wireless subwoofer is in compliance with the essential requirements and other relevant provisions of Directive 2014/53/EU Bluetooth®



The Bluetooth word mark and logos are registered trademarks owned by Bluetooth SIG, Inc.

What's in the Box

- Main unit



- Remote Control



- Wireless Subwoofer



- AC Power Cord

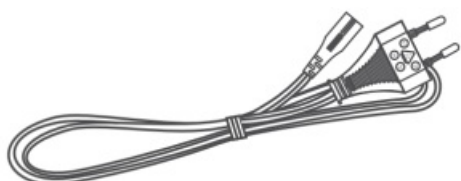

- Optical Cable

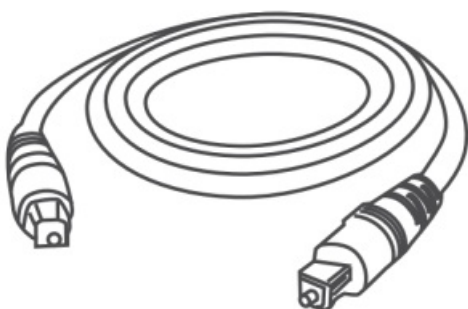

- 3.5 mm-cable male RCA cable

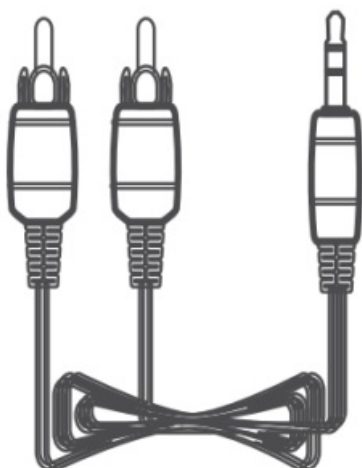

- 3.5 mm Audio cable

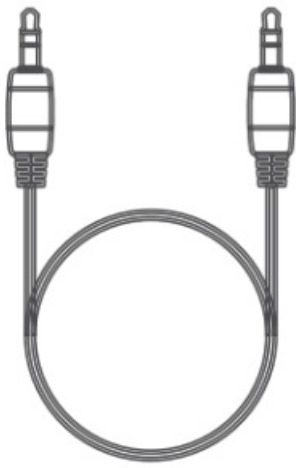

- DC Adapter

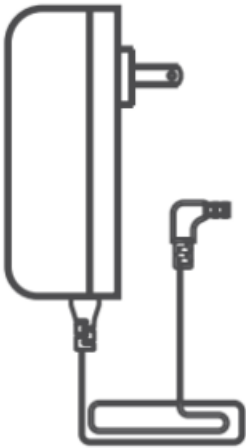

- User manual



- Wall mounting Kit

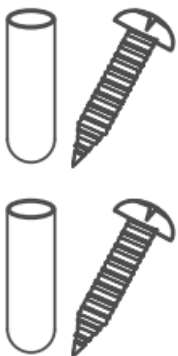

Identifying the Parts

Main Unit

1. + (Vol+) Buttons Increase the volume level.
2. – (Vol-) Buttons Decrease the volume level.
3. (SOURCE) Button Select the play mode.
4. (ON/OFF) Button Switch the unit between ON and STANDBY mode.

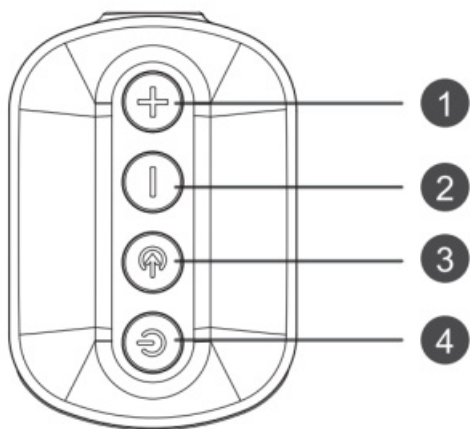

5. AUX IN Socket Connect to an external audio device.
6. OPTICAL Socket Connect to an optical audio output on the TV.
7. DC IN Socket Connect to the power supply.

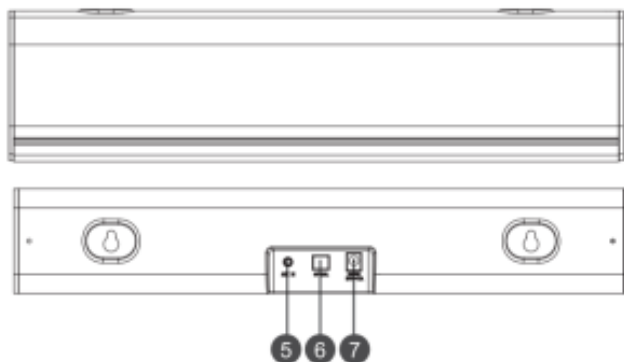

Wireless Subwoofer

1. PAIR Indicator
Light up solidly when the pairing succeed.
2. Reset Button
Reset the unit and broadcast the Bluetooth version.
3. AC IN Socket
Connect to power supply.

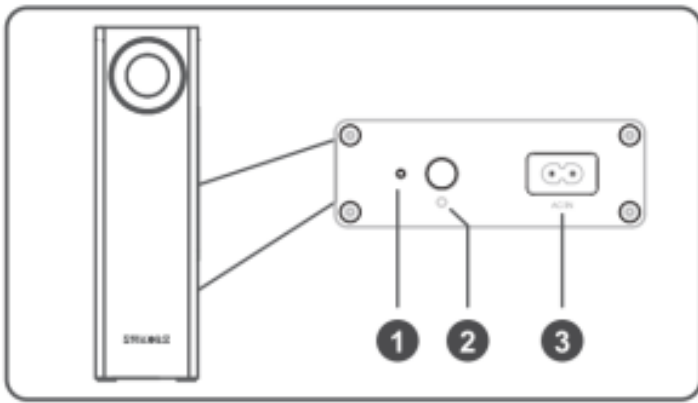

Remote Control



Switch the unit between ON and STANDBY mode.



Select the Bluetooth mode.



Increase/decrease the volume level.



Standard EQ mode.



Increase/decrease the bass level.



Select the play mode.



Mute or resume the volume.



Play/pause/resume playback in BT/OPT mode. Press and hold to activate the pairing function in Bluetooth mode or disconnect the existing paired Bluetooth device.



Skip to previous/next track in BT mode.



Press the sound mode on the remote control to select desired preset equalizers: MUSIC, TV, MOVIE.

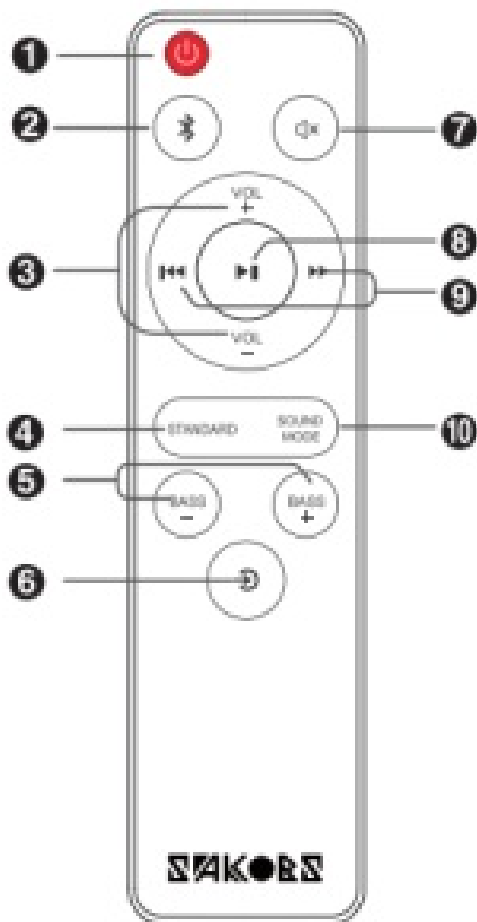

Instructions

Prepare the Remote Control

The provided Remote Control allows the unit to be operated from a distance.

- Even if the Remote Control is operated within the effective range 19.7 feet (6m), remote control operation may be disrupted if there are any obstacles between the unit and the remote control.
- If the Remote Control is operated near other products which generate infrared rays, or if other remote control devices using infra-red rays are used near the unit, it may operate incorrectly. Conversely, the other products may operate incorrectly.

Replace the Remote Control Battery

1. Press and slide the back cover to open the battery compartment of the remote control.
2. Insert two AAA size batteries . Make sure the (+) and (—) ends of the batteries match the (+) and (—) ends indicated in the battery compartment.
3. Close the battery compartment cover.

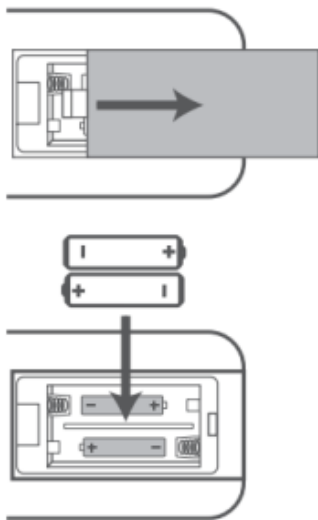

Placement and Mounting

Placement

1. If your TV is placed on a table, you can place the unit on the table directly in front of the N stand, centered with the N screen.
2. If your N is attached to a wall, you can mount the unit on the wall directly below the N screen.

Precautions Concerning Batteries

- Be sure to insert the batteries with correct positive “+” and negative “-” polarities.
- Use batteries of the same type. Never use different types of batteries together.
- Either rechargeable or non-rechargeable batteries can be used. Refer to the precautions on their labels.
- Be aware of your fingernails when removing the battery cover and the battery.
- Do not drop the remote control.
- Do not allow anything to impact the remote control.
- Do not spill water or any liquid on the remote control.
- Do not place the remote control on a wet object.
- Do not place the remote control under direct sunlight or near sources of excessive heat.
- Remove the battery from the remote control when not in use for a long period of time, as corrosion or battery leakage may occur and result in physical injury, and/or property damage, and/or fire.
- Do not use any batteries other than those specified
- Do not mix new batteries with old ones.
- Never recharge a battery unless it is confirmed to be a rechargeable type.

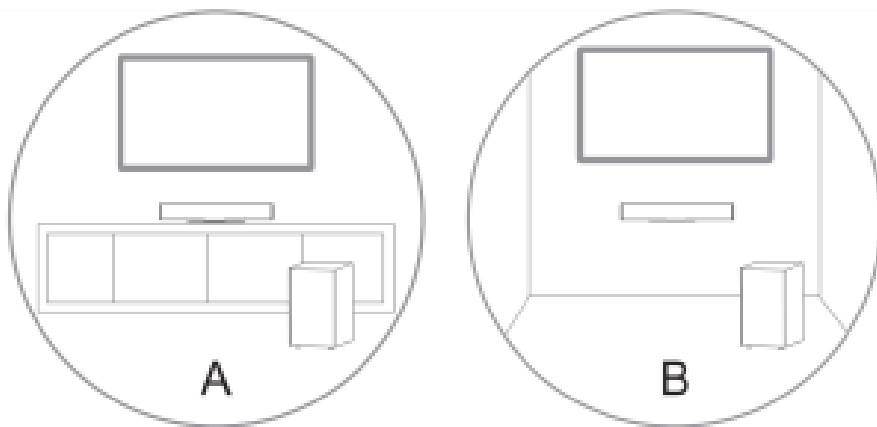

Wall Mounting (if using option-B)

Note:

- Installation must be carried out by qualified personnel only. In correct assembly can result in severe personal injury and property damage (if you intend to install this product yourself, you must check for installations such as electrical wiring and plumbing that may be buried inside the wall). It is the installer's responsibility to verify that the wall will safely support the total load of the unit and wall brackets.
- Additional tools (not included) are required for the installation.
- Do not overtighten screws.
- Keep this instruction manual for future reference.
- Use an electronic stud finder to check the wall type before drilling and mounting.

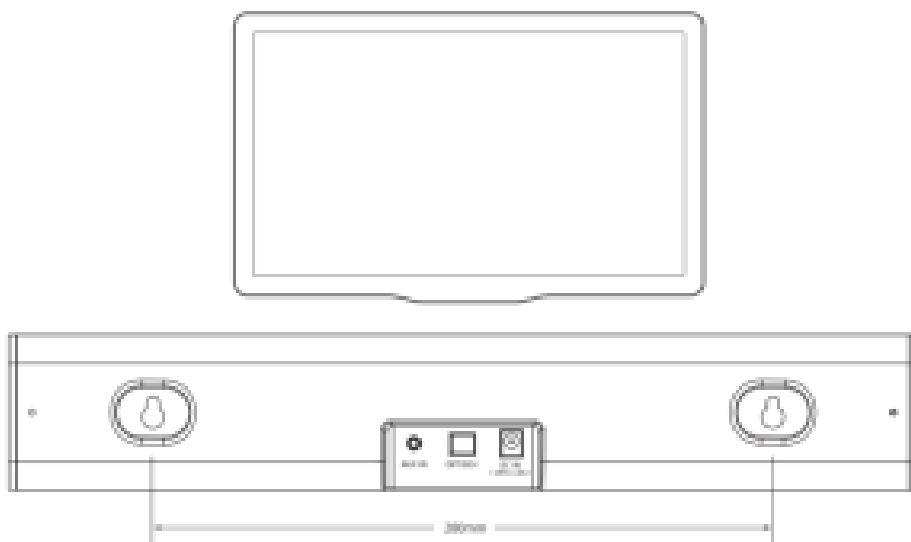

Connections

Connect to OPTICAL Socket

- Remove the protective cap of the OPTICAL socket, then connect an OPTICAL cable to the N's OPTICAL OUT socket and the OPTICAL socket on the unit.

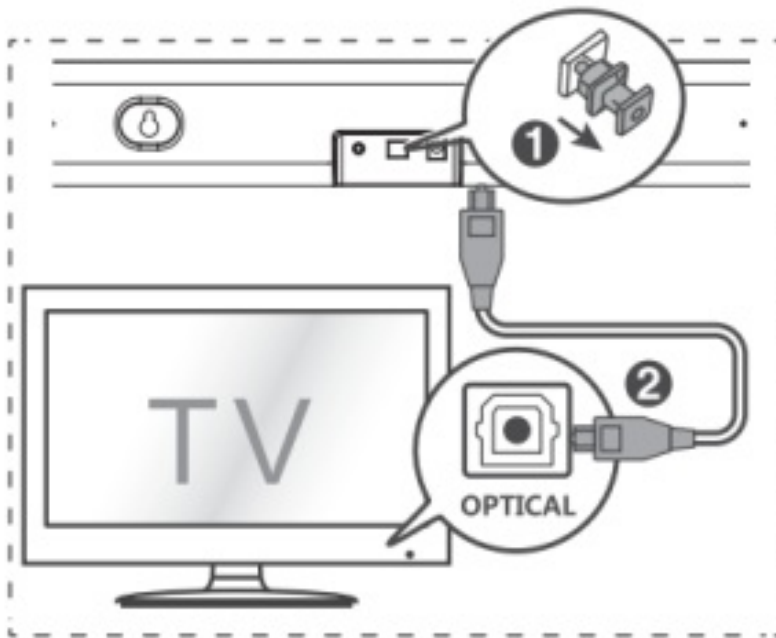

Connect to AUX Socket

1. Use a 3.5mm-male male RCA cable to connect the TV's audio output sockets (NO AUDIO IN) to the AUX socket on the unit.
2. Use a 3.5mm to 3.5mm audio cable to connect the TV's or external audio device AUX socket to the AUX socket on the unit.

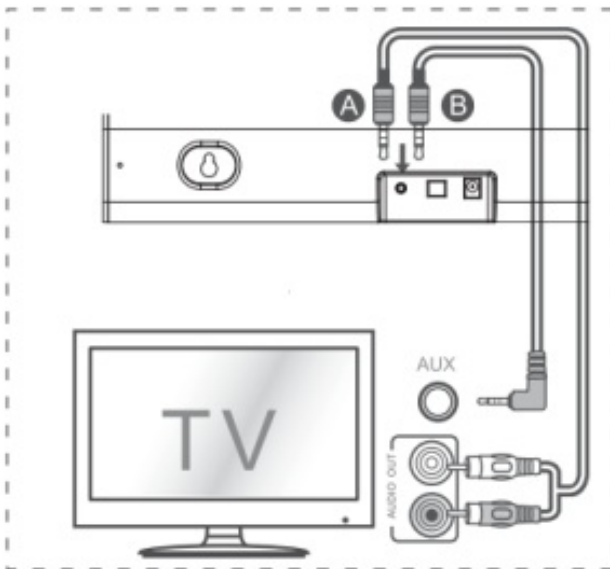

Connect Power

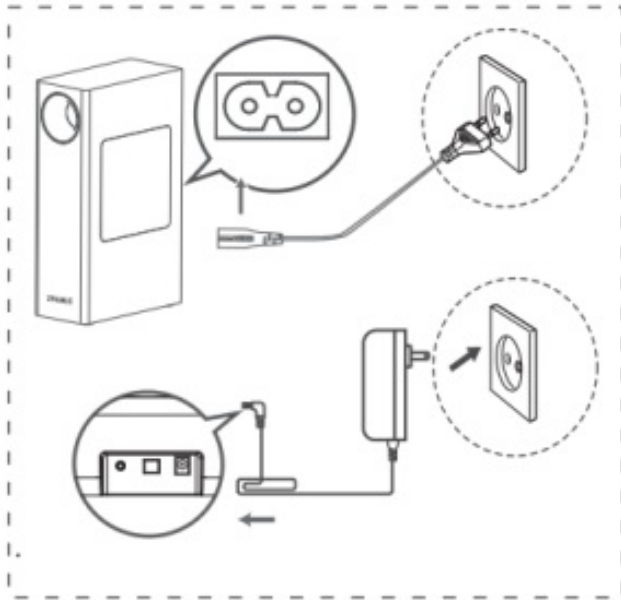

Risk of product damage!

- Ensure that the power supply voltage corresponds to the voltage printed on the back or the underside of the unit.
- Before connecting the AC power cord, ensure you have completed all other connections.

Subwoofer

- Connect the mains cable to the AC IN Socket of the subwoofer and then into a mains socket.

Sound bar

- Connect the Power adaptor to the DC IN Socket of main unit and then into a mains socket.

US: services@sakobs.cc

EU: desevirces@sakobs.cc

JP: jpservices@sakobs.cc



