

SAGEWORK Atlas Magnetic Guitar Support



SAGEWORK Atlas Magnetic Guitar Support Instruction Manual

[Home](#) » [SAGEWORK](#) » SAGEWORK Atlas Magnetic Guitar Support Instruction Manual 

Contents

- [1 SAGEWORK Atlas Magnetic Guitar Support](#)
- [2 Product Information](#)
- [3 Product Usage Instructions](#)
- [4 What's in the box](#)
- [5 Installation instructions](#)
- [6 KEY POINTS / SUMMARY](#)
- [7 Documents / Resources](#)
 - [7.1 References](#)
- [8 Related Posts](#)



SAGEWORK Atlas Magnetic Guitar Support



Product Information

Specifications:

- Brand: Sagework Guitar Supports LLC
- Model: Guitar Support
- Magnets: Neodymium (rare earth)
- Contents in the Box:
 1. One guitar support assembly
 2. Two low-tack marker strips
 3. Two interior magnet holders
 4. One Allen wrench
 5. Three 3M TMCommand Strips (1 spare)
 6. Instruction sheet

Product Usage Instructions

General Safety Information:

The neodymium magnets supplied with the Sagework Guitar Support are very strong and require careful handling to prevent personal injury and damage to the guitar or other items.

Caution:

Please read and follow the instructions carefully to avoid any damages or injuries resulting from improper installation or use of the product.

Preparation:

Place the guitar body on a table on a soft surface such as a bath towel. Loosen the strings to allow access through the sound hole.

Installation Instructions:

1. Magnet Holder Installation:

- Place one internal magnet holder inside the guitar body against the lower bout, ensuring the exposed magnets face the instrument's side.
- Slowly slide the rear end of the support along the outside of the instrument towards the magnet holder until it locks into place.
- Repeat the process with the second magnet holder at the front of the support, avoiding placing it directly at the location of the interior magnet.

Note: Be cautious of interior braces on some instruments; ensure magnets are placed between these braces to prevent damage to the guitar.

FAQ



• Q: Can neodymium magnets damage electronic devices?

A: Yes, neodymium magnets can damage magnetic media, CRT displays, and affect devices like credit cards and pacemakers. Avoid placing them near such items.

Installation Instructions

General safety information for magnets

The magnets supplied with your Sagework Guitar Support are very strong and pose potential safety hazards.

-  Neodymium (rare earth) magnetic fields are extremely strong. They must be handled with care to avoid personal injury, damage to the magnets, and damage to your guitar. Fingers and other body parts can be very painfully pinched between two attracting magnets. Neodymium magnets are brittle and can peel, crack, or shatter if allowed to come together at high speeds.
-  The strong magnetic fields of neodymium magnets can damage magnetic media such as credit cards and magnetic I.D. cards, as well as CRT televisions, VCRs, CRT computer monitors, and other CRT displays. Do not place neodymium magnets near these electronic appliances.
-  Never allow neodymium magnets near a person with a pacemaker or similar medical aid. Magnetic fields of magnets can affect the operation of such devices. We recommend that persons with such medical devices not use our product.

Caution

- Please read and follow these instructions carefully
- Sagework Guitar Supports LLC is not responsible for any damages and/or injuries resulting from improper installation or use of this product.
- If you are uncomfortable with installing this product, seek the assistance of a professional guitar technician.
- Newly applied instrument finishes may not be fully cured. No support, including your Sagework Guitar Support, should be used on a newly applied (uncured) instrument finish, as damage may occur. If your instrument is newly finished, please confirm with the manufacturer that the finish has fully cured.

What's in the box

1. One guitar support assembly
2. Two low-tack marker strips
3. Two interior magnet holders
4. One Allen wrench
5. Three 3M™Command Strips (1 spare)
6. This instruction sheet

Installation instructions

- **Preparation:** Place the guitar body on a table on top of a soft surface such as a bath towel. Loosen the strings enough to allow passage of your hand through the sound hole.
- **WARNING:** Always be absolutely sure that the cork is clean and free from debris.

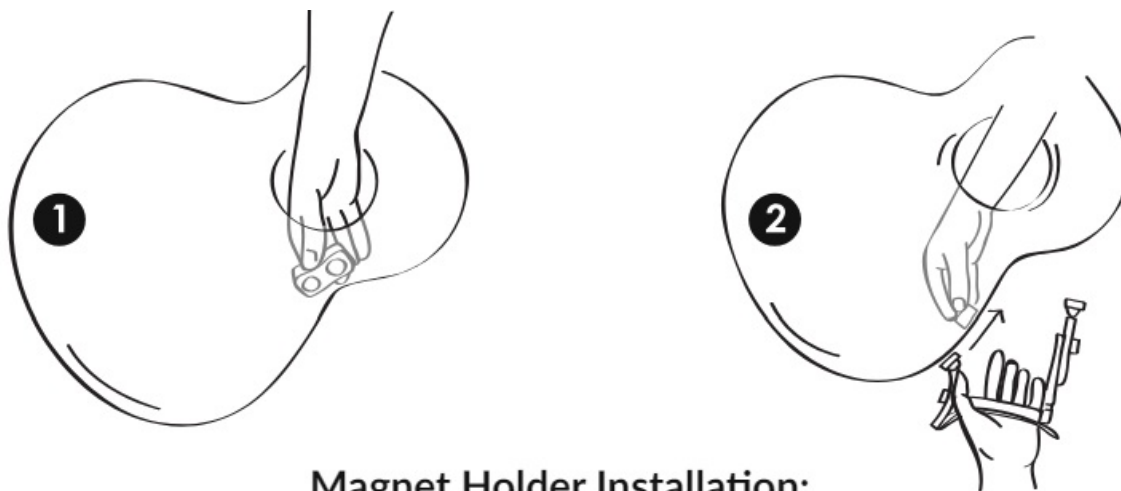

Magnet Holder Installation:

1. Place one of the internal magnet holders inside the body of the instrument and hold it against the side of the lower bout. Make sure the exposed magnets are facing the side of the instrument.
 2. Firmly grasp your support and slowly slide the rear end of the support along the outside of the instrument toward the location of the magnet holder until the support locks into place.
- Repeat this process with the second magnet holder and the front of the support. The second magnet holder will be placed inside the instrument on the side of the upper bout. Be sure to NOT place the support directly at the location of the interior magnet. Place the support a few inches away and slide it slowly toward the interior magnet.

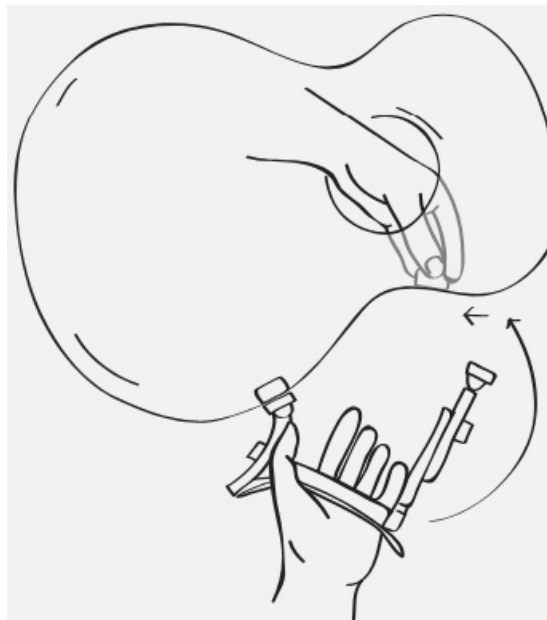

- The support should now be attached to the instrument.

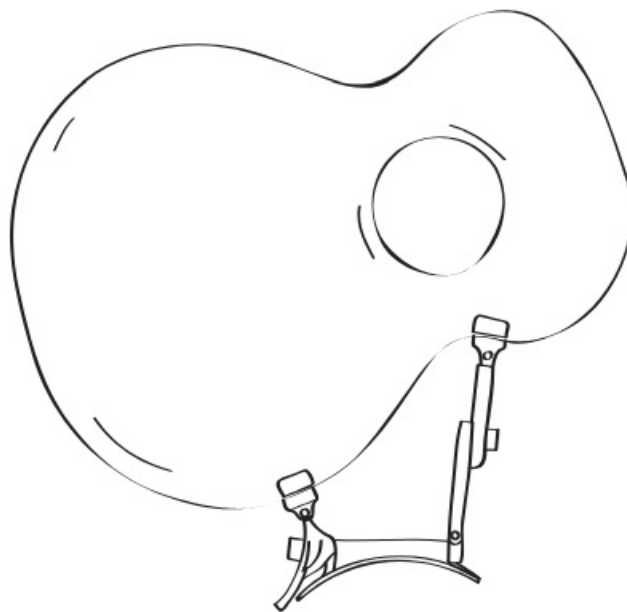

- **Locating the Support:** With the support attached to the instrument, you are now able to determine the correct placement for your playing position. To adjust, slowly slide the support along the guitar body. The interior magnets will follow the support. (Be sure not to allow them to slide over any interior bracing.) This positioning step is only performed once, during the initial installation process. Position the support such that it is touching the guitar at areas with minimal curvature. Be sure it is touching only the sides of the guitar, not any bindings or braces. This will allow the interior adhesive strips to have their maximum adhesion strength.
- **NOTE:** Some instruments have interior braces on the sides of the instrument. The magnets will NOT slide over these braces. The magnets must be placed between these braces when fitting the support. Attempting to slide the magnets over these braces may result in damage to the guitar.

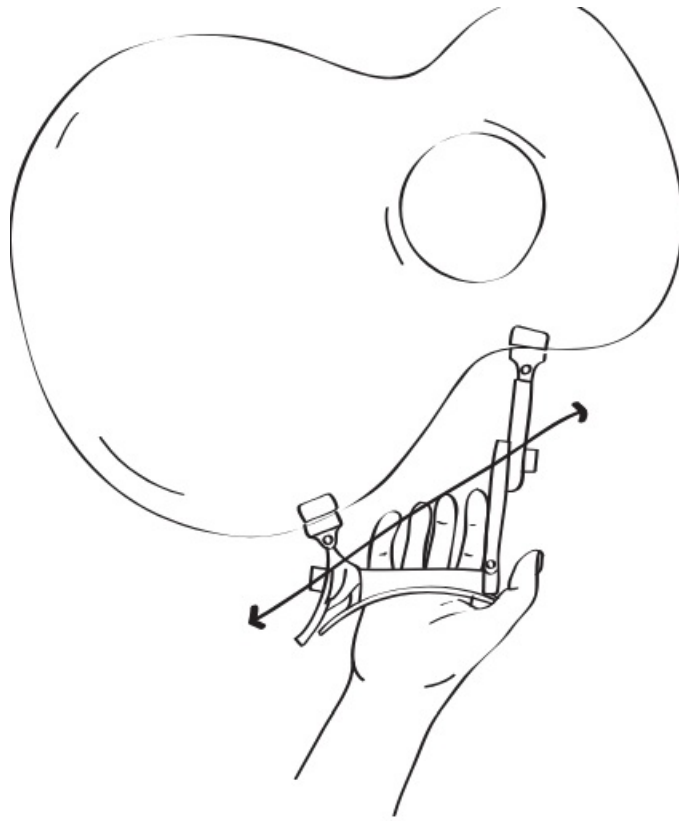

- Once you've found your preferred position, mark the locations of the front and rear exterior magnet holders with the low-tack marking strips supplied in the box. To prevent damage, hold the support in place and carefully remove each magnet holder.

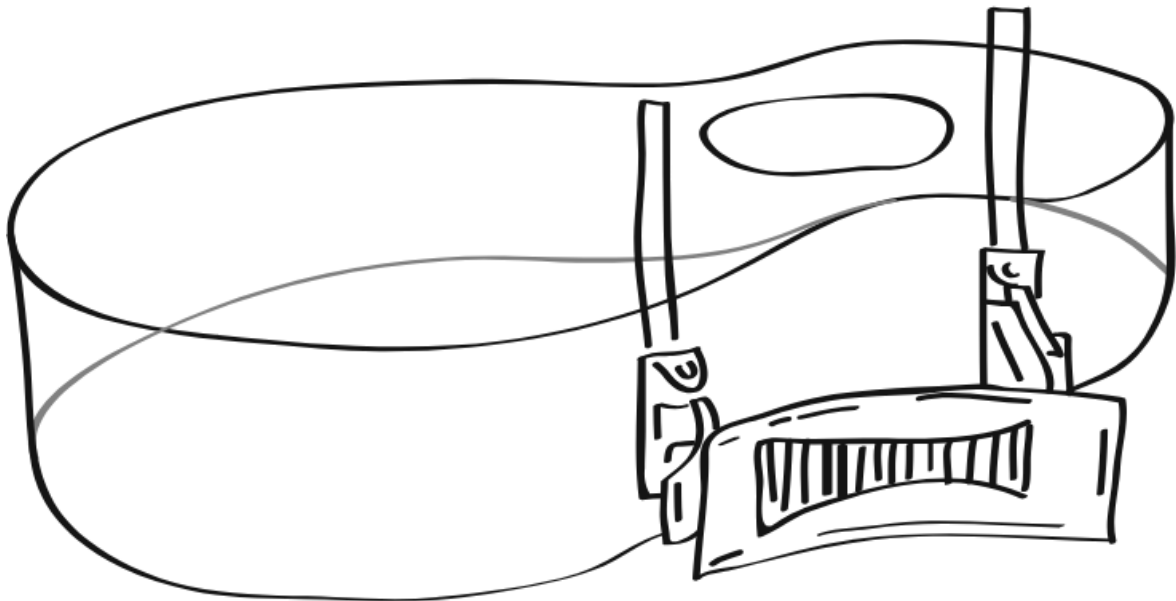

Adhesive Strip Installation

- Remove the red covering from the adhesive strip and securely affix it to the side of the internal magnet holder that has the two exposed magnet surfaces. Be sure to leave the tab at the end of the adhesive strip protruding beyond the end of the internal magnet holder.

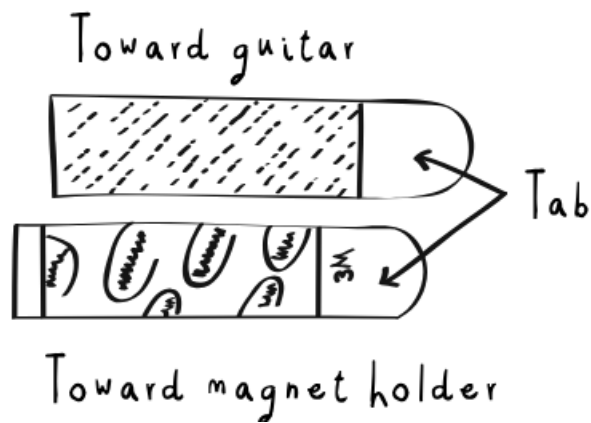

- **IMPORTANT:** Be sure to clean the interior of your guitar where the internal magnets will be positioned before applying the strips.

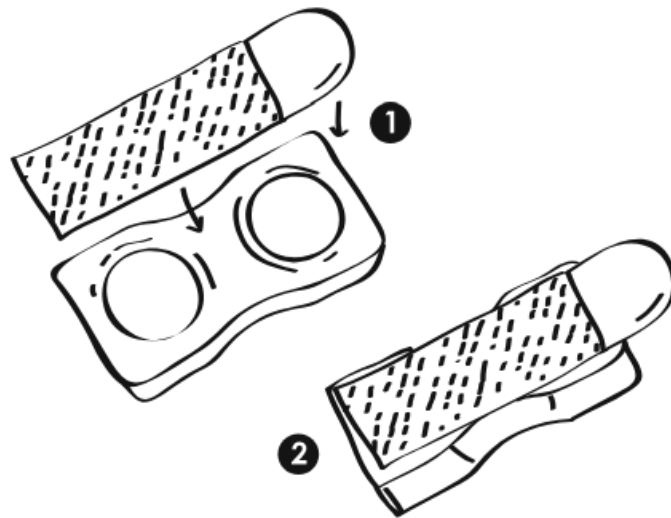

- Hold the rear of the support in the proper location on the instrument as indicated by the tape position marker.
- Remove the black covering of the adhesive strip and place the magnet holder inside the body of the guitar.
- Holding firmly onto the magnet holder, slowly guide the internal magnet holder toward the support through the sound hole. Be sure not to let go of the magnet holder until it is attached to the side of the guitar.
- The internal magnet holder will be attracted to the support and easily “find” the proper location. Securely press the magnet holder into place and hold it there for 30 seconds to ensure proper adhesion. Repeat this process with the second magnet holder and the front of the support.



- **IMPORTANT:** Do not affix and then move a Command Strip to reposition it. It can only stick once for proper adhesion. Once positioned, leave the support in place for at least 120 minutes for the adhesive strips to properly cure.
- If you need to remove the internal magnets
The 3M adhesive used to secure the internal magnet holders is specially formulated to release cleanly even after years of installation. To remove the internal magnet holders from inside the instrument, **VERY SLOWLY** pull laterally on the adhesive's exposed tab until the adhesive releases. Be patient; the adhesive will release gradually. Too much force all at once may cause the tab to break or the adhesive to release suddenly. If the tab breaks, first try rotating the magnet holder along the plane of the side of the guitar. If this is not possible, sliding a credit card between the magnet holder and the side of the guitar should allow the magnet holder to be removed.
- **Adjusting the Screws**
- The arms and magnet holders of the support are meant to move freely when the support is not attached to the guitar. The Allen wrench can be used to loosen or tighten these screws to your preference. Do not attempt to over-tighten these screws or the threads in the support will strip. The arms and magnet holders cannot be tightened such that their joints are immobile. The support will be fixed and stable when attached to the guitar.
- **NOTE:** Be sure the long arm is not angled inward toward the curved arm or the support will collapse under pressure.

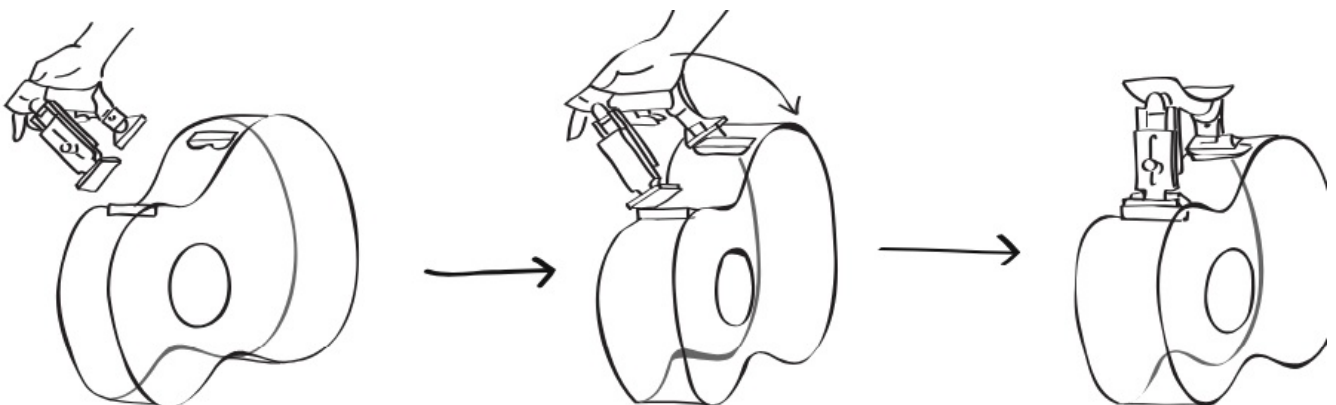

Attaching and removing the support

- Holding the support at a 45° angle to the side of the guitar, slowly move the support toward the guitar. The magnets on the support will find their corresponding interior magnets.
- When the support pad edges touch the side of the guitar, slowly rotate the support toward the guitar. The support will position itself into the correct place.
- Removal of the support is simply the reverse of its attachment. First, rotate one side of the support away from the guitar. Then, with the support at a 45° angle to the guitar, pull the support away from the instrument.

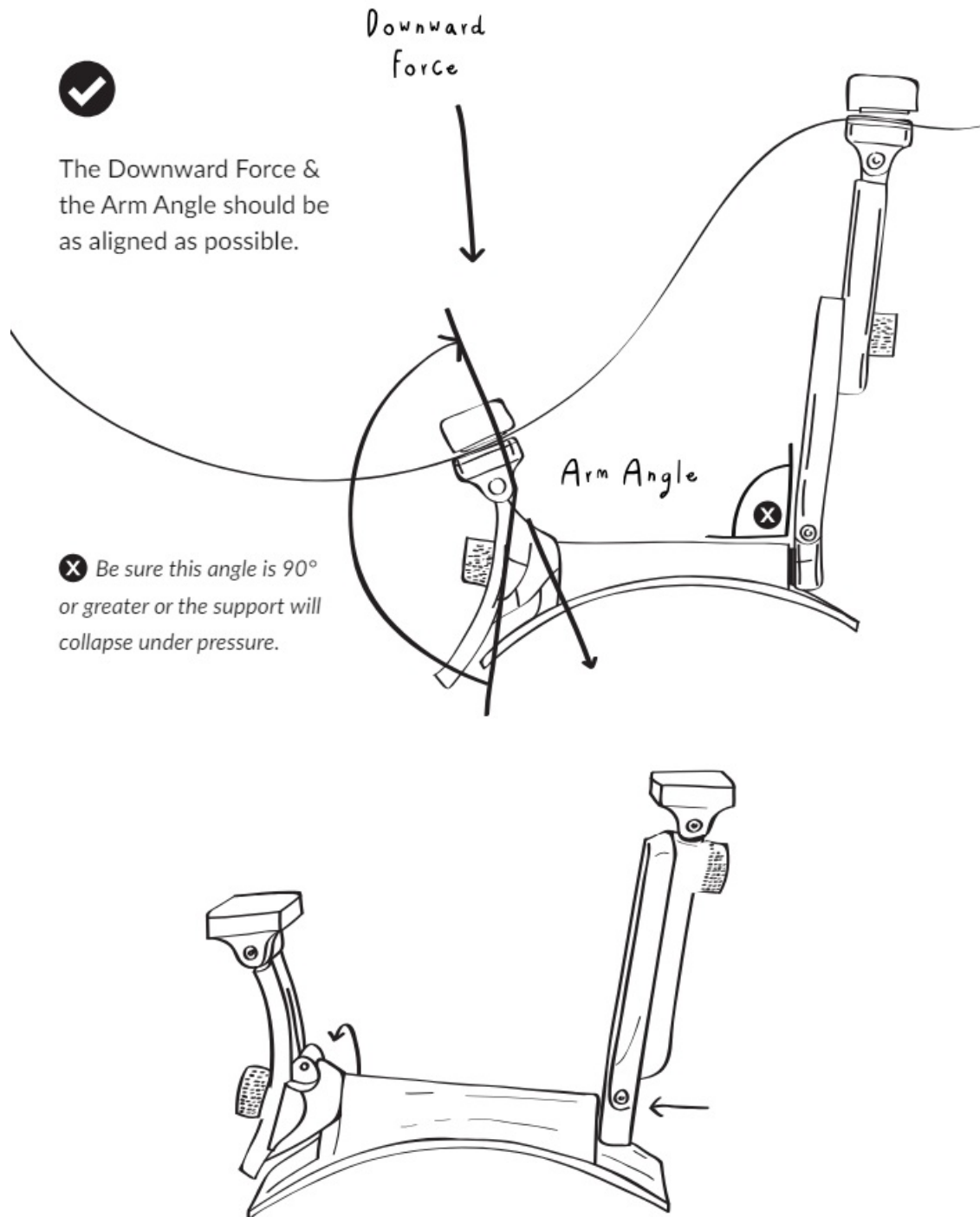

Angle adjustment

- To adjust the angle of the support toward or away from your body, apply pressure as shown in #1 above and rotate as shown in #2.
- **NOTE:** It is best to adjust these angles with the support not attached to your guitar.

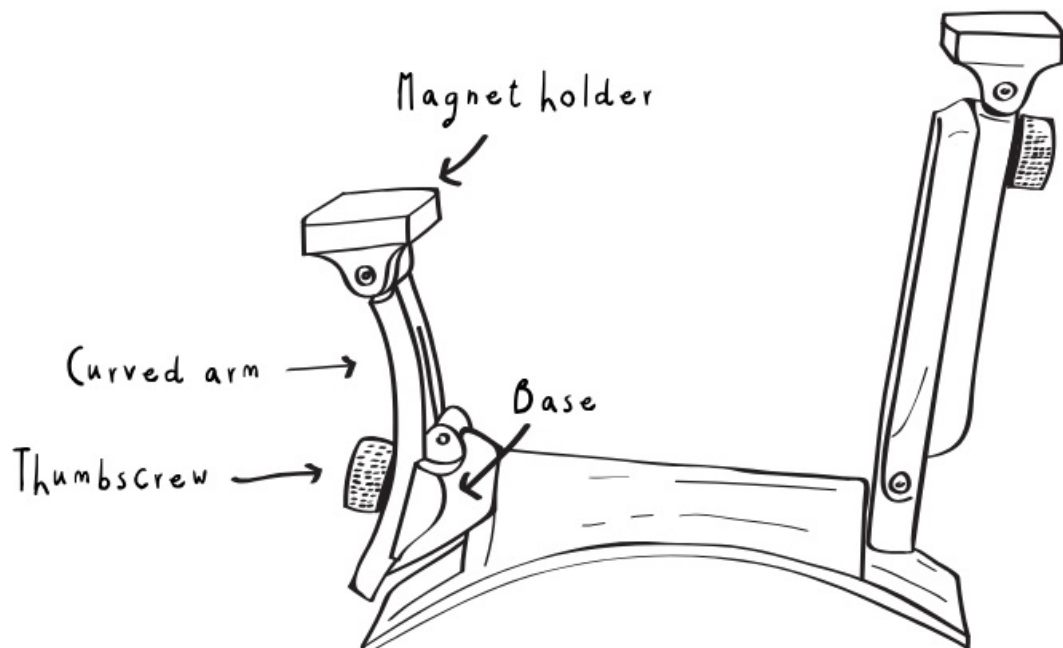

- For a slightly lower support, the curved arm can be removed and its magnet holder attached directly to the base of the support by 1. removing the thumbscrew to detach the curved arm, 2. removing the screws on either side of the magnet holder to detach the magnet holder, and 3. affixing the magnet holder to the base using the screws removed in step 2 above.

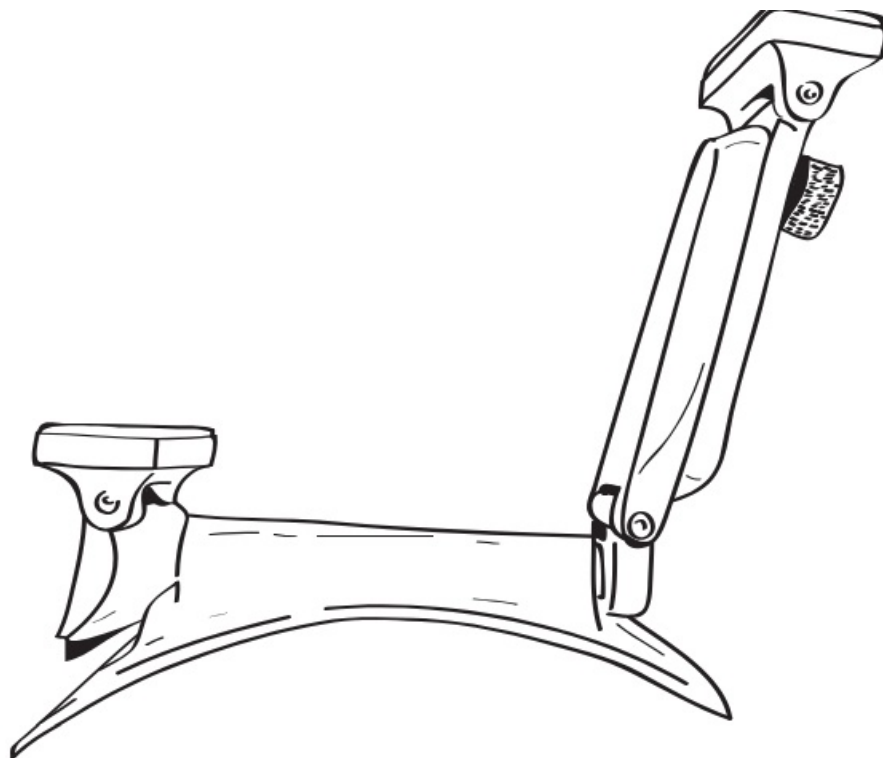

- Curved Arm removed and Magnet Holder attached directly to the Base

KEY POINTS / SUMMARY

1. ALWAYS keep the cork clean to avoid scratching your guitar.
2. DO NOT USE this support if you have a pacemaker.
3. Be very careful with the magnets, as they are very strong. Keep a firm grip on them at all times and keep them away from each other.
4. Use only on fully-cured finishes.
5. Clean the interior of your guitar before installing internal magnets.

6. Be sure internal magnets are touching only the sides of your guitar, not any braces nor bindings.
7. Install where there is minimal curvature in the sides of your guitar.
8. Be sure the force angles are correct and the straight arm is not angled inward toward the curved arm.
9. Leave the support attached for at least 2 hours after installation.
10. Don't over-tighten the Allen screws for the magnet holders. They are meant to be fairly loose to properly conform to the angle of your guitar's side. Once in place, they will be very sturdy.
11. Don't leave your support attached to your guitar while you're not using it.

WARNING

The magnets are incredibly strong. If they slip out of your grip, they can painfully pinch your skin or damage your guitar.

Keep a tight grip on them at all times.

- Sagework Guitar Supports, LLC Asheville, NC, USA
- www.sagework.org

Documents / Resources

	SAGEWORK Atlas Magnetic Guitar Support [pdf] Instruction Manual SHORT, Atlas Magnetic Guitar Support, Atlas Magnetic Support, Magnetic Guitar Support, Guitar Support, Atlas Guitar Support, Atlas Support, Support
--	--

References

- [S Magnetic Guitar Supports. Guaranteed for Life | Sagework](#)
- [User Manual](#)

[Manuals+](#), [Privacy Policy](#)

This website is an independent publication and is neither affiliated with nor endorsed by any of the trademark owners. The "Bluetooth®" word mark and logos are registered trademarks owned by Bluetooth SIG, Inc. The "Wi-Fi®" word mark and logos are registered trademarks owned by the Wi-Fi Alliance. Any use of these marks on this website does not imply any affiliation with or endorsement.