



# SAGE LU MEI RT2 Touch Wheel RF Remote Controller Instruction Manual

[Home](#) » [SAGE LU MEI](#) » [SAGE LU MEI RT2 Touch Wheel RF Remote Controller Instruction Manual](#) 



## RT2 Touch Wheel RF Remote Controller Instruction Manual

### Contents

- [1 RT2 Touch Wheel RF Remote Controller](#)
- [2 Features](#)
- [3 Technical Parameters](#)
- [4 Mechanical Structures and Installations](#)
- [5 Operation](#)
- [6 Match Remote Control \(two match ways\)](#)
- [7 Key function](#)
- [8 Safety information](#)
- [9 Documents / Resources](#)
- [10 Related Posts](#)

## RT2 Touch Wheel RF Remote Controller

1 and 4 zones CCT/Touch color wheel/Wireless remote 30m distance/AAx2 battery



RT2  
1 Zone CCT

RT7  
4 Zone CCT

CE RoHS  LVD RED

## Features

- Apply to dual color(warm white + cool white) LED controller.
- Ultra-sensitive color adjustment touch wheel.
- Each remote can match one or more receivers.
- AAx2 battery powered.
- Operate with LED indicator light.

## Technical Parameters

Input and Output	
Output signal	RF (2.4GHz)
Working voltage	3VDC (AAx2)
Working current	5mA
Standby current	10μA
Standby time	1 year
Remote distance	30m(Barrier-free space)

Environment	
Operation temperature	Ta: -30°C ~ +55°C
IP rating	IP20

Safety and EMC	
EMC standard (EMC)	EN301 489, EN 62479
Safety standard(LVD)	EN60950
Radio Equipment(RED)	EN300 328
Certification	CE,EMC,LVD,RED

Warranty	
Warranty	5 years

Weight	
Gross weight	0.048kg
Net weight	0.088kg

## Mechanical Structures and Installations

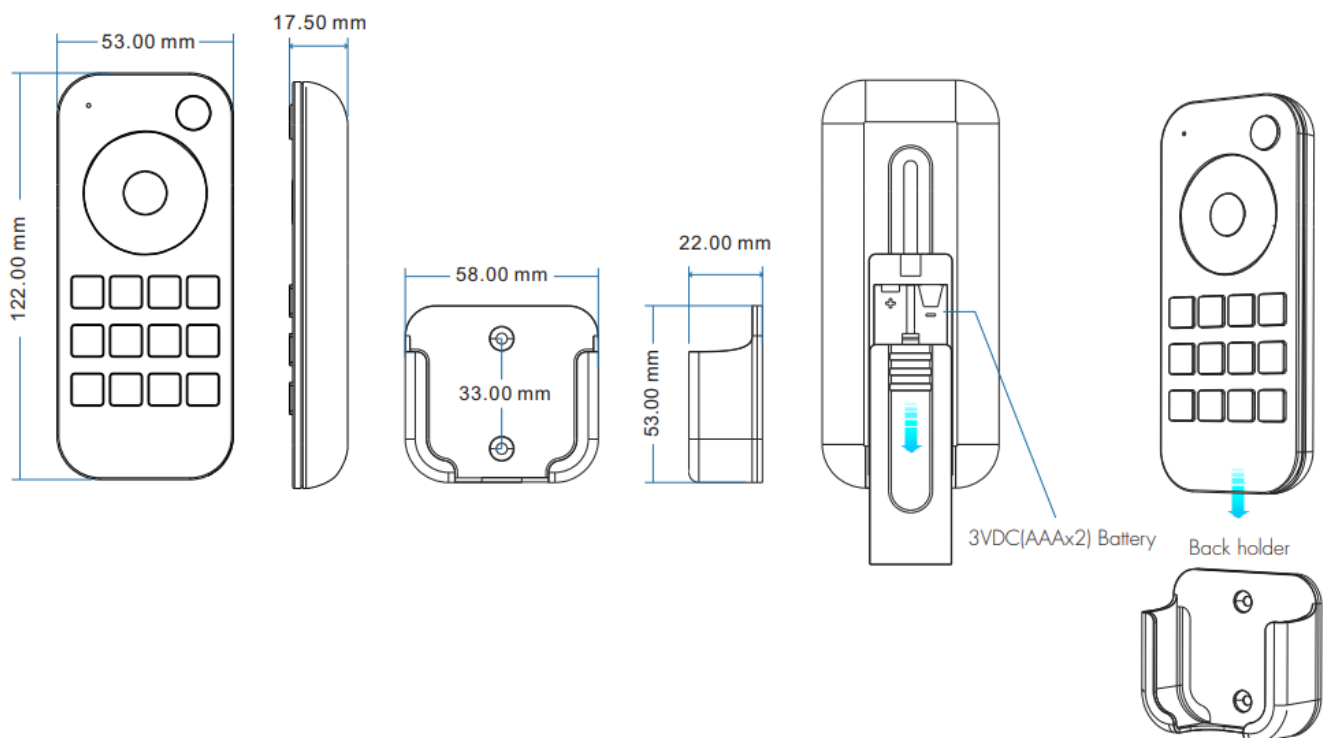

To fix the remote, two options are offered for the selection

**Option 1:** fix the remote' back holder on the wall with two screws.

**Option 2:** adhere the remote' back holder to the wall with a paster.

## Operation

- When turning on the light, the indicator displays blue. when turning off the light, the indicator display red.
- When touching the color wheel, the indicator will display the same color.

- When the press or touch operation is invalid (If the light is off), the indicator display red.
- To extend battery life, no touch or press key operation after a few seconds, the touch wheel will enter the sleep state, you need to press any key to make the touch wheel quit the sleep state.

## Match Remote Control (two match ways)

The end users can choose suitable match/delete ways. Two options are offered for selection:

### Use the controller's Match key

#### Match:

Short press the match key, and immediately press the on/off key (single zone remote) or zone key (multiple zones remote) of the remote.

The LED indicator fast flash a few times means the match is successful.

#### Delete:

Press and hold the match key for 5s to delete all match, The LED indicator fast flash a few times means all matched remotes were deleted.

### Use Power Restart

#### Match:

Switch off the power, then switch on power again, and immediately short press the on/off key (single zone remote) or zone key (multiple zones remote) 3 times on the remote. The light blinks 3 times means the match is successful.

#### Delete:

Switch off the power, then switch on power again, and immediately short press the on/off key (single zone remote) or zone key (multiple zones remote) 5 times on the remote. The light blinks 5 times means all matched remotes were deleted.

## Key function

- RT2 1 zone CCT remote



: Turn on/off the light.



: Touch to change color temperature.



: Adjust brightness, short press 10 levels, long press 1-6s for continuous 256 levels adjustment.



: Get warm white or cold white directly.



: 25%, 50%, 75%, 100% brightness.



: Short press recall the scene, long press 2s save current state into S1/2/3/4. the LED indicator display green when saving OK.

### • RT7 4 zones CCT remote

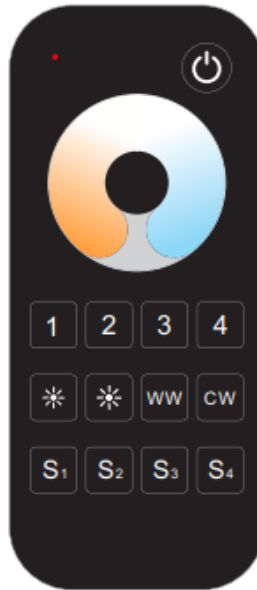

: Short press turn on/off all zone lights.



: Touch to change the current zone color temperature.



: Short press select and turn on zone light, long press 2s turn off zone light. Short press the multiple zone key fastly, will select multiple zones synchronously.



: Adjust the brightness for the currently selected zone, short press 10 levels, and long press 1-6s for continuous 256 levels adjustment.



: Get warm white or cold white directly for the currently selected zone.



: Short press recall the scene, long press 2s save current state into S1/2/3/4. the LED indicator display green when save OK. 4 zone recall or save synchronously.

### Safety information

1. Read all instructions carefully before you begin this installation.
2. When installing the battery, pay attention to the battery's positive and negative polarity. A long time without the

remote control, remove the battery. When remote distance becomes smaller and insensitive, replace the battery.

3. If no response from the receiver, please re-match the remote.
4. Gently handle the remote, beware of falling.
5. For indoor and dry location use only.



## Documents / Resources

	<p><a href="#">SAGE LU MEI RT2 Touch Wheel RF Remote Controller</a> [pdf] Instruction Manual RT2, Touch Wheel RF Remote Controller, RT2 Touch Wheel RF Remote Controller, Wheel RF Remote Controller, RF Remote Controller, Remote Controller, Controller</p>
---	---