



SafeHouse NEO-V2 Smart Gateway User Guide

[Home](#) » [SafeHouse](#) » SafeHouse NEO-V2 Smart Gateway User Guide 

SafeHouse NEO-V2 Smart Gateway User Guide



Contents

- [1 Product Configuration](#)
- [2 Packaging accessories](#)
- [3 Feature & Specifications](#)
- [4 LED State](#)
- [5 Install and Use](#)
- [6 Add Home APP](#)
- [7 Get Started with Tuya App](#)
- [8 Documents / Resources](#)

Product Configuration



Packaging accessories

- Gatewayx 1



- Gateway x 1



- User Manual x 1



Feature & Specifications

Support Zigbee 3.0 protocol to add Zigbee subsystem

App remote control

USB power: 5V/1A

Wireless protocol: Zigbee IEEE 80215.4

Communication Protocol: Zigbee 3.0

Frequency band: 2.4 – 2.485GHz

Standby power: 0.5W

Max. output power: 19d8m

Cable interface: RJ45 10/100M ethernet port

Firmware upgrade: Support OTA

Number of sub-devices that can be added: 128

Working temperature: 0~55°C

Working humidity: 10%~ 80%RH

Storage temperature: -10~60°C

Storage humidity: 10~ 90%RH
Product size: 78mm x 78mm x 25mm

LED State

Device Status	LED State
Standby state	Blue and purple on
The network connection has been configured	Blue is steady on and the purple is off
Add sub-devices	Steady blue and flashing purple
Data transmission	Purple is off and flashing blue
Reset	Long press the reset button for 75

Install and Use

Installation procedure:

1. Open the product package
2. Connect the gateway to the power supply and connect the router through the network cable
3. Add the device after it is started

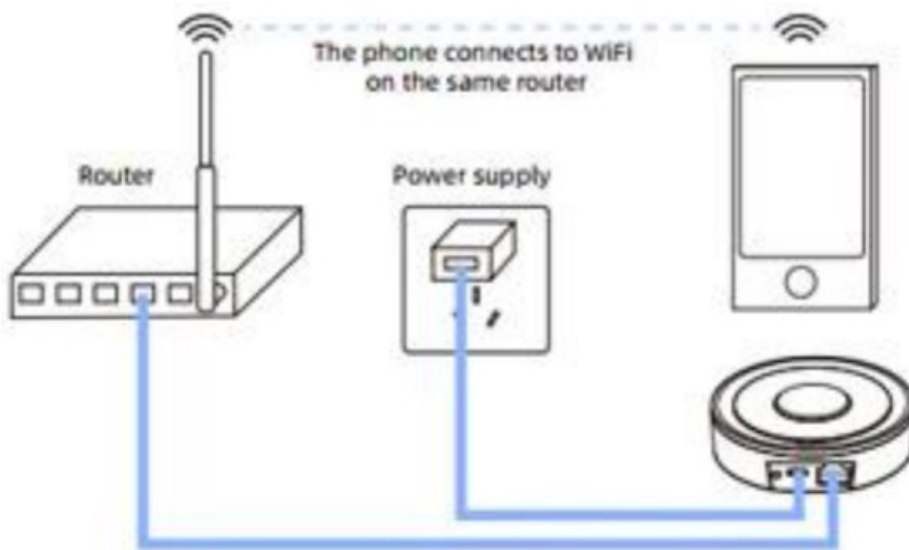

Matters needing attention:

1. The network cable must be connected to the Lan port of the router, and the Wan port cannot be used
2. Ensure that the phone and gateway are on the same LAN during the adding process
3. Smartlife and HomeA@P cannot be used together

Add Home APP

Note:

1. Before use, ensure that the network cable is connected and the gateway is powered on normally

2. When adding a gateway, the phone must be on the same LAN as the gateway
3. Before adding the gateway, make sure that the gateway is in the unconfigured state (blue and purple dual lights are on). In the unconfigured state, long press the reset button for 7 seconds before adding the gateway
4. When the Home hub is not set, Home only supports the use of LAN, and the gateway will not exit the state of network distribution after being added through Home.

Download the App

1. Open "APP Store", search "Homekit" and download the APP
2. After downloading, open the APP and log in with your iCloud account

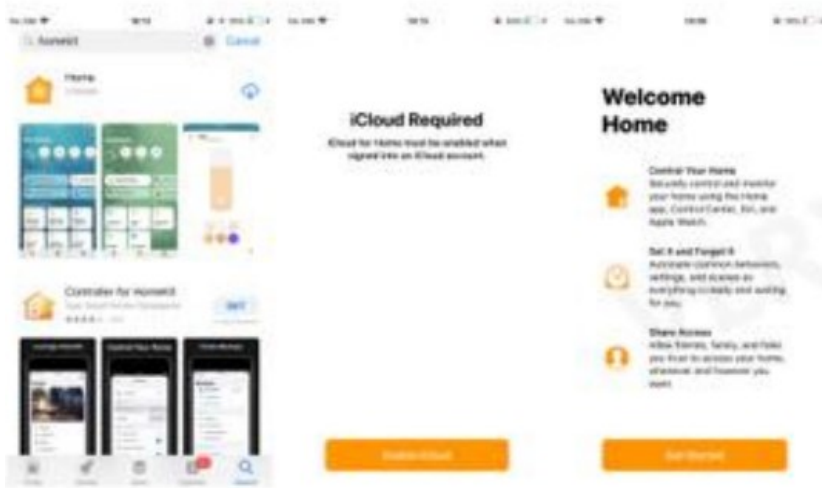

Add Gateway

1. Open Home APP, go to the add page



2. Scan QR code to add; After entering the add interface, scan the QR code at the bottom of the gateway directly.

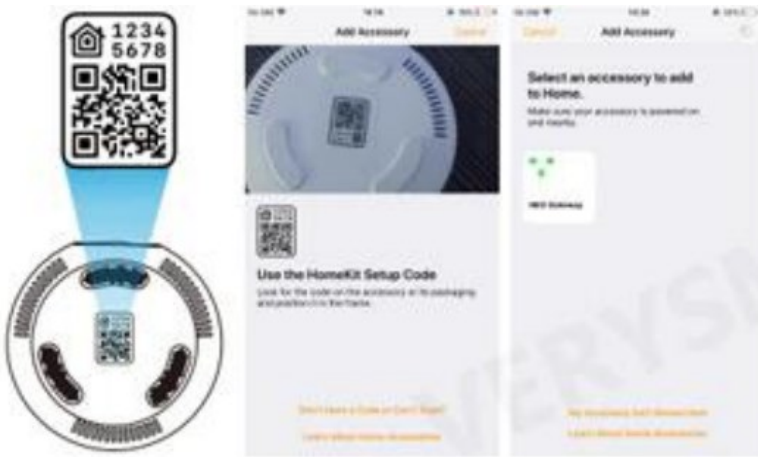

3. Manually enter the ID to add

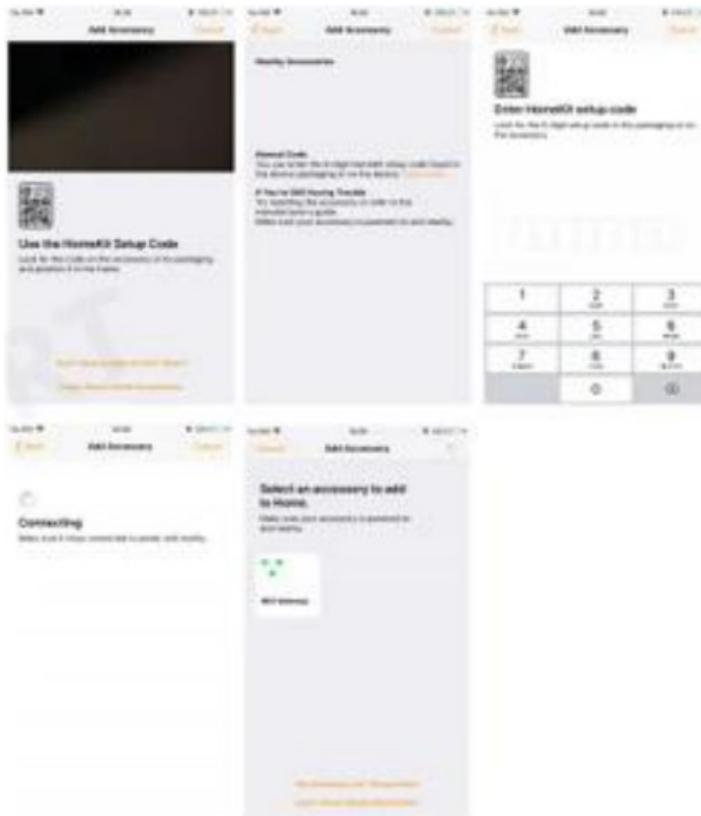

Add and manage sub-devices

Sub-device additions

1. Long press the reset button of sub-device to make the sub-device enter the standby state (the indicator lights on),



2. Short press the gateway reset button to make the gateway enter the sub-device adding state (steady blue, flashing purple).



3. Devices will be automatically added to the gateway. After the addition, the icon of sub-devices will appear in the APP (sub-devices will be in the room of the gateway by default after being added)

Sub-device settings

1. Modify room location: Long press the sub-device icon to enter Settings
2. Enable/disable APP push
3. Delete sub-device: delete sub-device need to go through the TUYA APP, Please refer to the instructions in the TUYA section

Setting up home hub

(The instructions take Apple TV as an example. For details, please refer « « 1o the official website of Apple) «

Note:

1. Make sure that the Apple TV is powered on and connected to the network cable before adding it
2. Ensure that the phone is on the same LAN as the Apple TV
3. The Apple TV login account must be the same as the iPhone login account

Log in account



Connect the Home APP





Set up the room and open home hub



The addition is complete and can be used by the external network



Family share

Note: Need to set up the home hub after the share account can access the external network



Get Started with Tuya App

Download APP

Download the “Smart life” app from APP Store or Google Play to your mobile.



Register and Login

A.Launch the *Smart life” app.

B.To register,enter your mobile phone number or email address create a password then login to the app.

C.Login if you have an account already.

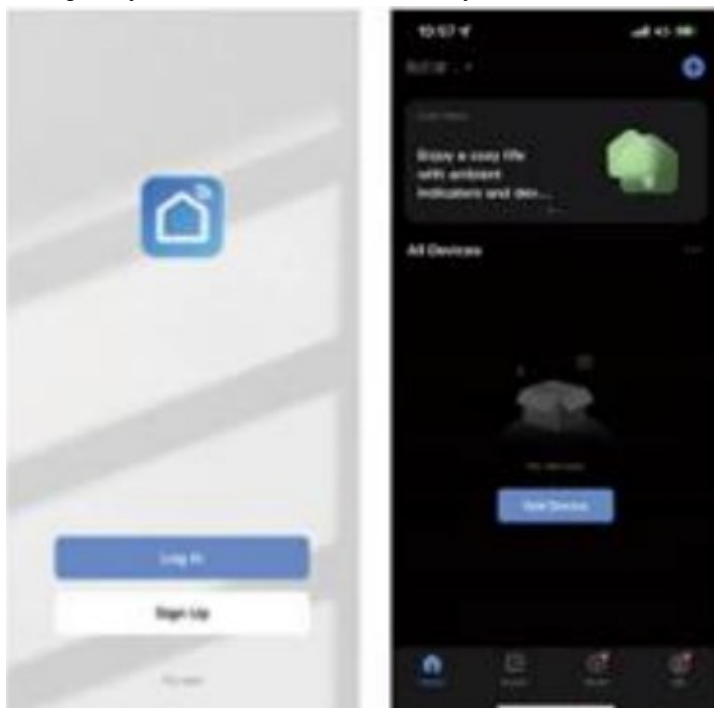

Use of Gateway

1. Add Gateway

Method 1: APP LAN automatically searches and adds devices. When the phone is connected to Wi-Fi, open the APP and add devices, the APP will automatically search gateways in the LAN



Method 2: APP LAN search and add

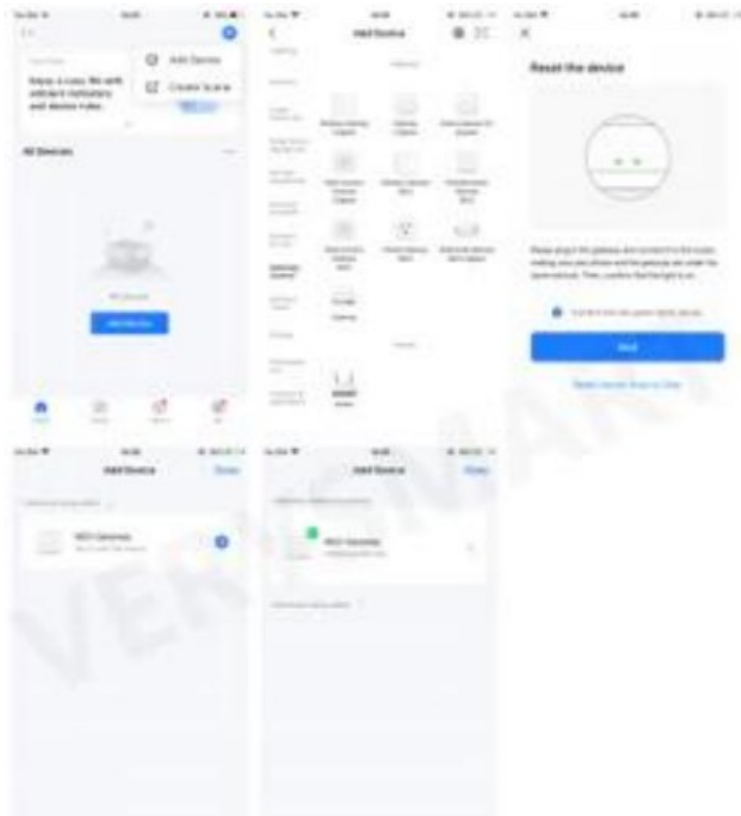

2. Add sub-devices, access the gateway page to add sub-devices

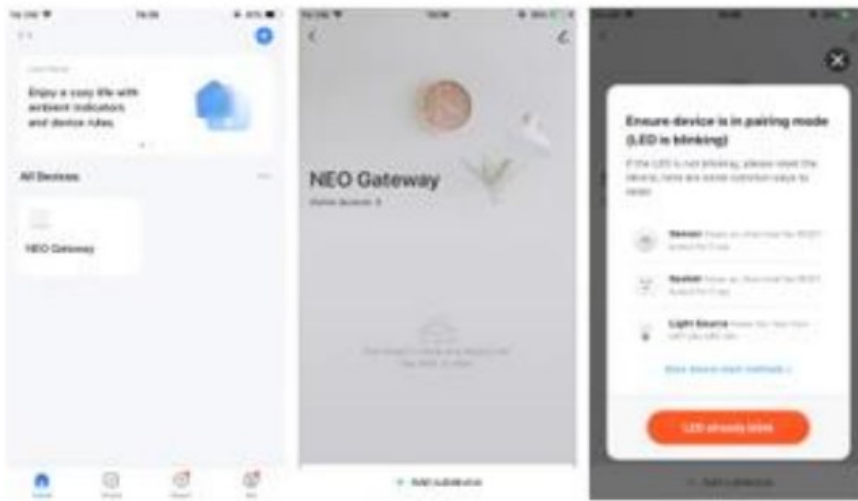

3. Delete sub-devices. Select the sub-device that you want to delete, the sub-device settings page is displayed

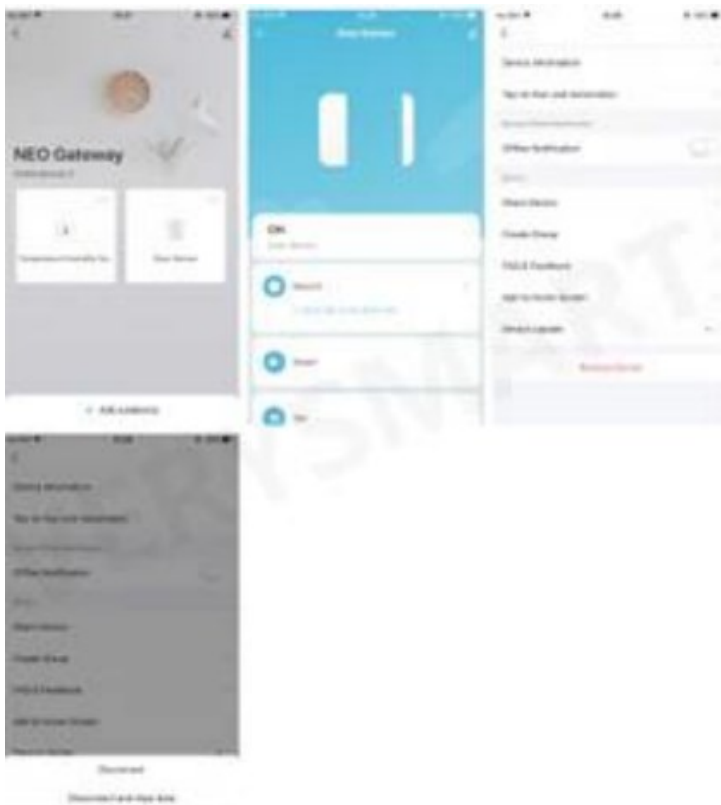

4. Delete the gateway

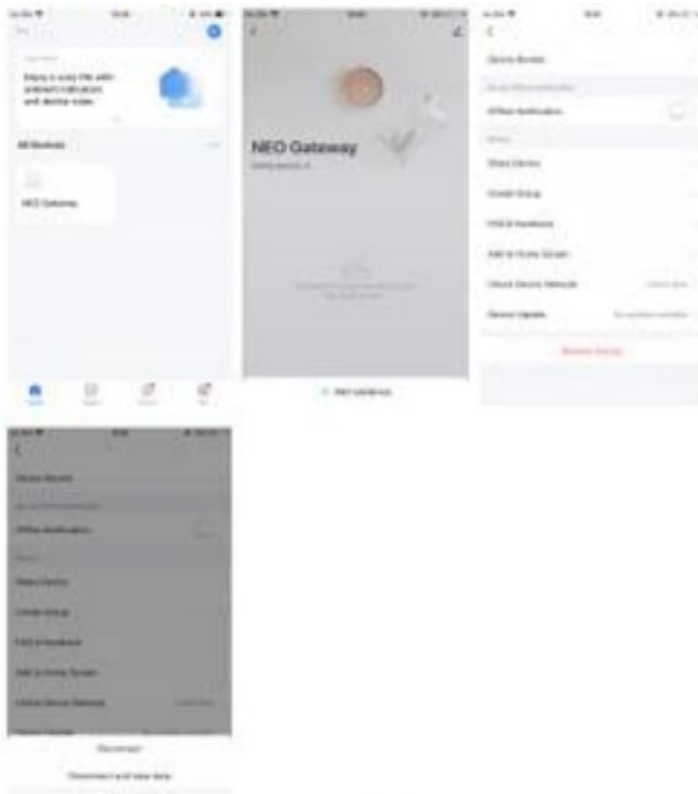

Other functions

Shared device

1. Single device sharing

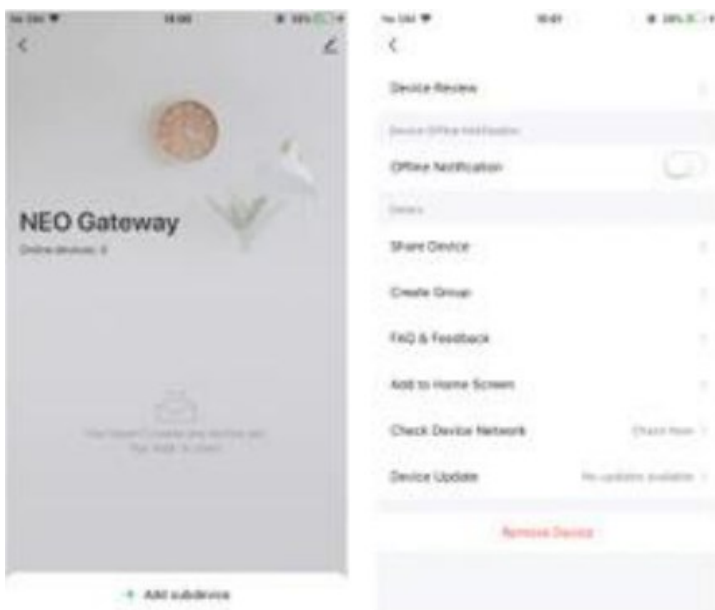

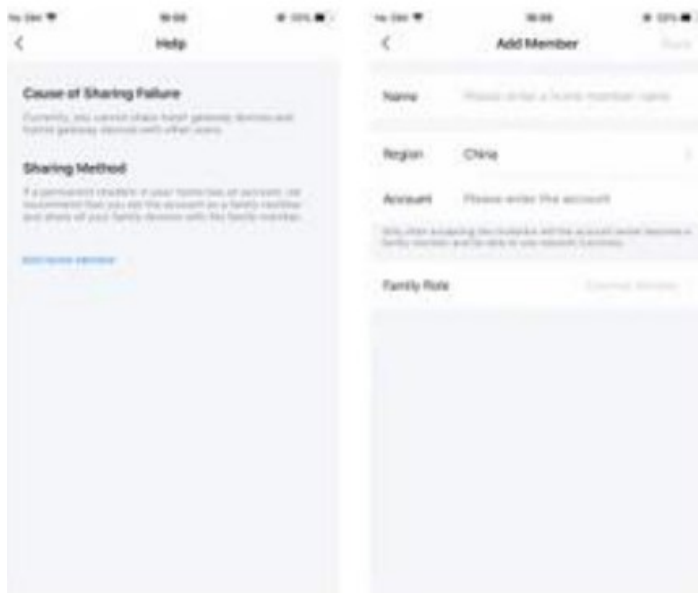

2. Family group sharing

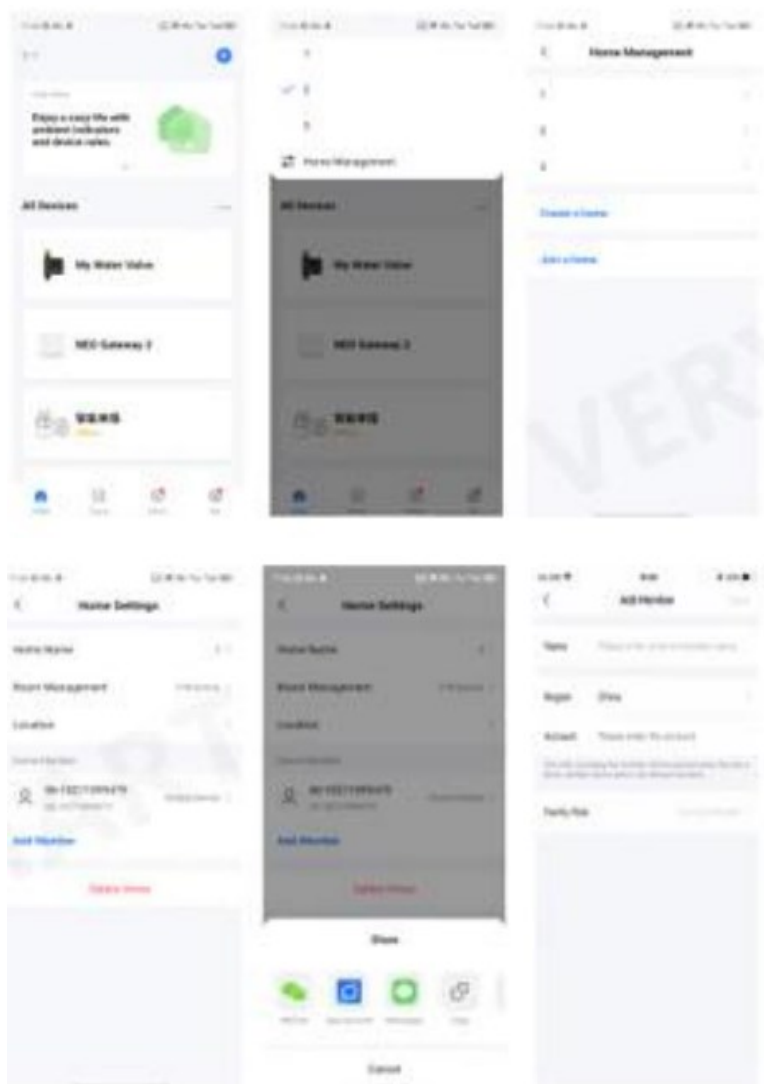

3. Product linkage

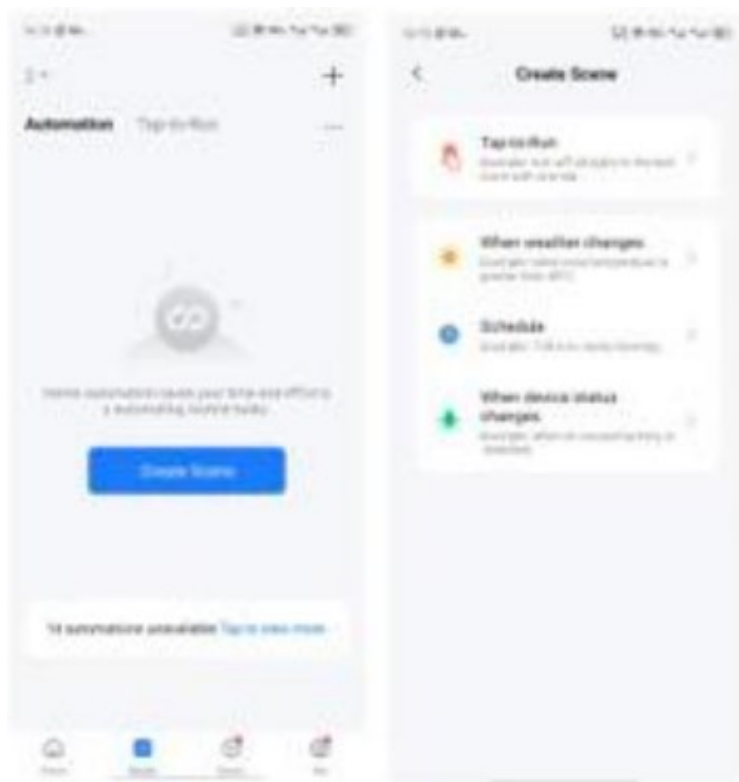

Management of push

All APP push: If push is closed here, all devices in the APP will not receive push, but message recording will not be affected

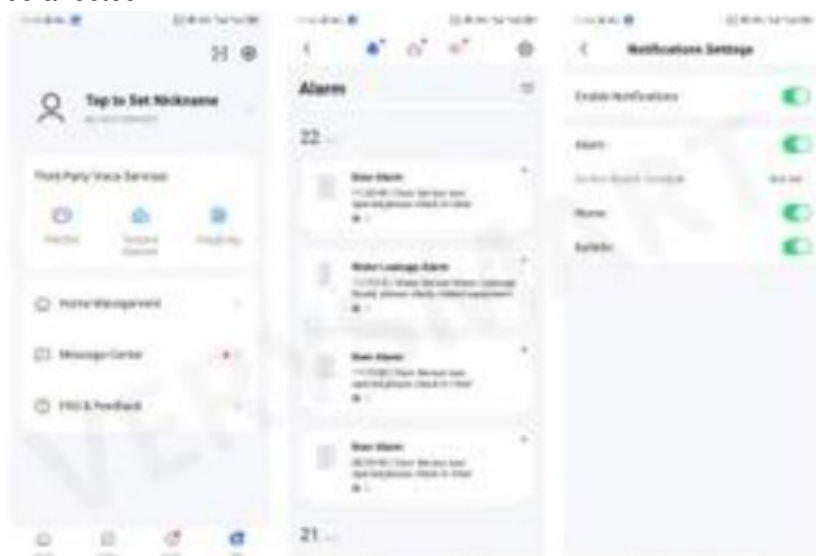

Smart Home Device contains WiFi smart device, 2-Wave device and ZigBee device, give you more choices to create 3 new smart Ufe. Wide application on the living room, kitchen, bedroom, bathroom, garage, garden, yard or basement of your home, office, warehouse, chain store... Make life smarter and more convenient.



Use of the Works with Apple badge means that an accessory has been designed to work specifically with the technology identified in the badge and has been certified by the developer to meet Apple performance standards. Apple is not responsible for the operation of this device or its compliance with safety and regulatory standards.



Web: gsmohrana.com.ua

Documents / Resources

	<p>SafeHouse NEO-V2 Smart Gateway [pdf] User Guide NEO-V2 Smart Gateway, NEO-V2, Smart Gateway, Gateway</p>
---	---

[Manuals+.](#)