



# SAFE VIEW SV50API Smart RV Power Inlet Installation Guide

[Home](#) » [SAFE VIEW](#) » SAFE VIEW SV50API Smart RV Power Inlet Installation Guide 

## SAFE VIEW SV50API Smart RV Power Inlet Installation Guide

**SAFE VIEW**  
POWER INLET  
SV50API

**\*\*\*PRIOR TO INSTALLATION-if you are unsure, consult a professional electrician! Make sure your RV is disconnected from any power source. Ture your RV's main breaker OFF.\*\*\***

For questions, comments or concerns please call 888-540-1504 or email at [www.hughesautoformers.com](http://www.hughesautoformers.com)

### Contents

- 1 CONSUMER INSTALLATION GUIDE
- 2 RV MANUFACTURER INSTALLATION GUIDE
- 3 Tools Needed
- 4 Documents / Resources
- 4.1 References

## CONSUMER INSTALLATION GUIDE

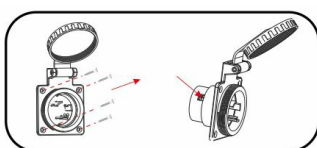

Turn off Rv's main breaker. Use a screwdriver to loosen and remove the four screws and pull out the old inlet out of the RV. Loosen screws and disconnect the old inlet to any wires.

\*TOOLS:

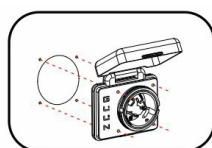

Test your new inlet for proper fit and hole alignment. Mark and drill new holes if needed

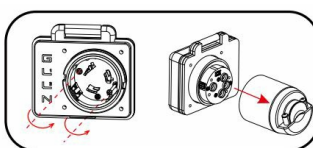

Loosen the screw , then remove the rear housing.

\*TOOLS:

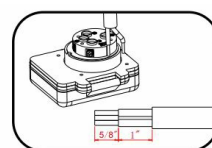

Please strip the wires as shown; strip off 1 5/8" of the outer insulation layer of the cable, and only 5/8" of the colored insulation of the conductor cables. Make sure the wire condition is good, full strands and shiny copper.

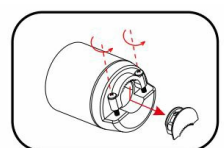

Loosen the screws and remove the cable bushing, this may be needed later.

\*TOOLS:



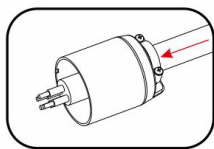

Insert the cable through the back of the rear housing.

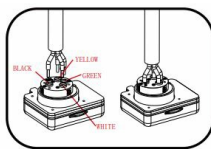

Connect the wires according to the matching color. W/white = neutral, G/green = ground, Y/Red = line 1, X/black = line 2.  
**Tighten the screws to 45-50 In/Lb. Do not over tighten.**

\*TOOLS:



Install the rear housing and tighten the screws.  
**(4.5-5.5 In/Lb).**

\*TOOLS:

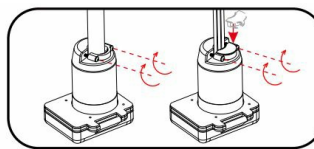

Tighten the screws on the strain relief clamp until they are snug around the cable. You may need to use the optional bushing to have a proper snug fit. **(4.5-5.5 In/Lb).**

\*TOOLS:

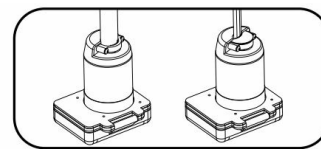

Make sure the wiring is tight and secured.



Reposition your new SafeView Power Inlet over the hole and align the screw holes. Secure the power inlet to the RV with the four screws. **(4.5-5.5 In/Lb).**

\*TOOLS:



Verify proper installation. Make sure it is tight and secure.



Press down the cover.

## RV MANUFACTURER INSTALLATION GUIDE

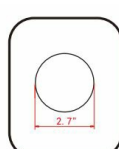
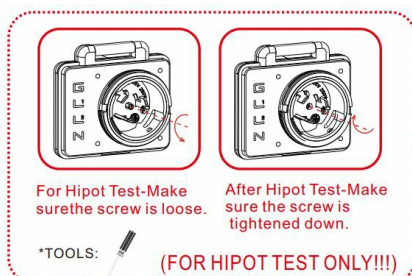

Make a hole of 2.7" diameter in the place where the INLET is to be installed

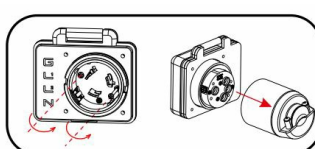

Loosen the screw, then remove the rear housing.

\*TOOLS:

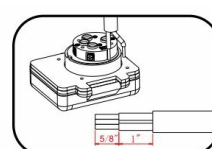

Please strip the wires as shown; strip off 1 5/8" of the outer insulation layer of the cable, and only 5/8" of the colored insulation of the conductor cables. Make sure the wire condition is good, full strands and shiny copper.

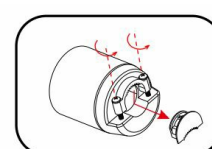

Loosen the screws and remove the cable bushing, this may be needed later.

\*TOOLS:

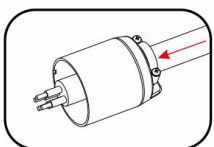

Insert the cable through the back of the rear housing.

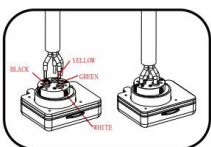

Connect the wires according to the matching color. W/white = neutral, G/green = ground, Y/Red = line 1, X/black = line 2.  
**Tighten the screws to 45-50 In/Lb. Do not over tighten.**

\*TOOLS:

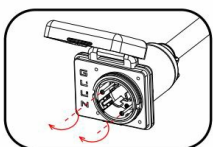

Install the rear housing and tighten the screws.  
**(4.5-5.5 In/Lb).**

\*TOOLS:

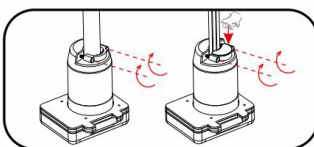

Tighten the screws on the strain relief clamp until they are snug around the cable. You may need to use the optional bushing to have a proper snug fit. **(4.5-5.5 In/Lb).**

\*TOOLS:

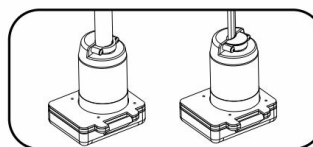

Make sure the wiring is tight and secured.

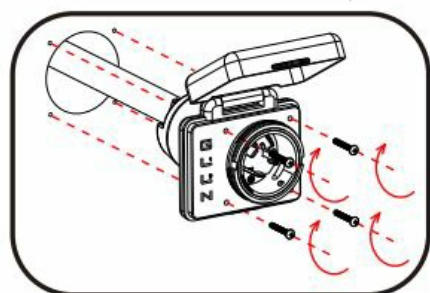

Reposition your new SafeView Power Inlet over the hole and align the screw holes. Secure the power inlet to the RV with the four screws. **(4.5-5.5 In/Lb).**

\*TOOLS:

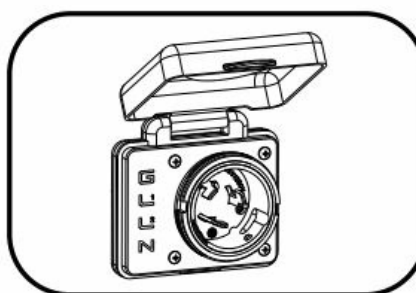

Verify proper installation. Make sure it is tight and secure.

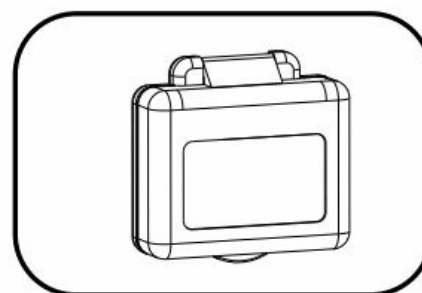

Press down the cover.

## Tools Needed

- Phillips Screwdriver
- Ruler/Measuring Tape
- Utility Knife
- Wire Cutters



---

## Documents / Resources

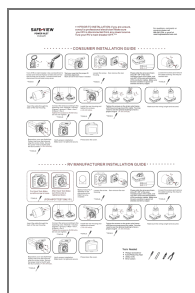

[SAFE VIEW SV50API Smart RV Power Inlet](#) [pdf] Installation Guide  
SV50API Smart RV Power Inlet, SV50API, Smart RV Power Inlet, RV Power Inlet, Power Inlet, Inlet

## References

- [User Manual](#)