



## SAFE VIEW SV30API Smart RV Power Inlet Installation Guide

[Home](#) » [SAFE VIEW](#) » SAFE VIEW SV30API Smart RV Power Inlet Installation Guide 

SAFE VIEW SV30API Smart RV Power Inlet Installation Guide



## Contents

- 1 CONSUMER
- 2 RV Manufacturer
- 3 Tools Needed
- 4 Documents / Resources
  - 4.1 References

## CONSUMER

Turn off Rv's main breaker. Use a screwdriver to loosen and remove the four screws and pull out the old inlet out of the RV. Loosen screws and disconnect the old inlet to any wires.

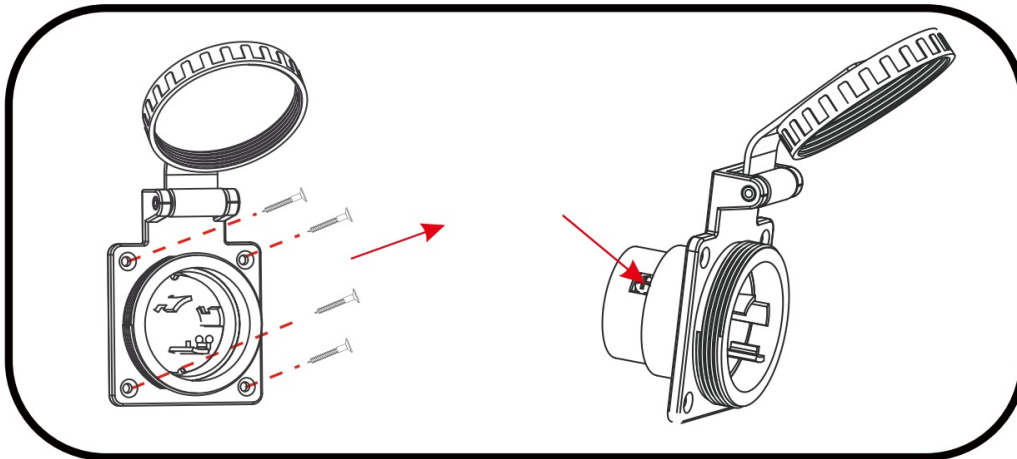

Test Your New Inlet for Proper Fit and hole alignment. Mark and drill new holes if needed

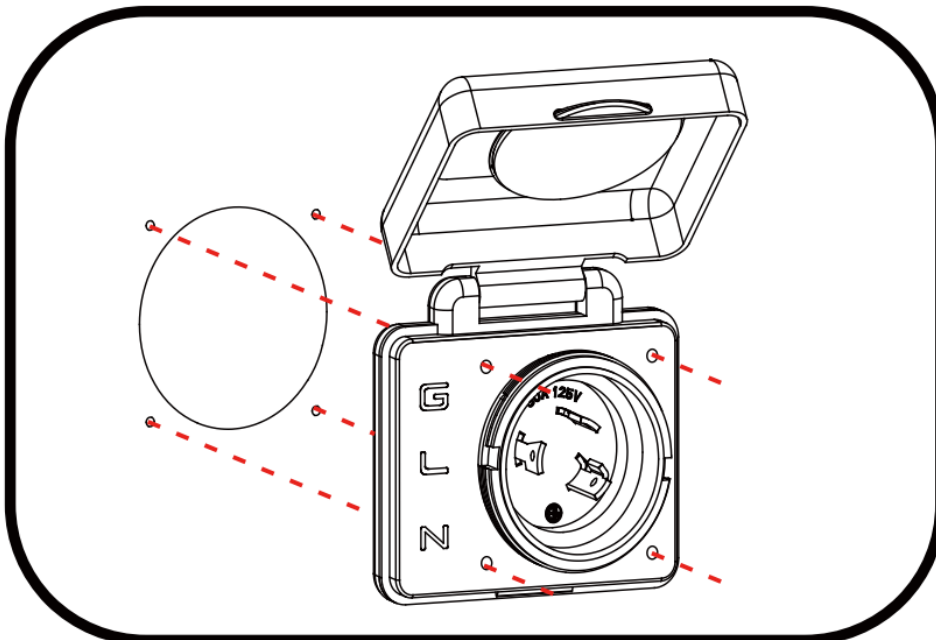

On the SafeView Power Inlet, loosen the screw on the rear housing. Rotate the rear housing counter clockwise and remove it.

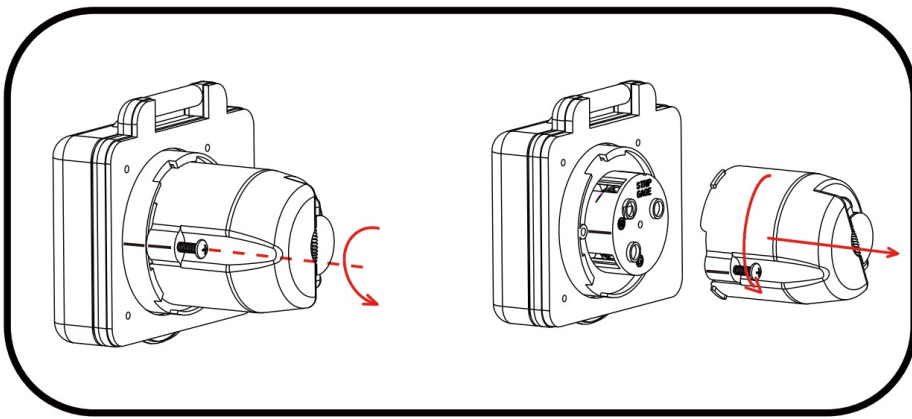

Please strip the wires as shown; strip off 1 5/8" of the outer insulation layer of the cable, and only 5/8" of the colored insulation of the conductor cables. Make sure the wire condition is good, full strands and shiny copper.

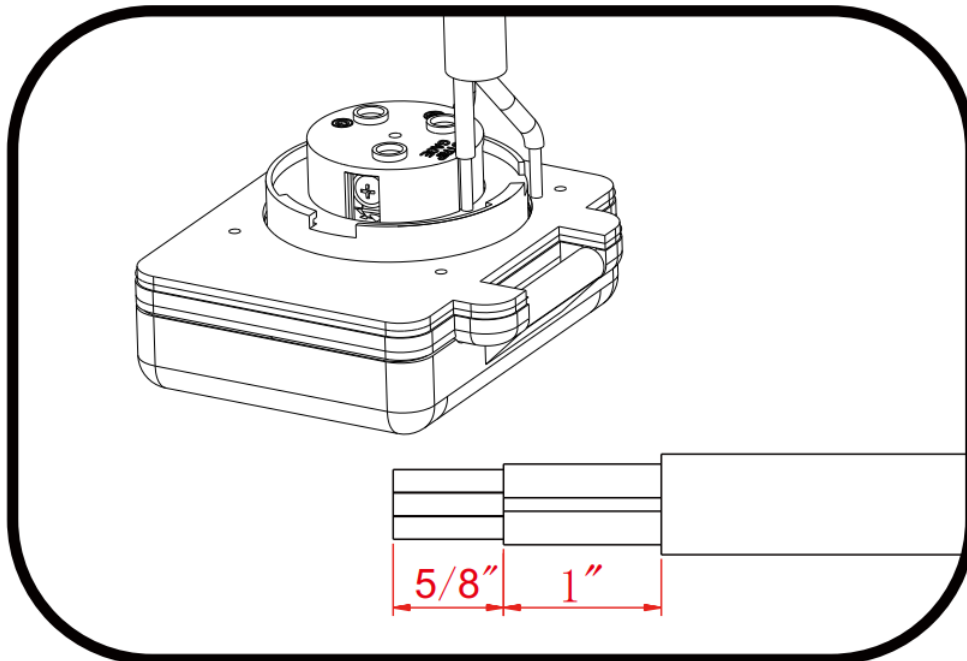

Loosen the screws and remove the cable bushing, this may be needed later.

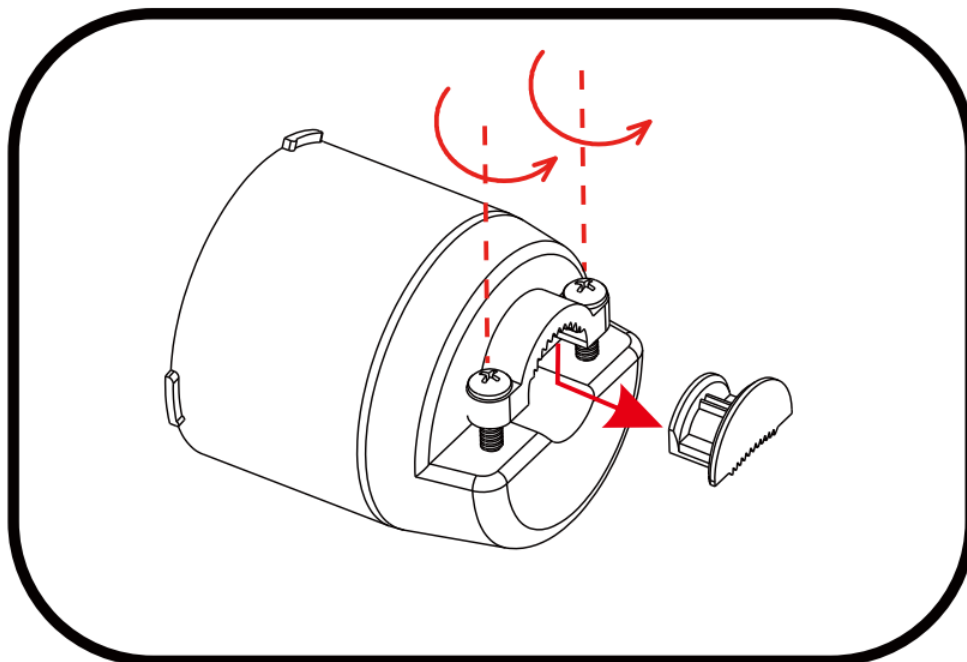

Insert the cable through the back of the rear housing

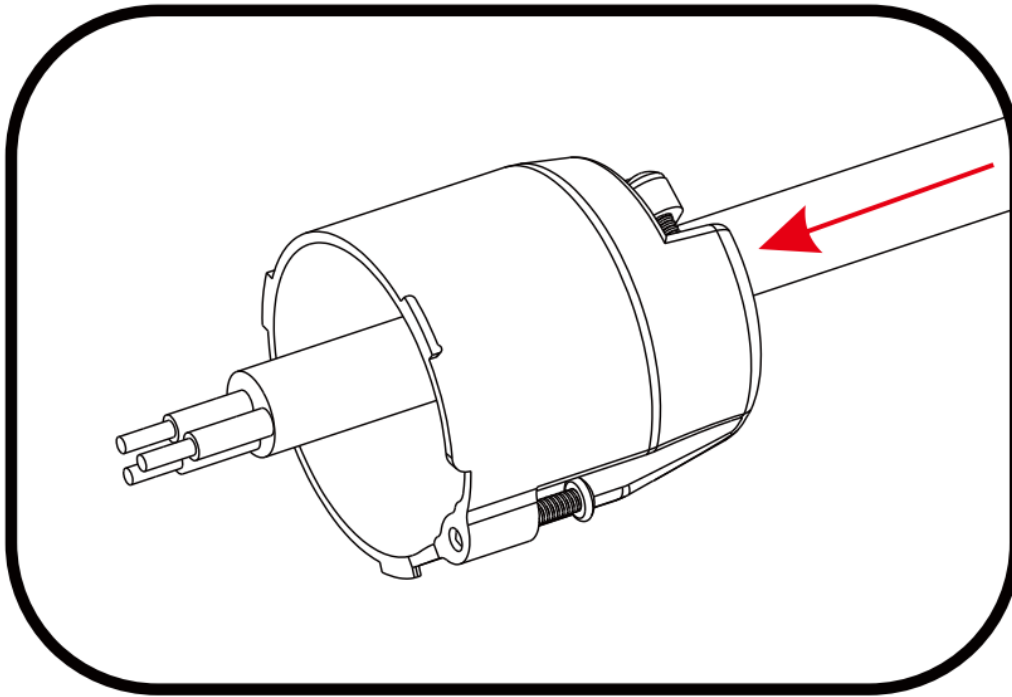

Connect the wires according to the matching color. W/white = neutral, G/green = ground, Y/Red = line Tighten the screws to 30-35 In/Lb. Do not over tighten.

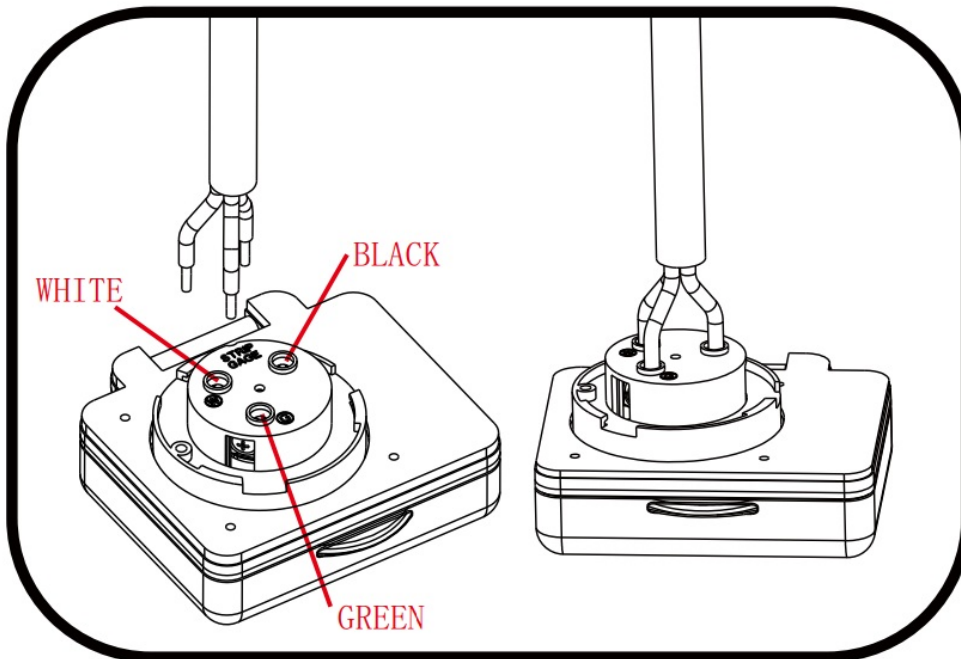

Install the rear housing and tighten the screw.( 3.0-3.9 In/Lb).

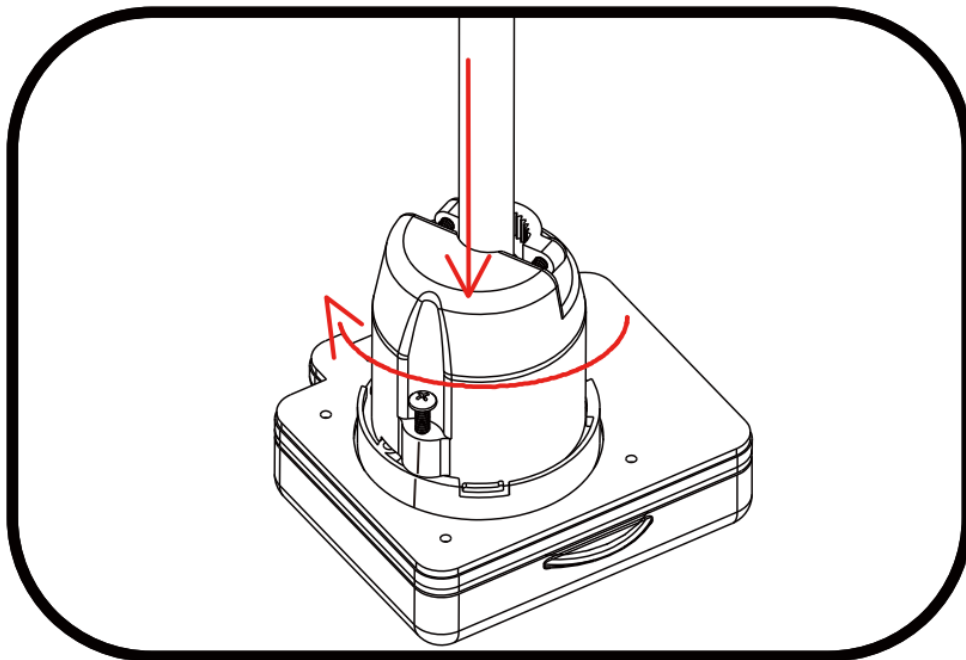

Tighten the screws on the strain relief clamp until they are snug around the cable. You may need to use the optional bushing to have a proper snug fit. (4.5-5.5 In/Lb).

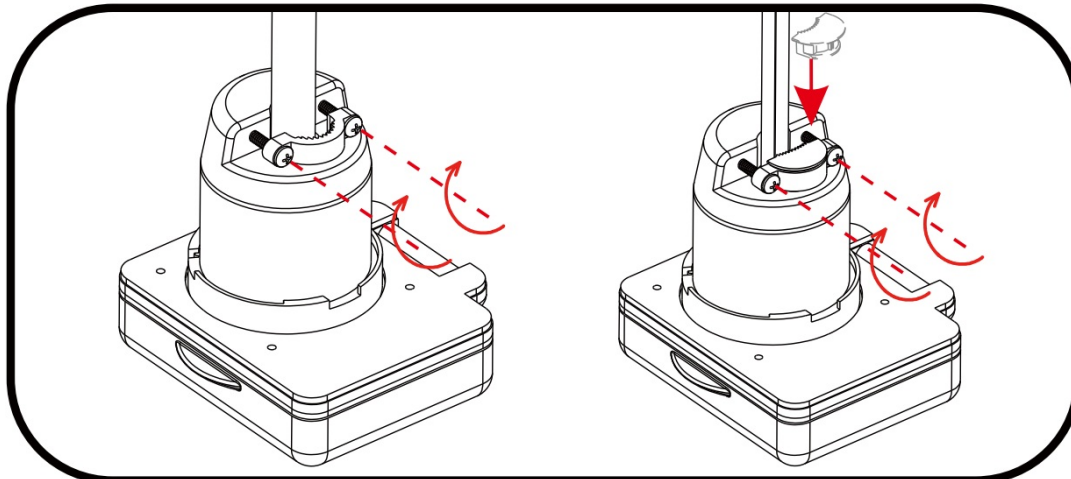

Make sure the wiring is tight and secured.

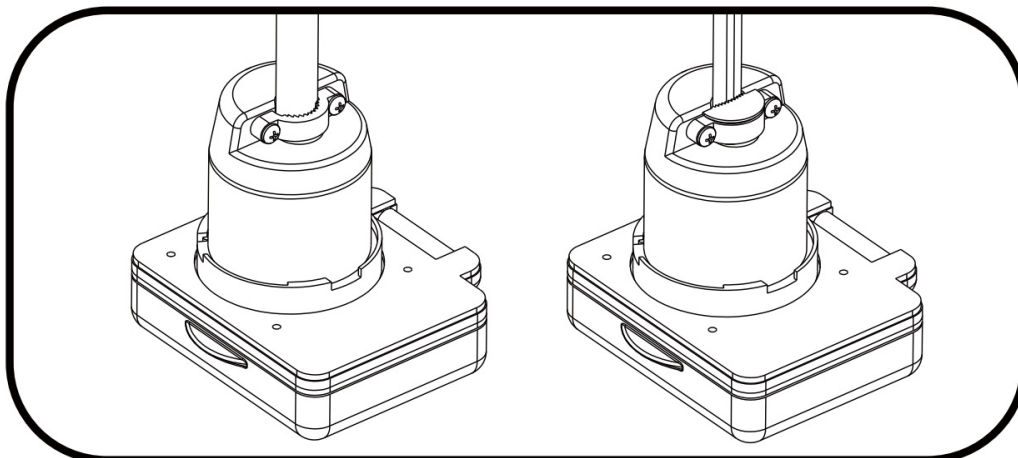

Reposition your new SafeView Power Inlet over the hole and align the screw holes. Secure the power inlet to the RV with the four screws ( 4.5-5.5 In/Lb).

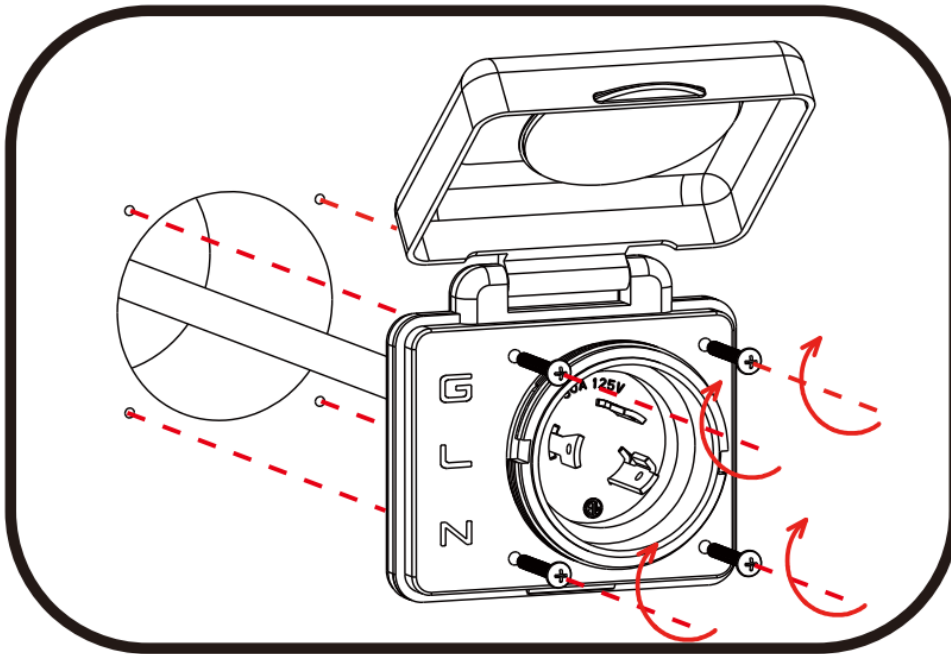

Verify proper installation. Make sure it is tight and secure.

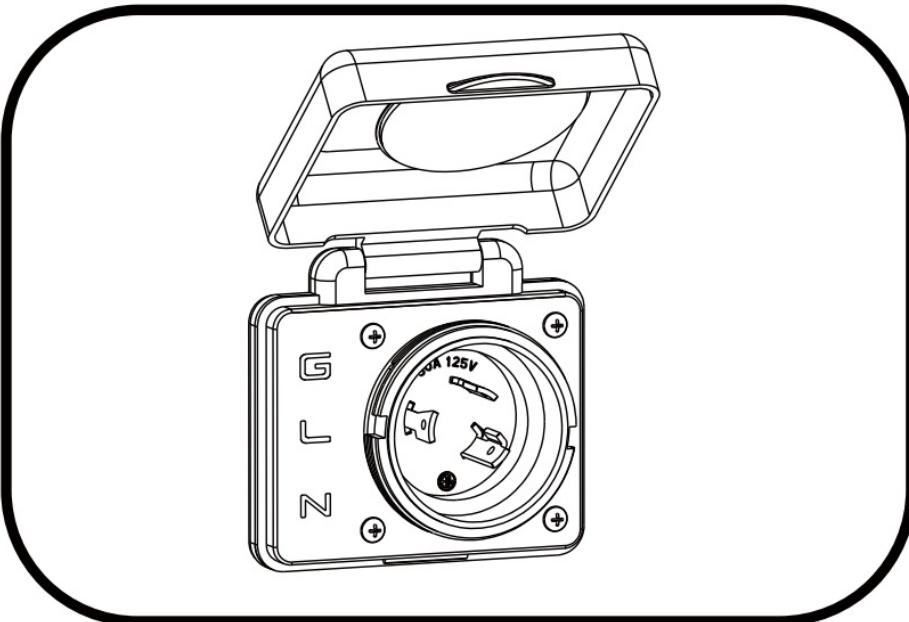

Press down the cover

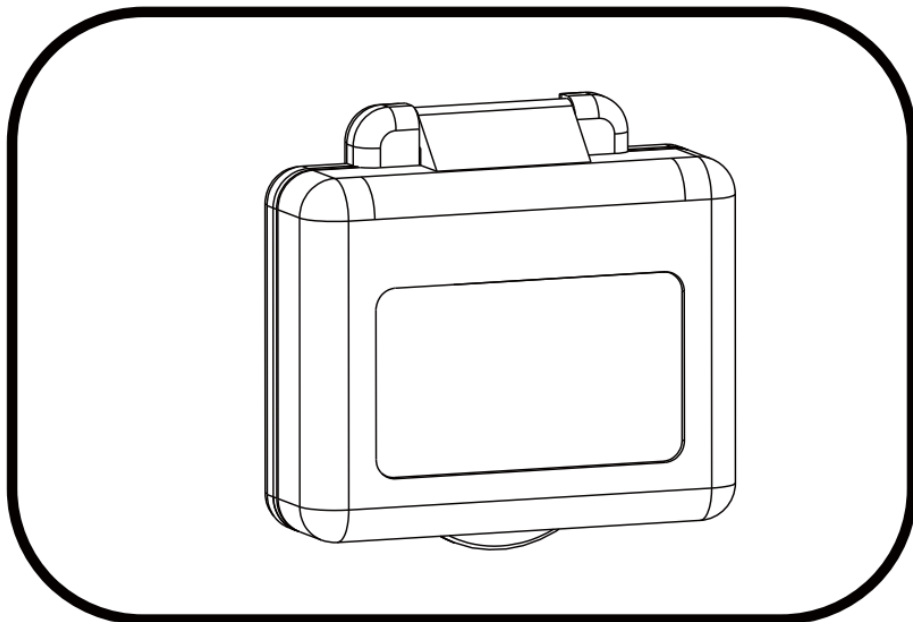

## RV Manufacturer

For Hipot Test-Make sure the screw is loose.

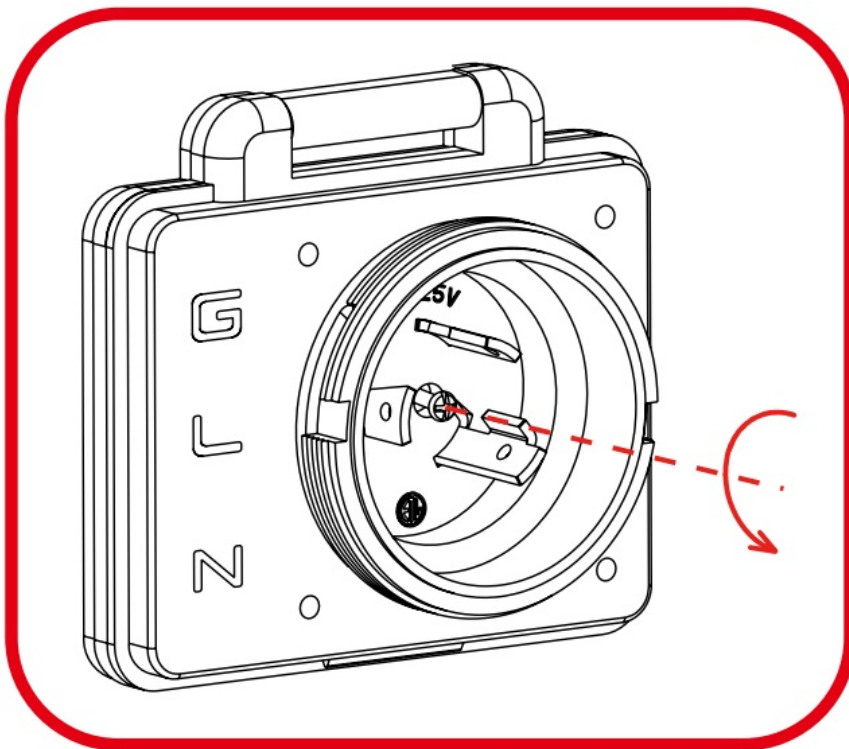

After Hipot Test-Make sure the screw is tightened down



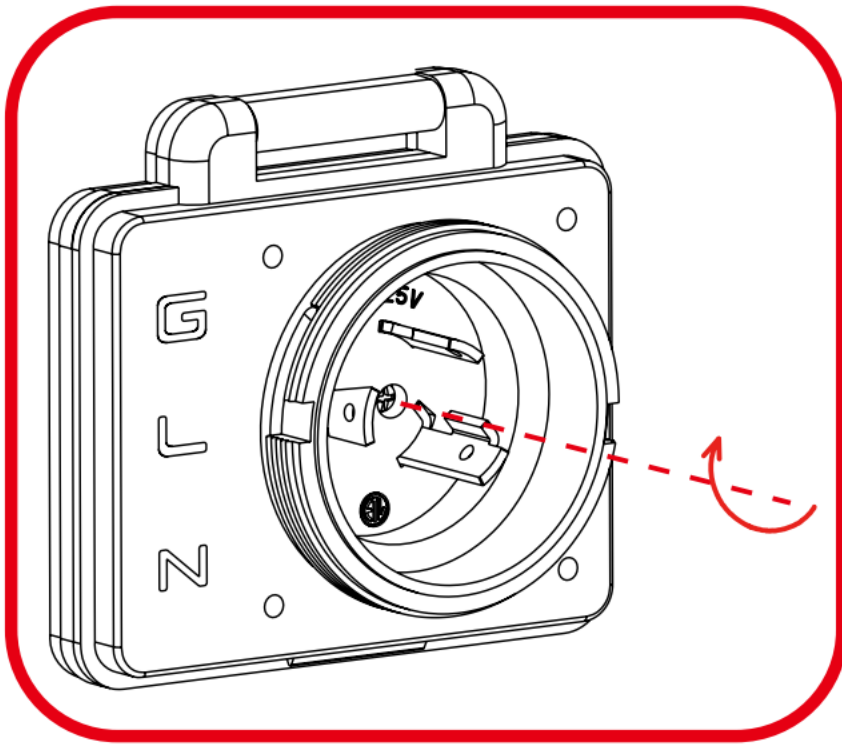

Make a hole of 2.7" diameter in the place where the INLET is to be installed

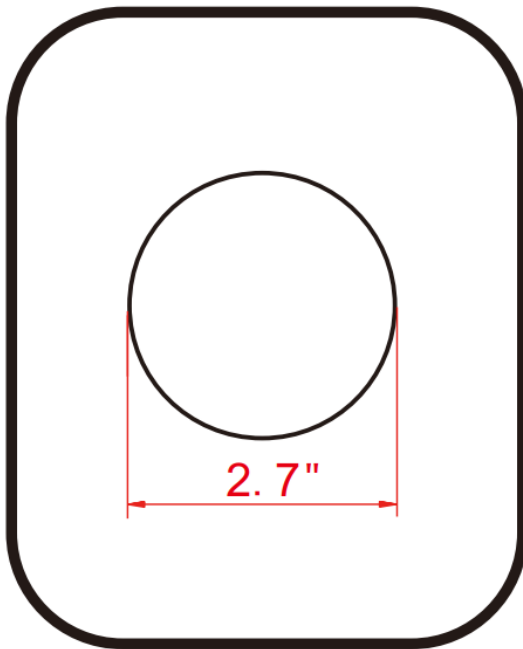

On the SafeView Power Inlet, loosen the screw on the rear housing. Rotate the rear housing counter clockwise and remove it.

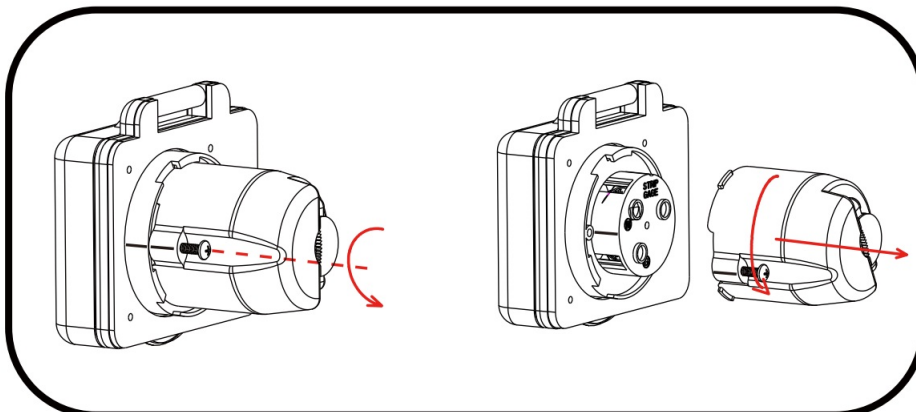



Please strip the wires as shown; strip off 1 5/8" of the outer insulation layer of the cable, and only 5/8" of the colored insulation of the conductor cables. Make sure the wire condition is good, full strands and shiny copper.

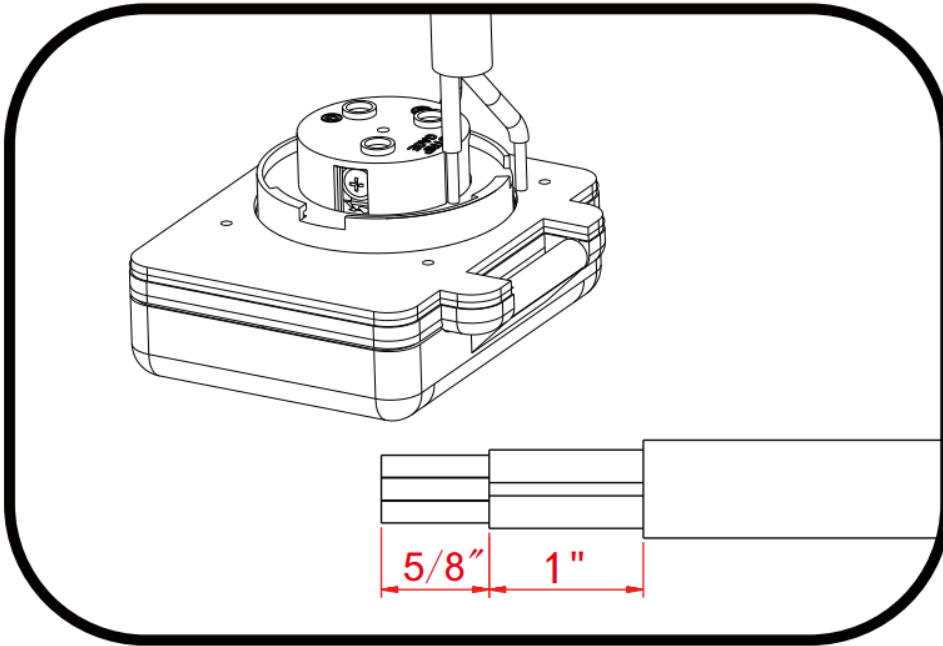

Loosen the screws and remove the cable bushing, this may be needed later.

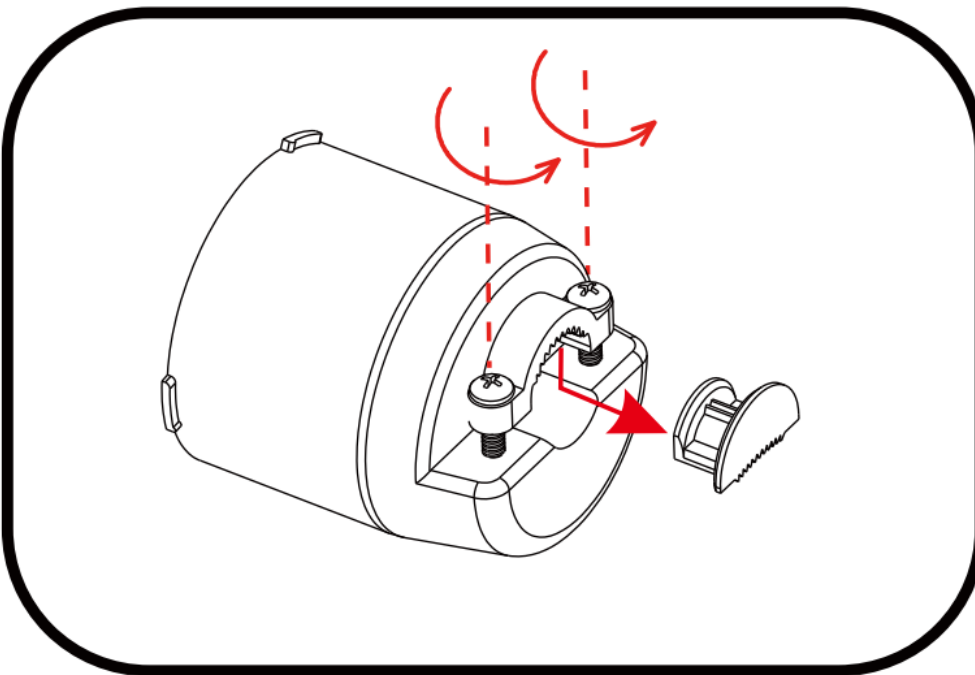

Insert the cable through the back of the rear housing

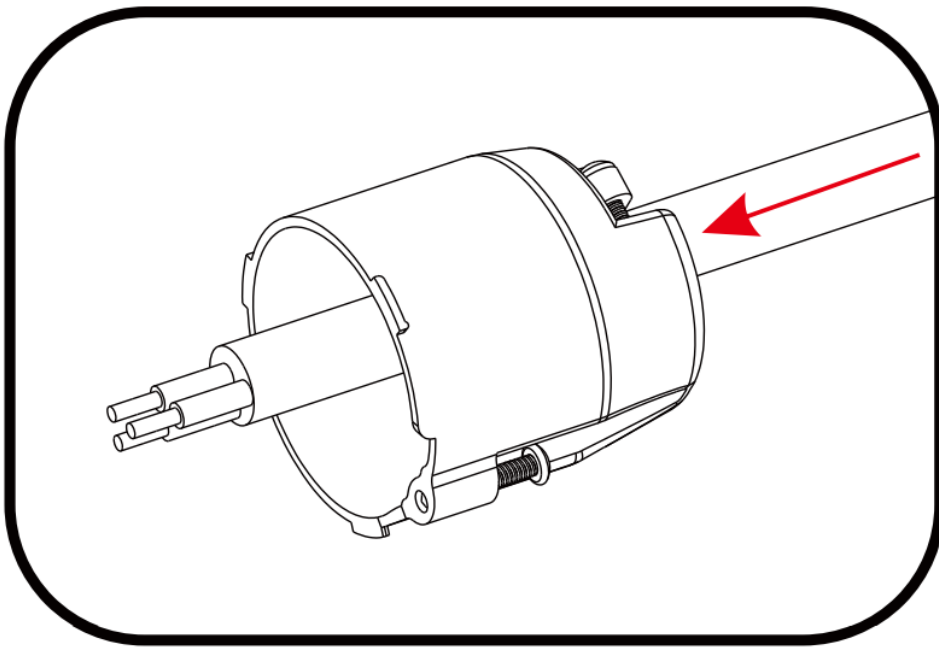

Connect the wires according to the matching color. W/white = neutral, G/green = ground, Y/Red = line Tighten the screws to 30-35 In/Lb. Do not over tighten.

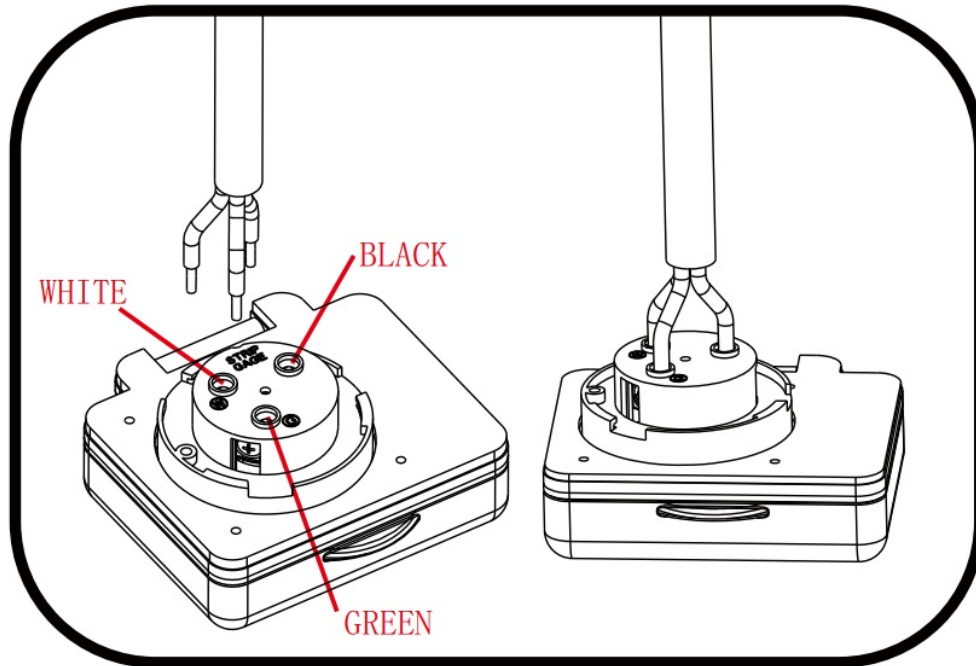

Install the rear housing and tighten the screw. ( 3.0-3.9 In/Lb).

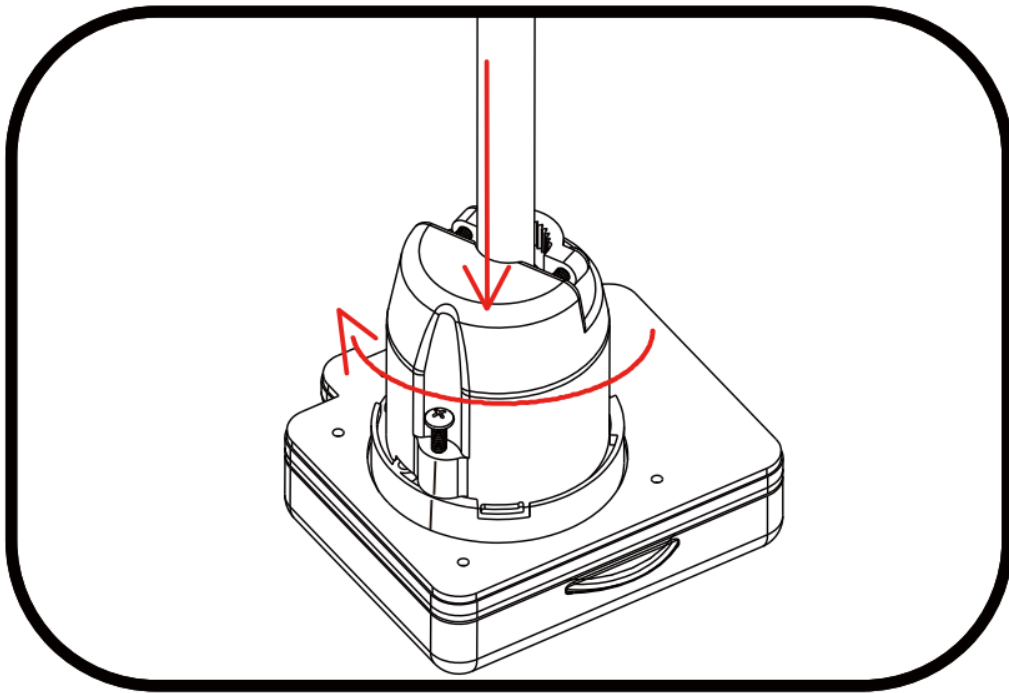

Tighten the screws on the strain relief clamp until they are snug around the cable. You may need to use the optional bushing to have a proper snug fit. (4.5-5.5 In/Lb).

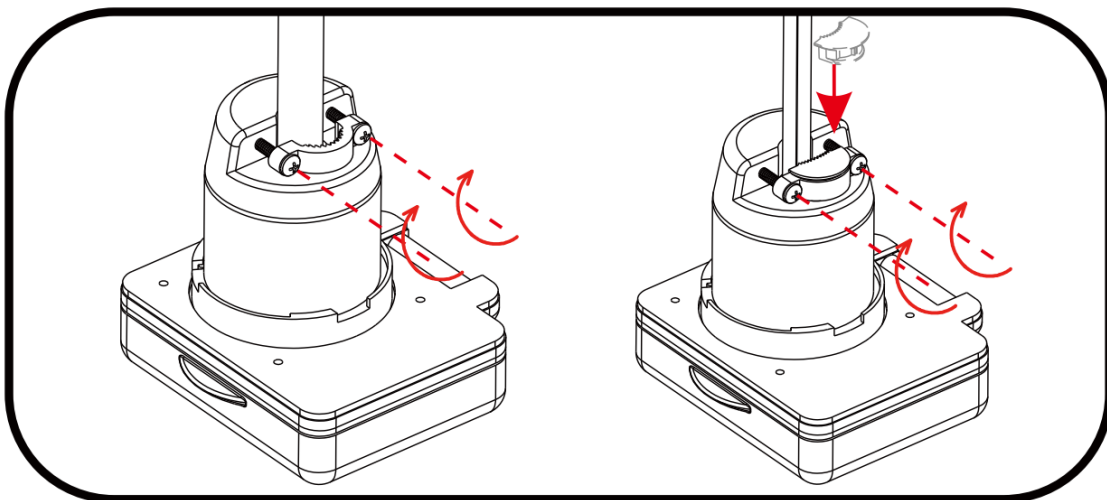

Make sure the wiring is tight and secured.

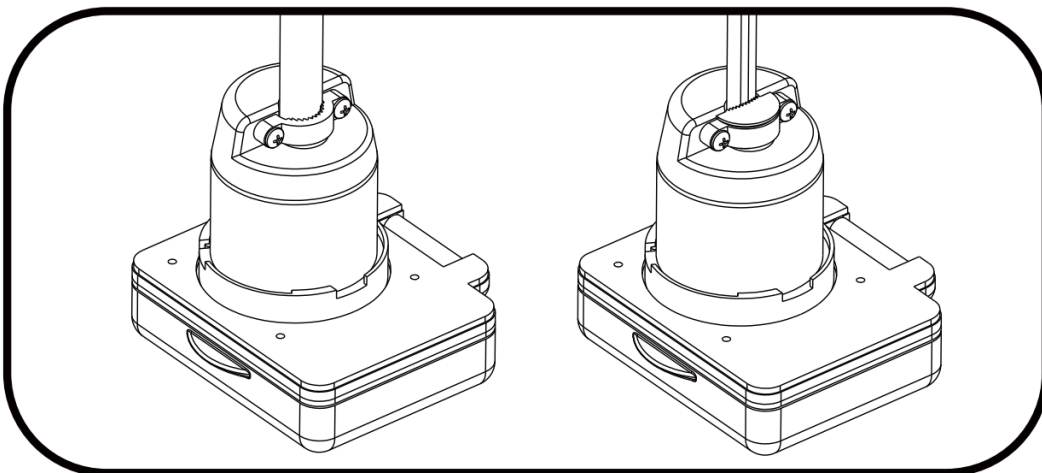

Reposition your new SafeView Power Inlet over the hole and align the screw holes. Secure the power inlet to the RV with the four screws ( 4.5-5.5 In/Lb).

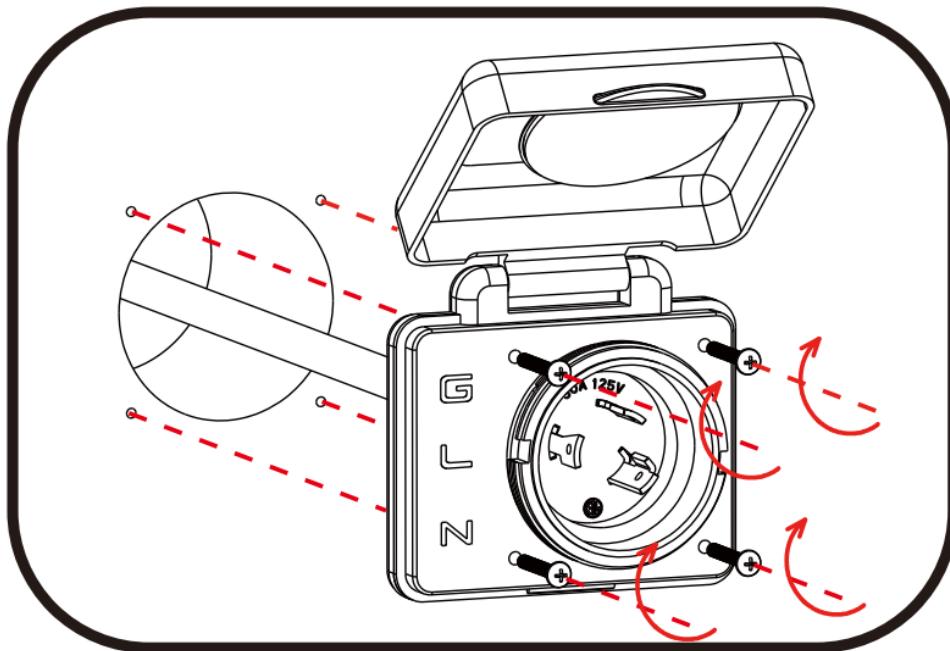

Verify proper installation. Make sure it is tight and secure.

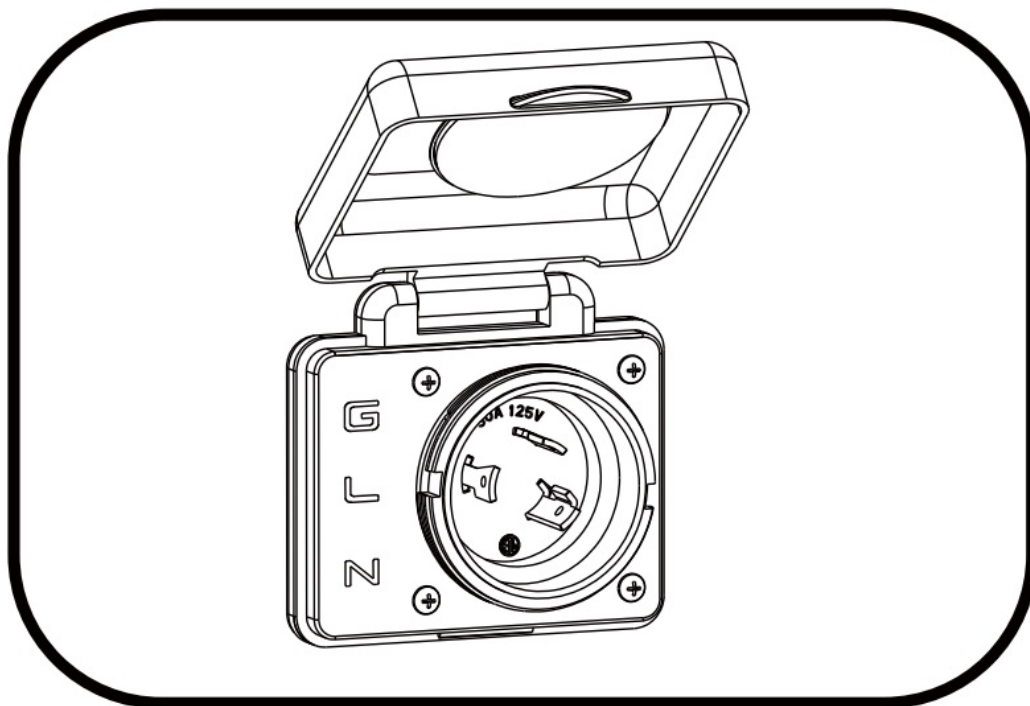

Press down the cover

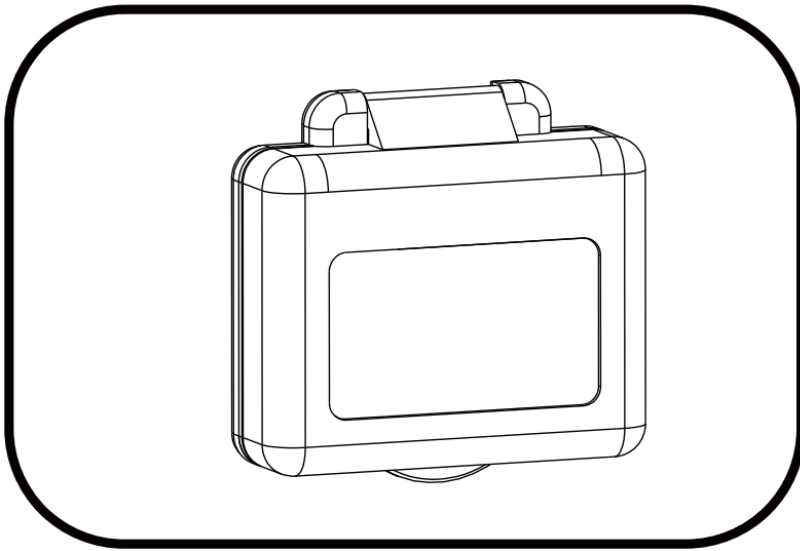

## Tools Needed

- Phillips Screwdriver

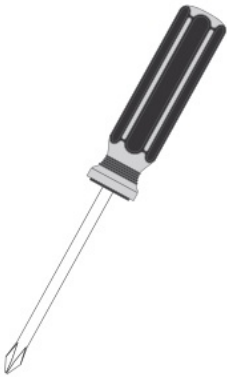

- Ruler/Measuring Tape

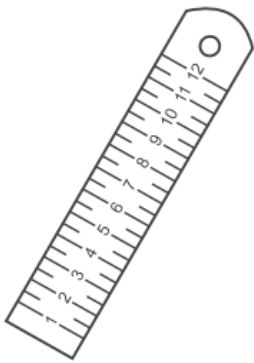

- Utility Knife



- Wire Cutters



---

## Documents / Resources

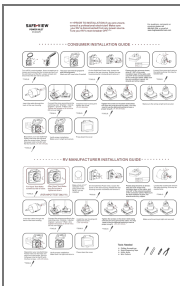

[SAFE VIEW SV30API Smart RV Power Inlet](#) [pdf] Installation Guide  
SV30API Smart RV Power Inlet, SV30API, Smart RV Power Inlet, RV Power Inlet, Power Inlet, Inlet

## References

- [User Manual](#)

### Manuals+, Privacy Policy

This website is an independent publication and is neither affiliated with nor endorsed by any of the trademark owners. The "Bluetooth®" word mark and logos are registered trademarks owned by Bluetooth SIG, Inc. The "Wi-Fi®" word mark and logos are registered trademarks owned by the Wi-Fi Alliance. Any use of these marks on this website does not imply any affiliation with or endorsement.