

saeyang

saeyang LEVENT
Dust Collector
with HEPA Filter



saeyang LEVENT Dust Collector with HEPA Filter Instruction Manual

[Home](#) » [saeyang](#) » saeyang LEVENT Dust Collector with HEPA Filter Instruction Manual 

Contents

- [1 saeyang LEVENT Dust Collector with HEPA Filter](#)
- [2 Part introduction & part names](#)
- [3 Installation & Operation](#)
- [4 How to replace the filter](#)
- [5 How to clean the filter](#)
- [6 Specification](#)
- [7 Warranty](#)
- [8 Documents / Resources](#)
 - [8.1 References](#)

saeyang

saeyang LEVENT Dust Collector with HEPA Filter



* Please be sure to read this manual before operation.

Precaution

Install the unit at your workplace and do not use in a dirty or very hot and humid environment. (-20°C- 40°C, 0-90% RH)

Part introduction & part names

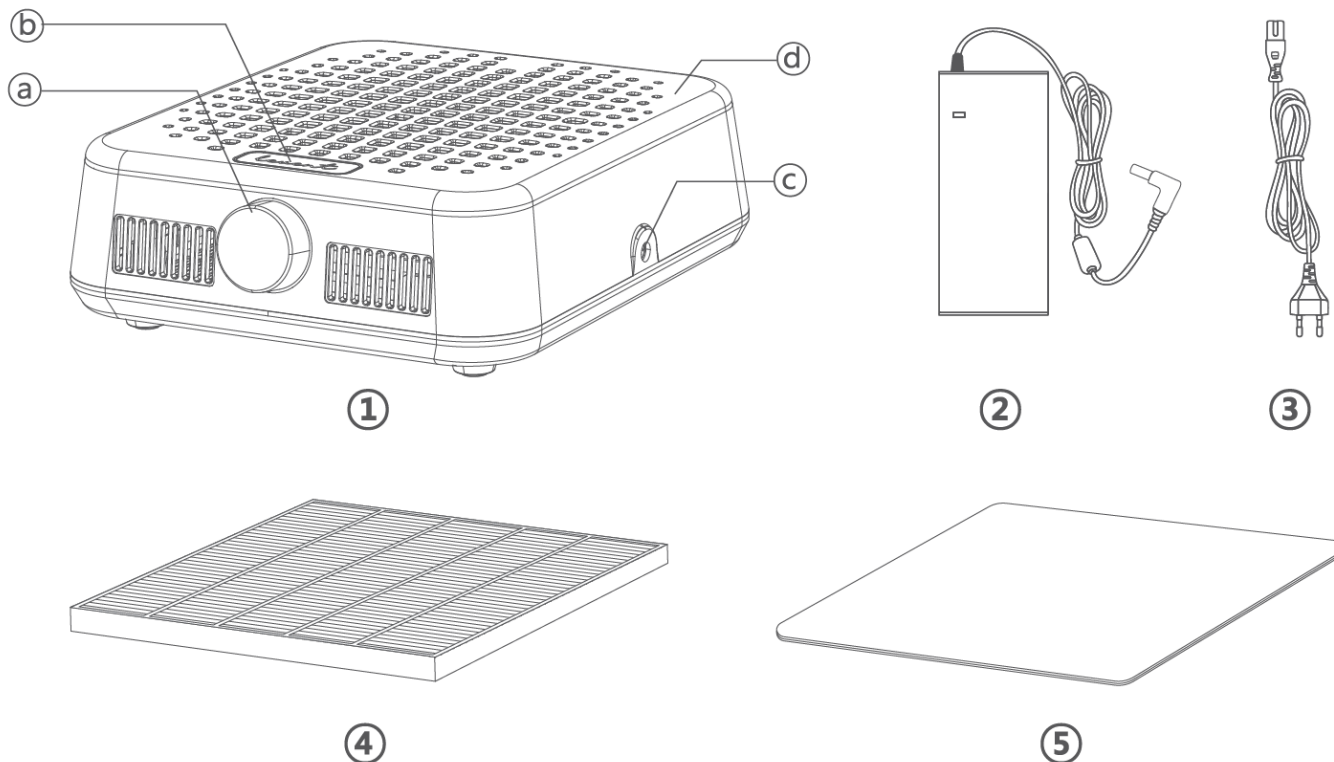

1. Main body

- a Power / Speed control dial
- b Status display window
- c Adaptor connector
- d Top cover

2. Power adaptor

3. Power cable

4. HEPA filter

5. Disposable filter

Installation & Operation

How to install

1. Please check the status of the product before installation.
2. Connect the power adaptor to the main body and insert the plug into an outlet.
3. Select a filter and install it as shown in the picture below.

HEPA filter installation

1. Separate the top cover from the main body.
2. Remove the plastic packaging from the HEPA filter and insert it into the main body.
3. Install the top cover to the main body.

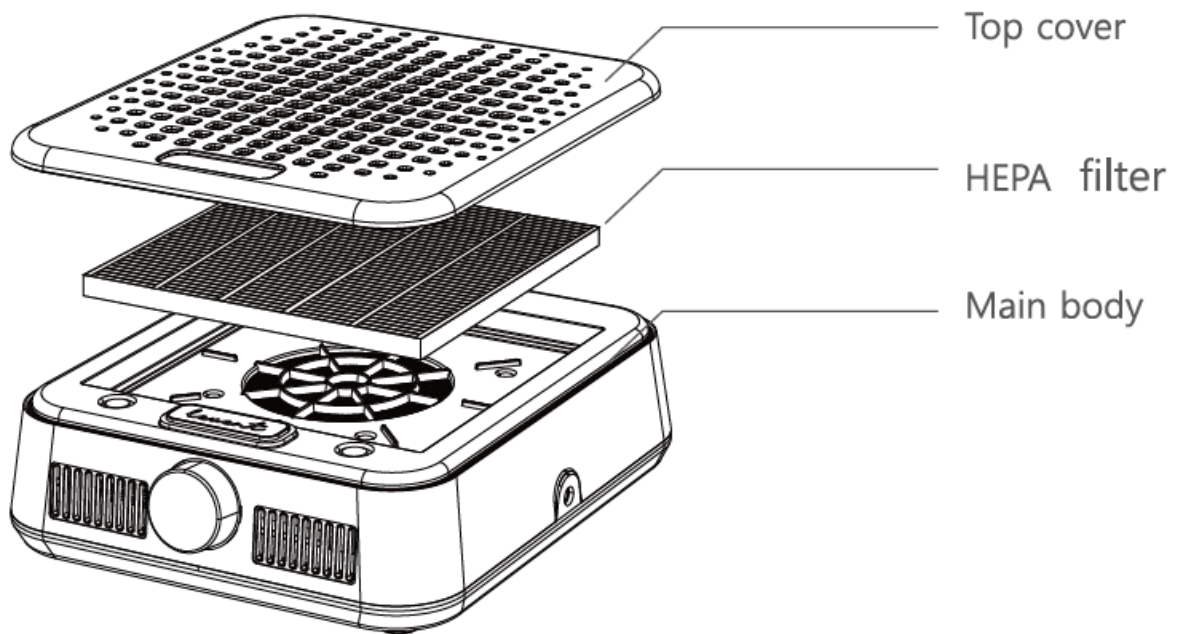

Disposable filter installation

1. Place the disposable filter on top of the main body.
2. It completely covers the filter so that no gaps in the main body are visible.

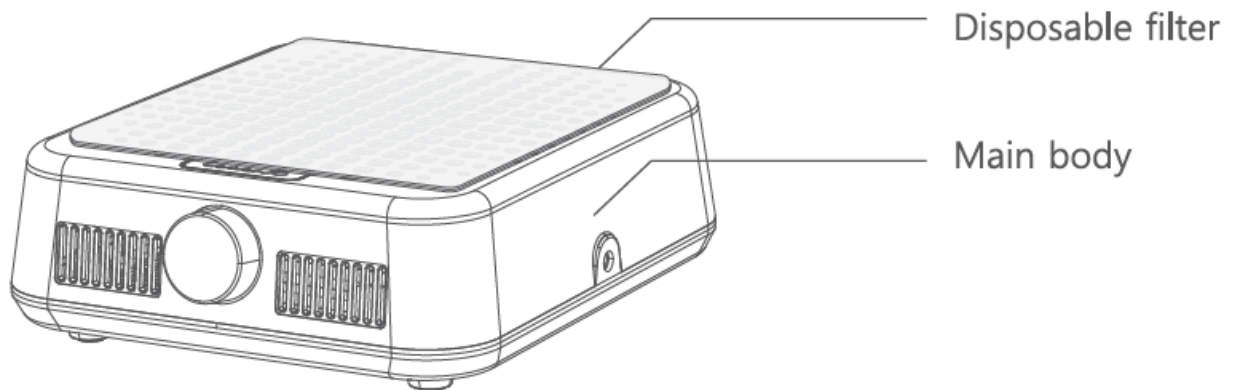

How to operation

1. Turn the speed control dial clockwise to set the desired speed.
2. The power is turned on with a 'blue' light on the status display window at the top.
3. Turn the speed control dial fully counterclockwise to turn off the power.

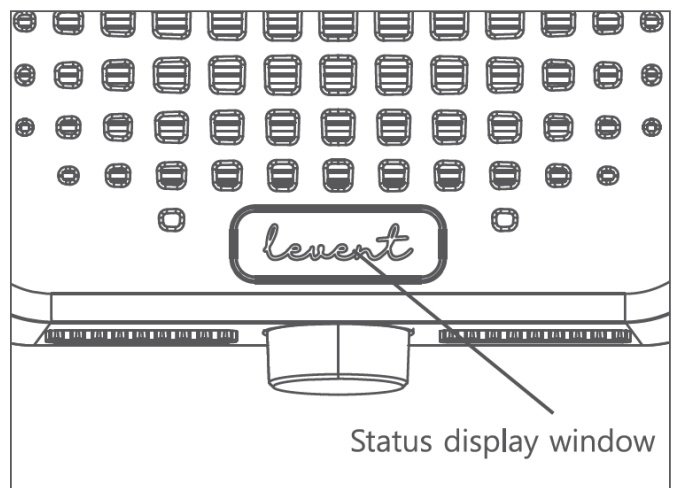
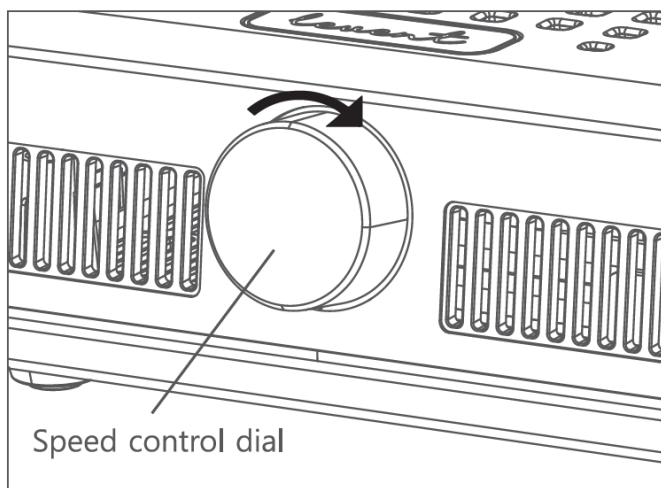

How to replace the filter

HEPA filter

1. Turn off the nail dust collector and remove the plug from the outlet.
2. Separate the top cover from the main body.
3. Hold the handle of the HEPA filter and separate it from the main body.
4. Insert a new HEPA filter and combine the top cover with the main body.

Disposable filter

1. Turn off the nail dust collector and remove the plug from the outlet.
2. Carefully remove the disposable filter to prevent foreign substances from entering the main body.
3. Place a new disposable filter on top of the main body.
4. Completely cover the disposable filter so that no gaps in the main body are visible.

It is recommended that the HEPA filter be replaced at least once every six months. Filter life may vary depending on installation location and environmental conditions.

How to clean the filter

HEPA filter

1. Turn off the nail dust collector and remove the plug from the outlet.
2. Separate the top cover from the main body.
3. Hold the handle of the HEPA filter and separate it from the main body.
4. Remove accumulated foreign matter by hand or using a vacuum cleaner.

- Do not use water or detergent when cleaning the HEPA filter.
- Filter performance deteriorates when water or detergent is used.
- It is recommended that you shake off the HEPA filter periodically before using it.

Specification

Model	Input	Output	Weight	Dimension		
				W	D	H
LEVENT	100-240V~, 50/60Hz 1.5A	24Vdc 2.7A	960g	210	252	77.7

Warranty

- 1 year
- We do not guarantee its quality in case of users' carelessness.

Website: www.saeyang.com

E-mail: marathon@saeyang.com

Documents / Resources

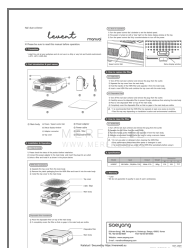

[saeyang LEVENT Dust Collector with HEPA Filter](#) [pdf] Instruction Manual
LEVENT, LEVENT Dust Collector with HEPA Filter, Dust Collector with HEPA Filter, Collector with HEPA Filter, HEPA Filter, Filter

References

- [User Manual](#)

[Manuals+](#), [Privacy Policy](#)

This website is an independent publication and is neither affiliated with nor endorsed by any of the trademark owners. The "Bluetooth®" word mark and logos are registered trademarks owned by Bluetooth SIG, Inc. The "Wi-Fi®" word mark and logos are registered trademarks owned by the Wi-Fi Alliance. Any use of these marks on this website does not imply any affiliation with or endorsement.