



Sabrent EC-DFLT External Hard Drive Docking Station User Manual

[Home](#) » [Sabrent](#) » Sabrent EC-DFLT External Hard Drive Docking Station User Manual 

Contents

- [1 Sabrent EC-DFLT External Hard Drive Docking Station](#)
- [2 TECHNICAL DATA](#)
- [3 FEATURES](#)
- [4 PARTS](#)
- [5 Connection](#)
- [6 PACKAGE CONTENTS](#)
- [7 Documents / Resources](#)
- [8 Related Posts](#)



Sabrent EC-DFLT External Hard Drive Docking Station



TECHNICAL DATA

- **Power:** DC 12V/2.0A
- **Operating Systems:** Windows Mac OSX

FEATURES

- 2.5" / 3.5" SATA Hard Drive Docking Station
- USB 3.0 transfer rates up to 5Gbps
- Plug & Play, Hot Swappable
- Supports 2.5" & 3.5" SATA HOD up to 4TB

PARTS

1. Hard Drive Slot
2. Power LED
3. Power Switch
4. USB 3.0 Cable Interface
5. Power Cable Interface

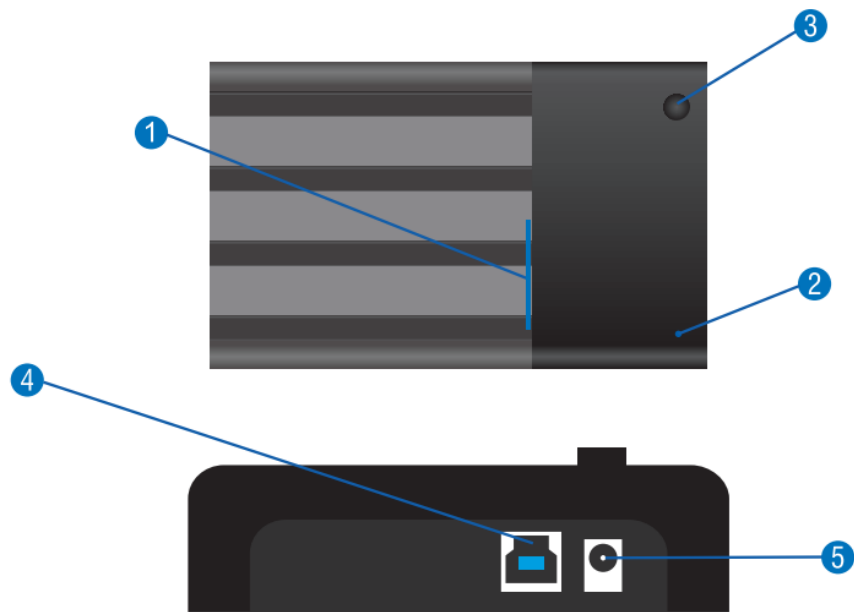

Connection

1. Check your Hard Drive to make sure it has the correct connector. This dock supports SATA only.



2. Insert the Hard Drive into the dock.

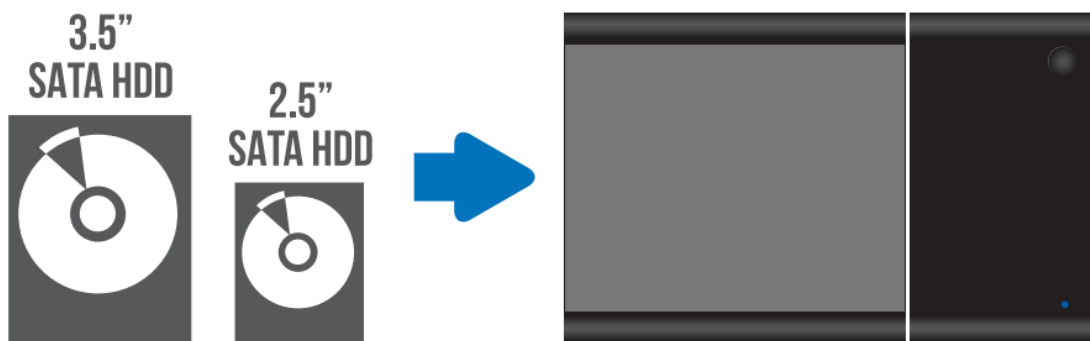

3. Next, connect the Power Adapter to a wall socket. Then, connect the USB cable from the Dock to the Computer.

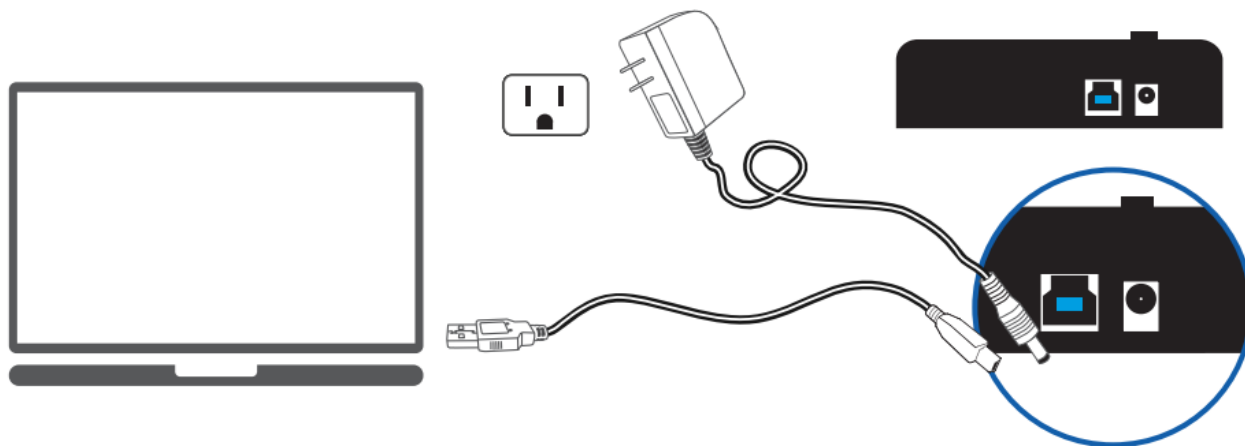

PACKAGE CONTENTS

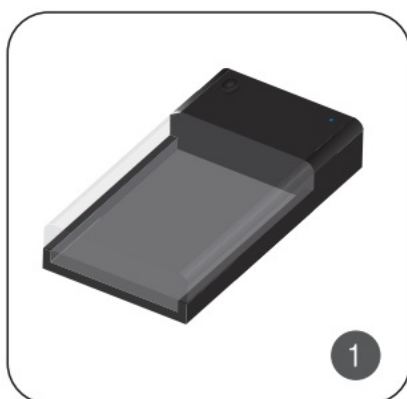

HARD DRIVE DOCK

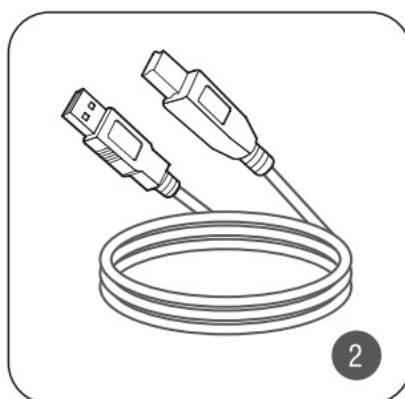

USB 3.0 CABLE

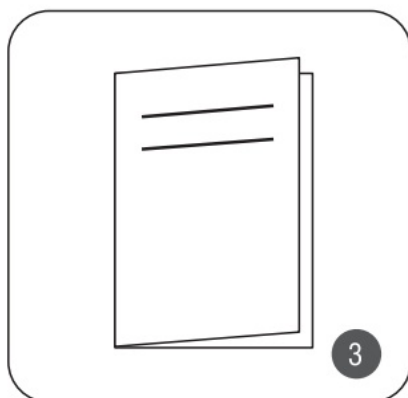

USER MANUAL

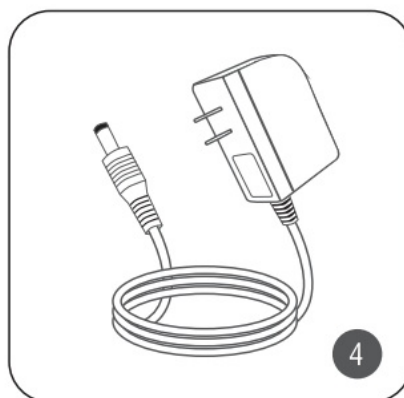

POWER ADAPTER

Documents / Resources

 <p>SABRENT USB 3.0 SATA HARD DRIVE FLAT DOCKING STATION</p> <p>EC-DFLT USER MANUAL</p>	<p>Sabrent EC-DFLT External Hard Drive Docking Station [pdf] User Manual EC-DFLT External Hard Drive Docking Station, External Hard Drive Docking Station, Docking Station</p>
------------------------------------------------------------------------------------------------------------------------------------------------------------------------------------	----------------------------------------------------------------------------------------------------------------------------------------------------------------------------------------------------