



**Contents** [ [hide](#) ]

- [1 S2B LEDWHP RF 2 Key Keychain Remote](#)
- [2 Specifications](#)
- [3 Bluetooth Controller](#)
- [4 2-key ON/OFF Remote](#)
- [5 Operating with TRUE MODS Smartphone A](#)
- [6 FCC Statement](#)
- [7 FAQs](#)
- [8 Documents / Resources](#)
  - [8.1 References](#)



## **S2B LEDWHP RF 2 Key Keychain Remote**



## Specifications

- Bluetooth Controller with pairing button
- 2-key ON/OFF Remote
- TRUE MODS Smartphone App compatibility
- Customizable device settings for patterns, colors, speed, brightness, and sensitivity

## Bluetooth Controller

Turn on your device and put the device into pairing mode by pressing and holding the pairing button for 5 seconds. The device will flash blue continuously to indicate that it is in pairing mode.

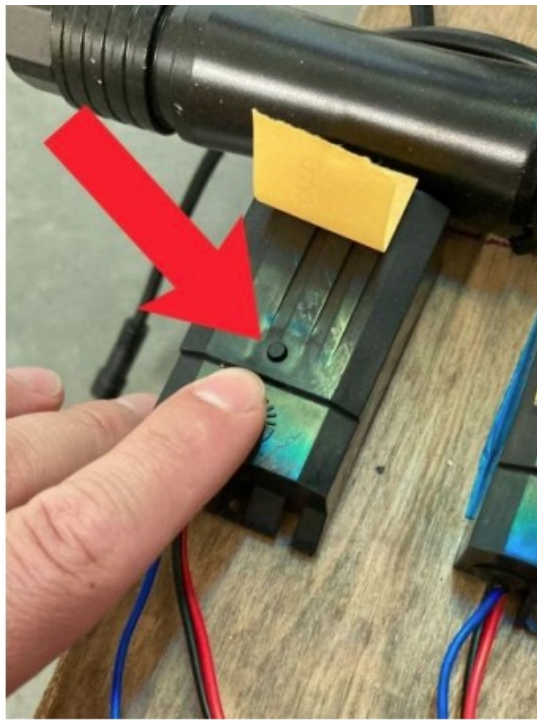

## 2-key ON/OFF Remote

1. Press the “On” button on the remote and hold.
2. If pairing is successful, the device will turn Green.
3. If pairing is not successful, the device will turn Red.
4. Turn the device off, then back on, and repeat the pairing process



## Operating with TRUE MODS Smartphone A

1. Open the TRUE MODS Connect App & log in using the method of your choice.

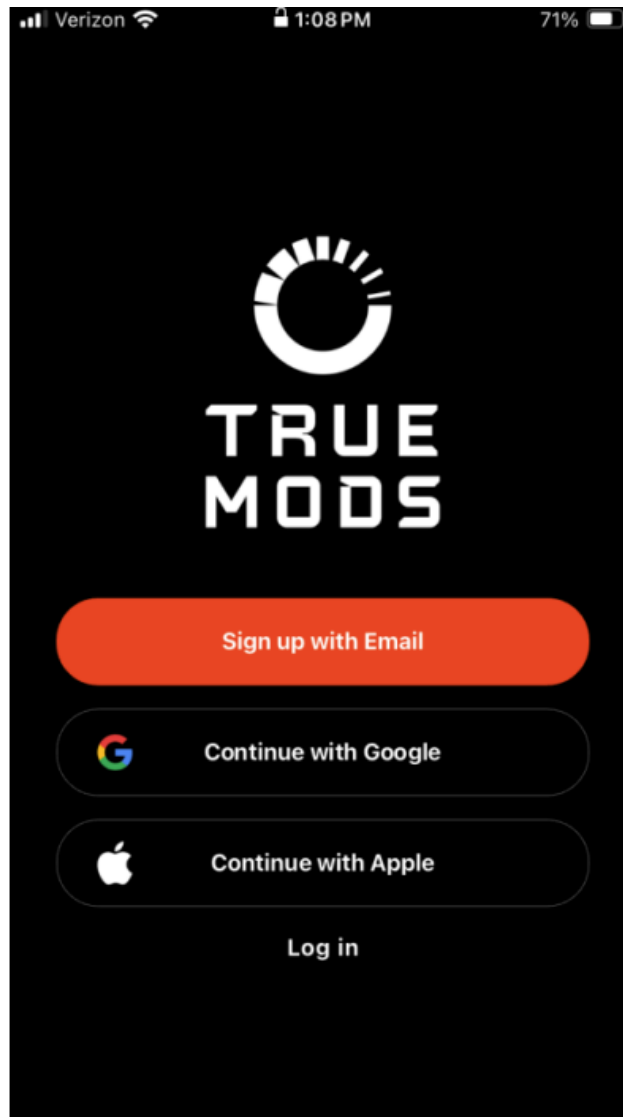

2. To pair devices, there must be at least one vehicle profile. Begin creating a vehicle profile by tapping on the hamburger menu and then on "Manage Garage".

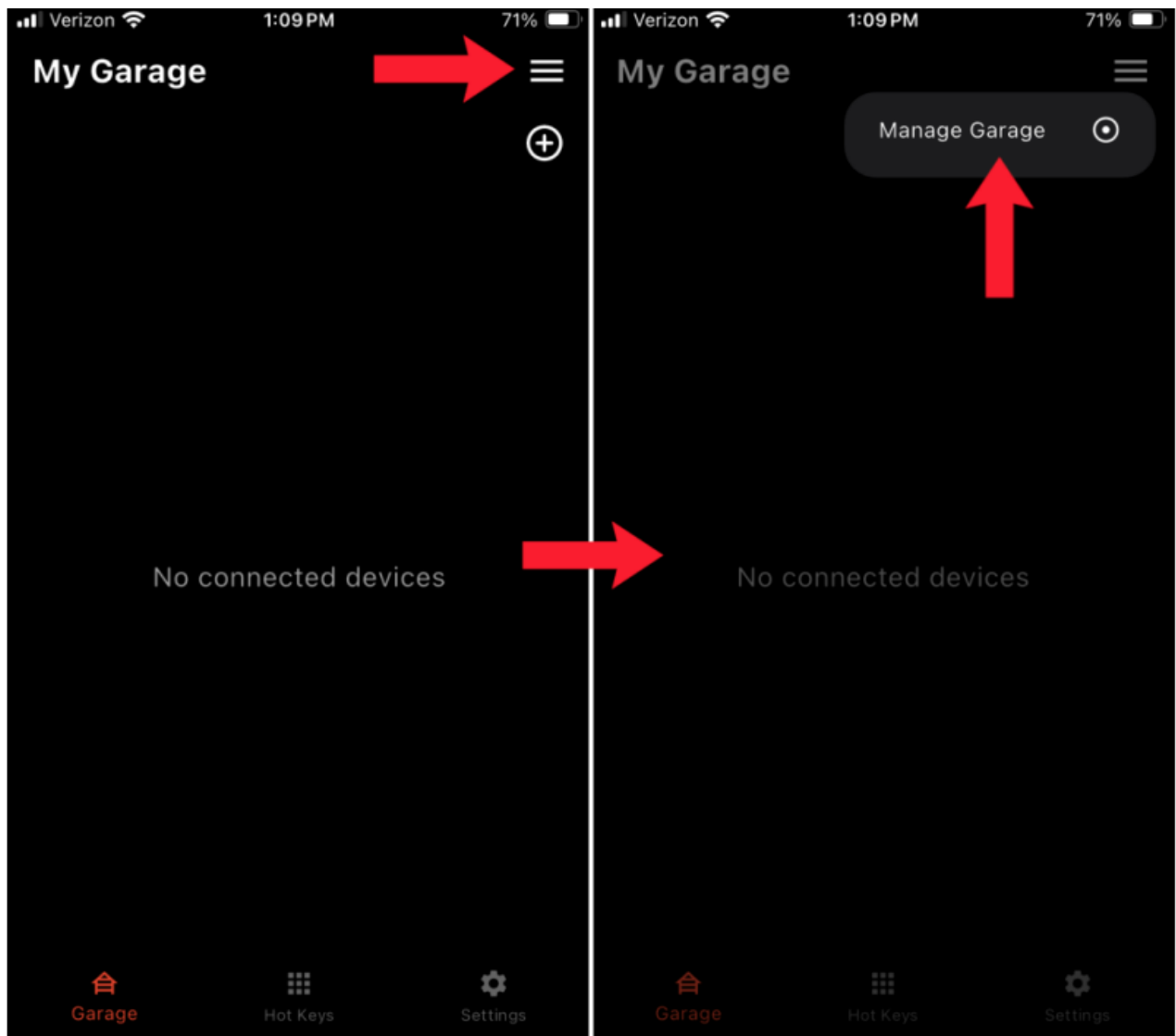

3. In the “Manage Garage” screen, tap the “+” Icon and follow the on-screen instructions to add your vehicle. Your vehicle will now be available on the “Manage Garage” screen. Tap the “X” on the top left to return to the main page.
4. Turn on your device and put the device into pairing mode by pressing and holding the pairing button for 5 seconds.

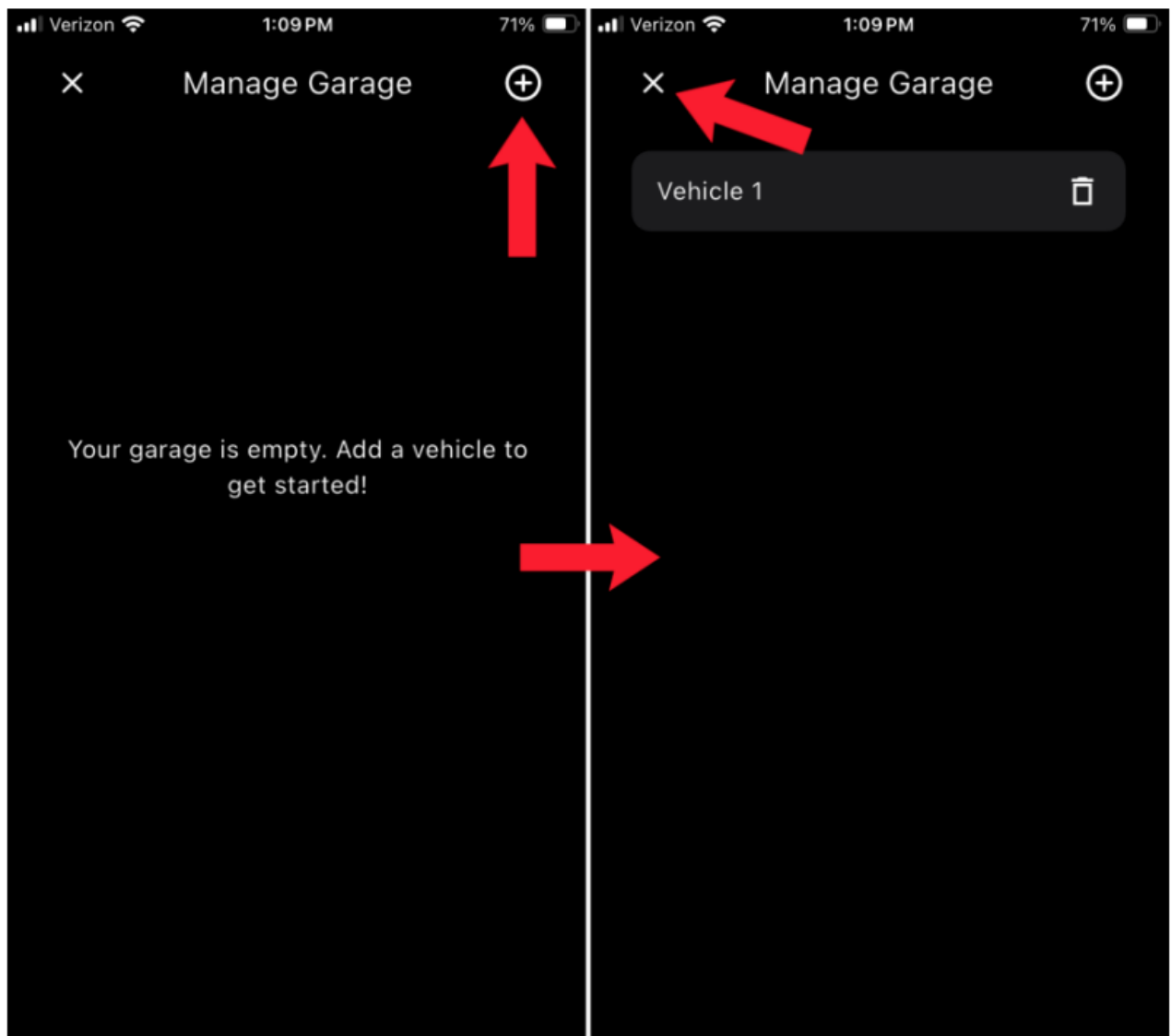

5. The device will flash blue continuously to indicate that it is in pairing mode.
6. On the app, tap the “+” to search for the device, then tap the device name to begin pairing.

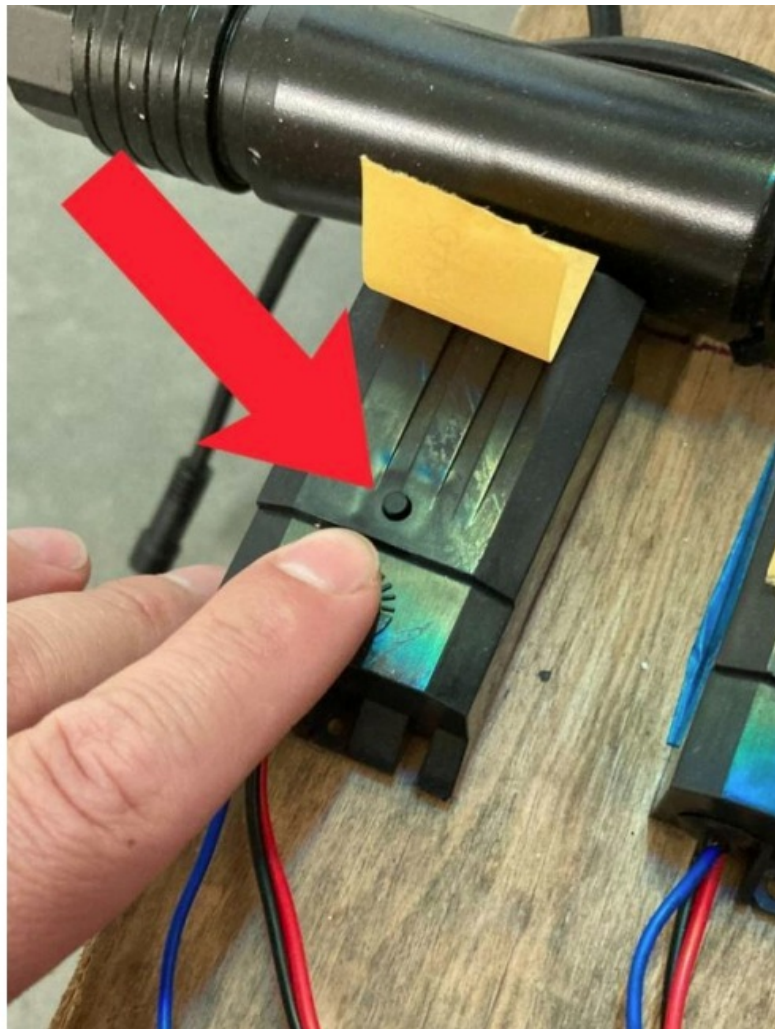

7. If pairing is successful, the device will turn Green. Continue following the on-screen instructions to finish adding the device.
8. If pairing is not successful, the device will turn Red. Turn the device off, then back on, and repeat the pairing process.

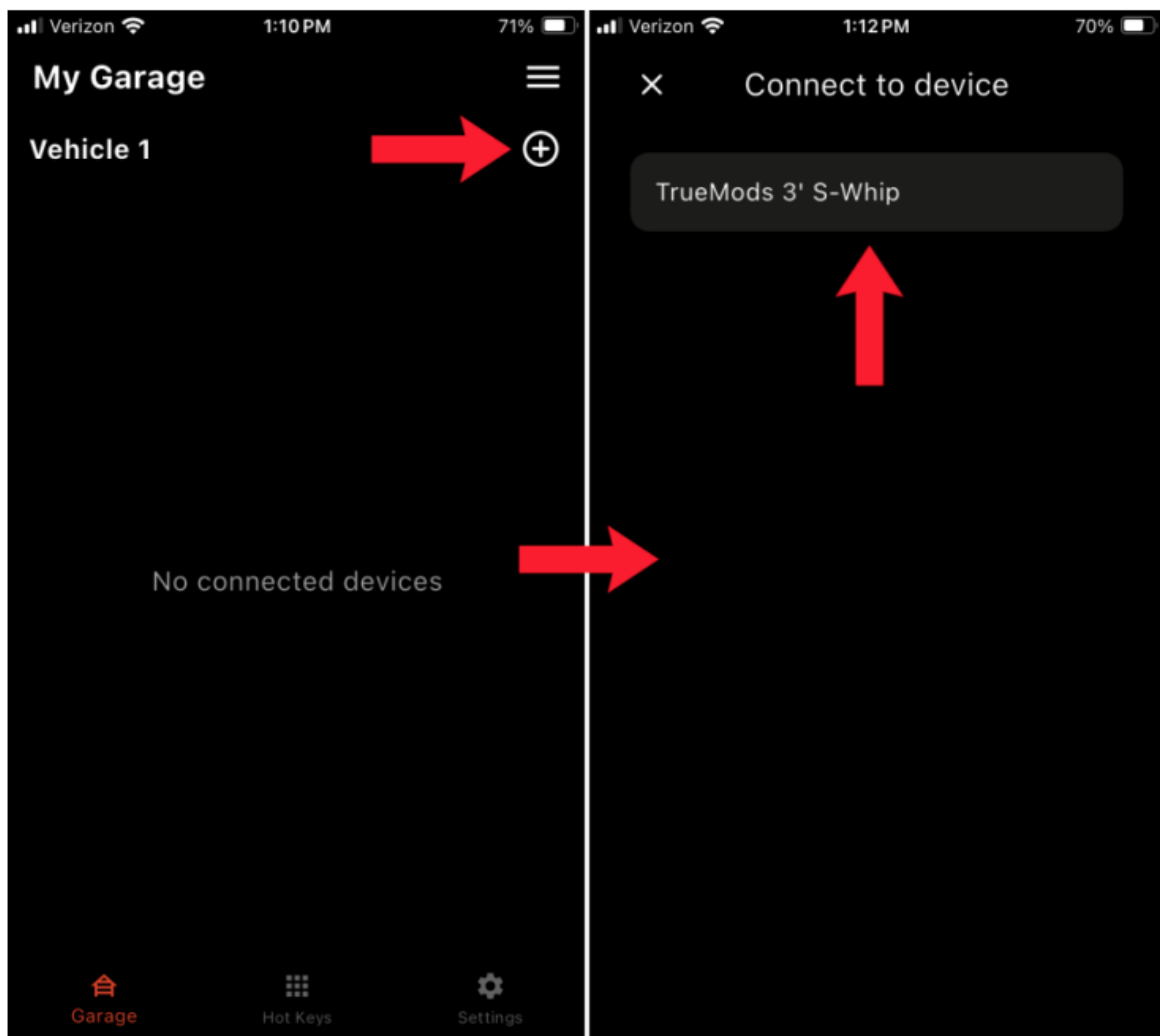

9. To change device settings, tap on the device. This will take you to the device settings screen.
10. In the device settings scr, you can choose different patterns and pattern directions, preset color gradients or solid colors, set the speed and brightness for each pattern, and adjust the sensitivity of audio-based patterns.



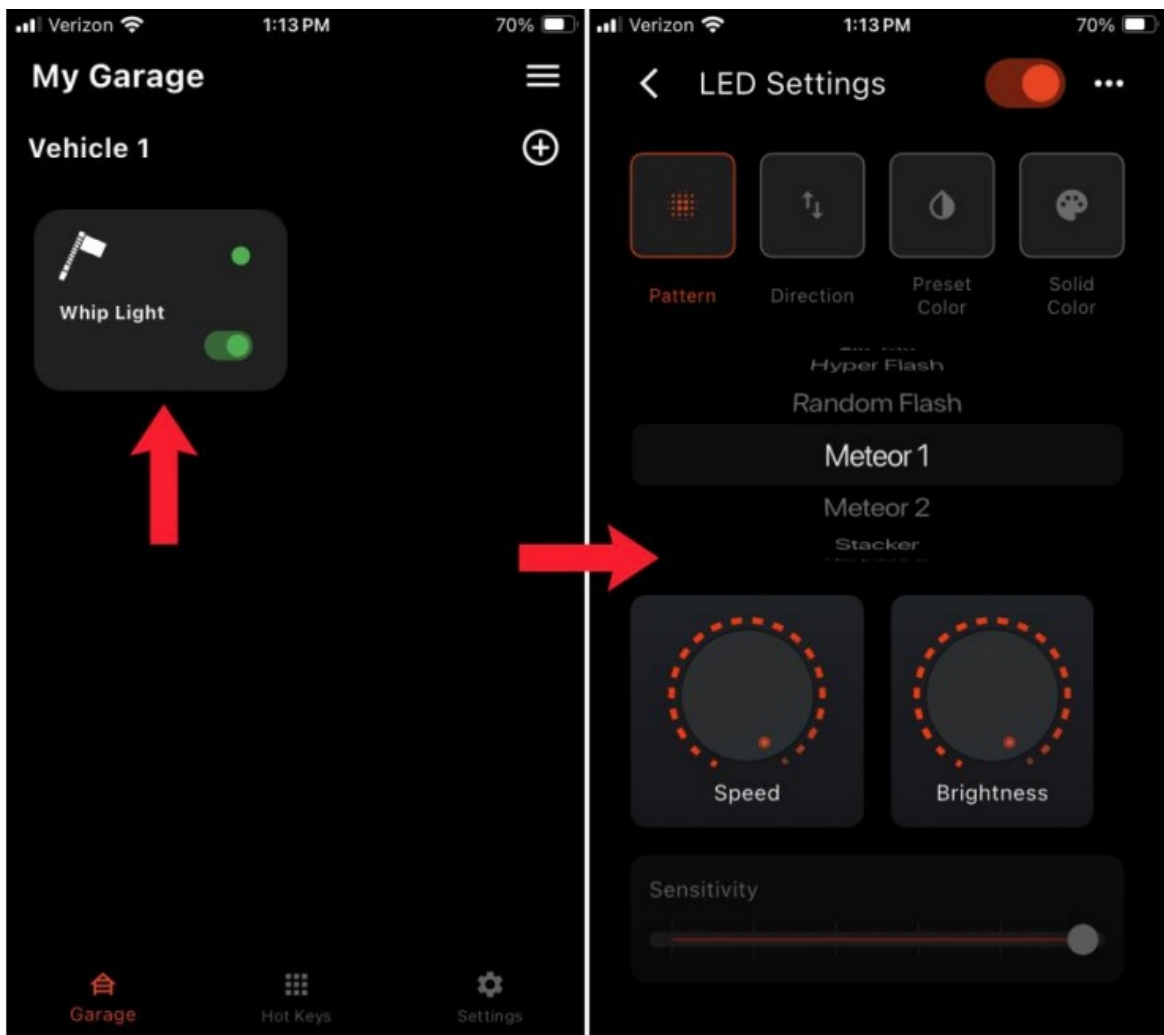

11. Settings will reflect on the device in real time. Some settings may not be available depending on the pattern chosen.

## FCC Statement

This device complies with part 15 of the FCC Rules.

Operation is subject to the following two conditions:

1. This device may not cause harmful interference, and
2. This device must accept any interference received, including interference that may cause undesired operation.

This equipment has been tested and found to comply with the limits for a Class B digital device, under part 15 of the FCC Rules. These limits are designed to provide reasonable protection against harmful interference in a residential installation. This equipment generates, uses, and can radiate radio frequency energy, and, if not installed and used according to the instructions, may cause harmful interference to radio communications.

However, there is no guarantee that interference will not occur in a particular installation.

If this equipment does cause harmful interference to radio or television reception, which can be determined by turning the equipment off and on, the user is encouraged to try to correct the interference by one or more of the following measures:

- Reorient or relocate the receiving antenna.
- Increase the separation between the equipment and receiver.
- Connect the equipment to an outlet on a circuit different from that to which the receiver is connected.
- Consult the dealer or an experienced radio/TV technician for help.

**Caution**

Any changes or modifications not expressly approved by the party.

**FAQs**

**Q: What should I do if my device does not pair successfully?**

A: If pairing is unsuccessful, turn the device off, then back on, and repeat the pairing process. Ensure that both devices are in pairing mode and try again.

**Q: Can I customize different patterns and colors for each device?**

A: Yes, using the TRUE MODS Smartphone App, you can choose different patterns, color gradients, solid colors, set speed and brightness, and adjust sensitivity for each device individually.

**Documents / Resources**

	<p><a href="#">S2B LEDWHP RF 2 Key Keychain Remote [pdf]</a> User Manual</p> <p>2BNZW-LEDWHP, 2BNZWLEDWHP, LEDWHP RF 2 Key Keychain Remote, LEDWHP, RF 2 Key Keychain Remote, 2 Key Keychain Remote, Keychain Remote, Remote</p>
---	--

**References**

- [User Manual](#)

■ S2B

🔑 2 Key Keychain Remote, 2BNZW-LEDWHP, 2BNZWLEDWHP, Keychain Remote, LEDWHP, LEDWHP RF 2 Key Keychain Remote, remote, RF 2 Key Keychain Remote, S2B

---

## Leave a comment

Your email address will not be published. Required fields are marked \*

Comment \*

Name

Email

Website

☐ Save my name, email, and website in this browser for the next time I comment.

**Post Comment**

**Search:**

**Search**

[Manuals+](#) | [Upload](#) | [Deep Search](#) | [Privacy Policy](#) | [@manuals.plus](#) | [YouTube](#)

This website is an independent publication and is neither affiliated with nor endorsed by any of the trademark owners. The "Bluetooth®" word mark and logos are registered trademarks owned by Bluetooth SIG, Inc. The "Wi-Fi®" word mark and logos are registered trademarks owned by the Wi-Fi Alliance. Any use of these marks on this website does not imply any affiliation with or endorsement.

