



S Pod BantamX Touchscreen User Guide

[Home](#) » [S Pod](#) » S Pod BantamX Touchscreen User Guide 

S Pod BantamX Touchscreen



Contents

- 1 Bantam and Source LT Pairing
- 2 Connecting to Control Panels
- 3 Documents / Resources
 - 3.1 References

Bantam and Source LT Pairing

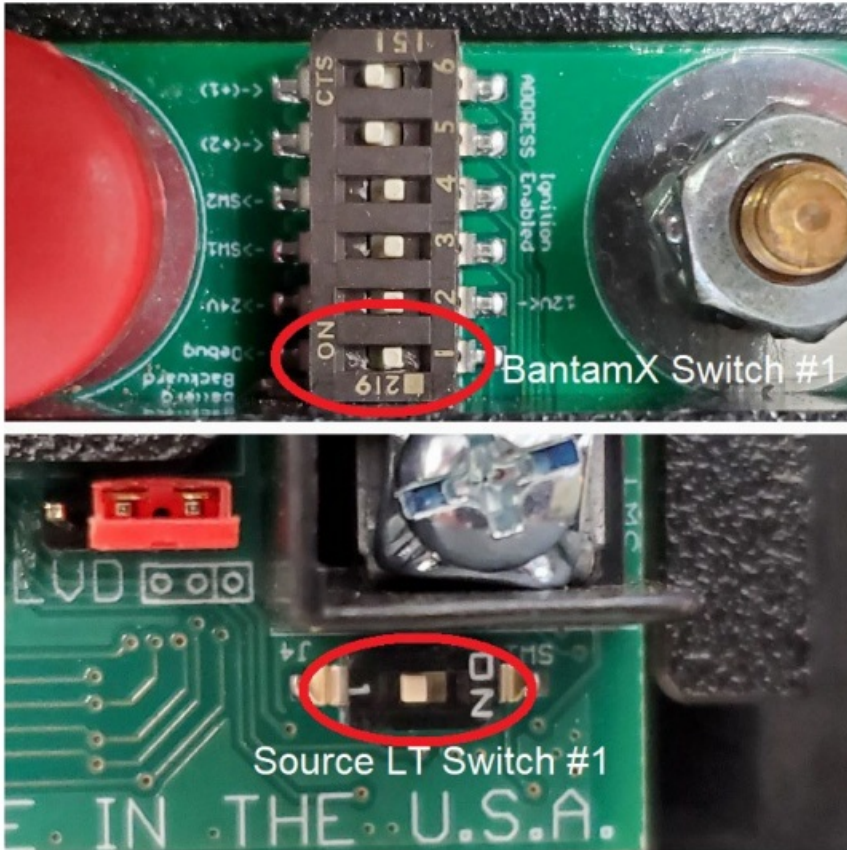

- Put the unit in pairing mode by turning dipswitch #1 from “Off” to “On” then back to the “Off” position. This gives you 60 seconds to pair to the app.



- Open the app (on Android devices, upon first opening of app, it will ask you to allow GPS location services, allow this) press “setup” then “scan”.



- Select which device you want to pair to.

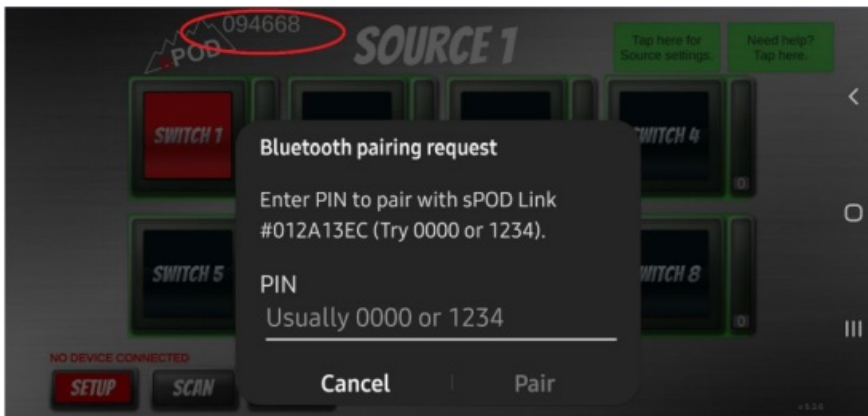

- The app will Pop up a PIN entry screen, press “Cancel”, then “Setup” and “Scan” again. After approx. 6 seconds, a 6-digit PIN number will appear on the top left center of the screen next to the S-Pod logo, and the PIN entry screen should appear again (On Android devices, you may need to perform this part of the procedure 2-3 times to get the PIN number to display).



- Enter the PIN number and select “Pair” the app will say “pairing” and connect to the selected device and populate the “connected to” location on the bottom left corner of the screen.

Connecting to Control Panels

Switch HD Panel Pairing



- The HD panel is shipped ready to pair, and doesn't require a PIN code for pairing.
- Open the app and press “setup” then “scan”, select the “Switch HD”



- The app will connect and pair automatically



- Once connected, app will show “connected to Switch HD” in the bottom left corner of the screen

Touchscreen Panel Pairing



- Select “Setup” on the touchscreen Menu,

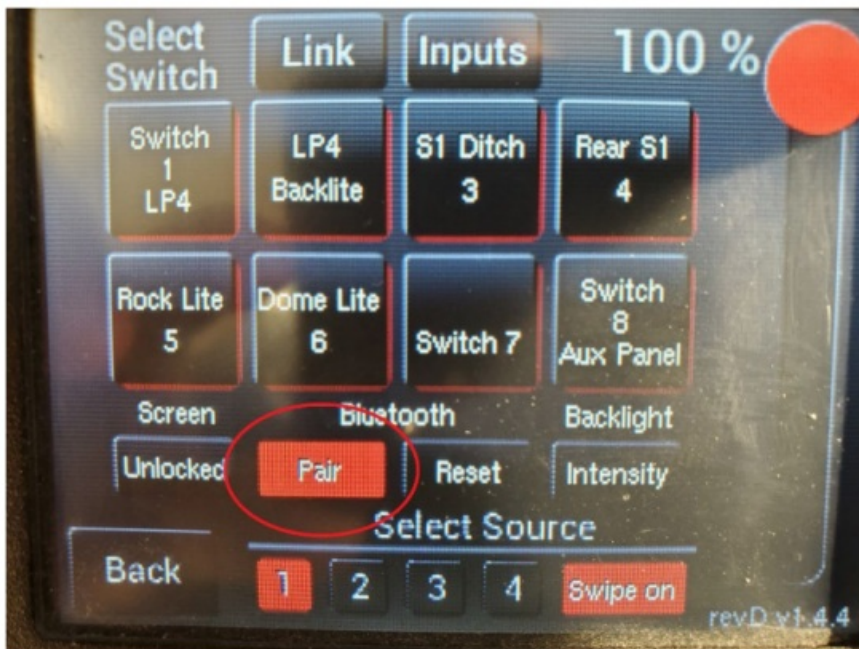

- Select “Pair”, this will put the screen in pairing mode for 1 Minute.



- Open the Bantam app, press “setup”, “scan”, and select “Touchscreen”

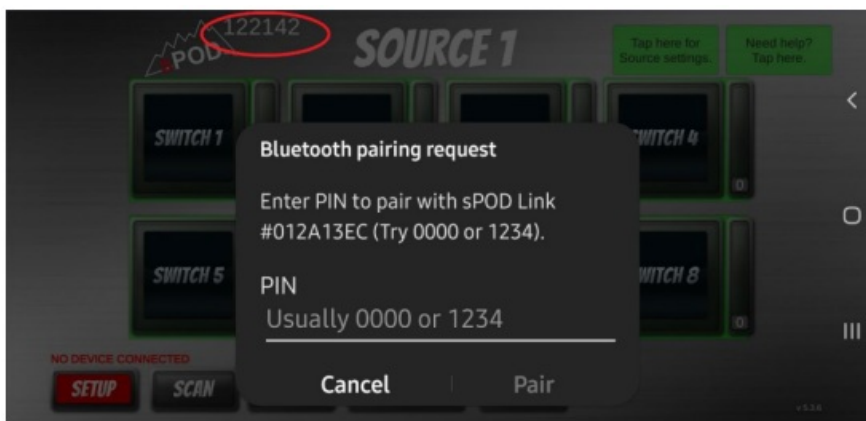

- The top-left corner of the screen will populate with the 6 digit PIN code, which you can then enter.



- The app will then say “Pairing with Touchscreen” and show the Touchscreen as a connected device in the Lower left corner of the app screen

Advanced Troubleshooting

- If you have tried to pair multiple times without success you may need to start over and reset your S-Pod units and your mobile device:

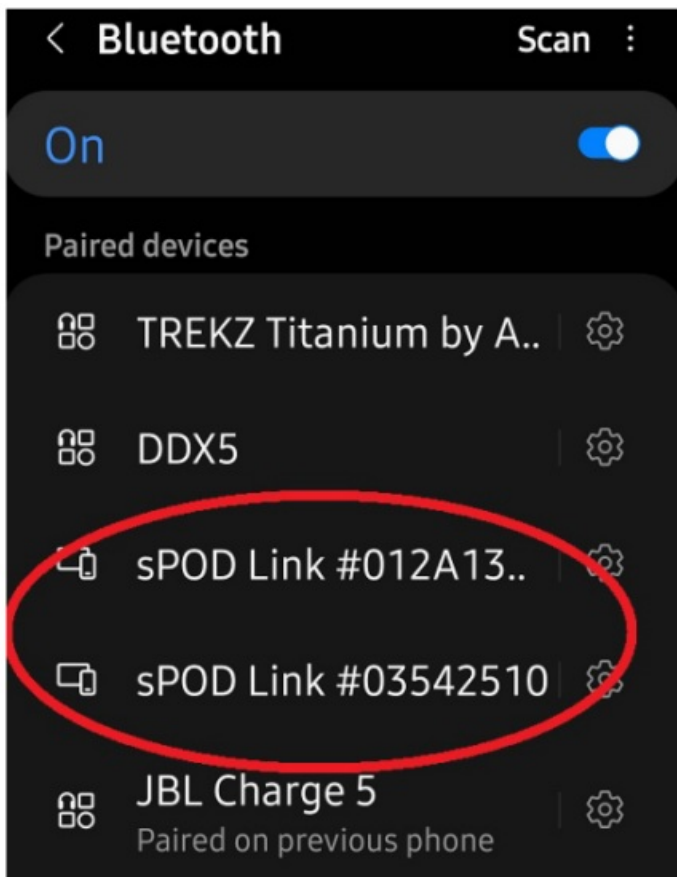

- **Android and Apple Devices:** Locate your Bluetooth device menu and “forget/unpair/remove” any device that says “S-Pod Link”

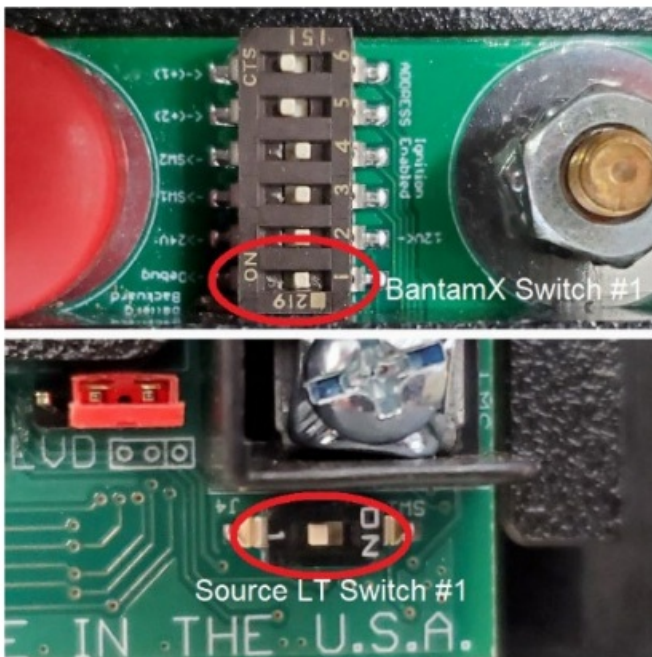

- **BantamX and Source LT:** Pull the 2 amp fuse for 20 seconds, re-install, then flip dipswitch #1 from “on” to “off” 5 times rapidly, ending in the “off” position, this will clear any previous attempts from the device and put it in pairing mode for 60 seconds.

PAIRING OPTIONS

- B1** Pair multiple devices to allow panel to link to more than one Bluetooth device.
- B4** Unpair with all devices to allow panel to link to any Bluetooth device.
- B5** Pair a single device to only allow panel to link to one Bluetooth device, and unpair all other devices.

- **Switch HD Panel:** Unplug the ethernet cable from the back of the unit, press and hold button “4” while plugging

the ethernet cable back into panel, continue holding the button until the Button LEDS have finished their cycling, this will unpair the panel from any devices and allow the panel to be discoverable by your device.



- **Touchscreen:** Press the “Setup” button on the home screen, then press and hold the “Reset” button in the Bluetooth menu for 5 -6 seconds until the “Pair” button illuminates red, this will clear any previous device pairings, and put the touchscreen in pairing mode for 60 seconds.

Android Auto and Apple CarPlay

Neither of these systems have been verified to work or support the Bantam app 100%, if you can get the device to pair, it may work, but we have seen cases where there are 2 vehicles in the bay and 1 works and the other doesn't.



Documents / Resources

	<p>S Pod BantamX Touchscreen [pdf] User Guide BantamX Touchscreen, BantamX, Touchscreen</p>
---	---

References

- [User Manual](#)

Manuals+. Privacy Policy

This website is an independent publication and is neither affiliated with nor endorsed by any of the trademark owners. The "Bluetooth®" word mark and logos are registered trademarks owned by Bluetooth SIG, Inc. The "Wi-Fi®" word mark and logos are registered trademarks owned by the Wi-Fi Alliance. Any use of these marks on this website does not imply any affiliation with or endorsement.