



RYTHMOS SWAP Pad Device Instructions

[Home](#) » [RYTHMOS](#) » RYTHMOS SWAP Pad Device Instructions

Contents [[hide](#)]

- [1 RYTHMOS SWAP Pad Device](#)
- [2 How to Use the Swap Pad](#)
- [3 FCC](#)
- [4 Documents / Resources](#)
- [5 Related Posts](#)



RYTHMOS SWAP Pad Device



How to Use the Swap Pad

- Read the instructions on the back of the Swap Pad.
- Place the old and new wearable on the . appropriate pad, button side down.
- The LEDs will turn blue when both wearables are correctly placed. 0 Press the center button.
- The LEDs will begin flashing in an alternating pattern to indicate a swap is in progress. B The LED's will blink green to indicate a successful swap, or red to indicate a failure.

- If they blink red, check Rhythms. It may be a false negative.
- The swap may take 1-2 minutes to complete.

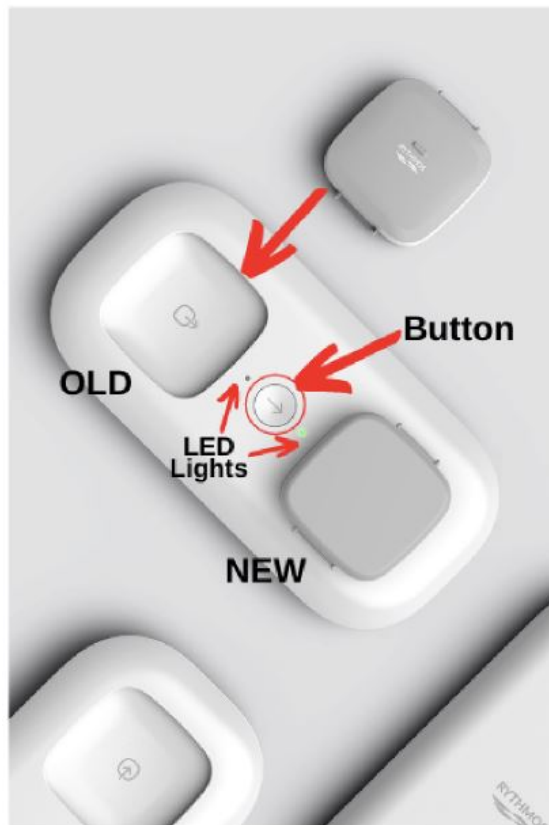

FCC

This equipment complies with FCC radiation exposure limits set forth for an uncontrolled environment. A separation distance of 25 cm must be maintained between this device and nearby persons.

This transmitter must not be co-located or operation in conjunction with any other antenna or transmitter.

Maximum antenna gain of -1dBi This device complies with part 15 of the FCC rules. Operation is subject to the following two conditions: (1) This device may not cause harmful interference, and (2) this devices must accept any interference received, including interference that may cause undesired operation.

Caution: Changes or modifications not expressly approved by the party responsible for compliance could void the user's authority to operate this equipment.

Documents / Resources

| | |
|---|---|
|  | <p>RHYTHMOS SWAP Pad Device [pdf] Instructions 1902, 2AWYM1902, SWAP Pad Device, SWAP, Pad Device</p> |
|---|---|