



RUSTA CDA1180 Bruksbo LX System 20V Battery Instructions

[Home](#) » [RUSTA](#) » RUSTA CDA1180 Bruksbo LX System 20V Battery Instructions 

RUSTA[®]

BRUKSBO

LX system 20V
LITHIUM EXCHANGE



BATTERY 20V 2.0AH
Battery 20V 2,0Ah / Akko 20V 2,0Ah

Contents

- [1 CDA1180 Bruksbo LX System 20V Battery](#)
- [2 SAFETY INSTRUCTIONS](#)
- [3 GENERAL SAFETY WARNINGS](#)
- [4 PRODUCT INFORMATION](#)
- [5 Technical specifications](#)
- [6 OPERATION](#)
- [7 MAINTENANCE](#)
- [8 ENVIRONMENT](#)
- [9 WARRANTY](#)
- [10 RIGHT OF COMPLAINT](#)
- [11 DECLARATION OF CONFORMITY](#)
- [12 Documents / Resources](#)
 - [12.1 References](#)
- [13 Related Posts](#)

CDA1180 Bruksbo LX System 20V Battery

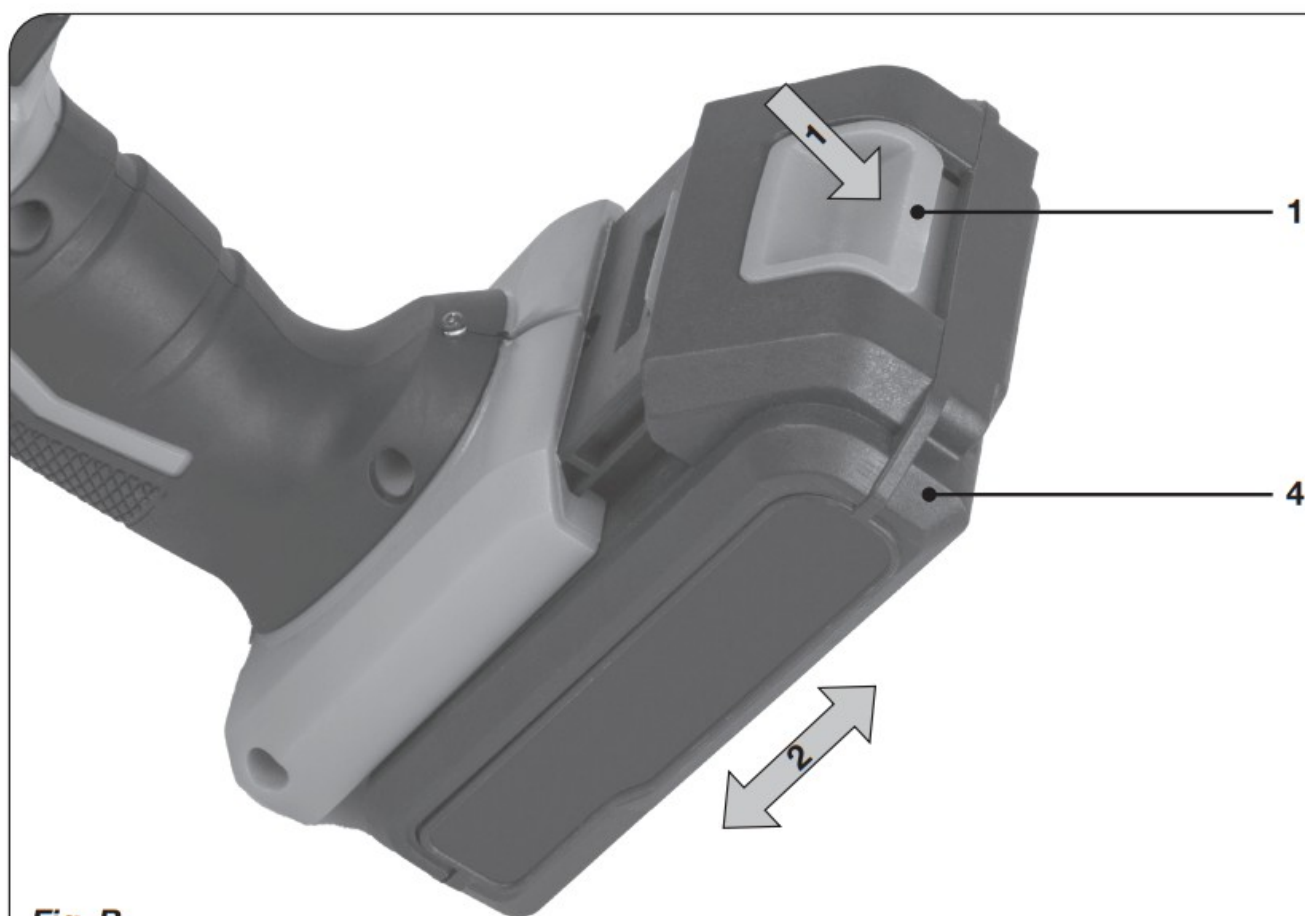
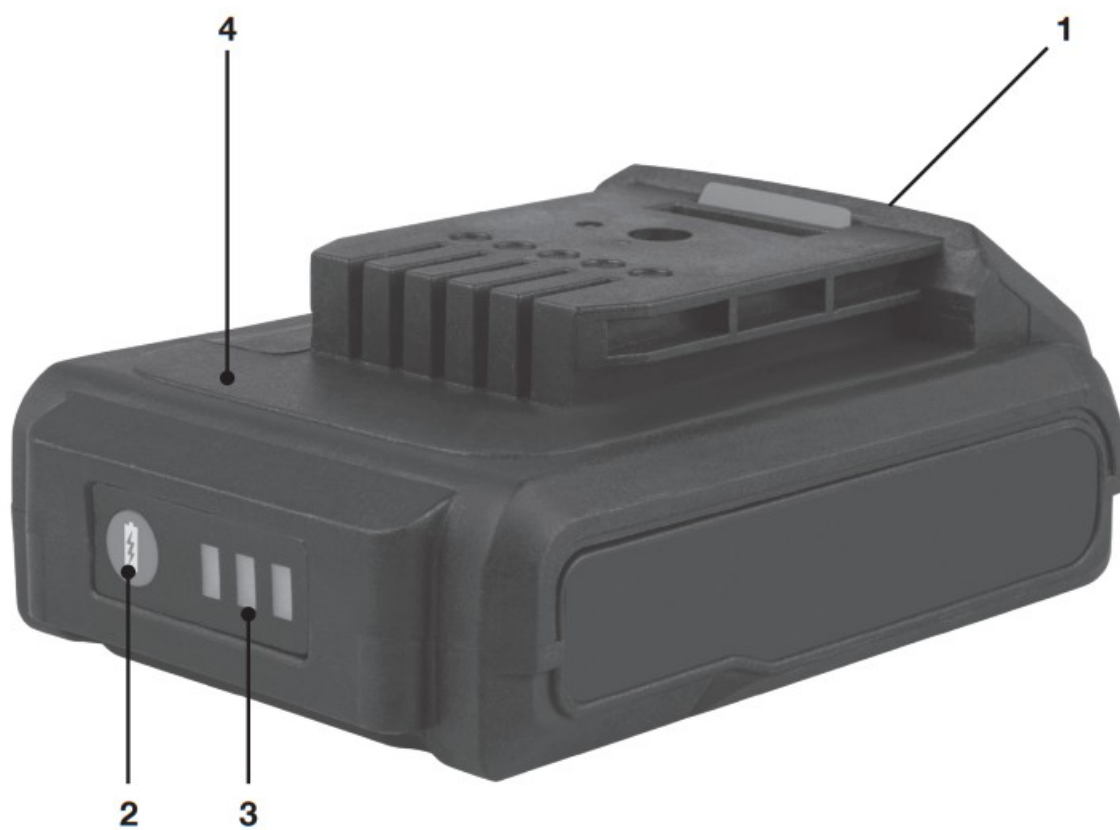

Thank you for choosing to purchase a product from Rusti!

SAFETY INSTRUCTIONS



Read the enclosed safety warnings, the additional safety warnings and the instructions. Failure to follow the safety warnings and the instructions may result in electric shock, fire and/or serious injury. Save the safety warnings and the instructions for future reference.

The following symbols are used in the user manual or on the product:

	Read the user manual.
	Denotes risk of personal injury, loss of life or damage to the tool in case of nonobservance of the instructions in this manual.
	Max temperature 45°C.
	Do not throw the battery into fire.
	Do not throw the battery into water.
	Do not expose to rain.
	Do not dispose of the product in unsuitable containers.
	Separate collection for Li-ion battery.
	The product is in accordance with the applicable safety standards in the European directives.

GENERAL SAFETY WARNINGS

- a) Keep work area clean and well lit. Cluttered or dark areas invite accidents.
- b) Do not operate power tools in explosive atmospheres, such as in the presence of flammable liquids, gases or

dust. Power tools create sparks which may ignite the dust or fumes.

c) Keep children and bystanders away while operating a power tool/battery. Distractions can cause you to lose control.

BATTERY TOOL USE AND CARE

a) Recharge only with the charger specified by the manufacturer. A charger that is suitable for one type of battery pack may create a risk of fire when used with another battery pack.

b) Use power tools only with specifically designated battery packs. Use of any other battery packs may create a risk of injury and fire.

c) When battery pack is not in use, keep it away from other metal objects, like paper clips, coins, keys, nails, screws or other small metal objects that can make a connection from one terminal to another.

Shorting the battery terminals together may cause burns or a fire.

d) Under abusive conditions, liquid may be ejected from the battery; avoid contact.

If contact accidentally occurs, flush with water. If liquid contacts eyes, additionally seek medical help. Liquid ejected from the battery may cause irritation or burns.

e) Do not use a battery pack or tool that is damaged or modified. Damaged or modified batteries may exhibit unpredictable behaviour resulting in fire, explosion or risk of injury.

f) Do not expose a battery pack or tool to fire or excessive temperature. Exposure to fire or temperature above 130 °C may cause explosion. NOTE The temperature „130 °C“ can be replaced by the temperature „265 °F“.

g) Follow all charging instructions and do not charge the battery pack or tool outside the temperature range specified in the instructions. Charging improperly or at temperatures outside the specified range may damage the battery and increase the risk of fire.

h) Never service damaged battery packs.

Service of battery packs should only be performed by the manufacturer or authorized service providers.

SAFETY WARNINGS FOR BATTERY

a) Do not open the battery. Danger of shortcircuiting.

b) Protect the battery against heat, e. g., against continuous intense sunlight, fire, water, and moisture. Danger of explosion.

c) In case of damage and improper use of the battery, vapours may be emitted. Ventilate the area and seek medical help in case of complaints. The vapours can irritate the respiratory system.

d) Use the battery only in conjunction with your Busboy LX system product. This measure alone protects the battery against dangerous overload.

e) The battery can be damaged by pointed objects such as nails or screwdrivers or by force applied externally. An internal short circuit can occur and the battery can burn, smoke, explode or overheat.

PRODUCT INFORMATION

Intended use

Only use the following Chargers of the LX system 20V battery platform. Using any other Charger for charging the battery, could cause serious injury or damage too the charger.

CDA1183 Charger adapter

CDA1182 Quick charger

The batteries of the LX system 20V battery platform are interchangeable with all the Busboy LX System 20V battery platform tools.

Technical specifications

Model No	CDA1180
Battery Type	Lithium-Ion
Voltage	20V
Capacity	2.0 Ah
Recommended charger	CDA1183, CDA1182
Weight	0.3 kg

DESCRIPTION

The numbers in the text refer to the diagrams on pages 2.

1. Battery unlock button
2. Battery LED indicators button
3. Battery LED indicators
4. Battery

OPERATION



Before any work on the power tool, remove the battery.



The battery must be charged before first use.

Inserting the battery into the machine (Fig. B)

Ensure that the exterior of the battery is clean and dry before connecting to the charger or machine.

1. Insert the battery (4) into the base of the machine as shown in Fig. B.
2. Push the battery further forward until it clicks into place.

Removing the battery from the machine (Fig. B)

1. Push the battery unlock button (1)
2. Pull the battery out of the machine like shown in Fig. B.

Checking the battery charging status (Fig. A)

- To check the battery charge status, push the button (2) on battery shortly.
- The battery has 3 lights indicating the charge level, the more lights that burn, the more charge the battery has left.
- When the lights are not burning it means the battery is empty and must be charged immediately.



When the machine is not being used over a longer period of time it is best to store the battery in charged condition. and never below 0 degrees Celsius.

MAINTENANCE



Before cleaning and maintenance, always switch off the machine and remove the battery pack from the machine.

Clean the battery casings regularly with a soft cloth, preferably after each use. Make sure that the ventilation openings are free of dust and dirt. Remove very persistent dirt using a soft cloth moistened with soapsuds. Do not use any solvents such as gasoline, alcohol, ammonia, etc. Chemicals such as these will damage the synthetic components.

ENVIRONMENT

Do not dispose of batteries in your normal household waste!

Separate collection of batteries.

Defective or worn-out rechargeable batteries must be recycled according to Directive 2006/66/ EC. Take the battery pack and/or appliance to a nearby collection facility. Please consult your local authorities regarding suitable disposal of worn out power tools/battery packs.

WARRANTY

Rusti products are developed to the highest quality standards and are guaranteed free of defects in both materials and workmanship for the period lawfully stipulated starting from the date of original purchase. Should the product develop any failure during this period due to defective material and/or workmanship then contact your Rusti dealer directly.

The following circumstances are excluded from this guarantee:

- Repairs and or alterations have been made or attempted to the machine.
- Normal wear and tear.
- The tool has been abused, misused or improperly maintained.
- Errors that occurred as a result of not following the user manual.

This constitutes the sole warranty made by company either expressed or implied. There are no other warranties expressed or implied which extend beyond the face hereof, herein, including the implied warranties of merchantability and fitness for a particular purpose. In no event shall Rusti be liable for any incidental or consequential damages. The dealers remedies shall be limited to repair or replacement of nonconforming units or parts.

The product and the user manual are subject to change. Specifications can be changed without further notice.

RIGHT OF COMPLAINT

By law the product must be returned to the place of purchase along with the original receipt in the event of a complaint. The user is liable for any damage to the product that is caused by not using the product for its intended purpose or by not following this user manual correctly. The right of complaint will not apply in these instances.

DECLARATION OF CONFORMITY

CDA1180 – 956015900201 – BATTERY 20V – 2.0AH LI-ION

We declare under our sole responsibility that this product is in conformity with the following standards and regulations:

Directive/Regulation	Harmonized standard
Battery directive 2006/66/EC amended by 2013/56/EU Battery regulation 2020/0353 (COD)	IEC 62133-2:2017 IEC 62133-2:2017; EN62841-1 Annex K, UN38.3

Vasey, 24-11-2022
Jasper Bondesson



Quality & Sustainability Manager
Customer Service Rusti

Consumer contact: Rusti Customer Service, Box 5064, 194 05 Uplands Vasey, SWEDEN

Website: www.rusta.com

E-mail: customerservice@rusta.com

Art. No. 956015900201

©2022 RUSTA AB 2211-24

Documents / Resources

	<p>RUSTA CDA1180 Bruksbo LX System 20V Battery [pdf] Instructions 956015900201, CDA1180 Bruksbo LX System 20V Battery, CDA1180, Bruksbo LX System 20V Battery, 20V Battery, Battery</p>
---	--

References

-  [Rusta](http://www.rusta.com)