

Russound AVA Series MINI-AVA Low Profile Mini AVR with HDMI



# Russound AVA Series MINI-AVA Low Profile Mini AVR with HDMI Installation Guide

[Home](#) » [Russound](#) » Russound AVA Series MINI-AVA Low Profile Mini AVR with HDMI Installation Guide 

## Contents

- [1 Russound AVA Series MINI-AVA Low Profile Mini AVR with HDMI](#)
- [2 Product Specifications](#)
- [3 Product Usage Instructions](#)
- [4 OVERVIEW](#)
- [5 WHAT'S IN THE BOX](#)
- [6 INSTALLATION OPTIONS](#)
- [7 USING THE MINI-AVA](#)
- [8 USING THE MINI-AVR](#)
- [9 Documents / Resources](#)
  - [9.1 References](#)

a sound relationship  
**Russound**

**Russound AVA Series MINI-AVA Low Profile Mini AVR with HDMI**



## Product Specifications

- **Model:** AVA2.11 & AVA3.11 Low Profile Mini-AVR with HDMI
- **Power Cord Length:** 6' (1.8m)
- **Speaker Connector:** Removable screw-down connector (accepts up to 14AWG wire)
- **Mounting:** Table-top or wall-mountable
- **External IRR Sensor Cable Length:** 3' (.91m)

## Product Usage Instructions

### What's in the Box:

The AVA-Series Mini-AVR comes with various components including power cords, speaker connector, mounting bracket, screws, IRR sensor, HDMI cable, remote control, batteries, and owner's manual.

### Installation Requirements:

You will need a flat screwdriver for the speaker connectors, a #2 Philips screwdriver for wall-mounting, and wire strippers for installation.

### Installation Options:

- **Table-Top Mounting:** The Mini-AVR can be installed on a table-top or shelf.
- **Wall Mounting:** Use the included wall-mount bracket to mount the Mini-AVR securely on a wall or surface.
- **In-Wall Box Mounting:** For a concealed installation, consider mounting the Mini-AVR in an in-wall mounting

box behind a TV.

## **Connections:**

The Mini-AVR offers various connection options including Aux Input, Line Out, Sub Out, IR In/Out, HDMI ARC, Optical Input, Power Connection, and Loudspeaker Connections.

## **IR Sensor Accessibility:**

Place the external IRR sensor discreetly with its 3' cable for optimal performance. Avoid direct sunlight exposure for accurate IR reception.

## **Using the Mini-AVR:**

Follow the user manual to connect your audio sources, speakers, and TV for an enhanced audio experience. Use the remote control to adjust settings and enjoy your audio setup.

## **FAQ:**

- **Q: Can I connect multiple Mini-AVRs together?**

- **A:** Yes, you can use the Line Out connection to link multiple Mini-AVRs or amplifiers for expanded audio coverage.

## **OVERVIEW**

Russound's mini-AVRs are a game changer in the audio industry. Their builtin HDMI ARC input with CEC control means that these compact, powerful, low-profile mini-AVRs can be used seamlessly with any modern television without the need for any remote control other than your native TV or cablebox/satellite remote that is already being used. If desired, their multiple inputs can be used to convert the AVA-Series into a mini-receiver supporting up to 4 total inputs (HDMI, Digital Optical, Line-Level Stereo, Bluetooth) and they include an external IR sensor and full-featured remote control.

## **WHAT'S IN THE BOX**

- (1) AVA-Series Mini-AVR
- (1) 6' (1.8m) Power Cord (US Version)
- (3) 6' (1.8m) Power Cords: Euro, UK and AUS (International Version)
- (1) Removable, Screw-Down Speaker Connector (accepts up to 14AWG wire, 4-pin or 6-pin depending on the model purchased)
- (1) Mounting Bracket
- (2) Mounting Screws – #8 1-1/4" (3.18 cm) Phillips
- (1) External IR Sensor with 3' cable
- (1) 3' (.91m) HDMI Cable
- (1) Remote Control
- (2) AA Alkaline Batteries
- (1) Owner's Manual

## **WHAT YOU NEED FOR THE INSTALLATION**

- Flat Mini-screwdriver for the speaker connectors
- #2 Philips Screwdriver for Wall-mounting (if desired)
- Wire Strippers

## INSTALLATION OPTIONS

The compact, low-profile design of the AVA-Series mini-AVRs allows them to be installed out of view, minimizing any intrusion into the customers' living space. There are several options available to choose from to meet any need. Please keep in mind that the AVA-Series mini-AVRs support Bluetooth Audio so that any audio content from a phone, tablet, or computer can be easily played. If planning on using the Bluetooth audio input, make sure to verify the Bluetooth functional range before finalizing a mounting location. Depending on the construction of the TV, wall-box, building materials, etc, the range of the internal Bluetooth receiver may be impacted.

### TABLE-TOP MOUNTING

The AVA-Series mini-AVRs may be installed on a table-top or shelf.

### WALL MOUNTING

The AVA-Series mini-AVRs may be mounted on any wall or other surface using the included wall-mount bracket. Make sure to use suitable wallanchors or secure the bracket to any wall stud.

### IN-WALL BOX MOUNTING

Many of today's TV accessories, including the AVA-Series mini-AVRs, are designed to be installed in in-wall mounting boxes hidden behind a television.

### IR SENSOR ACCESSIBILITY

The included external IR sensor has a 3' (91.4 cm) cable. Make sure to keep this in mind when locating the AVA-Series mini-AVA so that the IR sensor can be placed discreetly. The ideal location of the IR sensor is on the edge of the TV as the natural tendency of users is to point any remote control at the TV in the room. As with any IR sensor, keeping it out of direct sunlight is important.

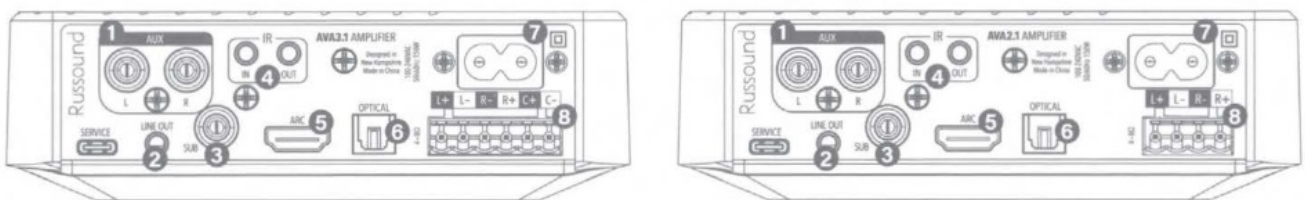

1. Aux Input – (Stereo RCA) Use this to connect any line-level audio source here
2. Line Out – (Stereo 3.5mm) Use this variable line-out connection to connect to an additional mini-AVR or other amplifier if desired
3. Sub Out – (Subwoofer RCA) Connect to a powered subwoofer to add extra bass
4. IR In/Out (Stereo, 3.5mm) Connect the included IA Sensor to “In”. An optional additional cable can be connected to the “Out” to pass along all received IR inputs to an additional device
5. HOM! ARC – Connect to a TV's HDMI ARC or eARC connection. The ARC connection on the TV is required in

order to allow for CEC control of the AVA-Series mini-AVR's power status and volume control functions.

6. Optical Input – Use this connection to add any compatible digital audio source
7. Power Connection – Connect the power cord here
8. Loudspeaker Connections – Removable, screw-down connector – Connect your loudspeakers here (4-pin for the AVA2.1 and 6-pin for the AVA3.1)

## USING THE MINI-AVA

### CONNECTING LOUDSPEAKERS

**Note:** All wiring connections must be made with the system powered off and the power cord disconnected from the electrical mains (unplugged from the wall outlet). The AVA-Series mini-AVA is stable to 4 ohms.

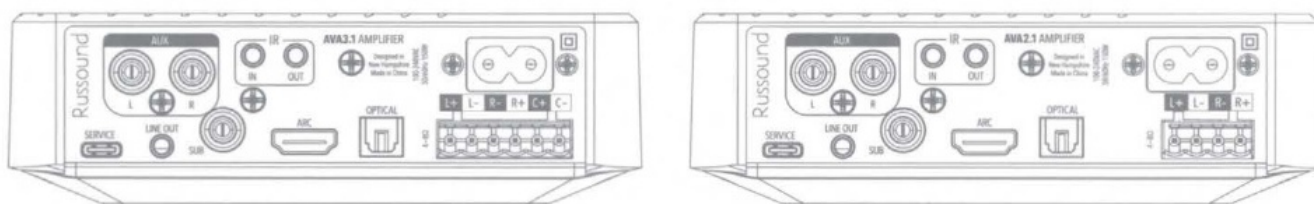

Loudspeakers should always connect directly to the AVA-Series mini-AVR. CL2-rated wire, or any specific wire specifications required by local electrical codes must be used when running wire within a home's walls. The loudspeaker connectors are designed to use up to 14ga wire. When connecting the loudspeaker wires, be sure to observe proper polarity. The positive and negative terminals on the AVA-Series mini-AVA must correspond with the positive and negative terminals at both the left and right loudspeakers.

Strip 1/8" (about 3mm) from each of the conductors for both the left and right loudspeaker connections and insert them into the removable screw-down terminal, again making sure to match the proper polarity of each connection. Tighten the screw-down connections securely and make sure that there are no exposed strands that might cause a short circuit. For the AVA-3.1, connect the center-channel loudspeaker the same way, matching the polarity at both ends of the wiring connection.

### CONNECTING AUDIO SOURCES

There are four available inputs on your Russound AVA-Series mini-AVA:

- HDMI
- Line In (Aux)
- Digital Optical
- Bluetooth

### HDMI – CONNECTING A TV OR OTHER HDMI AUDIO SOURCE

Connect the HDMI cable to the HDMI Port on the TV labeled HDMI (ARC or eARC) and to the rear HDMI port of your AVA-Series mini-AVR labeled "ARC". It is very important that you connect to the ARC or eARC HDMI connection on the TV. This enables the audio output of the TV through the HDMI connection and enables CEC control between the TV and the AVA-Series mini-AVR so that the TV remote control can control the mini-AVR without the need for any programming.

### TV SETTINGS

Most televisions will require changing a settings menu to disable their internal speakers and enable the audio output through the HDMI ARC port of the television. Some may even require adjustments to the HDMI control to enable CEC operation. Please refer to the television owner's manual for those settings. For any HDMI ARC-enabled product like the advanced AVA-Series mini-AVR, you'll need to make sure that these settings are configured on the connected television:

## **AUDIO OUTPUT**

Make sure the TV's Audio Output is configured for the HDMI ARC or eARC port that is connected to the amplifier

## **TV SPEAKERS DISABLED**

Do not use an "Automatic" setting if you want to use audio sources other than ARC when connected to your TV or your TV's internal speakers may turn on when not desired.

## **CEC CONTROL ENABLED**



Most TVs will have CEC control enabled by default. Using CEC is recommended in order to allow your TV remote to control the AVA-Series amplifier.

## **AUX**

Connect any audio source to the stereo RCA AUX input on the rear of your AVA-Series mini-AVR. The connected source may be selected by using the included remote control and pressing the input selection button on the top right of the remote control until you hear the desired source.

## **USING THE MINI-AVR**

### **DIGITAL OPTICAL IN**

Connect any digital audio source to the digital optical input on the rear of your AVA-Series mini-AVA. The connected source may be selected by using the included remote control and pressing the input selection button on the top right of the remote control until you hear the desired source.

## **USING BLUETOOTH**

Before using Bluetooth, your phone, tablet, or computer must be paired with your AVA-Series mini-AVA. Pairing may be done by selecting the Pair button on the remote control until the front panel LED on your AVA-Series mini-AVR begins blinking blue. While blinking, the amplifier is in pairing mode and can be found by searching for AVA3.1 or AVA2.1 from your phone, tablet, or computer.

Once connected, you can use your phone's volume control to go from zero up to the current maximum volume of the AVA-Series mini-AVR. We recommend setting your phone to its highest volume and then adjusting the AVA-Series mini-AVR to the maximum desired level so that you can then easily control the volume using your phone's volume control.

Once your phone has been paired, you can connect and send audio to your AVA-Series mini-AVR at any time by selecting "Bluetooth" as the active source using the AVA remote control.

## **POWER CONNECTION**

Once the source and loudspeaker connections have been made you can connect the power cable to the rear of the mini-AVA.

## **USING THE REMOTE CONTROL**

To use the included remote control, make sure to connect the included IR sensor to the "IR In" connection on the rear of the AVA-Series mini-AVR. All infrared commands are received through this sensor.

## **FUNCTIONS AVAILABLE:**

- Volume +/-/Mute
- Direct Input Select (Bluetooth, ARC (HDMI), Digital Optical (OPT), Line In (Aux))
- Audio Adjustments – Bass +/-, Treble +/-, Mega Bass On/Off, Movie
- Mode, Music Mode, Voice Mode (to enhance dialog)
- Bluetooth Pairing Mode Activation (Pair)
- Play/Pause
- Skip Track Forward/Back
- Amplifier Power

## **TV CONTROL BUTTONS**

If using the HDMI ARC input, there should be no need to use the TV infrared commands from the remote control, but they are available for use when connecting a TV to the amplifier's digital or Line In input connection. The included remote control is a multi-function learning remote control. The top section of the remote control is designed to learn several of the most important TV commands from your TV remote.

To do this, press and hold the "Set" button in the top right of the remote control until the light turns a solid bright red.

With the red light illuminated, press the button on the top of the remote that you would like to teach, for example the TV Input "TV In" button. The red Set button LED will blink fast, indicating it is ready to learn the IR command. Place your TV remote end to end with the Russound AVA remote control so that the front of both remote controls

are within 1" (2.54 cm) of each other. Press the button that you want to teach, in our example, the TV Input button on your TV remote control until the red SET LED becomes solid again. You may continue to teach other commands in any order by pressing the next button you wish to teach on the top section of the AVA remote control until the red Set button LED blinks fast, indicating it is ready to learn the IR command for that button and continuing the process, button by button.

## USING THE MINI-AVR

When you have taught all commands, press the Set button one more time until the LED turns off. Verify the correct programming by testing all of the learned buttons with your TV. You can repeat the above steps to re-learn any particular button as needed.

## FRONT PANEL LED STATUS

The front panel LED will indicate the status of the AVA mini-AVA as indicated in this table.

### LED COLOR

LED COLOR	SELECTED SOURCE
White	ARC (HDMI) input is selected
Green	Optical input is selected
Blue	Bluetooth input is selected
Cyan	Analog input is selected

LED	STATUS
3 Blinks	IR command received
Fast Blink	Volume has reached maximum or minimum setting
Slow Blink	Audio is muted
Blue (Blinking)	Bluetooth pairing mode is active
Red (Solid)	Standby mode

## AUDIO DSP ADJUSTMENTS USING THE REMOTE CONTROL

### MEGA BASS

This setting is recommended when there is no dedicated subwoofer. Pressing this button toggles an increase in the bass levels by approximately 10% from 50-100Hz.

### BASS+/-

This is a broad bass change across the range of 80Hz to 500Hz by approximately 1% for every button press, up to 10. When the limit is reached in either direction, the front panel LED will blink quickly



## **TREBLE+/-**

This is a broad treble change across the range of 1kHz to 20kHz, by approximately 1% for every button press, up to 10. When the limit is reached in either direction, the front panel LED will blink quickly

## **RESET BUTTON**

This button will reset all audio settings back to factory defaults.

## **VOICE (DIALOG)**

This button will enable a high pass filter at 100Hz and a low pass filter at 12KHz to allow for more dialog detail and clarity. In this mode, you may also customize the bass and treble or enable Mega Bass as desired.

## **MOVIE**

This button will enable a high pass filter at 35Hz, and a Box EQ at 240Hz (-4dB) and 860Hz (-3dB) to allow for dynamic response in movies and films. In this mode, you may also customize the bass and treble or enable Mega Bass as desired. Movie mode is the default acoustic mode of the AVA-Series amplifier.

## **USING THE MINI-AVR**

### **MUSIC**

This button will remove audio filters so that the EQ is flat from 20Hz to 20kHz for clear, uncluttered detail in all musical genres. In this mode, you may also customize the bass and treble or enable Mega Bass as desired.

**Note:** All changes to the audio settings will reset to defaults if the AVA is disconnected from AC power.

## **BLUETOOTH MOBILE AUDIO & VIDEO SETUP**

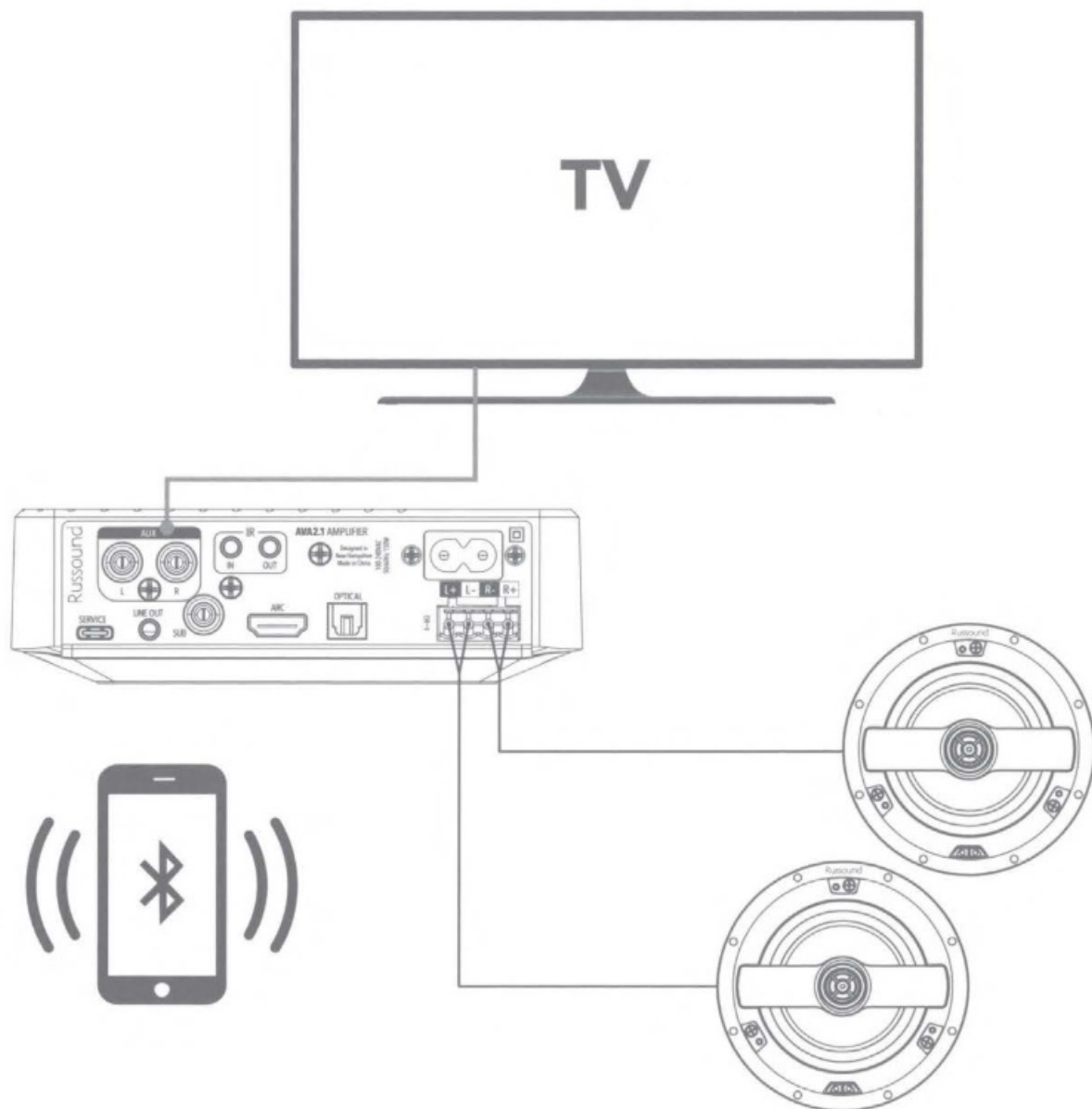





Issue	Troubleshooting Steps
<b>No audio output</b>	Verify that the amplifier is on, the power cable is connected to a working outlet and the front panel Status LED is illuminated
	Verify that the correct audio input has been selected with the included remote control
	Verify that all audio source cables are properly connected to the appropriate input
	Verify that the unit is not in a poorly ventilated area where an overheating condition could occur. The safety features of the AVA will turn off or reduce the audio output when temperature limits are exceeded
	Verify that the audio source cables are not defective by swapping them with known good cables
	Verify speaker wiring connections are tight and with no stray conductors

Reset the unit by disconnecting power for 2 minutes and then reconnecting power to resolve any other issues.

## SPECIFICATIONS

Model	AVA2.1	AVA3.1
Number of Channels	2.1	3.1
Power Output - 4 ohm	50W /Channel, 1kHz	50W /Channel, 1kHz
Power Output - 8 ohm	25W /Channel, 1kHz	25W /Channel, 1kHz
Freq Response	20Hz to 20kHz +/-3dB at 1W output into 4 or 8 Ohms	20Hz to 20kHz +/-3dB at 1W output into 4 or 8 Ohms
Input Sensitivity	1000mV for 50W at 1kHz, 4 Ohm	1000mV for 50W at 1kHz, 4 Ohm
Input Impedance	>22k ohms Line Input	>22k ohms Line Input
Signal to Noise Ratio , 4Ω	>94dB A-weighted	>93dB A-weighted
Signal to Noise Ratio , 8Ω	>96dB A-weighted	>97dB A-weighted
Inputs	HDMI (ARC), Line In (RCA), Optical, Bluetooth	HDMI (ARC), Line In (RCA), Optical, Bluetooth
Bluetooth Version	5.0	5.0
Bluetooth Range	Up to 100 feet (30m)	Up to 100 feet (30m)
Remote Control	Included	Included
IR Input/Output	3.5mm	3.5mm
IR Sensor Included	Yes	Yes
Speaker Connectors	Detachable Screw-down, up to 14AWG	Detachable Screw-down, up to 14AWG
Line Out	3.5mm Stereo	3.5mm Stereo
Subwoofer Out	RCA	RCA
Operating Temperature	32°F to 104°F (0°C to 40°C)	32°F to 104°F (0°C to 40°C)
Altitude	0 to 9,843' (3,000m)	0 to 9,843' (3,000m)
Power Requirements - North American Model	100-120VAC, 60Hz (150W Max)	100-120VAC, 60Hz (150W Max)
Power Requirements - International Model (-i)	220-240VAC, 50Hz (150W Max)	220-240VAC, 50Hz (150W Max)



	<b>WARNING:</b> TO REDUCE THE RISK OF FIRE OR ELECTRIC SHOCK, DO NOT EXPOSE THIS APPLIANCE TO RAIN OR MOISTURE.
	<b>CAUTION:</b> TO REDUCE THE RISK OF ELECTRIC SHOCK, DO NOT REMOVE THE COVER. NO USER-SERVICEABLE PARTS INSIDE. REFER SERVICING TO QUALIFIED PERSONNEL.
	The lightning flash with arrowhead symbol, within an equilateral triangle, is intended to alert the user to the presence of uninsulated dangerous voltage within the product's enclosure that may be of sufficient magnitude to constitute a risk of electric shock to persons.
	The exclamation point within an equilateral triangle is intended to alert the user to the presence of important operating and maintenance (servicing) instructions in the literature accompanying the appliance.

1. Read Instructions – All the safety and operating instructions should be read before the appliance is operated.
2. Retain Instructions – The safety and operating instructions should be retained for future reference.
3. Heed Warnings – All warnings on the appliance in the operating instructions should be adhered to.
4. Follow Instructions – All operating and user instructions should be followed.
5. Water and Moisture – The appliance should not be used near water; for example, near a bathtub, washbowl, kitchen sink, laundry tub, in a wet basement, or near a swimming pool. The apparatus shall not be exposed to dripping or splashing liquids and no objects filled with liquids, such as vases, shall be placed on the apparatus. Do not touch the appliance with wet hands. Do not handle the appliance or power cord with wet or damp hands. If water or any other liquid enters the appliance cabinet, take it to qualified service personnel for inspection.
6. Cleaning – The appliance should be cleaned only as recommended by the manufacturer. From time to time you should wipe off the front and side panels and the cabinet with a soft cloth. Do not use rough material, thinners, alcohol or other chemical solvents or cloths since this may damage the finish or remove the panel lettering.
7. Ventilation – The appliance should be situated so that its location or position does not interfere with its proper ventilation. For example, the appliance should not be situated on a bed, sofa, rug, or similar surface that may block the ventilation openings, or placed in a built-in installation, such as a bookcase or cabinet that may impede the flow of air through the ventilation openings. Place the unit in a well-ventilated location, leaving at least 2 inches (5 cm) of clearance on all sides, top and rear of unit for air flow. If ventilation is blocked, the unit may overheat and malfunction.
8. Heat – The appliance should be situated away from heat sources such as radiators, heat registers, stoves, or other appliances (including mini-AVRs) that produce heat.
9. Grounding or Polarization – Precaution should be taken so that the grounding or polarization means of an appliance is not defeated.
10. Power Cord Protection – Power supply cords should be routed so that they are not likely to be walked on or pinched by items placed upon or against them, paying particular attention to cords at plugs, receptacles, and

the point where they exit from the appliance.

11. **Power Sources** – The appliance should be connected to a power supply only of the type described in the operating instructions or as marked on the appliance.
12. **Main Power Disconnect** – The main power plug is used as the disconnect device and shall remain readily operable. When installing the product, ensure that the plug is easily accessible.
13. **Non-Use Periods** – The power cord of the appliance should be unplugged from the outlet when left unused for a long period of time.
14. **Attachments** – Only use attachments/accessories specified by the manufacturer.
15. **Location of the Mini-AVR** – Do not mount this unit under a kitchen cabinet. Do not expose the mini-AVR to direct sunlight or heating units as the mini-AVA internal components' temperature may rise and shorten the life of the components.
16. **Avoid damp and dusty places.**
17. **Object and Liquid Entry** – Care should be taken so that objects do not fall and liquids are not spilled into the enclosure through the openings.
18. **Servicing** – The user should not attempt to service the appliance beyond that described in the operating instructions. All other servicing should be referred to qualified service personnel.
19. **Damage Requiring Service** – The appliance should be serviced by qualified service personnel when: A. The power supply cord or the plug has been damaged; B. Objects have fallen, liquid has been spilled into the appliance; C. The appliance has been exposed to rain; or D. The appliance does not appear to operate normally; or E. The appliance has been dropped or the enclosure is damaged.

## LIMITED WARRANTY

The Russound AVA2.1 and AVA3.1 are guaranteed for two (2) years from the date of purchase against all defects in materials and workmanship. During this period Russound will replace any defective parts and correct any defect in workmanship without charge for either parts or labor. For this warranty to apply, the unit must be installed and used according to its written instructions. If service is necessary, it must be performed by Russound. Russound assumes no responsibility for defects resulting from abuse or servicing performed by an agency or person not specifically authorized in writing by Russound. Damage to or destruction of components due to improper use voids the warranty. In these cases, the repair will be made at the owner's expense. Accidental damage and shipping damage are not considered defects under the terms of the warranty. To return for repairs, the unit must be shipped to a repair facility designated by Russound at the owner's expense, along with a Return Authorization number and documentation explaining the nature of the service required. Any product returned without prior written permission will be returned to sender. Russound sells products only through authorized Dealers and Distributors to ensure that customers obtain proper support and service. Any Russound product purchased from an unauthorized dealer or other source, including retailers, mail order sellers and online sellers will not be honored or serviced under existing Russound warranty policy. Any sale of products by an unauthorized source or other manner not authorized by Russound shall void the warranty on the applicable product.

## WARRANTY ADDRESS

Russound

- **Attn:** RA# (Insert your RA number here) 1955 Wehrle Dr Williamsville NY 14221
- **email:** [tech@russound.com](mailto:tech@russound.com)

©2023 Russound/FMP, Inc. All rights reserved.

All trademarks are the property of their respective owners. Specifications are subject to change without notice  
REV7

## AVA2.1 & AVA3.1 – Compact Hi-Fidelity Audio Amplifiers

The AVA2.1 and AVA3.1 mini audio receivers are designed for custom installation specialists and were designed based on their feedback. In addition to being highly flexible receivers that can be placed in nearly any imaginable space, both models include a fully integrated, highly efficient Class-D amplifier with digital inputs, 110-240V 50/60Hz universal power supply for installation nearly anywhere on the planet, built-in Bluetooth 5.0, ARC HDMI, dedicated subwoofer output with gain control, and an IR remote control and external receiver. The most important feature is the HDMI input allowing for instant use with any TV through HDMI's CEC functionality, eliminating the need to teach IR commands for volume control.

Both the AVA2.1 and AVA3.1 are ultra-compact (1.6" x 5.7" x 7.9") audio receivers designed for installation in nearly any space, no matter how compact

### What's in the Box

- AVA2.1 or AVA3.1
- Learning Remote
- Power Cord
- Wall-Mount Bracket
- Infrared Receiver with IR Receiver Eye
- Operation Guide



Fully integrated highly efficient Class-D amplifier with 50 watts per channel, optimized for high-quality audio performance.



Input for Audio Return Channel from TV HDMI Port eliminates the need for a set top box.



2.1 or 3.1 speaker/subwoofer output matches existing soundbars or speaker setups.



Analog and digital audio inputs provide flexibility in connecting additional audio sources.



Built-in Bluetooth 5.0 allows to listen to any content from a phone, tablet, or computer



Learning remotely conveniently controls AVA, TV, and connected audio sources.



Super compact size 1.6" x 5.7" x 7.9". Ideal for any small behind-the-TV box, on-TV, on wall, on-shelf, computer desktop, credenza, or similar locations

### **Mounting Options**



The compact, low-profile design of the AVA-Series amplifiers allows them to be installed out of view, minimizing any intrusion into the customers' living space. Please keep in mind that the AVA-Series amplifiers support Bluetooth Audio so that any audio content from a phone, tablet, or computer can be easily played.

### **Table-Top Mounting**

The AVA-Series amplifiers may be installed on a table-top or shelf.

### **Wall Mounting**

The AVA-Series amplifiers may be mounted on any wall or other surface using the included wall-mount bracket. Make sure to use suitable wall anchors or secure the bracket to any wall stud.

### **In-Wall Box Mounting**

Many of today's TV accessories, including the AVA- Series amplifiers, are designed to be installed in in-wall mounting boxes hidden behind a television.

### **Application Example**



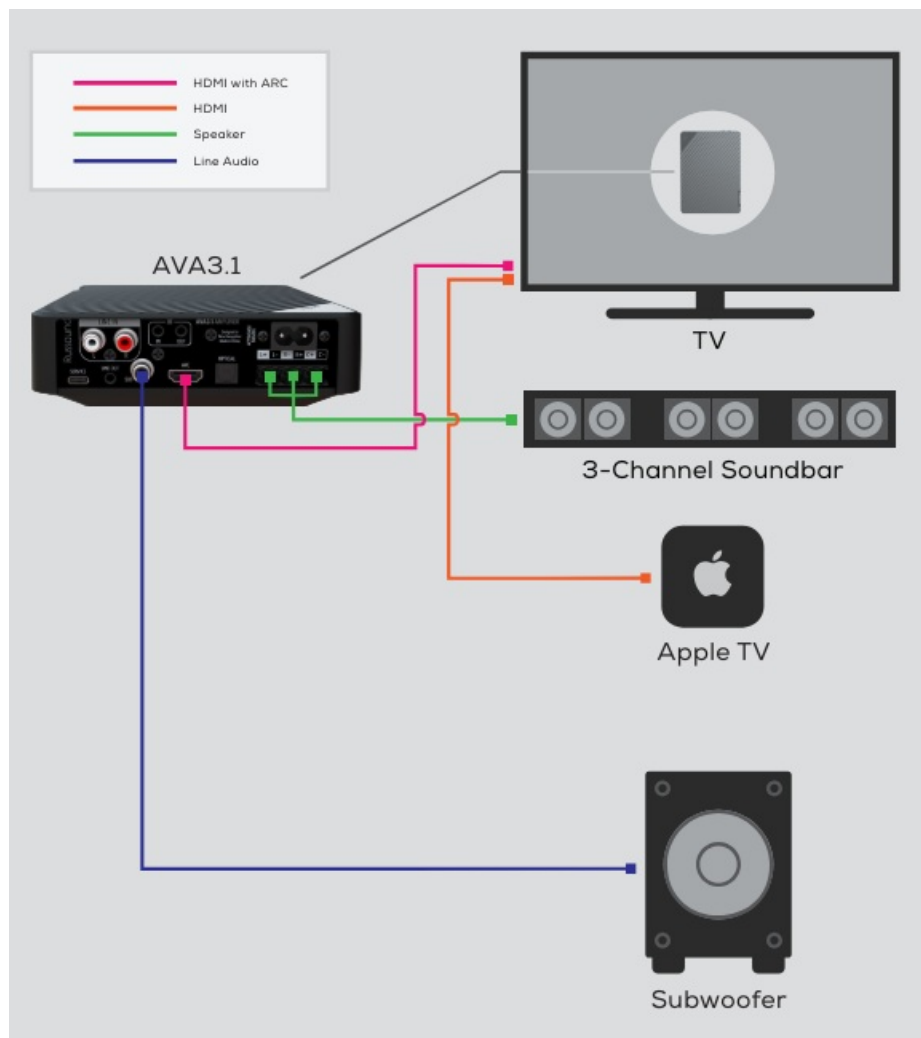

## Ports



1. HDMI with ARC (Audio Return Channel)
2. Optical Audio Input
3. Line Audio Input
4. Speaker Output
  - **AVR2.1:** 2 Channels (Left, Right)
  - **AVR3.1:** 3 Channels (Left, Right, Center)
5. Subwoofer Output
6. Line Audio Output
7. Infrared In and Out for use with the included IR Receiver with IR Receiver Eye
8. Power Input 110-240V 50/60Hz
9. USB-C for firmware updates

## **Specifications**

	AVA2.1	AVA3.1
Number of Channels	2.1	3.1
Power Output - 4Ω	50W /Channel, 1kHz	50W /Channel, 1kHz
Power Output - 8Ω	25W /Channel, 1kHz	25W /Channel, 1kHz
Freq Response	20Hz to 20kHz +/-3dB at 1W output into 4 or 8 Ohms	20Hz to 20kHz +/-3dB at 1W output into 4 or 8 Ohms
Input Sensitivity (8Ω)	620 mV for 80W @ 1kHz	1000 mV for 45W @ 1kHz
Input Impedance	>22k ohms Line Input	>22k ohms Line Input
Signal to Noise Ratio , 4Ω	>94dB A-weighted	>93dB A-weighted
Signal to Noise Ratio , 8Ω	>96dB A-weighted	>97dB A-weighted
Inputs	HDMI (ARC), Line In (RCA), Optical, Bluetooth	HDMI (ARC), Line In (RCA), Optical, Bluetooth
Bluetooth	5	5
Bluetooth Range	Up to 100 feet (30m)	Up to 100 feet (30m)
Remote Control	Included	Included
IR Input/Output	3.5mm	3.5mm
IR Sensor Included	Yes	Yes
Speaker Connectors	Detachable Screw-down, up to 14AWG	Detachable Screw-down, up to 14AWG
Line Out	3.5mm Stereo	3.5mm Stereo
Subwoofer Out	RCA	RCA
Operating Temperature	32°F to 104°F (0°C to 40°C)	32°F to 104°F (0°C to 40°C)
Altitude	0 to 9,843' (3,000m)	0 to 9,843' (3,000m)
Power Requirements - North American Model	115-120VAC, 60Hz (150W Max)	115-120VAC, 60Hz (150W Max)
Power Requirements - International Model (-i)	220-240VAC, 50Hz (150W Max)	220-240VAC, 50Hz (150W Max)
Power Connector	IEC C8	IEC C8
Standby Power Consumption	0.45W	0.45W
Product Dimensions	5.8" (W) x 1.4" (H) x 7.9" (D) (14.7 x 3.7 x 20.2 cm)	5.8" (W) x 1.4" (H) x 7.9" (D) (14.7 x 3.7 x 20.2 cm)
Product Weight	1.5 lbs (0.7 kg)	1.5 lbs (0.7 kg)
Shipping Dimensions	10.7" (W) x 3.3" (H) x 12.7" (D) (27.2 x 8.3 x 32.2 cm)	10.7" (W) x 3.3" (H) x 12.7" (D) (27.2 x 8.3 x 32.2 cm)
Shipping Weight	2.4 lbs (1.1 kg)	2.4 lbs (1.1 kg)
Limited Warranty	2 Years	2 Years

## RCI Program



- Prevents unauthorized internet reselling
- Units ship in lock-down mode
- Russound Certified Installer credentials required to activate and install
- Installers must accept the agreement that they will not resell online
- Featured on all new MCA-Series Controllers and MBX-Series Products

## Integrator Support



- Dealer Locator on our site so end users can find knowledgeable dealers
- RCI Products sold through distribution, not direct
- Profitable margins
- Training webinars and tech tip videos
- Surveys & outreach to identify customers' needs

## Dealer Website

- The tool kit every partner needs. All in one place!
- Password-protected, dealer-only information available
- Current Promos & Dealer Price Sheet
- Training & Tech Tips including alerts when new YouTube videos are posted
- Recent Email Blast Announcements
- Dealer Version of Product Pages
  - Firmware Updates
  - Training Files

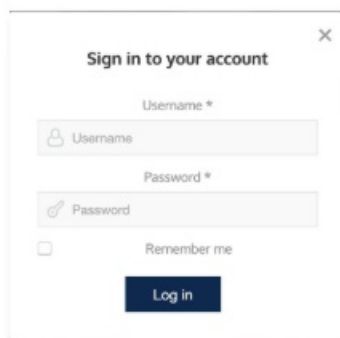

Sign in to your account

Username \*

Username

Password \*

Password

☐ Remember me

Log in

## Online Training Modules

- The training modules on our site are intended for users and prospective users to develop a basic understanding of Russound's products, functionality and operation.
  - **Available Modules:** MIXAMP-60 and VoicePlay



## Russound

- 200 International Drive, Suite 155 Portsmouth, NH 03801
- 603.659.5170
- [www.russound.com](http://www.russound.com)

---

## Documents / Resources

 <p>AVA-SERIES MINI-AVR 2007 &amp; 2008 Copyright Russound Inc. 0100 INSTALLATION GUIDE</p>	<p><a href="#">Russound AVA Series MINI-AVA Low Profile Mini AVR with HDMI</a> [pdf] Installation Guide AVA2.11, AVA3.11, AVA Series MINI-AVA Low Profile Mini-AVR with HDMI, MINI-AVA Low Profile Mini-AVR with HDMI, Low Profile Mini-AVR with HDMI, Mini-AVR with HDMI</p>
--	---

## References

- [Russound - Home](#)
- [User Manual](#)

### Manuals+, Privacy Policy

This website is an independent publication and is neither affiliated with nor endorsed by any of the trademark owners. The "Bluetooth®" word mark and logos are registered trademarks owned by Bluetooth SIG, Inc. The "Wi-Fi®" word mark and logos are registered trademarks owned by the Wi-Fi Alliance. Any use of these marks on this website does not imply any affiliation with or endorsement.