

**Ruko**<sup>®</sup>

**F11GIM  
Drone**

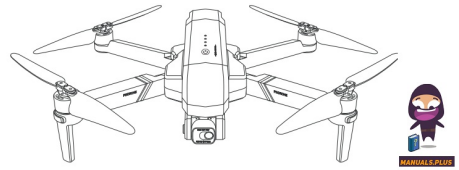

## Ruko F11GIM Drone User Guide

[Home](#) » [Ruko](#) » Ruko F11GIM Drone User Guide 

### Contents

- 1 Ruko F11GIM Drone
- 2 Product Usage Instructions
- 3 7. Calibration and Pre-flight Checks:
- 4 Take Off
  - 4.1 Common Problems and Solutions
  - 4.2 FAQ
- 5 Documents / Resources
  - 5.1 References
- 6 Related Posts

**Ruko**<sup>®</sup>

### Ruko F11GIM Drone

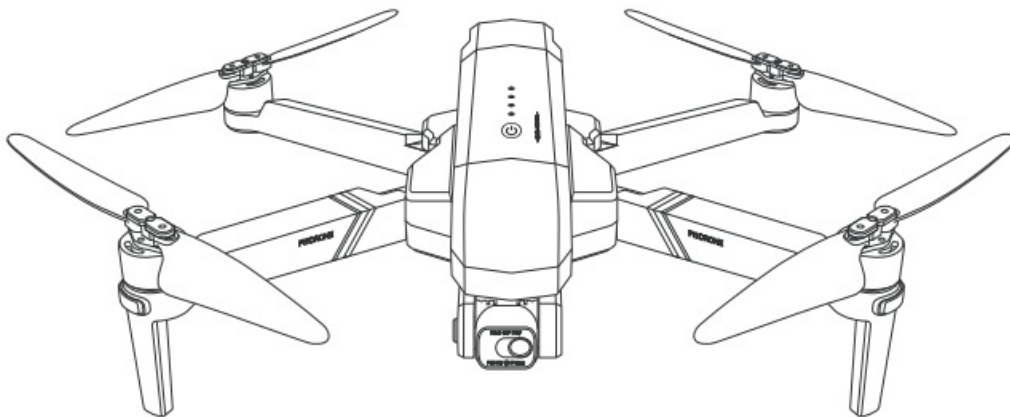

### Specifications

- Age Recommendation: 14+
- Version: v2.0

## Product Information

The RUKO DRONE is a high-performance drone designed for users aged 14 and above. It features advanced functionalities and a user-friendly design to provide an exciting flying experience.

## Product Usage Instructions

### Download App

Download the RUKO DRONE app from the App Store for iOS devices or the Google Play Store for Android devices.



### Charge the Batteries:

Ensure the drone batteries are fully charged before use.

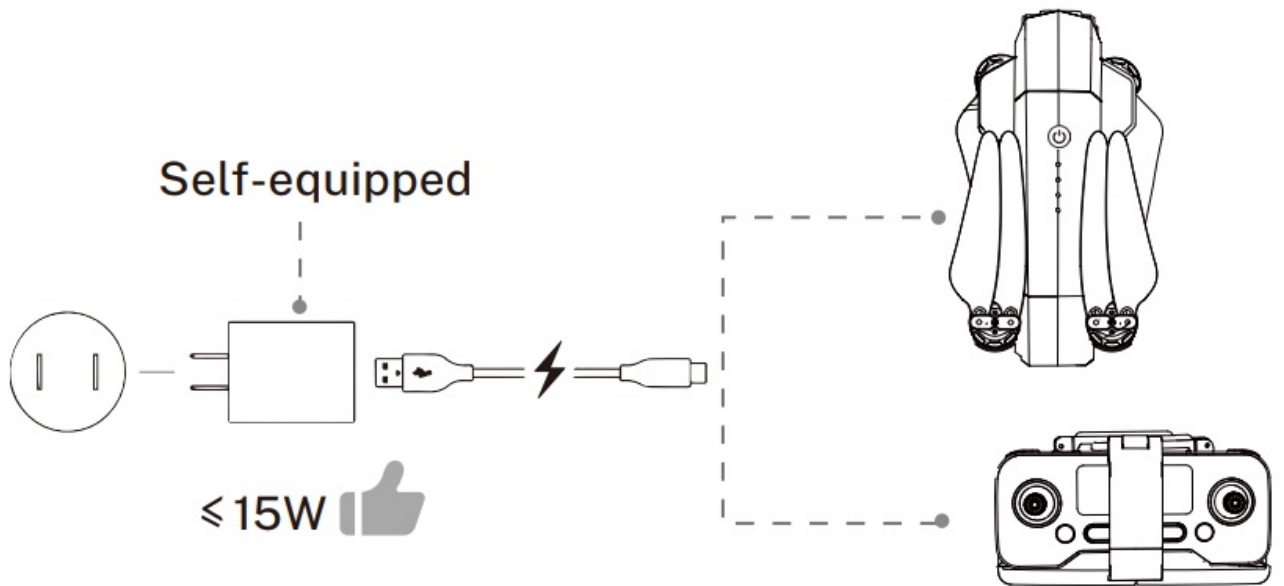

**Setup:**

1. Lift and pull to unfold the drone.
2. Unfold the antenna and handle.

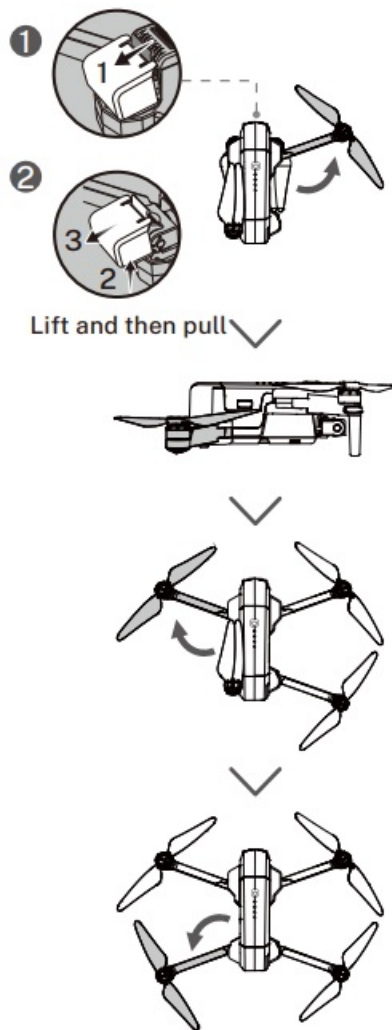

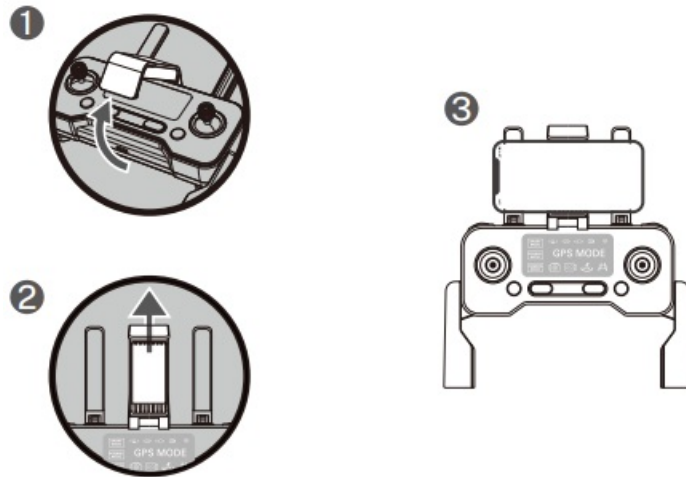
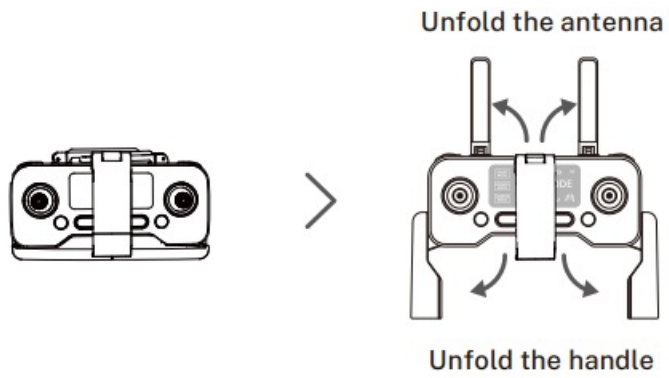

### Select an Open Flight Area

Choose a clear, open area for safe flight.

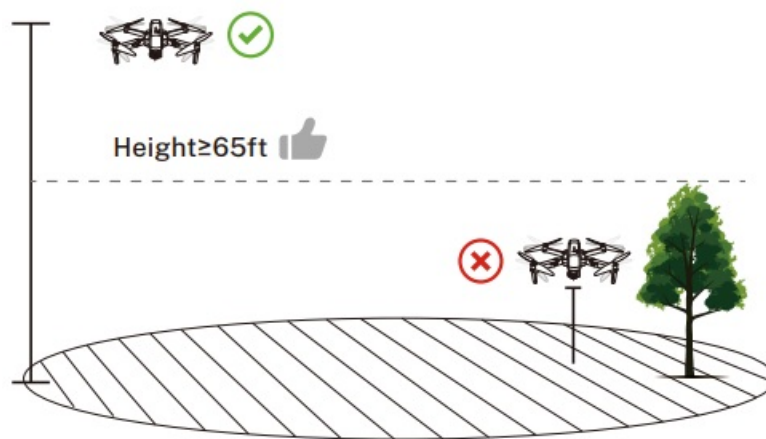

## Power On

1. Press and hold the button on the drone until it plays the startup sound.
2. Short-press to power on the transmitter after turning on the drone.

1

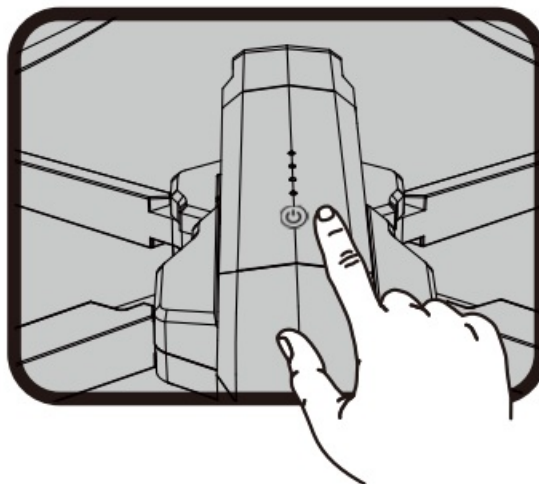

2

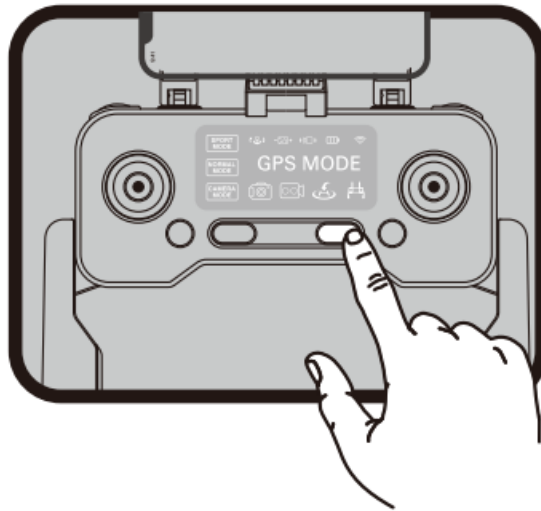

**Note:** Please turn on the Aircraft firstly, then the Transmitter. Otherwise, they will not be paired.

### Connect to Wi-Fi

Connect your mobile device to the drone's Wi-Fi and enter the app operation page for further instructions.

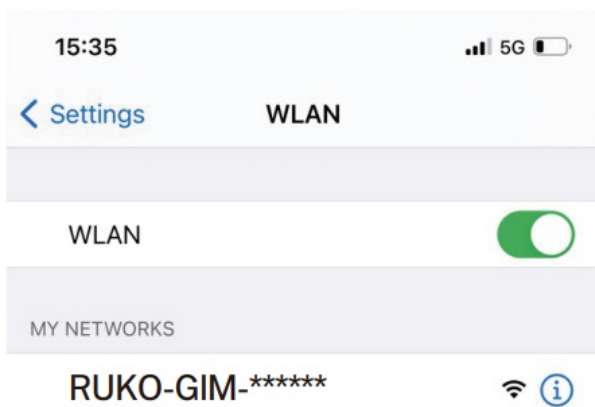

Tap "CONTROLS" icon

### 7. Calibration and Pre-flight Checks:

- Calibrate the compass and gyroscope as per the instructions provided.
- Ensure GPS signal is strong before takeoff.

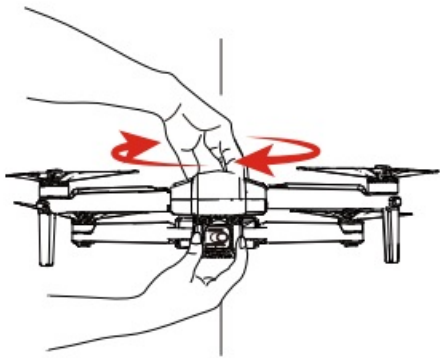

- Rotate the aircraft horizontally 360°. ( About 1-2 turns )

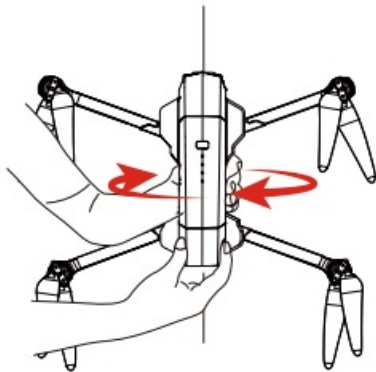

- Rotate the aircraft vertically 360°. ( About 1-2 turns )

### Calibrate the Gyroscope

Push joysticks to 11 & 1 o'clock position. ( About 2 seconds )

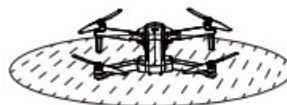

A level ground

### Gimbal Self-inspection

Put on a level surface. ( About 20 seconds )

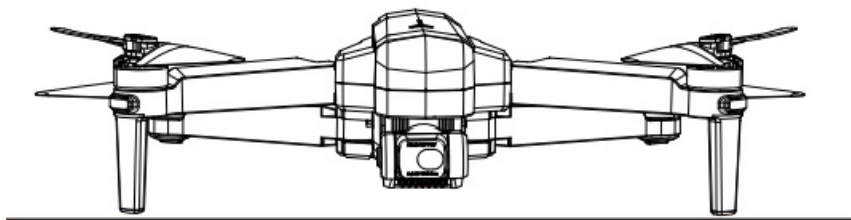

### Search for GPS Automatically



- ⚠ Tips: 1. The searching time depends on the flight environment.  
2. If unsuccessful, the motors can't be started.

### Start the Motors

Push joysticks to 5 & 7 o'clock position. ( About 2 seconds )

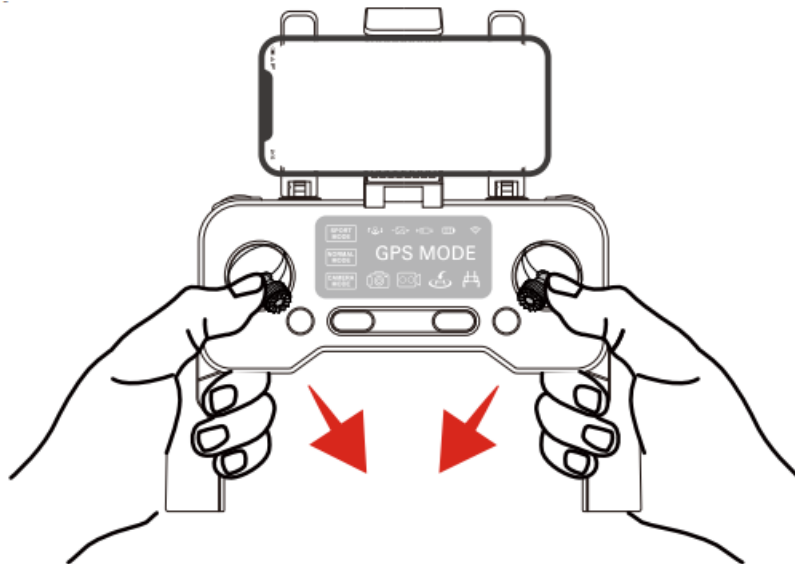

### Take Off

Push up the left stick to start the motors and lift off.

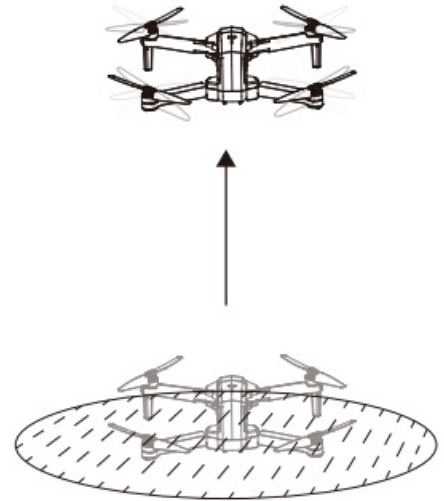
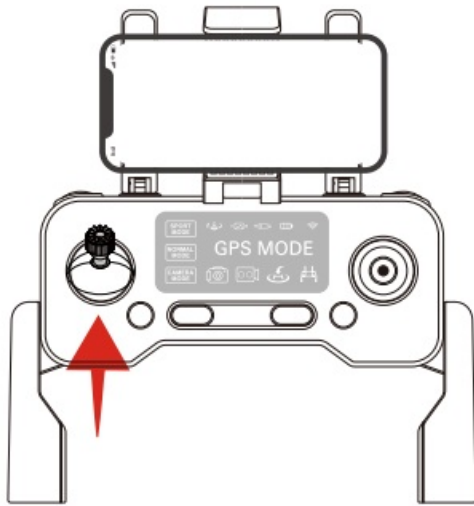

## Flight Guide and Support

Refer to the in-app flight guide for additional assistance. For technical support, contact RUKO via email or phone.

## NEW TO FLYING DRONES?



## CONTACT US FOR MORE TECH SUPPORT

[rukodrone@gmail.com](mailto:rukodrone@gmail.com)

+1 ( 949 ) 394 – 4635 ( Available from 6pm to 4am PDT)

## Common Problems and Solutions

Question	Reason	Solutions
The motors cannot be started	Weak GPS signal	Turn on the Aircraft in an open area with strong GPS signal
	The red light stays on	The Aircraft has low battery. Please charge the battery in time
	The pink light stays on	The compass is not calibrated. Please refer to the "Calibration Before Flight" section of the User Manual
	The left and right joystick are not in place	Push the left and right joysticks simultaneously to 5 o'clock and 7 o'clock for 2 seconds
Unstable flight	Flying too low, affected by Aircraft airflow	Please fly the Aircraft above 9.84ft(3 meters)
	The gyroscope is not calibrated	Place the Aircraft on a horizontal surface and conduct gyroscope/horizontal calibration. Please refer to the "Calibration Before Flight" section of the User Manual
	The propellers become deformed and incomplete	Replace the propellers with new ones
	GPS signal is unstable. Flying near buildings and in obstructed places	Please fly the Aircraft in an open area free of obstacles within the circle of radius 32.81 ft(10 meters)
Out of control, spinning around on its own, abnormal sound	The Transmitter signal is interfered or the Aircraft exceeds the range of remote control	Please fly the Aircraft outdoors without interference, and ensure that it is within a controllable range
	Compass interference	Please manually land the drone in time and calibrate the compass. Please make sure to fly away from the buildings, trees, power lines, and signal towers
	The propellers become deformed and incomplete	Replace the propellers with new ones
	When Fly from the grass, the gimbal touches the grass	Put the drone on landing pad or cardboard to prevent the gimbal from hitting with other objects

The Gimbal is not working	When fly from the wooden floor , vibration will be transmitted through the floor	Take off the drone from the place without vibrations
	The gimbal is interfered by external forces or the drone is picked up during self-inspection	Put the Aircraft on the level ground without touching. The gimbal will start to work after 40 seconds
	When turning on the drone on the desk, the desk will amplify the subtle vibrations into high-frequency vibrations	Turn on the drone on the place without vibrations
	The compass is in calibrating	Put the Aircraft on level ground after compass calibration. The gimbal will start to work after 20 seconds

Question	Reason	Solutions
Video freezes, image transmission distance is short	The Aircraft is out of Wi-Fi range	Fly the Aircraft within the range of the Wi-Fi
	WiFi image transmission signal interference	Fly the Aircraft in an unobstructed open area free of buildings, high-voltage wires and signal towers
	The transmitter and the mobile phone are not pointed at the direction of the drone	Point the Transmitter and the mobile device at the flying direction of the Aircraft to maintain the strongest signal connection
	Phone performance freezes	Close unused apps running in the background to maintain the best performance of the phone
Video is not clear	if use APP storage, the pixels are 1920×720P	Insert the memory card and store the video on the memory card
App does not display the interface	The phone is not connected to Wi-Fi	Connect your mobile device to the Wi-Fi : Ruko-GIM-*****
	The phone version is too low	Android 6.0 and above, IOS 10.02 and above
	When connecting to the drone's WiFi, the network is not set or set incorrectly	Set the Wi-Fi correctly
		Turn the phone to airplane mode
APP crashes or functions abnormally	VPN switch is turned on	Turn off the VPN switch
	Wrong app downloaded	Download the correct App
APP crashes or functions abnormally	A few mobile phone versions are old and incompatible with APP	Provide mobile phone version and model, we will adapt and solve it
	It is the first time to connect your phone to the Wi-Fi	Try connecting a few more times or restart the phone
The WiFi name is not displayed in the list	The phone is a single band	Use the dual band devices that support both 2.4 GHz and 5 GHz/5.8 GHz
	WiFi has not been activated	Wait for about 30 seconds after turning on the Aircraft and keep refreshing the Wi-Fi list while the Wi-Fi is activated
GPS signal is weak	Turning on the drone indoors	GPS signals cannot be found indoors. Please search for GPS signals in an open place outdoors
	Under the tree, next to the building, in an obstructed place	Please stay away from obstacles for more than 32.81 feet(10 meters), and search for GPS signals in an open area

Question	Reason	Solutions
Unable to return home, drifting and flying away	GPS signal was turned off during the flight	Please don't turn off GPS suddenly during outdoor flight. Switch back to GPS mode in time
App always says the Transmitter has low battery	The phone cannot connect to the Transmitter due to the wrong sequence for turning on the equipments	The correct sequence is: 1. Turn on the Aircraft firstly 2. turn on the Transmitter 3. Connect the WiFi
The Aircraft cannot be paired with the Transmitter	The wrong sequence for turning on the equipments	Correct pairing steps: 1. Turn on the Aircraft. 2. Turn on the Transmitter
Cannot charge battery/Cannot fully charge battery	Using inferior charger or charging on the computer with unstable voltage output	Use a mobile USB charger that ensures constant stable voltage output(5V) and amperage output(2-3A)
	Using inferior charging cables	Please use the original factory charging cable to charge
Short battery life	Flying in windy weather	Flying in windy weather will accelerate power loss
	Flying in cold weather	In low temperatures, the chemical reaction of the lithium battery is slowed down and the energy cannot be fully released
	The battery is not fully charged	Fully charged with the correct USB charger before flying
The product has slight marks	We tested all Aircraft before shipping	In order to give you the best experience, we tested functions of all Aircraft before shipping. Therefore, it is inevitable that there will be slight traces. However, it can be guaranteed that all Aircraft are 100% brand new

## FAQ

### Common Problems and Solutions:

**Issue: Motors cannot be started**

**Possible Reason: Weak GPS signal**

**Issue: Unstable flight**

**Possible Reason: Flying too low, affected by Aircraft airflow**

**Issue: Out of control, spinning around on its own, abnormal sound**

**Possible Reason: The Transmitter signal is interfered or the Aircraft exceeds the range of remote control**

**Issue: The Gimbal is not working**

**Possible Reason: The gimbal is interfered by external forces or the drone is picked up during self-inspection**

CONTACT US FOR MORE TECH SUPPORT  
8 +1 [888-892-0155](tel:888-892-0155) | Mon-Fri 7:00AM – 7:00PM (PST)

 +86 19129317359



rukotoy.com

Documents / Resources

	<p><a href="#">Ruko F11GIM Drone</a> [pdf] User Guide F11GIM Drone, F11GIM, Drone</p>
--	---

References

- [User Manual](#)

[Manuals](#), [Privacy Policy](#)

This website is an independent publication and is neither affiliated with nor endorsed by any of the trademark owners. The "Bluetooth®" word mark and logos are registered trademarks owned by Bluetooth SIG, Inc. The "Wi-Fi®" word mark and logos are registered trademarks owned by the Wi-Fi Alliance. Any use of these marks on this website does not imply any affiliation with or endorsement.