



Ruko F11 Pro Drone with Camera User Guide

[Home](#) » [Ruko](#) » Ruko F11 Pro Drone with Camera User Guide 

Ruko F11 Pro Drone with Camera User Guide

Quick Start Guide

v1.0

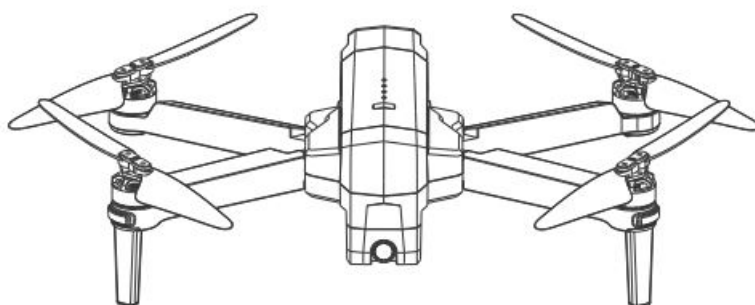

F11

Contents

- [1 Download App](#)
- [2 Charge the Batteries](#)
- [3 Select an Open Flight](#)
- [4 Pair the Transmitter with the Aircraft](#)
- [5 Connect to Wi-Fi](#)
- [6 Calibrate the Compass](#)
- [7 Calibrate the Gyroscope](#)
- [8 Search for GPS Automatically](#)
- [9 Start the Motors](#)
- [10 Take off](#)
- [11 Common Problems and Solutions](#)
- [12 Documents / Resources](#)
 - [12.1 References](#)
- [13 Related Posts](#)

Q Ruko Pro

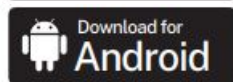

Ruko Pro App

http://www.vision-st.com/app/download/ruko_pro

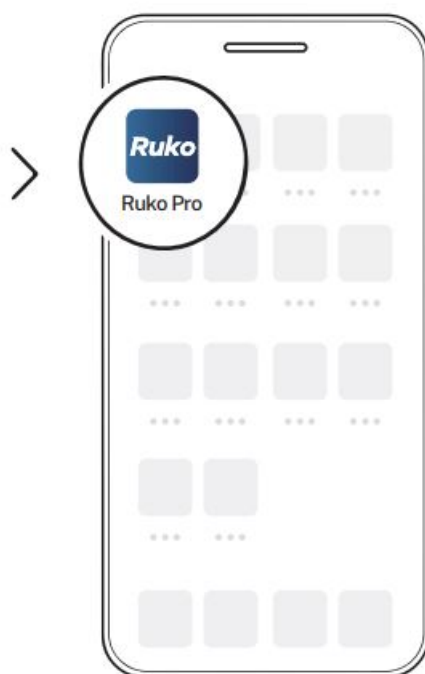

Charge the Batteries

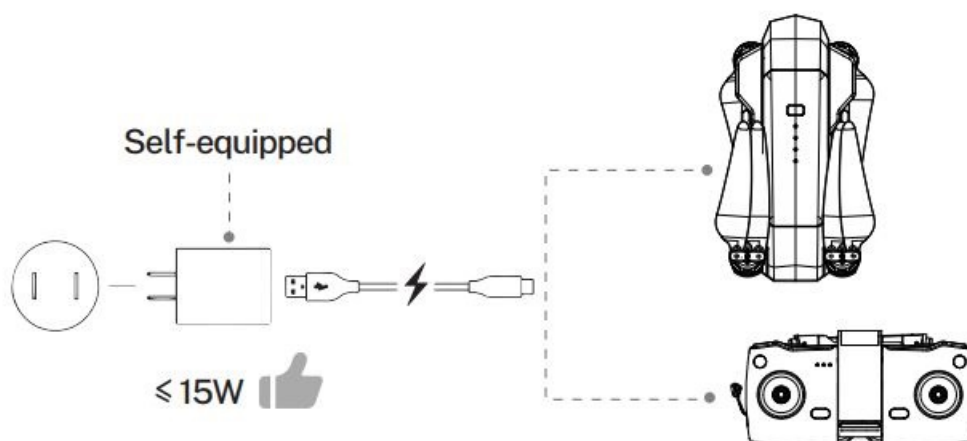

2

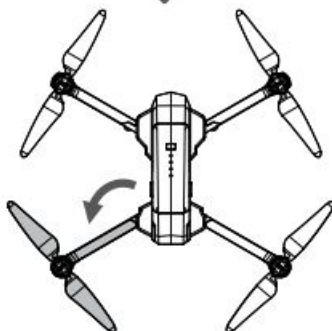
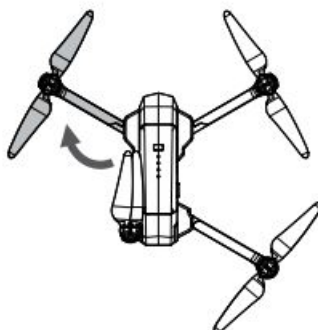
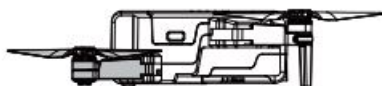
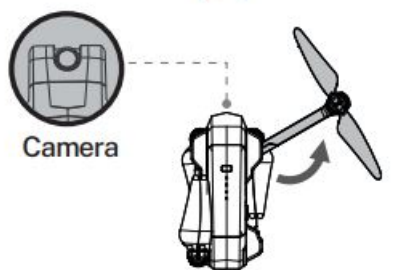

3

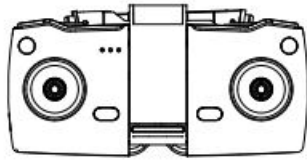

Unfold the antenna

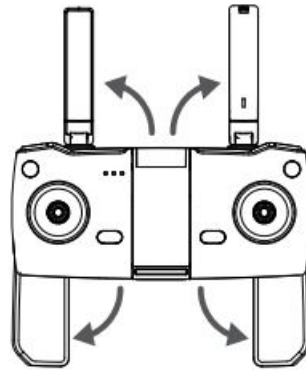

Unfold the handle

1

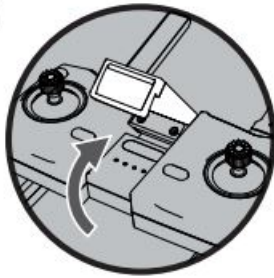

2



3

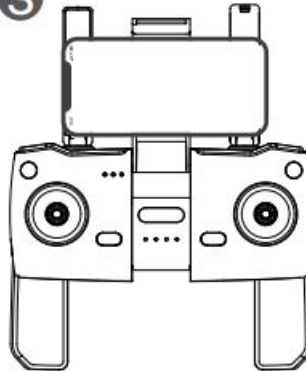

Select an Open Flight

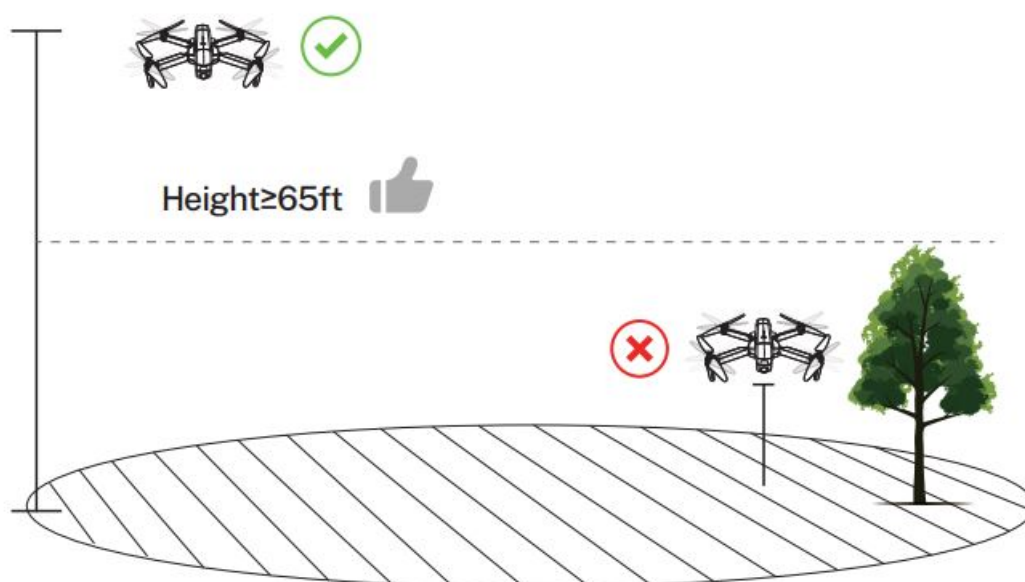

5

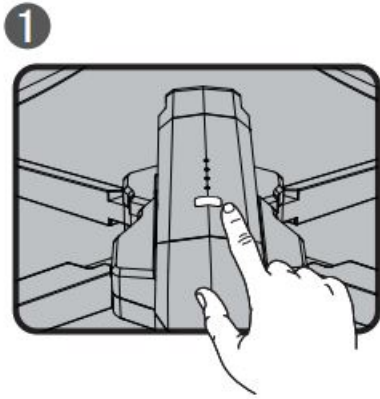

- Press and hold the button until the Aircraft plays startup sound.

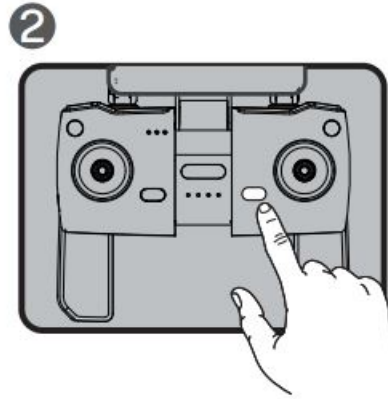

- Short-press to power on the Transmitter.

Pair the Transmitter with the Aircraft

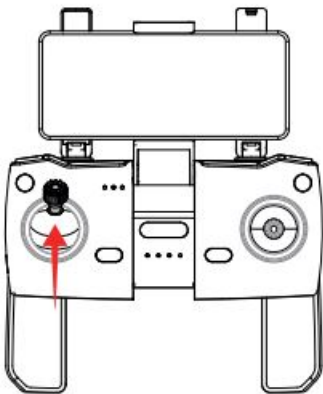

- Push up the left stick and the Transmitter plays a sound "di".

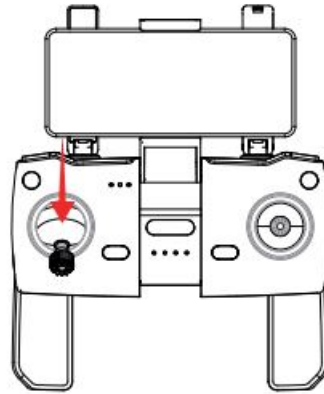

- Push down the left stick and the Transmitter plays another sound "di".

 Once successfully paired, white light will stay on.

Connect to Wi-Fi

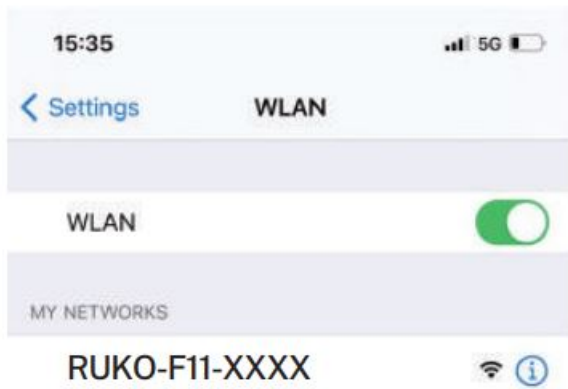

Tap "CONTROLS" icon

- Connect the mobile device to the Aircraft's Wi-Fi and enter the App operation page. Please refer to user manual (page 31) for more details.

Calibrate the Compass

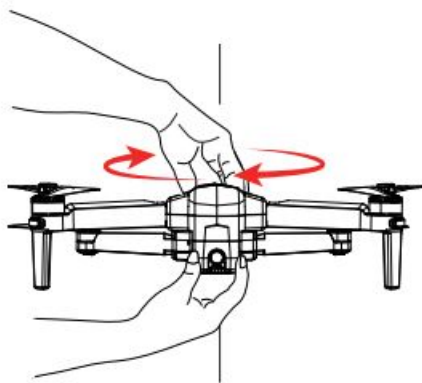

- Rotate the aircraft horizontally 360°.
(About 1-2 turns)

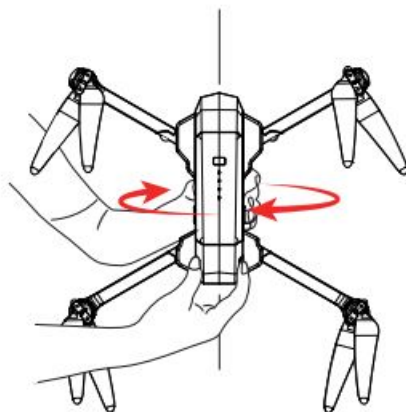

- Rotate the aircraft vertically 360°.
(About 1-2 turns)

Calibrate the Gyroscope

- Push joysticks to 11 & 1 o'clock position.
(About 2 seconds)

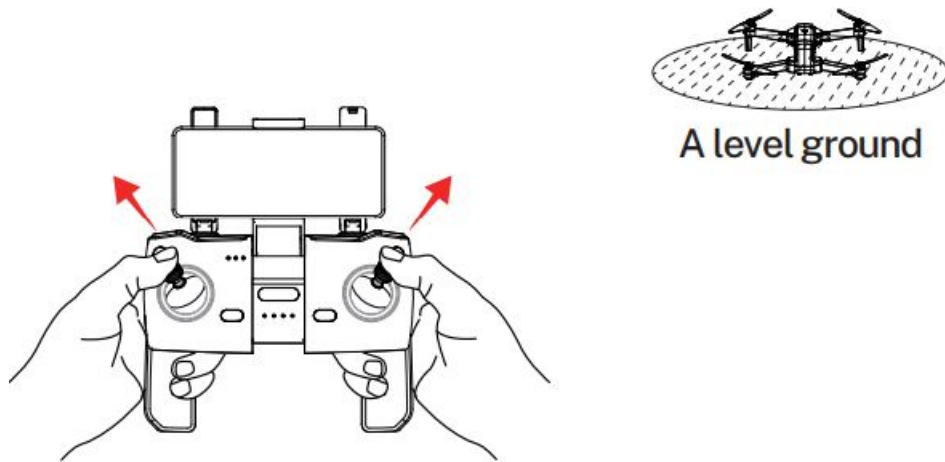

Search for GPS Automatically

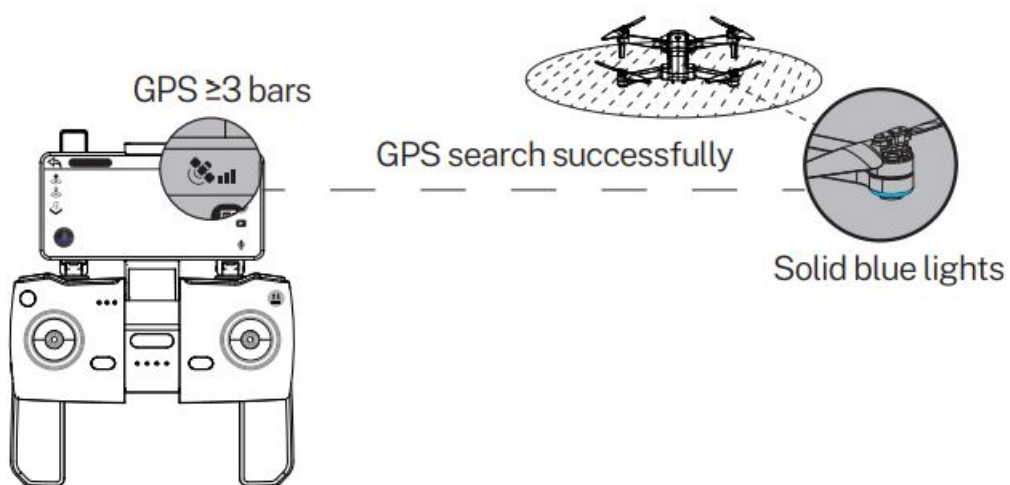

⚠ Tips:

1. The searching time depends on the flight environment.
2. If unsuccessful, the motors can't be started.

Start the Motors

- Push joysticks to 5 & 7 o'clock position.
(About 2 seconds)

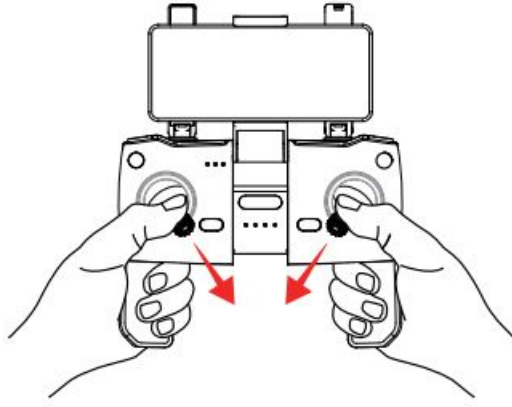

Take off

- Push up the left stick or press the “Auto Takeoff” button.

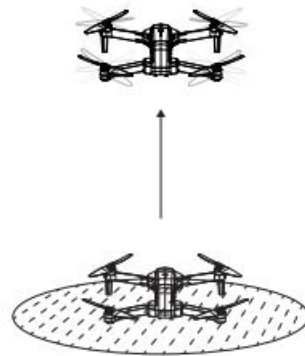
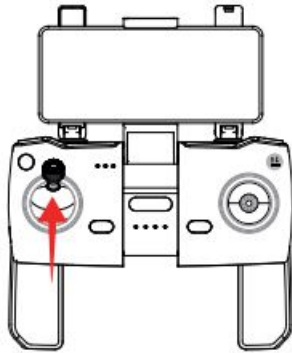



NEW TO FLYING DRONES?



Check the Flight Guide in the App



Search “**Ruko F11 Quick Start**”
on YouTube for First Flight



Scan QR Code for More
Tech and Video Support

[YouTube](#)

CONTACT US FOR MORE TECH SUPPORT

Rukodrone@gmail.com

+1 (949) 394 – 4635 (Available from 6pm to 3am PDT)
Printed in China.

Common Problems and Solutions

Question	Reason	Solutions
The motors cannot be started	Weak GPS signal	Turn on the Aircraft in an open area with strong GPS signal
	The red light stays on	The Aircraft has low battery. Please charge the battery in time
	The pink light stays on	The compass is not calibrated. Please refer to the "Calibration Before Flight" section of the user manual
	The left and right joystick are in place	Push the left and right joysticks simultaneously to 5 o'clock and 7 o'clock for 2 seconds
Unstable flight	Flying too low; affected by airflow	Please fly the Aircraft above 9.84ft(3 meters)
	The gyroscope is not calibrated	Place the Aircraft on a horizontal surface and conduct gyroscope/horizontal calibration. Please refer to the "Calibration Before Flight" section of the user manual
	The propellers become deformed and incomplete	Replace the propellers with new ones
	GPS signal is unstable. Flying near buildings and in obstructed places	Please fly the Aircraft in an open area free of obstacles within the circle of radius 32.81 ft(10 meters)
The flight direction is opposite or inconsistent with the remote control	The Aircraft is placed incorrectly before takeoff	Before takeoff, keep the camera ahead and the tail towards the pilot
	Get into Headless mode	Turn off headless mode
The Aircraft fall suddenly	Emergency stop is used	Do not use the emergency stop in non-emergency situations to avoid unnecessary losses
Out of control, spinning around on its own, abnormal sound	The Transmitter signal is interfered or the Aircraft exceeds the range of remote control	Please fly the Aircraft outdoors without interference, and ensure that it is within a controllable range
	Compass interference	Please manually land the drone in time and calibrate the compass. Please make sure to fly away from the buildings, trees, power lines, and signal towers
	The propellers become deformed and incomplete	Replace the propellers with new ones
The camera cannot be adjusted up and down	There are obstacles between the camera and the ground. When the Aircraft is turned on, the camera swings down for self-checking and the camera got stuck on obstacles	Restart the drone and ensure that there is enough space under the camera
		Recalibrate the gyroscope, and the camera will recheck itself as well
The camera will not point directly forward	This is the unique design of the camera, not a malfunction	Prevent propellers from affecting photography. Adjust the angle of the camera and let it point straight ahead to acquire best shooting experience
Video freezes, image transmission distance is short	The Aircraft is out of Wi-Fi range	Fly the Aircraft within the range of the Wi-Fi
	WiFi image transmission signal interference	Fly the Aircraft in an unobstructed open area free of buildings, high-voltage wires and signal towers
	The transmitter and the mobile phone are not pointed at the direction of the drone	Point the Transmitter and the mobile device at the flying direction of the Aircraft to maintain the strongest signal connection
	Phone performance freezes	Close unused apps running in the background to maintain the best performance of the phone

App does not display the interface	The phone is not connected to Wi-Fi	Connect your mobile device to the Wi-Fi : Ruko*****
	The phone version is too low	Android 6.0 and above, IOS 10.02 and above
	When connecting to the drone' s WiFi, the network is not set or set incorrectly	Set the Wi-Fi correctly Turn the phone to airplane mode
	VPN switch is turned on	Turn off the VPN switch
Phone cannot connect to Wi-Fi	It is the first time to connect your phone to the Wi-Fi	Try connecting a few more times or restart the phone
The WiFi name is not displayed in the list	The phone is a single band phone	Use the dual band devices that support both 2.4 GHz and 5 GHz/5.8 GHz
	WiFi has not been activated	Wait for about 30 seconds after turning on the Aircraft and keep refreshing the Wi-Fi list while the Wi-Fi is activated
GPS signal is weak	Turning on the drone indoors	GPS signals cannot be found indoors. Please search for GPS signals in an open place outdoors
	Under the tree, next to the building, in an obstructed place	Please stay away from obstacles for more than 32.81 feet(10 meters), and search for GPS signals in an open area
Unable to return home, drifting and flying away	GPS signal was turned off during the flight	Please don't turn off GPS suddenly during outdoor flight. Switch back to GPS mode in time
The Transmitter does not charge / App always says the Transmitter has low battery	The phone cannot connect to the Transmitter due to the wrong sequence for turning equipment on	The correct sequence is: Turn the Aircraft on first, then turn on the Transmitter. Next push the left stick up and down to pair the Transmitter with the Aircraft. Connect your mobile device to Wi-Fi in the end
The Aircraft cannot be paired with the Transmitter	Pairing the Transmitter with the Aircraft without unlocking the Transmitter	Correct pairing steps: 1. Turn on the Aircraft. 2. Turn on the Transmitter: push the left joystick to 12 o'clock position, and then push it down to 6 o'clock position to unlock the Transmitter and pair it with the Aircraft. Lights of the Aircraft turn pink if the Transmitter is successfully paired with the Aircraft
Cannot charge battery/- Cannot fully charge battery	Using inferior charger or charging on the computer with unstable voltage output	Use a mobile USB charger that ensures constant stable voltage output(5V) and amperage output (2-3A)
	Using inferior charging cables	Please use the original factory charging cable to charge
Short battery life	Flying in windy weather	Flying in windy weather will accelerate power loss
	Flying in cold weather	In low temperatures, the chemical reaction of the lithium battery is slowed down and the energy cannot be fully released
The product has slight marks	We tested all Aircraft before shipping	In order to give you the best experience, we tested functions of all Aircraft before shipping. Therefore, it is inevitable that there will be slight traces. However, it can be guaranteed that all Aircraft are 100% brand new

References

- Manuals+,**