



Ruijie Reyee Cloud App for Wireless Access Point User Guide

[Home](#) » [RuiJie](#) » Ruijie Reyee Cloud App for Wireless Access Point User Guide 

Contents

- 1 [Ruijie Reyee Cloud App for Wireless Access Point](#)
- 2 [Product Information](#)
- 3 [Product Usage Instructions](#)
- 4 [USING INSTURCTION](#)
- 5 [CONTACT](#)
- 6 [Documents / Resources](#)
 - 6.1 [References](#)



Ruijie Reyee Cloud App for Wireless Access Point



Product Information

The Wireless Access Point is a device that allows you to connect to a wireless network and access the internet. It is designed to provide a seamless and reliable connection for your wireless devices.

Product Usage Instructions

1. Download and register the Ruijie Cloud App. You can do this by scanning the QR code on the box or by downloading from the Google Play Store (Android) or App Store (Apple).
2. Once registered, an email will be sent to you. Click on 'Activate' in the email to open the Ruijie web-based Portal. Close this page and open the Ruijie Cloud App.
3. Open the Ruijie Cloud App and select 'Add a Project'.
4. Select 'Yes Connect to Wi-Fi'.
5. Switch on all devices and wait for 3 minutes.
6. Select 'Start'.
7. Select 'Connect'.
8. Select the network starting with '@Ruijie-sxxx' and wait for the WiFi symbol to appear. Then, return to the APP (top left).
9. If you only have 1 Wireless Access Point, select 'Yes. Continue'.
10. The topology should be displayed. Select 'Start Config'.
11. Create a project name and password with no spaces. Choose a 'Scenario' and select 'Next'.
12. Select the country. If there is no NZ option, choose Australia.
13. Create an SSID and password (Encryption) and select 'Save'.
14. Please wait while your network is being created.
15. Once the network is created, you will receive a notification of success with the SSID and password. Select 'Connect' to connect.

16. In your phone's setup, select the new network and enter the new password to connect.
17. Return to the APP for an inspection and optional speed test.

If you encounter any issues or require technical support, please contact AU Technical Support at 1800-AERIAL (237 425) or visit www.matchmaster.com.au. For NZ Technical Support, dial 0800-AERIAL (237 425) or visit www.matchmaster.co.nz.

USING INSTURCTION

If you haven't already done so, please download and register the Ruijie Cloud App. This can be done using the QR code on the box or from the Google Play Store (Android) / App Store (Apple). Once Complete an email will be sent to you, Click 'Activate', which will open the Ruijie web based Portal, close this page, and open the Ruijie Cloud App. Follow the instructions below.

1. Download and open the Ruijie Cloud APP (first time users will need to confirm their account by email). Select 'Add a Project'

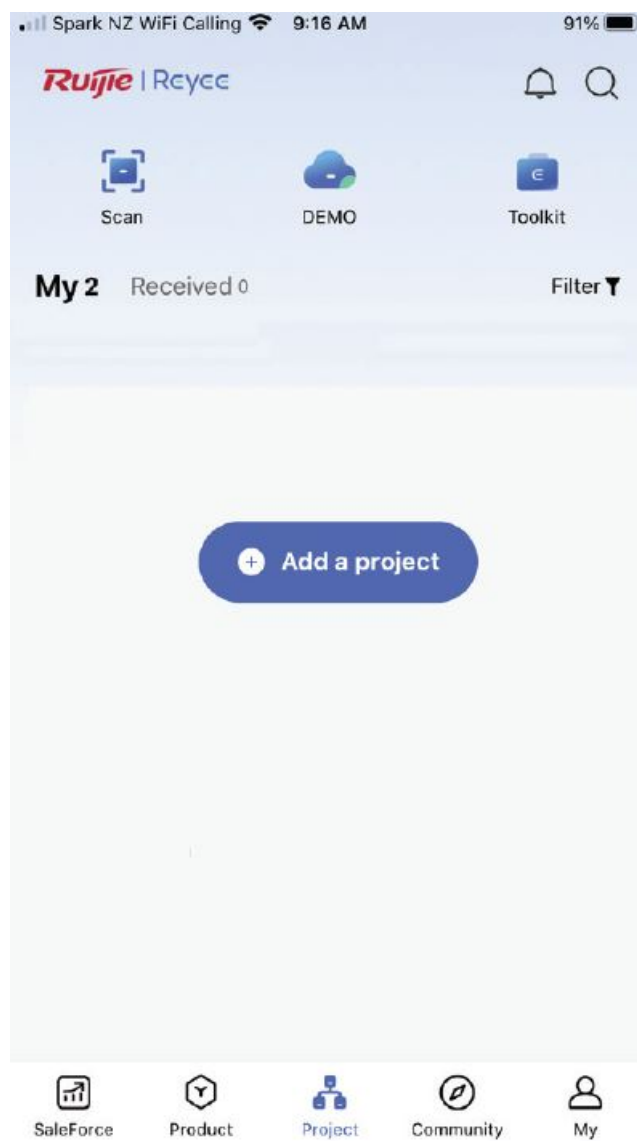

2. Select 'Yes Connect to Wi-Fi'

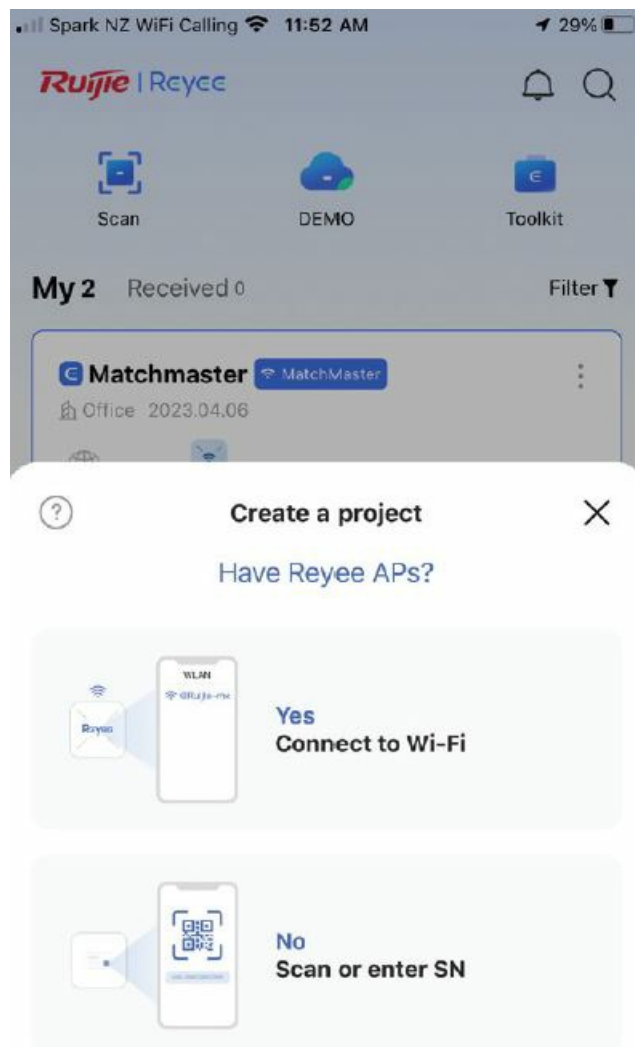

3. Switch everything on and wait for 3 mins then select 'Start'



4. Select 'Connect'

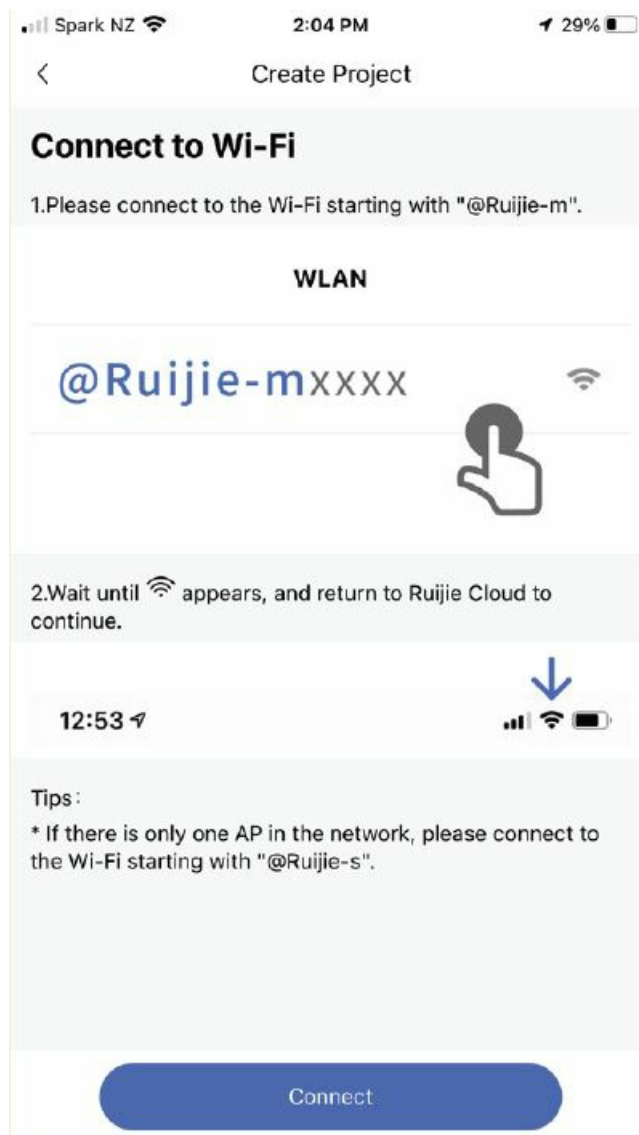

5. Select the network starting with '@Ruijie-sxxxx' and wait for the WiFi symbol  to appear, then return to the APP (top left).

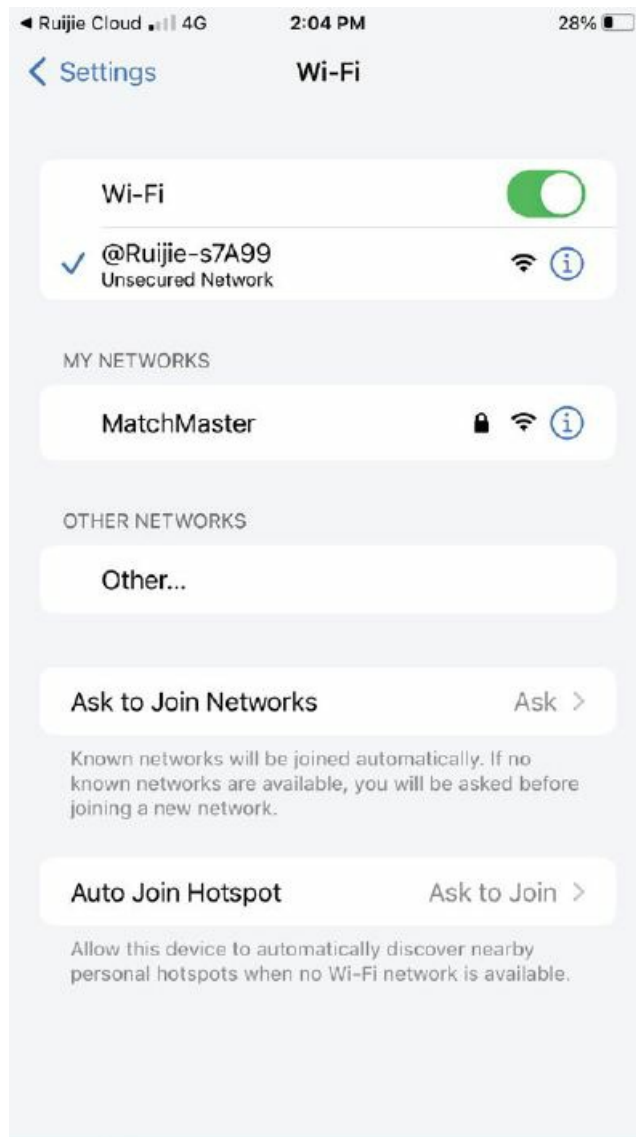

6. If you only have 1 WAP select 'Yes. Continue'

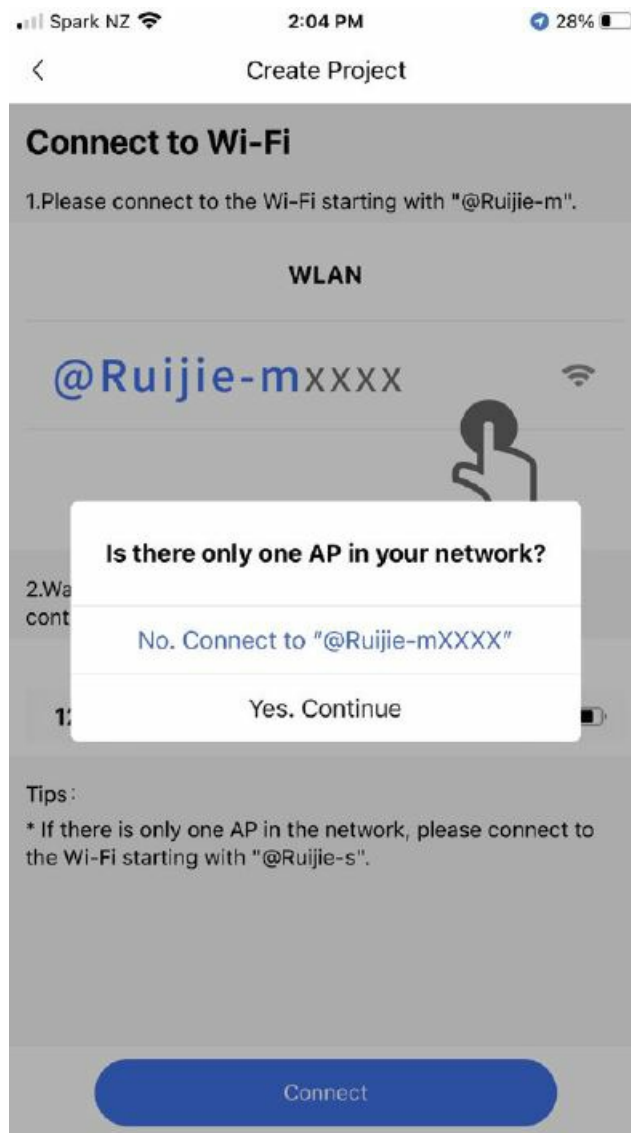

7. Topology should be displayed, select 'Start Config'



8. Create a Project name and Password with no spaces and choose a 'Scenario' then select 'Next'

Spark NZ 2:04 PM 28%

< Basic Config

Project Name
Enter project name

Management Password
More than 8 letters and numbers

To ensure project security, ensure that the password meets the following requirements:

- ☒ Has at least eight characters.
- ☒ Contains three of the following items:
 - Lowercase letters: abc...
 - Uppercase letters: ABC...
 - Numerals: 123...
 - Special characters: <=>[]!@#\$()
- ☒ Does not allow "admin"
- ☒ Does not allow spaces or question marks

Scenario *

Next

9. Select the country (If there is no NZ option, choose Australia). Create an SSID and Password (Encryption) and select 'Save'.

Spark NZ 2:41 PM 74%

< Basic Config

Project Config Internet Config Wi-Fi Config

Radio Country/Region Code
New Zealand

2.4G/5G Smart Connect ☒

2.4G+5G

SSID/Wi-Fi Name *
Sally

Encryption Mode ☐ Do Not Encrypt ☒ Encrypt

Encryption Type WAP/WPA2-PSK

Password *

Save

10. Please wait whilst your network is created.

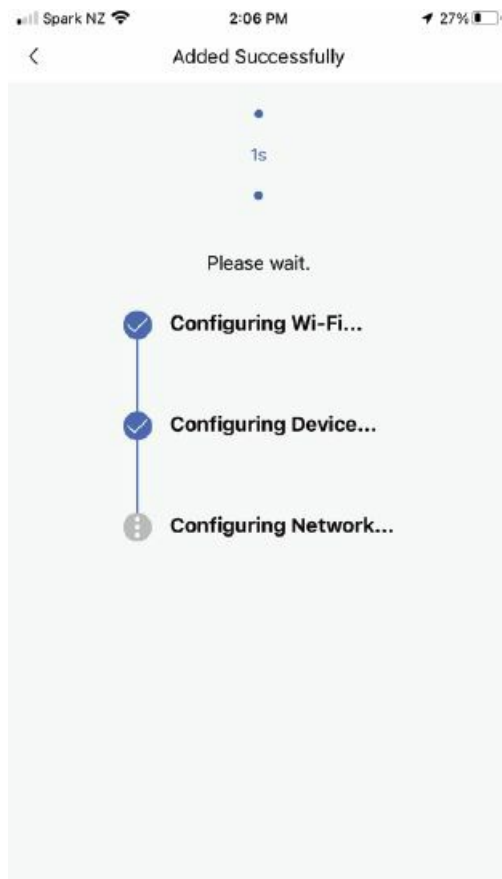

11. Notification of success noting the SSID and Password. Select 'Connect' to connect

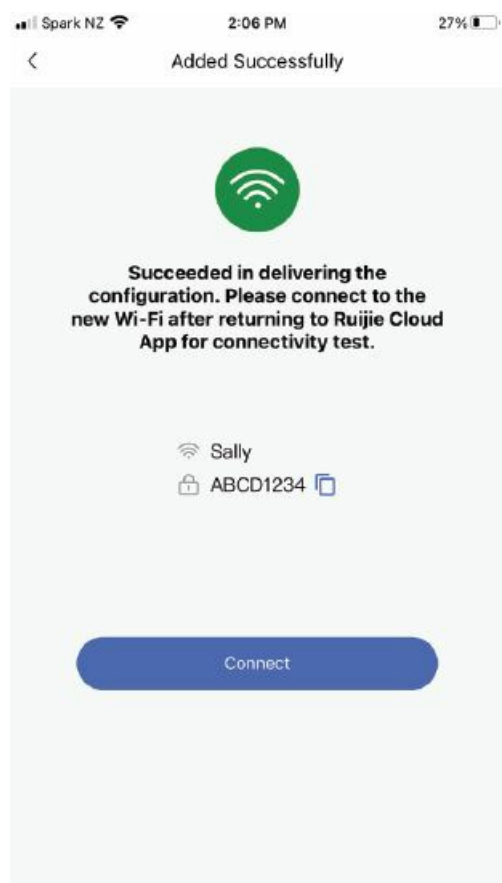

12. In your Phones' setup, select the new network and enter in the new password to connect. Return to the APP for an inspection and optional speed test.

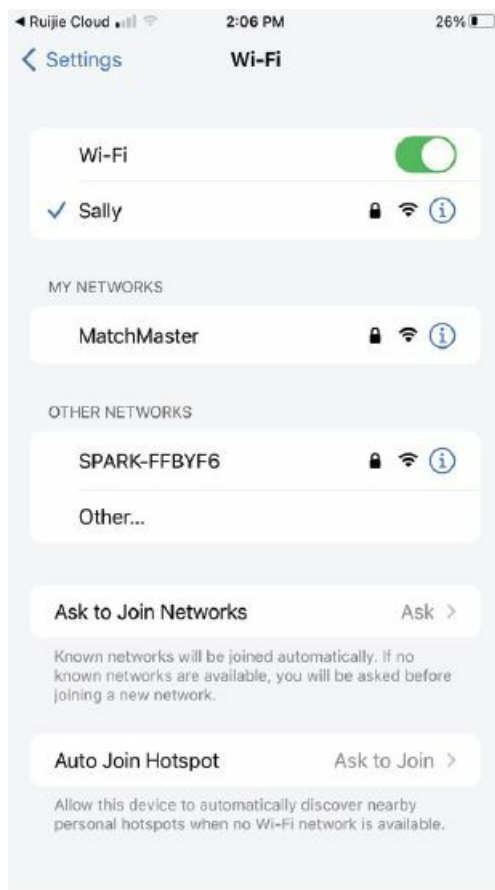

CONTACT

- AU Technical Support 1800-AERIAL 237 425 www.matchmaster.com.au.
- NZ Technical Support 0800-AERIAL 237 425 www.matchmaster.co.nz.
- Modified 7 Jun 2023

Documents / Resources

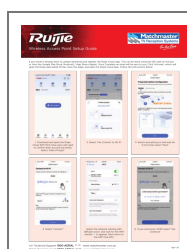

[Ruijie Reyee Cloud App for Wireless Access Point](#) [pdf] User Guide
 Reyee Cloud App for Wireless Access Point, Reyee Cloud App, Wireless Access Point, Reyee Cloud, App

References

- matchmaster.co
- Matchmaster