

**RUBIK'S**  
CONNECTEDX  
Smart Cube



## RUBIKS CONNECTEDX Smart Cube User Guide

[Home](#) » [Rubiks](#) » RUBIKS CONNECTEDX Smart Cube User Guide 

### Contents

- 1 RUBIKS CONNECTEDX Smart Cube
  - 1.1 ACTIVATE YOUR CUBE
- 2 DOWNLOAD the Rubik's Connected App
- 3 HOW TO INSERT THE BUTTON CELL BATTERY
- 4 ENVIRONMENT:
- 5 FCC STATEMENT:
- 6 Documents / Resources
  - 6.1 References
- 7 Related Posts



**RUBIKS CONNECTEDX Smart Cube**



## User Instruction Guide

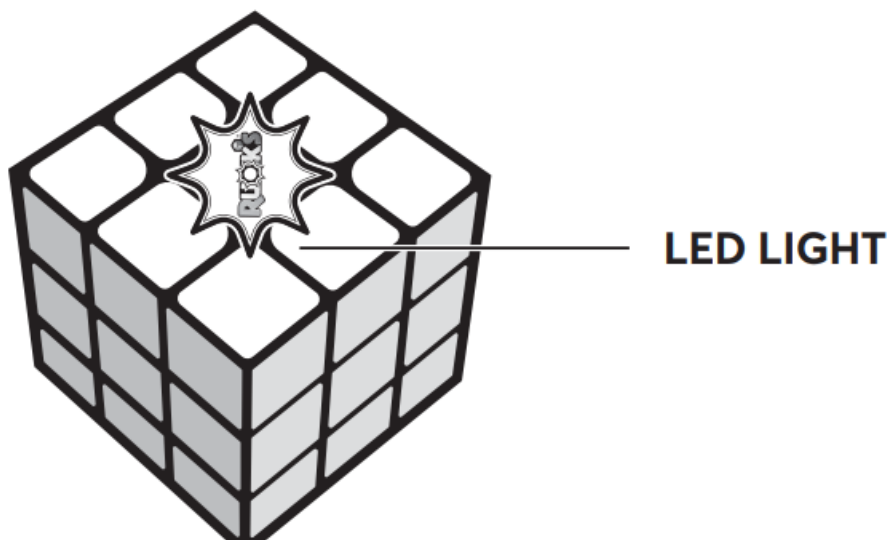

This Important Product Information Guide contains safety, handling, disposal, recycling, and regulatory information as well as the limited warranty for ConnectedXTM Cube. Read all safety information and operating instructions before using ConnectedXTM Cube to avoid injury or harm. By using ConnectedXTM Cube you agree to the terms and policies found at [Spinmaster.com](https://Spinmaster.com)/terms including the Spin Master Inc. Privacy Policy.

### ACTIVATE YOUR CUBE

1. Pick up your ConnectedX Cube (but don't rotate it!) to ACTIVATE.

2. The LED will FLASH for 2-3 seconds. (The LED is on the center tile with Rubik's logo) ConnectedXTM Cube you agree to the terms and policies found at [Spinmaster.com](https://Spinmaster.com)/terms including the Spin Master Inc. Privacy Policy.

## DOWNLOAD the Rubik's Connected App



Your Connected X Cube is ready for gameplay and tracking all your moves!

**NOTE:** Connected X Cube begins tracking your movements AFTER the LED light has flashed for 2-3 seconds and you've connected to the app. When Connected X Cube is idle, the LED remains inactive to conserve battery power.

## CONNECTING YOUR RUBIK'S CONNECTED X CUBE

### LAUNCH the App



- Follow the step-by-step instructions on screen to CONNECT to your Cube



- The LED light will flash when you're connected
- Battery included is for in-store demonstration, and should be replaced to improve performance.

### **KEEP BATTERIES OUT OF REACH OF CHILDREN.**

This product contains a button or coin cell battery. A swallowed button or coin cell battery can cause internal chemical burns in as little as two hours and lead to death due to chemical burns and potential perforation of the esophagus. Dispose of used batteries immediately and safely. Used batteries can still be dangerous. Keep new and used batteries away from children. If you think batteries might have been swallowed or placed inside any part of the body, seek immediate medical attention. (AUSTRALIAN RESIDENTS ONLY) If you suspect your child has swallowed or inserted a button battery immediately call the 24-hour Poisons Information Centre on 13 11 26 for fast, expert advice. Examine devices to make sure the battery compartment is correctly secured, e.g., that the screw or other mechanical fastener is tightened. Do not use if compartment is not secure. Tell others about the risk associated with button batteries and how to keep their children safe.

### **HOW TO INSERT THE BUTTON CELL BATTERY**

replace the battery, the screw hole must always be on the bottom right corner.

- Screw hole

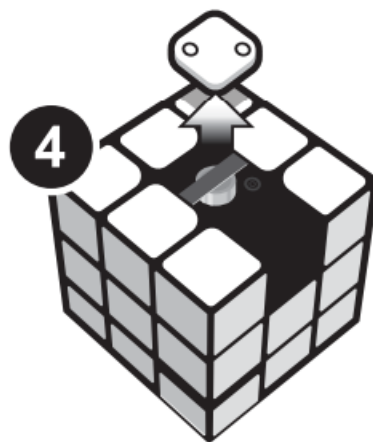
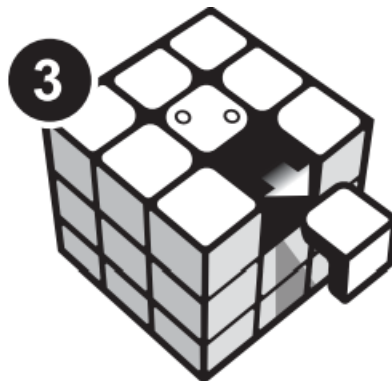
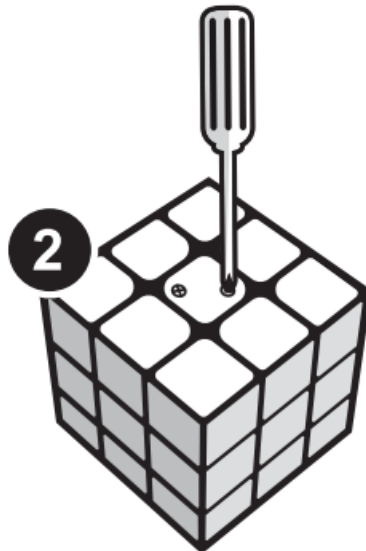
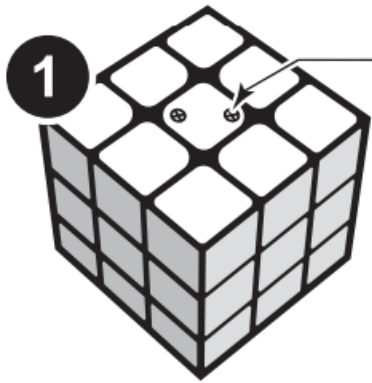

- Use a philips-head screwdriver (screwdriver not included).
- Please install with positive side (+) facing up

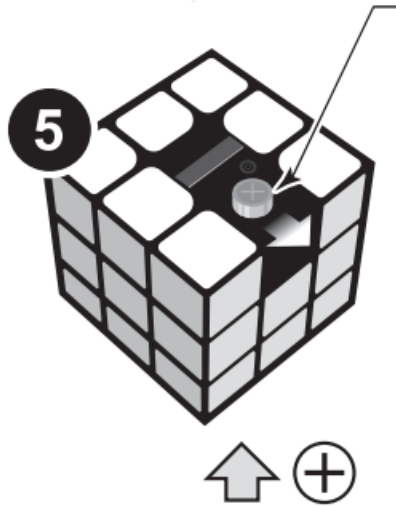

## HOW TO INSTALL BATTERIES

1. Open the battery door with a screwdriver.
2. If used batteries are present, remove these batteries from the unit by pulling up on one end of each battery. DO NOT remove or install batteries using sharp or metal tools.
3. Install new batteries as shown in the polarity diagram (+/-) inside the battery compartment.
4. Replace battery door securely.
5. Check your local laws and regulations for correct recycling and/or battery disposal.

## BATTERY SAFETY INFORMATION:

Batteries are small objects. Replacement of batteries must be done by adults. Follow the polarity (+/-) diagram in the battery compartment. Promptly remove dead batteries from the toy. Dispose of used batteries properly. Remove batteries for prolonged storage. Only batteries of the same or equivalent type as recommended are to be used. DO NOT incinerate used batteries. DO NOT dispose of batteries in fire, as batteries may explode or leak. DO NOT mix old and new batteries or types of batteries (i.e. alkaline/standard/rechargeable). Using rechargeable batteries is not recommended due to possible reduced performance. Rechargeable batteries are only to be charged under adult supervision. Replaceable-rechargeable batteries are to be removed from the toy before being charged. DO NOT T recharge non-rechargeable batteries. DO NOT short-circuit the supply terminals.

## WEEE INFORMATION :

Contains 1 LR1131 Maxell battery (1 LR54/AG10/189 Energizer). Batteries or battery packs must be removed for recycling and proper disposal. When this product has reached the end of its useful life, it should not be disposed of with other household waste. EU legislation for Electrical and Electronic Equipment and Batteries, requires these to be separately collected so that they can be treated using the best available recovery and recycling techniques. This will minimize the impact on the environment and human health from soil and water contamination by any hazardous substances, decrease the resources required to make new products and avoid using up landfill space. Please do your part by keeping this product out of the municipal waste stream! The “wheelie bin” symbol means that it should be collected as “waste electrical and electronic equipment”. You can return an old product to your retailer when you buy a similar new one. For other options, please contact your local council.

## ENVIRONMENT:

- **Operating Temperature:** 0°C to 40°C (32°F to 104°F)
- **Relative Humidity:** 5% to 95% non-condensing. Using Connected X Cube in very cold or high humidity

conditions might temporarily shorten battery life and could cause Connected X Cube to temporarily stop working. Do not expose Connected X Cube to high temperature conditions such as direct sunlight or hot car interiors because temperatures in these situations can exceed this range. For best results, use indoors. Never expose Connected X Cube to water.

## **MAGNETS WARNING**

- **WARNING:** This toy contains inaccessible magnet.
- **WARNING:** Not suitable for children under 8 years. This product contains (a) small magnets(s). Swallowed magnets can stick together across intestines causing serious injuries. Seek immediate medical attention if magnet(s) are swallowed

## **FCC STATEMENT:**

**FCC ID:** 2ASMERBE001CC

**This device complies with Part 15 of the FCC rules. Operation is subject to the following two conditions:**

1. This device may not cause harmful interference,
2. This device must accept any interference received, including interference that may cause undesired operation.

This equipment has been tested and found to comply with the limits for Class B digital devices pursuant to Part 15 of the FCC rules. These limits are designed to provide reasonable protection against harmful interference to radio communications. This equipment generates, uses and can radiate radio frequency energy and, if not installed and used in accordance with the instruction, may cause harmful interference to radio communication. However, there is no guarantee that interference will not occur in a particular installation. If this toy does cause interference to radio or television reception (you can check this by turning the toy off and on while listening for the interference), one or more of the following measures may be useful:

- Reorient or relocate the receiving antenna.
- Increase the separation between the toy and the radio or the TV.
- Consult the dealer or an experienced TV-radio technician for help.
- A. Frequency band(s) in which the radio equipment operates: 2402-2480MHz.
- B. Maximum radio-frequency power transmitted in the frequency band(s) in which the radio equipment operates:<10 dBm.

**NOTE:** Changes, adjustments or modifications to this unit, including but not limited to, replacement of any transmitter component (crystal, semiconductor, etc) could result in a violation of FCC rules under part 15 and/or 95 and must be expressly approved by Spin Master Ltd or they could void the user's authority to operate the equipment. Spin Master Inc., PMB #10053, 300 International Drive, Suite 100, Williamsville, NY 14221. To contact the responsible party please visit [fcc.spinmaster.com](http://fcc.spinmaster.com)

## **CLASS B STATEMENT (FOR CANADA)**

- Electrical Low Power Products CAN ICES-3(B)/NMB-3(B)
- **CANADIAN Class B statement:** This device contains licence-exempt transmitter(s)/receiver(s) that comply with Innovation, Science and Economic Development Canada's licence-exempt RSS(s). Operation is subject to

the following two conditions:

1. This device may not cause interference.
2. This device must accept any interference, including interference that may cause undesired operation of the device.
  - **Trade name:** RBK RON Rubiks 3X3 Connected X
  - **IC:** 24826-RBE001CC
  - **Model:** 45852
  - **PMN:** 43701

## EU/UK RADIO EQUIPMENT COMPLIANCE

Spin Master International B.V. hereby declares that the radio equipment type 24826-RBE001CC is in compliance with Directive 2014/53/EU and Radio Equipment Regulation 2017. The full text of the declaration of conformity is available at the following internet address: <http://doc.spinmaster.com>

## SUPPORT

- Spin Master reserves the right to withdraw and discontinue the website
- [Spinmaster.com/support](http://Spinmaster.com/support) at anytime.
- Spin Master is not responsible for any damage caused to electronic devices through improper use.
- Keep these instructions for future reference as they contain important information



**WARNING:** CHOKING HAZARD – Small parts. Not suitable for children under three years

© 2024. TM & © Spin Master Toys UK Limited. All rights reserved

- Spin Master Ltd., 225 King Street West, Toronto ON M5V 3M2 Canada
- Spin Master Inc., PMB #10053, 300 International Drive, Suite 100, Williamsville, NY 14221
- Spin Master International B.V., Kingsfordweg 151, 1043 GR Amsterdam, NL
- Spin Master Australia Pty Ltd, Level 9, 205 Pacific Hwy, St Leonards, NSW 2065
- Spin Master Toys UK Ltd. Boston House, Boston Drive, Bourne End, Buckinghamshire, SL8 5YS, UK  
[www.spinmastergames.com](http://www.spinmastergames.com)

Spin Master reserves the right to discontinue the Rubik's Connected app at any time

**MADE IN CHINA**





- [WWW.SPINMASTER.COM](http://WWW.SPINMASTER.COM)
- Rubiks Connected X
- PROJ\_SPM\_22008
- T43701\_0002\_20148728\_GML\_IS\_R1RBK\_Ron\_Rubiks\_3x3\_Connected\_X\_F24)

## IS

- Double sided 420mm x 297mm 5 fold

## Documents / Resources



[RUBIKS CONNECTEDX Smart Cube](#) [pdf] User Guide  
RBE001CC, 2ASMERBE001CC, CONNECTEDX Smart Cube, CONNECTEDX, Smart Cube, C  
ube

## References

- [doc.spinmaster.com](http://doc.spinmaster.com)
- [fcc.spinmaster.com](http://fcc.spinmaster.com)
- [Spinmaster.com/support](http://Spinmaster.com/support)
- [User Manual](#)

[Manuals+](#), [Privacy Policy](#)

This website is an independent publication and is neither affiliated with nor endorsed by any of the trademark owners. The "Bluetooth®" word mark and logos are registered trademarks owned by Bluetooth SIG, Inc. The "Wi-Fi®" word mark and logos are registered trademarks owned by the Wi-Fi Alliance. Any use of these marks on this website does not imply any affiliation with or endorsement.