



Rubicson 47098 Ice Cube Machine User Manual

[Home](#) » [rubicson](#) » Rubicson 47098 Ice Cube Machine User Manual 

Rubicson®

manual
Ice Maker
Item:47098

Contents

- [1 Overview](#)
- [2 Control panel](#)
- [3 Specifications](#)
- [4 Before first use](#)
- [5 Cleaning and maintenance](#)
- [6 Troubleshooting](#)
- [7 Safety information](#)
- [8 Documents / Resources](#)
- [9 Related Posts](#)

Overview

1.

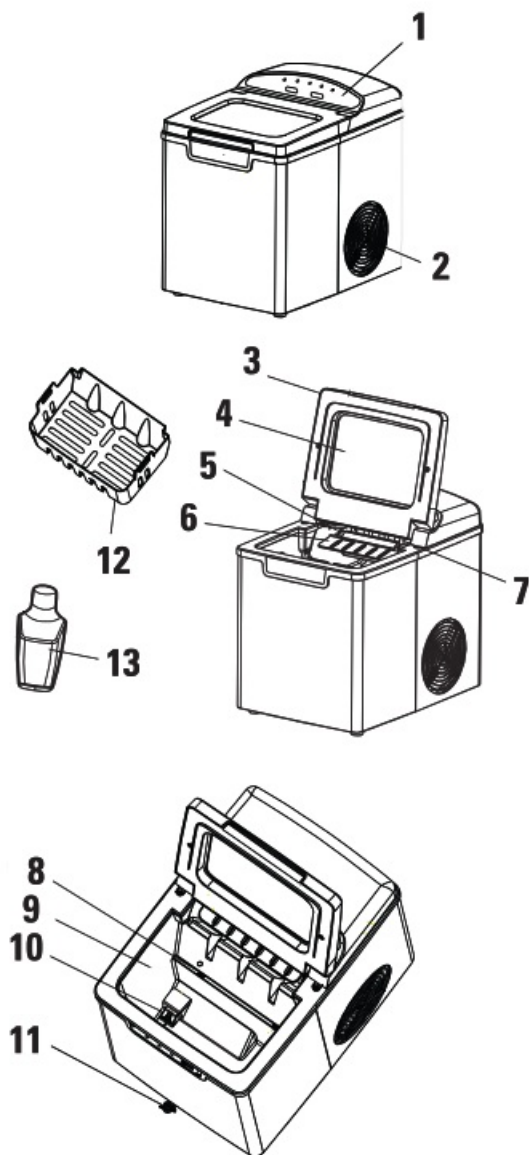

Control panel

2. Air outlet

3. Lid

4. Viewing window

5. Ice tray

6. Ice shovel

7. Evaporator

8. Max water level

9. Water container

10. Filter

11. Drain plug

12. Ice basket

13. Ice scoop

Control panel

1.

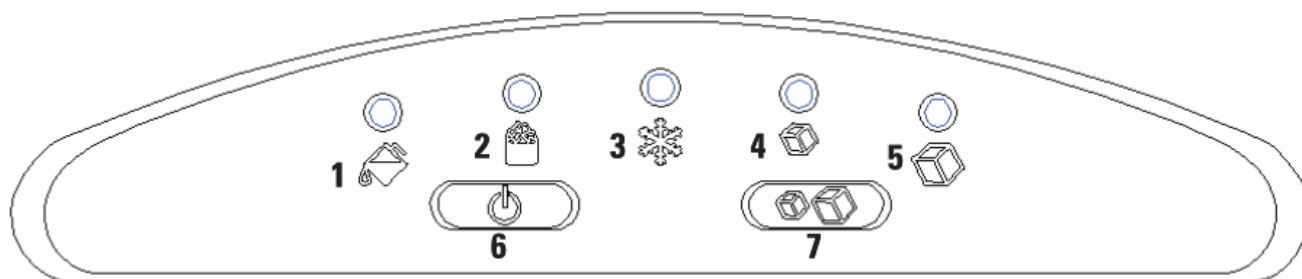

Add water indicator

2. Ice full indicator
3. Working indicator
4. Small ice cubes indicator
5. Large ice cubes indicator.
6. On/Off button
7. Ice size button

Specifications

Power supply	220-244 V- 50 Hz
Power consumption	105W
Refrigerant/refrigerant amount	Ft600a/29 g
Weight	8.5 kg
Size	348x249x325mm

Before first use

Place the ice maker on a stable and flat surface, away from heat sources. Make sure it has 20 cm of free space on all sides. Wait for approximately 2 hours after the ice maker has been leveled before using it. Clean the ice maker before first use according to the instructions under the heading 'Cleaning and maintenance (page 4).

Use

Make sure the drain plug at the bottom of the water container (9) is closed.

Insert the plug into a wall socket. The Working indicator (3) starts to blink. Open the lid (3) and remove the ice basket (14). Fill the water container 19) with clean water (temperature 8-25 °C). Mind the MAX mark 18). Reinsert the ice basket and close the lid.

Press the ice size button (control panel, 7) to choose the ice size. The corresponding indicator lights up.

Press the On/Off button (control panel, 6). The Working indicator lights up with a steady light.

The ice maker starts to make ice. Depending on water temperature and the ambient temperature, every cycle takes approximately 643 minutes and the ice cubes may differ slightly in size and shape. Ice forms on the evaporator (6) during the ice-making. The ice tray (5) then tilts backward to pour the remaining water back into the water container and the ice cubes on the evaporator are being dropped into the ice basket. The ice tray then moves back into starting position and the ice maker starts the next cycle. When the Ice full indicator (2) lights up, the ice basket has to be emptied. The ice maker stops the ice-making cycle automatically and continues again 5 seconds after the ice basket is empty. Use the ice scoop 113) to remove the ice.

The Add water indicator lights up if there is not enough water in the water container. The ice maker stops automatically. Remove the ice basket, fill the container with water and press the On button to start the ice-making again.

You can stop the ice making whenever you feel that you have enough ice by pressing the On/Off button. Move the ice to a freezer when you are done making ice.

Cleaning and maintenance

Unplug the power cord before cleaning. Clean the ice maker regularly.

If there is water left on the ice tray, gently push it back so the water goes back into the water container. Push the ice maker about 75 mm outside the table (fig. 1 to be able to open the drain from underneath. Remove the drain plug and let all water out (fig. 2-3).

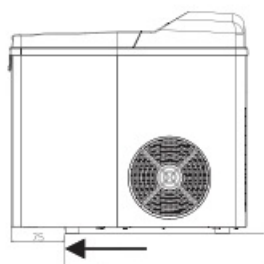

Fig. 1

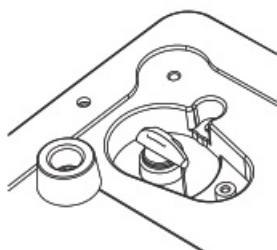

Fig. 2

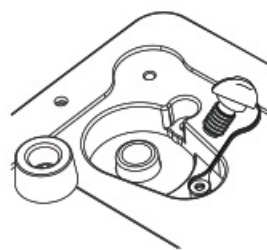

Fig. 3

Close the drain again and fill the water container with clean water. Press and hold the On/Off button to start the cleaning program. The ice maker pumps the water for 15 minutes. When it is finished, open the drain and let the water out.

Wash the ice basket and ice scoop with warm water and mild detergent. Clean the surface of the ice maker with a damp cloth. Use a mild detergent if needed.

Troubleshooting

Problem	Cause	Solution
The Add water indicator lights up even though the water level is fine.	Pipes from the water container have been blocked.	Start the cleaning program.
Ice cubes stick together.	The ice-making cycle takes too long.	Turn off the ice maker, let the ice melt and try again.
	The water is too cold.	All the water containers with water that has a temperature between 8 °C and 25 °C.
No ice is produced, but the ice maker seems to work normally.	The room temperature or the water temperature is too high.	Make sure the room temperature is lower than 32 °C or fill the water container with cold water.
Poor ice-making result	Poor heat dissipation.	Make sure there is 20 free spaces on all sides of the ice maker.
	The water temperature is too high.	Make sure the water has a temperature between 8 °C and 25 °C.
	The room temperature is too high.	Make sure the room temperature is between 10 °C and 32 °C.

Safety information

Before plugging into a socket, check that the voltage in your home corresponds with the voltage printed on the bottom of the appliance.

If the supply cord is damaged, it must be replaced by the manufacturer, its service agent, or a similarly qualified person in order to avoid a hazard.

Never let the power cord hang over the edge of a table or counter or touch hot surfaces.

Do not place on or near a heat source, such as a heated oven.
Do not touch the evaporator during ice-making. Do not immerse the ice maker in water.
Always unplug the ice maker before any cleaning or maintenance.
Do not turn upside down or tilt the ice maker. If the ice maker is turned accidentally, let it stand on a leveled surface for 2 hours before using it again.
Do not try to modify or repair the ice maker yourself.
Keep away from children.
Never leave the appliance unattended when in use.
Only for indoor use.
Fill the water container only with water.

Note

If you encounter any problems with the manual, please go to www.kjell.com/47098 for an updated version.



www.rubicson.com

Box 50435
Malmo, Sweden

Documents / Resources

	<p>Rubicson 47098 Ice Cube Machine [pdf] User Manual 47098, Ice Cube Machine</p>
--	--