



**IST-10 10 Inch
Intelligent
Surfaces
Touchpanel
Tablet Computer**



RTI IST-10 10 Inch Intelligent Surfaces Touchpanel Tablet Computer User Guide

[Home](#) » [RTI](#) » RTI IST-10 10 Inch Intelligent Surfaces Touchpanel Tablet Computer User Guide 

Contents

- 1 RTI IST-10 10 Inch Intelligent Surfaces Touchpanel Tablet Computer
- 2 Product Information
- 3 Product Usage Instructions
- 4 Key Features
- 5 Overview
- 6 Mounting Bracket Installation
- 7 Power the IST-10
- 8 Dimensions
- 9 Programming
- 10 Safety Suggestions
- 11 Federal Communications Commission Notice
- 12 Limited Warranty
- 13 Documents / Resources
 - 13.1 References
- 14 Related Posts



RTI IST-10 10 Inch Intelligent Surfaces Touchpanel Tablet Computer

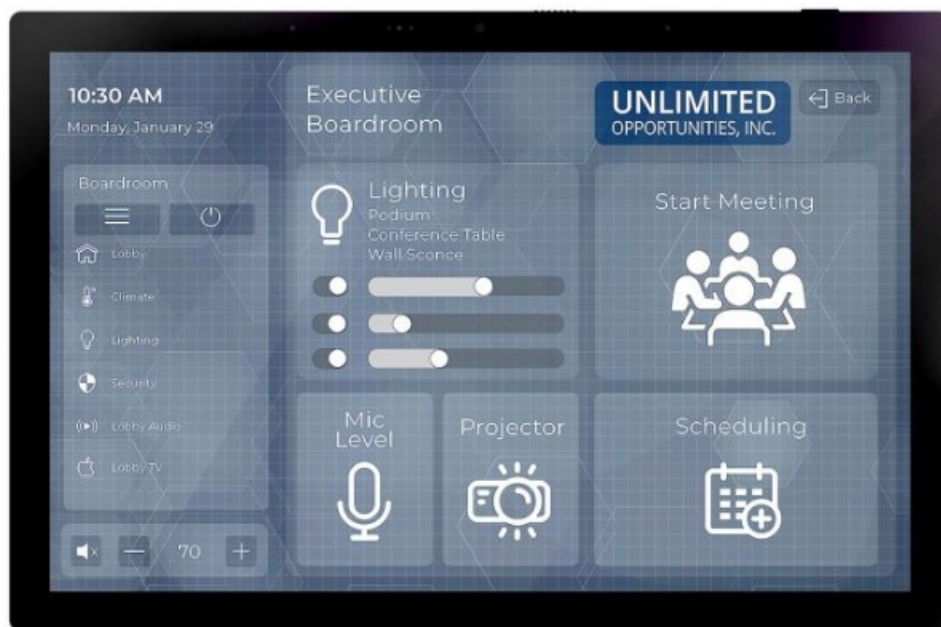

Product Information

Specifications:

- **Display:** 10" capacitive touchscreen
- **Resolution:** 1920×1200 with true-black display filter
- **Control:** Ethernet with PoE
- **Mounting Depth:** 1.34" (34mm)
- **Mounting Height:** 57-65" (145cm-165cm) from floor

Product Usage Instructions

- **Mounting the IST-10:**

The IST-10 can be wall-mounted in Portrait or Landscape orientation or placed on a tabletop using a stand (sold separately).

- **Mounting Depth:**

Ensure a minimum depth of 1.34" from the wall surface, leaving space for connectors.

- **Mounting Height:**

Recommended height is 57-65" from the floor to the center of the unit.

- **Mounting Bracket:**

Attach the mounting bracket to a standard single/dual gang wall box or low-voltage bracket.

- **Powering the IST-10:**

The IST-10 can be powered via Ethernet with PoE or by connecting a 12VDC power supply, not both.

- **LAN/PoE:**

Use the jack on the rear enclosure for power.

Installing and Removing the IST-10:

Installation:

1. Loosen the captive screw.
2. Align mounting frame hooks and gently pull the IST-10 down.
3. Tighten the captive screw to secure the unit.

Removal:

1. Loosen the captive screw.
2. Gently push the IST-10 upwards to remove it.

Programming and Communication:

Programming: Use the RTI Integration Designer Programming Software to program the touchscreen display with various objects like buttons and graphics.

FAQ:

- **How do I power the IST-10?**

The IST-10 can be powered either through an Ethernet connection with PoE or by using a 12VDC power supply, but not both simultaneously.

- **Can the IST-10 be mounted on a tabletop?**

Yes, the IST-10 can be mounted on a tabletop using a stand that is available for purchase separately.

The IST-10 touch panel elevates system control in all commercial and residential settings. It starts with a hi-resolution 10" capacitive touch screen with a 1920×1200 resolution with a true-black display filter for exceptional clarity. With an ultra-thin bezel and a near-flush mount (just 0.4"/12mm off the wall), the IST-10 makes an elegant statement in landscape or portrait mount, while the optional stand enables tabletop and countertop convenience. Built-in 10/100 Base-T Ethernet with PoE enables seamless two-way system control, video, and remote programming.

Key Features

- Hi-resolution 10" capacitive-touch screen (1920×1200) with ultra-thin bezel.
- Near-flush mount (less than 0.4"/11mm off wall).
- Ethernet and Wi-Fi options for control and communication.
- PoE or 12V DC power options.
- Exceptional video streaming and two-way intercom at H.264 or H.265 format.
- Hi-res privacy ensures a 2MP camera.
- Dual speakers and far-field microphone array (with mute button).
- Proximity and ambient light sensors.
- Tabletop stand option.
- Portrait or landscape.

Product Contents

- IST-10
- Metal Wall Mounting Bracket (1)

- Mounting Bracket Screws (4)

Overview

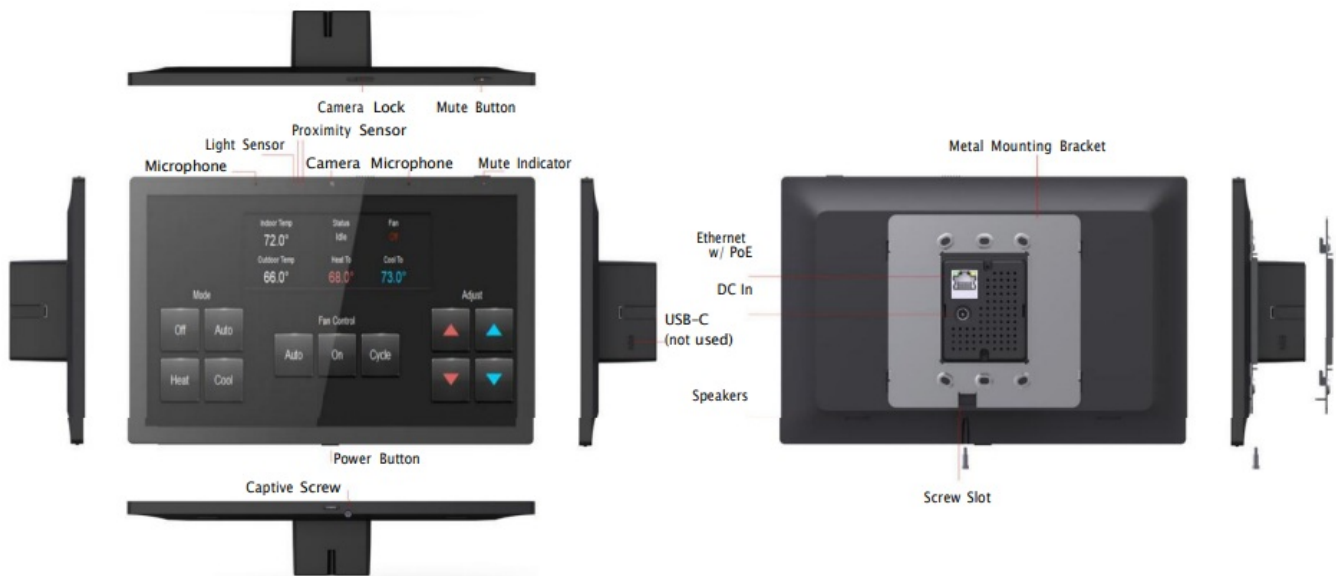

Mounting Bracket Installation

The IST-10 is designed to be wall mounted in either Portrait or Landscape orientation, or on tabletop using the stand (available separately).

• Mounting Depth

The IST-10 requires a minimum mounting depth of 1.34" (34mm) from the wall surface. Leave space to account for the RJ-45 or 12V barrel connector.

• Mounting Height

The recommended mounting height for the IST-10 is 57"- 65" (145 cm -165 cm) from the finished floor to the center of the unit.

• Mounting Bracket

The IST-10 is designed to be mounted to a US standard single/dual gang wall box or a single/dual gang low voltage bracket. The IST-10 mounting bracket should be attached to the low voltage bracket with the supplied screws, then the IST-10 unit is secured on the metal rear mounting bracket with a captive screw located at the bottom of the IST-10.

• Landscape/Portrait Mounting

- Landscape orientation: Install the single gang low-voltage bracket on a wall in its normal position.
- Portrait orientation: Install the single gang low-voltage bracket on the wall after rotating it 90 degrees in a counterclockwise direction.

• Install the IST-10 Mounting Bracket

- The IST-10 package includes a mounting bracket that **MUST** be used for installation.
- Use the included screws to mount the bracket onto a single-gang low-voltage bracket.
- Verify that the bracket is level before tightening the captive screw on the IST-10.

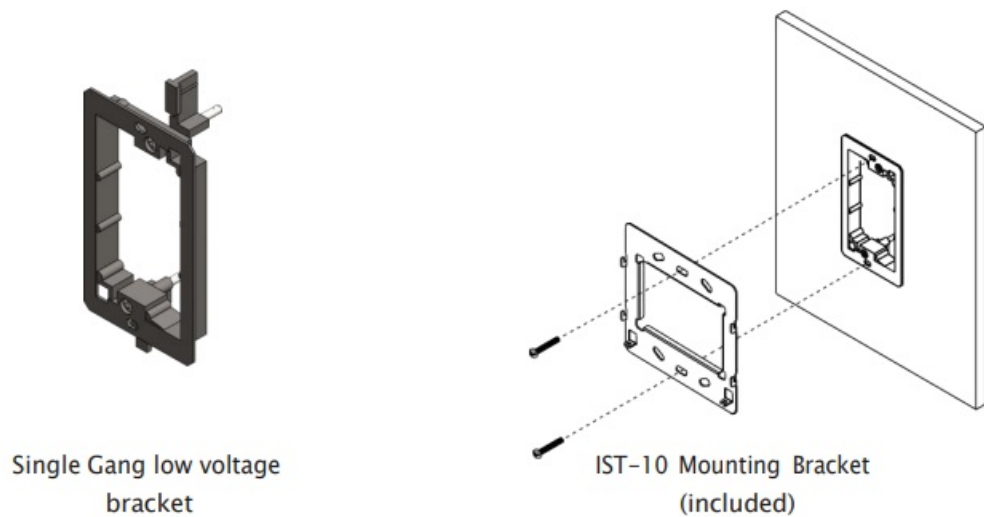

Power the IST-10

The IST-10 is designed to be powered over an Ethernet connection with PoE or by connecting a 12VDC power supply (not included), but not both.

• PoE Connection

- PoE connection requires IEEE 802.3at standard. Utilize a network switch or PoE injector that meets this standard.
- Connect the IST-10 using a standard T568A or T568B Ethernet cable from the network switch to the LAN/PoE jack on the rear enclosure of the IST-10.

• 12VDC Power Supply

- You can provide power to the IST-10 by utilizing a 12VDC/2A power supply (available separately).
- Plug the connector into the DC jack on the rear enclosure of the IST-10.

• Power Up The IST-10

- The IST-10 will automatically power on when power is applied.

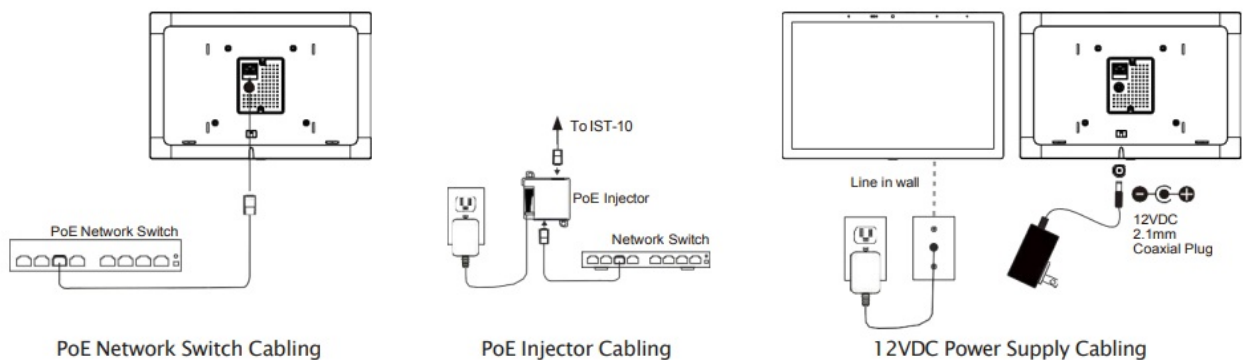

Install the IST-10

- Use a Philips #1 head screwdriver to loosen the captive screw of the unit to the level indicated below in the diagram. Screw should not be removed from the unit.
- Align the mounting frame hooks with the IST-10 mounting slots and gently pull the IST-10 unit down the mounting bracket. Make sure the mounting hooks are properly engaged.
- To complete the installation, tighten the captive screw on the bottom part of unit, to secure the IST-10 on the mounting bracket.

- For Portrait orientation, rotate mounting bracket and IST-10 90 degrees in a counterclockwise direction before installation.

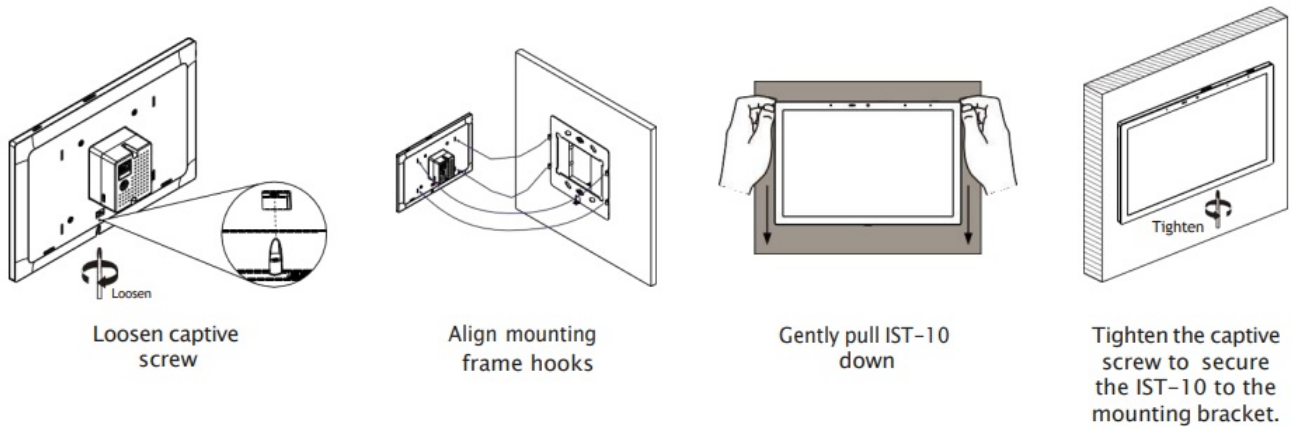

Remove the IST-10

Use a Philips #1 head screwdriver to loosen the captive screw of the IST-10, then gently pull straight up from the mounting frame to disengage the unit.

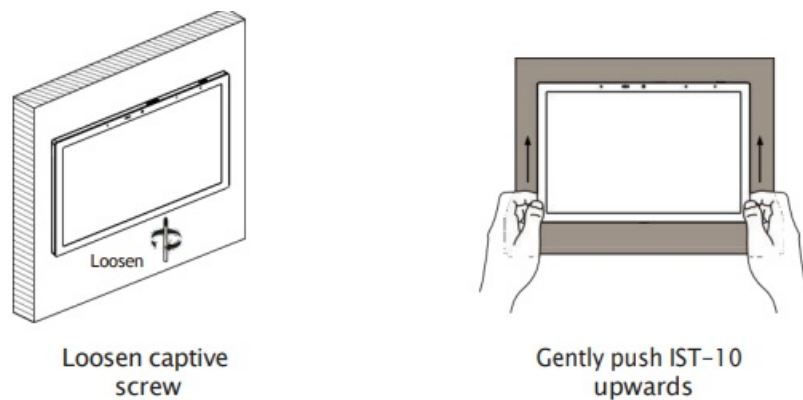

Dimensions

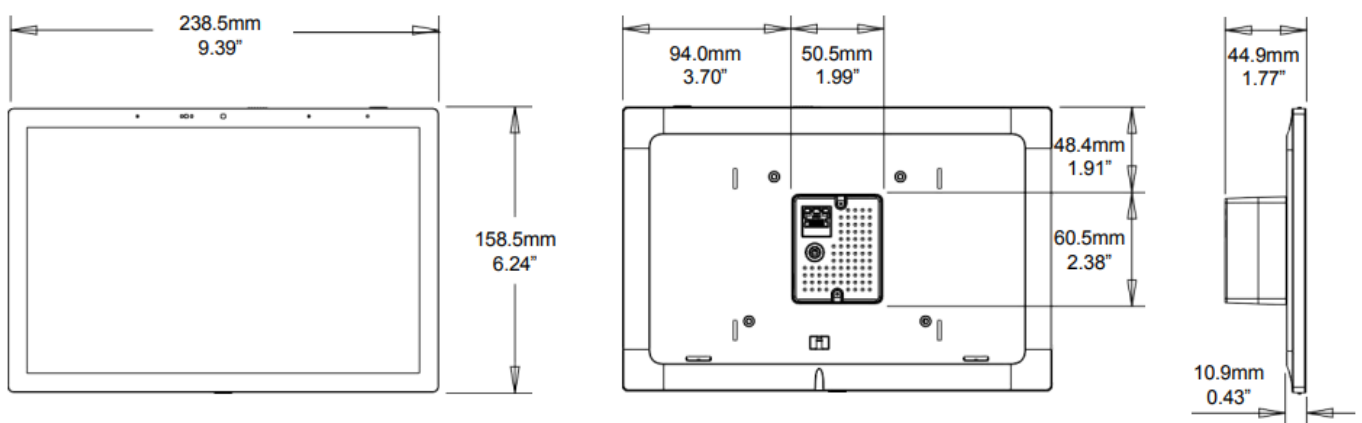

Ethernet Communication

When the IST-10 is connected to a network switch by Ethernet cable, the unit will acquire a network address via DHCP and automatically connect to the LAN.

Programming

- Touchscreen Display

The IST-10 touchscreen display is programmed using the RTI Integration Designer Programming Software. Normally, it is organized into a series of pages containing objects (buttons, text, graphics, etc.) that are related to each other.

- **Updating the Software**

RTI's Integration Designer data files can be downloaded to the IST-10 via Ethernet network.

Hard Buttons

- **Power Button:** Short press turns off/on display
- **Mute Button:** Short press disables/enables the microphone
- **Full Reboot:** Short press of power button + mute button simultaneously
- **Network IP/Wi-Fi reset:** Hold power + mute button for 4 seconds, then release
- **Factory Reset:** Hold power + mute button for 8 seconds then release

Safety Suggestions

- **Read and Follow the Instructions**

Read all safety and operating instructions before operating the unit.

- **Retain Instructions**

Keep the safety and operating instructions for future reference.

- **Heed Warnings**

Adhere to all warnings on the unit and in the operating instructions.

- **Accessories**

Only use attachments/accessories specified by the manufacturer.

- **Heat**

Keep the unit away from heat sources such as radiators, heat registers, stoves, etc., including amplifiers that produce heat.

- **Power**

Unplug this apparatus during lightning storms or when unused for long periods of time.

- **Power Sources**

Connect the unit only to a power supply of the type described in the operating instructions, or as marked on the unit.

- **Power Sources**

Connect the unit only to a power supply of the type described in the operating instructions, or as marked on the unit.

- **Power Cord Protection**

Route power supply cords so that they are not likely to be walked on or pinched by items placed on or against them, paying particular attention to the cord plugs at power receptacles and at the point at which they exit from the unit.

- **Water and Moisture**

Do not use the unit near water—for example, near a sink, in a wet basement, near a swimming pool, near an open window, etc.

- **Object and Liquid Entry**

Do not allow objects to fall or liquids to be spilled into the enclosure through openings.

- **Servicing**

Do not attempt any service beyond that described in the operating instructions. Refer all other service needs to qualified service personnel.

- **Damage Requiring Service**

The unit should be serviced by qualified service personnel when:

- The power supply cord or the plug has been damaged.
- Objects have fallen or liquid has been spilled into the unit.
- The unit has been exposed to rain.
- The unit does not appear to operate normally or exhibit a marked change in performance.
- The unit has been dropped or the enclosure has been damaged.

Cleaning

To clean this product, lightly dampen a lint-free cloth with plain water or a mild detergent and wipe the outer surfaces.

NOTE: Do not use harsh chemicals as damage to the unit may occur.

Federal Communications Commission Notice

This equipment has been tested and found to comply with the limits for a Class B digital device, pursuant to Part 15 of the FCC Rules. These limits are designed to provide reasonable protection against harmful interference in a residential installation. Any changes or modifications not expressly approved by the party responsible for compliance could void the user's authority to operate the device. This equipment generates, uses, and can radiate radio frequency energy and, if not installed and used in accordance with the instructions, may cause harmful interference to radio communications. However, there is no guarantee that interference will not occur in a particular installation. If this equipment does cause harmful interference to radio or television reception, which can be determined by turning the equipment off and on, the user is encouraged to try to correct the interference by one or more of the following measures:

- Reorient or relocate the receiving antenna.
- Increase the separation between the equipment and the receiver.
- Connect the equipment into an outlet on a circuit different from that to which the receiver is connected.
- Consult the dealer or an experienced radio/TV technician for help.

This device complies with Part 15 of the FCC Rules. Operation is subject to the following two conditions:

1. This device may not cause harmful interference.
2. This device must accept any interference received including interference that may cause undesired operation.

Industry Canada Compliance Statement

This device complies with Industry Canada license-exempt RSS standard(s). Operation is subject to the following two conditions:

1. This device may not cause harmful interference.
2. This device must accept any interference received including interference that may cause undesired operation.

Declaration of Conformity (DoC)

The Declaration of Conformity for this product can be found on the RTI website at:

www.rticontrol.com/declaration-of-conformity

Contacting RTI

For news about the latest updates, new product information, and new accessories, please visit our website at:

www.rticontrol.com

For general information, you can contact RTI at:

Remote Technologies Incorporated

5775 12th Ave. E Suite 180

Shakopee, MN 55379

Tel. +1 [952-253-3100](tel:952-253-3100)

info@rticontrol.com

Service & Support

If you are encountering any problems or have a question about your RTI product, please contact RTI Technical Support for assistance (see the Contacting RTI section of this guide for contact details). RTI provides technical support by telephone or e-mail. For the highest quality service, please have the following information ready:

- Your Name
- Company Name
- Telephone Number
- E-mail Address
- Product model and serial number (if applicable)

If you are having a problem with hardware, please note the equipment in your system, a description of the problem, and any troubleshooting you have already tried.

Please do not return products to RTI without return authorization.

Limited Warranty

RTI warrants new products for a period of three (3) years (excluding consumables such as rechargeable batteries which are warrantied for one (1) year) from the date of purchase by the original purchaser (end-user) directly from RTI / Pro Control (herein referred to as "RTI"), or an authorized RTI dealer. Warranty claims may be initiated by an authorized RTI dealer using the original dated sales receipt or other proof of warranty coverage. In the absence of the receipt of purchase from the original dealer, RTI will provide warranty coverage extension of six (6) months from the date code of the product.

Note: RTI warranty is limited to the provisions set forth in this policy and does not preclude any other warranties offered by third parties who are solely responsible for those other warranties. Except as specified below, this warranty covers defects in product material and workmanship.

The following are not covered by the warranty:

- Product purchased via unauthorized sellers or internet sites will not be serviced- regardless of purchase date.
- Damages caused by accident, misuse, abuse, neglect or acts of God.
- Cosmetic damage, including, but not limited to, scratches, dents and normal wear and tear.
- Failure to follow instructions contained in the Product Installation Guide.
- Damages due to products used in an application or environment other than that for which it was intended, improper installation procedures or adverse environmental factors such as incorrect line voltages, improper wiring, or insufficient ventilation.
- Repair or attempted repair by anyone other than RTI and Pro Control or authorized service partners.
- Failure to perform recommended periodic maintenance.
- Causes other than product defects, including lack of skill, competence or experience of user.
- Damage due to shipment of this product (claims must be made to the carrier).

- Altered unit or altered serial number: defaced, modified or removed.

RTI Control is also not liable for:

- Damages caused by its products or for failure of its products to perform, including any labor costs, lost profits, lost savings, incidental damages, or consequential damages.
- Damages based upon inconvenience, loss of use of the product, loss of time, interrupted operation, commercial loss, any claim made by a third party or made on behalf of a third party.
- Loss of, or damage to, data, computer systems or computer programs.

RTI's liability for any defective product is limited to repair or replacement of the product, at the sole discretion of RTI. In cases where the warranty policy conflicts with local laws, the local laws will be adopted.

Disclaimer

All rights are reserved. No part of this document may be photocopied, reproduced, or translated without the prior written notice of Remote Technologies Incorporated. The information contained in this document is subject to change without notice. Remote Technologies Incorporated shall not be liable for errors or omissions contained herein or for consequential damages in connection with the furnishing, performance, or use of this guide. Integration Designer and the RTI logo are registered trademarks of Remote Technologies Incorporated. Other brands and their products are trademarks or registered trademarks of their respective holders.

ISED Statement

This device contains license-exempt transmitter(s)/receiver(s) that comply with Innovation, Science and Economic Development Canada's licence-exempt RSS(s). Operation is subject to the following two conditions:

- This device may not cause interference.
- This device must accept any interference, including interference that may cause undesired operation of the device.

The digital apparatus complies with Canadian CAN ICES-3 (B)/NMB-3(B).

This equipment complies with Canada radiation exposure limits set forth for an uncontrolled environment.

This equipment should be installed and operated with minimum distance 20cm between the radiator & your body.

The device for operation in the band 5150–5250 MHz is only for indoor use to reduce the potential for harmful interference to co-channel mobile satellite systems.

This radio transmitter has been approved by Industry Canada to operate with the antenna types listed with the maximum permissible gain indicated. Antenna types not included in this list, having again greater than the maximum gain indicated for that type, are strictly prohibited for use with this device.

Remote Technologies Incorporated

5775 12th Avenue East, Suite 180

Shakopee, MN 55379

Tel: [952-253-3100](tel:952-253-3100)

www.rticontrol.com

© 2024 Remote Technologies Inc. All rights reserved.

Technical Support: support@rticontrol.com

Customer Service: custserv@rticontrol.com

Documents / Resources

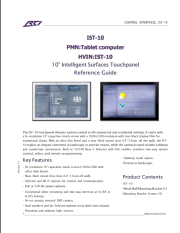
	<p>RTI IST-10 10 Inch Intelligent Surfaces Touchpanel Tablet Computer [pdf] User Guide</p> <p>IST-10, IST-10 10 Inch Intelligent Surfaces Touchpanel Tablet Computer, 10 Inch Intelligent Surfaces Touchpanel Tablet Computer, Intelligent Surfaces Touchpanel Tablet Computer, Surfaces Touchpanel Tablet Computer, Touchpanel Tablet Computer, Tablet Computer, Computer</p>
---	---

References

- [User Manual](#)

Manuals+, Privacy Policy

This website is an independent publication and is neither affiliated with nor endorsed by any of the trademark owners. The "Bluetooth®" word mark and logos are registered trademarks owned by Bluetooth SIG, Inc. The "Wi-Fi®" word mark and logos are registered trademarks owned by the Wi-Fi Alliance. Any use of these marks on this website does not imply any affiliation with or endorsement.