



ROYALAXE B0C6PZ7D6C X ProtoArc L98 Wireless Mechanical Keyboard User Manual

[Home](#) » [ROYALAXE](#) » ROYALAXE B0C6PZ7D6C X ProtoArc L98 Wireless Mechanical Keyboard User Manual 

ROYALAXE B0C6PZ7D6C X ProtoArc L98 Wireless Mechanical Keyboard User Manual



Contents

- 1 [Function Overview](#)
- 2 [Wired Connection](#)
- 3 [2.4G Connection](#)
- 4 [Bluetooth Connection](#)
- 5 [Mode Switching](#)
- 6 [iOS/Mac/Win layout switching](#)
- 7 [LCD Screen](#)
- 8 [Sketchpad Mode](#)
- 9 [Custom Driver](#)
- 10 [Technical Specifications](#)
- 11 [System Requirement](#)
- 12 [Troubleshooting](#)
- 13 [Attention](#)
- 14 [Switch Replacement](#)
- 15 [Important Safety and Compliance Information](#)
- 16 [Dear customer,](#)
- 17 [Documents / Resources](#)
 - 17.1 [References](#)
- 18 [Related Posts](#)

Function Overview

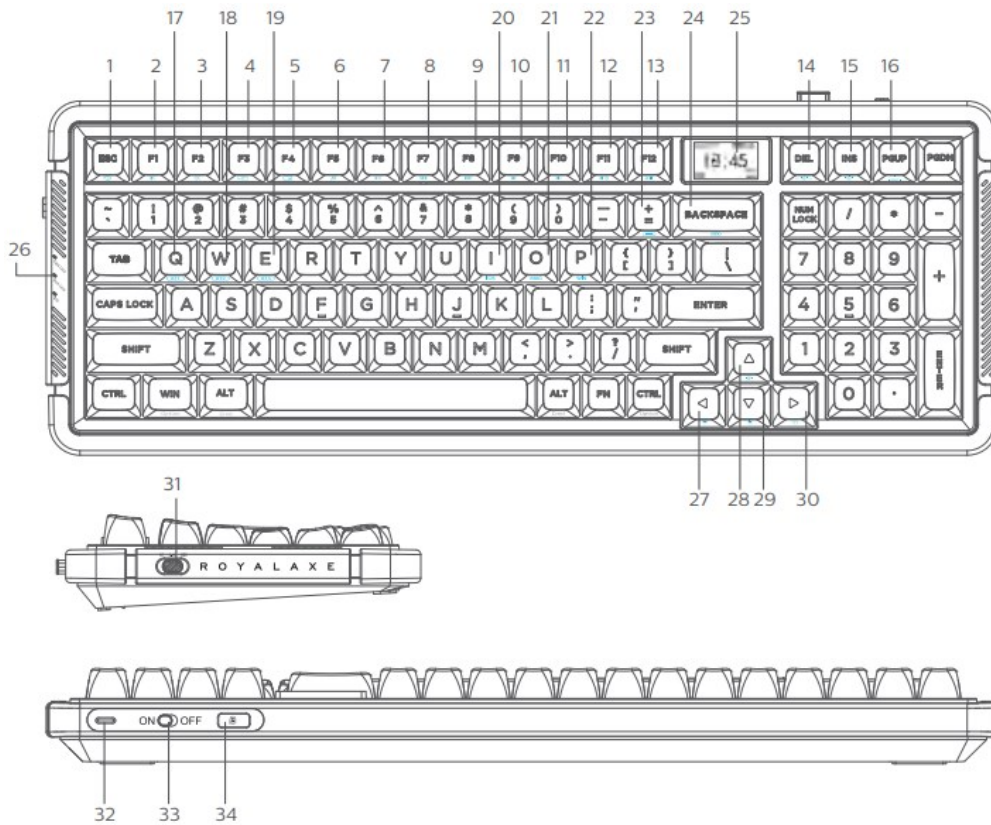

1. Fn+: Reset
2. Fn+ : Screen brightness –
3. Fn+: Screen brightness +
4. Fn+: Multi screen display
5. Fn+: Back to the desktop
6. Fn+: Media Playe
7. Fn+: Play/Pause
8. Fn+: Prev song
9. Fn+: Next song
10. Fn+: Mute
11. Fn+: Volume –
12. Fn+: Volume +
13. Fn+: Input method switching
14. Fn+: RGB Light switch
15. Fn+: Switch the RGB light mode
16. Fn+: Switch the RGB light strip mode/Turn off the RGB light strip
17. Fn+: Bluetooth mode 1
18. Fn+: Bluetooth mode 2
19. Fn+: Bluetooth mode 3
20. Fn+: Switch to IOS system
21. Fn+: Switch to MAC system
22. Fn+: Switch to WIN system
23. Fn+: Battery indicator

24. Fn+: Monochromatic light switching
25. . LCD Color Screen
26. Capl Lock: Caps lock indicator
Num Lock: Num lock indicator
:Low battery indicator
27. Fn+: Decrease the RGB light frequency
28. Fn+: Increase the RGB light brightness
29. Fn+: Decrease the RGB light brightness
30. Fn+: Increase the RGB light frequency
31. Wired mode
2.4G wireless mode
BT Bluetooth mode
32. Type-C charging/wired interface
33. ON/OFF power switch
34. 2.4G receiver

Wired Connection

1. Insert the TYPE-C interface of the charging cable into the keyboard, and connect the USB interface to your computer.

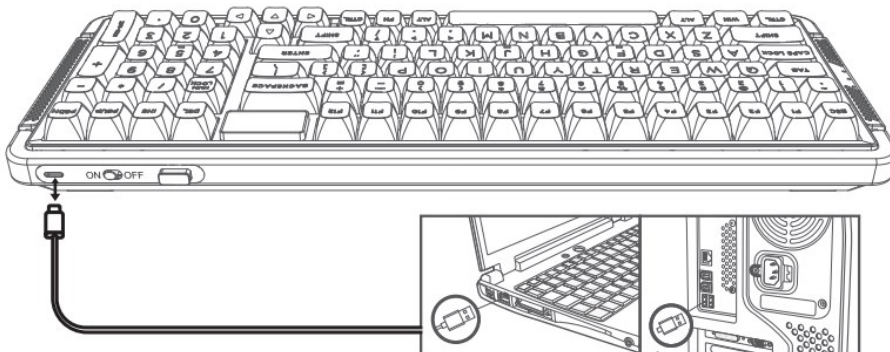

2. Switch to wired mode

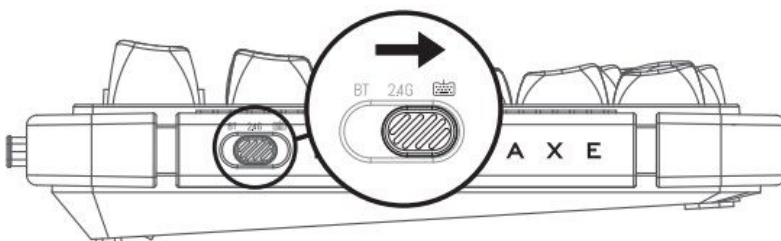

3. The LCD Color Screen displays “**CONNECTED**”, indicating a successful connection.



Note:

In TYPE-C wired mode, the “ON/OFF” switch has no function

2.4G Connection

1. Turn the power switch to ON

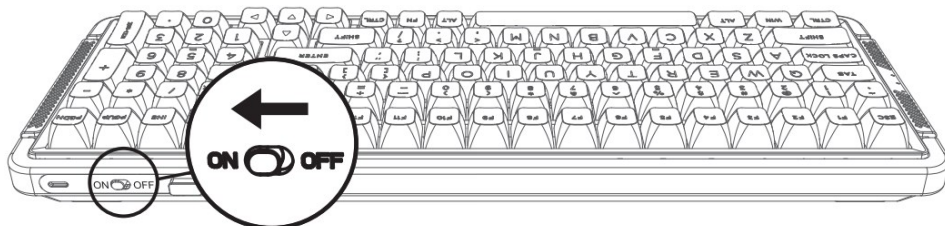

2. Take out the dongle and insert the dongle into the USB port of the computer.

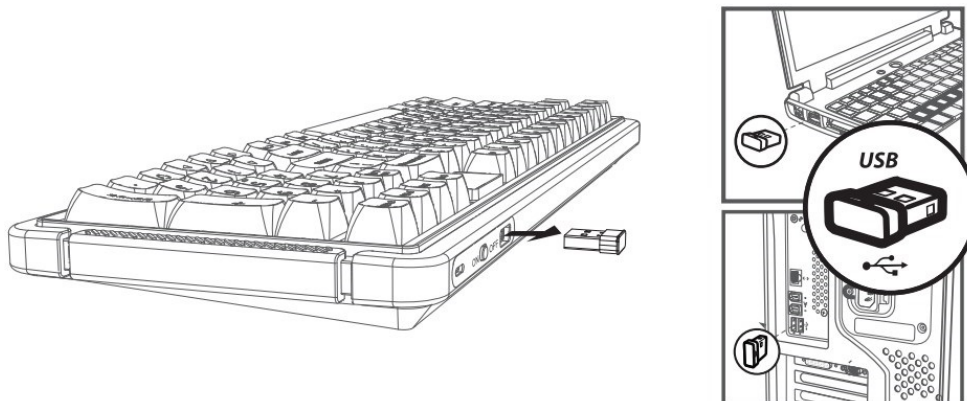

3. Switch to 2.4G mode

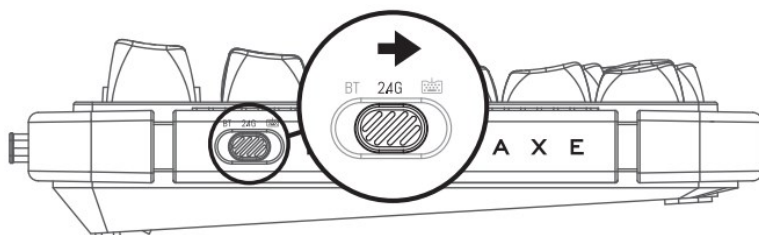

4. The LCD Color Screen displays “CONNECTED”, indicating a successful connection.



Bluetooth Connection

1. Turn the power switch to ON. Switch to BT mode.

Take the connection to BT1 as an example as follows:

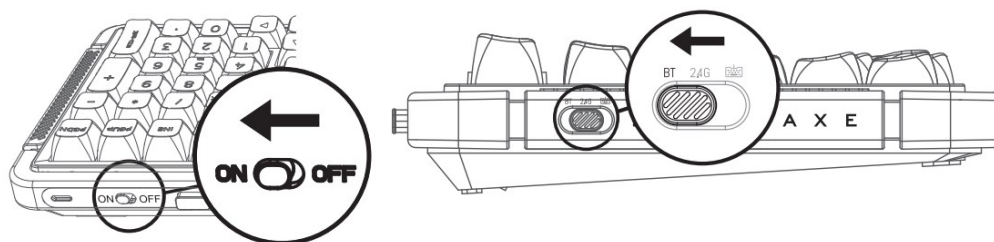

2. The LCD Color Screen displays “UNLINKING”. Long press the Fn+Q keys about 3 to 5 seconds, and the corresponding indicator below will flash quickly. The LCD Color Screen displays “PAIRING”.



3. Turn on the Bluetooth of your computer or other devices, search and select “L98 BT3.0” or “L98 BT5.0” and start Bluetooth pairing. The LCD Color Screen displays “Connected”, indicating a successful connection.

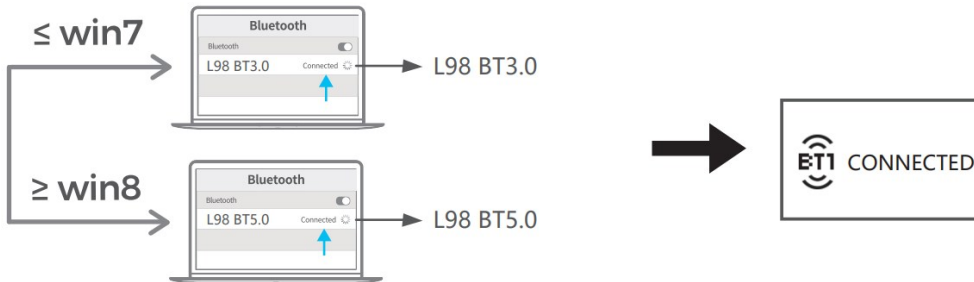

Notice:

1. Windows 7 and below system versions do not support Bluetooth 5.0;
2. The device number corresponding to Bluetooths 3.0 is L98 BT3.0, and the device number corresponding to Bluetooth 5.0 is L98 BT5.0

Mode Switching

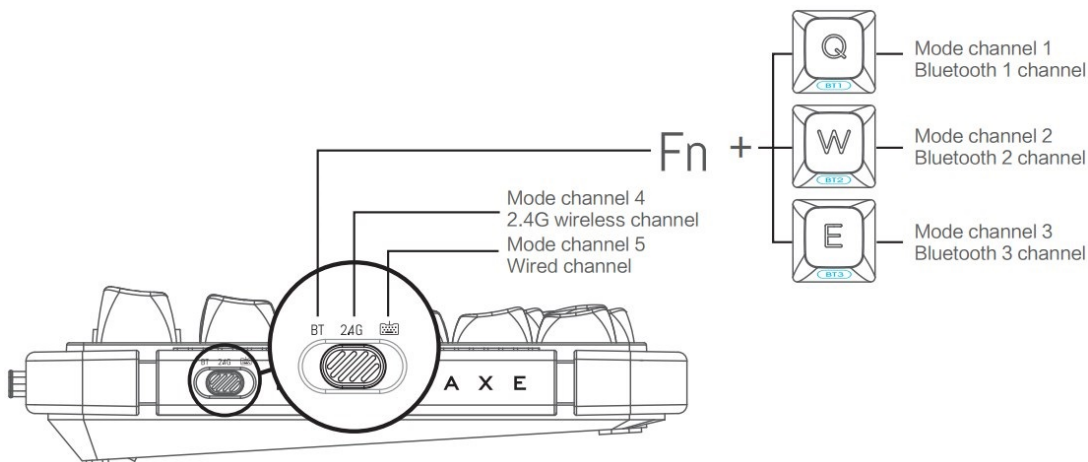

1. Mode channel: The keyboard has 5 channels, BT1, BT2, BT3, 2.4G, wired, and 5 devices can be connected at the same time.
2. Mode switch: Turn the switch between Wired/2.4G/BT. Press Fn + Q, W or E to switch between different Bluetooth channels of BT1, BT2 and BT3.

iOS/Mac/Win layout switching

Short press to switch system layout

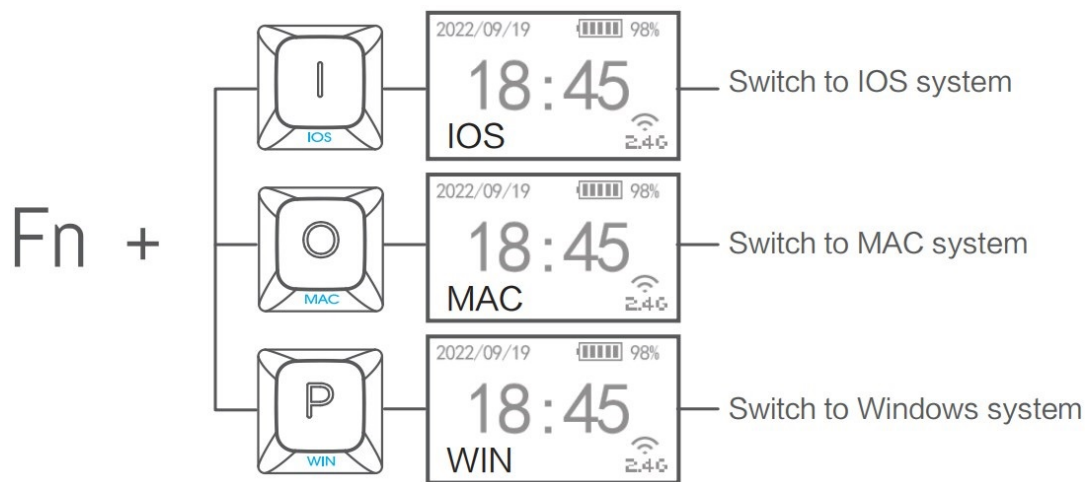

Note: the default setting is Windows layout.

LCD Screen

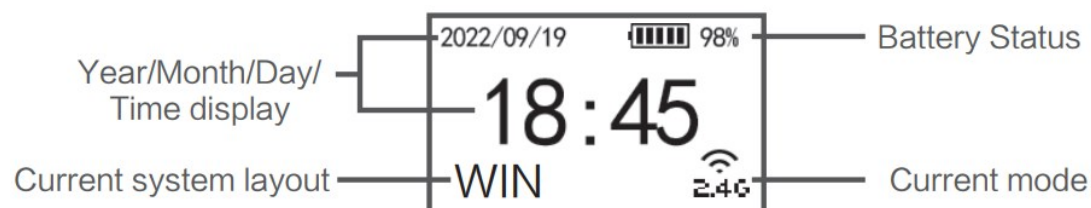
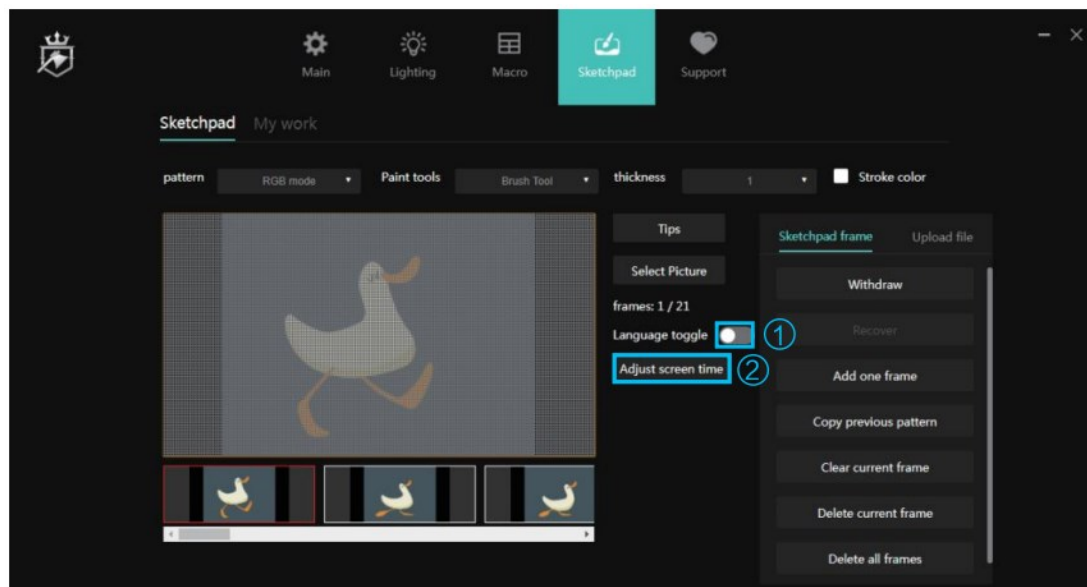

Note: Click “Adjust Screen Time” to update the date and time displayed on the LCD screen (retrieve the current time from the computer).

Sketchpad Mode

1. Select “RGB mode”.
2. Select the prepared GIF animation and drag it into the area ②

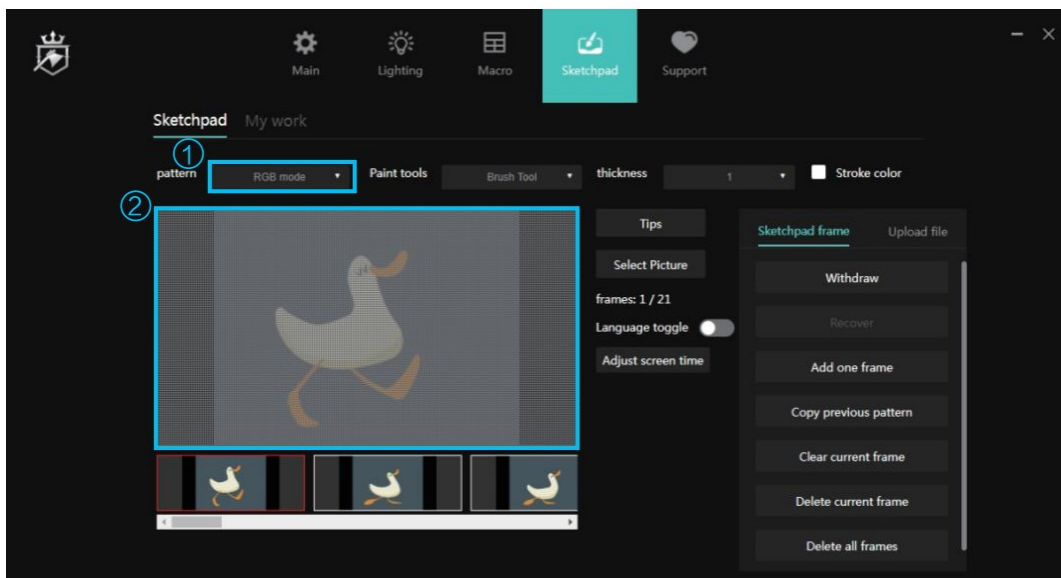

3. Click the “Upload file” option.
4. Select “Preview gif” to view the imported animation.
5. Select “Upload gif” to upload animation to the LCD screen.

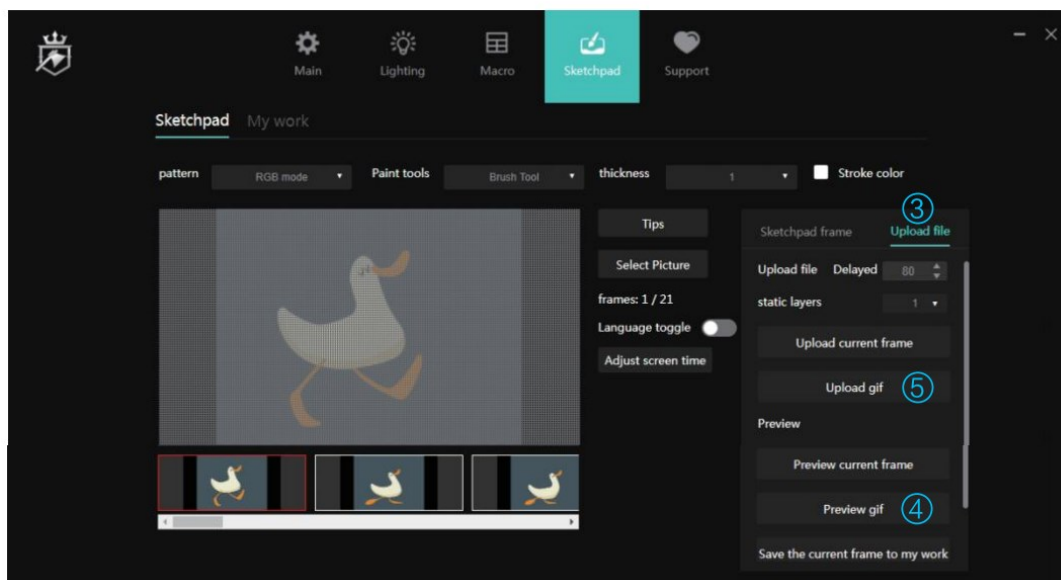



6. After a successful upload, the display screen will show the customized animation. Press FN+Ctrl to switch back to the default style.

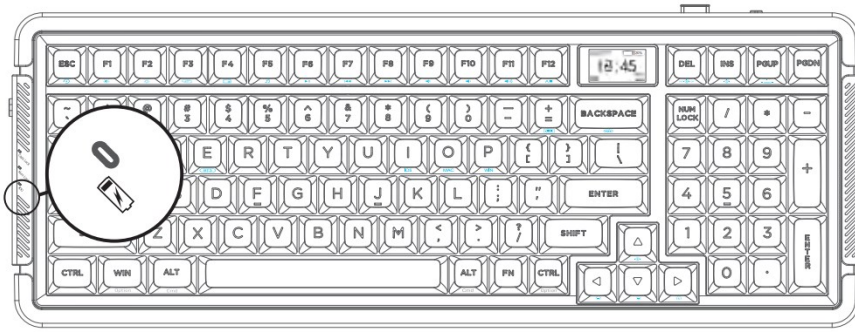

Charging Guide:

1. **Low voltage reminder**  : The light flashes red to remind low voltage.



2. When the charging cable's Type-C interface is plugged into the keyboard and the USB interface is connected to your computer, the charging process begins, the light  stays red continuously. and the battery icon in LCD screen displays charging animation.

3.  When charging is complete, the green light illuminates, and the LCD screen displays the battery at 100%.

Notice:

During the charging process, all modes are not controlled by the "ON/OFF" switch and are directly powered by the charging cable

Custom Driver

For custom mode please go to the following URL to download official driver.

<https://www.protoarc.com>

Find "Support" from the Header Menu > "Driver Download"

Note: The driver can only be used in wired and 2.4G mode.

Technical Specifications

- **Connection method:** wired / 2.4GHz / Bluetooth 3.0 / Bluetooth 5.0
- **Wireless range:** 2.4GHz(49ft/15 meters), Bluetooth(33ft/10 meters)
- **Working current and voltage:** 5V, 500mA(max)
- **Keyboard keys:** 98
- **Keycap material:** PBT
- **Mechanical switch lifespan:** 100 million times
- **Lithium battery capacity:** 6000mAh
- **Keyboard product size:** 15.8" x 5.9" x 1.5"
- **Weight:** 2.5 lbs

System Requirement

1. 1 x USB port
2. Bluetooth 3.0/Bluetooth 5.0
3. Windows® 7, Windows® 8, Windows® 10 or later, Android 3.2 and above; Mac OS 10.5 or later

Note Multimedia functions are partially invalid in different OS versions.

Troubleshooting

1. Ensure that the product's USB wireless receiver is properly inserted into the computer's USB port.
2. Ensure that your computer meets the minimum system requirements.
3. If the product and the wireless receiver are beyond the effective connection distance, please reduce the distance between the product and the receiver.

Attention

1. For cleaning, please use dry, soft cotton fabric, etc.
2. Do not fold or bend the product.
3. Do not forcefully disassemble the product.
4. Avoid getting the product wet, exposed to direct sunlight, or near open flames.
5. Do not directly rinse with water.
6. The keyboard is designed to be charged with a rated voltage of 5V based on the USB protocol. Please use the computer's USB interface for charging and avoid using a charger to charge the keyboard.
7. During use, prevent liquids from entering the internal components, as this may cause short circuits and electrical malfunctions.

Switch Replacement

1. Use the keycap puller(included) to pull out the keycap.

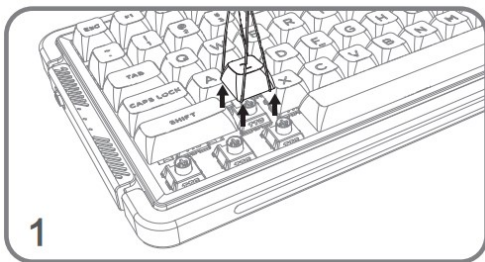

2. Pull out the switch with the switch puller(included).

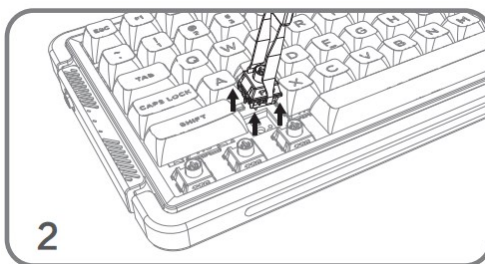

3. To install the new switch, align it with the corresponding holes on the keyboard.

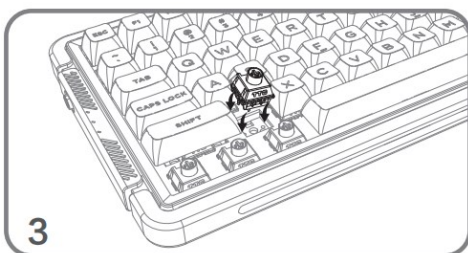

4. Place the new switch on the socket.

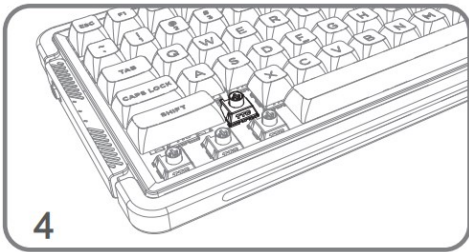

5. Gently press the new switch into the socket

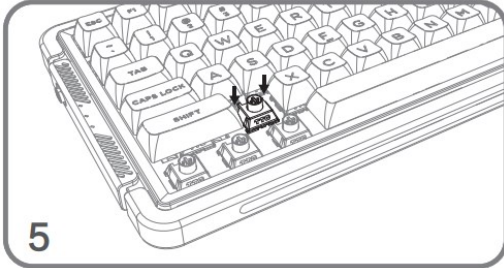

6. Once the keycap is installed, it can be used normally

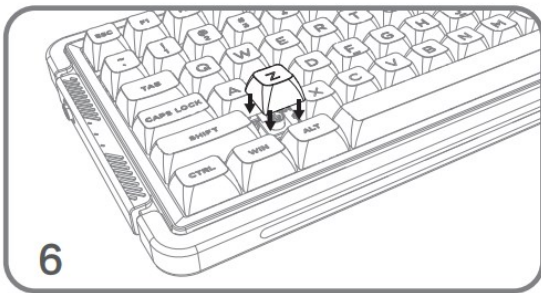

Important Safety and Compliance Information

Disposal of product and packing material Important Safety and Compliance Information

Waste Electrical and Electronic Equipment-WEEE



— This symbol on the product or on its packaging indicates that this product must not be disposed of with your household waste. Instead, it is your responsibility to dispose of your waste equipment by handing it over to a designated collection point for the recycling or waste electrical and electronic equipment. The separate collection and recycling of your waste equipment at the time of disposal will help to conserve natural resource and ensure that it is recycled in a manner that protects human health and the environment. For more information about where you can drop off your waste equipment for recycling, please contact the local city office, the household waste disposal service or the shop where you purchased the product.

CE Declaration of Conformity

This device complies with the requirements set out in the Council Directive on the Approximation of the Laws of the Member States relating to Electromagnetic Compatibility Directive (2014/30/EU), RoHS directive (2011/65/EU) and Radio Equipment Directive (2014/53/EU)(for Radio Equipment) This product has been tested and found to comply with the harmonized standards for Information Technology Equipment, these harmonized standards published under Directives of Official Journal of the European Union.

Federal Communications Commission (FCC) Notice

This equipment has been tested and found to comply with the limits for a Class B digital device, pursuant to Part 15 of the FCC Rules. These limits are designed to provide reasonable protection against harmful interference in a

residential installation. This equipment generates, uses and can radiate radio frequency energy and, if not installed and used in accordance with the instructions, may cause harmful interference to radio communications.

However, there is no guarantee that interference will not occur in a particular installation. If this equipment does cause harmful interference to radio or television reception, which can be determined by turning the equipment off and on, the user is encouraged to try to correct the interference by one or more of the following measures:

- Reorient or relocate the receiving antenna.
- Increase the separation between the equipment and receiver.
- Connect the equipment into an outlet on a circuit different from that to which the receiver is connected.
- Consult the dealer or an experienced radio/TV technician for help.

Changes or modifications not expressly approved by the party responsible for compliance could void the user's authority to operation the equipment.

THIS CLASS B DIGITAL APPARATUS MEETS ALL REQUIREMENTS OF THE CANADIAN INTERFERENCE – CAUSING EQUIPMENT REGULATIONS.

FCC Compliance Statement

This device complies with Part 15 of the FCC Rules. Operation is subject to the following two conditions: (1) this device may not cause harmful interference, and (2) this device must accept any interference received, including interference that may cause undesired operation.

Dear customer,

Thank you for purchasing ROYALAXE x ProtoArc products. To ensure you receive reliable after-sales service, please read the following instructions carefully. The product warranty period is valid for one year from the date of purchase (the date of receipt of the return receipt and the invoice date of the buyer)

The following situations are not covered by the after-sales service:

1. Inability to provide a valid warranty card and invoice (excluding those that can prove the product is within the valid warranty period) or any unauthorized alteration of the warranty.
2. The product model and serial number on the warranty card do not match the physical product or lack the distributor's seal.
3. Alteration, removal, or illegibility of the model number, serial number, or production date code on the product.
4. Defects resulting from excessive use outside the intended purpose, such as non-stop use in a commercial environment.
5. Damage caused by not using the product in accordance with the provided instructions.
6. Damage caused by the use of pirated software or computer viruses during use.
7. Damage caused by accidents, unauthorized repair, or service from unapproved vendors.
8. Damage caused by force majeure.
9. Product malfunction due to accidental disconnection, signal interference, or other influencing factors during use.
10. Normal wear and tear defects or defects in consumable parts by nature.
11. The product not functioning properly because it was not originally designed, manufactured, or approved for use in the country where you use the product, which might occur when you imported the product. If the product functions you purchased are defective or cannot be used normally, please contact your local retailer.

The serial number filled in the form must match the actual product. This certificate is the primary document for after-sales service, so please keep it safe. If you need technical support, please present this warranty card, and we will provide quality and professional services.

Customer Support:
Email: support@protoarc.com

Co-created by ProtoArc x RoyalAxe

Manufacturer: Dongguan Lingjie Electronics & Technology Co.,
Ltd Address: No. 23 Zhenxing North Road, Xiegang Town, Dongguan,Guangdong, China
Web:<https://www.protoarc.com>



Documents / Resources

	<p>ROYALAXE B0C6PZ7D6C X ProtoArc L98 Wireless Mechanical Keyboard [pdf] User Manual</p> <p>B0C6PZ7D6C X ProtoArc L98 Wireless Mechanical Keyboard, B0C6PZ7D6C, X ProtoArc L98 Wireless Mechanical Keyboard, L98 Wireless Mechanical Keyboard, Wireless Mechanical Keyboard, Mechanical Keyboard, Keyboard</p>
--	--

References

-  [ProtoArc® Better Workspace: Portable & Comfortable & Efficient](#)