



RK61 Manual: Learn How to Use Royal Kludge Mechanical Keyboard

[Home](#) » [ROYAL KLUDGE](#) » **RK61 Manual: Learn How to Use Royal Kludge Mechanical Keyboard**

The ROYAL KLUDGE RK61 Mechanical Keyboard User Manual provides detailed instructions on how to use the keyboard effectively. This manual includes information on wired mode and charging, Bluetooth connection, backlight control, and multimedia keys for both Windows and Mac operating systems. The manual also outlines system requirements for Bluetooth mode and provides an FCC statement regarding compliance with Part 15 of the FCC Rules. Additionally, the FAQ section answers common questions about the keyboard's compatibility with various devices and switches. The manual is a comprehensive guide for users who want to optimize their experience with the ROYAL KLUDGE RK61 Mechanical Keyboard.

Contents [[hide](#)]

- [1 ROYAL KLUDGE RK61 Mechanical Keyboard User Manual](#)
- [2 Product Base](#)
- [3 Wired mode and charging](#)
- [4 Bluetooth connection](#)
- [5 Backlight control method](#)
- [6 WINDOWS Multimedia key](#)
- [7 MAC Multimedia eky](#)
- [8 System requirement](#)
- [9 FCC Statement](#)
- [10 SPECIFICATION](#)
- [11 FAQs](#)
- [12 VIDEO](#)
- [13 Documents / Resources](#)
- [14 Related Posts](#)





ROYAL KLUDGE RK61 Mechanical Keyboard User Manual

Product Base



keyboard

Wired mode and charging

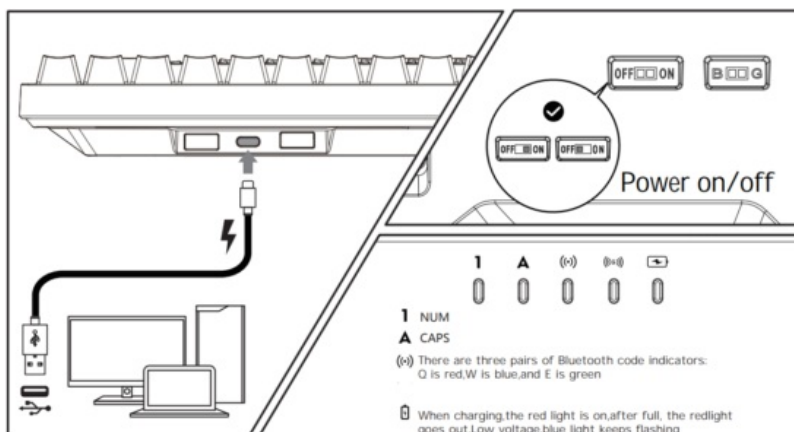

Bluetooth connection

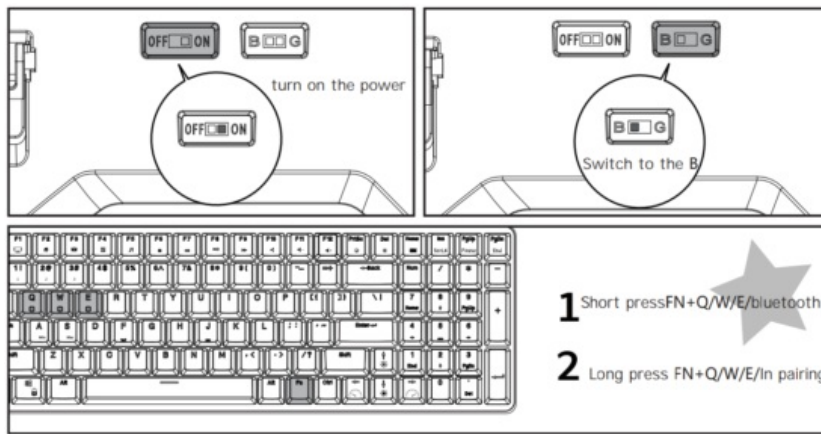

Backlight control



Backlight control method

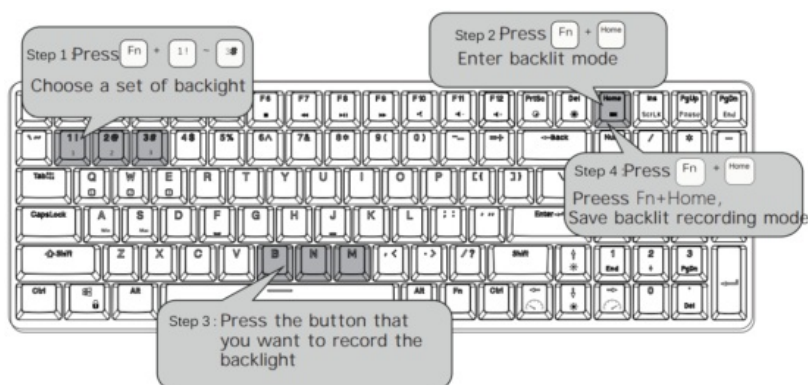

WINDOWS Multimedia key

Windows mode (FN+A: Cut Windows)

- My Computer



- Explorer

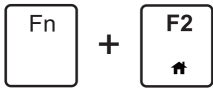

- Mailbox

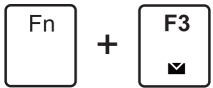

- Calculator



- Player

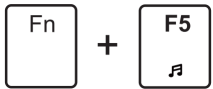

-



- Previous



- Play/pause



- Next



- Mute



- Volume-



- Volume+



MAC Multimedia eky

MAC OS FN+s CUT MAC OS MAC OS AND ALT Key seap

- Previous



- Play/pause

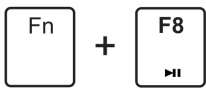

- Next

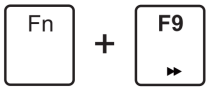

- Mute

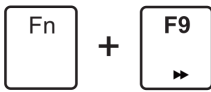

- Volume-



- Volume+



System requirement

Bluetooth mode

- bluetooth 3.0, bluetooth 5.1 or a later version of the device
- PC: Windows 7 or higher
- **Mac:** macOS X 10.6 Snow Leopard or higher
- **ios:** iPad/iphone 5 or higher
- **Android:** 5.0 or higher

FCC Statement

This device complies with Part 15 of the FCC Rules. Operation is subject to the following two conditions:

1. this device may not cause harmful interference, and
2. this device must accept any interference received, including interference that may cause undesired operation

NOTE: This equipment has been tested and found to comply with the limits for a Class B digital device, pursuant to Part 15 of the FCC Rules. These limits are designed to provide reasonable protection against harmful interference in a residential installation. This equipment generates, uses and can radiate radio frequency energy and, if not installed and used in accordance with the instructions, may cause harmful interference to radio communications. However, there is no guarantee that interference will not occur in a particular installation.

If this equipment does cause harmful interference to radio or television reception, which can be determined by turning the equipment off and on, the user is encouraged to try to correct the interference by one or more of the following measures:

- Reorient or relocate the receiving antenna.
- Increase the separation between the equipment and receiver.
- Connect the equipment into an outlet on a circuit different from that to which the receiver is

connected.

- Consult the dealer or an experienced radio/TV technician for help.

Warning: changes or modifications not expressly approved by the party responsible for compliance could void the user's authority to operate the equipment

The device has been evaluated to meet general RF exposure requirements; the device can be used in portable exposure conditions without restriction.

SPECIFICATION

FAQS

Did it work on ps4 Fortnite

Plug it in to ps4 it should work

Are the hot-swappable RGB gaming keyboard fits for 5pin keycaps?

Yes, 3/5 pin mechanical switches hot swappable.

Does this keyboard support the same feature as the wired/wireless version and is it supported with consoles?

No. It can't.

What brand of switches are used in this keyboard as of right now?

All 3-pin/5-pin mechanical switches.

How long is the keyboard

13.03 x 5.98 x 1.93 inches.

Do the stabilizers snap into the pcb or screw in?

snap in

Will you be having a full restock anytime soon?

5.1-5.5.

What is the actuation force for the brown switch?

Gateron Blue Switch: The blue switch offers "clicky" tactile feedback that certainly works for gamers or those who are in favor of the "ka ka" sound and the rhythm of typing (Actuation Force 60g Distance to Actuation 2.3mm)

Gateron Brown Switch: It is more slighter, quieter and easier to trigger than blue switches. It is suitable for the starters of mechanical keyboard. Actuation Force 55g Distance to Actuation 2.0mm

Gateron Red Switch: The linear switch that offers smoother, quieter and faster tactile feedback than brown switches, making it especially popular among gamers. And red switch is the best switch that can be used in office. Actuation Force 40g Distance to Actuation 2.0mm

Which switches are the fastest?

Gateron linear reds for gaming and yellows for typing.

It have optical switches?

Mechanical switches.

Can you connect a rk61 bluetooth keyboard to a ps4 pro?

Yes.

are they PBT keycaps?

No,it's not PBT keycaps,it's ABS keycaps !

Does this version use the Gateron Switches?

They use kailh switches not gateron

Is it hot swappable?

it is hot swappable, they guy who said it wasn't was lying. it supports 3 and 5 pin switches

is it a bluetooth keyboard?

No, this is not a Bluetooth keyboard, this version is a mechanical keyboard of RK61 Type-C USB wired version, but we also produce RK61 wireless version, but not this

what switches the rk61 use and is it hot swappable

This is a axis switch, not hot-swappable



[ROYAL KLUDGE RK61 Mechanical Keyboard](#)

VIDEO



ROYAL KLUDGE RK61 Mechanical Keyboard
www.rkgamingstore.com

Documents / Resources

| | |
|---|--|
|  | ROYAL KLUDGE RK61 Mechanical Keyboard [pdf] User Manual RK61, 2A4MQ-RK61, 2A4MQRK61, RK61, Mechanical Keyboard |
|  | ROYAL KLUDGE RK61 Mechanical Keyboard [pdf] User Manual RK61, Mechanical Keyboard |
|  | ROYAL KLUDGE RK61 Mechanical Keyboard [pdf] User Manual RK61 Mechanical Keyboard, RK61, Mechanical Keyboard, Keyboard |