



Roxtone XT-433 Two-Way Professional Radio Instruction Manual

[Home](#) » [ROXTONE](#) » Roxtone XT-433 Two-Way Professional Radio Instruction Manual 

Contents

- [1 Roxtone XT-433 Two-Way Professional Radio](#)
- [2 Product Information](#)
- [3 Product Usage Instructions](#)
- [4 BATTERY](#)
- [5 INITIALIZATION](#)
- [6 BASIC FUNCTIONS](#)
- [7 DEVICE DESCRIPTION](#)
- [8 Documents / Resources](#)
 - [8.1 References](#)

Roxtone

Roxtone XT-433 Two-Way Professional Radio



Product Information

The Roxtone XT-433 is a professional two-way radio designed for reliable communication. It operates on the UHF frequency and has a power output of 4/5W. The radio features 16 channels, 50 CTCSS tones, and 107 DCS codes for enhanced privacy and interference reduction. It is PC-programmable, allowing for easy customization of settings. The Li-ion battery has a capacity of 1300mAh, providing extended usage time. The device comes with various safety features and precautions to ensure user safety.

Product Usage Instructions

- 1. Safety Information:** Before using the device, read the safety information provided in the manual carefully. Follow the recommended precautions to prevent fire, personal injury, or device damage. Turn off the device in explosive atmospheres.
- 2. Unpacking and Checking the Equipment:** Carefully unpack the device and check for any missing or damaged items. If there are any issues, contact the supplier.
- 3. Battery Charging:** To ensure optimal battery performance, fully charge and discharge the battery 2 or 3 times initially. Use only approved original batteries for compatibility and safety. Avoid shorting the battery terminals or disposing of the battery in fire. Never remove the casing from the battery pack.

4. **Battery Replacement:** Replace or charge the battery when the power is low. If the battery operating time decreases despite correct charging, it should be replaced you notice any faults such as swelling or heating, immediately cease operating the device, switch off the power, remove the battery pack, and contact the supplier.
5. **Battery Charging Precautions:** Always switch off the device before charging. Do not plug/unplug the AC adapter and battery during charging. Do not recharge the battery if it is already fully charged. Do not recharge the device if the battery or other parts are wet. Ensure the device is dry before charging. Recharge the battery and operate the chargers only with personnel present.
6. **Antenna Installation:** Follow the instructions provided to install the antenna correctly.
7. **Basic Operations:** Familiarize yourself with the device's basic functions and controls as described in the manual
8. **Device Description:** Refer to the manual for a detailed description of the device's components and their functions.

For further assistance or maintenance service, contact the supplier using the provided contact information.

Roxtone XT-433 Two-way professional radio

4/5 W 16CH 50 CTCSS 107 DCS PC-programmable Li-ion battery 1300mAh

Please read this instruction manual carefully before using the device. The device is delivered with pre-programmed channels designed for your operations. You can freely use all the channels. Please contact the supplier about channels and channel-related changes.

SAFETY INFORMATION

Maintenance must be performed by the engineers approved by Suomen Yhtey-syrytykset Oy. You can request maintenance service with the contact form at www.roxtone.fi or by sending email to info@roxtone.fi

Safety:

The user needs to understand the hazards common to the operation of the device. We do not guarantee the safety and functionality of the device when using accessories not approved by Suomen Yhteyspiste. Use only Roxtone chargers and accessories.

WARNING: Turn off the device when in an explosive atmosphere (gases, dust, fumes, etc.), for example, at fuel stations.

Precautions:

Observe the following precautions to prevent fire, personal injury, or device damage:

- Do not modify or attempt to adjust the settings of the device.
- Do not expose the device to direct sunlight for long periods nor place it close to heat sources.
- If an abnormal odor or smoke is detected coming from the device, switch off the power immediately and remove the battery pack from the rear. Contact the supplier.

UNPACKING AND CHECKING THE EQUIPMENT

Carefully unpack the device. If any items are missing or have been damaged during shipment, please contact the supplier.

BATTERY

Charging:

The standard durability and functionality of the battery are achieved only when fully charging and discharging it 2 or 3 times. This applies also to reusing a battery after a longer storage time of 2 months.

Charging steps:

1. Plug the AC adaptor cable into the adaptor jack.
2. Slide the battery pack or radio with a battery pack into the charger.
3. Plug the AC adaptor into the AC outlet.
4. Make sure the battery pack contacts are in contact with the charging terminals, the charger LED lights are red and charging begins.
5. The green LED indicates that the charging is completed. Remove the battery or the radio from the charger.

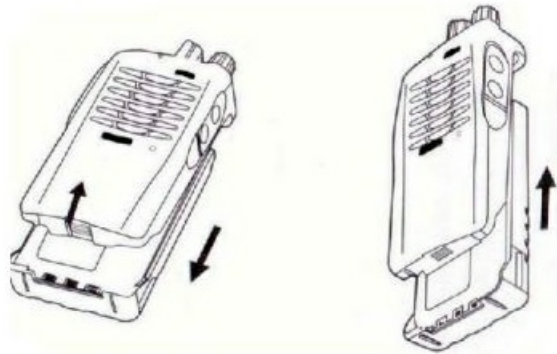

Note:

1. The LED light of the charger lights before unplugging the battery pack – this is normal.
2. If the LED light of the charger is blinking, do not insert the battery. If a red light is blinking during charging, the battery is damaged or the surrounding temperature is too high or low.

INITIALIZATION

Installing/removing the battery pack:

The battery pack is not charged at the factory; charge it before use.

1. Match the two bulges of the battery pack with the guides on the back of the radio, then press the battery pack and radio firmly together until the release latch on the base of the radio locks.

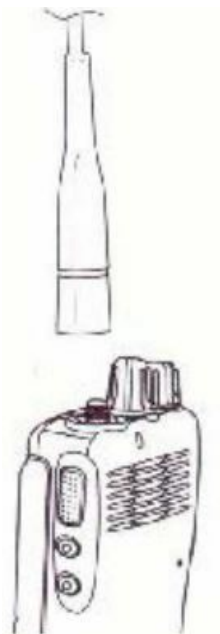

2. Pull the battery pack away from the radio while pressing the release latch.

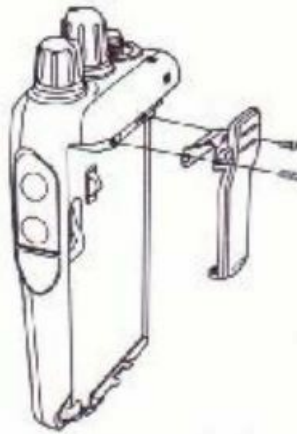

Replace or charge the battery when the power is low (alarm).

Compatible batteries:

Use only the original batteries approved by the supplier, using any other batteries might cause a serious malfunction and a fire hazard.

Note:

1. Do not short the battery terminals or dispose of the battery in fire. Never attempt to remove the casing from the battery pack.
2. Charging of the battery must happen at the ambient temperature of $+5 - +40^{\circ}\text{C}$. Charging outside this range may not fully charge the battery and could be a safety hazard. Never charge the battery in freezing temperatures.
3. Always switch off the device before charging. Using the device while charging will interfere with the normal charging rate.
4. Do not plug/unplug the AC adaptor and battery during charging, to avoid interrupting the process.
5. If the battery operating time decreases despite charging correctly, it must be replaced.
6. Do not recharge the battery if it is already fully charged. Doing so may cause the life of the battery to shorten or the battery may be damaged.
7. Do not recharge the device if the battery or other parts are wet. Ensure that the device is dry before charging.

Important:

- If you notice the battery swelling, heating, or some other fault, immediately cease operating the device, switch off the power, remove the battery pack, and contact the supplier.
- Recharge the battery and operate the chargers only with personnel present. Never leave the device to be recharged without supervision.
- Always place the charger on a clean desk surface. Never place the chargers on top of other electronic devices.

Charging:

Use only the designated Roxtone charging dock for one or six devices. When installing the battery, the LED light of the device lights red and three beeps sound every 30 seconds. This means a low power level and the battery must be charged. The LED light on the charger indicates the status.

- LED light Status
- red light charging
- green light battery fully charged
- red light blinking battery overheated or broken

Installing the antenna:

Screw the antenna into the connector on the top of the radio by holding the antenna at its base and turning it clockwise until secure. Never use the radio without the antenna

Installing the belt clip:

If necessary, attach the belt clip using the two supplied screws.

Caution: Do not use glue to prevent screw loosening when installing the belt clip, as it may cause damage to the radio. Acrylic ester, which is contained in these glues, may crack the back panel of the radio.

BASIC FUNCTIONS

1. Turn the Power switch/volume control clockwise to switch the radio power ON. A beep sounds if enabled by your dealer.
2. Press the key programmed with the Monitor or Squelch Off function to hear background noise, then rotate the Power switch/volume control to adjust the volume.
3. Rotate the Channel selector to select your desired channel. When you receive an appropriate signal, you will hear audio from the speaker
4. Press and hold the PTT switch to make a call, and speak into the microphone with a normal speaking voice at 5 cm away.
5. Release the PTT switch to receive.

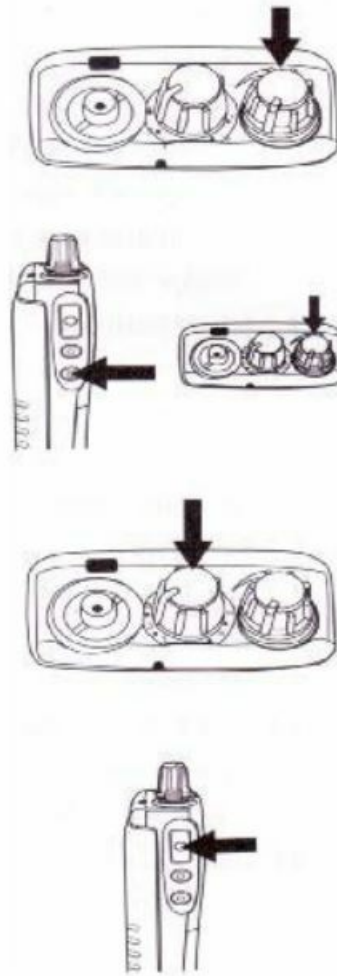

Note: When the battery charge becomes too low, the transmission will stop and an alarm tone will sound. See the "Low Battery Warning" introduction.

OPERATOR CONVENIENCES

Monitor/squelch off:

- You can use the Monitor key (9) to listen to weak signals that you can not hear during normal operation, deactivate channel signalling, and adjust the volume when no signals are present on your selected channel.
- **Momentary usage:** Press and hold to hear background noise. Release the key to return to normal operation.

Call key:

- The purpose of the call tone (11) can be determined by the client.
- The call tone plays and the LED turns red.
- The call tone is received by all radios on the same channel while their radios' LED light turns green. The signal ends when the call tone ends.

DEVICE DESCRIPTION

1. Antenna. Do not use the radio without the antenna.
2. Channel selector, rotate to select channels 1-16.
3. Power switch/volume control. Rotate clockwise to switch power to ON. When turning the power to OFF, rotate the switch counterclockwise until you hear a snap. Turn to adjust the volume.
4. LED indicator light. Lights are red while transmitting and green while receiving. Blinks red when the battery voltage is low while transmitting.
5. SP/MIC jack
6. Speaker
7. Microphone
8. Battery pack, behind the device.
9. Monitor
10. PTT (Push-To-Talk) switch. Press and speak into the microphone to transmit, release to receive.
11. Call key

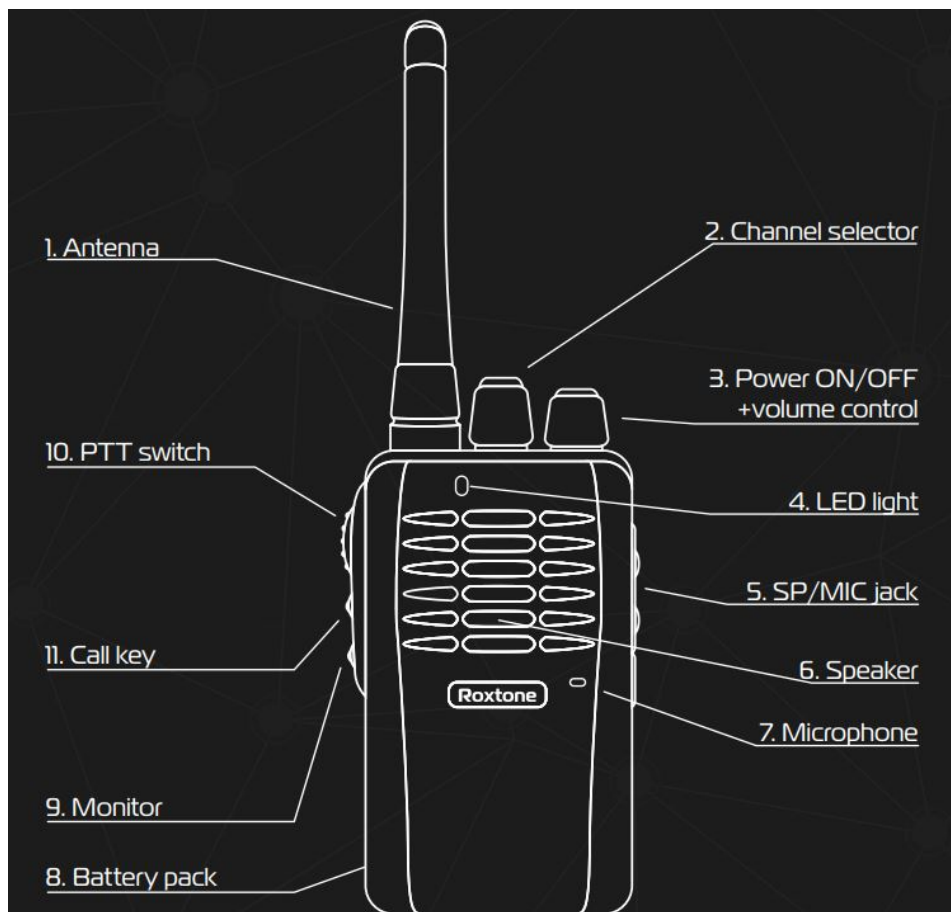

Suomen Yhteisyritykset Oy Ratamotie 44 90800 Oulu info@roxtone.fi 020 765 9090 www.roxtone.fi



[Roxtone XT-433 Two-Way Professional Radio](#) [pdf] Instruction Manual
XT-433 Two-Way Professional Radio, XT-433, Two-Way Professional Radio, Professional Radio, Radio

References

- [Roxtone | Radiopuhelimet ammattikäyttöön](#)

[Manuals+](#).