

ROXIYED DC-C Series Ceiling Fan with Light and Remote



ROXIYED DC-C Series Ceiling Fan with Light and Remote Instruction Manual

[Home](#) » [ROXIYED](#) » ROXIYED DC-C Series Ceiling Fan with Light and Remote Instruction Manual 

Contents

- [1 ROXIYED DC-C Series Ceiling Fan with Light and Remote](#)
- [2 Product Information](#)
- [3 BEFORE INSTALLATION](#)
- [4 QUICK 'CLICK' BLADE INSTALLATION](#)
- [5 ELECTRICAL WIRING DIAGRAM](#)
- [6 REMOTE CONTROL OPERATION](#)
- [7 IMPORTANT FACTS](#)
- [8 TECHNICAL INFORMATION](#)
- [9 WARRANTY INFORMATION](#)
- [10 CONTACT INFORMATION](#)
- [11 Documents / Resources](#)
 - [11.1 References](#)
- [12 Related Posts](#)



ROXIYED DC-C Series Ceiling Fan with Light and Remote



Specifications

- Models: DC-C48-W, DC-C48L-W, DC-C48-B, DC-C48L-B, DC-C48-T, DC-C48L-T
- Customer Support Email: Support@ROXIYED.COM

Product Information

This Roxiyed DC ceiling fan is equipped with intelligent energy-saving DC technology. The model comes with LED lighting options for added convenience and efficiency.

Installation Instructions

Before Installation

1. Unpack the fan and identify all parts as shown in Fig 1a and Fig 1b.
2. Check for any damage to the fan prior to installation.
3. Ensure the power is off before installation.
4. Verify that the outlet box can support the fan's weight.

Quick Blade Installation

1. Insert the blades into the blade holding slots on the motor housing and slide downward until they click into position.
2. Secure the blade screws into place.

Hanging the Fan

Lift the fan assembly onto the mounting bracket. Align the hanger ball with the tab of the mounting bracket to prevent rotation during operation. Secure the safety wire to the ceiling joist.

FAQ

- **Q: Can I install the fan myself?**

- A: The fan must be installed by a licensed electrician to ensure safety and proper installation.

- **Q: What should I do if I notice physical damage to the fan?**

- A: Physical damage like marks and scratches are not covered by the warranty. Contact Roxiyed for replacement parts discussion.



Intelligent energy saving DC technology

Images are for reference only and may vary slightly from actual product.
Ceiling Fan Installation Manual Rev 1.1

MODELS

- DC-C48-W, DC-C48L-W, DC-C48-B, DC-C48L-B, DC-C48-T, DC-C48L-T
- DC-C52-W, DC-C52L-W, DC-C52-B, DC-C52L-B, DC-C52-T, DC-C52L-T
- DC-C60-W, DC-C60L-W, DC-C60-B, DC-C60L-B, DC-C60-T, DC-C60L-T

Customer Support Email: Support@ROXIYED.COM

Thank you for purchasing this quality Roxiyed DC ceiling fan. To ensure correct function and safety, please read all instructions before using the product and keep all instructions for future reference.

CAUTION

Read Instructions Carefully For Safe Installation and Fan Operation



MUST BE INSTALLED BY
A LICENSED ELECTRICIAN

SAFETY PRECAUTIONS

WARNING:FOR SAFE USE OF THIS FAN. AN ALL-POLE DISCONNECTION MUST BE INCORPORATED INTO

THE FIXED WIRING IN ACCORDANCE WITH THE WIRING RULES.

The installation is to be in accordance with the National Electrical Code, ANSI/NFPA 70 and local codes. As outlined in clause ANSI/NFPA70 for meeting the minimum electrical safety of this standard.

Please note warranty will be void if installation is without an all-pole disconnection incorporated in the fixed wiring in accordance with the wiring rules. Example: If a fan is connected to a circuit that can be isolated via an all-pole safety switch at the switchboard, then this is considered to be an all-pole disconnection to the ceiling fan electrical circuit, meeting the requirements of clause ANSI/NFPA70

A single-pole switch on the active of the receiver input of remote control must also be included in the wiring, and located in the same room as the ceiling fan. (see wiring diagram)

1. The appliance is not intended for use by persons (including children) with reduced physical, sensory or mental capabilities, or lack of experience and knowledge, unless they have been given supervision or instruction concerning the use of the appliance by a person responsible for their safety.
2. Children should be supervised to ensure that they do not play with the appliance.
3. The structure to which the fan is to be mounted must be capable of supporting a weight of 20kg.
4. The fixing point on the ceiling, requires a solid bracing structure such as Timber noggins or joists. The bracing should be butted up firmly and securely to the back of any non structural roofing panel such as plaster or Gyprock to ensure safety and optimum performance of the fan.
5. CAUTION: To Reduce The Risk Of Injury To Persons, Install Fan So That The Blade Is At Least 3.05 Meters (10 Feet) Above The Floor.
6. Only a licensed electrician should complete the installation.
7. WARNING: If unusual wobbling or oscillating movement is observed, immediately stop using the ceiling fan and contact the manufacturer, its service agent or suitably qualified persons.
8. WARNING: Light and fan must be connected to the same phase. Before servicing, ensure both light and fan circuits are disconnected. Do not dispose of electrical appliances as unsorted municipal waste, use separate collection facilities. Contact you local government for information regarding the collection systems available. If electrical appliances are disposed of in landfills or dumps, hazardous substances can leak into the ground water and get into the food chain, damaging your health and well-being.



Do not dispose of electrical appliances as unsorted municipal waste, use separate collection facilities. Contact you local government for information regarding the collection systems available. If electrical can leak into the ground water and get into the food chain, damaging your health and well-being.

BEFORE INSTALLATION

Unpack the fan carefully and identify all parts. Please refer to Fig 1a and Fig 1b

AREO LUX DC WITHOUT LIGHT

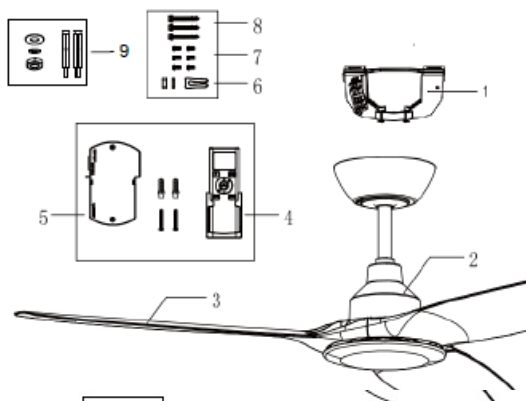

Fig 1a.

AREO LUX DC WITH LIGHT

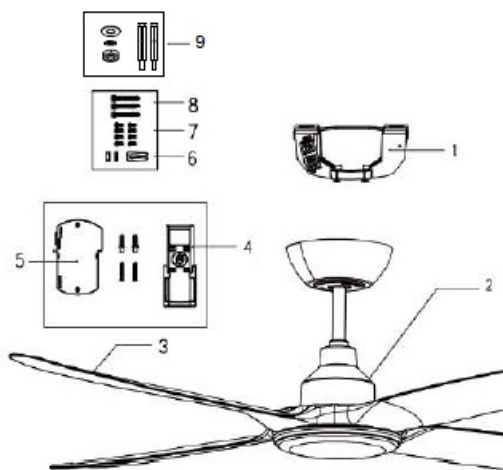
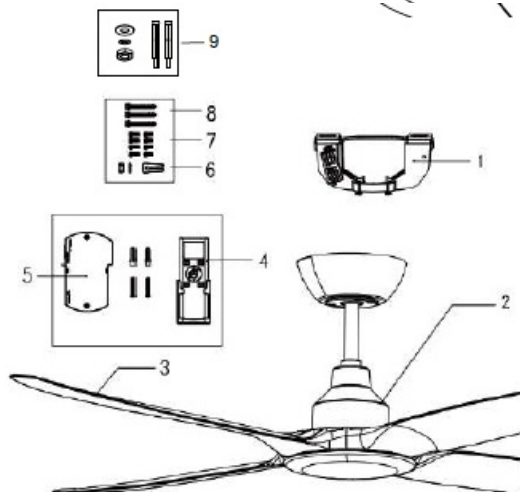
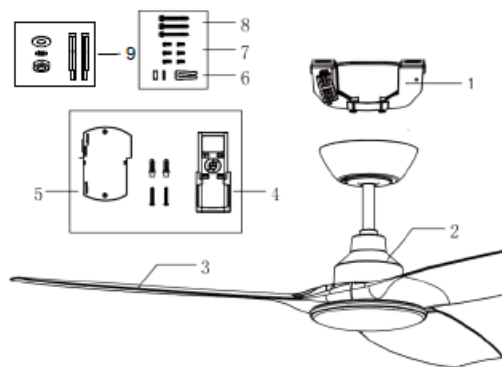

Fig 1b.

1. Mounting bracket x 1
2. Pre-assembled fan motor, down rod, canopy and bottom cover x 1
3. Blades x 3 (or 4)
4. Remote Control x 1 Wood screws 3.5*20mm)
5. Receiver x 1
6. Balancing Kit x 1
7. Blade screws x 6 (or 8) (5 x 16mm)
8. Wood screws for mounting bracket x 2 (6 x 50mm)
Wood screw for safety wire x 1 (6 x 50mm)
9. Concrete Screw Anchors set x 1 (6 x 54mm)

Fig 1b.

1. Mounting bracket x 1
2. Pre-assembled fan motor, down rod, canopy and LED light x 1
3. Blades x 3 (or 4)
4. Remote Control x 1 Wood screws 3.5x 20mm).
5. Receiver x 1
6. Balancing Kit x 1

7. Blade screws x 6 (or 8) (5 x 16mm)
8. Wood screws for mounting bracket x 2 (6 x 50mm)
Wood screw for safety wire x 1 (6 x 50mm)
9. Concrete Screw Anchors set x 1 (6 x 54mm)

Please note: Check for any damage to the fan prior to installation. Physical damage such as marks and scratches is not covered by the in home warranty. In this case, please contact Roxiyed to discuss replacement parts.

FIX THE CEILING HANGER BRACKET WARNING: The fixing must be done securely in the structure of the ceiling by a qualified person.

Depending on the structure of your ceiling, use suitable screws and washers. Do not fix the ceiling support in a structure thinner than 2 inch or in hollow elements, in order to avoid any risk of falling. Make sure that the fixing is very solid and capable of carrying a load of a least 20kg. We decline all responsibility in the event of a fall of the ceiling fan. Make sure power is off before installation. You can install the hanger bracket on an inclined ceiling of 15° maximum. If your ceiling is inclined, the lugs of the hanger bracket must be on the highest side of your ceiling. Do not put it on the lowest side of your ceiling.

Check that the outlet box is securely installed in place such that it is able to support at least the fan weight.

WOOD CEILING

Position the support in the desired location and fix it using the screws provided.

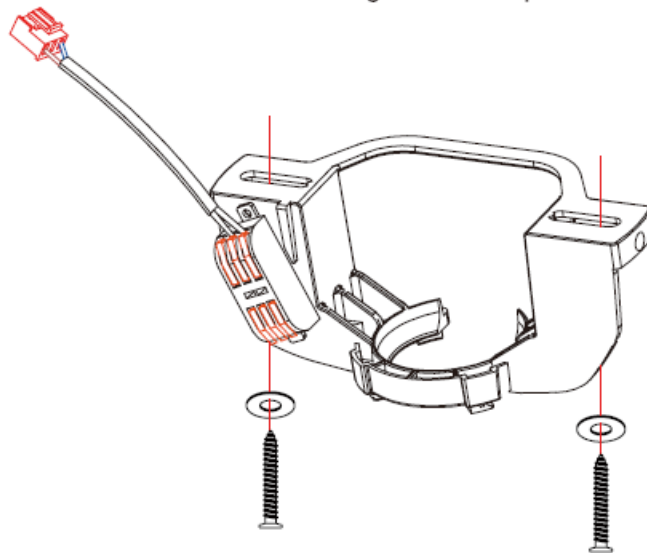

CONCRETE CEILING

Position the support in the desired location and mark the holes to be made. Remove the support and drill the concrete structure by making 2 holes corresponding to the diameter of your anchor studs. Remove dust and introduce the anchor studs using a hammer (leave the threaded rod sticking out). Remove nuts and washers, replace the support and replace the washers and nuts. Tighten the nuts securely using a suitable wrench.

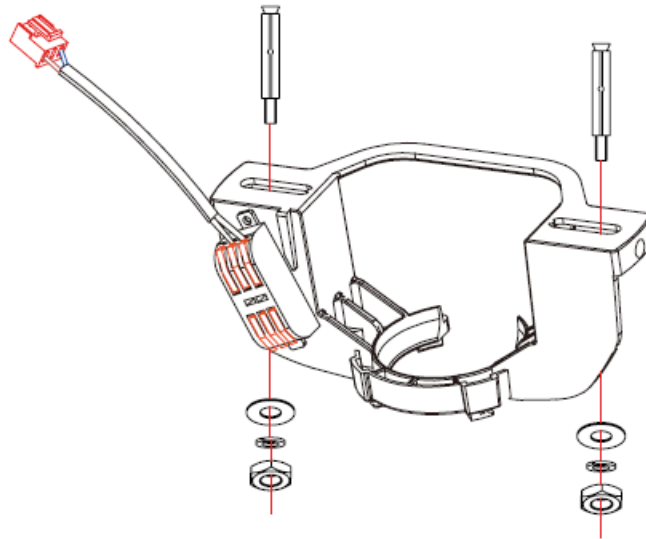

QUICK 'CLICK' BLADE INSTALLATION

BLADE ATTACHMENT

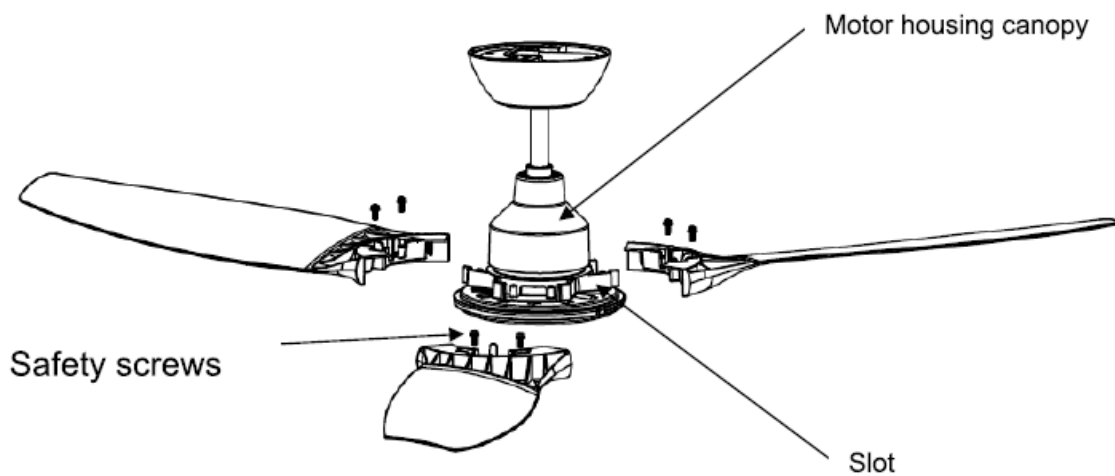

1. Insert the blades (AREO LUX DC x 3) into the blade holding slots on the motor housing, slide downward and click into position'.
2. Insert the 2 safety screws ,being caws, being careful not to over-tighten
3. Move motor housing canopy download until covering the motor

HANGING THE FAN

Lift the fan assembly onto the mounting bracket. Ensure that slot (A) of the hanger ball is fully aligned/engaged with the Tab (B) of the mounting bracket (C) to prevent the fan from rotating when in operation. Fig. 3)

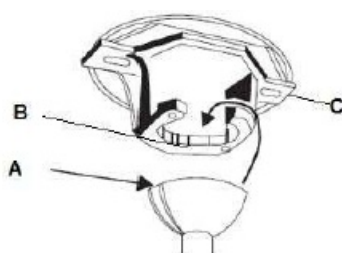
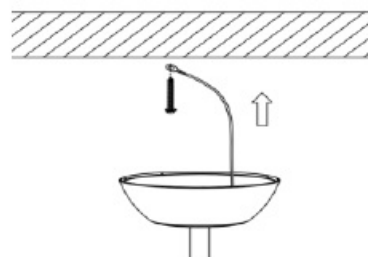

Fig. 3



Secure the safety wire to the ceiling joist or other suitable fixing point.

Angle Ceiling Installation

This fan hanging system supports a maximum 15-degree angled installation. (Fig 4)

Please note: the Tab (B) on the hanging bracket that sits in the groove (A) on the hanging ball should be positioned at the highest point to ensure correct operation

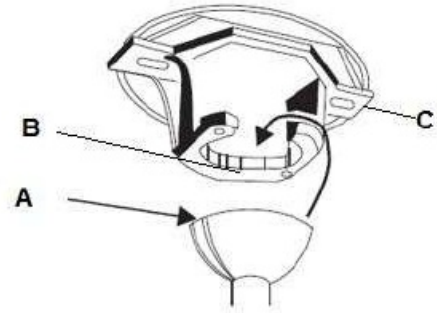
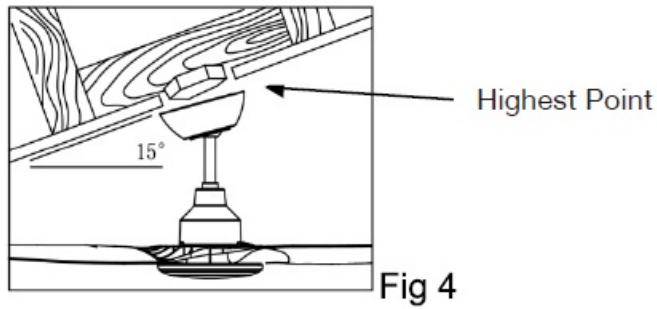

Finish Installation

- Complete the electrical connection at the mounting bracket terminal block.
- Fix the EARTH cable from motor to the mounting bracket.

NOTE: AREO LUX DC is a Class I electrical product. (Refer to Fig 6.).

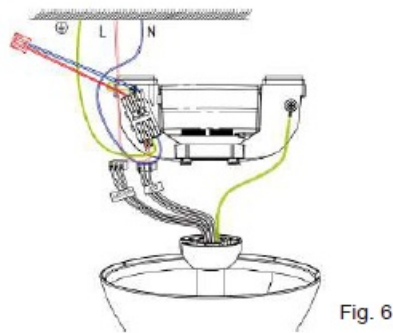

FINISHING THE INSTALLATION

- Connect fan to the receiver (can be done before or after sliding receiver into place).
 - A.** For fan models without light, plug cable marked 'motor' into remote control box. See Fig 7.2
 - B.** For fan models with light, plug cable marked 'motor' and 'LED' into remote control box. See Fig 7.1
- Slide receiver into position in the hanging bracket making sure the AC input connector on the receiver is aligned with the AC port on the receiver. Refer Fig 7.1 on page 7
- **CAUTION:** To Reduce The Risk Of Electric Shock, Disconnect The Electrical Supply Circuit To The Fan Before Installing Light Kit.

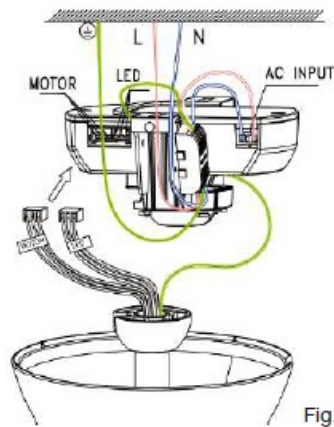
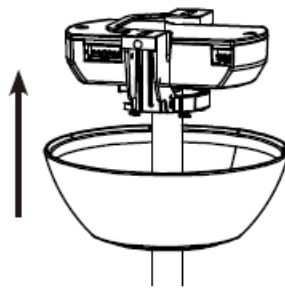

Fig. 7.1.

- After making the wire connections, the wires should be spread apart with the grounded conductor and the equipment grounding conductor on one side of the outlet box and the ungrounded conductor on the other side of the outlet box. The splices after being made should be turned upward and pushed carefully up into the outlet box
- Slide the canopy upwards into position over the mounting bracket then turn counter clockwise to twist lock into position. Ensure all 4 tabs on the mount bracket are located correctly into the slots on the canopy. Canopy should be sitting approx. -1/8 inch off the ceiling.



- Ensure all wires are tucked neatly into canopy taking care not to cause damage

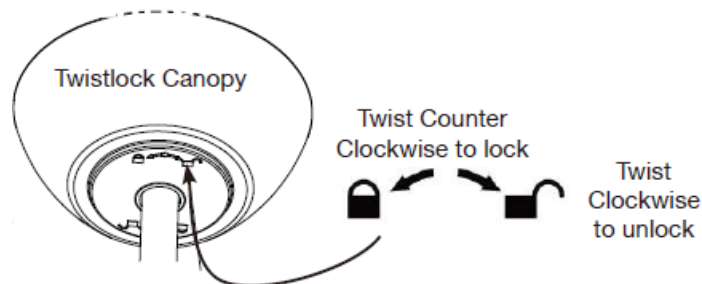



Fig. 8

ELECTRICAL WIRING DIAGRAM

WARNING: FOR YOUR SAFETY ALL ELECTRICAL CONNECTIONS MUST BE UNDERTAKEN BY A LICENSED ELECTRICIAN IN ACCORDANCE WITH ANSI/NFPA 70 WIRING RULES.

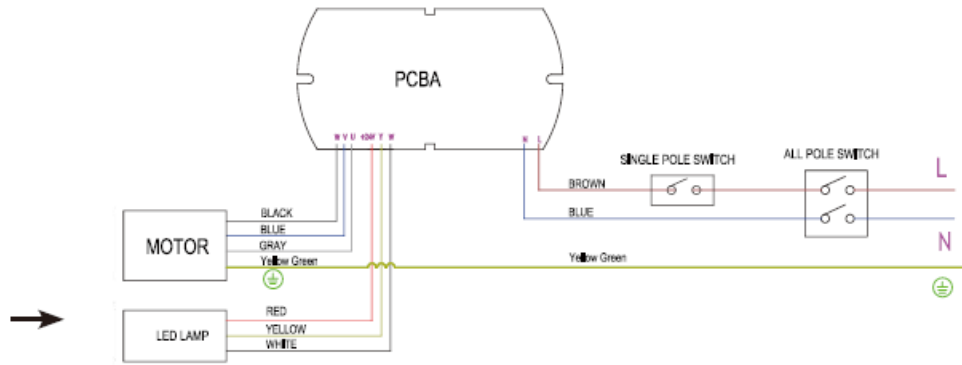

- Connect "LIVE" supply to the "L" of the terminal block on the mounting bracket.
- Connect "EARTH" supply wire to  of the terminal block on the mounting bracket.
- Connect "NEUTRAL" supply to "N" of the terminal block on the mounting bracket.
- Screw "EARTH" cable from motor to cavity  on the mounting bracket. Please refer to Fig 6

Please note:
This is only applicable to models with LED light.



REMOTE CONTROL OPERATION



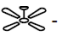

Fan Models Without Light

FAN	Fan 'ON' and 'OFF'
	Increases fan speed until Max (speed 5)
	Decreases fan speed until Min (speed 1)
TIMER	Run on Timer with 12 setting options (1hr to 12hrs)
MODE	ECO, SLEEP and NORMAL
ECO MODE	level, usually somewhere between speeds 1 and 2
SLEEP MODE	2nd press – Fan will reduce by 1 speed every 30mins
NORMAL	3rd Press – cancels mode and returns to normal function Please note:  + and  - will not operate during 'SLEEP' or 'ECO' modes.

Note: Light will reactivate at previous brightness and colour (CCT) settings when using handset only. Once wall (isolation) switch has been turned 'OFF' Light will default back to 100% brightness (NW) Natural white light.



Fan Models With Light

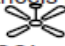
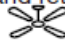

FAN	Fan 'ON' and 'OFF'
	Increases fan speed until Max (speed 5)
	Decreases fan speed until Min (speed 1)
LIGHT	Switches light 'ON' and 'OFF'
	Scrolls through colours: WW - NW - CW
	Increases light brightness
	Decreases light brightness
TIMER	Run on Timer with 12 setting options (1hr to 12hrs)
MODE	ECO, SLEEP, NORMAL and Forward/Reverse
ECO MODE	1st press - Fan will operate at peak energy efficiency level, usually somewhere between speeds 1 and 2
SLEEP MODE	2nd press - Fan will reduce by 1 speed every 30mins until speed 1. (select preferred starting speed level first)
NORMAL	3rd Press - cancels mode and returns to normal function Please note:  + and  - will not operate during 'SLEEP' or 'ECO' modes.

REMOTE CONTROL OPERATION

- A remote control consists of two parts.
 - Handset (transmitter) controller.
 - Receiver. Receives messages from the handset and is located in upper canopy of the fan.
- The AREO LUX DC remote control comes pre-paired at the factory and is ready to use.
Pairing will only be required in situations mentioned below.



Using 1 remote handset to control 2 or more AREO LUX DC Ceiling fans

- Choose the fan you wish to pair with your handset.
- Turn isolation switch 'ON' and within 20 seconds press and hold  on the remote for 8 seconds. The fan will emit a 'beep beep' sound to indicate the pairing process is activated.
- Press operation and successful pairing. press and hold FAN on the FAN and change the speed of the ceiling fan via the remote to check the operation and successful pairing.
-
- Press  and change the speed of the ceiling fan via the remote to check the operation and successful pairing.

Troubleshooting

AREO LUX DC

Q) One remote is controlling multiple fans, how do I fix this?

This can be fixed by re-pairing each fan one at a time:

- Turn all fans you wish to separate off at the isolation switch and leave off for a minimum of 1 minute.
- Turn the isolation switch on for the 1st fan and within 20 seconds press and hold on the remote for 8 seconds. Remote should be paired, check fan functions. Repeat the above steps with next fan ensuring the previous fan is left on at the isolation switch.

NOTE: Each fan must have its own isolation switch as per the instructions on page 2 and the diagram on page 7. Please contact your installing electrician to rectify if this is not the case.

Loss of function or control between hand piece and receiver

- Try the re-pairing process as outlined above (point 1)
- Try pairing a hand piece from a different fan as outlined above (point 1). If the problem persists, Email Roxiyed support on support@ROXIYED.com

Replacing an old or damaged handset

- If you are replacing a handset only (not the receiver), the repairing process (point 1) will need to be performed before operation of the fan is possible.

IMPORTANT FACTS

Fan Operation:

AREO LUX DC

A ceiling fan rotates much more slowly than traditional style wall, pedestal or desk fan; otherwise still, hot air of a room, creating a natural evaporative cooling effect. Fans never

Normal Wear and Tear

Over time, moving parts may become slightly loose or worn creating small increases in noise or movement. Fan operation may also be affected by accidental contact by persons or foreign objects. These conditions are not covered under warranty, but a little care and maintenance can reduce or prevent these problems from arising.

Night Noise

All electric motors, including fan motors make some noise however, the AREO LUX DC motor is not susceptible to the noise problems that are commonly experienced with typical Higher wattage, heavier AC type ceiling fan motors. The AREO LUX DC Range are one of the quietest fans available and are ideal for all areas of the home especially bedrooms where noise is a crucial consideration.

MAINTENANCE

CARE AND CLEANING:

NOTE: Always turn OFF the power at the mains switch before performing any maintenance or attempting to clean your fan.

- Every 6 months, periodic cleaning of your ceiling fan is the only maintenance required. Use a soft brush or lint free damp cloth to avoid scratching or marking the surface. Please turn off electricity power when you do so.
- Do not soak or immerse your ceiling fan in the water or other liquids. It could damage the motor or the blades and create the possibility of an electrical shock.
- Ensure that the fan does not come in contact with any organic solvents or cleaners.
- To clean the fan blade, wipe with only a damp clean cloth with NO organic solvents or cleaners.
- The motor has a permanently lubricated ball bearing so there is no need to oil.

TECHNICAL INFORMATION

Ceiling Fan Model	Rated Voltage	Rated Power (Motor)	Rated Power (Lamp)	Fan Weight (Kg)
DC-C36-W	120AC/60HZ	32W	N/A	3.82
DC-C36L-W	120AC/60HZ	32W	20W, LED, 3000K, 4000K, 5000K	4.16
DC-C36-B	120VAC/60HZ	32W	N/A	3.82
DC-C36L-B	120VAC/60HZ	32W	20W, LED, 3000K, 4000K, 5000K	4.16
DC-C48-W	120VAC/60HZ	31W	N/A	4.00
DC-C48L-W	120VAC/60HZ	31W	20W, LED, 3000K, 4000K, 5000K	4.43
DC-C48-B	120VAC/60HZ	31W	N/A	4.00
DC-C48L-B	120VAC/60HZ	31W	20W, LED, 3000K, 4000K, 5000K	4.43
DC-C52-W	120VAC/60HZ	31W	N/A	4.05
DC-C52L-W	120VAC/60HZ	31W	20W, LED, 3000K, 4000K, 5000K	4.39
DC-C52-B	120VAC/60HZ	31W	N/A	4.05
DC-C52L-B	120VAC/60HZ	31W	20W, LED, 3000K, 4000K, 5000K	4.39
DC-C52-T	120VAC/60HZ	31W	N/A	4.05
DC-C52L-T	120VAC/60HZ	31W	20W, LED, 3000K, 4000K, 5000K	4.39
DC-C60-W	120VAC/60HZ	43W	N/A	4.50
DC-C60L-W	120VAC/60HZ	43W	20W, LED, 3000K, 4000K, 5000K	4.70
DC-C60-B	120VAC/60HZ	43W	N/A	4.50
DC-C60L-B	120VAC/60HZ	43W	20W, LED, 3000K, 4000K, 5000K	4.70
DC-C60-T	120VAC/60HZ	43W	N/A	4.50
DC-C60L-T	120VAC/60HZ	43W	20W, LED, 3000K, 4000K, 5000K	4.70

Ceiling Fan Model	Rated Voltage	Rated Power (Motor)	Rated Power (Lamp)	Fan Weight (Kg)
DC-C364-W	120VAC/60HZ	30W	N/A	4.11
DC-C364L-W	120VAC/60HZ	30W	20W, LED, 3000K, 4000K, 5000K	4.45
DC-C484-B	120VAC/60HZ	30W	N/A	4.11
DC-C484L-B	120VAC/60HZ	30W	20W, LED, 3000K, 4000K, 5000K	4.45
DC-C564-W	120VAC/60HZ	38W	N/A	4.31
DC-C564L-W	120VAC/60HZ	38W	20W, LED, 3000K, 4000K, 5000K	4.65
DC-C564-B	120VAC/60HZ	38W	N/A	4.31
DC-C564L-B	120VAC/60HZ	38W	20W, LED, 3000K, 4000K, 5000K	4.65
DC-C48-T	120VAC/60HZ	31W	N/A	4.00
DC-C48L-T	120VAC/60HZ	31W	20W, LED, 3000K, 4000K, 5000K	4.43

WARRANTY INFORMATION

- If you suspect faults relating to installation, contact your installer to rectify.
- If you suspect there to be manufacturing defect, You can contact us without any hesitation at any time of the day, and we will reply to you within 12 hours.

(It would be appreciated if you could provide us with a video or pictures, if available)

It would be appreciated if you could provide us with:

Photos or videos to illustrate the issue with your ceiling fan. Model number and serial number (on motor housing). The date and place of purchase of the unit.

We will send you brand new items for free or give you a full refund if any quality problems occur within 1 years from the date of purchase.

CONTACT INFORMATION

You can contact us by sending an email to: support@ROXIYED.com

Documents / Resources

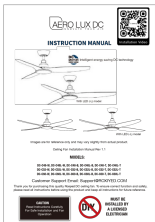
	<p>ROXIYED DC-C Series Ceiling Fan with Light and Remote [pdf] Instruction Manual DC-C48-W, DC-C48L-W, DC-C48-B, DC-C48L-B, DC-C48-T, DC-C48L-T, DC-C52-W, DC-C52L-W, DC-C52-B, DC-C52L-B, DC-C52-T, DC-C52L-T, DC-C60-W, DC-C60L-W, DC-C60-B, DC-C60L-B, DC-C60-T, DC-C60L-T, DC-C Series Ceiling Fan with Light and Remote, DC-C Series, Ceiling Fan with Light and Remote, Fan with Light and Remote, Light and Remote, Remote</p>
---	---

References

- [User Manual](#)

[Manuals+](#), [Privacy Policy](#)

This website is an independent publication and is neither affiliated with nor endorsed by any of the trademark owners. The "Bluetooth®" word mark and logos are registered trademarks owned by Bluetooth SIG, Inc. The "Wi-Fi®" word mark and logos are registered trademarks owned by the Wi-Fi Alliance. Any use of these marks on this website does not imply any affiliation with or endorsement.