

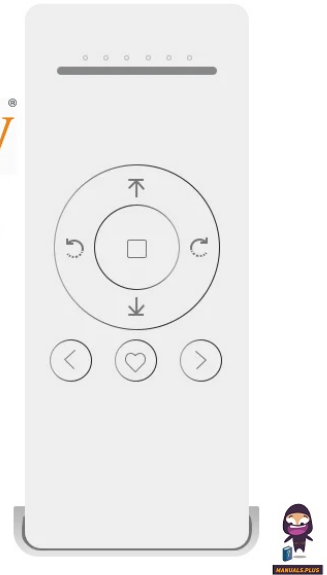



I-RTEC4 Tec Automation 6 Channel LED Remote Controller



Rowley I-RTEC4 Tec Automation 6 Channel LED Remote Controller User Manual

[Home](#) » [Rowley](#) » Rowley I-RTEC4 Tec Automation 6 Channel LED Remote Controller User Manual 

Contents

- [1 Rowley I-RTEC4 Tec Automation 6 Channel LED Remote Controller](#)
- [2 PRODUCT DIAGRAM](#)
- [3 REMOTE SPECIFICATIONS](#)
- [4 INSTRUCTIONS](#)
- [5 FAQ](#)
- [6 Documents / Resources](#)
 - [6.1 References](#)
- [7 Related Posts](#)



Rowley I-RTEC4 Tec Automation 6 Channel LED Remote Controller

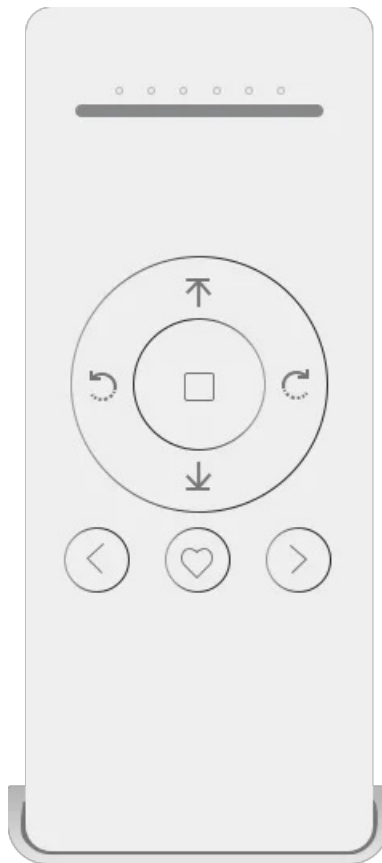

PRODUCT DIAGRAM

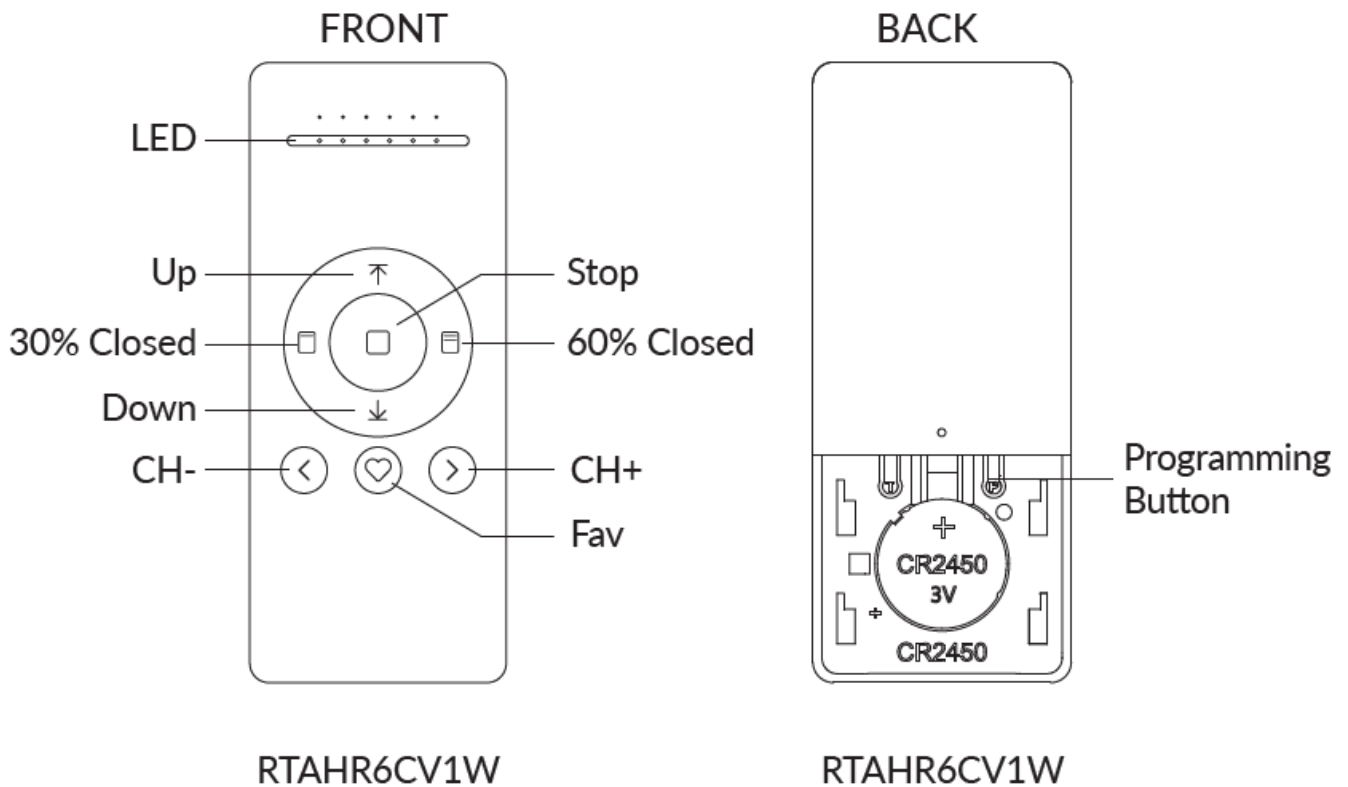

Hand-held 6-channel with percentage

REMOTE SPECIFICATIONS

Battery Type	CR2450*3V*1
Work Temperature	14°-122°F
Radio Frequency	433.92M+-100KHz
Transmit Distance	>=98.5' indoor

WARNING

- **INGESTION HAZARD:** This product contains a button cell or coin battery
- **DEATH** or serious injury can occur if ingested.
- A swallowed button cell or coin battery can cause Internal Chemical Burns in as little as 2 hours.
- **KEEP** new and used batteries **OUT OF REACH** of **CHILDREN**
- Seek immediate medical attention if a battery is suspected to be swallowed or inserted inside any part of the body.



CAUTION

WARNING: Important safety and operation instructions to be read before installation and use.

1. This product is intended for indoor use only. Do not expose the remote to moisture or extreme temperatures.
2. If the remote becomes less responsive and has a shorter transmission range, please check whether the battery needs to be replaced.
3. Use or modification outside the scope of this instruction manual will void the warranty.
4. When the battery voltage is too low, the orange LED will flicker during operation.
5. Please properly dispose of used batteries and replace them with only the specified battery type.

INSTRUCTIONS

Channel Selection

To change channels on the remote in order to pair with a single or multiple motors

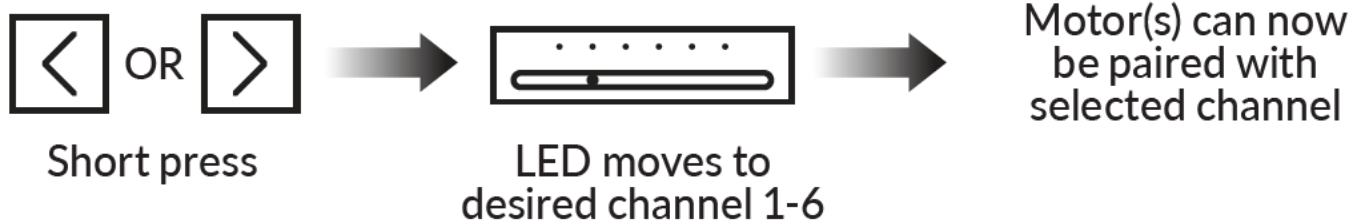

Note: A maximum of 15 motors can be added to one channel. All motors added to the same channel will operate simultaneously.

Follow the motor pairing instructions first before completing the remote settings below:\

Hide Unused Channels

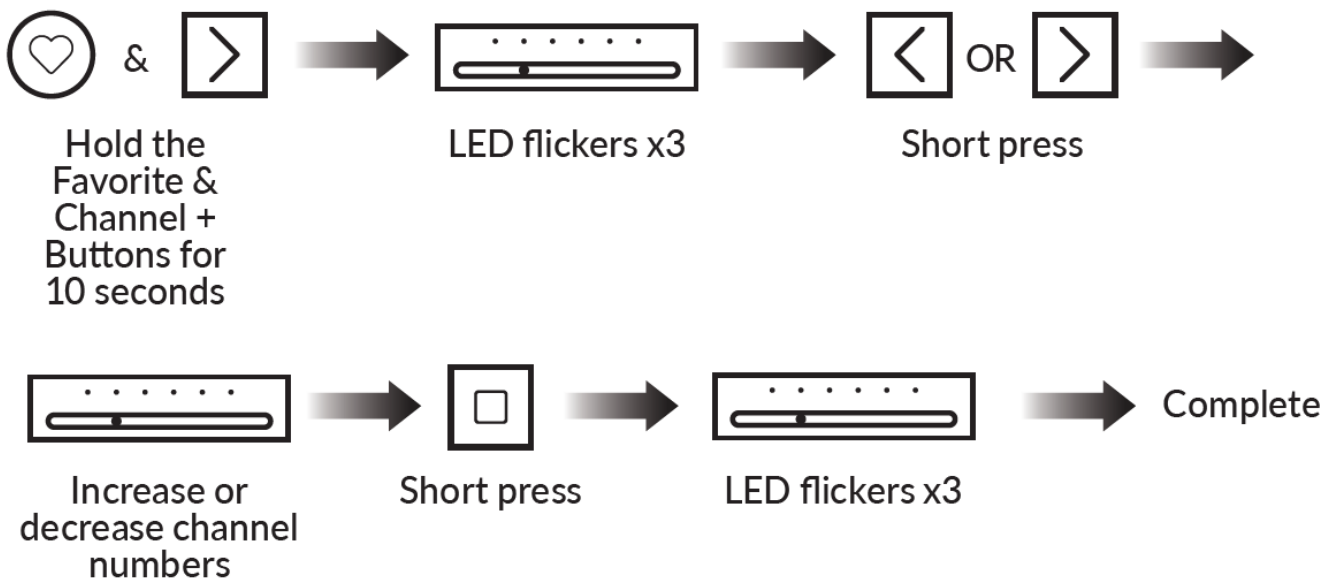

Locking the Remote

Prohibits any programming or settings from being changed on the Remote.

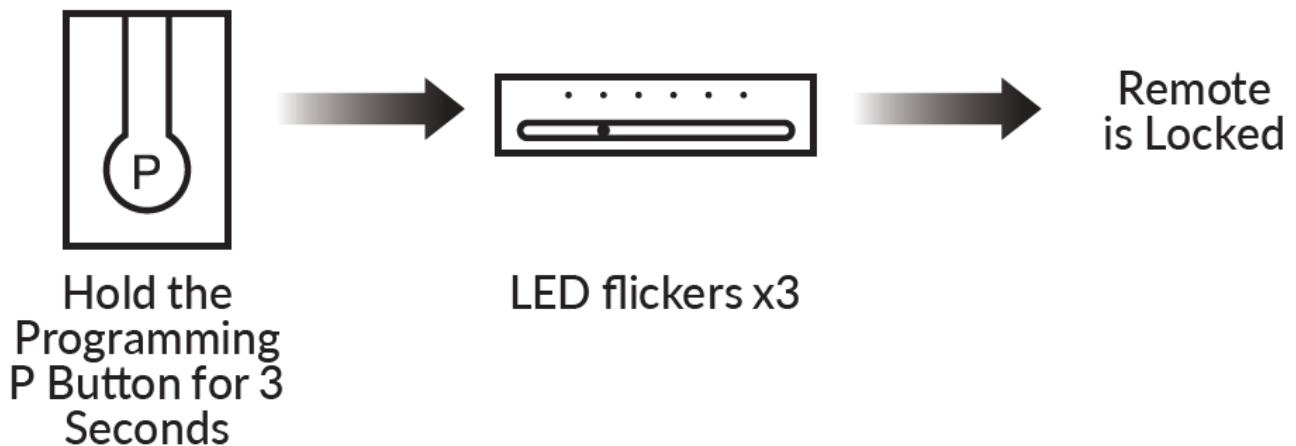

To unlock the remote and allow programming once again, repeat the steps above. For further operations please refer to the motor pairing instructions.

- RowleyCompany.com

FAQ

- **Q: How many motors can be added to one channel?**
 - A: A maximum of 15 motors can be added to one channel. All motors added to the same channel will operate simultaneously.
- **Q: What to do if the remote is locked?**
 - A: To unlock the remote and allow programming once again, repeat the steps for locking the remote.

Documents / Resources

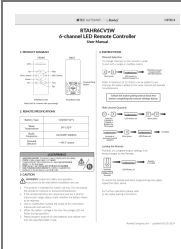

[Rowley I-RTEC4 Tec Automation 6 Channel LED Remote Controller \[pdf\] User Manual](#)
RTAHR6CV1W, I-RTEC4, I-RTEC4 Tec Automation 6 Channel LED Remote Controller, Tec Automation 6 Channel LED Remote Controller, 6 Channel LED Remote Controller, LED Remote Controller, Remote Controller

References

- [Drapery Workroom & Upholstery Supplies | Rowley](#)
- [User Manual](#)

[Manuals+](#), [Privacy Policy](#)

This website is an independent publication and is neither affiliated with nor endorsed by any of the trademark owners. The "Bluetooth®" word mark and logos are registered trademarks owned by Bluetooth SIG, Inc. The "Wi-Fi®" word mark and logos are registered trademarks owned by the Wi-Fi Alliance. Any use of these marks on this website does not imply any affiliation with or endorsement.