



## ROTRONIC RMS data logger Instruction Manual

[Home](#) » [ROTRONIC](#) » ROTRONIC RMS data logger Instruction Manual 

## ROTRONIC RMS data logger Instruction Manual



### Contents

- 1 GENERAL DESCRIPTION
- 2 COMMISSIONING
- 3 INTEGRATION OF A DATA LOGGER (PAIRING) IN 6 STEPS
- 4 ACCESSORIE
- 5 Technical data
- 6 Connections
- 7 DIMENSIONS
- 8 DELIVERY PACKSGE
- 9 FCC DECLARATION (RMS-LOG-T30 915)
- 10 Documents / Resources
  - 10.1 References
- 11 Related Posts

### GENERAL DESCRIPTION

Congratulations on your new RMS data logger. The data logger has an internal data memory of 44,000 measured values and transmits these values continuously to the RMS software by Ethernet or wireless communication. These short instructions describe the main functions of the device. Please read these short instructions and the instruction manual on [www.rotronic.com/rms](http://www.rotronic.com/rms) carefully

## COMMISSIONING

The device is supplied with power as soon as the battery is inserted. The data logger can also be supplied with 24 V (terminals: V+ / V-) or PoE (only in LAN version). The data logger can be mounted easily with the wall bracket. Choose a suitable position for measurement. Avoid disruptive influences such as sunlight, heating elements, etc. The device is connected to the RMS software by pairing.

### Important: Port 80, DHCP

To integrate a LAN device, port 80 must be enabled in your network and a DHCP server must assign the IP address to the device.

## INTEGRATION OF A DATA LOGGER (PAIRING) IN 6 STEPS

1. LAN device: if you do not want to connect the device to the Rotronic Cloud, the server must be configure in the device.
  - a. Connect the device to the local network and start the RMS configuration software.
  - b. Search for the device under Device > Search > Network Device. The software finds all RMS devices in the local network.
  - c. Enter the host (server address) and the URL of the software services under Settings.
  - d. Finish configuration with Write. Close the software
2. Log into the RMS software/Cloud. Select Tools > Setup > Device > New Wireless Device or LAN



LAN device – Enter the serial number of the device.

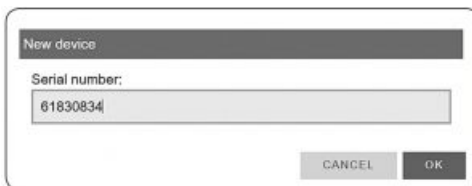

Wireless device – Select the gateway you want your wireless data logger to be connected to.



**Note:** The gateway must first be integrated.

3. Wait until the device flashes orange. Briefly press the button on the device as shown in the picture of the RMS software. The LED flashes green when connection is successful.

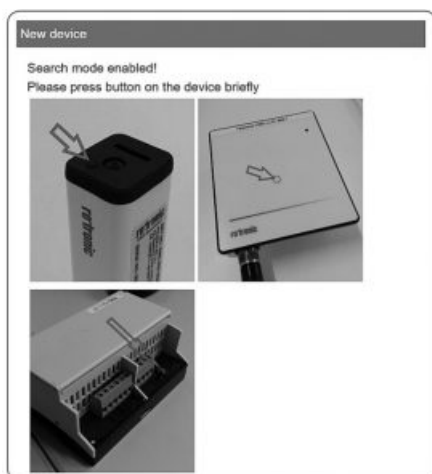

4. Configure the device.
5. Finish configuration.

LAN-Logger

Device

Serial number

61830834

Name

LAN-Logger\_61830834

Interval [s]

60

Group

Dynament

Measuring point 1

Name

Temperature-61830834

Type

Temperature

LED INDICATORS		
State	LED Function	Meaning
Connected	Flashes green	Status OK
	Flashes orange	Device not connected to the Internet
	Flashes red	1 time: low battery, replace soonest
Not connected	Flashes orange	Device waiting for integration into the software

## Maintenance

The battery needs to be replaced regularly in dependence on the recording interval.

## ACCESSORIE

### AC1321 :

Mounting kit with Allen key and mounting cone

### T30-XXXX:

PT100 probes

## Technical data

Power	24 VDC $\pm 10\%$ / $<100\text{ mA}$ / Battery: RMS-BAT(2xAA, LiSocI2) / POE: 80 2.3af-2003, Class 1
AC adapter requirements	24 VDC $\pm 10\%$ / 4 W nominal / $<15\text{ W}$ power-limited
Storage capacity	44,000 data points
Application range / Electronics	$-40\dots 70\text{ }^{\circ}\text{C}$
IP protection	IP65
Software	RMS Monitoring Software
Weight	240 g

## Connections

No.	Marking	Function
1	V+	Power supply +
2	V-	Power supply –
3	1F+	RTD 1 Force+
4	1S+	RTD 1 Sensor+
5	1S-	RTD 1 Sensor-
6	1F-	RTD 1 Force-
7	2F+	RTD 2 Force+
8	2S+	RTD 2 Sensor+
9	2S-	RTD 2 Sensor-
10	2F-	RTD 2 Force-

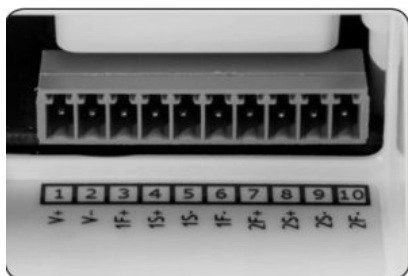

## DIMENSIONS

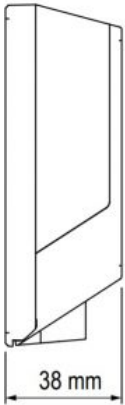
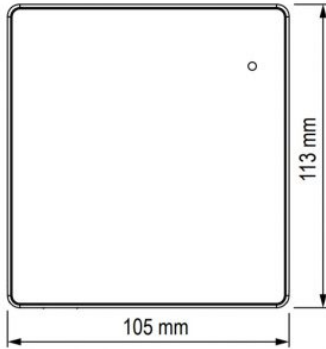

## DELIVERY PACKSGE

- Data logger
- 2 batteries
- Wall bracket
- Short instruction manual
- 2 cable glands 5

## FCC DECLARATION (RMS-LOG-T30 915)

**i** This equipment has been tested and found to comply with the limits for a Class A digital de- vice, pursuant to part 15 of the FCC Rules. These limits are designed to provide reasonable protection against harmful interference when the equipment is operated in a commercial environment. This equipment generates, uses, and can radiate radio frequency energy and, if not installed and used in accordance with the instruction manual, may cause harmful interference to radio communications. Operation of this equipment in a residential area is likely to cause harmful interference in which case the user will be required to correct the interference at his own expense.

**!** Any changes or modifications to this device not explicitly approved by manufacturer could void your authority to operate this equipment.

Website: [www.rotronic.com](http://www.rotronic.com)

## Documents / Resources

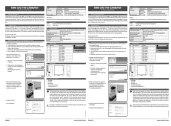

[ROTRONIC RMS data logger](#) [pdf] Instruction Manual  
ROTRONIC, RMS data logger, RMS-LOG-T30-L 868 915

## References

- [r0 RMS - Rotronic Monitoring System](#)

[Manuals+.](#)