



Roth Touchline SL Wireless Control Panel Heating System



Contents [[hide](#)]

- [1 Installation Instructions](#)
- [2 Thermostat Display & Lock Guide](#)
- [3 Thermostat Symbol Guide](#)
- [4 Customer Support](#)
- [5 Documents / Resources](#)
 - [5.1 References](#)

Installation Instructions

The thermostat must be installed in a wall box by a certified installer.

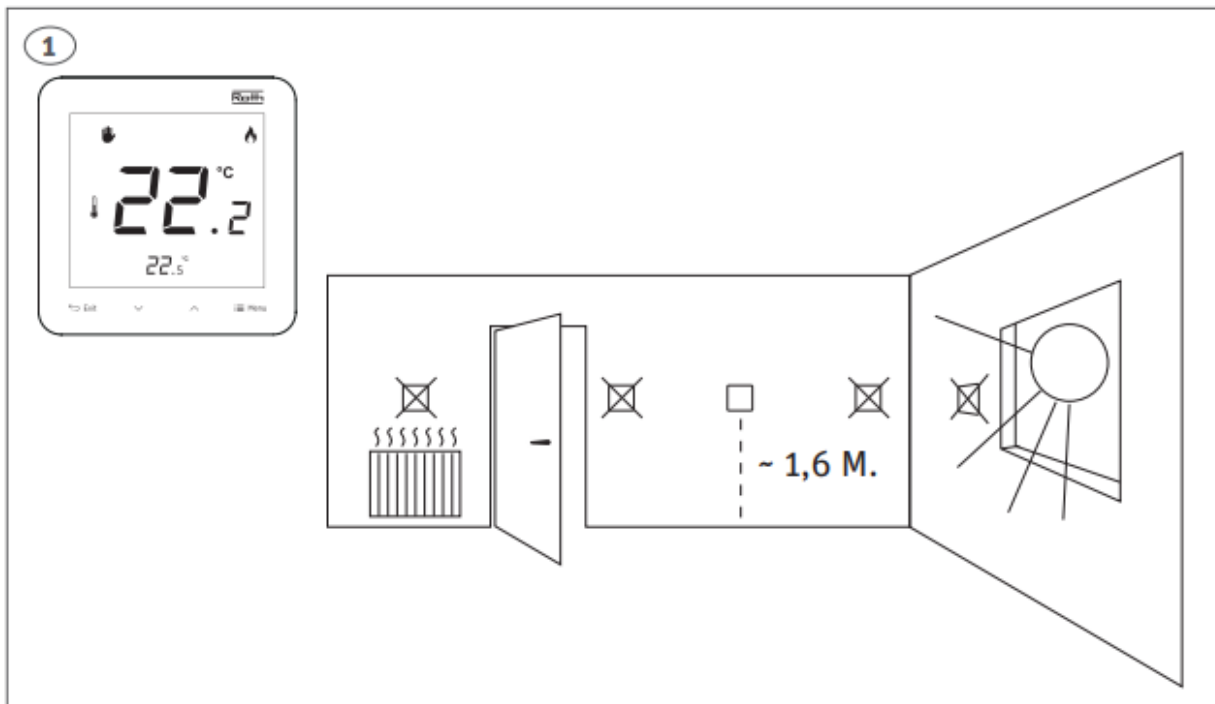

Connect the power cable (N, L) to the thermostat's terminal.

It is possible to connect a floor sensor to the thermostat (floor sensor not incl.). Connect floor sensor to the terminal "Floor sensor". The sensor must be drawn in a tube and the tip placed directly beneath the top floor cover, in the middle between the floor heating pipes.

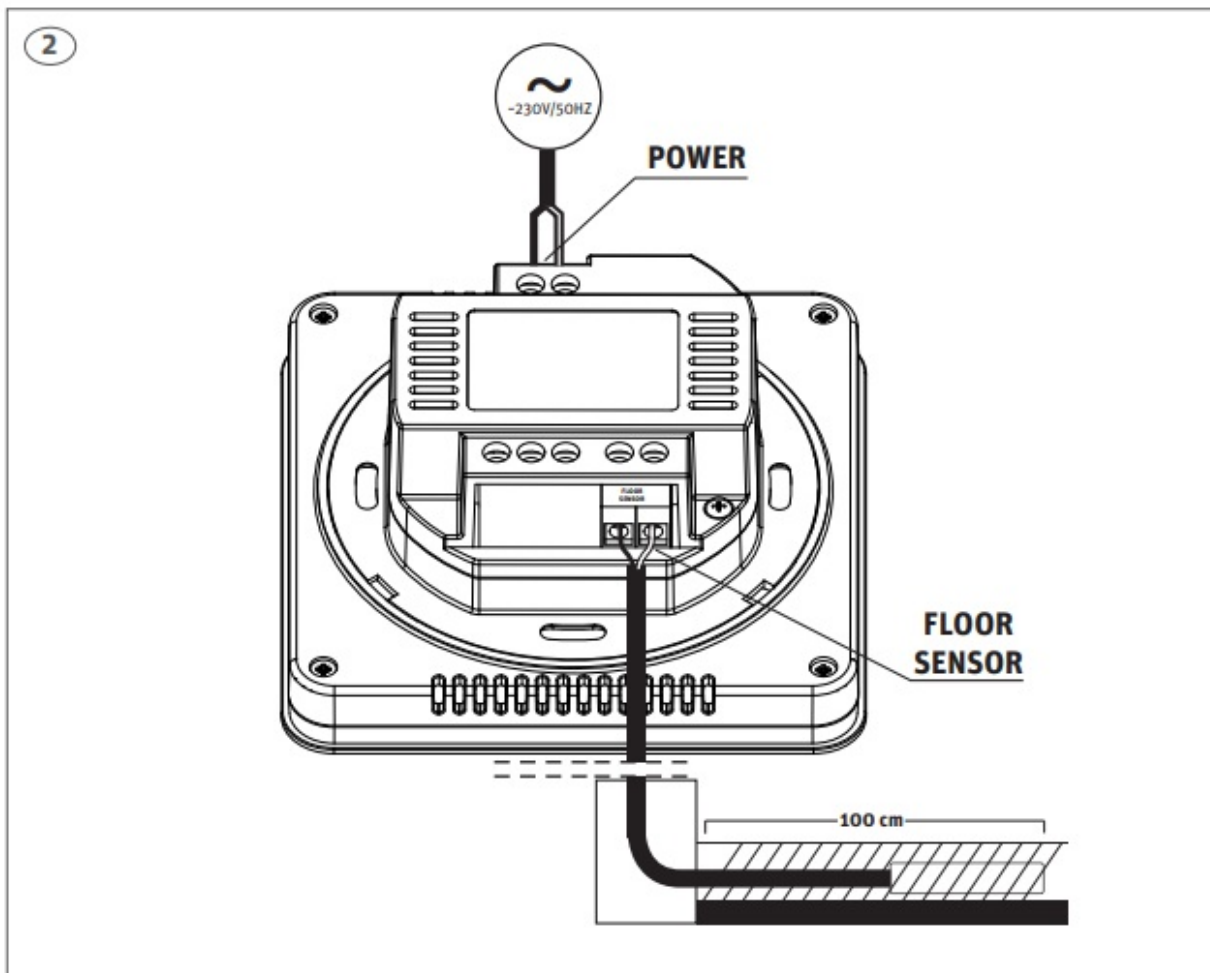

Fasten thermostat backplate in the wall box using 2 screws and then attach the thermostat display.

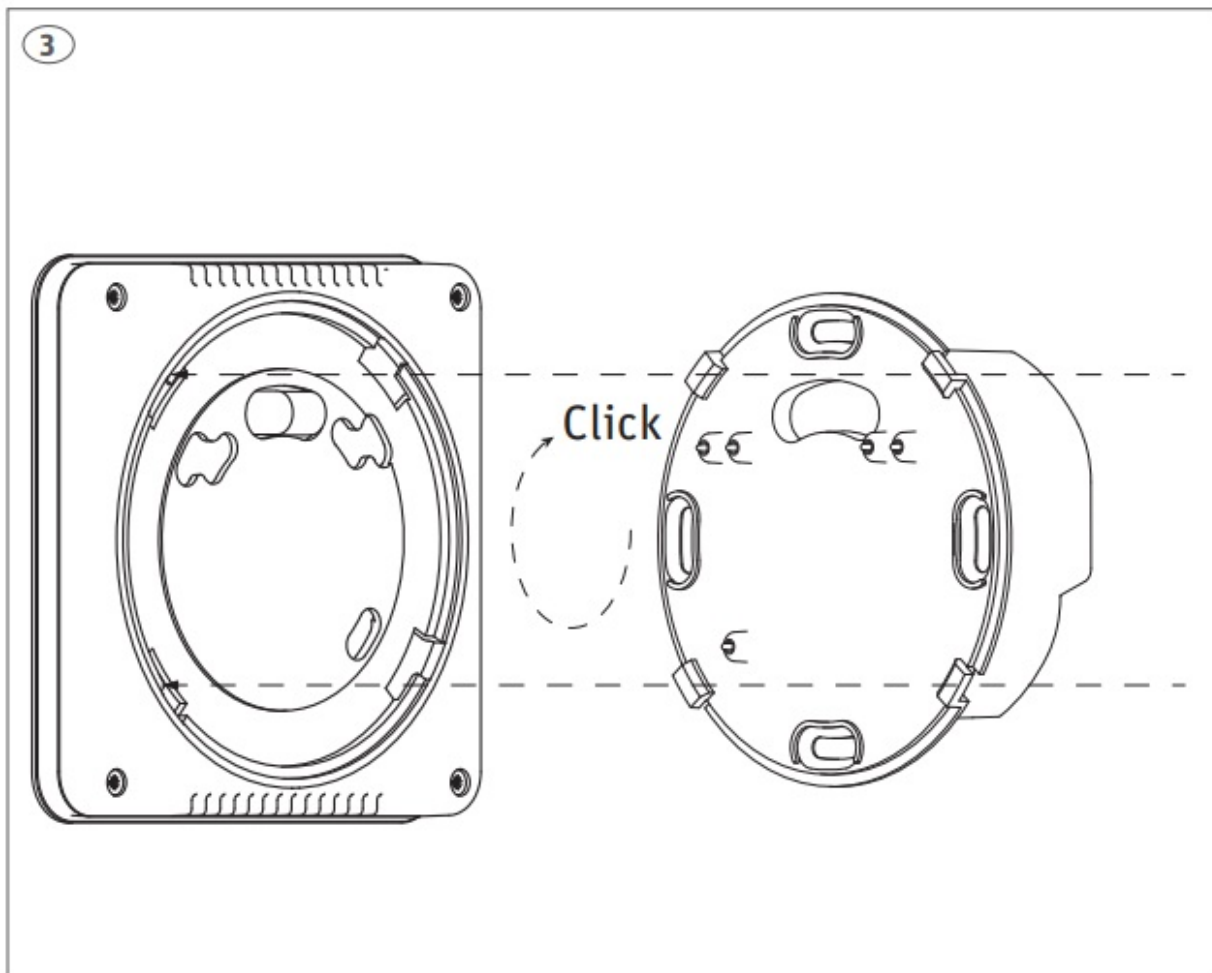

The thermostat can be connected to all Controllers in the Roth Touchline® SL series. Pairing/registering is made the same way on all Controllers using the same buttons. On the pictures the panel of the Roth Touchline® SL Controller, master is shown.

Pairing/registering the thermostat to a zone (channel). All connections must be made to the Controller (pump, actuators and optionally potential free relay) before start-up.

Please see controller manual for details.

Attention! Do not press the buttons on the front of the thermostat whilst pushing the pairing button on the rear (see picture 10).

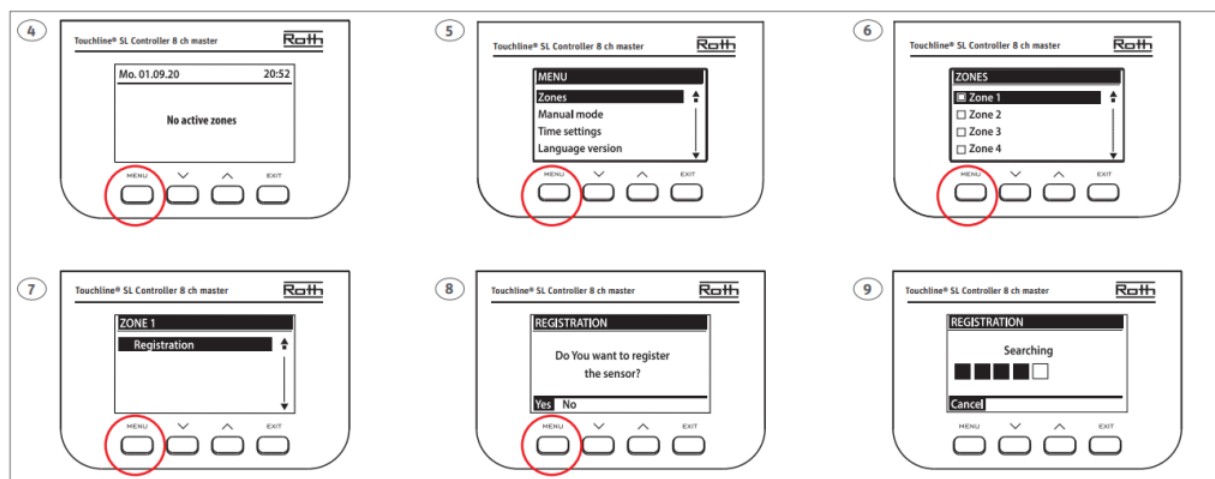

Once the thermostat is connected to the Zone/Channel, the overview

shows: – Temperatures on the thermostat (setpoint 22,0°C, actual 25,0°C), signal strength (appears with 4 lines, there must be a minimum of 1 line during installation) and mode of operation (CON = continuously). For more info on the display, see controller manual. Repeat registration for other thermostats, by choosing one of the other zones (2 to 8) until required number of thermostats are connected.

Attention! If a thermostat is paired to the wrong zone, do not delete the thermostat. Pair the thermostat to the correct/new zone and the old pairing will be deleted.

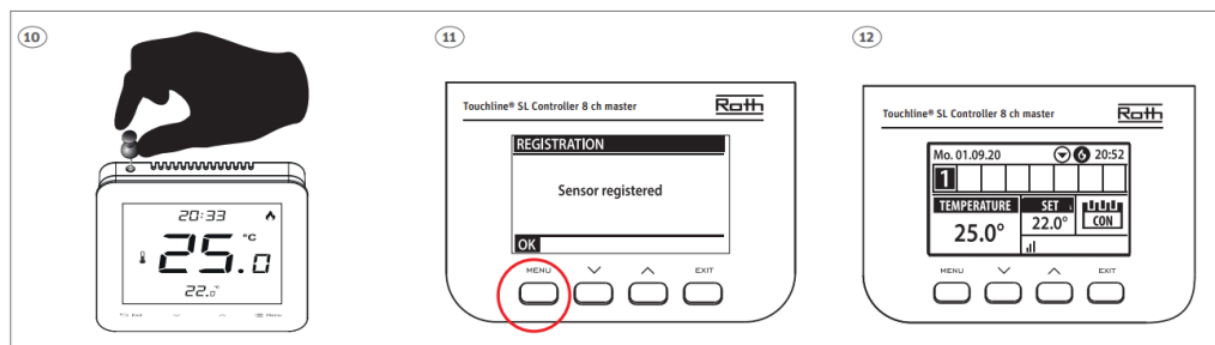

If the thermostat has a floor sensor connected, this must also be paired/registered as shown below (picture 20, must be two quick presses).

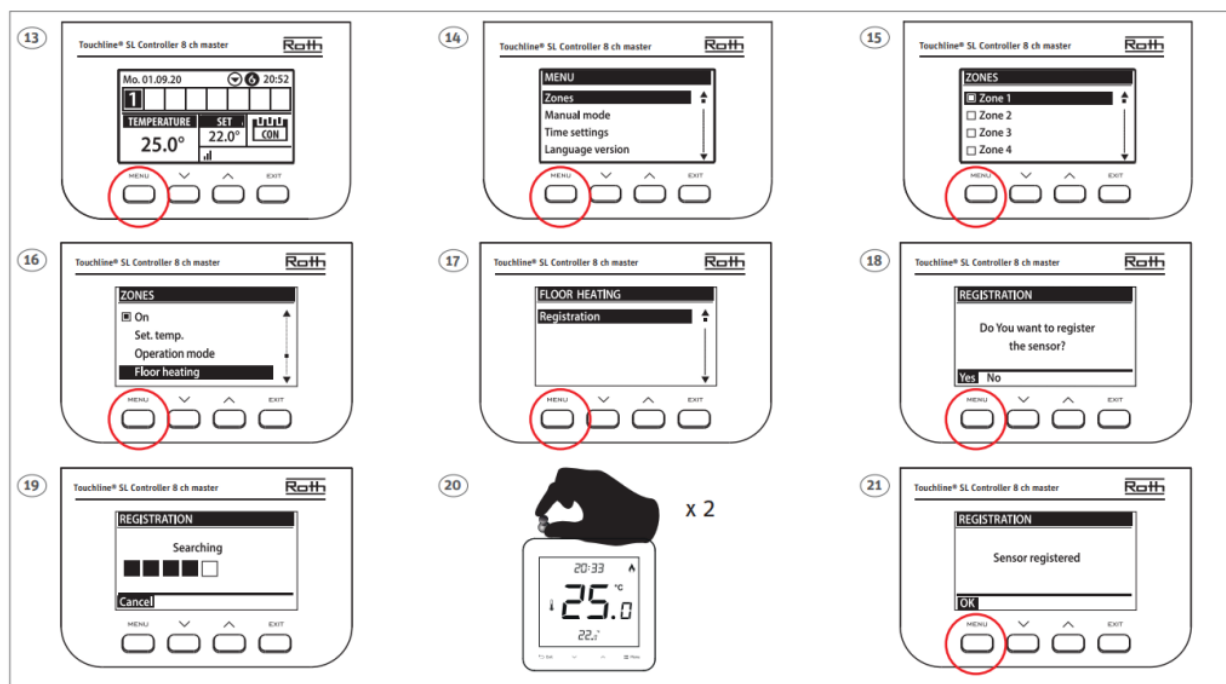

In the overview you can see both the thermostat (setpoint 22,0°C, actual 25,0°C) and the actual floor temperature (21,0°C). Repeat this for all other zones/channels (2 to 8) with a floor sensor.

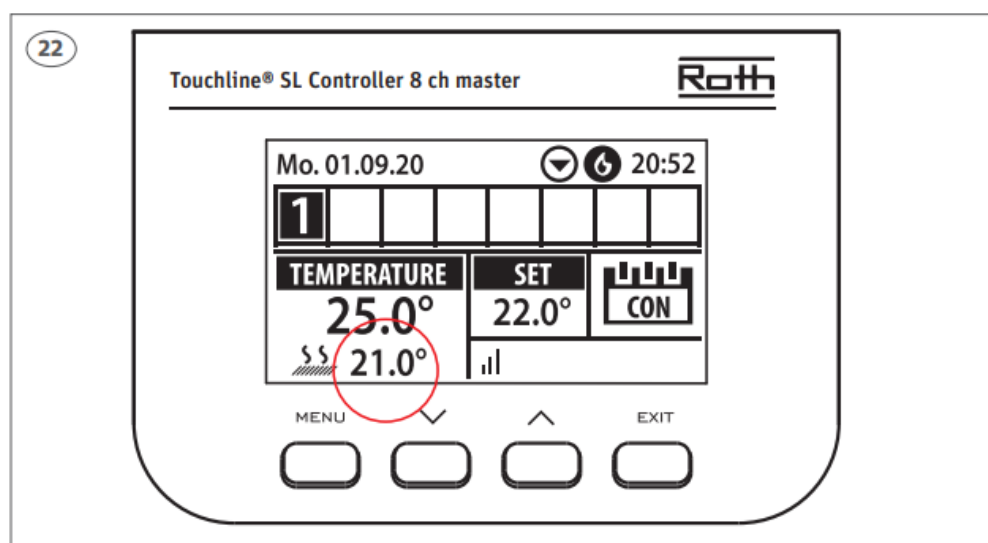

Operation/setting of the floor sensor is carried out on the display of the Controller. Floor sensor operation can be set up as either “Floor protection” (standard) or “Comfort” (min. Floor temp.).

Set sensor as “Floor protection”. Choose operation mode and choose “Floor protection”.

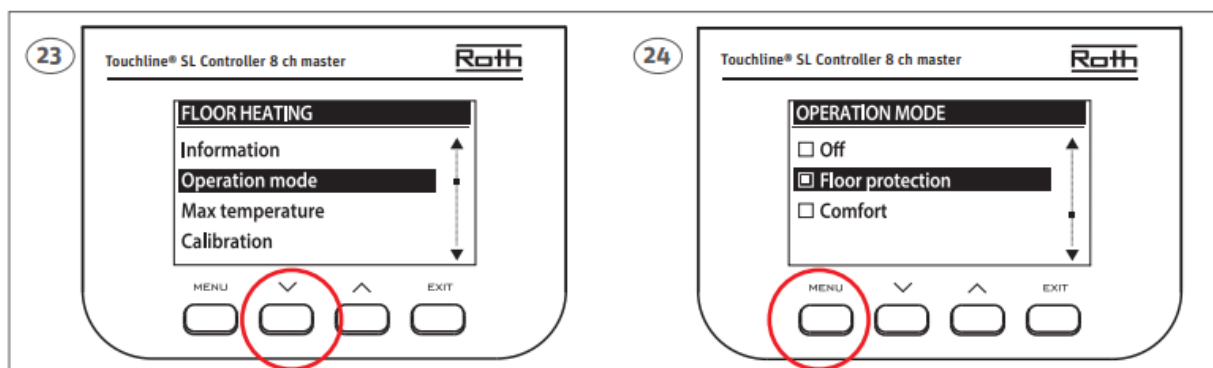

Set max. floor temperature to protect your floor.

Confirm with “Menu”.

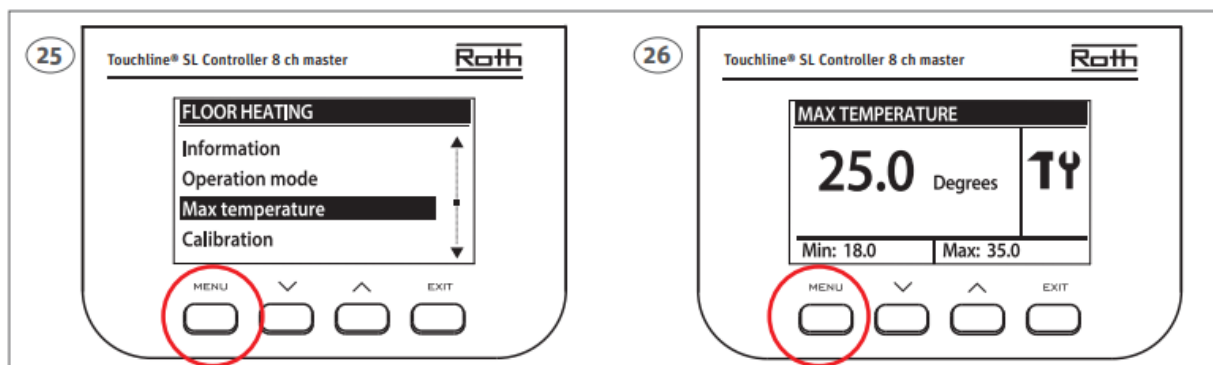

Set sensor as “Comfort”.

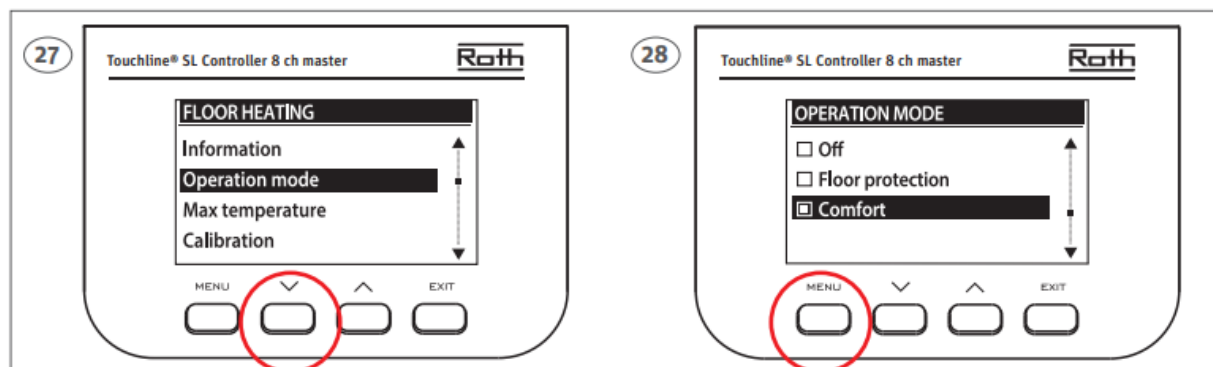



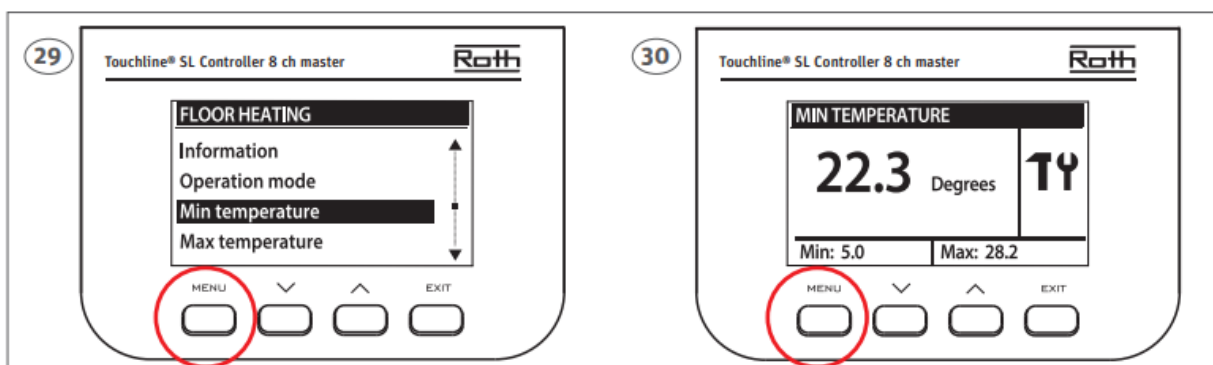

Set min. floor temperature for your comfort level.



Confirm with “Menu”. Min. temperature is set as described above.



Attention! Using the floor sensor as “Floor protection”, the sensor will stop heating if the temperature goes above the set max. temperature. Below this temperature the room sensor has priority. Using the floor sensor in “Comfort” mode, the room sensor will have priority between min. and max. setting. Outside this min/max setting the floor sensor has priority.

Thermostat Display & Lock Guide

	<p>In sleep mode the current temperature is displayed. To set/change temperature press \vee / \wedge buttons. Confirm by pressing Menu.</p>
	<p>You can switch between temperature display and relative humidity display by briefly pressing the Exit button.</p>
	<p>How to lock the buttons. Press “Menu” Select “Yes” using one of the \vee / \wedge buttons and confirm by pressing “Menu” or wait 5 seconds. When the lock is active, the keys are locked automatically after 10 seconds of inactivity. Unlock by pressing both \vee / \wedge buttons for 5 sec. The keys are available when the display does not show the lock. The lock is active until you deactivate it in the menu.</p>
	<p>The room thermostat can show calibration value. Hold down “Menu” for 3 sec. The display shows “Cal” and the calibrated temperature. The value can ONLY be changed on the control unit, under the relevant channel/zone. It can take up to 5 minutes before the calibrated temperature is displayed.</p>

	The room thermostat can be deleted from a control unit by pressing “Menu” for 3 sec., Release and briefly press “Menu” again. FA r is set to NO by default, to change this use “v / ^ “. At “Yes“ press “Menu” or wait 5 sec and the thermostat is cleared from the control unit.
	The room thermostat can display the firmware version, by pressing “Menu” for 3 sec., Release and press twice briefly on “Menu”.

Thermostat Symbol Guide

1	Manual mode
2	Pre-set temperature
3	Button lock
4	WiFi signal strength
5	Current temperature
6	Heating/Cooling

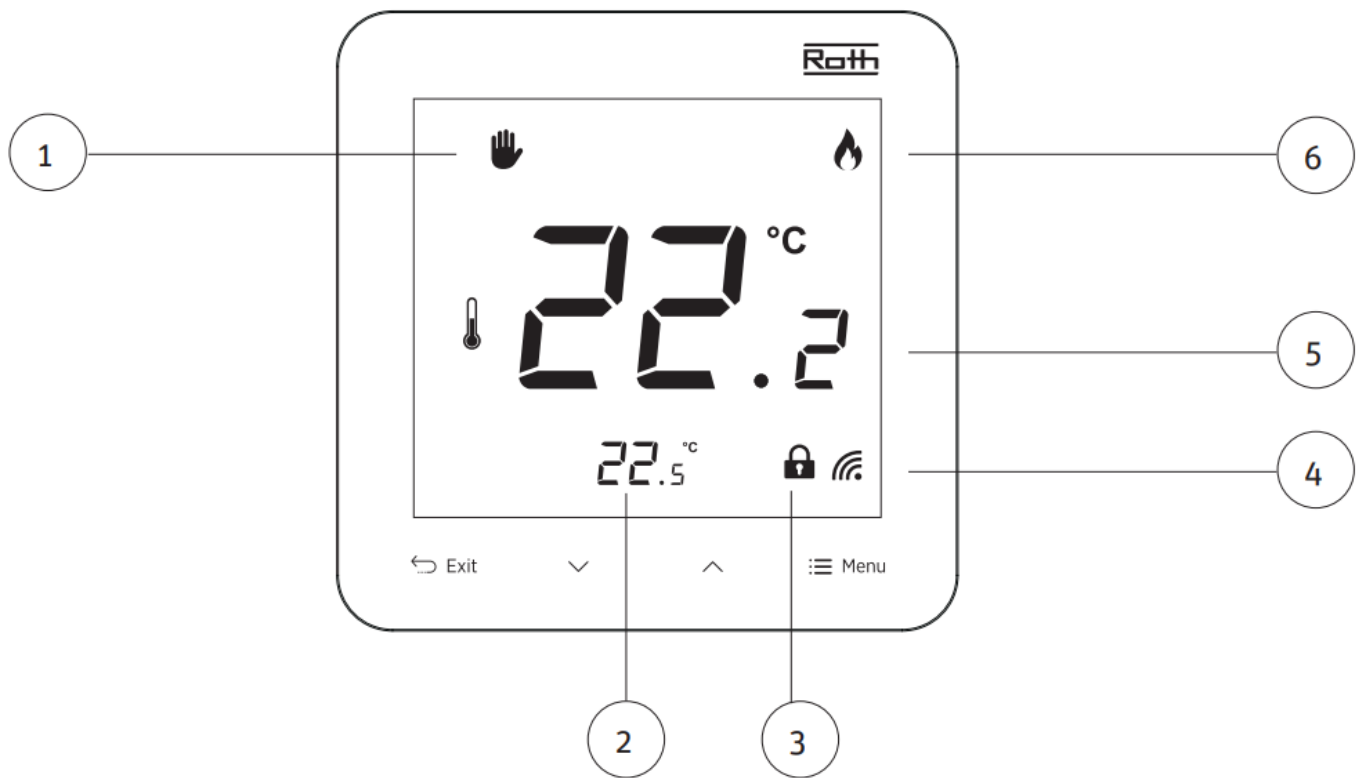

Customer Support

Roth Touchline® SL QR



Enterprise House
Barracks Road
Stourport-On-Severn
Worcestershire
DY13 9RW

Phone +44 (0) 1905 453424

E-Mail enquiries@roth-uk.com

technical@roth-uk.com

orders@roth-uk.com

accounts@roth-uk.com

roth-uk.com



Documents / Resources

	<p>Roth Touchline SL Wireless Control Panel Heating System [pdf] Instruction Manual</p> <p>Touchline SL Wireless Control Panel Heating System, Touchline SL, Wireless Control Panel Heating System, Control Panel Heating System, Panel Heating System, Heating System</p>
---	--

References

- [User Manual](#)

■ Roth

◆ Control Panel Heating System, Heating System, Panel Heating System, Roth, Touchline SL, Touchline SL Wireless Control Panel Heating System, Wireless Control Panel Heating System

Leave a comment

Your email address will not be published. Required fields are marked *

Comment *

Name

Email

Website

☐ Save my name, email, and website in this browser for the next time I comment.

Post Comment

Search:

e.g. whirlpool wrf535swhz

Search

[Manuals+](#) | [Upload](#) | [Deep Search](#) | [Privacy Policy](#) | [@manuals.plus](#) | [YouTube](#)

This website is an independent publication and is neither affiliated with nor endorsed by any of the trademark owners. The "Bluetooth®" word mark and logos are registered trademarks owned by Bluetooth SIG, Inc. The "Wi-Fi®" word mark and logos are registered trademarks owned by the Wi-Fi Alliance. Any use of these marks on this website does not imply any affiliation with or endorsement.