



# Roth Touchline SL Intelligent Control System Instructions

[Home](#) » [Roth](#) » Roth Touchline SL Intelligent Control System Instructions 

## Contents

- [1 Roth Touchline SL Intelligent Control System](#)
- [2 Product Information](#)
- [3 Product Usage Instructions](#)
- [4 BATTERY INSTALLATION](#)
- [5 INSTALLATION INSTRUCTION](#)
- [6 OVERVIEW](#)
- [7 Documents / Resources](#)
  - [7.1 References](#)



**Roth Touchline SL Intelligent Control System**



## Product Information

The product is a thermostat that can be connected to an optional floor sensor (not included) for controlling the temperature of underfloor heating. The sensor can be placed just below the upper floor covering, in the middle between the underfloor heating pipes. The operation and setting of the floor sensor can be done on the display of the controller. The thermostat can be mounted on a wall using the included backplate and screws.

## Product Usage Instructions

1. To separate the front and back parts of the floor sensor, insert the tip of a straight-edged screwdriver into the slot between them and twist them apart.
2. If you have an optional floor sensor, carefully push its wires into the clamp and screw them on. Pull the sensor into the draw pipe and place its end just below the upper floor covering, in the middle between the underfloor heating pipes.
3. Mount the backplate on the wall using the included screws, and slide the thermostat onto it.
4. Set up the floor sensor operation by selecting either Floor Protection (standard) or Comfort (minimum floor temperature) mode on the controller display.
5. If you choose to use the floor sensor as Floor Protection, it will stop heating if the temperature goes above the set maximum temperature. Below this temperature, the room sensor has priority.
6. If you choose to use it in Comfort mode, the room sensor will have priority between the minimum and maximum settings. Outside this range, the floor sensor has priority.

## BATTERY INSTALLATION

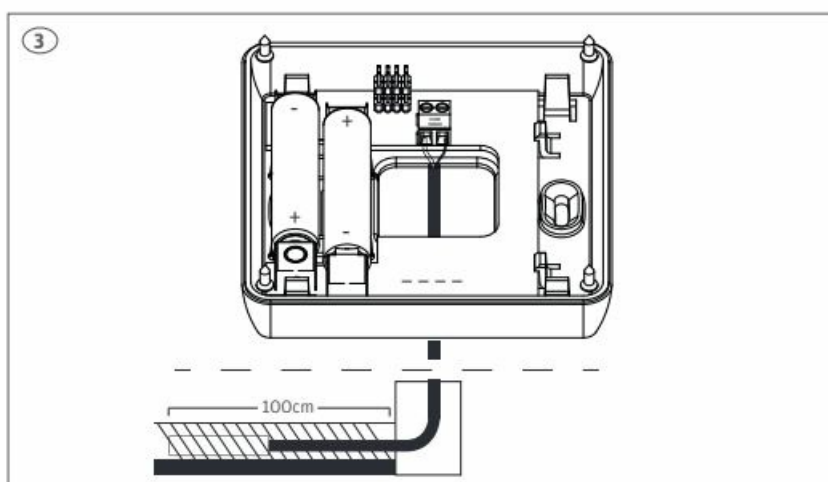
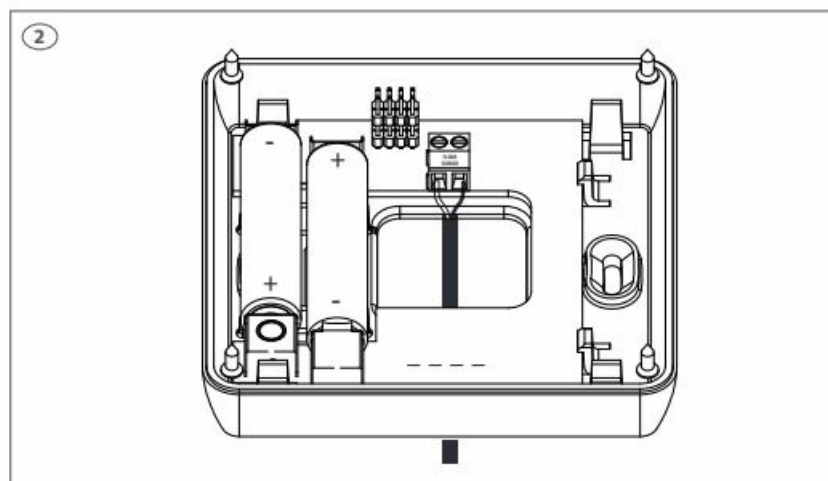
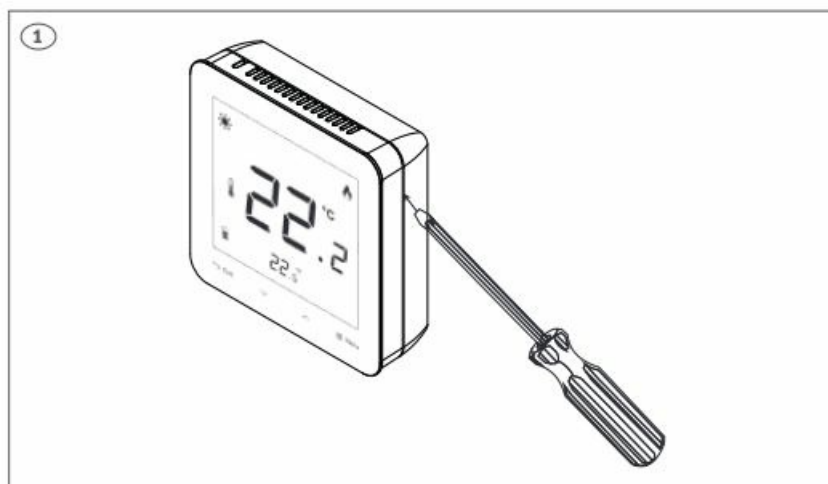
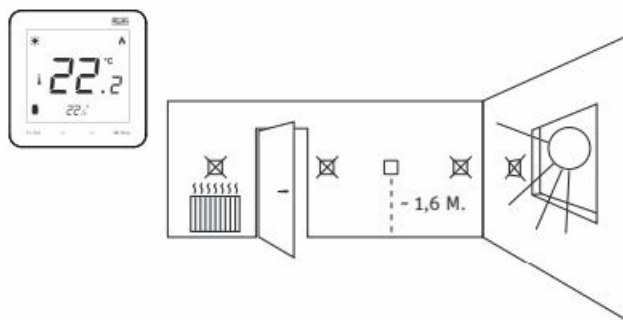

- Insert the tip of a straight-edged screwdriver into the slot between the front and the back and twist the parts apart.
- Insert batteries (included), be aware of +/- polarity

- It is possible to connect a floor sensor to the thermostat (floor sensor not included). Carefully push the wires into the clamp and screw them on. The sensor must be pulled into the draw pipe and the sensor end placed just below the upper floor covering, in the middle between the underfloor heating pipes.

## INSTALLATION INSTRUCTION

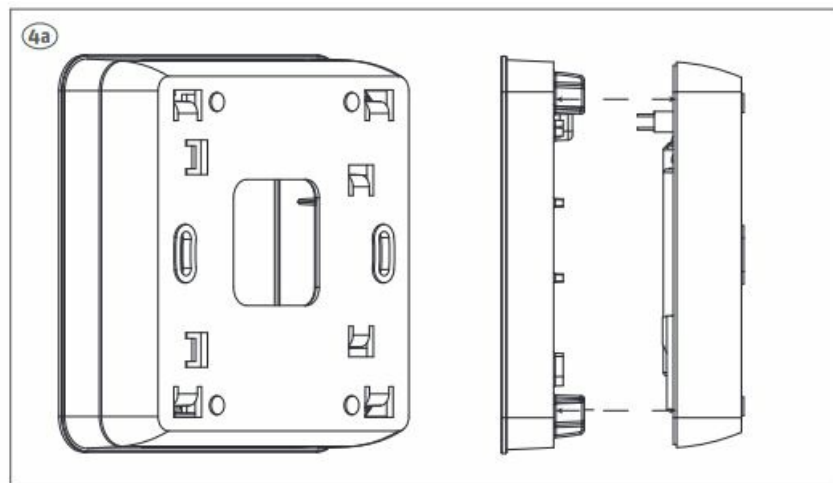

- Mount backplate on the wall (screws are incl.) thermostat slides onto back plate.
- The thermostat can be connected to all Controllers in the Roth Touchline® SL series. Pairing/registering is made the same way on all Controllers using the same buttons. On the pictures the panel of the Roth Touchline® SL Controller, master is shown.

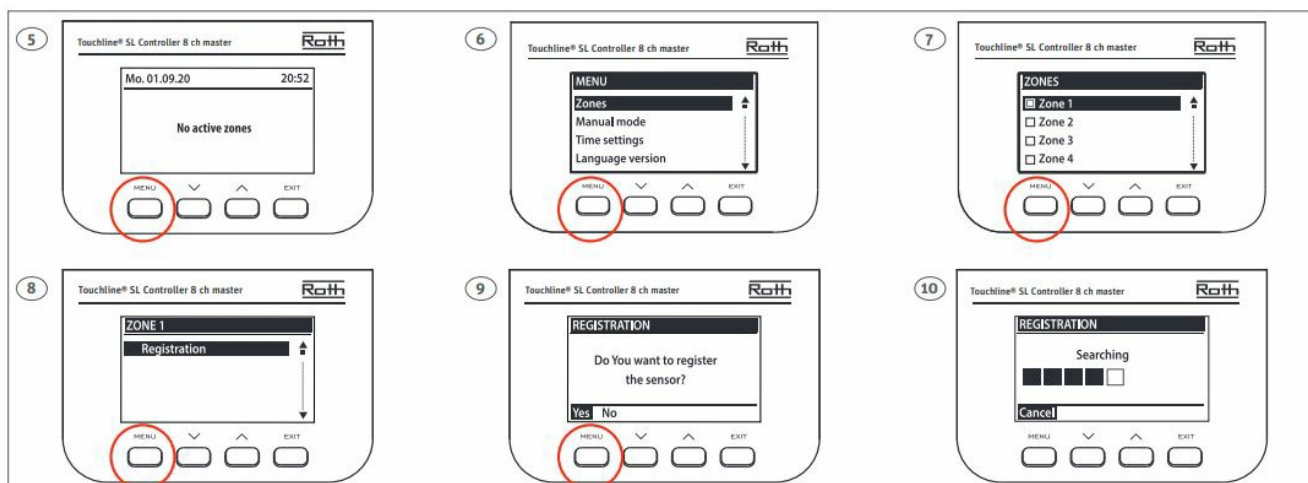

- Pairing/registering the thermostat to a zone (channel). All connections must be made to the Controller (pump, actuators and optionally potential free relay) before start-up.
- Please see controller manual for details.
- **Attention!** Do not press the buttons on the front of the thermostat whilst pushing the pairing button on the rear (see picture 11).

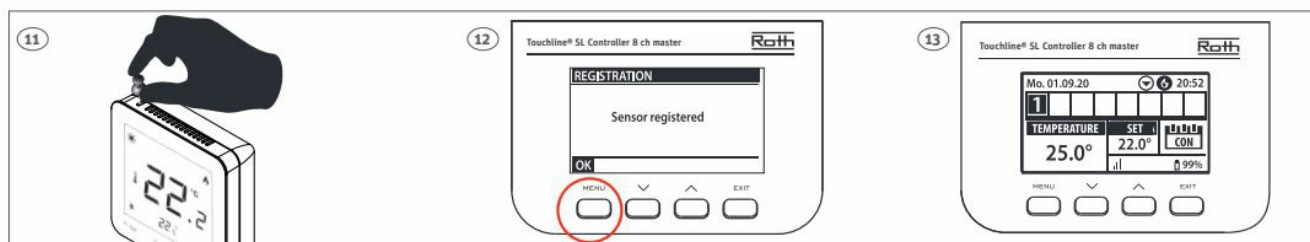

- Once the thermostat is connected to the Zone/Channel, the overview shows: – Temperatures on the thermostat (setpoint 22,0°C, actual 25,0°C). battery (99%), signal strength (appears with 4 lines, there must be a minimum of 1 line during installation), and mode of operation (CON = continuously). For more info on the display, see the

controller manual. Repeat registration for other thermostats, by choosing one of the other zones (2 to 8) until the required number of thermostats are connected.

- **Attention!** If a thermostat is paired to the wrong zone, do not delete the thermostat. Pair the thermostat to the correct/new zone and the old pairing will be deleted.

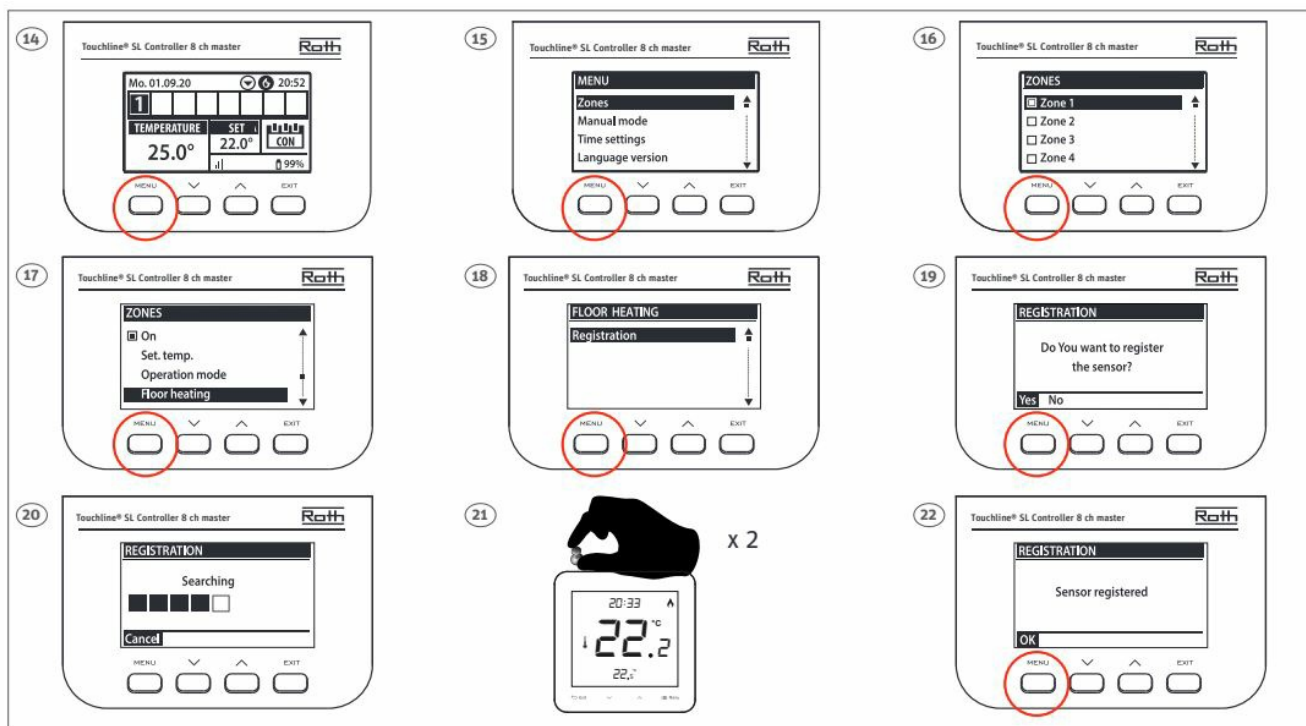

- If the thermostat has a floor sensor connected, this must also be paired/registered as shown below picture 21, must be two quick presses).
- In the overview you can see both the thermostat (setpoint 22,0°C, actual 25,0°C) and the actual floor temperature (21,0°C). Repeat this for all other zones/channels (2 to 8) with a floor sensor.

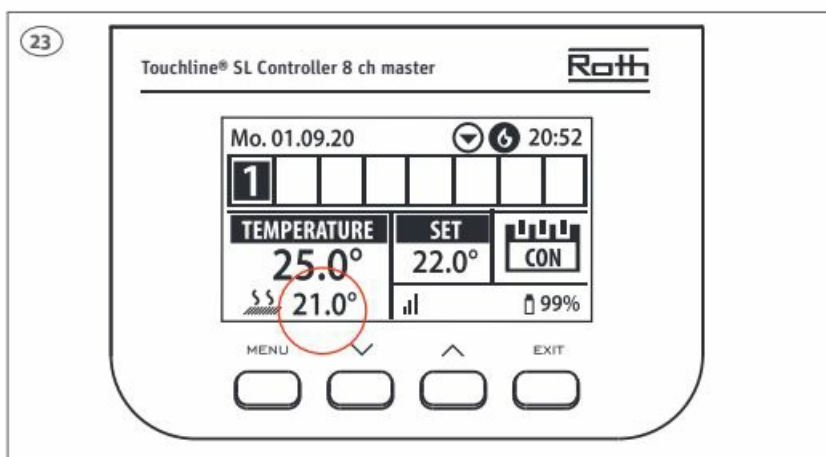

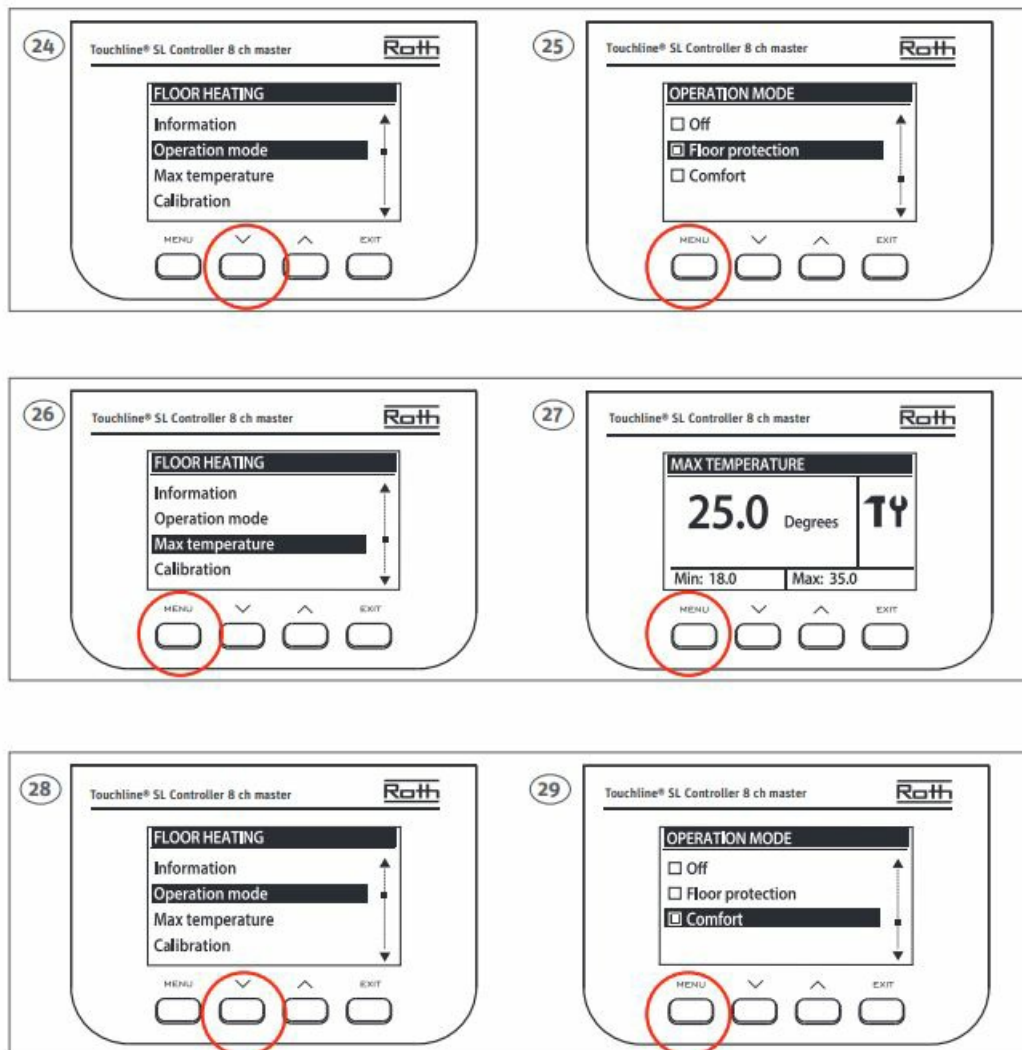

- Operation/setting of the floor sensor is carried out on the display of the Controller. Floor sensor operation can be set up as either “Floor protection” (standard) or “Comfort” (min. Floor temp.).
- A set the sensor as “Floor protection”. Choose operation mode and choose “Floor protection”.
- Set max. floor temperature to protect your floor. Confirm with “Menu”.
- Choose operation mode and choose “Comfort”.
- Set min. floor temperature for your comfort level. Confirm with “Menu”. Min. temperature is set as described above.

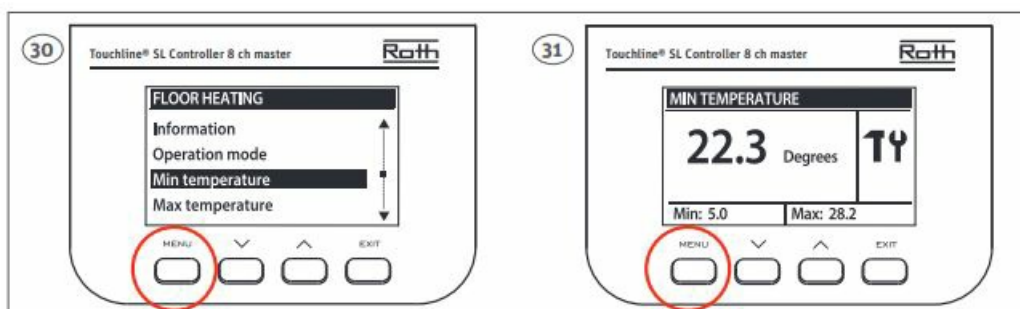

- **Attention!** Using the floor sensor as “Floor protection”, the sensor will stop heating if the temperature goes above the set max. temperature. Below this temperature the room sensor has priority. Using the floor sensor in “Comfort” mode, the room sensor will have priority between min. and max. setting. Outside this min/max setting the floor sensor has priority.
- In sleep mode the current temperature is displayed. To set/change temperature press the v / ^ buttons. Confirm by pressing Menu.



- You can switch between temperature display and relative humidity display by briefly pressing the Exit button.



- How to lock the buttons.
- Press "Menu" Select "Yes" using one of the v / ^ buttons and confirm by pressing "Menu" or wait 5 seconds.
- When the lock is active, the keys are locked automatically after 10 seconds of inactivity.
- Unlock by pressing both v / ^ buttons for 5 sec. The keys are available when the display does not show the lock. The lock is active until you deactivate it in the menu.



- The room thermostat can show calibration value.
- Hold down "Menu" for 3 sec. The display shows Cal" and the calibrated temperature. The value can ONLY be changed on the control unit, under the relevant channel/zone. It can take up to 5 minutes before the calibrated temperature is displayed.



- The room thermostat can be deleted from a control unit by pressing "Menu" for 3 sec., Release and briefly pressing "Menu" again.
- FA is set to NO by default, to change this use "v / ^"
- At "Yes" press "Menu" or wait 5 sec and the other- most is cleared from the control unit.



- The room thermostat can display the firmware version, by pressing “Menu” for 3 sec., Releasing and pressing twice briefly on “Menu.”



## OVERVIEW

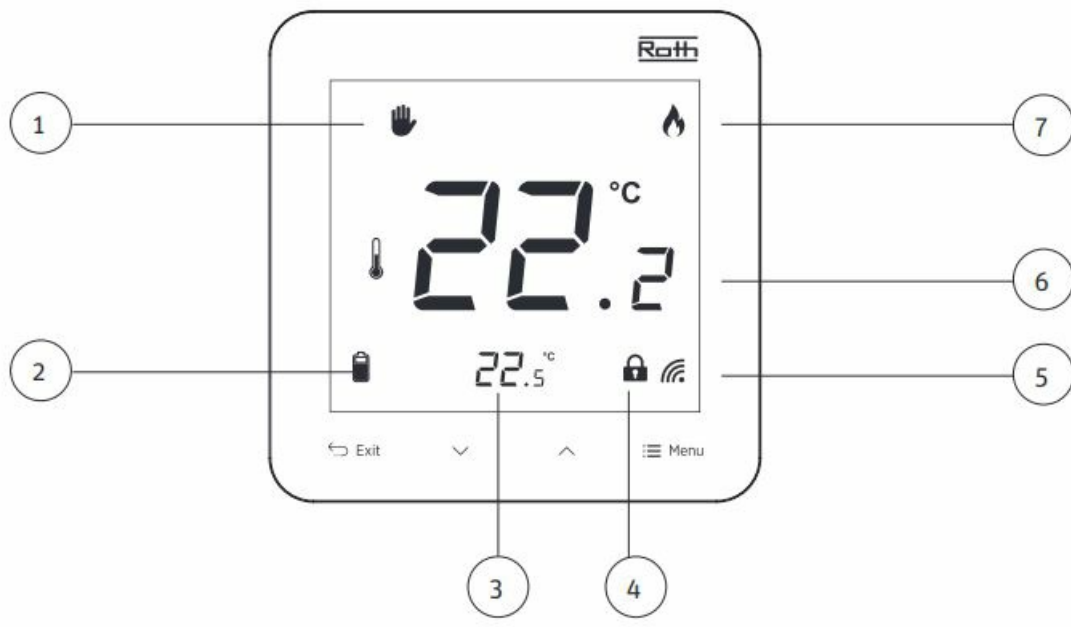



1	Manual mode
2	Battery level
3	Pre-set temperature
4	Button lock
5	WiFi signal strength
6	Current temperature
7	Heating/Cooling

- ROTH UK Ltd
- 1a Berkeley Business Park
- Wainwright Road
- Worcester WR4 9FA
- Phone +44 (0) 1905 453424
- E-Mail: [enquiries@roth-uk.com](mailto:enquiries@roth-uk.com) [technical@roth-uk.com](mailto:technical@roth-uk.com) [orders@roth-uk.com](mailto:orders@roth-uk.com) [accounts@roth-uk.com](mailto:accounts@roth-uk.com)  
[roth-uk.com](http://roth-uk.com)



## Documents / Resources

	<p><a href="#">Roth Touchline SL Intelligent Control System</a> [pdf] Instructions Touchline SL Intelligent Control System, Touchline SL, Intelligent Control System, Control System</p>
---	--

## References

-  [Frontpage | Norge.no](#)
-  [Hej! Welcome to Sweden | sweden.se – the official website of Sweden](#)
-  [UK.COM](#)

Manuals+.