

Roth Touchline SL Energy logic Project line Wireless Control



Roth Touchline SL Energy logic Project line Wireless Control Installation Guide

[Home](#) » [Roth](#) » Roth Touchline SL Energy logic Project line Wireless Control Installation Guide 

Contents

- [1 Roth Touchline SL Energy logic Project line Wireless Control](#)
- [2 Product Information](#)
- [3 Models](#)
- [4 Placement](#)
- [5 Installation and Using Instructions](#)
- [6 Contacts](#)
- [7 Documents / Resources](#)
 - [7.1 References](#)



Roth Touchline SL Energy logic Project line Wireless Control



Product Information

Specifications

- **Model:** Thermostat XYZ
- **Dimensions:** ~ 1.6 meters
- **Features:** Floor sensor compatibility, zone pairing, temperature settings, battery level display

Frequently Asked Questions

- **Q:** How do I pair/register the thermostat to a zone?
 - **A:** Make all necessary connections to the Controller first before pairing. Avoid pressing buttons on the front while pushing the pairing button at the rear of the thermostat.
- **Q:** What happens if I set the floor sensor as Floor protection?
 - **A:** The sensor will stop heating if the temperature exceeds the set maximum. Below this temperature, the room sensor takes priority.
- **Q:** How do I check the battery level?
 - **A:** Select Bat to view battery level. Confirm within 5 seconds for percentage display.

Models

- Roth Touchline® SL rumtermostat X >
- Roth Touchline® SL thermostat X >

- Roth Touchline® SL termostat X >
- Roth Touchline® SL huonetermostaatti X >
- Roth Touchline® SL room thermostat X>

Placement

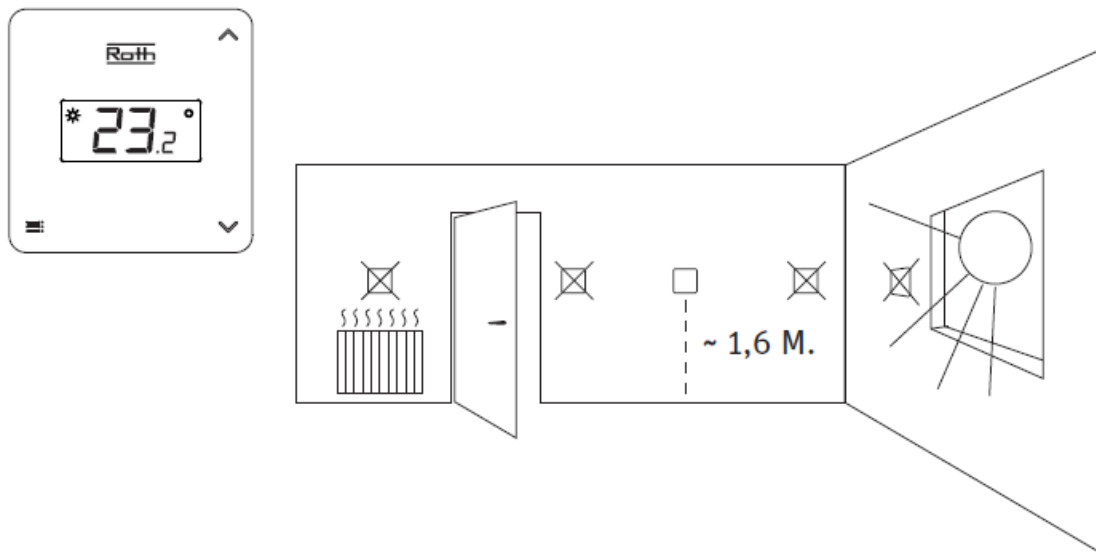

Installation and Using Instructions

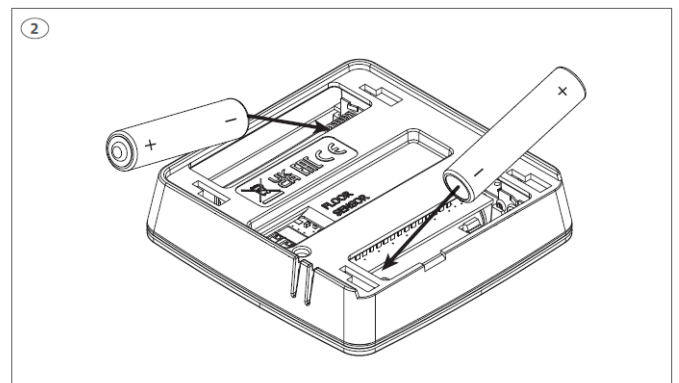
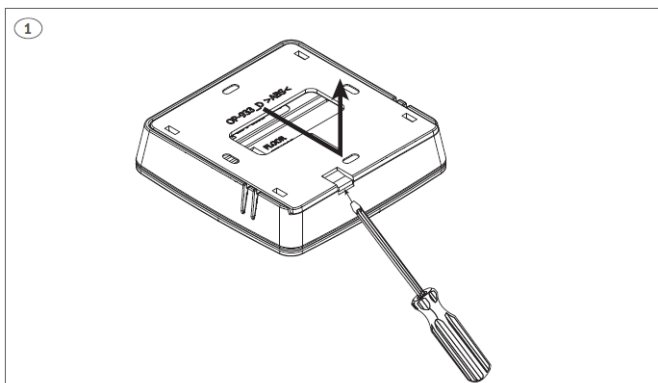

- Push lightly on the snap lock with a finger or screwdriver (if mounted on the wall) to slide the backplate of the thermostat.
- Insert batteries (included), be aware of +/- polarity.

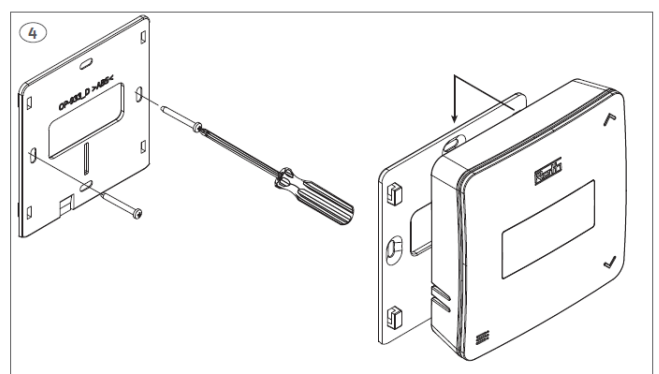
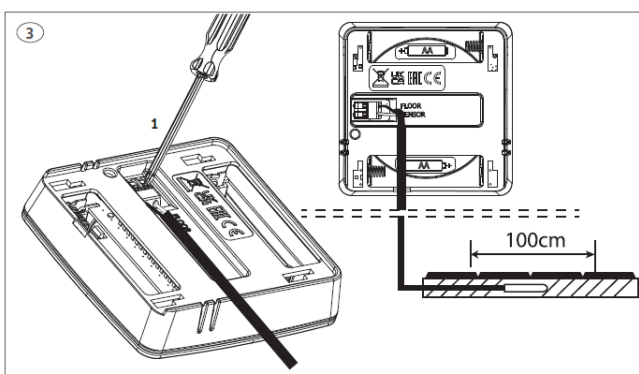

- It is possible to connect a floor sensor to the thermostat (floor sensor not incl.). Push gently on the terminals while you put the cable into the terminal. The sensor must be drawn in a tube and the tip placed directly beneath the top floor cover, in the middle between the floorheating pipes.

- Mount backplate on the wall (screws not incl.) thermostat slides onto back plate.

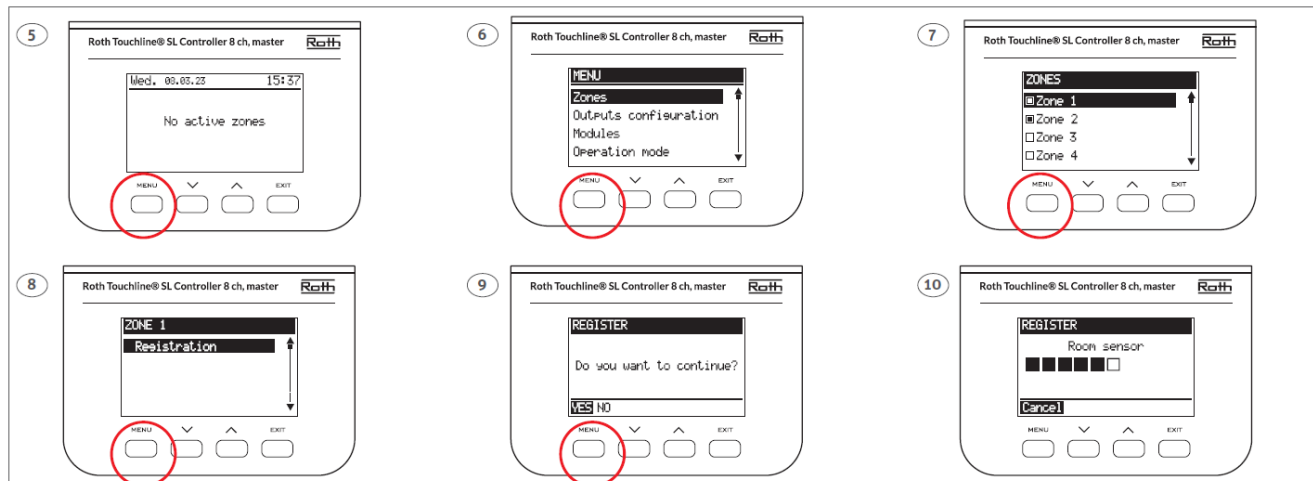

- The thermostat can be connected to all Controllers in the Touchline® SL series. Pairing/registering is made the same way on all Controllers using the same buttons. On the pictures the panel of the Touchline® SL Controller, master is shown.
- Pairing/registering the thermostat to a zone (channel). All connections must be made to the Controller (pump, actuators and optionally potential free relay) before start-up. Please see controller manual for details.
 - **Attention:** Do not press the buttons on the front of the thermostat whilst pushing the pairing button on the rear (see picture 11).

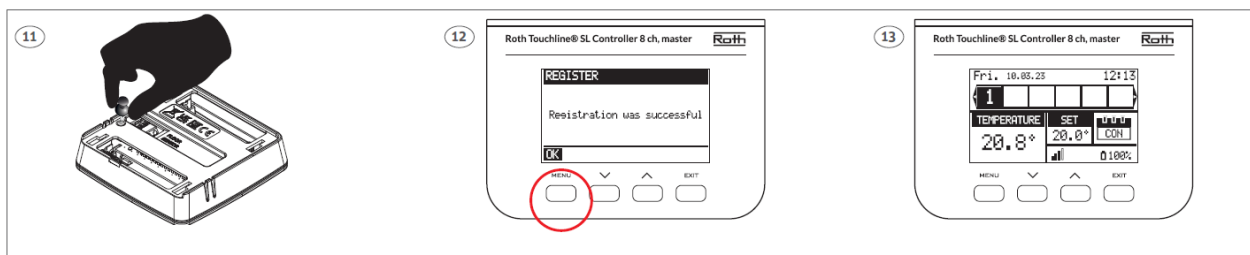

- Once the thermostat is connected to the Zone/Channel, the overview shows: – Temperatures on the thermostat (setpoint 22,0°C, actual 25,0°C) , battery (99%), signal strenght (100% – must be at least 10%) and mode of operation (CON = continously). For more info on the display, see controller manual. Repeat registration for other thermostats, by choosing one of the other zones (2 to 8) until required number of thermostas are connected.
 - **Attention:** If a thermostat is paired to the wrong zone, do not delete the thermostat. Pair the thermostat to the correct/new zone and the old pairing will be deleted.

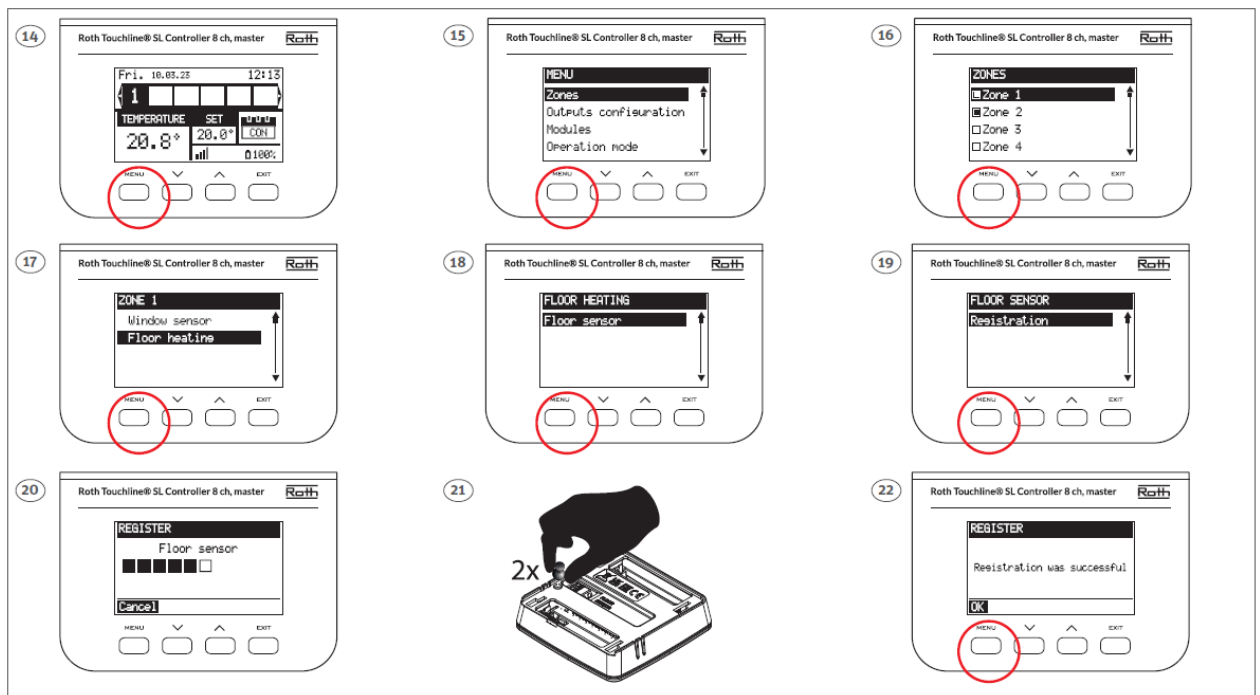

- If the thermostat has a floor sensor connected, this must also be paired/registered as shown below (picture 21, must be two quick presses).

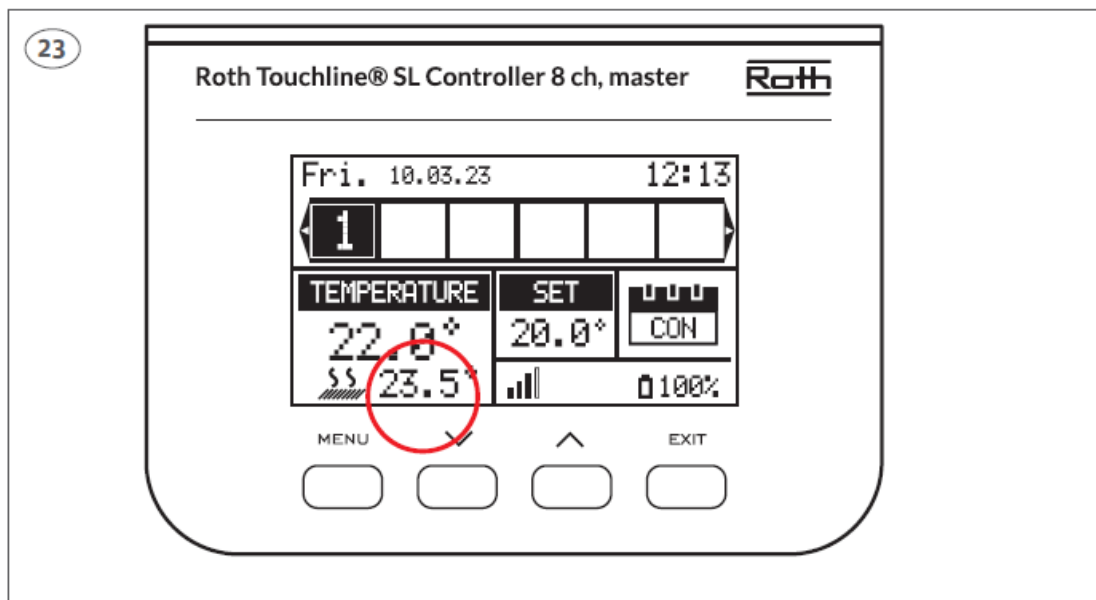

- In the overview you can see both the thermostat (setpoint 22,0°C, actual 25,0°C) and the actual floor temperature (21,0°C). Repeat this for all other zones/channels (2 to 8) with a floor sensor.
- Operation/setting of the floor sensor is carried out on the display of the Controller. Floor sensor operation can be set up as either "Floor protection" (standard) or "Comfort" (min. Floor temp.).

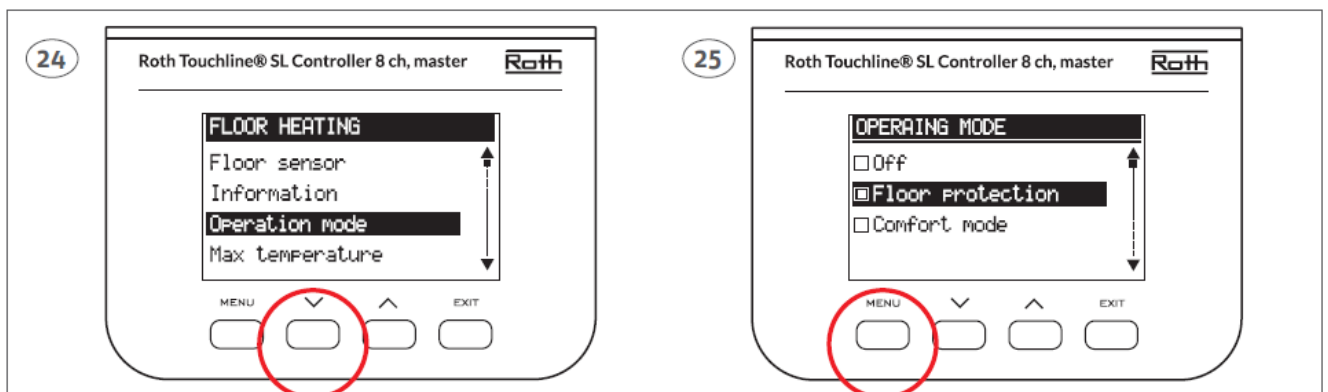

- Set sensor as "Floor protection". Choose operation mode and choose "Floor protection".

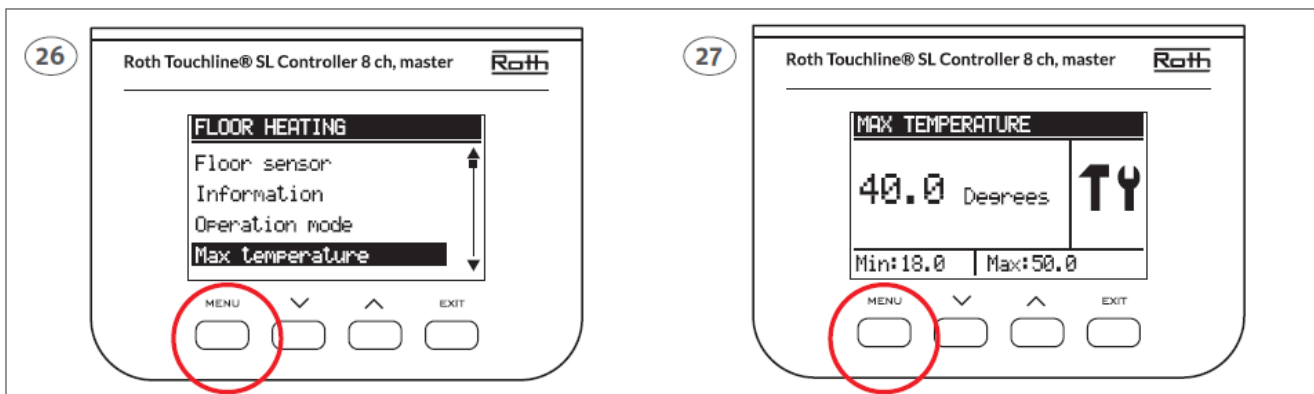

- Set max. floor temperature to protect your floor. Confirm with "Menu".

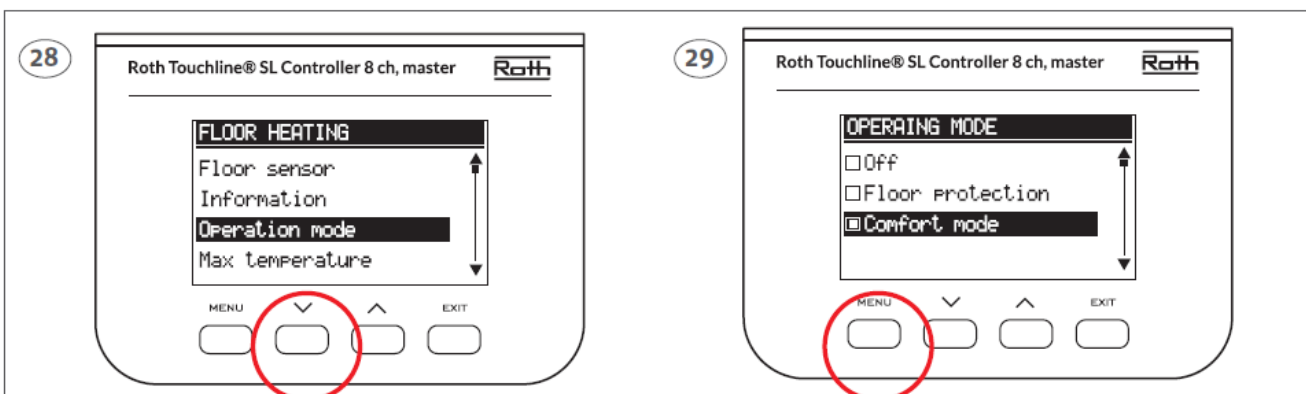

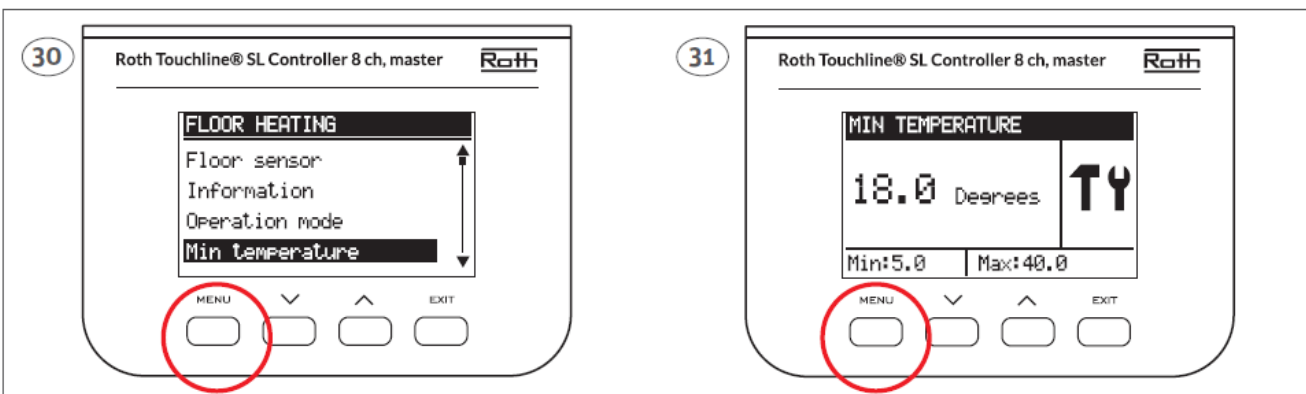

- Choose operation mode and choose "Comfort".



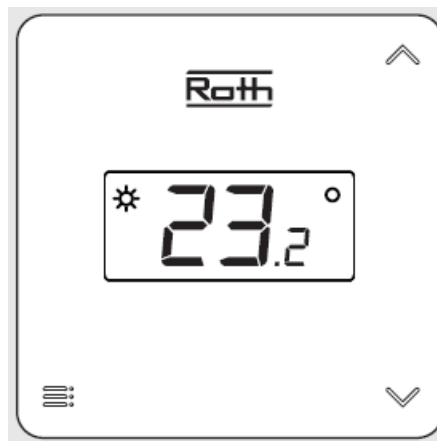

- Set min. floor temperature for your comfort level. Confirm with "Menu". Min. temperature is set as described above.

Attention: Using the floor sensor as "Floor protection", the sensor will stop heating if the temperature goes above the set max. temperature. Below this temperature the room sensor has priority. Using the floor sensor in "Comfort" mode, the room sensor will have priority between min. and max. setting. Outside this min/max setting the floor sensor has priority.

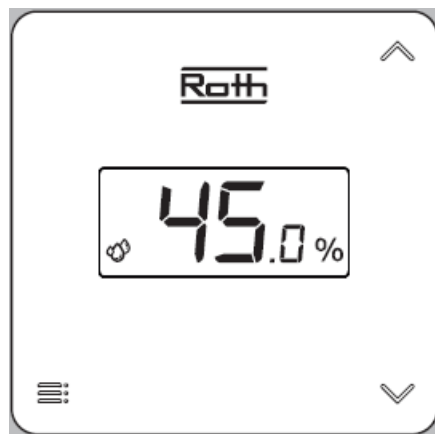

- In sleepmode the current temperature is displayed. To set/change temperature press < > buttons. Confirm by pressing  or wait 5 sec.



- You can switch between temperature display and relative humidity display by briefly pressing the  button.
- You can choose between three modes on the thermostat. After changing the setpoint with < / > the actual setting is flashing:

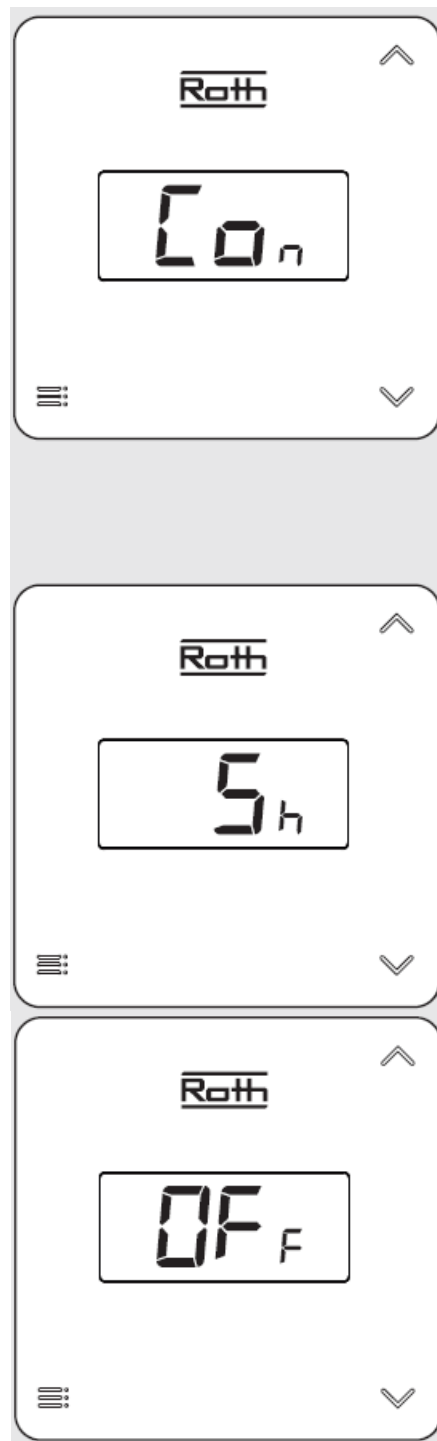

- “Con” means setpoint is due constantly.
- “5H” means that the desired setpoint will be valid for the next 5 hours, after this the thermostat will return to it’s normal mode.
- “OFF” means that it follows the mode preset on the Controller.
- The chosen mode can also be seen on the Controller display. Changing the mode “Con”, “5h” and “OFF” is done using the buttons < / > when the mode is flashing.

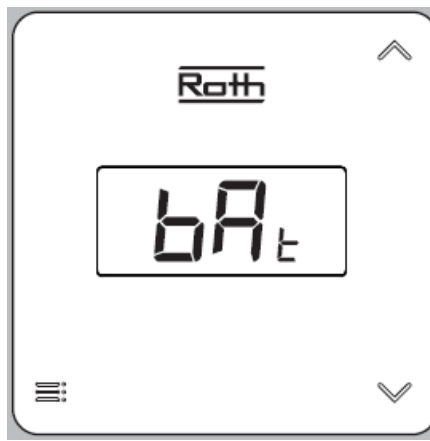

- Enables you to view battery level. Select “Bat”, the display flashes. Confirm within 5 sec. after which the battery level is displayed in percentage %.

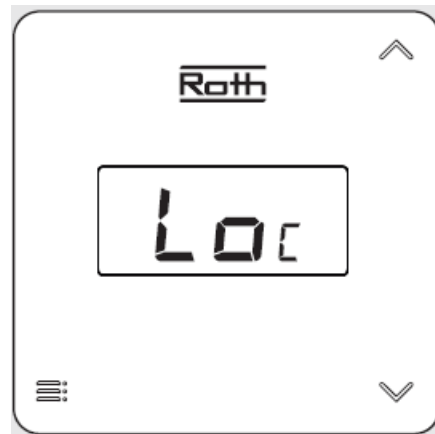

- Enables you to lock the buttons. Select “Yes” by using one of the buttons < >, confirm by pressing or wait 5 seconds. When the lock is active, the keys are locked automatically after 10 seconds of in-activity. To unlock, press and hold the bottoms < > for 10 sec. The keys are accessible when the display returns to showing the current temperature. The key lock is activated until you inactivate it in the menu.

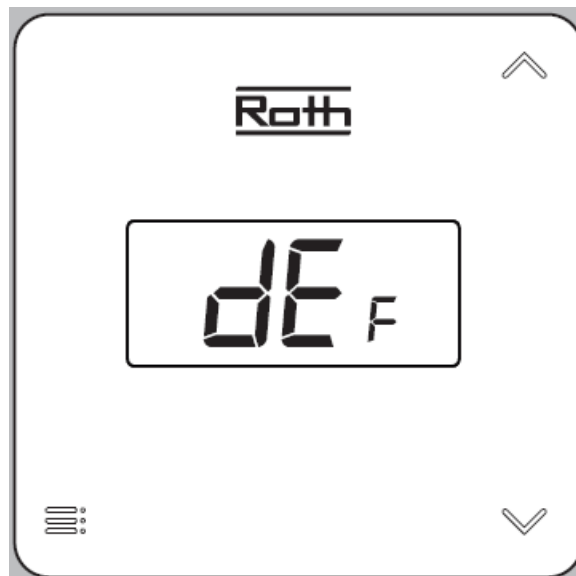

- Enables you to return the room thermostat to the factory setting. Select “dEF” and the display flashes and shows the selected value. Select/confirm (Yes) with < > buttons within 5 sec. Confirm by pressing or wait 5 sec. and the factory settings has be restored.

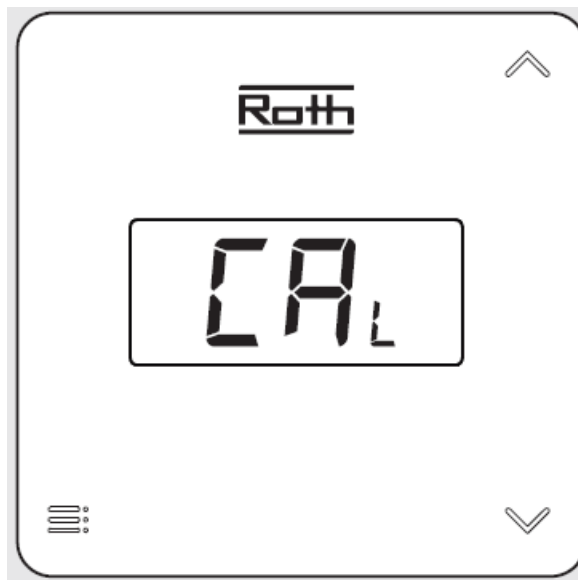

- Enables you to view the sensor calibration value. After selecting "Cal" the screen flashes for 3 sec. and the value is displayed. Value can be changed on the Controller, please see user manual.

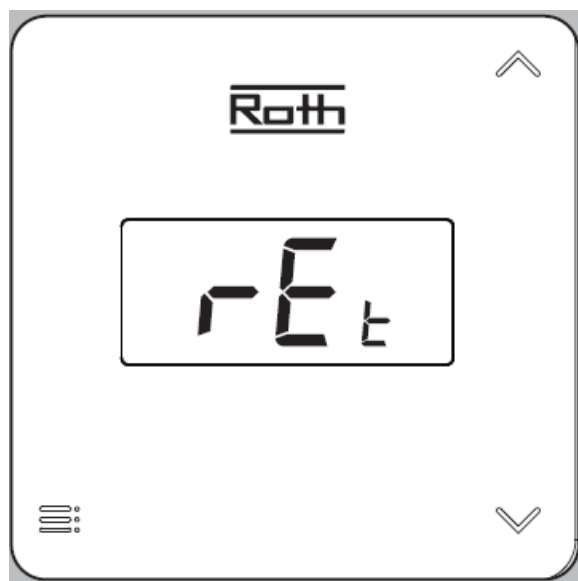

- Enables you to return from the MENU manually. After selecting "rEt" the screen flashes for 5 sec. and returns to view of the current temperature.

Contacts

ROTH UK Ltd

- Enterprise House
- Barracks Road Stourport-On-Severn Worcestershire DY13 9RW
- **Phone:** +44 (0) 1905 453424
- **E-Mail:** enquiries@roth-uk.com
- technical@roth-uk.com
- orders@roth-uk.com
- accounts@roth-uk.com
- roth-uk.com

ROTH DANMARK A/S

- Centervej 5 3600 Frederikssund
- Tlf. +45 4738 0121
- E-mail: service@roth-danmark.dk
- roth-danmark.dk

ROTH SVERIGE AB

- Höjdrodergatan 22 212 39 Malmö
- Tel. +46 40534090
- Fax +46 40534099
- E-mail: service@roth-sverige.se
- roth-sverige.se

ROTH NORGE AS

- Billingstadsletta 19 1396 Billingstad
- Tel. +47 67 57 54 00
- E-mail: service@roth-norge.no
- roth-norge.no
- facebook.com/RothNorge

ROTH FINLAND OY

- Raaseporintie 9 (Talo 2) 10600 Tammisaari
- Puh. +358 (0)19 440 330
- S-posti: service@roth-finland.fi
- roth-finland.fi
- facebook.com/RothFinland

Roth Touchline® SL QR



Installation Roth Touchline® SL room thermostat_X_20231129

Documents / Resources

	<p>Roth Touchline SL Energy logic Project line Wireless Control [pdf] Installation Guide Touchline SL Energy logic Project line Wireless Control, Touchline SL, Energy logic Project line Wireless Control, Project line Wireless Control, Wireless Control</p>
---	---

References

- [Frontpage | Norge.no](#)
- [Hej! Welcome to sweden.se – the official website of Sweden](#)
- [UK.COM](#)
- [User Manual](#)

Manuals+ Privacy Policy

This website is an independent publication and is neither affiliated with nor endorsed by any of the trademark owners. The "Bluetooth®" word mark and logos are registered trademarks owned by Bluetooth SIG, Inc. The "Wi-Fi®" word mark and logos are registered trademarks owned by the Wi-Fi Alliance. Any use of these marks on this website does not imply any affiliation with or endorsement.