



Roth Touchline SL Controller Installation Guide

[Home](#) » [Roth](#) » Roth Touchline SL Controller Installation Guide 

Contents

- [1 Roth Touchline SL Controller](#)
- [2 Product Usage Instructions](#)
- [3 INSTALLATION](#)
- [4 CONNECTION](#)
- [5 SETTING](#)
- [6 Documents / Resources](#)
 - [6.1 References](#)



Roth Touchline SL Controller



Product Usage Instructions

1. Installation: Before working on the controller, always switch off the 230V power supply to prevent the risk of fatal electric shock from touching live connections.
2. Connect the control unit extension to a 230V power supply.
3. The control unit extension has a 230V pump output. Ensure the cables are secured.
4. The pump output on the control unit extension can be used to control a pump connected locally or transfer signals (heat call from thermostats) to the control unit master. Refer to page 6 of the user manual for detailed

instructions on setting up the pump output.

5. Connect the control unit to a 230V power supply. The controller is ready for pairing of sensors. Please refer to the thermostat/sensor operation manual for instructions.
6. Use the menu options to set time settings, screen settings, language version, and access fitter-specific functions.
7. In the fitters menu, you can configure additional contacts, contact operation mode, and radiator zones.
8. In the contact operation mode, you can choose between a potential-free contact or pump operation.
9. Follow the steps on the screens to set up the control unit extension for controlling the global pump connected to the master control unit.
10. Access the service menu for language version, fitters menu, and software version options.
11. In the fitters menu, you can configure the internet module, repeater configuration, additional contacts, and contact operation mode.
12. You can enable or disable remote work in the fitters menu.
13. Contact operation mode allows you to choose between a potential-free contact or pump operation.

WARNING

Risk of fatal electric shock from touching live connections. Before working on the controller always switch off the 230V power supply and prevent it from being accidentally switched on.

INSTALLATION

- Roth Touchline® SL Controller 8 ch, extension HVAC no.7466397038

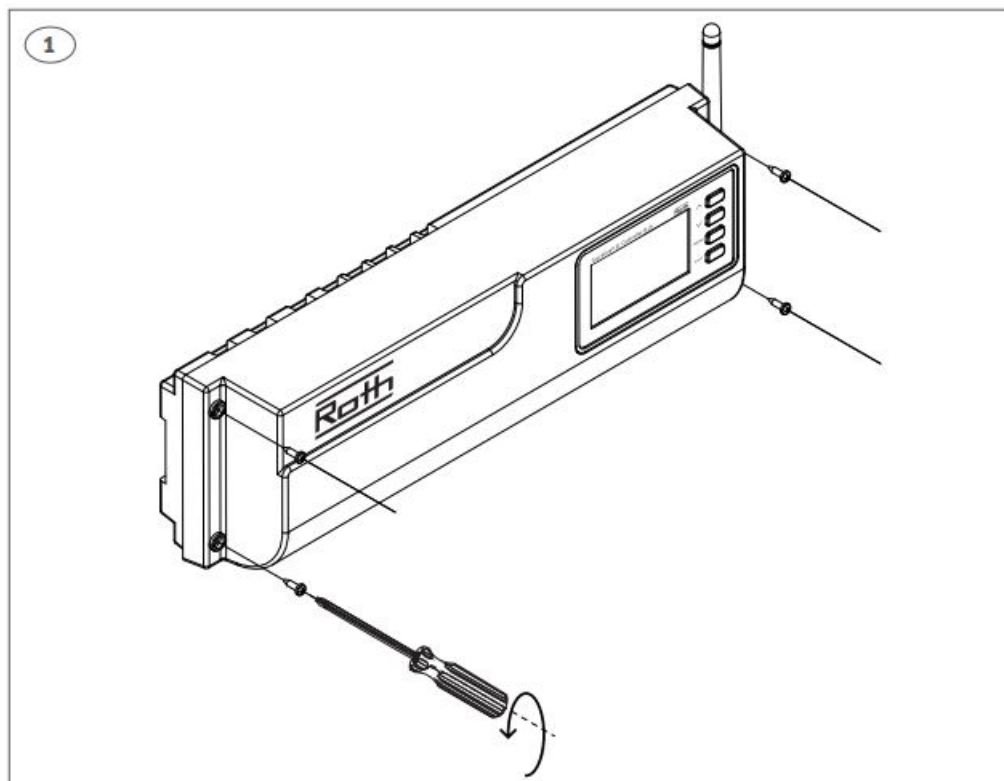

- Must be mounted on a flat surface or using a DIN rail (not incl.), screws max. Ø 4 mm.

B. Boiler/heat supply, potential free relay max. load 1A.

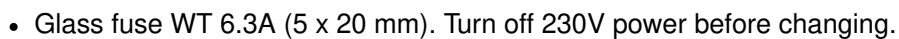
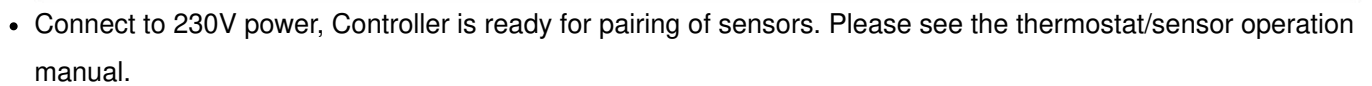

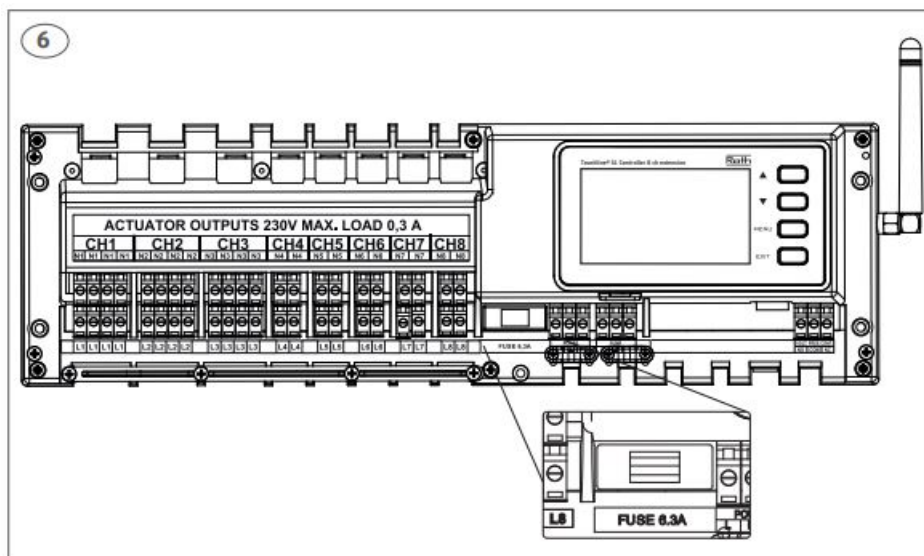

CONNECTION

- One Roth Touchline® SL Controller, master can be connected wireless with up to 4 Roth Touchline® SL Controllers, extension, meaning up to 40 channels in one system.



SETTING

- Now press the MENU button on the Roth Touchline® SL Controller extension, and follow the screens.

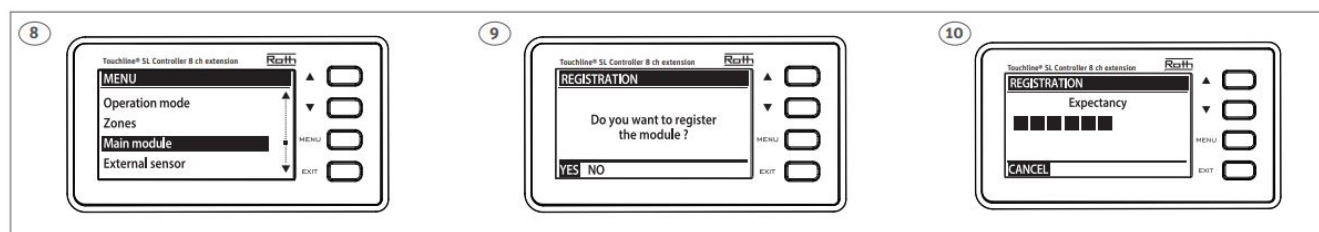

- Now press the MENU button on the Roth Touchline® SL Controller master, and follow the screens.

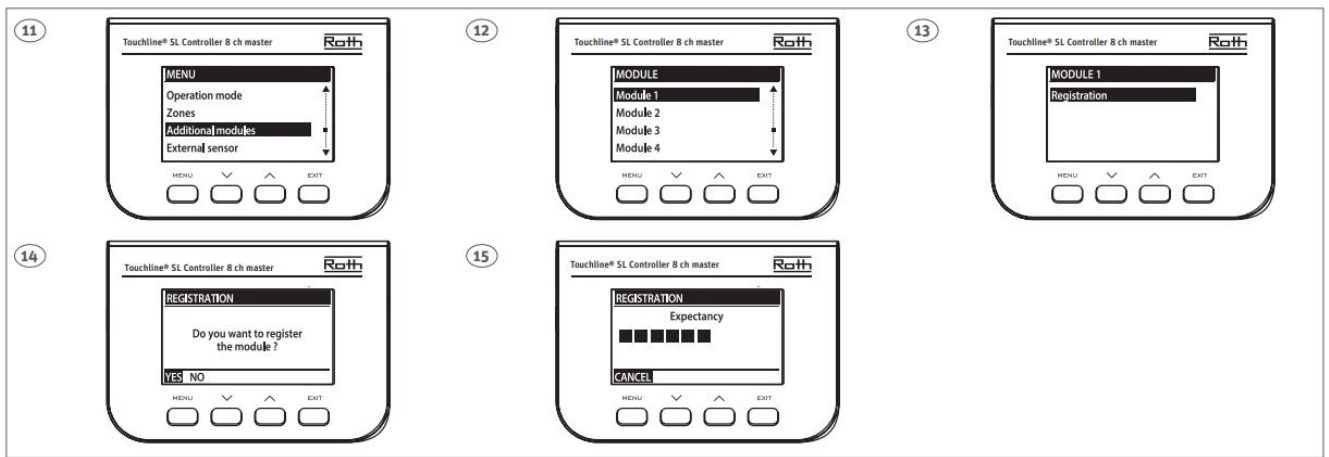

- When the devices have registered the connection, “OK” is displayed. Finish by pressing “Menu”.

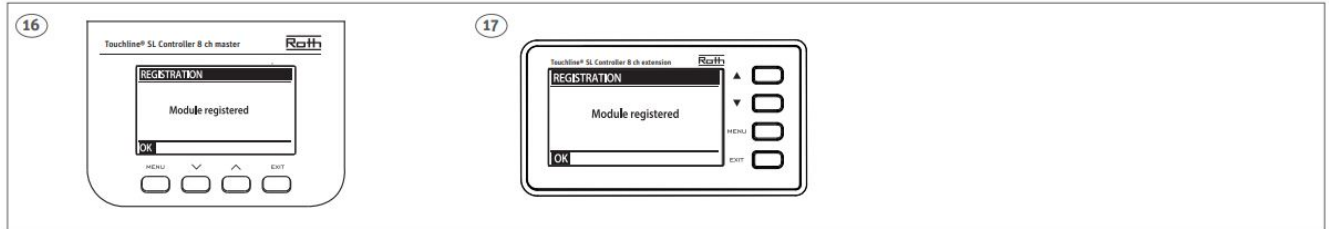

- After registering the Roth Touchline® SL Controller, extension to the Roth Touchline® SL Controller, master this will be shown on the display. It is now possible to see all channels on both the Master and extension Controller on the Master display. All channels can be operated from the Roth Touchline® SL Controller, master or via the Roth Touchline® SL app if the Master Controller is connected to the internet via a Roth Touchline® SL WiFi Internet module. Now press the “MENU” button on the extension Controller and follow the screens. Roth Touchline® SL extension Controller 1 will show the channels 9-16. Controller 2 channels 17-24 etc.

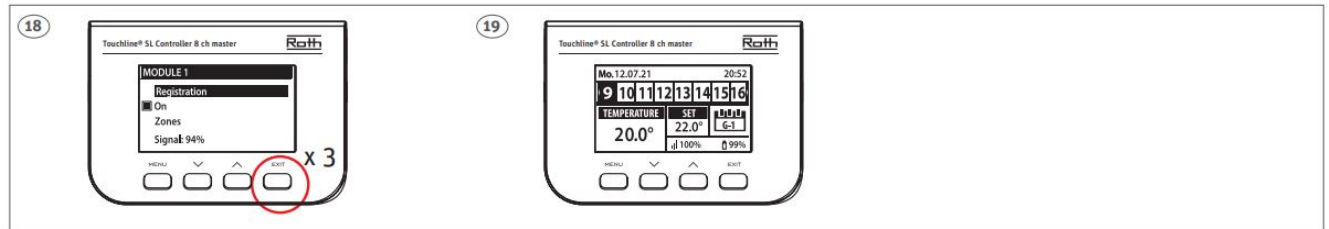

Setting up pump stop

- If the pump output is to be used to control the global pump connected to the control unit – master, the signal must be transmitted from the control unit – extension to the master control unit. Follow the steps on the screens for setting up the the control unit – extension.

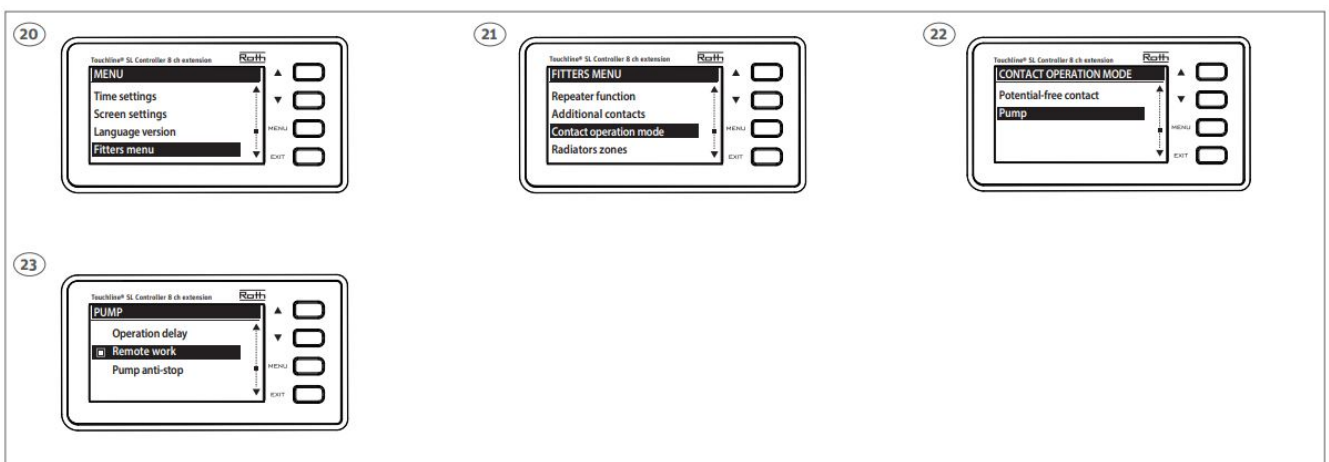

- Finish the setup on controller – master, follow the steps on the screens.

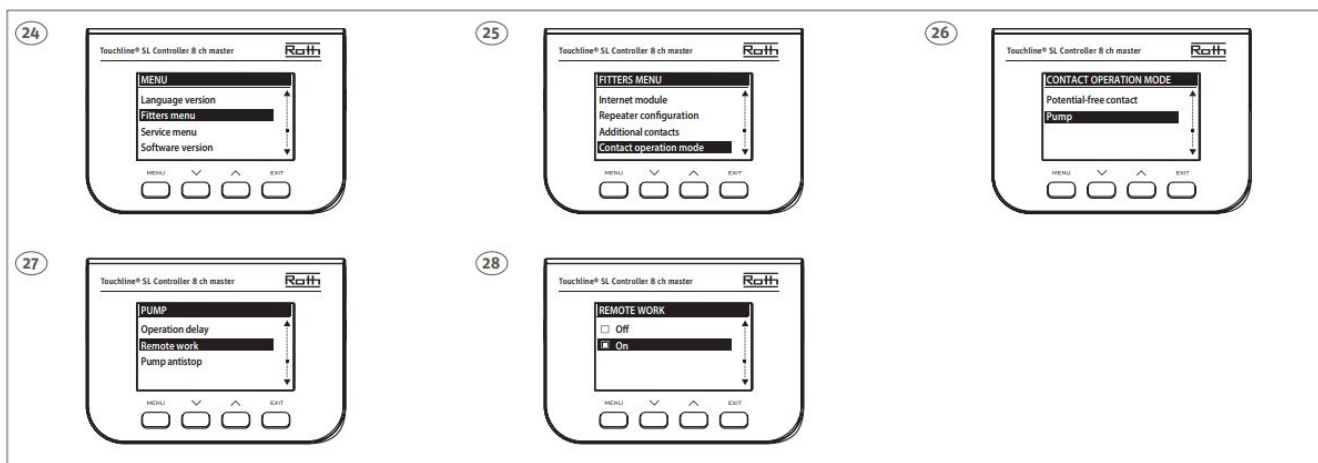

Roth Touchline® SL QR



ROTH UK Ltd

1a Berkeley Business Park
Wainwright Road
Worcester WR4 9FA

Phone +44 (0) 1905 453424

E-Mail enquiries@roth-uk.com

technical@roth-uk.com

orders@roth-uk.com

accounts@roth-uk.com

roth-uk.com

ROTH DANMARK A/S

Centervej 5
3600 Frederikssund
Tlf. +45 4738 0121

E-mail: service@roth-danmark.dk

roth-danmark.dk

ROTH SVERIGE AB

Höjrodergatan 22
212 39 Malmö

Tel. +46 40534090

Fax +46 40534099

E-mail: service@roth-sverige.se

roth-sverige.se

ROTH NORGE AS

Billingstadsletta 19
1396 Billingstad

Tel. +47 67 57 54 00

E-mail: service@roth-norge.no

roth-norge.no

facebook.com/RothNorge

ROTH FINLAND OY

Raaseporintie 9 (Talo 2)

10600 Tammisaari

Puh. +358 (0)19 440 330

S-posti: service@roth-finland.fi

roth-finland.fi

facebook.com/RothFinland

Documents / Resources

	<p>Roth Touchline SL Controller [pdf] Installation Guide Touchline SL Controller, Touchline SL, Controller</p>
---	--

References

- [Frontpage | Norge.no](#)
- [Hej! Welcome to sweden.se – the official website of Sweden](#)
- [UK.COM](#)

Manuals+.