

Roth Touchline SL app for Android and iOS User Manual

[Home](#) » [Roth](#) » Roth Touchline SL app for Android and iOS User Manual 

Contents

- [1 Roth Touchline SL app for Android and iOS](#)
- [2 Product Information](#)
- [3 Product Usage Instructions](#)
- [4 Roth Touchline® SL app](#)
 - [4.1 Register a new control unit](#)
- [5 Documents / Resources](#)
 - [5.1 References](#)



Roth Touchline SL app for Android and iOS

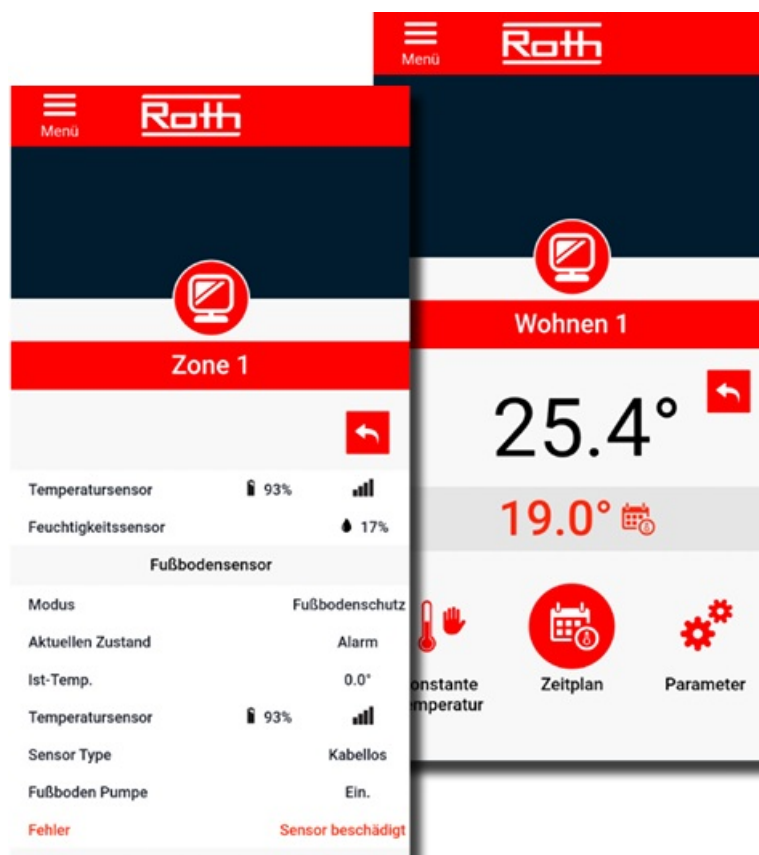

Product Information

The product is a heating and cooling control unit that can be paired with a controller through a mobile app called Roth. The app is available for download in the App Store or Google Play. The control unit can be registered and named via a registration code that can be accessed through the Fitters menu on the control unit. The device also features potential-free contact to start or stop a boiler, battery status, and signal strength until the outdoor sensor is displayed.

Product Usage Instructions

1. Download the Roth app in the App Store or in Google Play.
2. Create a new user by tapping the pencil and entering user information. Finish with Register.
3. To connect to a control unit, register it by entering all information and finish with Register. Access the registration code from the control unit by pressing Menu > Fitters menu > Internet module > Registration menu.
4. Click on the desired room in the overview to get into a detailed overview of the individual room.
5. Set the desired temperature either by using the +/- keys or the slider. An outdoor sensor displays the current temperature.
6. Use the Party function to change the temperature in a room for a limited period of time. Use the Normal function to bring the room back to normal operation.
7. Select a time program for the individual room or for the entire facility. You can save 1 time program which only applies to the individual room and 5 time programs which apply to the entire control unit (+ possible extension module).
8. Set lowering temperature outside the specified time periods. Set the time period for which the temperature is to be raised and set the temperature in the desired time period. Set the remaining days in a similar way and finish with a tick.
9. Choose which rooms/zones the time program should apply to, and approve with a tick.

10. Access advanced functions by going to Menu.

Roth Touchline® SL app

Congratulations on your new Roth Touchline® SL app. The Roth Touchline® SL app for Android, iOS and WEB allows you to regulate your Roth Touchline® SL underfloor heating or radiator system no matter where in the world you are. With the app, it is possible to read the current room temperature, change room temperature, see if inputs and outputs for external devices are active, switch between heating, cooling or automatic switching (if a refrigeration compressor is connected) and many other useful information from your system, which ensures optimal comfort and safety for you and your plant. In addition, the operating mode of the entire system can be changed without having to enter each room. With the Roth Touchline® SL app you can control several plants/installations located in several different locations, e.g. your permanent residence, your holiday home or your apartment abroad. For a faster and easier overview, you can name both your facilities and all your rooms. System setup: Your Roth Touchline® SL Master control unit must be connected to your WiFi network via the Roth Touchline® SL WiFi internet module. For help setting up these devices, see the package leaflet in the device, or visit our website. <https://www.roth-uk.com>. Create a Roth Touchline® SL app/cloud account. To be able to use the Roth app, you need to create a Roth Cloud account. All rules regarding GDPR are of course complied with, see Data Protection – Roth (roth-danmark.dk) for further information. Download the app in the App Store or in Google Play.

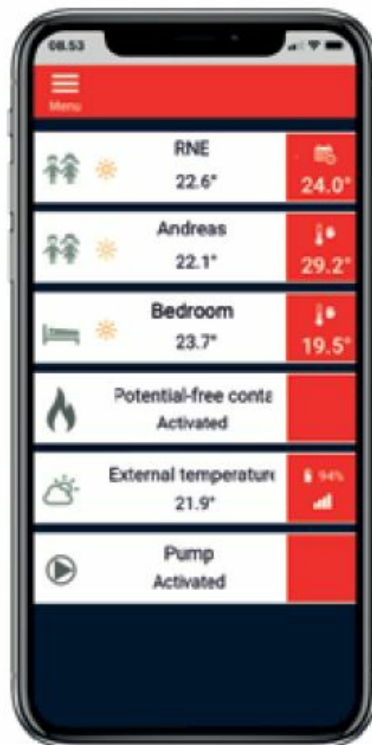



Create a Roth Touchline® SL app/Cloud account

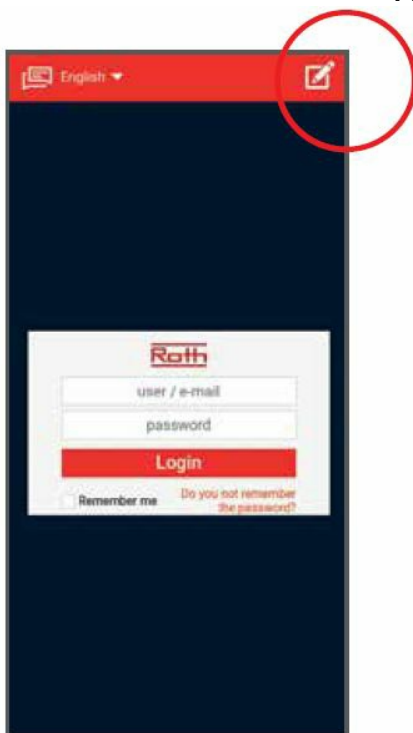

Download the Roth app in the App Store or in Google Play.
Tap the pencil to create a new user.

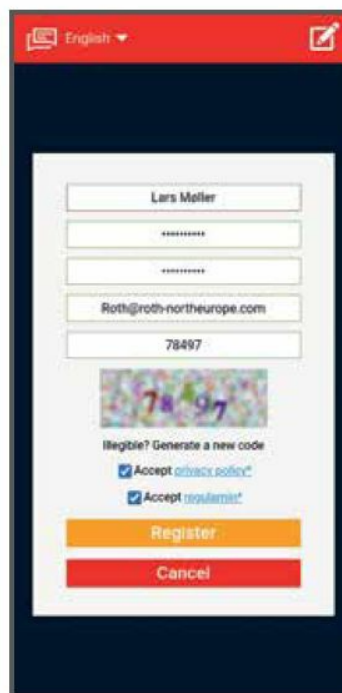

Enter user information, finish with "Register".



The app is now ready to be paired with a controller.

Roth Touchline® SL app

Register a new control unit

Register a new control unit

To connect to a control unit, the unit must be named and registered via a code.

Enter all information and finish with "Register".

The app will now make an update of information in the control unit. Press "OK" and the app is ready for use.

Registration code from the control unit



- To access the registration code from the control unit, press "Menu" on the control unit. Select the menu "Fitters menu" with the arrow keys. Press "Menu" to confirm.
- Select the menu "Internet module" and press "Menu".
- Select the "Registration" menu and press "Menu".
- The registration code is displayed after a while.

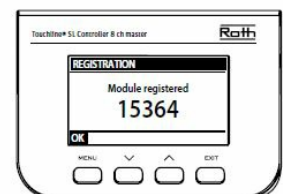
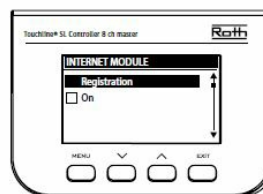
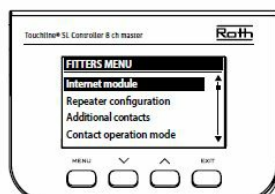
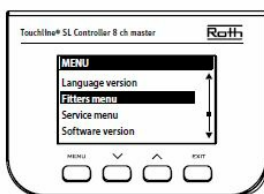

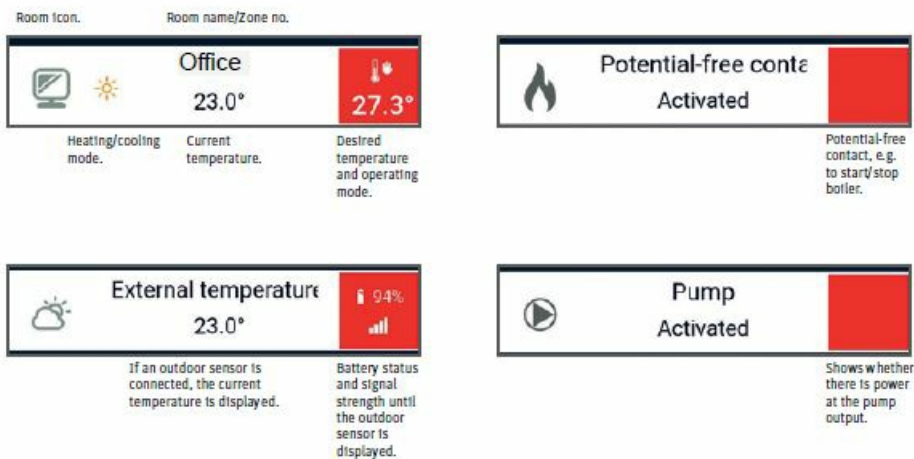

The desired temperature is set either by use of the +/- keys or the slider.

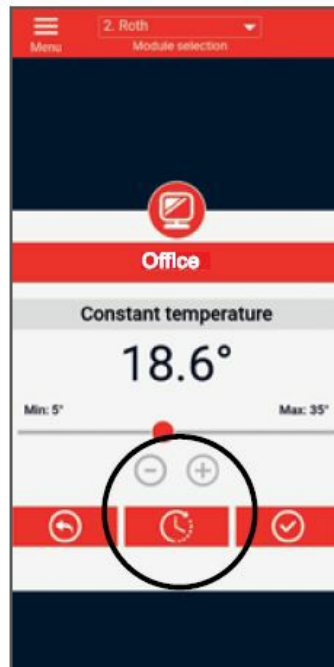

“Party” function. Can be used if you want to change the temperature in a room for a limited period of time.

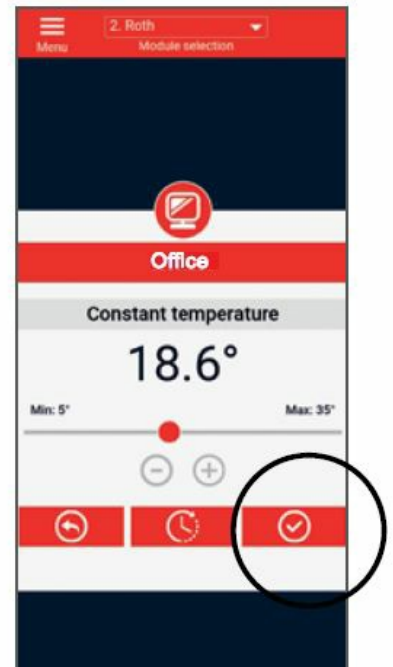

Used to bring the room back to normal operation. e.g. if this area should not be included in a time program or if the room is in “Party” mode.

Settings menu – 1



The desired temperature is set either by use of the +/- keys or the slider.

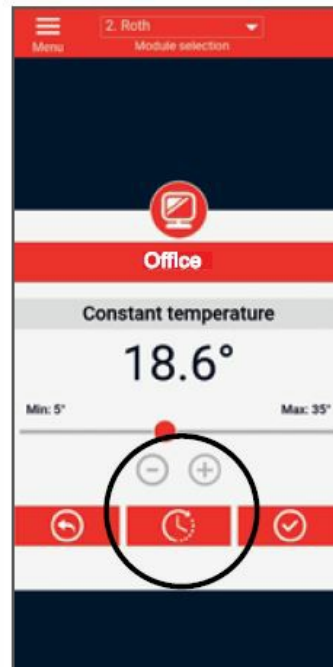

"Party" function. Can be used if you want to change the temperature in a room for a limited period of time.

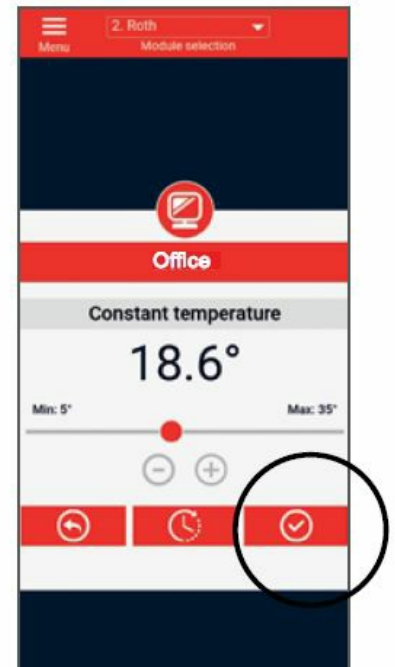

Used to bring the room back to normal operation. e.g. if this area should not be included in a time program or if the room is in "Party" mode.

Settings menu – 2

- Time program. Here you can select a time program for the individual room or for the entire facility. You can save 1 time program which only applies to the individual room and 5 time programs which apply to the entire control unit (+ possible extension module).
- Create two different time programs. e.g. one valid for weekdays and one for the weekend.
- At the top you can select the days for which the time program is to apply.

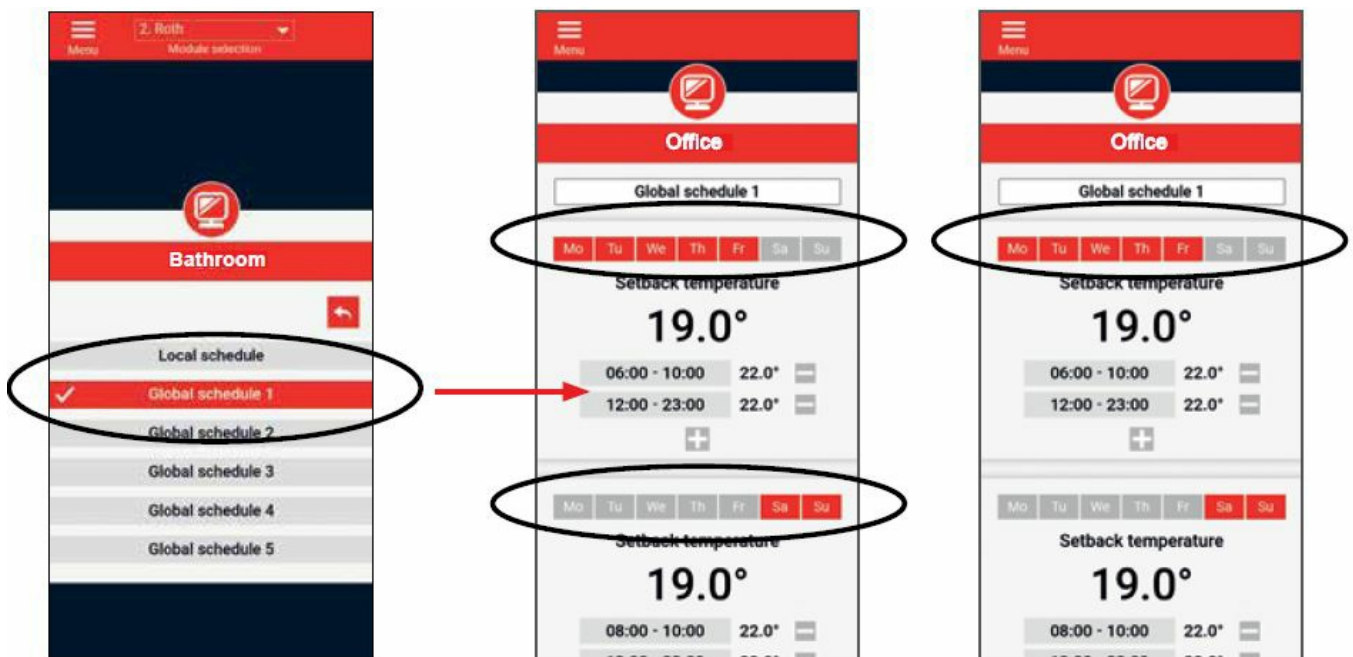

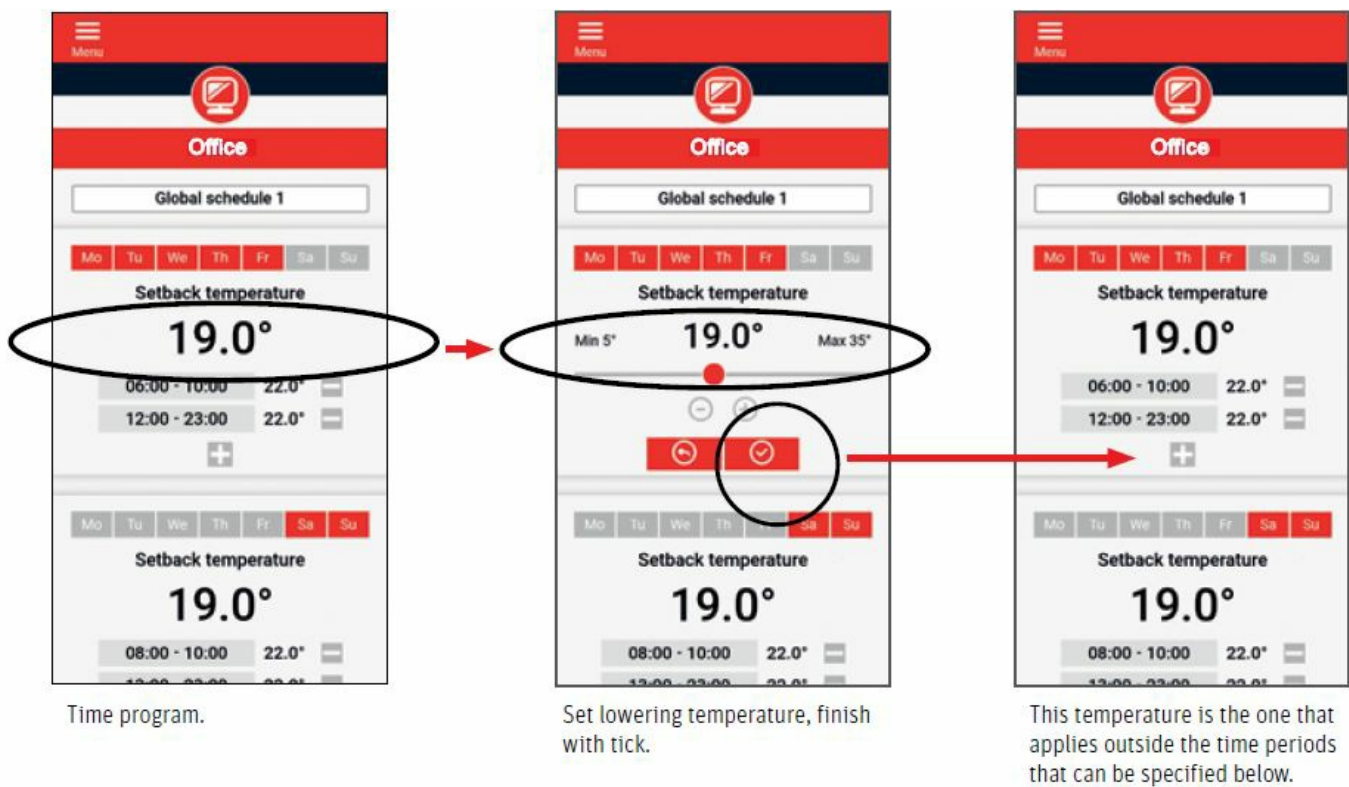

- Time program.
- Setting the time period for which the temperature is to be raised.
- Setting the temperature in the desired time period.

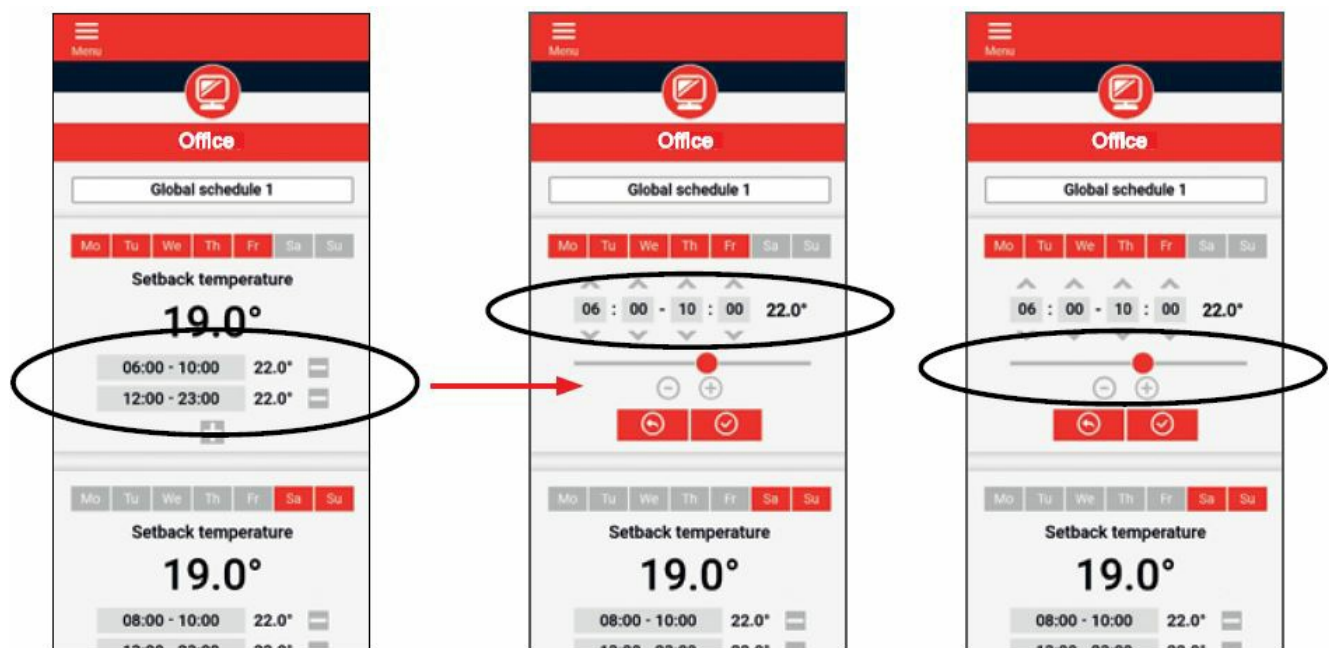

- Set the remaining days in a similar way and finish with a tick.
- Choose which rooms/zones the time program should apply to, and approve with a tick.

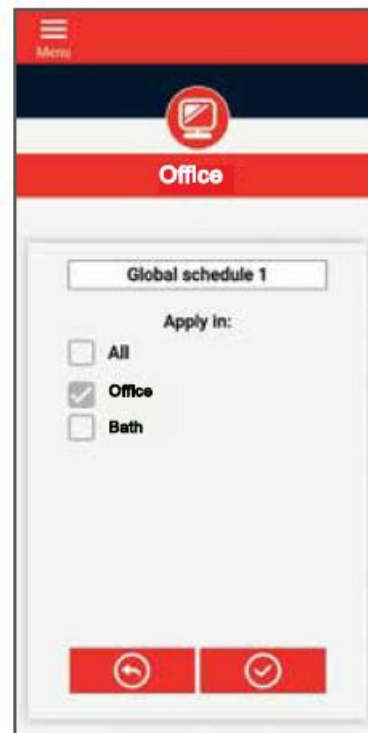

Settings menu – 3

- Menu 3 is a view menu.
- Displays a list of devices connected to this room/zone, and their current status.

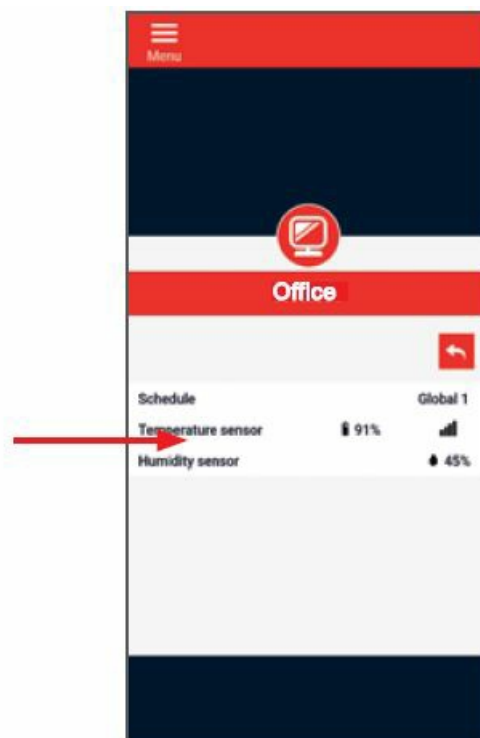

Advanced user

Under “Menu” there are a number of functions that can be used to optimize the plant’s operation, naming the individual rooms, changing the operation mode for the entire plant e.g. holiday mode, current operation information, configuration of contact sets from external sensors, setup of heating/cooling and resetting of all settings to factory settings. If you want more users on the same app, the new user just needs to download the app

and log in with the same user name and password as the first user.

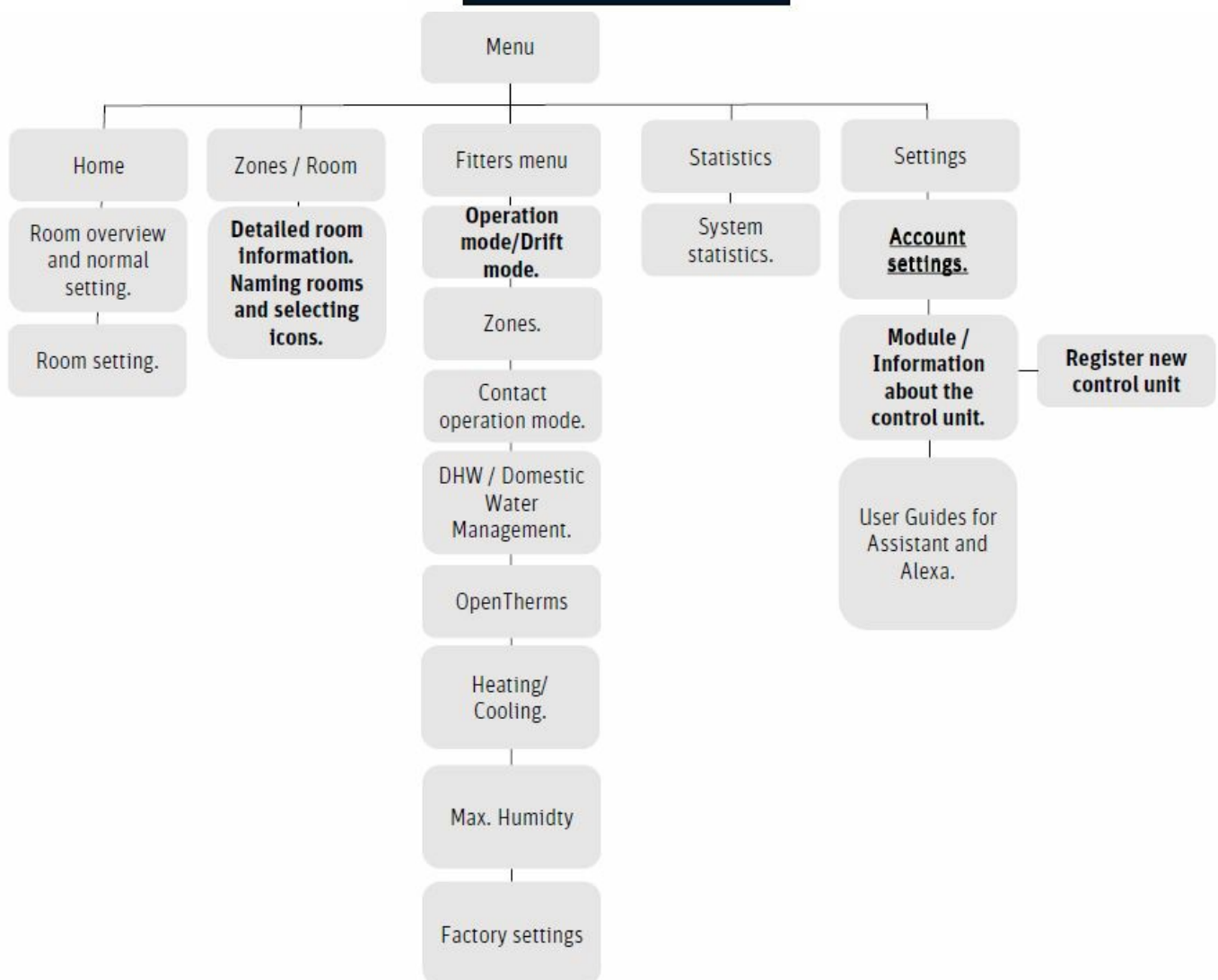
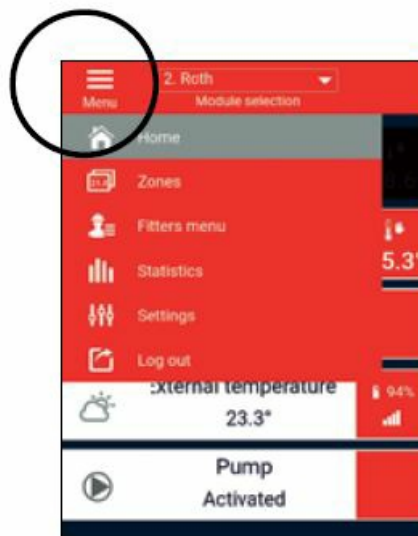

- Zones/zoner.
- Displays an overview of all rooms with details and with the option to change name, icon, turn off a channel or reset the thermostat.

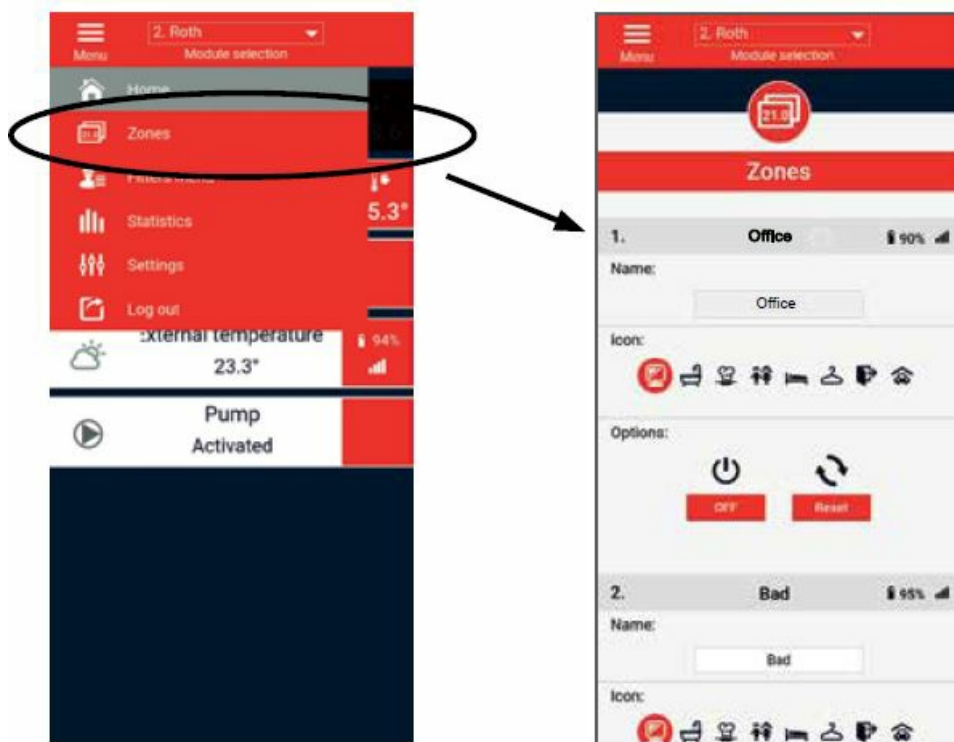

- Fitter's menu/installer's
- Operation mode
- In this menu, the operating mode can be switched for the entire system.

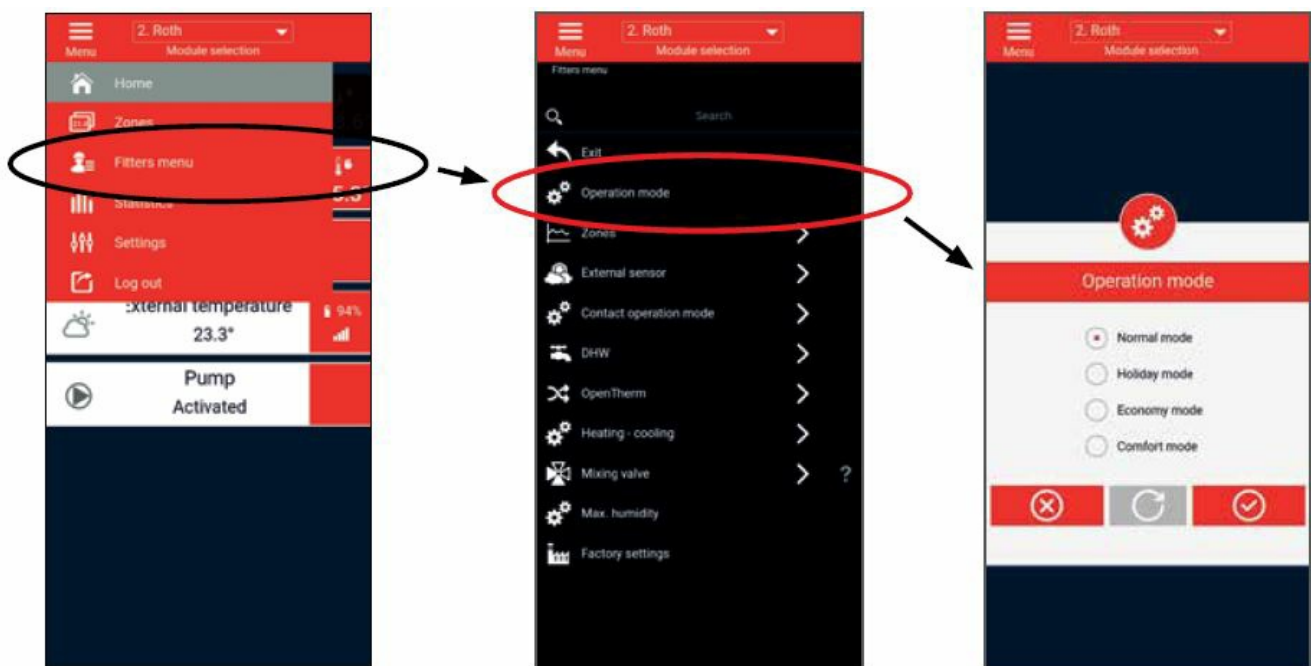

Normal mode

Used when the preset temperature must follow the selected operating mode for each zone.

Holiday mode

Used when you want to lower the temperature centrally for all zones for a longer period, e.g. when you have a holiday. Preset temperature can be changed on the Master control unit, in Zones > User settings > Temperature settings. The default setting is 10°C.

Economy mode

Used when you want to lower the temperature centrally for all zones for a longer period, e.g. on a weekend when you are not home. Preset temperature can be changed on the Master control unit, in Zones > User settings > Temperature settings. The default setting is 18°C.

Comfort mode

Used when you want to lower the temperature centrally for all zones for a longer period, e.g. to override an active schedule without having to change it. Preset temperature can be changed on the Master control unit, in Zones >

User settings > Temperature settings. The default setting is 24°C.

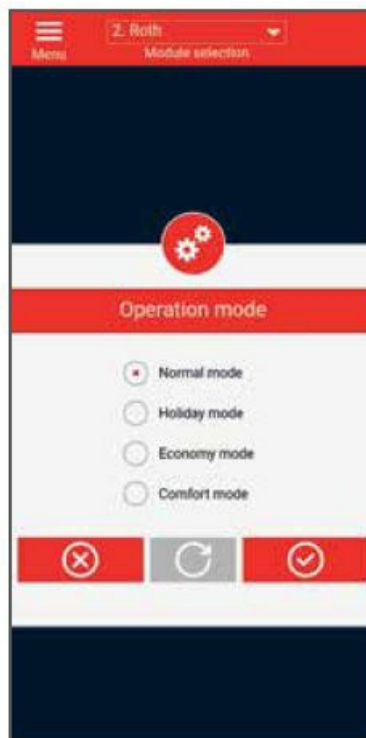

- Settings
- In “Account settings”, the password can be changed and you can see the current e-mail address.
- In “Module”, you can change the name of the control unit, and/or the location of the control unit, add new units or remove control units.

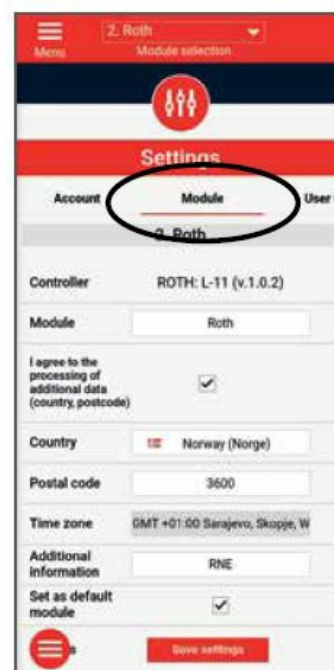
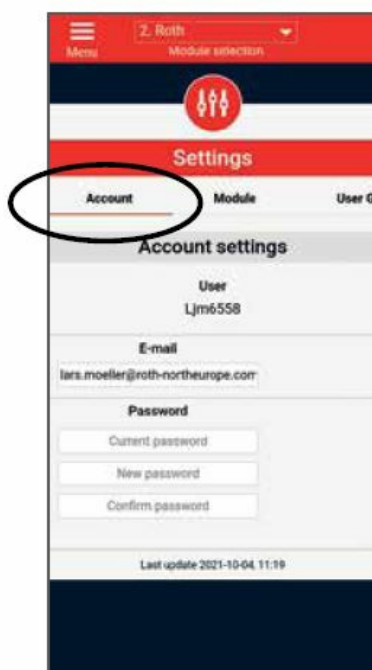
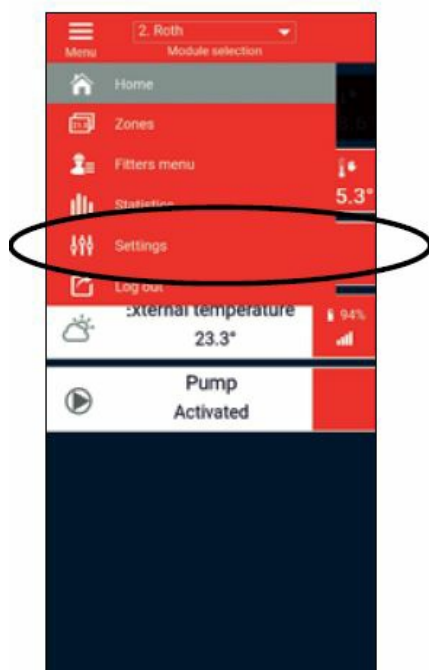

Create a new control unit

- Create a new control unit.
- Register new control unit.
- The creation of additional control units takes place in the same way as with the first control unit.

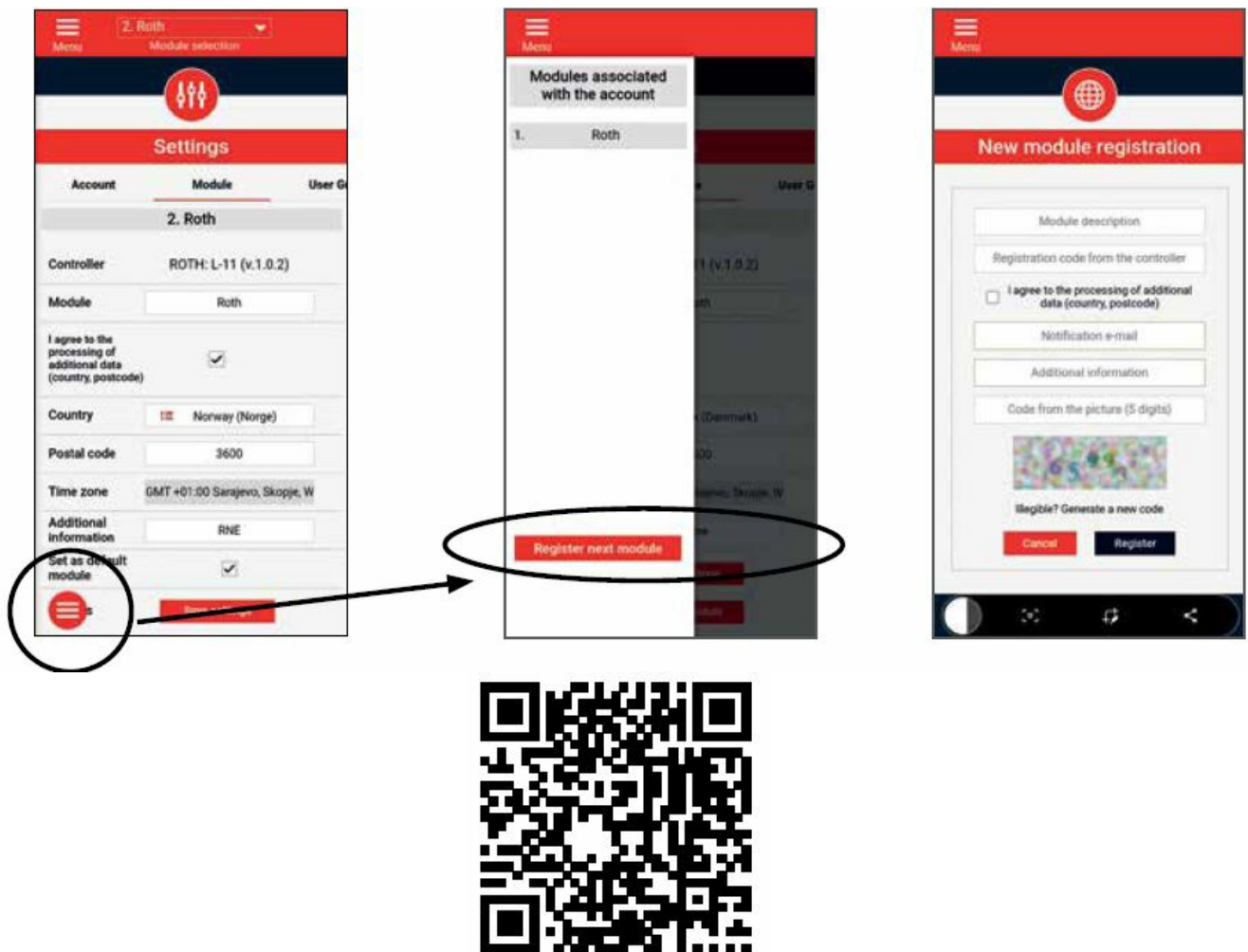

- Roth Touchline® SL

ROTH UK Ltd

- 1a Berkeley Business Park
- Wainwright Road
- Worcester WR4 9FA
- **Phone** +44 (0) 1905 453424
- **E-Mail** enquiries@roth-uk.com.
- technical@roth-uk.com.
- orders@roth-uk.com.
- accounts@roth-uk.com
- roth-uk.com.

Roth Touchline® SL app user manual__UK_20220714

Documents / Resources

 <p data-bbox="233 277 272 297">Getting started with energy</p>	<p data-bbox="320 165 1107 197">Roth Touchline SL app for Android and iOS [pdf] User Manual</p> <p data-bbox="320 203 1369 235">Touchline SL app for Android and iOS, Touchline SL app, for Android and iOS, and iOS</p>
--	---

References

- [Roth](#) **[Roth Danmark - Roth Danmark](#)**
- [UK.COM](#)