

ROLLS BT287 Bluetooth Audio Adapter with switch User Guide

[Home](#) » [Rolls](#) » ROLLS BT287 Bluetooth Audio Adapter with switch User Guide 

ROLLS

BT287 Bluetooth
Audio Adapter with switch
Connection guide

Contents

- [1 SPECIFICATIONS:](#)
- [2 DESCRIPTION:](#)
- [3 OPERATION:](#)
- [4 Documents / Resources](#)
- [5 Related Posts](#)

SPECIFICATIONS:

Output Impedance: 1K Ohm RCA
Power Requirements: 15 VDC, 500 mA; Rolls part number PS27s
Size: 3.75" x 3.25" x 1.5"
Weight: 1 lb.

DESCRIPTION:

The Rolls BT287 is a Bluetooth interface that will supply stereo or mono audio to a sound system. It also features a 400-watt contact closure relay for activation of the connected system. For example, if you have a sound system such as an old jukebox and want to add Bluetooth capability to it. The BT287 will supply the audio to the jukebox as well as provide a contact closure relay to turn the jukebox on, controlling cabinet lights, amplifier, and audio level remotely. When audio is sent to the BT287 the jukebox will turn on automatically and start playing audio,

when Bluetooth audio is not present the jukebox will be powered off by the BT287. This way a homeowner or shop owner could have a piece of equipment (jukebox) remotely controlled via laptop, phone, tablet, or another digital Bluetooth device with the BT287.

OPERATION:

To pair a device to the BT287 simply find the BT287 (ROLLSBT) on your device and connect. After the device is connected to the BT287 a steady blue led will light indicating that the BT287 is paired to a device, but no audio is present. A slow blinking blue light indicates that audio is being sent when paired.

When powered off the BT287 will remember the device it was previously paired with. On power-up will search for that device and reconnect to it.

The DB287 has a Bluetooth operating range of 15 to 40 feet depending on how and where it is installed.

The BT287 should be installed by a knowledgeable sound installation professional that is familiar with electronic installations. Since hazardous voltages may be present on the control contacts, only people familiar with the hazards of such devices should attempt installation.

When in use the BT287's internal relay (N/C C N/O) will close (or open if needed) within milliseconds of a Bluetooth audio input signal sent, then 20 seconds after the audio signal stops playing the relay will switch even if Bluetooth is still paired to a device. The BT287 senses the level of the audio signal for switching its relay. NOTE: the controlled device may have a warm-up time after being turned on, delaying audio being played.

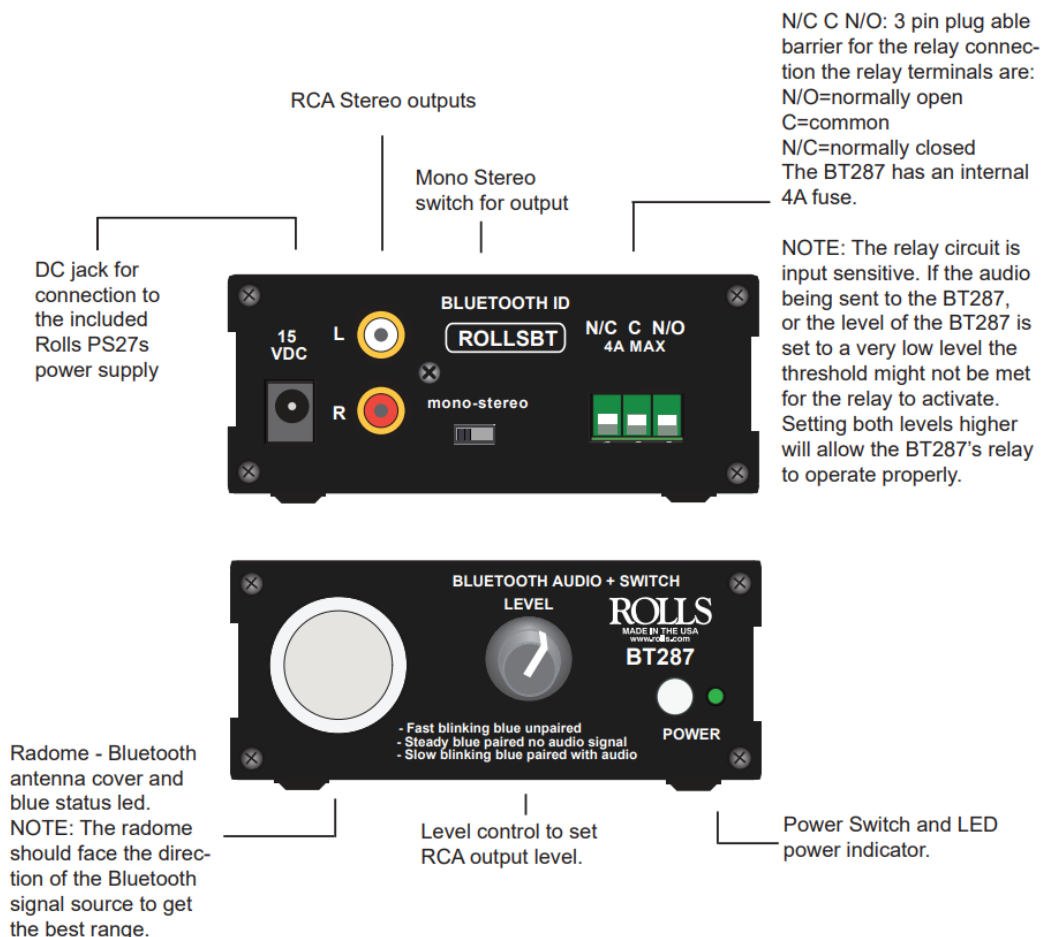

What's in the box?

- 1 – Made in USA BT287
 - 1 – 15V power supply PN PS27s
 - 1 – This owners manual
- Rolls Corporation
Salt Lake City, UT 1/20

ROLLS

Documents / Resources

	<p>ROLLS BT287 Bluetooth Audio Adapter with switch [pdf] User Guide BT287, Bluetooth Audio Adapter with switch</p>
---	--

[Manuals+.](#)