

ROLLINGSQUARE EKIT01 EDGE Full Kit



# ROLLINGSQUARE EKIT01 EDGE Full Kit User Manual

[Home](#) » [ROLLINGSQUARE](#) » ROLLINGSQUARE EKIT01 EDGE Full Kit User Manual 

## Contents

- [1 ROLLINGSQUARE EKIT01 EDGE Full Kit](#)
- [2 Product Usage Instructions](#)
- [3 EDGE® Wireless Charger](#)
- [4 EDGE® Light](#)
- [5 Warnings and Specifications](#)
- [6 Certifications](#)
- [7 Documents / Resources](#)
  - [7.1 References](#)



ROLLINGSQUARE EKIT01 EDGE Full Kit



## Specifications

- **EDGE Mount:**
  - **Weight:** 34 gr / 1.1 oz
  - **Size:** 115X30X4.5 mm / 4.5X1.1X1.7 in
  - **Materials:** CNC machined aluminum, with N52 magnets and an ultra gripping layer on the front surface
- **EDGE Wireless Charger:**
  - **Input:** 5V/2A, 9V/2A, 12V/1.5A
  - **Output:** 7.5W / 10W / 15W
  - **Weight:** 38 gr / 1.3 oz
- **EDGE Light:**
  - **Brightness:** 280 lumens with x3 levels of control
  - **Input:** 5V / 1A
  - **Battery Capacity:** 140mAh / 0.5Wh
  - **Weight:** 35gr / 1.2oz

## Product Usage Instructions

### EDGE Mount

1. Use the Magnetic Disc Aligner to stick the Magnetic Disc (A) on the back of your phone.
2. Remove the nano suction's protective film.
3. Clean the surface of the device before proceeding.
4. Open the EDGE Mount and snap your phone on it, find the position you prefer on your device and push part B for 10 seconds to fix it in place.
5. To remove the EDGE Mount, pry with EDGE Remover on the lower right side. Never pull the EDGE Mount from part C.

## EDGE Wireless Charger

1. Use the Magnetic Disc Aligner to stick the Magnetic Disc (A) on the back of your phone (not needed for iPhone 12 or later). To center it, use the Magnetic Disc Aligner.
2. Snap the EDGE Wireless Charger to the EDGE Mount and plug the USB-C connector into a USB-C power source.
3. Snap your phone to the EDGE Wireless Charger to start charging your phone.

## EDGE Light

1. Snap the EDGE Light to the EDGE Mount and click the button to light it up.
2. The first three clicks change the light intensity and the fourth turns it off.
3. The EDGE Light works for 55 minutes at medium intensity when fully charged.
4. To recharge the EDGE Light, use the USB-C to USB-C cable provided in the pack. You can also keep it plugged in while using it.

## FAQ

### 1. Q: Can I submerge the device in water?

A: No, avoid submerging the device in water or exposing it to adverse weather conditions.

### 2. Q: How long does the EDGE Light work when fully charged?

A: The EDGE Light works for 55 minutes at medium intensity when fully charged.

## User Manual

### EDGE® Full Kit



### EDGE® Mount

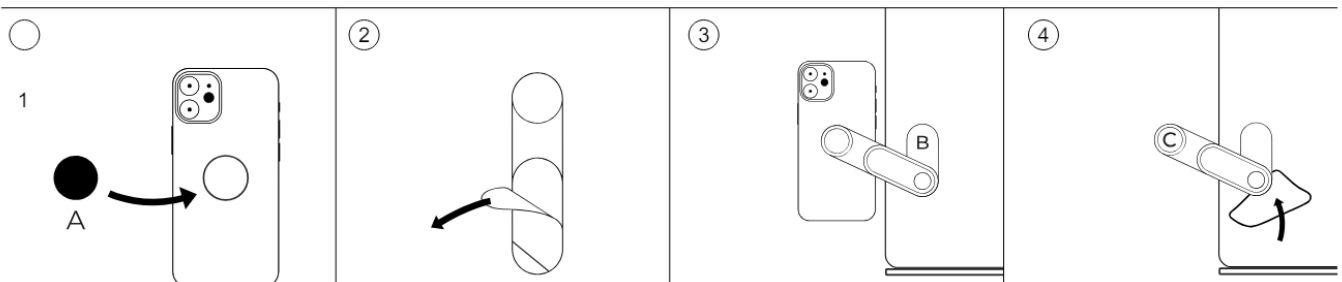

1. Use the Magnetic Disc Aligner to stick the Magnetic Disc (A) on the back of your phone.

2. Remove the nano suction's protective film.
3. Clean the surface of the device before proceeding. Open the EDGE Mount and snap your phone on it, find the position you prefer on your device and push part B for 10 seconds to fix it in place.
4. To remove the EDGE Mount pry with EDGE Remover on the lower right side. Never pull the EDGE Mount from part C.

## EDGE® Wireless Charger

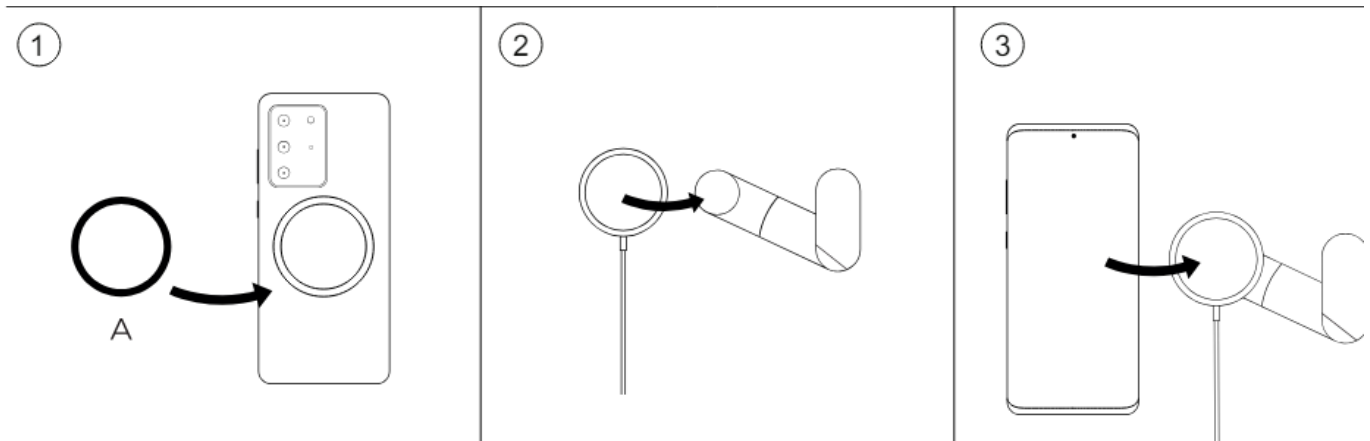

1. Use the Magnetic Disc Aligner to stick the Magnetic Disc (A) on the back of your phone (not needed for iPhone 12 or later). To center it, use the Magnetic Disc Aligner.
2. Snap the EDGE Wireless Charger to the EDGE Mount and plug the USB-C connector in a USB-C power source.
3. Snap your phone to the EDGE Wireless Charger to start charging your phone.



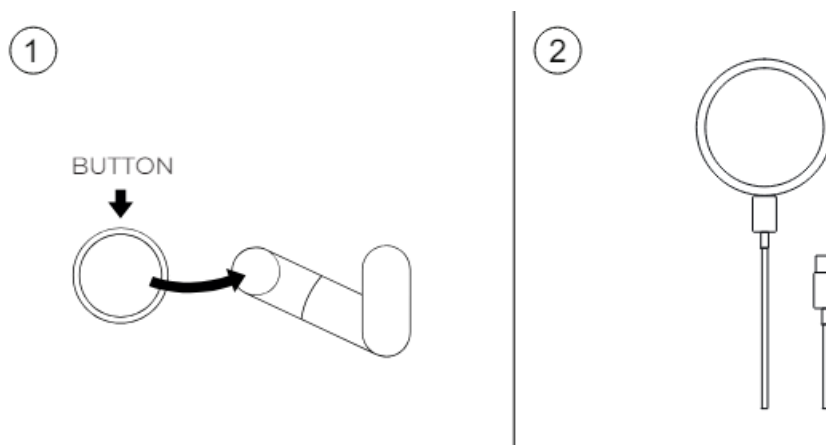



## EDGE® Light



1. Snap the EDGE Light to the EDGE Mount and click the button to light it up. The first three clicks change the light intensity and the fourth turns it off.
2. The EDGE Light works for 55 minutes at medium intensity when fully charged. To recharge the EDGE Light use the USB-C to USB-C cable provided in the pack. You can also keep it plugged in while using it.

## Warnings and Specifications

### Warnings

-  KEEP THE DEVICE OUT OF REACH OF CHILDREN.
-  KEEP THE DEVICE AWAY FROM FIRE AND HIGH TEMPERATURE.
-  AVOID DROPPING THE DEVICE.
-  DO NOT SUBMERGE IN WATER OR EXPOSE TO ADVERSE WEATHER CONDITIONS.
-  DO NOT OPEN OR PUNCTURE IT.
-  DO NOT DISPOSE OF LITHIUM POLYMER BATTERY WITH GENERAL WASTE. PLEASE DISPOSE OF IT IN A BATTERY RECYCLING COLLECTION POINT.

### Specifications

#### EDGE® MOUNT

- **SIZE:** 115X30X4.5 mm / 4.5X1.1X1.7 in
- **MATERIALS:** CNC MACHINED ALUMINIUM, WITH N52 MAGNETS AND AN ULTRA GRIPPING LAYER ON THE FRONT SURFACE
- **WEIGHT:** 34 gr / 1.1 oz



#### EDGE® UNIVERSAL WIRELESS CHARGER

- **SIZE:** Ø56X6 mm / Ø2.2X0.2 in
- **MATERIALS:** CNC MACHINED ALUMINIUM, BASALT GREY WITH N52 MAGNETS
- **INPUT:** 5V/2A, 9V/2A, 12V/1.5A
- **OUTPUT:** 7.5W / 10W / 15W
- **WEIGHT:** 38 gr / 1.3 o

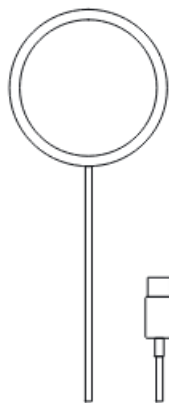

## EDGE® LIGHT

- **SIZE:** Ø56X11 mm / Ø2.2X0.4 in
- **MATERIALS:** CNC MACHINED ALUMINIUM, BASALT GREY
- **BRIGHTNESS:** 280 LUMENS WITH X3 LEVELS OF CONTROL
- **INPUT:** 5V / 1A
- **BATTERY CAPACITY:** 140mAh / 0.5Wh
- **WEIGHT:** 35gr / 1.2oz

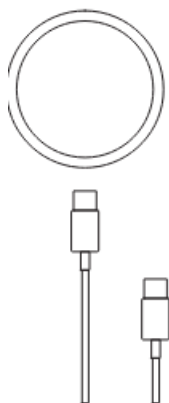

## Certifications



ROLLING SQUARE ® is a trademarks of Ferraris Group Sagl / Corso San Gottardo 99, Chiasso CH 6830, Switzerland / +41 091 2347763

	<p><a href="#">ROLLINGSQUARE EKIT01 EDGE Full Kit</a> [pdf] User Manual EKIT01 EDGE Full Kit, EKIT01, EDGE Full Kit, Full Kit, Kit</p>
---	--

References

- [User Manual](#)

Manuals+, Privacy Policy

This website is an independent publication and is neither affiliated with nor endorsed by any of the trademark owners. The "Bluetooth®" word mark and logos are registered trademarks owned by Bluetooth SIG, Inc. The "Wi-Fi®" word mark and logos are registered trademarks owned by the Wi-Fi Alliance. Any use of these marks on this website does not imply any affiliation with or endorsement.