



ROLLEASE ACMEDA AX30 Automate External Shade Motor Instruction Manual

[Home](#) » [ROLLEASE ACMEDA](#) » ROLLEASE ACMEDA AX30 Automate External Shade Motor Instruction Manual



Contents

- [1 ROLLEASE ACMEDA AX30 Automate External Shade Motor](#)
- [2 SAFETY INSTRUCTIONS](#)
- [3 Statement Regarding FCC Compliance](#)
- [4 ASSEMBLY](#)
- [5 WIRING](#)
- [6 P1 BUTTON FUNCTIONS](#)
- [7 Motor configuration options](#)
- [8 NON CASSETTE OPEN MODE](#)
- [9 CASSETTE MODE](#)
- [10 Delete Upper/Lower Limits](#)
- [11 VERTICAL DROP MODE](#)
- [12 ADD CONTROLLER AND CHANNEL](#)
- [13 FAVORITE POSITIONING](#)
- [14 Sleep Mode](#)
- [15 WIND SENSOR FUNCTION](#)
- [16 TROUBLESHOOTING](#)
- [17 Documents / Resources](#)
 - [17.1 References](#)
- [18 Related Posts](#)

ROLLEASE ACMEDA AX30 Automate External Shade Motor



SAFETY INSTRUCTIONS

WARNING:

Important safety instructions to be read before installation. Incorrect installation can lead to serious injury and will void the manufacturer's liability and warranty. It is important for the safety of persons to follow the enclosed instructions. Save these instructions for future reference

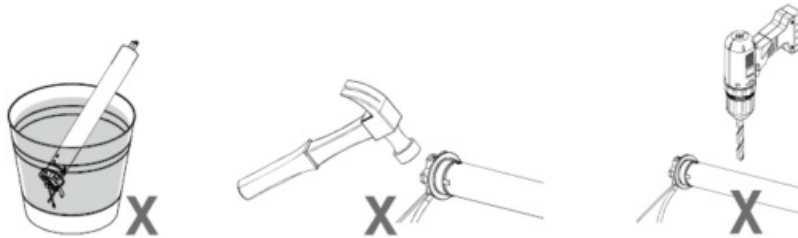

- Do not expose to water, moisture, humid and damp environments or extreme temperatures
- Persons (including children) with reduced physical, sensory or mental capabilities, or lack of experience and knowledge should not be allowed to use this product.
- Keep away from children.
- Use or modification outside the scope of this instruction manual will void warranty.
- Installation and programming to be performed by a suitably qualified installer.
- For use with motorized shading devices.
- Ensure correct crown and drive adapters are used for the intended system.
- Keep antenna straight and clear from metal objects
- Do not cut the antenna.
- Follow Rollease Acmeda installation instructions.
- Before installation, remove any unnecessary cords and disable any equipment not needed for powered operation.
- Ensure torque and operating time is compatible with end application.
- Motor is to be installed in horizontal application only.
- The routing of cable through walls shall be protected by isolating bushes or grommets.
- Ensure power cable and aerial is clear and protected from moving parts.
- If cable or power connector is damaged do not use.
- Route motor cable to create a drip loop
- Frequently inspect for improper operation. Do not use if repair or adjustment is necessary.
- Keep motor away from acid and alkali.

- Do not force the motor drive.
- Keep clear when in operation.

Statement Regarding FCC Compliance

This device complies with Part 15 of the FCC Rules. Operation is subject to the following two conditions:

1. This device may not cause harmful interference, and
2. This device must accept any interference received, including interference that may cause undesired operation.

Note:

This equipment has been tested and found to comply with the limits for a Class B digital device, pursuant to Part 15 of the FCC Rules. These limits are designed to provide reasonable protection against harmful interference in a residential installation. This equipment generates, uses and can radiate radio frequency energy and, if not installed and used in accordance with the instructions, may cause harmful interference to radio communications. However, there is no guarantee that interference will not occur in a particular installation. If this equipment does cause harmful interference to radio or television reception, which can be determined by turning the equipment off and on, the user is encouraged to try to correct the interference by one or more of the following measures:

- Reorient or relocate the receiving antenna.
- Increase the separation between the equipment and receiver.
- Connect the equipment into an outlet on a circuit different from that to which the receiver is connected.
- Consult the dealer or an experienced radio/TV technician for help.

Any changes or modifications not expressly approved by the party responsible for compliance could void the user's authority to operate the equipment.

Statement Regarding IC Compliance

1. This device complies with Industry Canada RSS standard(s). Operation is subject to the following two conditions: this device may not cause interference, and this device must accept any interference, including interference that may cause undesired operation of the device.
2. Changes or modifications not expressly approved by the party responsible for compliance could void the user's authority to operate the equipment.

ASSEMBLY

Please refer to Rollease Acmeda System Assembly Manual for full assembly instructions relevant to the hardware system being used, including recommended crown, drive and bracket adapter kits.

Step 1. Cut roller tube to the required length.

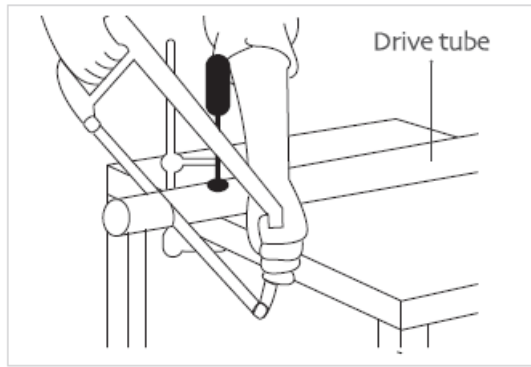

IMPORTANT

Impact detection does not require a 2 piece drive set. The use of a standard 1 part drive adapter is compatible. Zipscreen is needed to let the impact transmit to the top during downward movement. The top tube must be able to freely rotate ~ 5 degrees after installation.

Step 2. Ensure roller tube is clean and free from burrs.

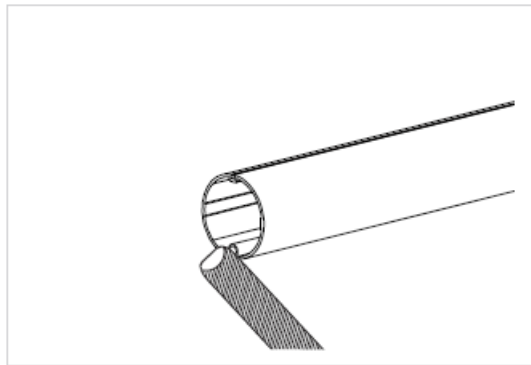

Step 3. Fit required crown, drive and bracket adapters.

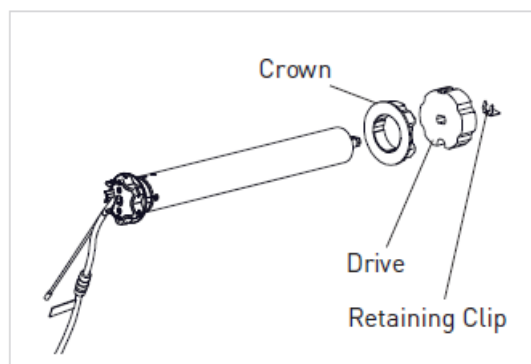

Step 4. Slide Motor into tube. Insert by aligning key-way in crown and drive wheel into the tube.

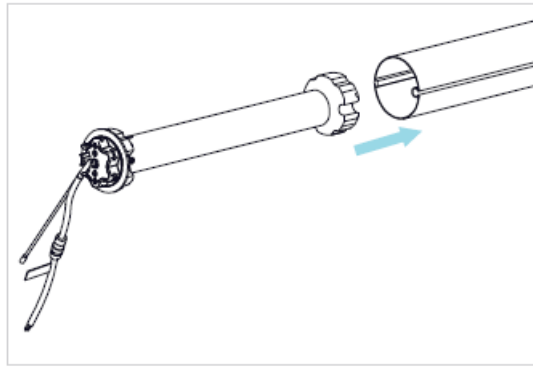

Step 5. Mount motorized tube onto brackets.

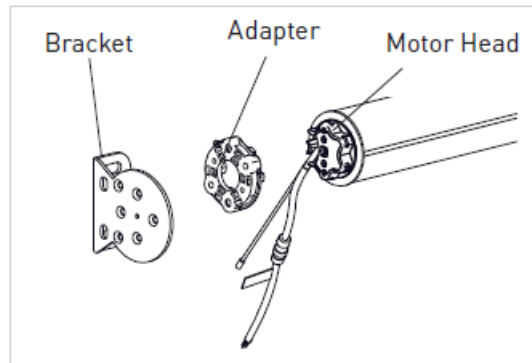

WIRING

EU/AU Motor

Disconnect the mains power supply. Connect the motor according to the information in the table below. Ensure cable is kept clear of fabric. Ensure antenna is kept straight and away from metal objects.

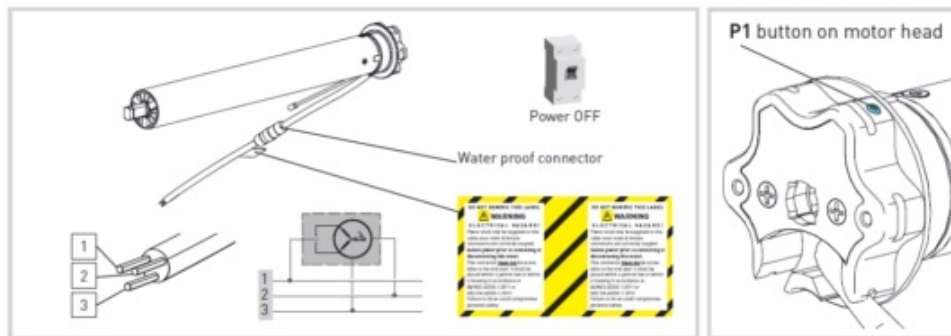

MOTOR	POWER	NEUTRAL	LIVE	EARTH	REGION
MT01-1145-069014	230V AC 50Hz	Blue	Brown	Yellow/Green	EU
MT01-1145-069016					
MT01-1145-069013	240V AC 50Hz				AU
MT01-1145-069015					

US Motor

Ensure cable is kept clear of fabric. Ensure antenna is kept straight and away from metal objects.

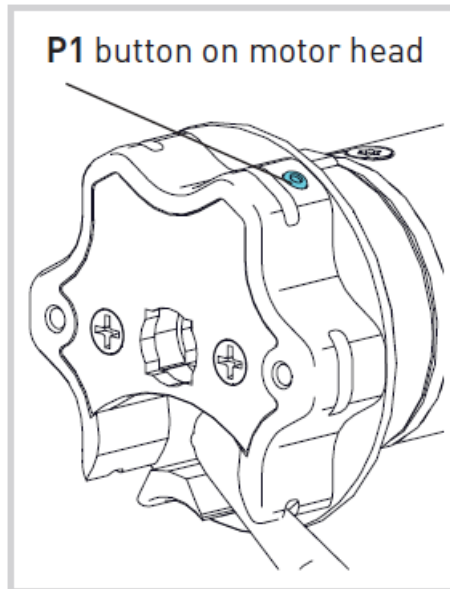
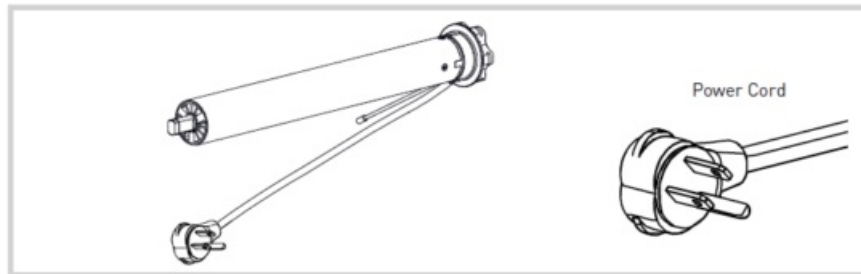

MOTOR	POWER CORD LENGTH	POWER	NEUTRAL	LIVE	EARTH
MT01-1145-069017	240in. (6096mm)	120V AC 60Hz	White	Black	Green
MT01-1145-069018					

P1 BUTTON FUNCTIONS

Motor state test

This table describes the function of a short P1 Button press/release (<2 seconds) depending on current motor configuration.

P1 Press	Condition	Function Achieved	Visual Feedback	Audible Feedback	Function Described
Short Press	If limit is NOT set	None	No Action	None	No Action
	If limits are set	Operational control of motor, run to limit. Stop if running	Motor Runs	None	Operational control of motor after pairing and limit setting is completed first time
	If motor is in "Sleep Mode" & limits are set	Wake and control	Motor wakes and runs in a direction	None	Motor is restored from Sleep Mode and RF control is active

Motor configuration options

The P1 Button is utilized to administer motor configurations as described below. Hold P1 button on motor head.

Activate Pairing Mode



Sleep Mode



Reverse Direction



Reset To Factory Settings



P1 button on motor head

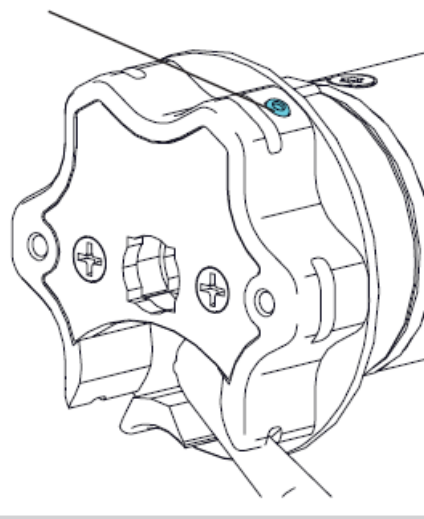

NON CASSETTE OPEN MODE

Note:

Ensure Motor is in factory default setting.

Initial Setup

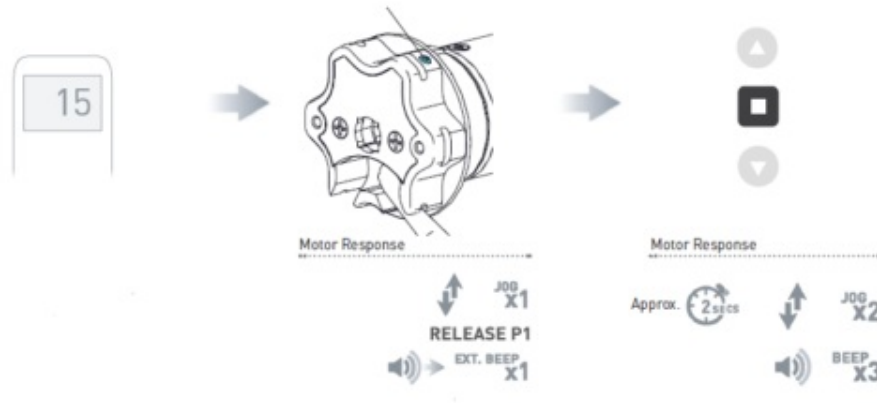

Check motor direction

To check travel direction of shade, press UP or DOWN on controller.. To reverse shade direction, hold both UP and DOWN. Until the motor responds.



- Quick Press = Step
- Long Press = Continuous Travel



Set Limits

Move shade to the desired highest or lowest position by pressing the UP or DOWN buttons on controller.

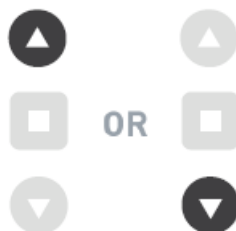

To save upper limit, hold UP and STOP.



To save lower limit, hold DOWN and STOP.

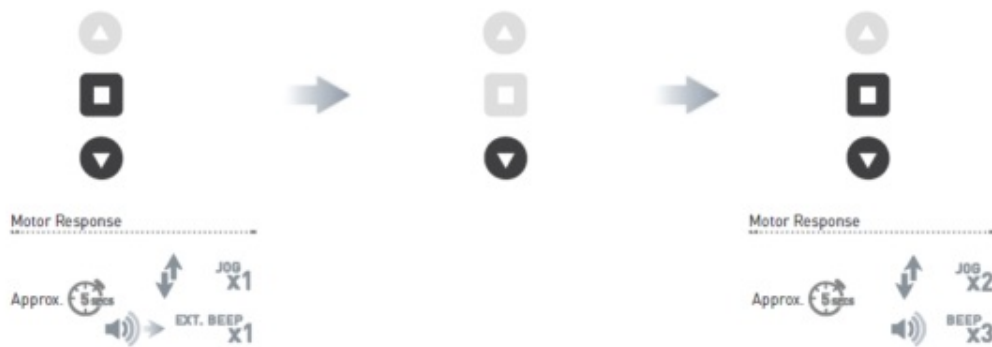

Adjust Upper Limit

Hold UP and STOP on controller. Move shade to the desired highest position by pressing the UP button. To save upper limit, hold UP and STOP.

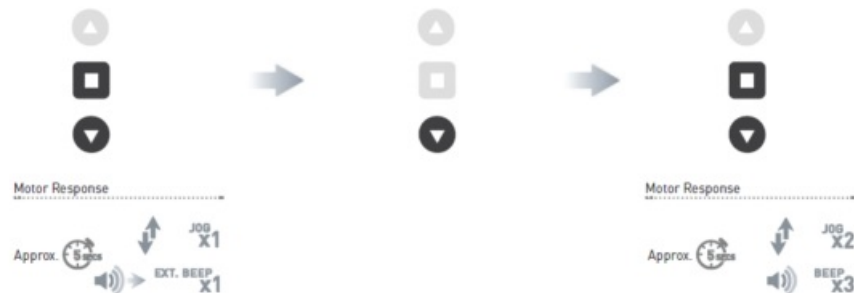

Adjust lower limit

Hold DOWN and STOP on the controller. Move shade to the desired lowest position by pressing the DOWN button. To save lower limit, hold DOWN and STOP.



Delete Upper/Lower Limits

- Press P2 on controller
- Press DOWN on controller
- Press P2 on controller

Press **P2** on controller.



Press **UP** on controller.



Press **UP** on controller.



Cassette Mode:

Motor Response



CASSETTE MODE

Initial Setup



Motor Response



Motor Response



Check motor direction

To check travel direction of shade, press UP or DOWN on controller. To reverse shade direction, hold both UP and DOWN. Until the motor responds.

Press **P2** on controller.

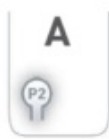

Press **DOWN** on controller.



Press **DOWN** on controller.



Motor Response

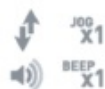

Motor Response



Impact Detection ON

Motor Response



Impact Detection OFF

Motor Response

Select Motor Mode

Now set the motor to cassette mode.



Set Limits

Move shade to the desired lowest position by pressing the UP or DOWN buttons on controller. To save lower limit, hold DOWN and STOP.



SET UPPER LIMIT IN CASSETTE MODE

Move shade to the highest position by pressing the UP button on controller. Upper limit will be automatically set when motor stops.*

Note:

On condition that lower limit has been set prior.

Delete Upper/Lower Limits

Move shade to Upper/Lower Limits



activate/Deactivate Upper Limit Fabric Tension



Activate/Deactivate Lower limit Fabric Tension

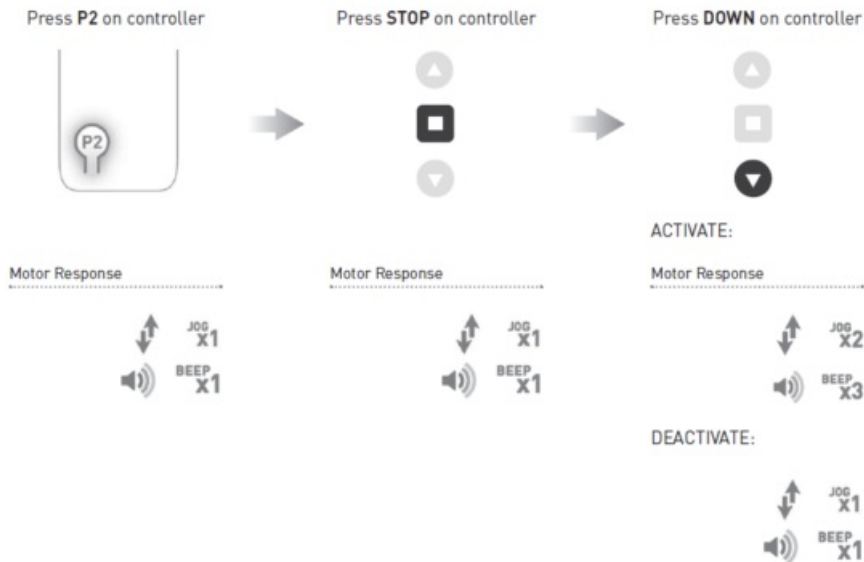

VERTICAL DROP MODE

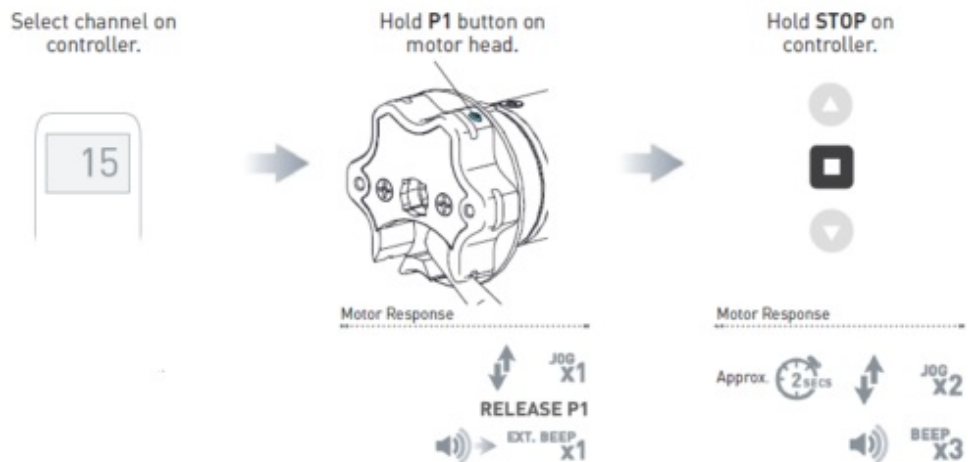

Motor is now in step mode and ready for setting limits

Check motor direction

To check travel direction of shade, press UP or DOWN on controller.. To reverse shade direction, hold both UP and DOWN. Until the motor responds.



Select Motor Mode

Now set vertical drop mode.

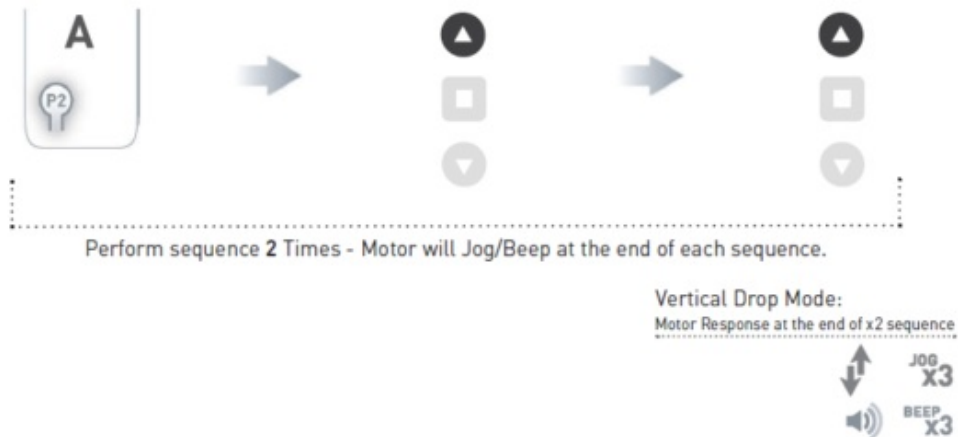

Set Limits

For Ultralock application, see Zipscreen Manual for further info Move shade to the desired highest or lowest position by pressing the UP or DOWN buttons on controller.



To save upper limit, hold UP and STOP.

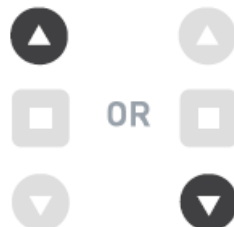

IMPORTANT

After setting limits, motor will automatically exit from initial set-up mode.

Adjust upper limit



Motor Response



Adjust lower limit

Hold DOWN and STOP on controller. Move shade to the desired lowest position by pressing the DOWN button. To save lower limit, hold DOWN and STOP.

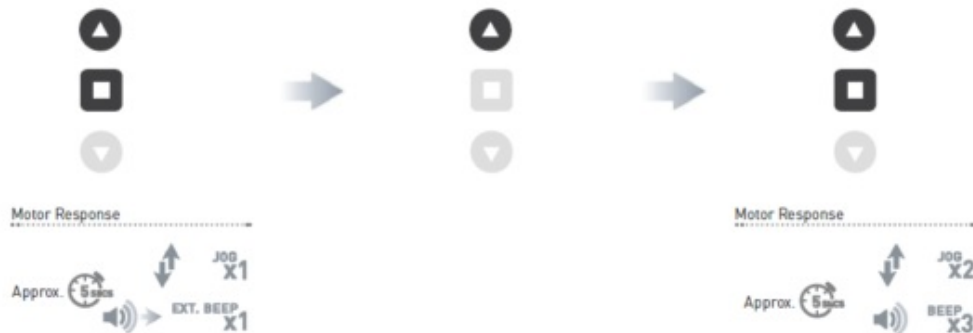

ADD CONTROLLER AND CHANNEL

Using P2 Button on existing controller to add a new controller or channel

- A = Existing controller or channel (to keep)
- B = Controller or channel to add or remove



Using a pre-existing controller to add or delete a controller or channel

- A = Existing controller or channel (to keep)
- B = Controller or channel to add or remove



FAVORITE POSITIONING

Set a favorite position

Move shade to the desired position by pressing the UP or DOWN button on the controller.



Sleep Mode

If multiple motors are grouped on a single channel, Sleep Mode may be used to put all but 1 motor to sleep, allowing programming of just the one motor that remains "Awake". Enter Sleep Mode Sleep mode is utilized to prevent a motor from incorrect configuration during another motor setup. Hold P1 button on motor head. Exit Sleep Mode: Method 1 Exit sleep mode once the shade is ready. Press and release P1 button on the motor head Exit Sleep Mode: Method 2 Remove power and then re-power the motor.

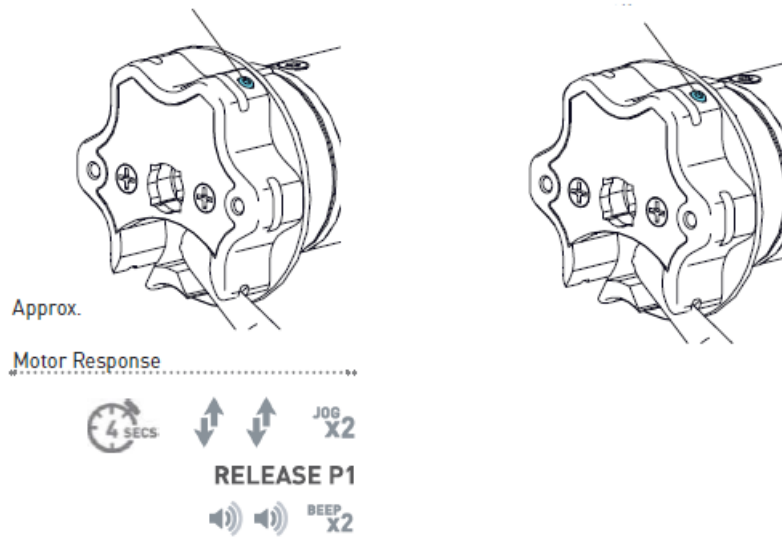

WIND SENSOR FUNCTION

Once the motor receives a command from the wind sensor the motor will respond accordingly. At this point the motor will ignore any other remote or sensor commands for 8 minutes. This function is needed to avoid contradicting multiple triggers. Keep this in mind when testing the motor with the remote after the wind sensor has been triggered. The wind sensor function is ON by default.

Note:

Motor will jog to alert user if operated within the 8 minutes.

TROUBLESHOOTING

Problem	Cause	Remedy
Motor is not responding	A/C power supply not plugged in.	Check motor to power cable connection and AC plug
	Transmitter battery is discharged	Replace battery
	Radio interference/shielding	Ensure transmitter is positioned away from metal objects and the aerial on motor or receiver is kept straight and away from metal
	Receiver distance is too far from transmitter	Move transmitter to a closer position
	Power failure	Check power supply to motor is connected and active
	Incorrect wiring	Check that wiring is connected correctly (refer to motor installation instructions)
Cannot program a single Motor (multiple motors respond)	Multiple motors are paired to the same channel	Always reserve an individual channel for programming functions
		SYSTEM BEST PRACTICE - Provide an extra 15 channel controller in your multi-motor projects, that provides individual control for each motor for programming purposes
		Place all other motors into sleep mode (refer to P1 button function overview - Section 3)

Documents / Resources

 <p>AUTOMATE™ ADVANCED EXTERNAL SHADE MOTOR</p> <p>ARC</p> <p>ROLLEASE ACMEDA</p>	<p>ROLLEASE ACMEDA AX30 Automate External Shade Motor [pdf] Instruction Manual MT011145017, 2AGGZMT011145017, AX30, AX50, Automate External Shade Motor</p>
---	---

References

- [ROLLEASE Acmeda - Precision in Motion](#)