













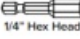

ROLLA SHADE Plus Shade 4 Bottom Fascia Coupled Installation Guide

[Home](#) » [ROLLA SHADE](#) » ROLLA SHADE Plus Shade 4 Bottom Fascia Coupled Installation Guide 

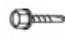

RAS – Installation Instructions Plus+ Shade 4” Bottom Fascia Coupled Manual

| Hardware Included | | | | | | Tools Supplied | Tools Required |
|---|--|---|---|---|---|---|---|
|  |  |  |  |  |  |  |  |
| Clutch Bracket | Single Bearing Link Bracket(s) | Pin End Termination Bracket | Fascia | Bracket Cover (Optional) | Bearing & Locking Clip | |  |
|  |  |  |  |  | | |  |
| Self Tapping Phillips Screws for Tension Device | 1/4" x 1/2" Self Tapping Screws | 1/4" x 1" Wood Screws (If requested) | Drywall Anchors | Metal Stop Ball | | | |

Contents

- [1 Install Bracket](#)
- [2 Install the Clutch Shade](#)
- [3 Linking 3 or more Shades](#)
- [4 Adjusting Levels of Shades](#)
- [5 Install the Pin End Shade/Final Shade](#)
- [6 Adjusting Levels of Shades](#)
- [7 Shade Tracking \(If Necessary\)](#)
- [8 Install the Fascia](#)
- [9 Install Chain Anchor](#)
- [10 TENSION DEVICE](#)
- [11 Documents / Resources](#)
 - [11.1 References](#)

Install Bracket

Install clutch bracket. Install all single bearing link brackets. Then, install pin end termination bracket. Make sure

ALL brackets are level.

Note: Brackets may not be rotated for side mount

Note: If screws do not secure into stud, use supplied drywall anchors.

Note: Must be at least two screws in every bracket



TOP Installation

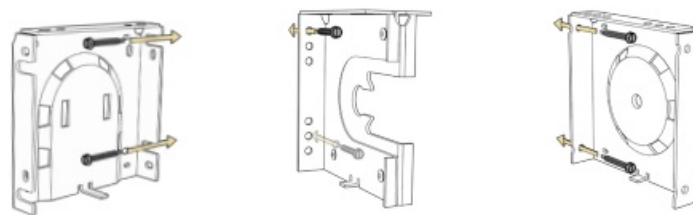

BACK Installation

Install the Clutch Shade

(A) Insert the tongues on clutch into holes on the manual bracket and (B) rest link pin onto the “C” of link bracket. (C) Go to link end of manual shade, and with holes facing away from the clutch, slide bearing onto end of link pin (rotating slightly if needed). Make sure holes are vertical as picture shows and slide onto bracket. (D) Once firmly into bracket, rotate holes 90 degrees so holes are as picture, insert locking clip into bearing until it clicks (Note: Bearing clip cannot not be removed once engaged)

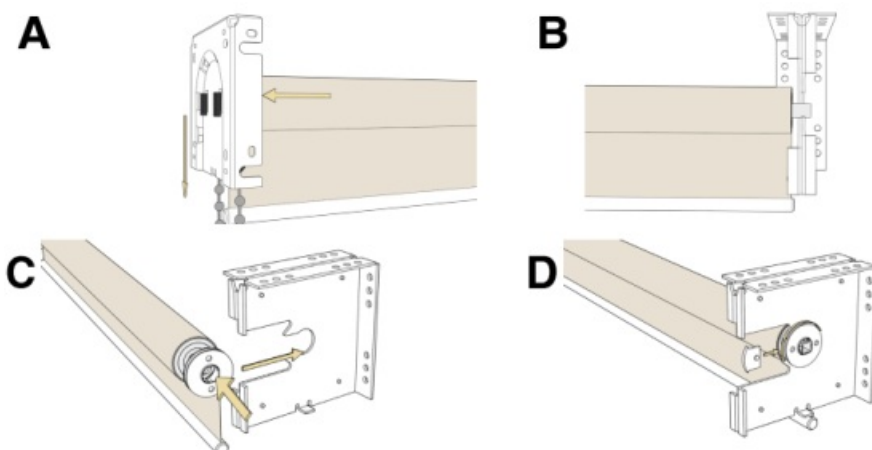

Skip step #3 if there is only one linked shade

Linking 3 or more Shades

(D) Take slave blind with adjuster, and place adjuster over shaft rotating slightly if needed to secure on shaft. (E) Rest link pin onto “C” of Link bracket (F) Go to link end of shade and with holes facing away from manual bracket, slide bearing on end of link (rotating slightly if needed). Make sure holes are vertical as picture shows and slide onto bracket. (G) Once firmly into bracket rotate holes 90 degrees so holes are as picture, insert locking clip into

bearing until it clicks (**Note:** Bearing clip cannot not be removed once engaged).

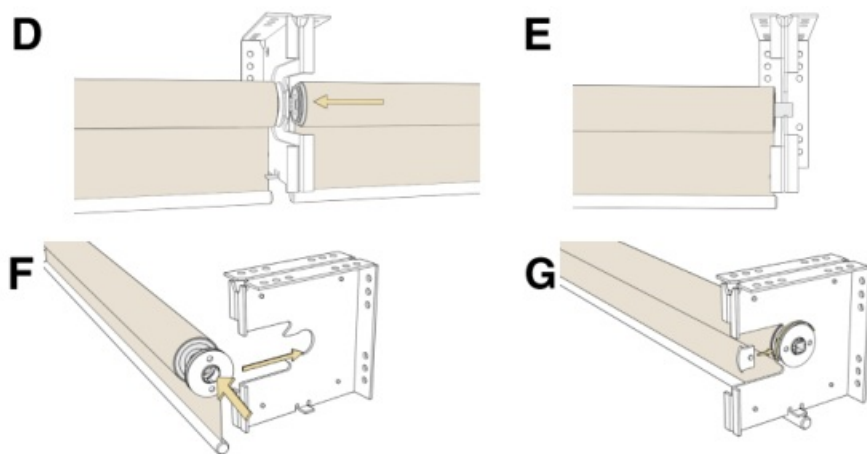

Adjusting Levels of Shades

Once link shade secured, use wheel on infinite adjuster to adjust the level of the bottom of shade of slave shade(s) until it becomes level with clutch shade. The leveling can be performed in both Up and Down direction. A spanner is available if space is too tight to get fingers around the adjusting wheel.

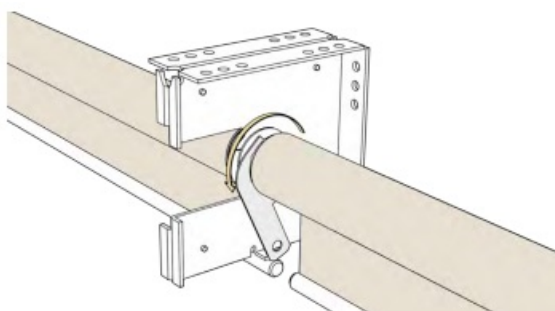

Install the Pin End Shade/Final Shade

(H) From pin end of shade take slave blind with adjuster, and place adjuster over shaft rotating slightly if needed to secure on shaft (I) Depress pin end (J) and slide onto bracket until pin engages in center hole.

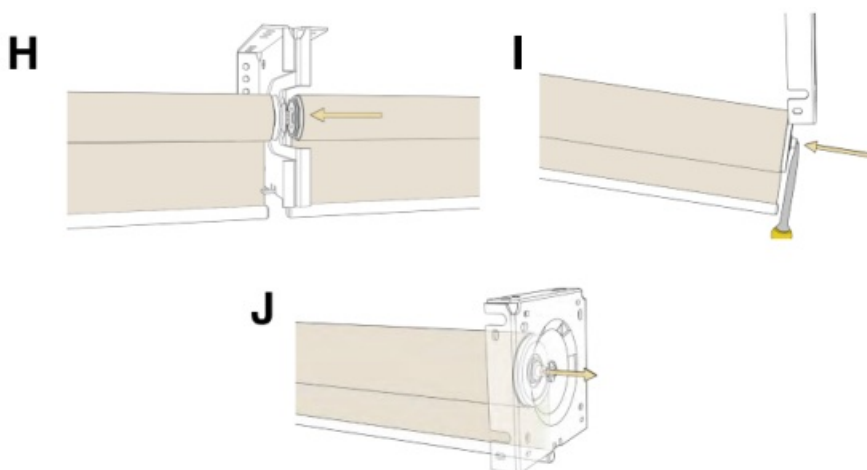

Adjusting Levels of Shades

Once link shade secured, use wheel on infinite adjuster to adjust the level of the bottom of shade of slave shade(s) until it becomes level with Clutch shade.

The leveling can be performed in both Up and Down direction. A spanner is available if space is too tight to get fingers around the adjusting wheel.

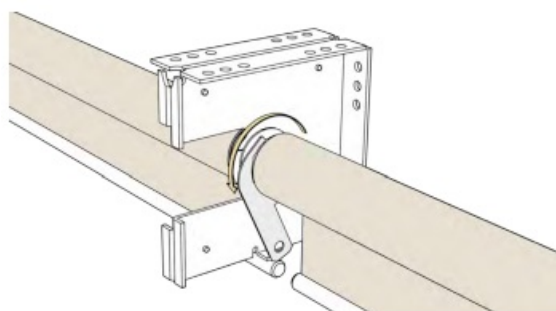

Shade Tracking (If Necessary)

Roll shade up and down to confirm hembar or bottom rail is level and material rolls straight on center tube. If the hembar or bottom rail is not level, lower shade until you see the metal tube. Add layers of masking tape to the metal tube to the end that is too low until hembar or bottom rail is straight. If the material tracks to one side, lower shade until the metal tube is visible. Add layers of masking tape to the metal tube to the end that is opposite the direction of tracking, until shade rolls up straight.

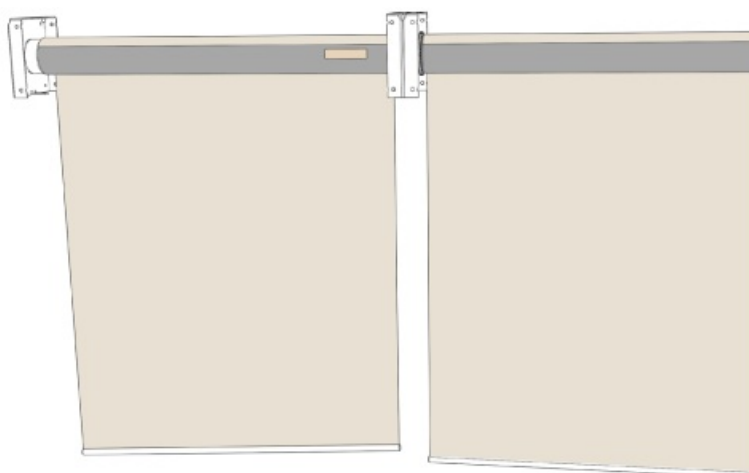

Install the Fascia

Place the top hanger arm of the fascia into the corner openings of the brackets on the 4 inch side (Fig. 1). Gently push the hooked bottom onto the bracket (Fig. 2) insuring each side is locked.

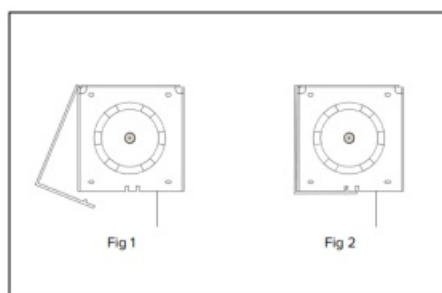
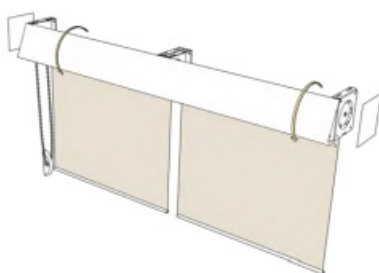

Install Chain Anchor

The chain anchor is a plastic piece that is attached to the chain to secure it from possible accidents. Position the chain anchor on the window frame so that the chain anchor and chain do not interfere with raising or lowering the shade. The chain anchor should be installed without stretching or pulling down the chain. Leave a little play through the chain anchor to allow the chain to pass freely. Do not twist or cross the bead chain. Secure the anchor with Phillips screws in both upper and lower holes.

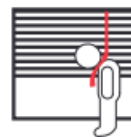
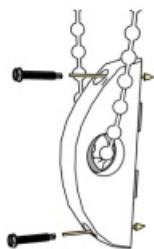

Window Blind Cord Can STRANGLE Your Child

- Children can climb furniture to reach cords
- Move cribs and other furniture away.
- Keep all cords out of children's reach.
- Attach tension device to wall or floor.
- Fasteners provided with the tension device may not be appropriate for all mounting surfaces.
- Use appropriate anchors for the mounting surface conditions.



TENSION DEVICE

INSTALLATION INSTRUCTIONS

Rollashade.com

info@rollashade.com

951.245.5077

© Copyright Roll A Shade ®

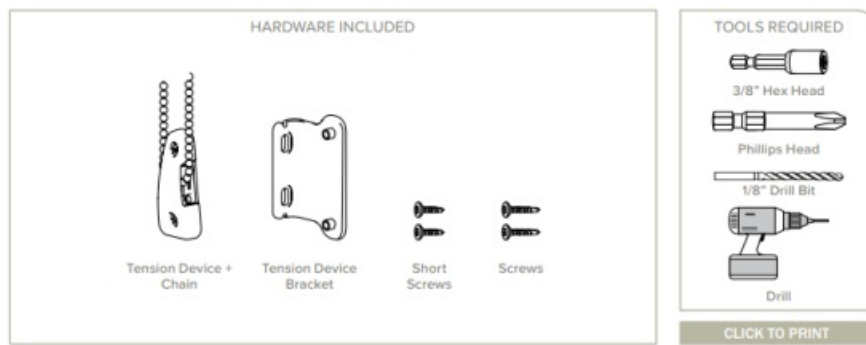

INSIDE OR OUTSIDE APPLICATION

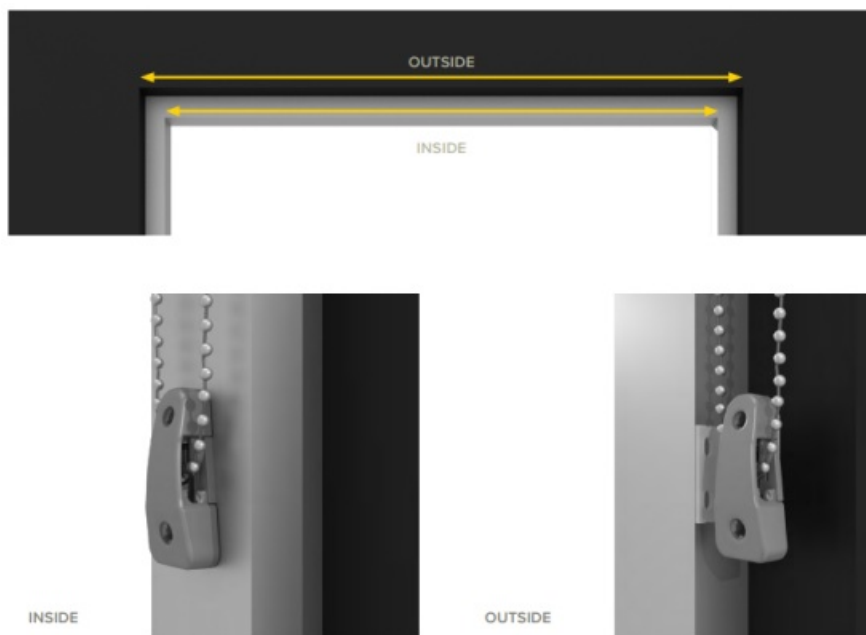

INSIDE MOUNT & TENSION DEVICE INSTALLATION

Pull the Chainhold down until the chain is fully tensioned (plunger will be fully raised). Screw device into wall.

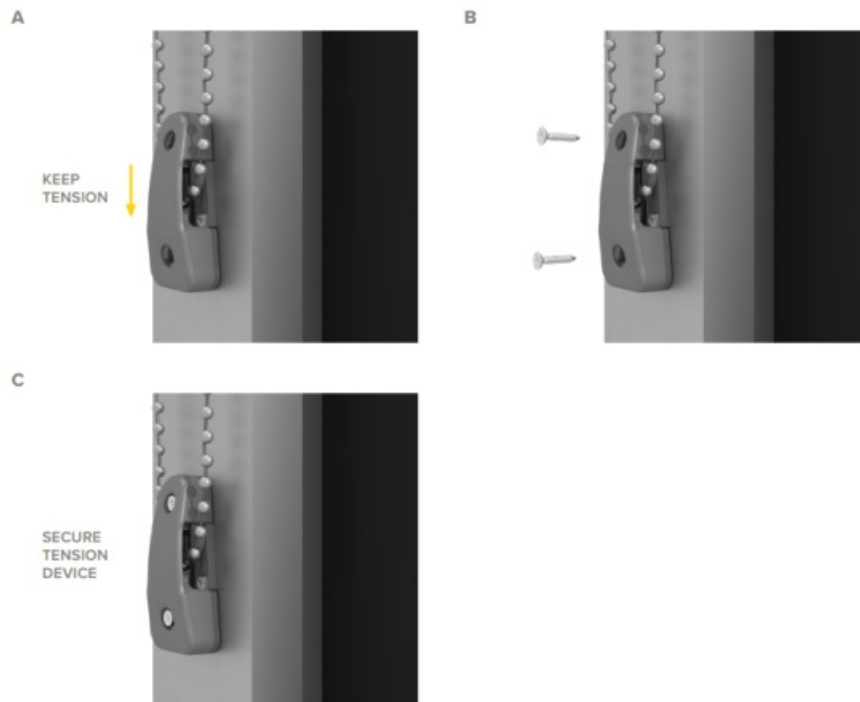

NOTE: Please make sure shade operates smoothly.

OUTSIDE MOUNT & TENSION DEVICE INSTALLATION

With provided screws, install bracket first with large screws (use Chainhold marked screw hole locations as reference). Pull the Chainhold down until the chain is fully tensioned (plunger will be fully raised). Install Chainhold into bracket with small screws.

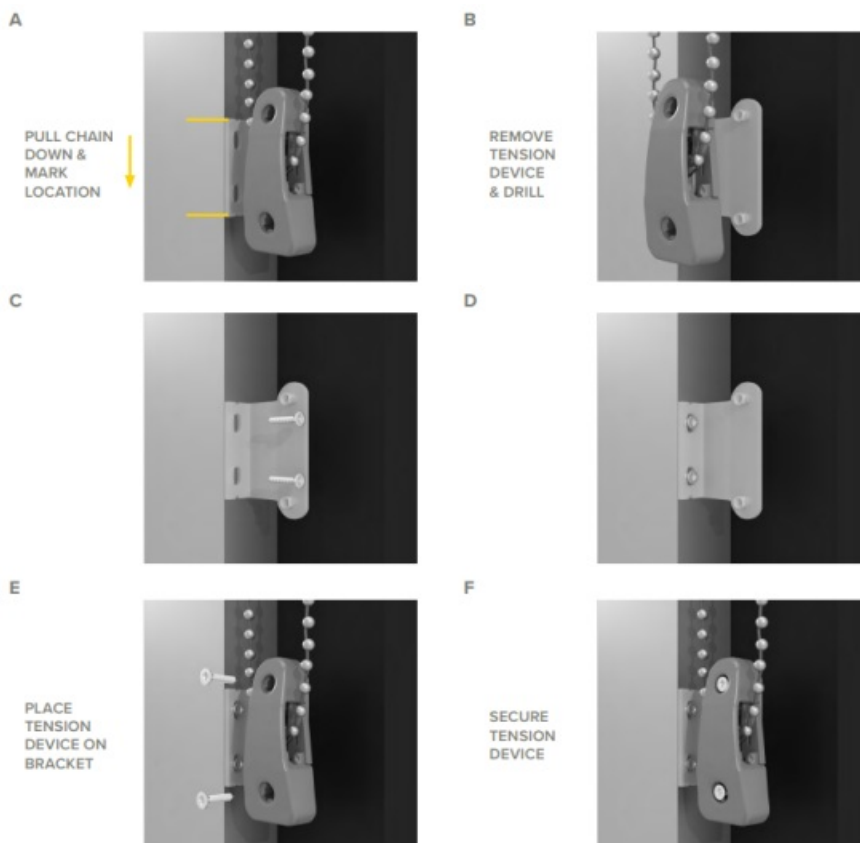

NOTE: Please make sure shade operates smoothly.

12101 Madera Way
Riverside, CA 92503
Phone: [888-245-5077](tel:888-245-5077)
Fax: [951-245-5075](tel:951-245-5075)

Documents / Resources

| | |
|---|--|
|  | <p>ROLLA SHADE Plus Shade 4 Bottom Fascia Coupled [pdf] Installation Guide Plus Shade 4 Bottom Fascia Coupled, 4 Bottom Fascia Coupled, Fascia Coupled</p> |
|---|--|

References

- [Roll A Shade - Commercial Window Shade Solutions](#)
- [Roll A Shade - Commercial Window Shade Solutions](#)
- [User Manual](#)

[Manuals+](#), [Privacy Policy](#)

This website is an independent publication and is neither affiliated with nor endorsed by any of the trademark owners. The "Bluetooth®" word mark and logos are registered trademarks owned by Bluetooth SIG, Inc. The "Wi-Fi®" word mark and logos are registered trademarks owned by the Wi-Fi Alliance. Any use of these marks on this website does not imply any affiliation with or endorsement.