

## ROLL-A-SHADE RASCPORMVER.4 Contract Plus Open Roll Installation Guide

[Home](#) » [ROLL-A-SHADE](#) » ROLL-A-SHADE RASCPORMVER.4 Contract Plus Open Roll Installation Guide 

### ROLL-A-SHADE RASCPORMVER.4 Contract Plus Open Roll

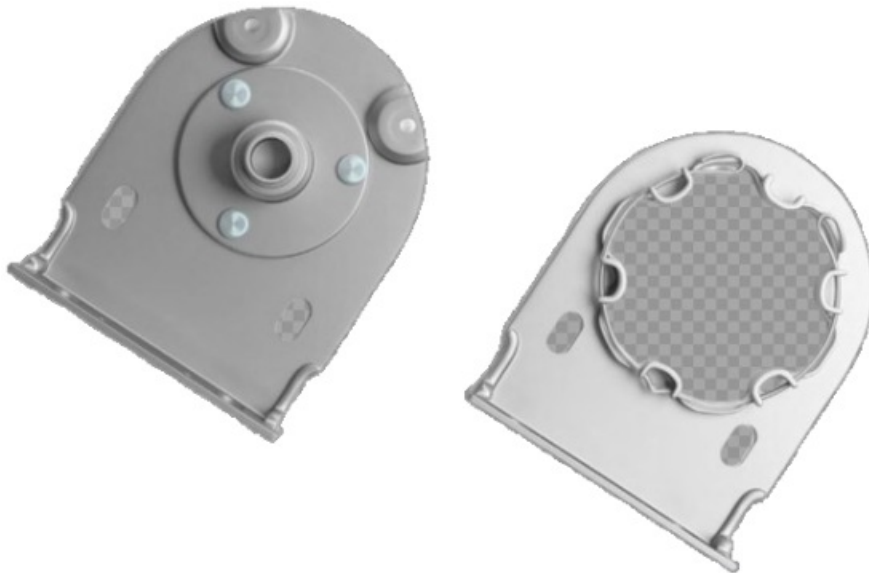

## Contents

- 1 [HARDWARE INCLUDED](#)
- 2 [TOOLS REQUIRED](#)
- 3 [INSIDE OR OUTSIDE APPLICATION](#)
- 4 [MOUNTING LOCATION](#)
- 5 [SCREW INSTALLATION](#)
- 6 [ALIGNMENT](#)
- 7 [SHADE PIN END INSTALLATION](#)
- 8 [MOTOR END INSTALLATION](#)
- 9 [LOCK RING INSTALLATION](#)
- 10 [PLUG IN MOTOR](#)
- 11 [SHADE ADJUSTING \(IF NECESSARY\)](#)
- 12 [ADJUSTING LIMITS \(IF NECESSARY\)](#)
- 13 [Customer Support](#)
- 14 [Documents / Resources](#)
  - 14.1 [References](#)
- 15 [Related Posts](#)

## HARDWARE INCLUDED

- Shade + Motor

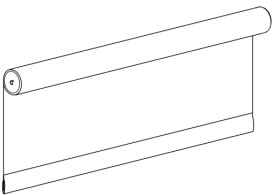

- Motor Bracket

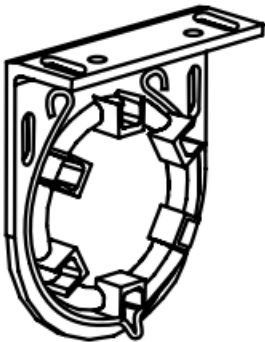

- Motor Bracket Idler End

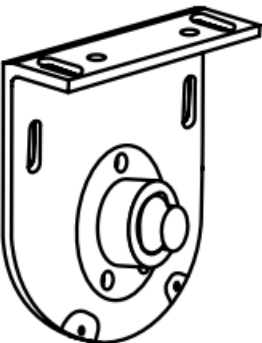

- Wall Switch

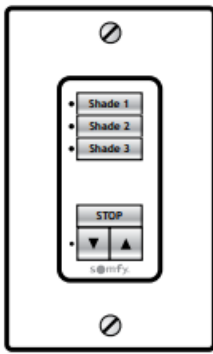

- Switch Box

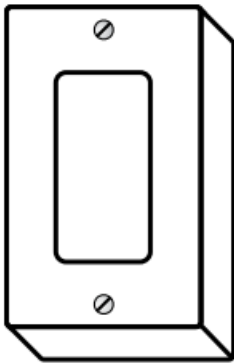

- #14 Screw



- Screws

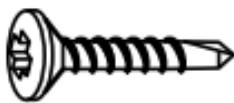

- Zip Ties



- Wire Tie Pads

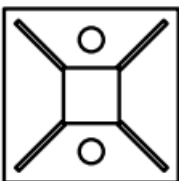

## TOOLS REQUIRED

- 3/8" Hex Head



- Phillips Head

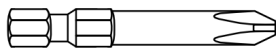

- 1/8" Drill Bit



- Drill

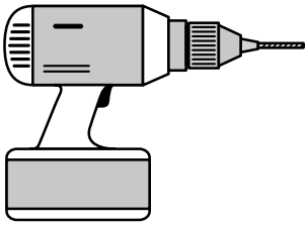

## INSIDE OR OUTSIDE APPLICATION

**\*\*NOTE:** ALL SHADES MAY BE PRE-PROGRAMMED TO SENSORS, REMOTES, AND/OR WALL SWITCHES UPON ARRIVAL \*\*

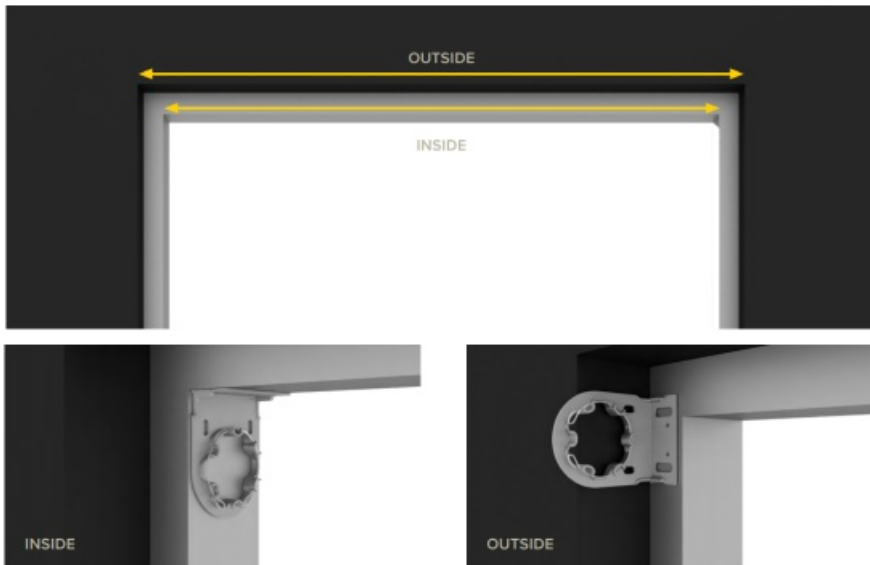

## MOUNTING LOCATION

Place your first bracket in its mounting location and mark the screw holes. Place your second bracket in its mounting location and repeat the process.

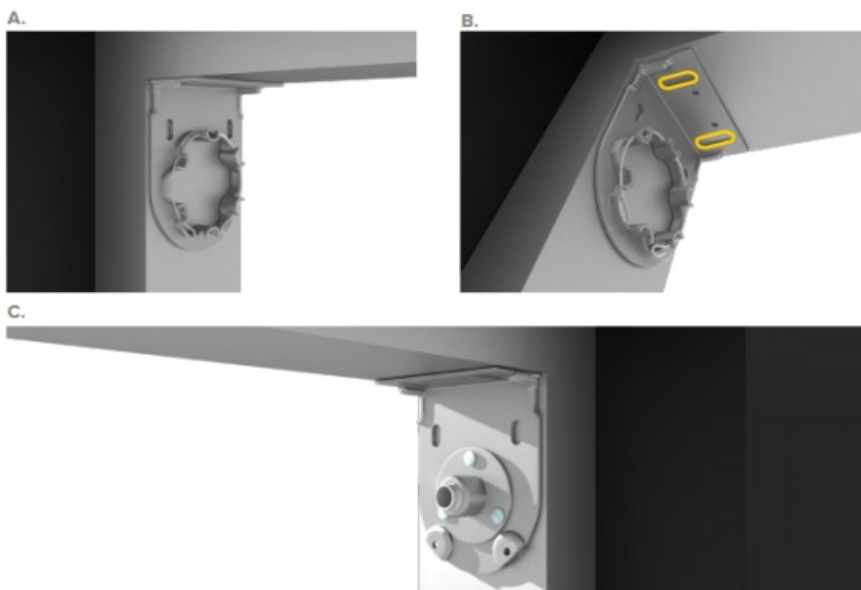

## SCREW INSTALLATION

Next, pre-drill your screw holes using a 1/8" drill bit. Install the brackets with the provided screws using the 1/4" hex head driver.

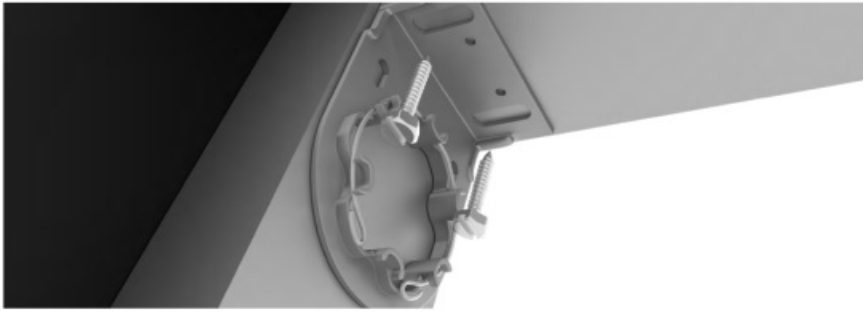

## ALIGNMENT

Check to make sure your brackets are level and aligned.



## SHADE PIN END INSTALLATION

Swivel ball bearing to align with idler shaft for easy installation. Press idler shaft all the way to the bracket.

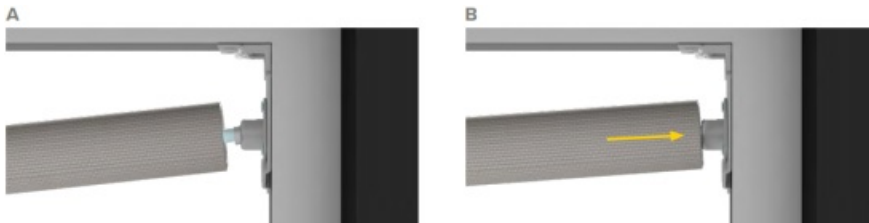

## MOTOR END INSTALLATION

Remove locking ring. Lineup to motor bracket. Push motor into motor bracket.

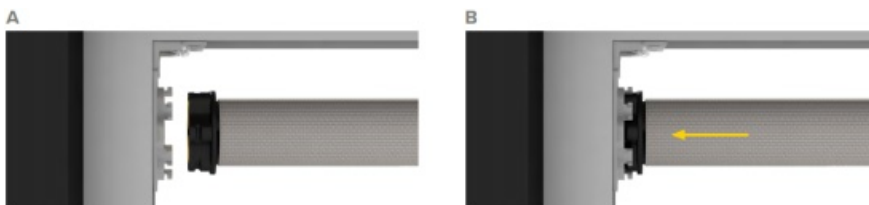

## LOCK RING INSTALLATION

Add locking ring to motor bracket. Check motor is secured correctly.



## PLUG IN MOTOR

- Run motor power cord to nearest power outlet.
- Install wire tie pads and secure with zip ties to hold wire down.
- The path of the wire should be parallel with mullions and/or drop ceiling tiles ensuring the cable is neatly organized.
- Any modifications to the power cable should be done by a certified electrician to meet your city/state code requirements.



## SHADE ADJUSTING (IF NECESSARY)

- Roll shade up and down to confirm hembar is level and material rolls up straight on center tube.
- If the hembar is not level, lower shade until you see the metal tube.
- Add layers of masking tape to the metal tube to the end that is too low until hembar is straight.
- If the material tracks to one side, lower shade until you see the metal tube.
- Add layers of masking tape to the metal tube to the end that is opposite the direction of tracking, until shade rolls up straight.

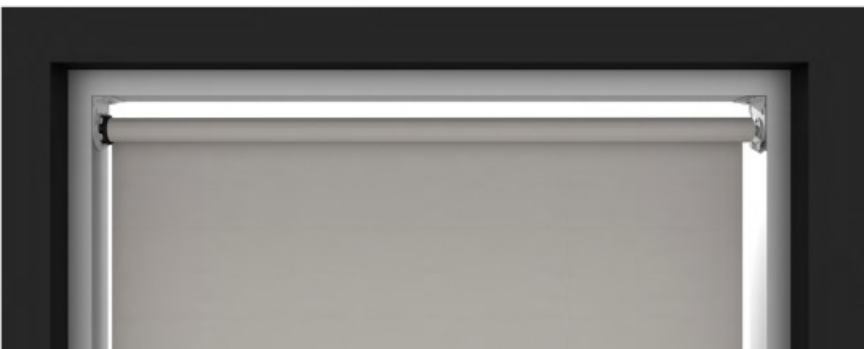

## ADJUSTING LIMITS (IF NECESSARY)

See programming instructions based on the motor used for your application.

## Customer Support

[Rollashade.com](http://Rollashade.com)  
[info@rollashade.com](mailto:info@rollashade.com)

951.245.5077

© Copyright Roll A Shade® Inc. All Rights Reserved.



## Documents / Resources

 <p>CONTRACT PLUS® OPEN ROLL INSTALLATION INSTRUCTIONS</p>	<p><a href="#">ROLL-A-SHADE RASCPORMVER.4 Contract Plus Open Roll</a> [pdf] Installation Guide RASCPORMVER.4 Contract Plus Open Roll, RASCPORMVER.4, Contract Plus Open Roll, Op en Roll</p>
--	--

## References

-  [Roll A Shade - Commercial Window Shade Solutions](#)
- [User Manual](#)

[Manuals+](#), [Privacy Policy](#)

This website is an independent publication and is neither affiliated with nor endorsed by any of the trademark owners. The "Bluetooth®" word mark and logos are registered trademarks owned by Bluetooth SIG, Inc. The "Wi-Fi®" word mark and logos are registered trademarks owned by the Wi-Fi Alliance. Any use of these marks on this website does not imply any affiliation with or endorsement.