



Roland V-02HD MK II Multi Format Live Streaming Video User Guide

[Home](#) » [Roland](#) » Roland V-02HD MK II Multi Format Live Streaming Video User Guide 

Contents

- 1 [Roland V-02HD MK II Multi Format Live Streaming Video](#)
- 2 [Product Information](#)
- 3 [Product Usage Instructions](#)
- 4 [Checking the Included Items](#)
- 5 [Attaching the Cord Hook](#)
- 6 [Operating Guide \(Panel Descriptions\)](#)
 - 6.1 [Top Panel](#)
- 7 [Rear Panel/Side Panel \(Connecting Your Equipment\)](#)
- 8 [Video Operations](#)
 - 8.1 [Using Mix/Wipe to Switch Video](#)
- 9 [Using Picture-In-Picture to Composite Video \(PinP\)](#)
- 10 [Using a Key to Composite Video \(KEY\)](#)
- 11 [Applying a Visual Effect to the Video \(VFX\)](#)
- 12 [USING THE UNIT SAFELY](#)
- 13 [IMPORTANT NOTES](#)
- 14 [Documents / Resources](#)
 - 14.1 [References](#)



Roland V-02HD MK II Multi Format Live Streaming Video



Product Information

Specifications

- **Model:** V-02HD MK II
- **Included Items:**
 - V-02HD MK II unit
 - Cord hook
 - AC adaptor
 - Startup Guide
 - Power cord
 - Leaflet USING THE UNIT SAFELY

Product Usage Instructions

Checking the Included Items

Check that all of the included items are present. If any of the included items are missing, contact your dealer.

Attaching the Cord Hook

1. Remove the screw (one) indicated in the illustration.
2. Using the screw that you removed in step 1, attach the cord hook as shown in the illustration. Align the cord hook as shown.

Downloading PDF Manual

1. Enter the following URL in your computer: <https://proav.roland.com/manuals/>
2. Choose V-02HD MK II.

Checking System Program Version

Before using the unit, ensure that its system program is at the most recent version. You can check the system program version by pressing the [MENU] button, navigating to SYSTEM, and selecting VERSION.

Operating Guide (Panel Descriptions)

Top Panel

- **[OUTPUT FADE] knob:** Fading video and audio in or out. Turn counterclockwise from the center for fade-in/fade-out effects. Turn clockwise from the center to output a captured still image as a cut (instant switching).
- **[TYPE] button:** Select the effect applied to the video. Press the button to switch between different video effects.
- **[1] [2] buttons & Video fader:** Switches between the videos being input to INPUT 1 and 2, and sends them to the program output. The video fader manually switches between the input videos and sends them to the program output.

Indicator Status

- **Left indicator:** Blinking red (Fading in/out), Lit red (Fade-out completed)
- **Right indicator:** Lit green (Unit contains still image), Lit red (Still image is being output), Dark (Unit contains no still image)

Video Effects

- **Transition effects:** MIX (The two videos are mixed as the transition occurs), WIPE (The next video moves across to replace the original video)
- **Composition effects:** Picture-in-picture (The inset screen is shown on top of the background video), KEY (A portion of the video is made transparent and composited with the background video)

FAQs

- **Q: How do I check if all the included items are present?**

A: You can check if all the included items are present by referring to the startup guide and verifying each item listed.

- **Q: Where can I download the PDF manual for detailed operations and menu lists?**

A: You can download the PDF manual from the Roland website by visiting <https://proav.roland.com/manuals/> and selecting V-02HD MK II.

- **Q: How can I update the system program version of the unit?**

A: To update the system program version, visit the Roland website at <https://proav.roland.com/> and follow the instructions provided for available upgrades.

- **Q: What are the different video effects available on the unit?**

A: The unit offers transition effects such as MIX and WIPE, as well as composition effects like Picture-in-picture (PinP) and KEY.

Checking the Included Items

Check that all of the included items are present. If any of the included items are missing, contact your dealer.

- V-02HD MK II unit
- AC adaptor
- Power cord
- Cord hook
- Startup Guide
- Leaflet "USING THE UNIT SAFELY"

PDF Manual (download from the Web)

Details on operations and menu lists are provided in the "Reference Manual" (PDF).

Downloading

1. Enter the following URL in your computer. <https://proav.roland.com/manuals/>.
2. Choose "V-02HD MK II".



Attaching the Cord Hook

Attach the included cord hook. The cord hook is used to secure the cord of the AC adaptor.

1. Remove the screw (one) indicated in the illustration.

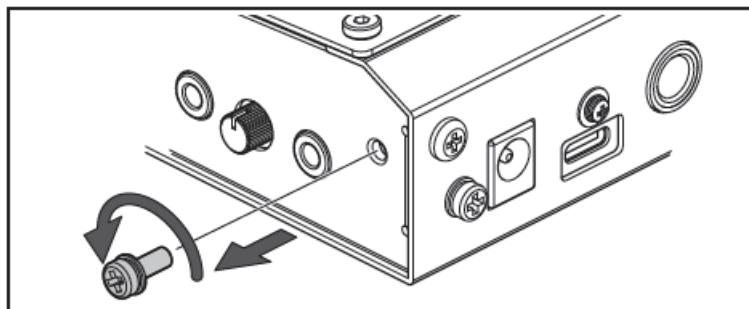

2. Using the screw that you removed in step 1, attach the cord hook as shown in the illustration.

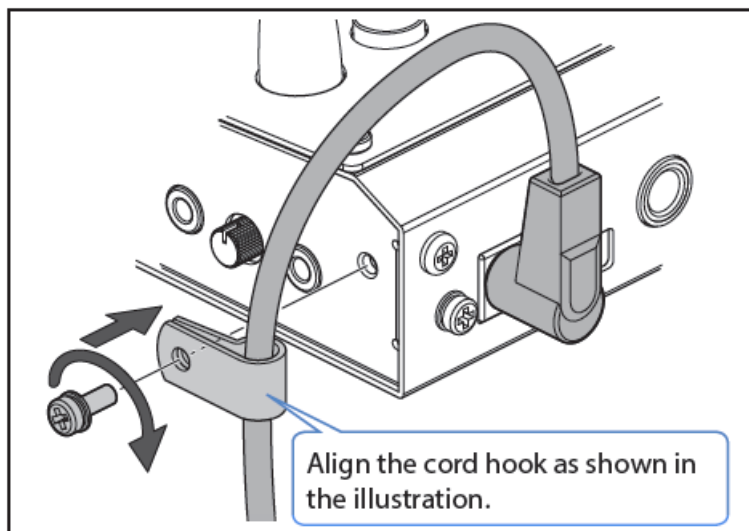

- Before using the unit, ensure that its system program is at the most recent version. For information on available upgrades for the system program, see the Roland website (<https://proav.roland.com/>).
You can check the system program version by Pressing the [MENU] button0“SYSTEM”0“VERSION”.
- Before using this unit, carefully read “USING THE UNIT SAFELY” and “IMPORTANT NOTES” (the leaflet “USING THE UNIT SAFELY” and the Startup Guide (p. 10)). After reading, keep the document(s) where it will be available for immediate reference.

Operating Guide (Panel Descriptions)

Top Panel

■ Fading video and audio in or out

■ Outputting a captured still image

[OUTPUT FADE] knob

Turn counterclockwise from the center
The program output video and audio fade in/out simultaneously. The video fades to a black screen.



Turn clockwise from the center

If you turn the knob all the way clockwise, the captured still image is output to preview/program as a cut (instant switching).

Center

Normal output.

The indicators located at the left and right of the [OUTPUT FADE] knob show the status.

Left indicator

Blinking red	Fading in/out
Lit red	Fade-out completed

Right indicator

Lit green	Unit contains still image
Lit red	Still image is being output
Dark	Unit contains no still image

* The settings described above are the factory defaults. You can also assign other functions to the [OUTPUT FADE] knob.

■ Selecting a Video Effect

[TYPE] button

You can select the effect that's applied to the video. The video effect is switched each time you press the button. The indicator of the selected video effect is lit.

Transition effects ➔ p. 6

MIX	The two videos are mixed as the transition occurs.
WIPE	The next video moves across to replace the original video.

Composition effects ➔ p. 7, 8

Picture-in-picture (PinP)	The inset screen (a separate small screen) is shown on top of the background video.
KEY	A portion of the video is made transparent, and composited with the background video.



■ Switching video

[1] [2] buttons, Video fader

➔ p. 6

[1] [2] buttons

Switch between the videos being input to INPUT 1 and 2, and send them to the program output.

[1] [2] buttons	Status
Lit red	Video that's being output as the program
Lit green	Preview video (standby video)

Video fader

Manually switch between the videos being input to INPUT 1 and 2, and send them to the program output.

Transition indicators (both sides of the fader)

The lit indicator shows the video that is being output as the program.

■ Compositing video

[1] [2] buttons, Video fader

➔ p. 7, 8

[1] button (Lit yellow)/

Transition indicators (both sides of the fader)

Selects the background video when compositing video. A transition indicator (left or right) is lit to indicate the selected background video.

[2] button/Video fader

Outputs the resulting composited video as the program. The inset screen of picture-in-picture or the key video or image for key compositing is revealed or removed.

[2] button	Status
Lit red	Outputting the composited result as the program
Dark	Outputting only the background video as the program

■ Adjusting the video effect

[CONTROL 1] [CONTROL 2] knobs → p. 7-9

These adjust the video effect or visual effect (VFX).

- If the visual effect is on ([VFX] button lit), these knobs control the visual effect.
- Operate this while holding down the [VFX] button to target the audio effect.

■ Applying a Visual Effect to the Video

[VFX] button → p. 9

Turns the visual effect on/off.

When on, the [VFX] button is lit.

- You can adjust the audio effect by holding down the button and operating the [CONTROL 1] and [CONTROL 2] knobs.



■ Operating the Menu

[MENU] button, [VALUE] knob

Here's how to access the menu, and make video/audio settings and settings for the V-02HD MK II itself. The menu is shown on the display that's connected to the PREVIEW OUT connector.

1. Press the [MENU] button to display the MENU screen.

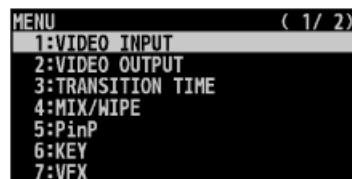

The menu is organized into functions.

2. Turn the [VALUE] knob to move the cursor to the menu item that you want to change, and then press the [VALUE] knob.

3. Repeat step 2 as needed.

Pressing the [MENU] button moves you back one level higher.

4. Turn the [VALUE] knob to change the setting value, and then press the [VALUE] knob to confirm.

MEMO

- By turning the [VALUE] knob while pressing it, you can change the value more greatly.
- Long-pressing the [VALUE] knob returns the current menu item you're setting to its default value.

5. Press the [MENU] button several times to close the menu.

What is the program output?

This is the video output that reflects all processing such as video compositing and visual effects. It is output from the PROGRAM OUT connector.

This is the video that is seen by the people who are watching the live stream or presentation.

Tripod mounting socket (bottom panel)



This is used when attaching the V-02HD MK II to a commercially available camera tripod. The socket is threaded for a 1/4" screw.

What is the program output?

- This is the video output that reflects all processing such as video compositing and visual effects. It is output from the PROGRAM OUT connector.
- This is the video that is seen by the people who are watching the livestream or presentation.

Rear Panel/Side Panel (Connecting Your Equipment)

To prevent malfunction and equipment failure, always turn down the volume, and turn off all the units before making any connections.

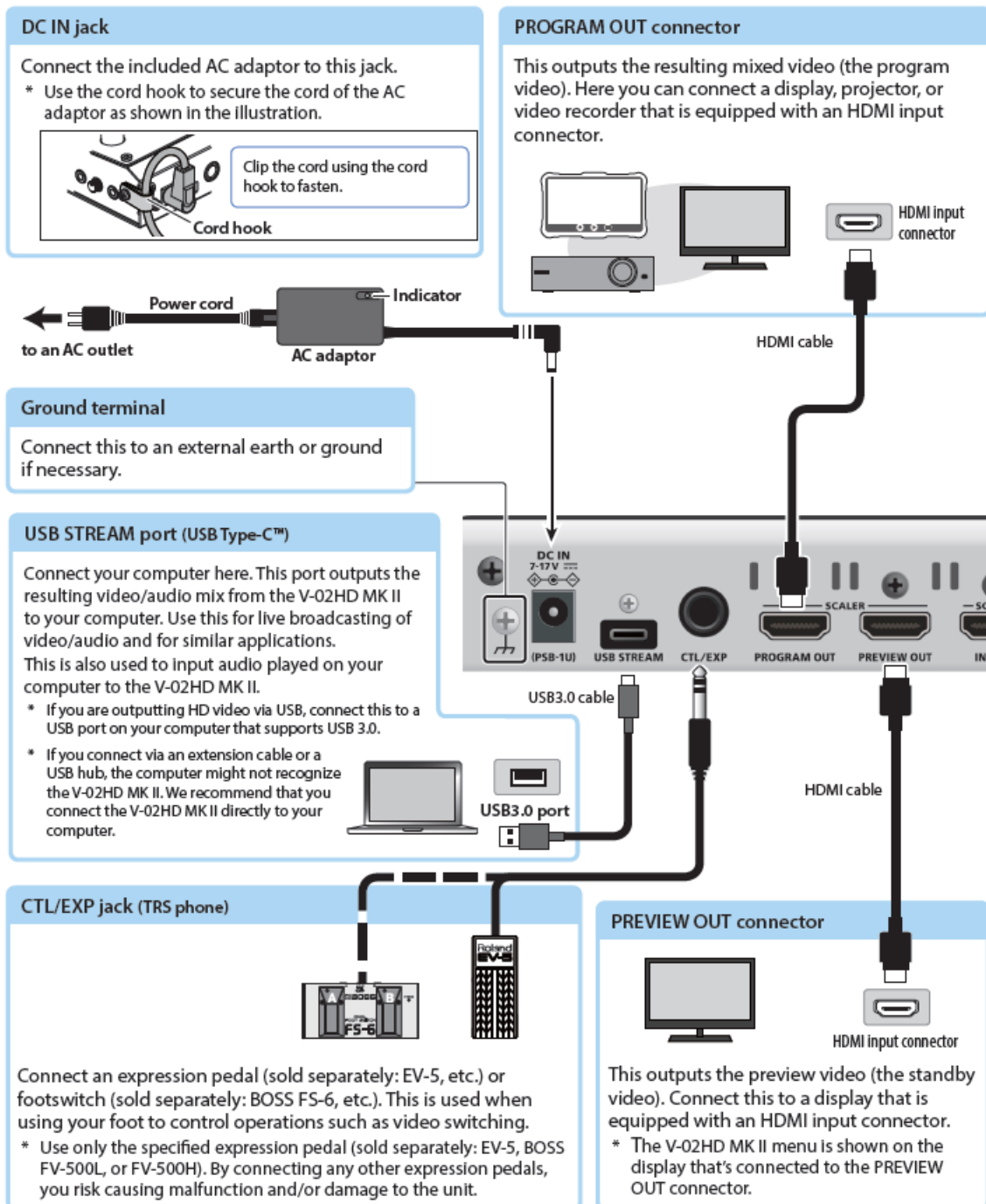

Do not block the ventilation openings (the slits located on the front and side panels, etc.). If the ventilation openings are blocked, the internal temperatures may rise, causing malfunctions due to excessive heat.

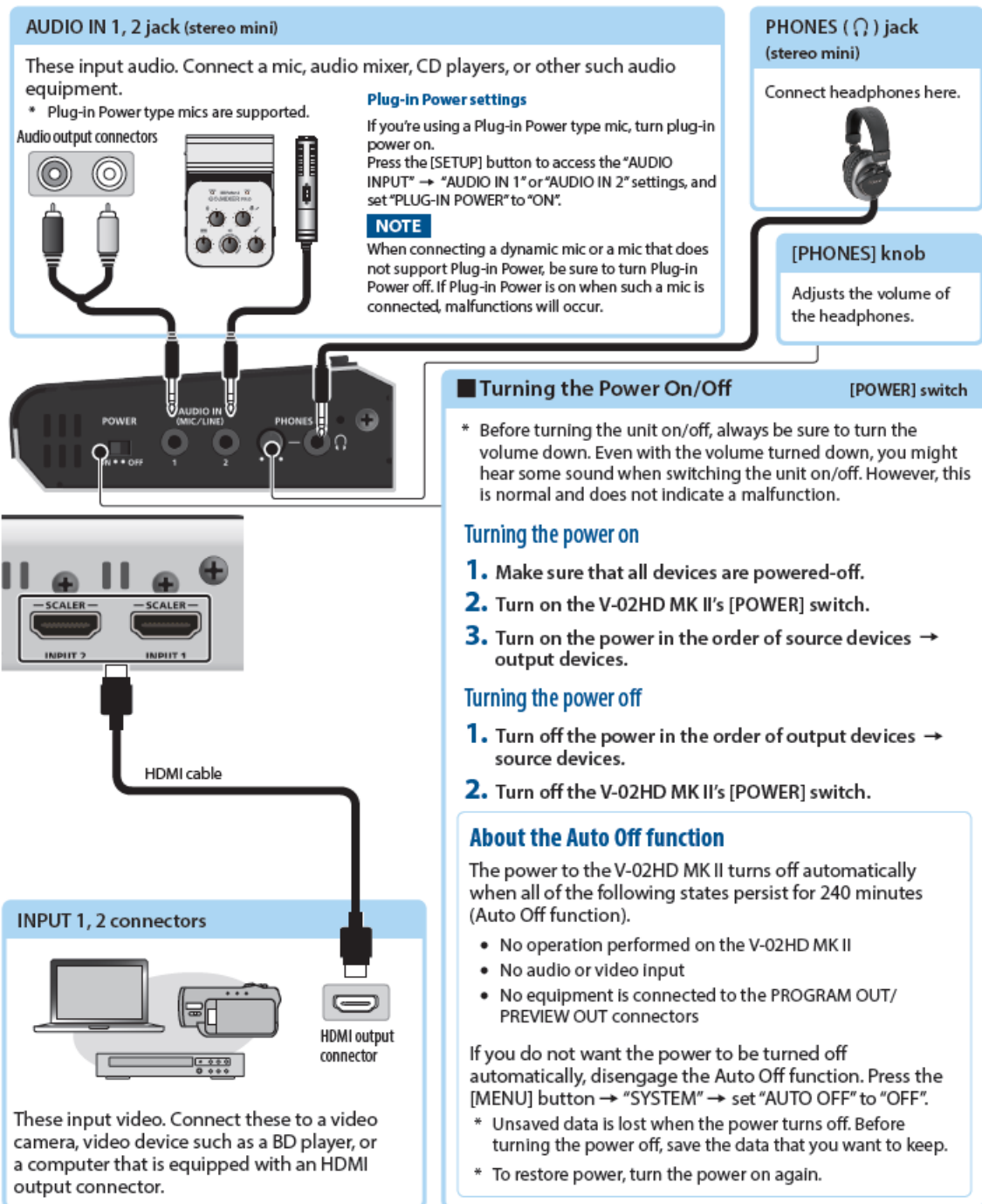

Video Operations

Using Mix/Wipe to Switch Video



Using Mix/Wipe to Switch Video (MIX/WIPE)

Here's how to switch between input video while applying an effect, and output the program.

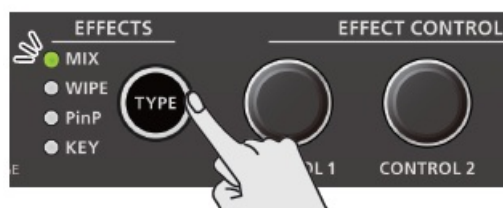
1. Press the [TYPE] button several times to select the transition effect (MIX, WIPE).



The MIX or WIPE indicator is lit.

Transition effects	Explanation
MIX	<p>The two videos are mixed as the transition occurs.</p> 
WIPE	<p>The next video moves across to replace the original video.</p> 

<Using the buttons to switch>

- Press the button [1] or [2] that is lit green.

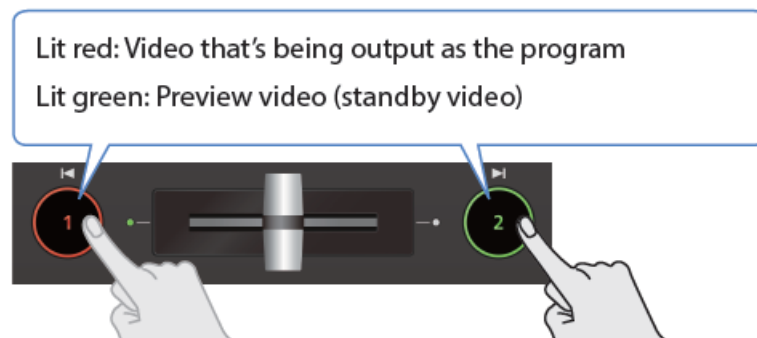

- The button you press lit red, and the video switches.
- When the video has switched completely, the lit state (red, green) of buttons [1] [2] is exchanged.

MEMO

• Operation of the [1] [2] buttons

The [1] [2] buttons can be assigned to perform other operations, such as auto-take switching. To specify this, set the SYSTEM menu items “INPUT 1 SW ASSIGN” and “INPUT 2 SW ASSIGN”. These settings are effective only if mix/wipe is selected as the video effect.

• Video transition time

If you use the buttons to switch video, the transition occurs over a pre-specified time. To specify the video transition time, set the TRANSITION menu item “MIX/ WIPE TIME”.

<Using the fader to switch>

- Slide the video fader to the far left or far right.

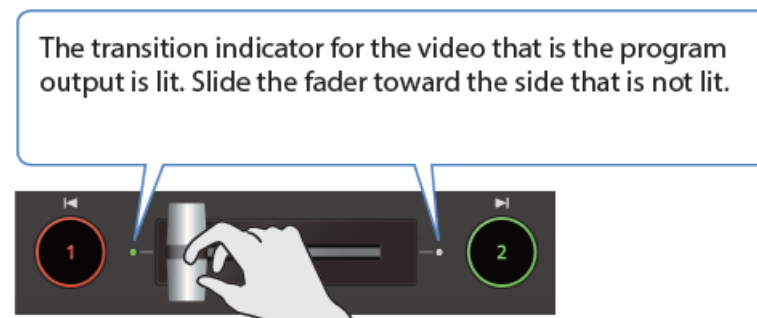

- The video is switched according to the movement of the video fader.
- When the video has switched completely, the lit state (red, green) of buttons [1] [2] is exchanged.

MEMO

Depending on the timing at which you switch the video effect, the position of the video fader might differ from the actual output. If you operate the video fader in this state, the output does not change until the

position of the video fader matches the actual output.

Changing the mix/wipe pattern

You can use the MIX/WIPE menu to specify the pattern by which the mix/wipe occurs and the direction of the wipe.

Menu item	Explanation
MIX TYPE	Pattern of the mix transition
WIPE TYPE	Pattern of the wipe transition
WIPE DIRECTION	Direction of wipe
WIPE BORDER COLOR	Color of the border added to the periphery of the wipe
WIPE BORDER WIDTH	Width of the border added to the periphery of the wipe

Using Picture-In-Picture to Composite Video (PinP)

Here's how to composite an inset screen (a small separate screen) onto the background video.



1. Press the [TYPE] button several times to select PinP.

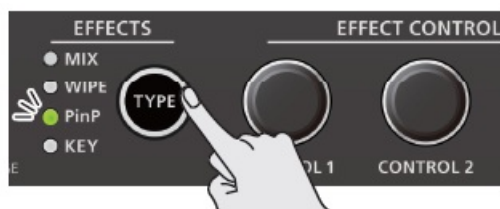

- The PinP indicator is lit green, and the inset screen is shown in the preview video (standby video).
 - You can check the position and size of the inset screen that will be composited before outputting the program.
2. Press the [1] button (lit yellow) to select the background video and the inset screen.

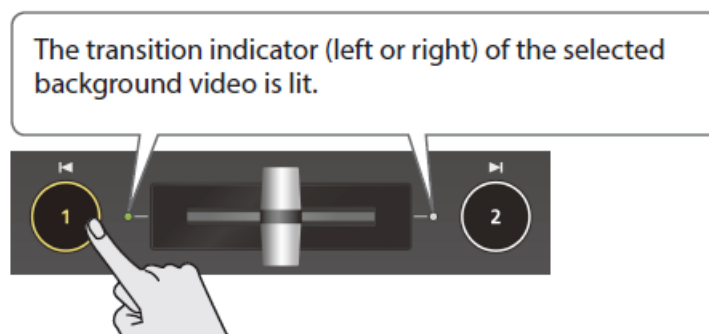

- Each time you press the [1] button, the background video and the inset screen video that are output as the preview will alternate.

3. Turn the [CONTROL 1] [CONTROL 2] knobs to adjust the inset screen.



- **[CONTROL 1] knob**
 - **Turn:** Horizontal display position of the inset screen
 - **Turn while pressing:** Size of the inset screen (reduce/magnify)
- **[CONTROL 2] knob**
 - **Turn:** Vertical display position of the inset screen
 - **Turn while pressing:** Zoom ratio of the inset screen

4. Press the [2] button.

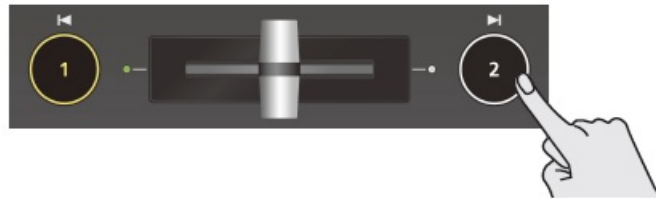

- The inset screen is composited with the background video, and output as the program. The [2] button is lit red.
- When you press the [2] button once again, the button goes dark and the inset screen disappears.

MEMO

- The fade time over which the inset screen appears or disappears when you press the [2] button is specified by the setting of the TRANSITION menu item "PinP TIME".
- You can also use the video fader to show or hide the inset screen.
- If a video composited by PinP is being output as the program, the PinP indicator is lit red.

Making detailed settings for the inset screen

You can use the PinP menu to specify the shape and size of the inset screen, and the color of the border that is added to the inset screen.

Menu item	Explanation
WINDOW	Use the following items to adjust the inset screen.
POSITION H	Horizontal display position
POSITION V	Vertical display position
SIZE	Size (reduce/magnify)
CROPPING H	Horizontal frame size
CROPPING V	Vertical frame size
SHAPE	Shape (rectangle, circle, diamond)
BORDER COLOR	Color of border
BORDER WIDTH	Width of border
VIEW	Use the following items to adjust the video that is shown in the inset screen.
POSITION H	Horizontal display position
POSITION V	Vertical display position
ZOOM	Magnification

Using a Key to Composite Video (KEY)

You can turn a portion of the video transparent and composite it with the background video. You can use a luminance key with either a black or white background or a chroma key with either a blue or green background.

Luminance key

This cuts out text or an image by turning the black or white portion transparent, and composites it onto the background video.



Chroma key

This cuts out a video by turning the blue or green portion transparent, and composites it onto the background video. Using this, you can composite only a subject that you are photographing against a blue screen or green screen.



1. Press the [TYPE] button several times to select KEY.

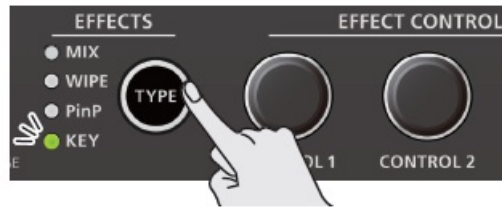

- The KEY indicator is lit green, and the composition results is shown in the preview video (standby video).
- You can check the logo to be key-composited before you output the program.

2. Press the [1] button to select the video of either INPUT 1 or 2 as the background.

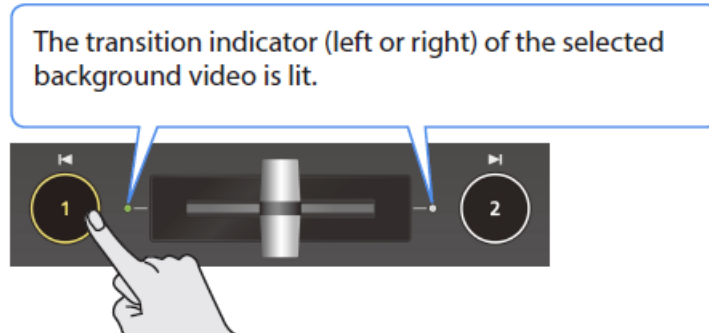

- Each time you press the [1] button, the background video being output as the preview will switch.

3. Turn the [CONTROL 1] [CONTROL 2] knobs to adjust the depth of the effect that is applied.



• **[CONTROL 1] knob**

Adjusts the degree of extraction for the key.

• **[CONTROL 2] knob**

Adjusts the degree of edge blur for the key.

4. Press the [2] button.

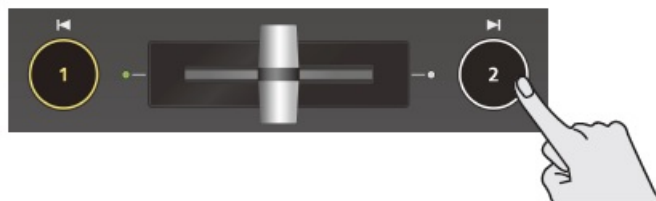

- The logo is composited with the background video, and output as the program. The [2] button is lit red.
- When you press the [2] button once again, the [2] button goes dark and the logo disappears.

MEMO

- The fade time over which the logo appears or disappears when you press the [2] button is specified by the setting of the TRANSITION menu item “KEY TIME”.
- You can also use the video fader to show or hide the logo.
- If the key-composited video is being output as the program, the KEY indicator is lit red.

Applying a Visual Effect to the Video (VFX)

Here's how you can apply an effect to the entire video, such as varying the video's color or shape. You can apply

a visual effect even while using picture-in-picture or key to composite the video.

Selecting a visual effect

1. Press the [MENU] button0“VFX”0select “VFX TYPE”, and press the [VALUE] knob.

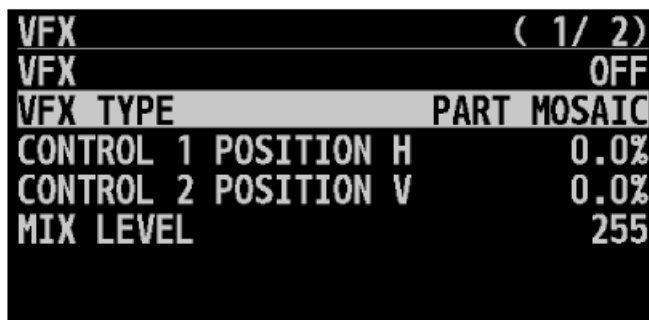

2. Turn the [VALUE] knob to select the visual effect, then press the [VALUE] knob.

Value	Explanation
PART MOSAIC	Applies a mosaic to the selected region.
BACKGROUND MOSAIC	Applies a mosaic to the portion outside the selected region.
FULL MOSAIC	Applies a mosaic to the entire screen.
WAVE	Makes the video wavy.
RGB REPLACE	Exchanges the colors.
COLORPASS	Turns the video black and white while preserving a specific color.
NEGATIVE	Inverts the brightness and colors.
COLORIZE	Adds color to the video.
POSTERIZE	Changes the gradations in brightness.
SILHOUETTE	Separates the video into light and dark areas, and makes the dark areas black and adds a different color to the light areas.
EMBOSS	Adds a bas-relief effect to the video.
FIND EDGES	Extracts contours.
MONOCOLOR	Turns the video monochrome.
HUE OFFSET	Changes the visual character by controlling the hue.
SATURATION OFFSET	Changes the visual character by controlling the saturation.
VALUE OFFSET	Changes the visual character by controlling the brightness.

3. Press the [MENU] button several times to close the menu.

Applying visual effects

1. Output the video to which you want to apply an effect.
2. Press the [VFX] button to turn on the visual effect (making the button light up).



- The visual effect is applied to the program output video.
3. Turn the [CONTROL 1] or [CONTROL 2] knob to adjust the degree of effect applied.



MEMO

- For “PART MOSAIC” and “BACKGROUND MOSAIC”, you can adjust the following settings by turning the [CONTROL 1] or [CONTROL 2] knob while pressing them.
 - **[CONTROL 1] knob**
Size of the selected region
 - **[CONTROL 2] knob**
Mosaic detail (block size)
 - Settings for the effect that is controlled by the [CONTROL 1] [CONTROL 2] knobs can be checked in the VFX menu.
4. To turn off a visual effect, press the [VFX] button once again.

USING THE UNIT SAFELY

WARNING

Concerning the Auto Off function

The power to this unit will be turned off automatically after a predetermined amount of time has passed since it was last used for playing music, or its buttons or controls were operated (Auto Off function). If you do not want the power to be turned off automatically, disengage the Auto Off function.

Secure a sufficient amount of space at the setup location

Since this unit normally emits a slight amount of heat, make sure to secure sufficient space around it, as shown below.

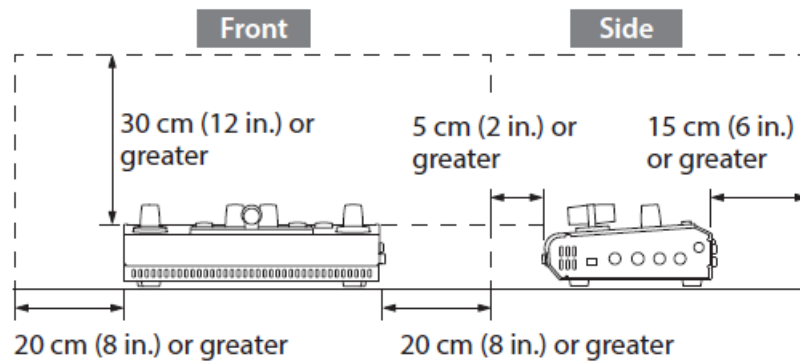

Use only the supplied AC adaptor and the correct voltage

Be sure to use only the AC adaptor supplied with the unit. Also, make sure the line voltage at the installation matches the input voltage specified on the AC adaptor's body. Other AC adaptors may use a different polarity, or be designed for a different voltage, so their use could result in damage, malfunction, or electric shock.

Use only the supplied power cord

Use only the attached power cord. Also, the supplied power cord must not be used with any other device.

CAUTION

Keep small items out of the reach of children

To prevent accidental ingestion of the parts listed below, always keep them out of the reach of small children.

- **Included Parts:** Cord hook
- **Removable Parts:** Screw

Handle the ground terminal carefully

If you remove the screw from the ground terminal, be sure to replace it; don't leave it lying around where it could accidentally be swallowed by small children. When refastening the screw, make that it is firmly fastened, so it won't come loose.

IMPORTANT NOTES

Power Supply

- If the unit has been used with a power supply that has not been specified as suitable for the unit, the subsequent performance and operation of the unit can no longer be guaranteed. Also note that we may not be able to accept the unit for servicing and repairs.
- Place the AC adaptor so the side with the indicator faces upwards and the side with textual information faces downwards. The indicator will light when you plug the AC adaptor into an AC outlet.

Placement

Depending on the material and temperature of the surface on which you place the unit, its rubber feet may discolor or mar the surface.

Repairs and Data

Before sending the unit away for repairs, be sure to make a backup of the data stored within it; or you may prefer to write down the needed information. Although we will do our utmost to preserve the data stored in your unit when we carry out repairs, in some cases, such as when the memory section is physically damaged, restoration of the stored content may be impossible. Roland assumes no liability concerning the restoration of any stored content

that has been lost.

Additional Precautions

- Any data stored within the unit can be lost as a result of equipment failure, incorrect operation, etc. To protect yourself against the irretrievable loss of data, try to make a habit of creating regular backups of the data you've stored in the unit.
- Roland assumes no liability concerning the restoration of any stored content that has been lost.
- This unit allows you to switch images at high speed. For some people, viewing such images can cause headaches, nausea, or other discomfort. Do not use this unit to create videos that might cause these types of health problems. Roland Corporation will accept no responsibility for any such health problems that may occur in yourself or in viewers.
- Do not use connection cables that contain a built-in resistor.
- This document explains the specifications of the product at the time that the document was issued. For the latest information, refer to the Roland website.

Intellectual Property Right

- It is forbidden by law to make an audio recording, video recording, copy, or revision of a third party's copyrighted work (musical work, video work, broadcast, live performance, or other work), whether in whole or in part, and distribute, sell, lease, perform or broadcast it without the permission of the copyright owner.
- Do not use this product for purposes that could infringe on a copyright held by a third party. We assume no responsibility whatsoever with regard to any infringements of third-party copyrights arising through your use of this product.
- This product can be used to record or duplicate audio or visual material without being limited by certain technological copy-protection measures. This is due to the fact that this product is intended to be used for the purpose of producing original music or video material, and is therefore designed so that material that does not infringe copyrights belonging to others (for example, your own original works) can be recorded or duplicated freely.
- Roland is either a registered trademark or trademark of Roland Corporation in the United States and/or other countries.
- Company names and product names appearing in this document are registered trademarks or trademarks of their respective owners.

© 2021 Roland Corporation.

Documents / Resources

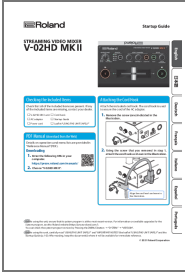

[Roland V-02HD MK II Multi Format Live Streaming Video](#) [pdf] User Guide
V-02HD MK II Multi Format Live Streaming Video, V-02HD MK II, Multi Format Live Streaming Video, Format Live Streaming Video, Live Streaming Video, Streaming Video, Video

References

- [User Manual](#)