



Roland TD-27 Drum Sound Module User Guide

[Home](#) » [Roland](#) » Roland TD-27 Drum Sound Module User Guide 

Roland TD-27 Drum Sound Module User Guide



Contents

- 1 ASSEMBLE INSTRUCTION ‘
- 2 Main Specifications
- 3 Panel Descriptions
- 4 Connect Your Equipment
- 5 Side Panel
- 6 Settings for pads that support digital connection
- 7 Getting Ready
- 8 Turning the Power On/Off
- 9 Turning the Power On
- 10 Turning the Power Off
- 11 Making Hi-Hat Settings
- 12 Settings for the VH-14D
- 13 Settings for the VH-13
- 14 Settings for the VH-10 / VH-11
- 15 About Performance Techniques
- 16 Selecting a Drum Kit
- 17 Selecting a Drum Kit
- 18 Performing Along with a Song
- 19 Registering the smartphone (pairing)
- 20 Performing Along with a Song
- 21 Audio files that can be played by the TD-27
- 22 Documents / Resources
 - 22.1 References
- 23 Related Posts

ASSEMBLE INSTRUCTION ‘

Quick Start (this document)

This explains basic use of the TD-27, such as playing the drums and practicing.



PDF Manuals (download from the web)

- **Reference Manual**

In addition to the content of this document, this explains all the functionality of the TD-27, such as functions for live performance and for recording.

- **Data List**

This explains all of the TD-27's parameters and how to edit them.

- **MIDI Implementation**

This is detailed information about MIDI messages that you can use when connecting the TD-27 with MIDI devices.



Video Manual

You can view a quick start video.



To obtain the PDF manuals

1. Enter the following URL in your computer. <https://www.roland.com/support/>



2. Search for TD-27.
3. Download the manual as directed by the screen.



To access the “Video Manual”



<http://roland.cm/td-27qs>

Before using this unit, carefully read “USING THE UNIT SAFELY” and “IMPORTANT NOTES” (the leaflet “USING THE UNIT SAFELY” and the Owner’s Manual (p. 30). After reading, keep the document(s) where it will be available for immediate reference.

Main Specifications

Drum Kits	100 (Preset: More than 50)
Instruments	More than 700
User Sample Import	Number of User Sample: Maximum 500 (includes factory preloaded user samples) Sound Length (total): 24 minutes in mono, 12 minutes in stereo File formats that can be loaded: WAV (44.1 kHz, 16/24 bits)
Effect Types	Pad Compressor: each pad Pad Equalizer: each pad Overhead Mic Simulator Room/Reverb Multi-Effects: 3 systems, 30 types Master Compressor and Master Equalizer
Bluetooth	Supported standards: Bluetooth Ver 4.2 Supported profile: A2DP (Audio), GATT (MIDI over Bluetooth Low Energy) Codec: SBC (Support to the content protection of the SCMS-T method)
Song Player (SD Card)	File format: WAV (44.1 kHz, 16/24 bits), MP3*1
Recorder	Recording Method: Realtime Maximum length: 60 min (temporary recording: 3 min) *2 File format: WAV (44.1 kHz, 16 bits)
Display	Graphic LCD 256 x 80 dots
Power Supply	AC adaptor (DC 9 V)

This document explains the specifications of the product at the time that the document was issued. For the latest information, refer to the Roland website.

Current Draw	770 mA
Dimensions	238 (W) x 204 (D) x 79 (H) mm 9-3/8 (W) x 8-1/16 (D) x 3-1/8 (H) inches
Weight (excluding AC adaptor)	1.1 kg / 2 lbs 7 oz
Accessories	Quick Start Leaflet "USING THE UNIT SAFELY" AC adaptor Dedicated connection cable Sound module mounting plate Wing bolt (M5 x 10) x 2
Options(sold separately)	Pads: PD series, PDX series, BT series Cymbals: CY series Kick: KD series, KT series Hi-hat: VH-14D, VH-13, VH-11, VH-10 Hi-hat control pedal: FD series Acoustic drum trigger: RT series Footswitch: BOSS FS-5U, FS-6 Personal drum monitor: PM series Noise eater: NE series

Audio files must be saved on an SD card.

Song recording is required SD card. The case of no inserted is capable to record the temporary recording approximately 3 minutes.

Panel Descriptions

Display

This shows various information depending on the operation. A short time after you turn on the power, the DRUM KIT screen (basic screen) appears. &“Selecting a Drum Kit” (p. 13) Function button ([F1]–[F5]) The function of these buttons will change depending on the screen. The names of the current functions are shown in the bottom of the screen.

button

This button record your performance. &“Recording” (p. 19) [s] button Plays/stops the built-in song or recorded performance data, or starts/stops recording. &“Performing Along with a Song” (p. 14) &“Recording” (p. 19)

[SONG] button

Lets you make song-related settings, such as demo performances or backing (accompaniment) songs. &“Performing Along with a Song” (p. 15)

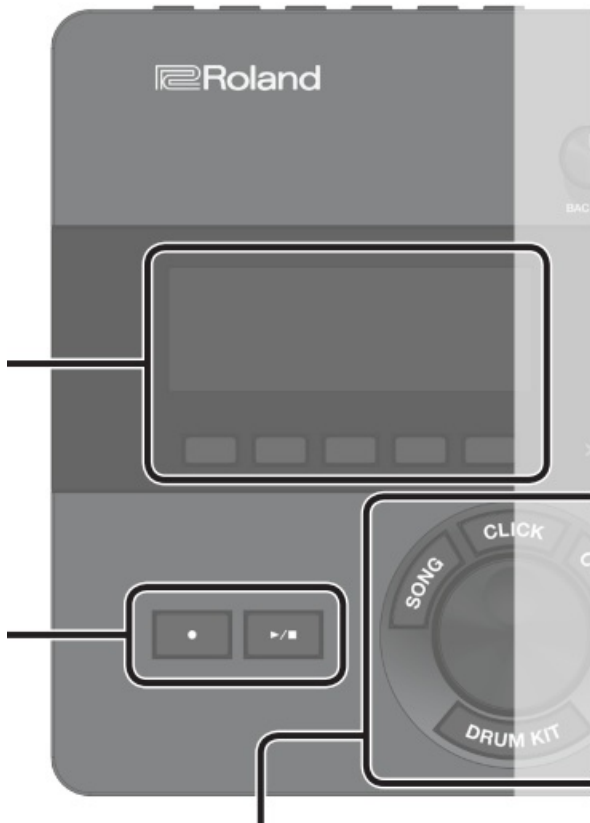

[Drum KIT] button

Accesses the basic screen where you can select drum set sounds (drum kits). You can also press this to return to the basic screen from another screen. &“Selecting a Drum Kit” (p. 13)

[CLICK] button

Allows you to sound the click (metronome), or to make settings for the tempo or beat. &“Sounding a Click (Metronome)” (p. 16) [COACH] button Lets you use the coach menu to practice drums in a way that's appropriate for your performance skill level.

Dial

In the DRUM KIT screen (basic screen), turn the dial to select drum set sounds (drum kits). This is also used to change the value of the parameter selected by the cursor buttons.

[COACH] button

Lets you use the coach menu to practice drums in a way that's appropriate for your performance skill level. &“Practicing in Coach Mode” (p. 16)

[BACKING] knob

Adjusts the volume of the built-in song or the click (metronome), and the volume of a smartphone connected to the

MIX IN jack or via Bluetooth.

&“Performing Along with a Song” (p. 14)

&“Sounding a Click (Metronome)” (p. 16)

[PHONES] knob : Adjusts the volume of headphones connected to the PHONES jack.)

[MASTER] knob

Adjusts the volume of amplified speakers etc. connected to the MASTER OUT jacks. Sound modify knob

([INSTRUMENT], [LEVEL], [TUNING], [MUFFLING])

Select the sound (instrument) of a pad, adjust the volume (level) or pitch (tuning) of the selected instrument, or adjust the decay length (muffling). &“Editing a Drum Kit” (p. 21)

Bluetooth indicator

The LED indicates the Bluetooth connection status. You can wirelessly connect a smartphone or other device, and play the drums while a song plays back from your smartphone.

Unlit	Bluetooth is not connected
Blinking	Pairing is in progress
Lit	Bluetooth audio is connected* Rapidly blinks several times when connecting or disconnecting.

&“Performing Along with a Song from Your Smartphone” (p. 14) &“Recording Your Performance Along with a Song” (p. 19) * If you are using TD-27 connected with a smartphone app, the appearance of the indicator will be different. For details, refer to “Reference Manual” (PDF).

[KIT EDIT] button

You can shape the sound in various ways, such as customizing the drum itself by changing the type of head or the shell depth, or by adjusting the reverberation. &“Editing a Drum Kit” (p. 21)

[EXIT] button

Cancels an operation. Alternatively, returns to the previous screen.

[USER SAMPLE] button

Audio files that you created on your computer can be imported into the TD-27, and played as instrument.

&“Importing and Playing A

Dial

In the DRUM KIT screen (basic screen), turn the dial to select drum set sounds (drum kits). This is also used to change the value of the parameter selected by the cursor buttons.

[COACH] button

Lets you use the coach menu to practice drums in a way that’s appropriate for your performance skill level.

&“Practicing in Coach Mode” (p. 16)

[BACKING] knob

Adjusts the volume of the built-in song or the click (metronome), and the volume of a smartphone connected to the MIX IN jack or via Bluetooth.

&“Performing Along with a Song” (p. 14)

&“Sounding a Click (Metronome)” (p. 16)

[PHONES] knob

Adjusts the volume of headphones connected to the PHONES jack.

[MASTER] knob

Adjusts the volume of amplified speakers etc. connected to the MASTER OUT jacks.

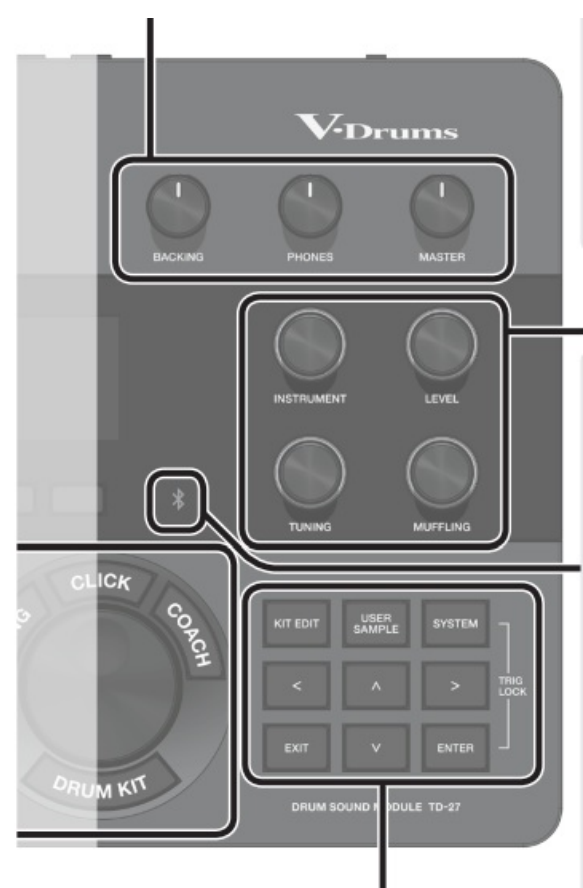

Sound modify knob

([INSTRUMENT], [LEVEL], [TUNING], [MUFFLING])

Select the sound (instrument) of a pad, adjust the volume (level) or pitch (tuning) of the selected instrument, or adjust the decay length (muffling). &“Editing a Drum Kit” (p. 21)

Bluetooth indicator

The LED indicates the Bluetooth connection status. You can wirelessly connect a smartphone or other device, and play the drums while a song plays back from your smartphone.

Unlit	Bluetooth is not connected
Blinking	Pairing is in progress
Lit	Bluetooth audio is connected* Rapidly blinks several times when connecting or disconnecting.

&“Performing Along with a Song from Your Smartphone” (p. 14)

&“Recording Your Performance Along with a Song” (p. 19)

If you are using TD-27 connected with a smartphone app, the appearance of the indicator will be different. For details, refer to “Reference Manual” (PDF).

[KIT EDIT] button

You can shape the sound in various ways, such as customizing the drum itself by changing the type of head or the shell depth, or by adjusting the reverberation. &“Editing a Drum Kit” (p. 21)

[EXIT] button

Cancels an operation. Alternatively, returns to the previous screen.

[USER SAMPLE] button

Audio files that you created on your computer can be imported into the TD-27, and played as instrument. &“Importing and Playing Audio Files (USER SAMPLE)” (p. 23)

Cursor buttons [][][]

Move the on-screen cursor up/down/ left/right to select a parameter.

[SYSTEM] button

Lets you make system settings for the TD-27. &“Various Settings (SYSTEM)” (p. 25)

[ENTER] button

Confirms an operation or value. Alternatively, proceeds to the next screen.

By holding down the [ENTER] button and pressing the [SYSTEM] button, you can lock the pad you’re editing so that it will not be switched (Trig Lock function).

Connect Your Equipment***Rear Panel***

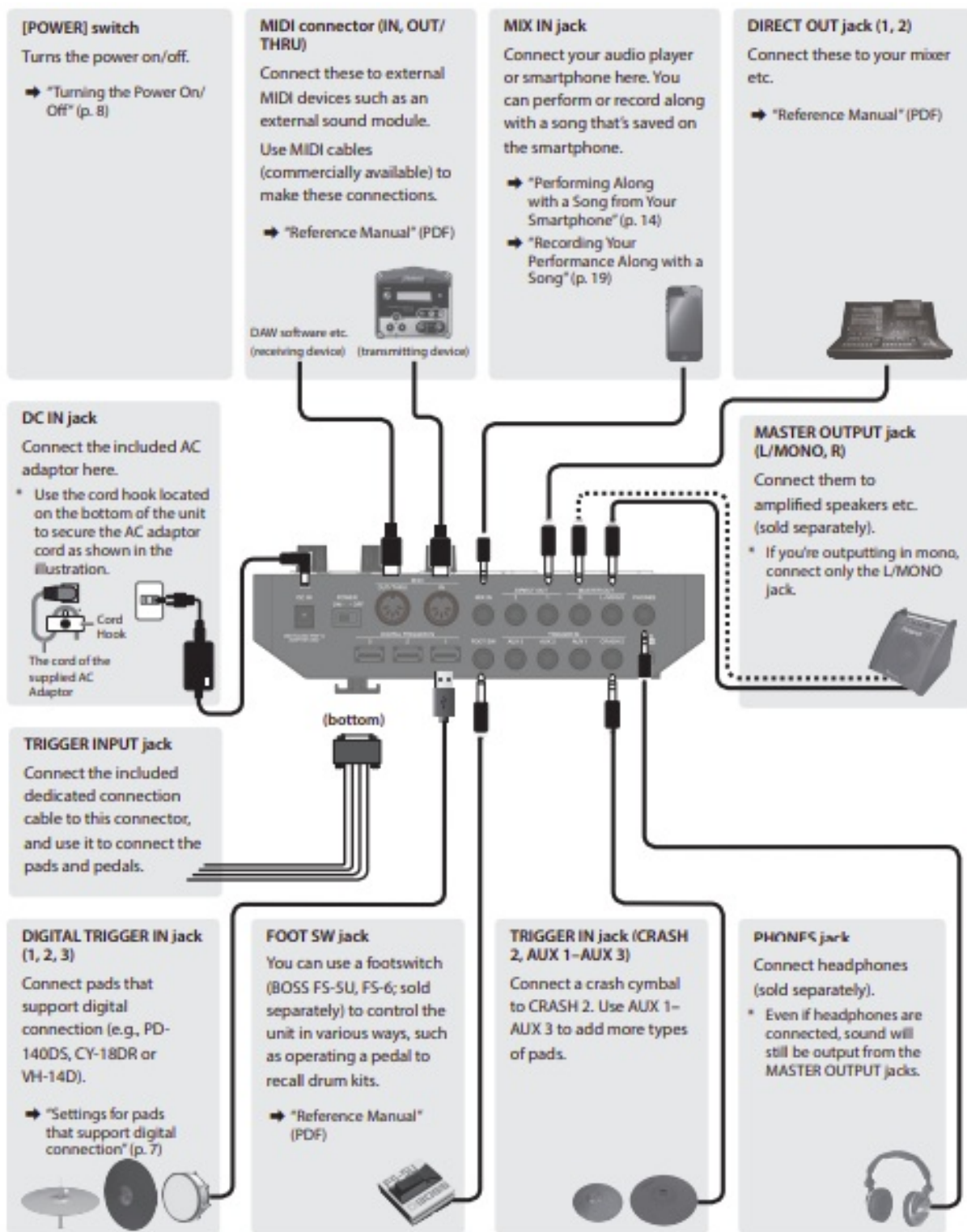

Side Panel



SD CARD slot

Insert a commercially available SD card (SDHC cards (up to 32 GB) are supported).

You can use an SD card to store songs for backing (accompaniment) or to store settings of the TD-27 itself. You can also use it to import user samples and or save performance data that you recorded.

- Formatting an SD Card” (p. 25)
- Performing Along with a Song” (p. 15)
- Recording” (p. 19)
- Importing and Playing Audio Files (USER SAMPLE)” (p. 23)
- Backing Up Data” (p. 26)
- Before using an SD card for the first time, you must format it on the TD-27 (p. 25).
- Never turn off the power or remove the SD cards while the screen indicates “Processing...” or ”Now Saving...”.
- Some SD card types or SD cards from some manufacturers may not record or play back properly on the unit.

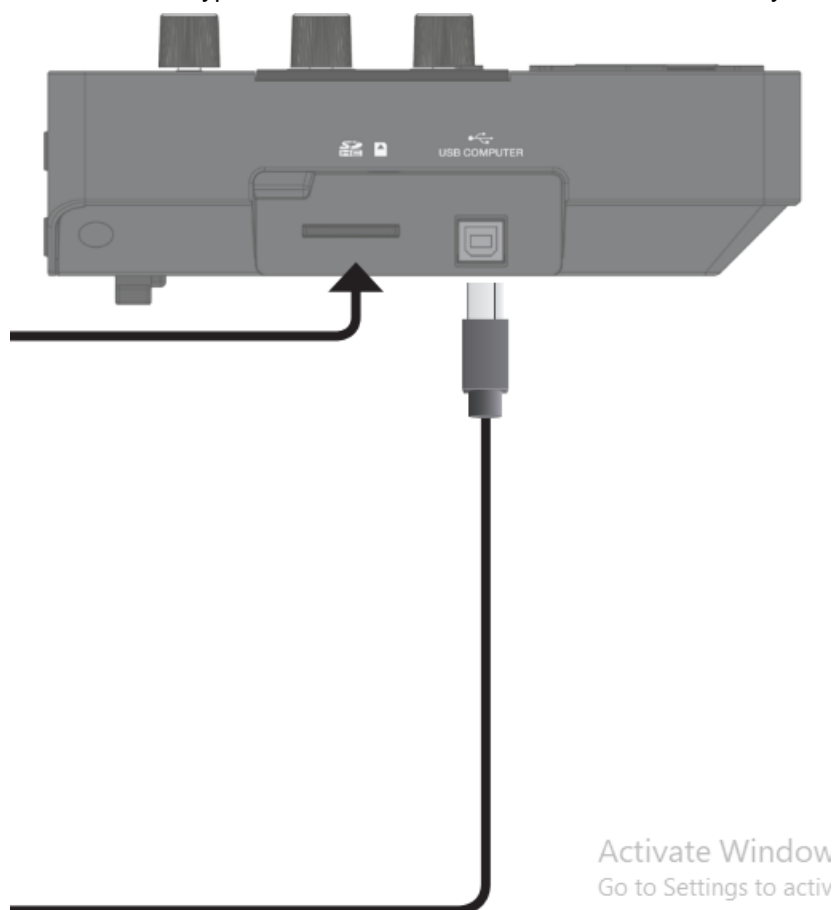

USB COMPUTER port

Connect this to your computer. Use a USB cable (commercially available) to make this connection. You can use DAW software (commercially available) to record a TD-27 performance as audio or MIDI, or you can use the TD-27 to hear sound that's played back from the computer. &“Reference Manual” (PDF)

Settings for pads that support digital connection

The first time that a pad that supports digital connection is connected to a DIGITAL TRIGGER IN port, the following screen appears. Following the instructions in the screen, make settings to specify the trigger input to which the connected pad should be assigned.

- If you specify the same trigger input as a pad that is connected to a dedicated connection cable or TRIGGER IN jack, the pad that's connected to that TRIGGER INPUT jack and TRIGGER IN jack won't produce sound.



1. Use the cursor buttons to select "OK", and press the [ENTER] button.

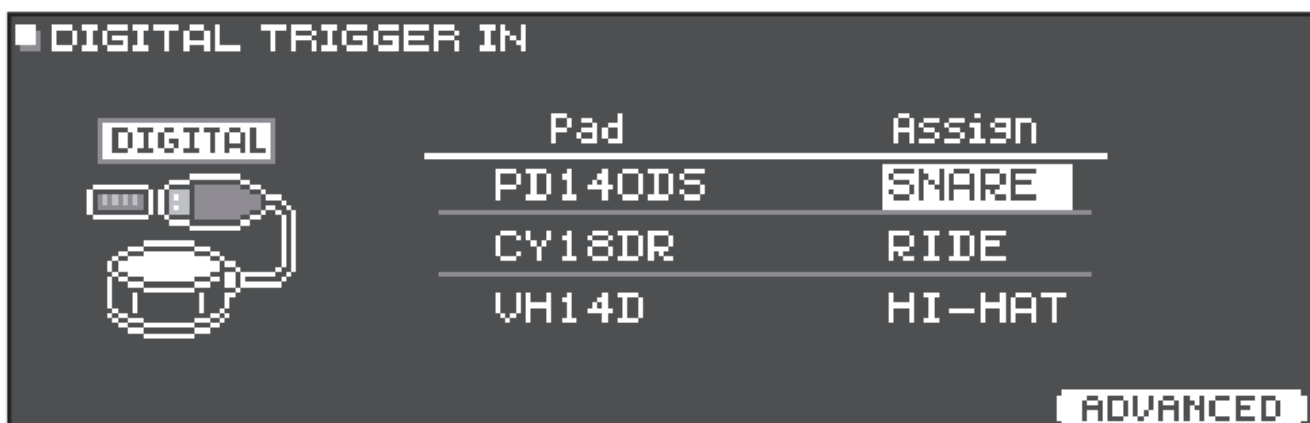

2. Use the cursor buttons to select the pad that you want to specify, and use the dial to specify the Assign.
 - You can't specify the same assignment multiple times Setting example

Pad	Assign
PD140DS	SNARE
CY18DR	RIDE
VH14D	HI-HAT

3. Press the [DRUM KIT] button to return to the DRUM KIT screen.

Getting Ready

Mounting the TD-27 on the Stand

Use the included sound module mounting plate to attach the TD-27 to a drum stand (e.g., MDS Series; sold separately). Use the included wing bolts to attach the plate as shown in the illustration.

- Use only the included wing bolts. Using any other bolts will cause malfunctions.
- When turning the unit over, be careful so as to protect the buttons and knobs from damage. Also, handle the unit carefully; do not drop it.

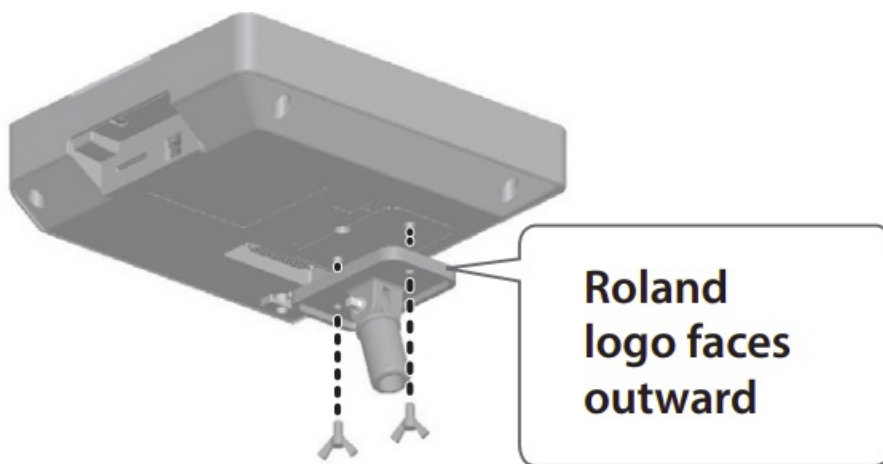

MEMO

The All Purpose Clamp (APC-33; sold separately) can be attached to a pipe of 10.5–28.6 mm radius in case you want to mount the TD-27 on a cymbal stand or other such stand.

Turning the Power On/Off

Before turning the unit on/off, always be sure to turn the volume down. Even with the volume turned down, you might hear some sound when switching the unit on/off. However, this is normal and does not indicate a malfunction.

Turning the Power On

Connect headphones (sold separately) or amplified speakers (sold separately) to the TD-27.

* If amplified speakers are connected, minimize the volume of the amplified speakers.

On the TD-27's rear panel, turn the [POWER] switch ON. When you turn the TD-27 on, the following screen appears.

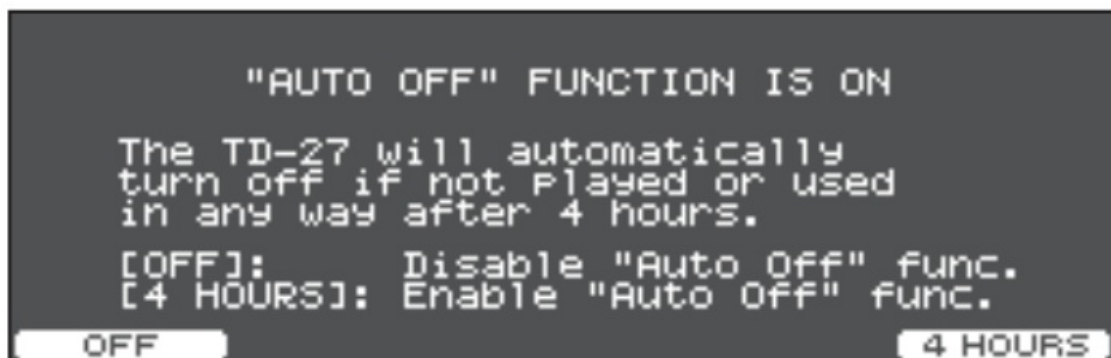

In this screen you can make settings to specify whether the power will automatically turn off after a predetermined amount of time (AUTO OFF function).

Button	Explanation
[F1] (OFF)	The power does not turn off automatically.
[F5] (4 HOURS)	When four hours have passed without any pad being struck or any operation being performed, the unit will turn off automatically.

- If the AUTO OFF function is set to “OFF”, this screen won’t appear.
- The power to this unit will be turned off automatically after a predetermined amount of time has passed since it was last used for playing music, or its buttons or controls were operated (AUTO OFF function). If you do not want the power to be turned off automatically, disengage the AUTO OFF function (p. 27). To restore power, turn the power on again.

If amplified speakers are connected, turn on the power of the amplified speakers.

Use the [PHONES] knob to adjust the volume of the headphones, and use the [MASTER] knob to adjust the volume of the amplified speakers.

Turning the Power Off

NOTE

Settings that you edit on the TD-27 are saved when you turn off the unit. Be sure to turn off the unit by turning the [POWER] switch.

If amplified speakers are connected to the TD-27, minimize the volume of amplified speakers and turn off their power.

Turn the TD-27’s [POWER] switch OFF. The screen will indicate “Please wait. Now saving...”, and the unit will turn off when the settings have been saved.

Making Hi-Hat Settings

If you’re using the hi-hat (VH-14D, VH-13 or VH-10/VH-11), adjust the offset on the TD-27. This adjustment is required for hi-hat pedal movements such as open or close to be detected correctly. & If you want to make fine adjustments to the hi-hat sensitivity etc., refer to “Reference Manual” (PDF).

Settings for the VH-14D

1. Press the [SYSTEM] button.
2. Use the cursor buttons to select “TRIGGER”, and then press the [ENTER] button.
3. Use the cursor buttons to select “HI-HAT”, and then press the [ENTER] button. The TRIGGER HI-HAT screen appears.

“VH-14D” is not shown as a Trig Type when the VH-14D is not connected or if it is not assigned as the hi-hat. In this case, connect the VH-14D and assign it as the hi-hat.

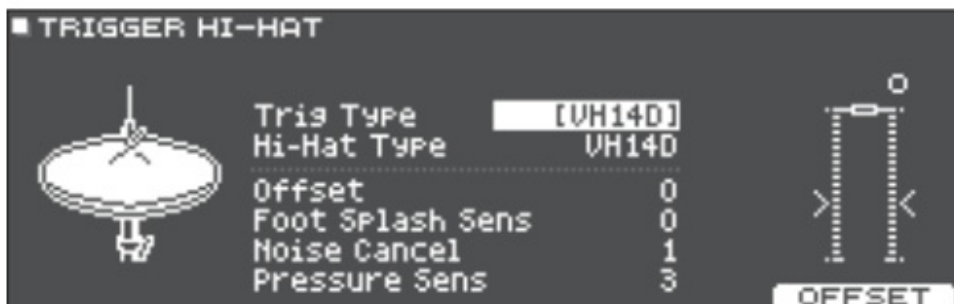

4. Press the [F5] (OFFSET) button.

The VH OFFEST ADJUSTMENT screen appears.

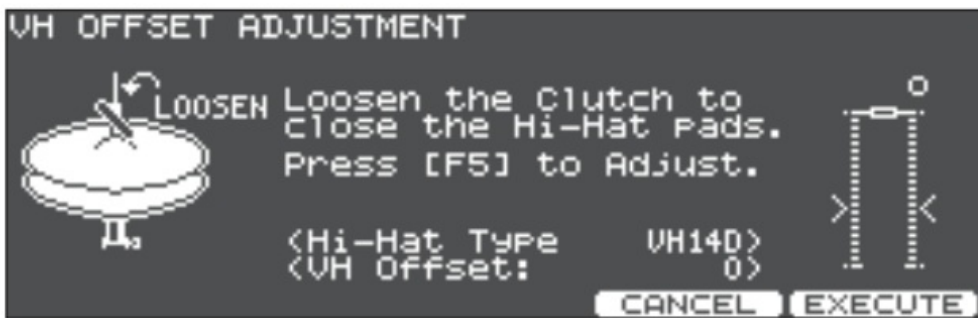

5. Loosen the clutch screw of the top cymbal and let it sit on the bottom cymbal. * Do NOT touch the hi-hats or the pedal.

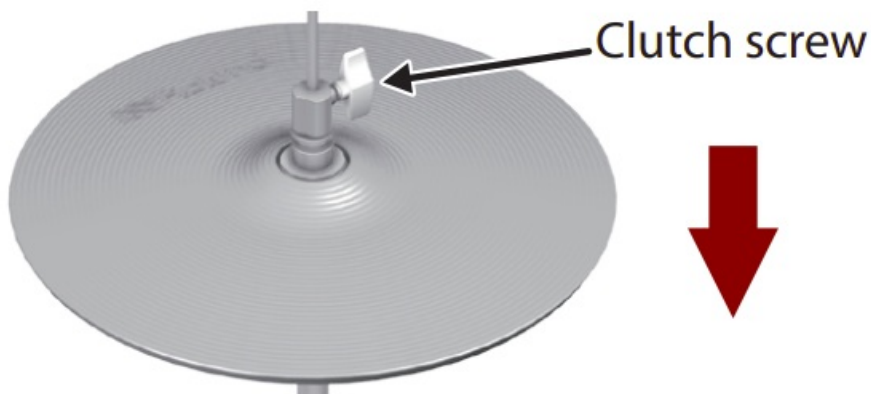

6. Press the [F5] (EXECUTE) button.

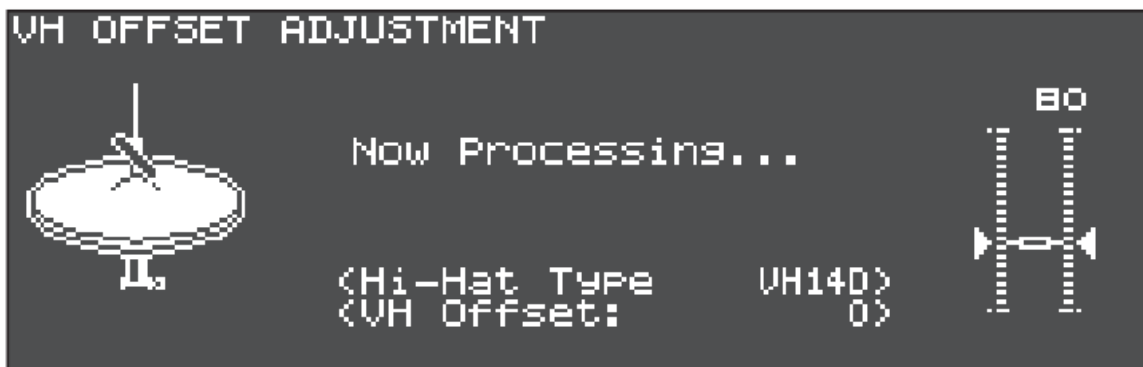

The "VH

Offset" parameter is set automatically (approx. 3 seconds).

7. Press the [KIT] button to return to the DRUM KIT screen.

Settings for the VH-13

1. Press the [SYSTEM] button.
2. Use the cursor buttons to select "TRIGGER", and press the [ENTER] button.
3. Use the cursor buttons to select "HI-HAT", and press the [ENTER] button. The TRIGGER HI-HAT screen appears.

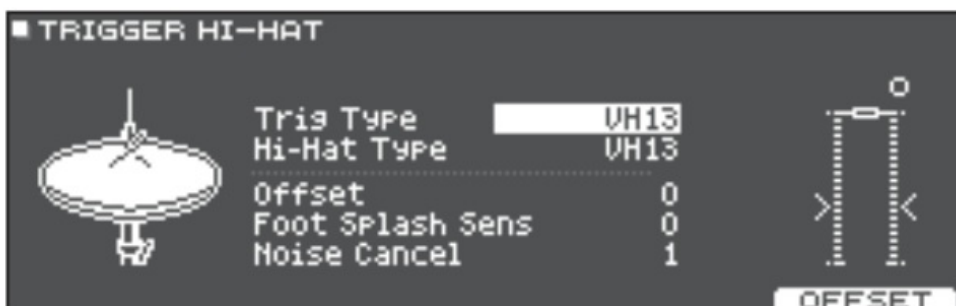

4. Use the dial to set the Trig Type to “VH13”.
5. Press the [F5] (OFFSET) button. The VH OFFSET ADJUSTMENT screen appears
6. Loosen the clutch screw of the top hi-hat and let it sit on the bottom hi-hat.
Do NOT touch the hi-hats or the pedal.

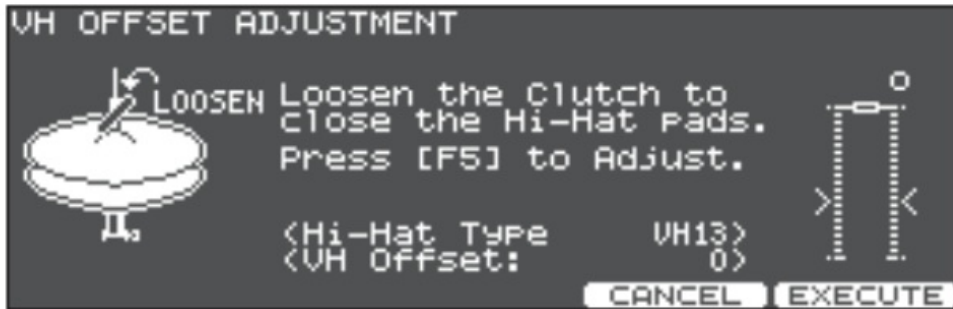

7. Press the [F5] (EXECUTE) button.



The “VH Offset” parameter is set automatically (approx. 3 seconds).

8. Press the [DRUM KIT] button to return to the DRUM KIT screen.

Settings for the VH-10 / VH-11

1. . With the hi-hat completely separated from the motion sensor unit, power-on the TD-27.

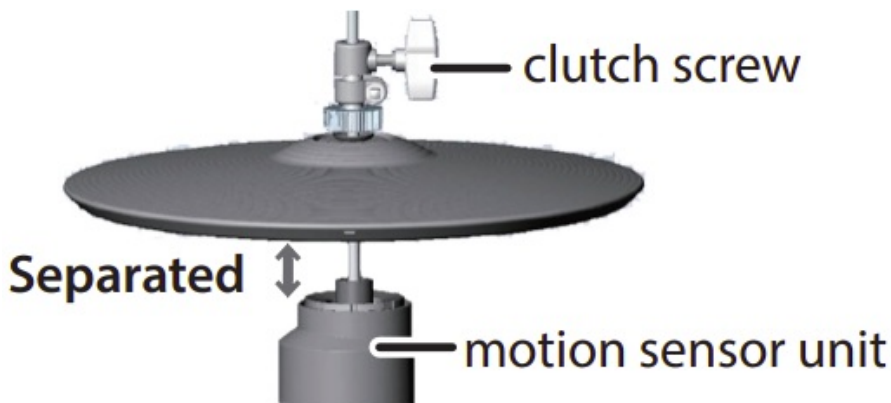

2. . Loosen the clutch screw and let the hi-hat rest naturally on the motion sensor unit.
3. Press the [SYSTEM] button.
4. Use the cursor buttons to select “TRIGGER”, and press the [ENTER] button.
5. **Use the cursor buttons to select “HI-HAT”, and press the [ENTER] button.**
The TRIGGER HI-HAT screen appears.

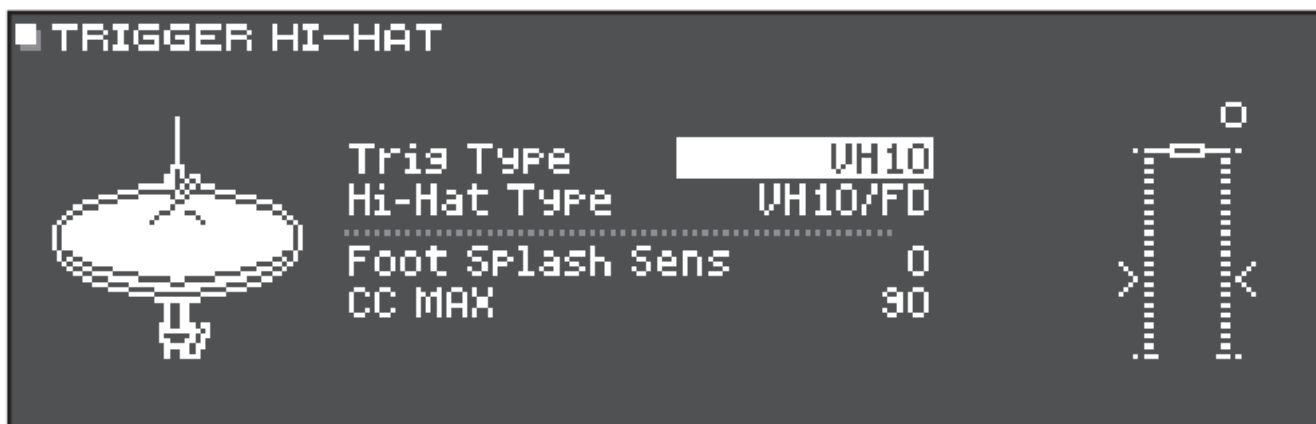

6. Use the dial to set the Trig Type to "VH10".

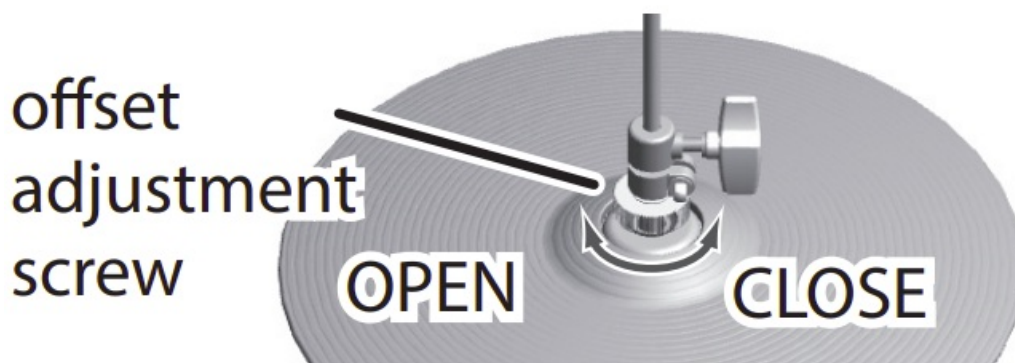

7. While reading the meter displayed on the right side of the TD-27's screen, adjust the offset with the VH-10's offset adjustment screw.

Adjust the offset so that the appear in the meter.

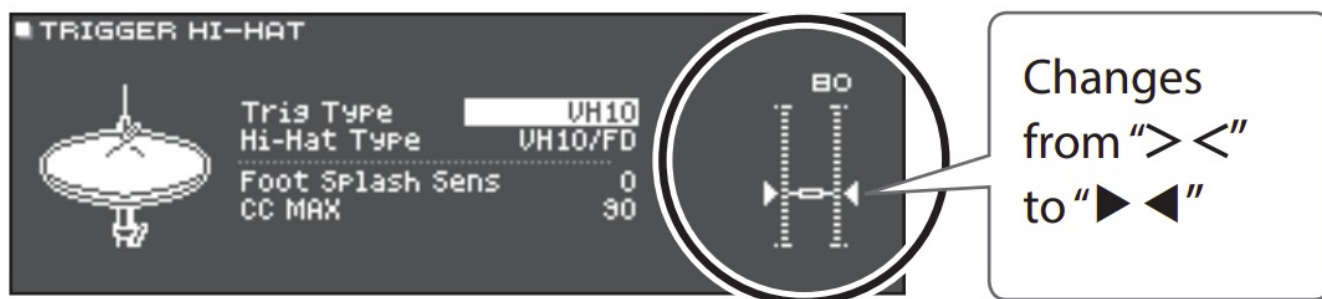

8. Fasten the clutch screw at a position where the hi-hat sways naturally when struck.
9. Press the [DRUM KIT] button to return to the DRUM KIT screen.

About Performance Techniques

The TD-27 lets you use various performance techniques just as on acoustic drums.

NOTE

- Use only wooden or plastic sticks. Using a carbon or metal stick may cause the sensor to malfunction.
- Use nylon brushes. Using metal brushes may cause the sensor to malfunction, and may scratch the pad.

Rim shot

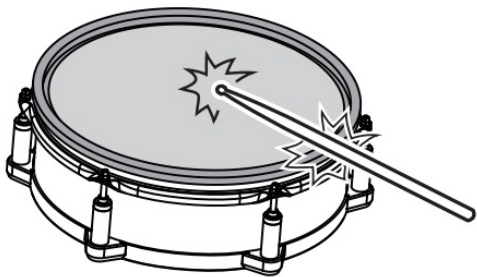

Strike the head and the rim of the pad simultaneously. A sound (rim sound) different than the head shot will be heard.

Cross stick



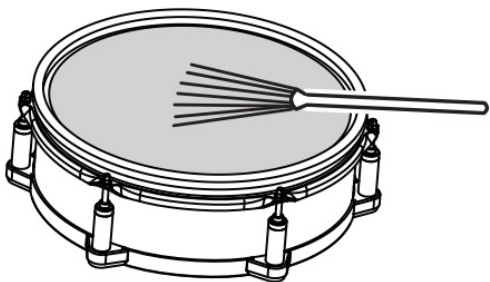

Strike the rim while placing your hand on the head. Snare sounds can produce different sounds in response to different playing techniques; for example they can produce a rim sound when played using a rim shot, or a cross-stick sound when played using a cross-stick technique. Either connect a pad that supports the rim shot to “SN” of the dedicated connection cable, or connect a pad (such as the PD-140DS) that supports digital connection and allows cross-stick playing technique, and assign it to snare. * On units other than the PD-140DS, strike only the rim so as not to touch the head.* On some snare sounds, it might not be possible to play separate sounds in this way.

Playing with brushes

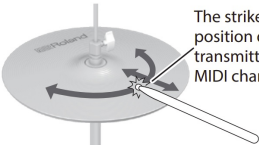
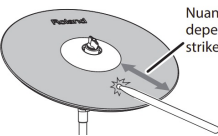
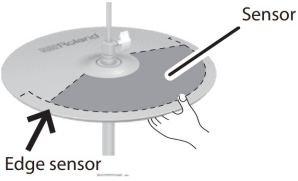

You can use brushes to scrape the head (brush sweep). Either connect a pad with a mesh head to “SN” of the dedicated connection cable, or connect a pad (such as the PD-140DS) that supports digital connection and allows brush playing technique, and assign it to snare. In addition, assign an instrument that supports brush techniques to the head of the snare, and turn the Brush Switch “ON”. & For details, refer to “Reference Manual” (PDF).

Playing method	Explanation
<p>Open/closed</p> 	<p>The hi-hat tone changes smoothly from open to closed in response to how far the pedal is pressed. You can also play a foot-close sounded by pressing the pedal, or a foot-splash sounded by pressing the pedal and then immediately opening it. Depending on the instrument, you can also express the tonal change that occurs when you strike in the closed position and then open immediately.</p>
<p>Pressure(VH-14D, VH-13)</p> 	<p>When you strike the hi-hat while pressing on the pedal with the hi-hat closed, you can then change the closed tone in response to the pressure you place on the pedal.* The VH-10, VH-11, FD-9, and FD-8 do not respond to pressure.</p>
<p>Bow shot</p>	 <p>The strike position data transmitted via MIDI changes.</p> <p>This playing method involves striking the middle area of the top hi-hat. It corresponds to the sound of the “head-side” of the connected trigger input. If you are using a pad that distinguishes between where you strike it (such as the VH-14D), the strike position data transmitted via MIDI changes, depending on what part of the bow you strike.* This does not make the sound change.</p>
<p>Edge shot</p>	 <p>Nuance changes depending on the strike location</p> <p>This playing method involves striking the edge of the top hi-hat with the shoulder of the stick. When played as shown in the illustration, the “rim-side” sound of the connected trigger input is triggered. If you are using a pad that distinguishes between where you strike it (such as the VH-14D), the strike position data transmitted via MIDI changes, depending on what part of the edge you strike.* This does not make the sound change.* Striking directly on the edge (i.e., exactly from the side) will not produce the correct sound. Strike as shown in the illustration.</p>
<p>Choke play</p>	 <p>Edge sensor</p> <p>Sensor</p> <p>If you use your hand to choke (grasp) the edge sensor after striking the cymbal, the sound stops. With the VH-14D, the sound stops (is muted) even if you simply place your hand on the sensor detection area. When you strike the cymbal in the choked state, the sound is shorter.</p>

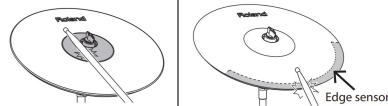
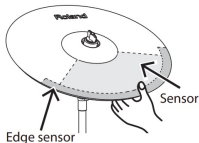
Edge shot		This playing method involves striking the edge with the shoulder of the stick. When played as shown in the illustration, the “rim-side” sound of the connected trigger input is triggered.	
Bell shot		This is the method of striking the bell. When the bell area shown in the illustration is struck, the bell sound is heard. Either connect a pad that supports ride three-way triggering to “RD” and “RDB” of the dedicated connection cable, or connect a pad (such as the CY-18DR) that supports digital connection and allows bell shot playing technique, and assign it to ride.	
Choke play	Edge sensor		If you use your hand to choke (grasp) the edge sensor after striking the cymbal, the sound stops. On the CY-18DR, placing your hand on the sensor will also stop the sound. When you strike the cymbal in the choked state, the sound is shorter.

Selecting a Drum Kit

What Are “Drum Kits” and “Instruments”?

On the TD-27, a set of drums is called a “drum kit”. The sounds that play when you strike each pad of the drum kit are called “instruments”. The illustration below shows the structure of a drum kit.

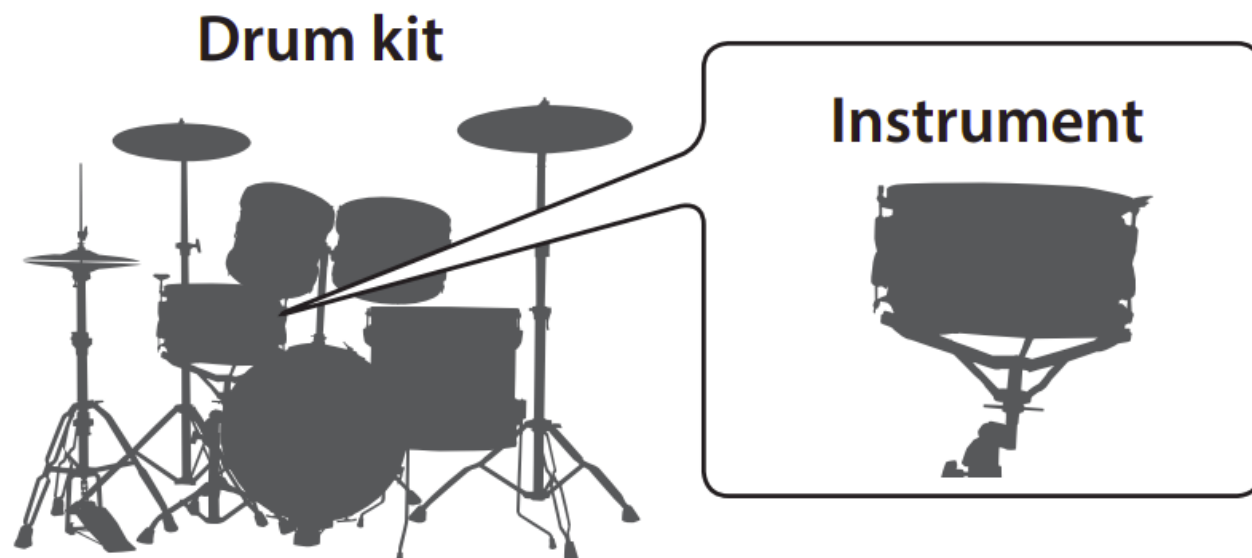

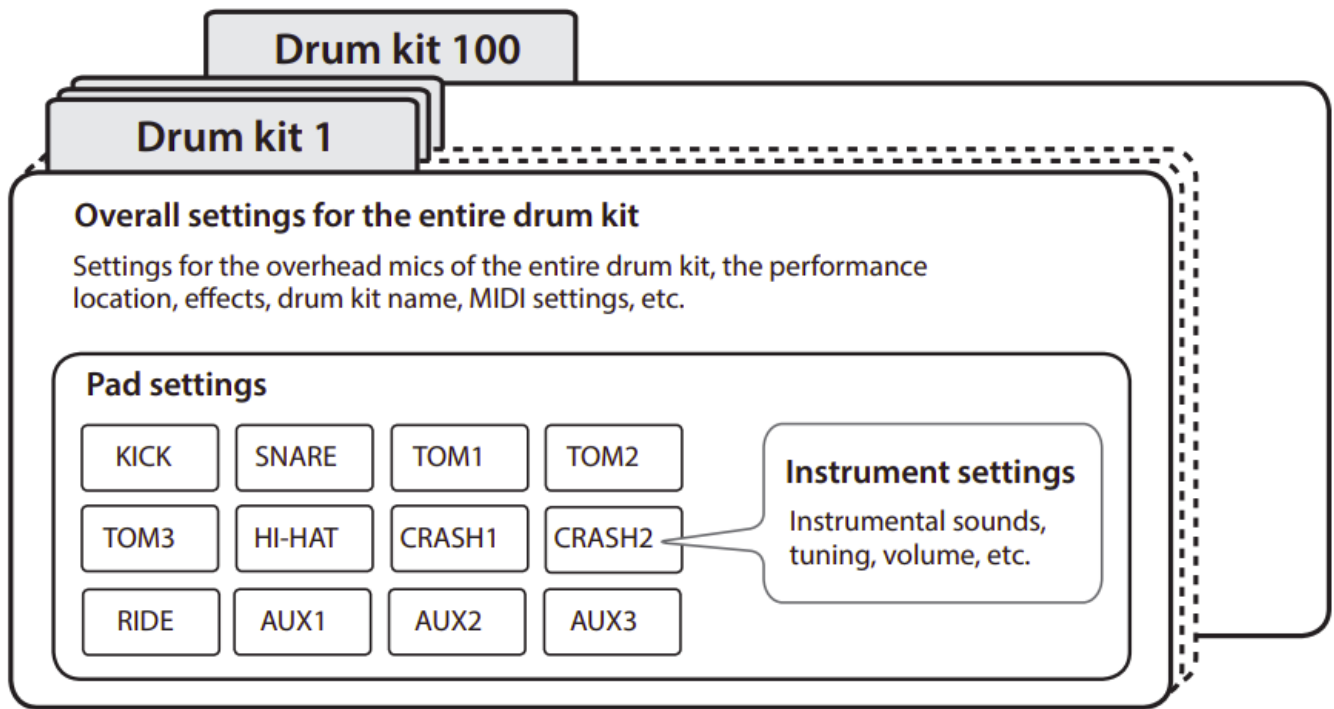

Selecting a Drum Kit

The TD-27 lets you enjoy performing with a drum kits that are suitable for a variety of musical genres.

Press the [DRUM KIT] button.

The DRUM KIT screen appears. Depending on the settings, this screen shows the following content.

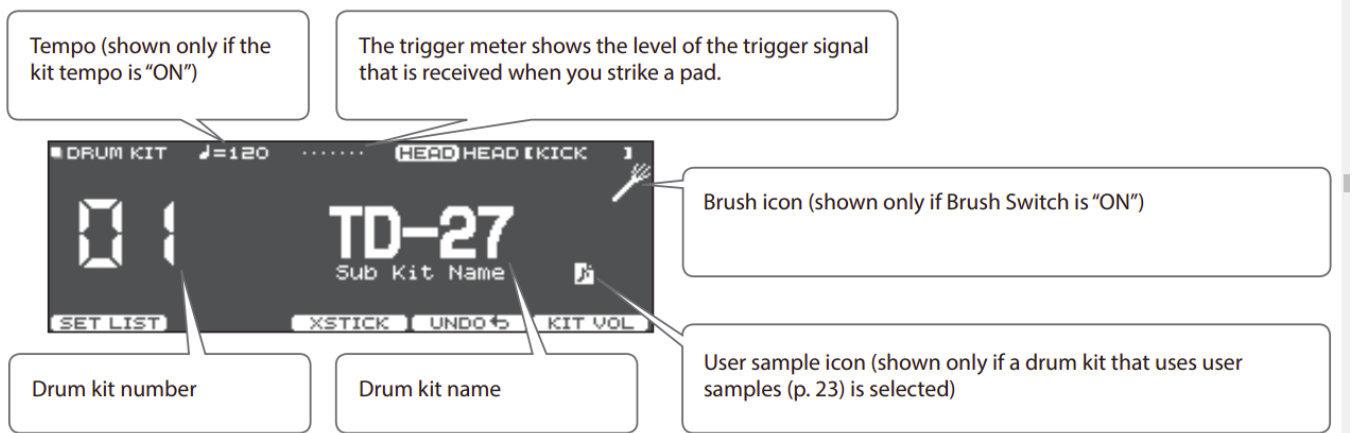

Use the dial to select a drum kit.

Reference

For a list of the drum kits, refer to "Data List" (PDF).

Cross-Stick function

Pads that are connected to a TRIGGER INPUT jack Each time you press the [F3] (XSTICK) button, you'll switch between sounding and not sounding the cross-stick sound (p. 11) from the snare pad.

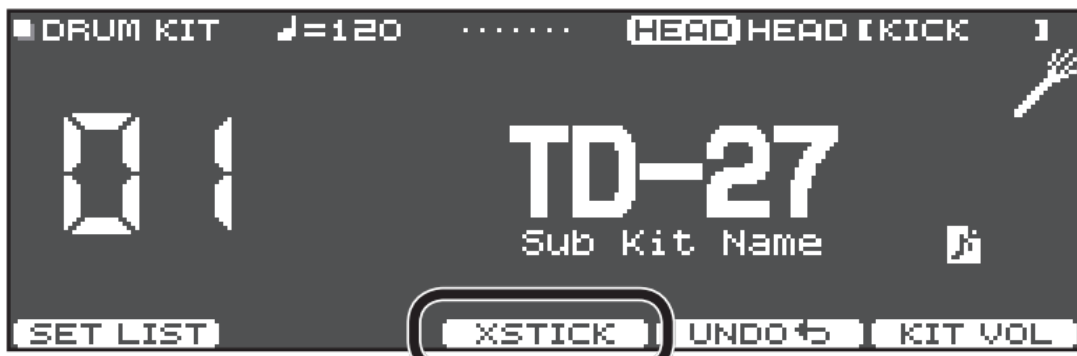

When playing using a pad that supports digital connection and cross-stick technique (such as the PD-140DS) If a trigger input is assigned to snare (p. 7), cross-stick technique is always possible. In this case, the XSTICK icon is not shown in the screen.

Performing Along with a Song

You can enjoy playing the drums along with songs on your smartphone or other mobile device (subsequently called “smartphone”) or songs that can be played back on the TD-27 itself.

Performing Along with a Song from Your Smartphone

Connecting via a Cable to the MIX IN Jack

1. Connect a stereo mini-plug cable (commercially available) from your smartphone to the TD-27’s MIX IN jack (p. 6).
2. Play back a song on your smartphone.
3. Turn the [BACKING] knob to adjust the volume of the song.

Connecting Wirelessly via Bluetooth

In order to connect your smartphone wirelessly to the TD-27 via Bluetooth, you’ll need to “pair” by registering the TD-27 in your smartphone so that the two devices can authenticate with each other.



As an example, we explain how to make settings for an iPhone.

Once a smartphone has been paired with TD-27, there is no need to perform pairing again. Refer to “Connecting an already-paired smartphone” (p. 14)

Registering the smartphone (pairing)

1. Place the smartphone that you want to connect near TD-27.
2. Press the [SYSTEM] button.
3. Move the cursor to "BLUETOOTH", and press the [ENTER] button.
4. Press the [F1] (PAIRING) button.

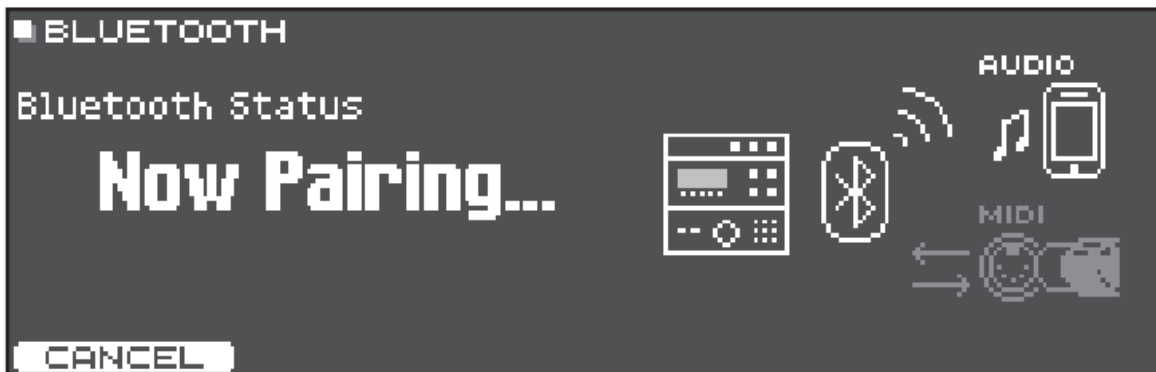

MEMO

If you decide to cancel pairing, press the [F1] (CANCEL) button or [EXIT] button.

5. Turn on the Bluetooth function of your smartphone.

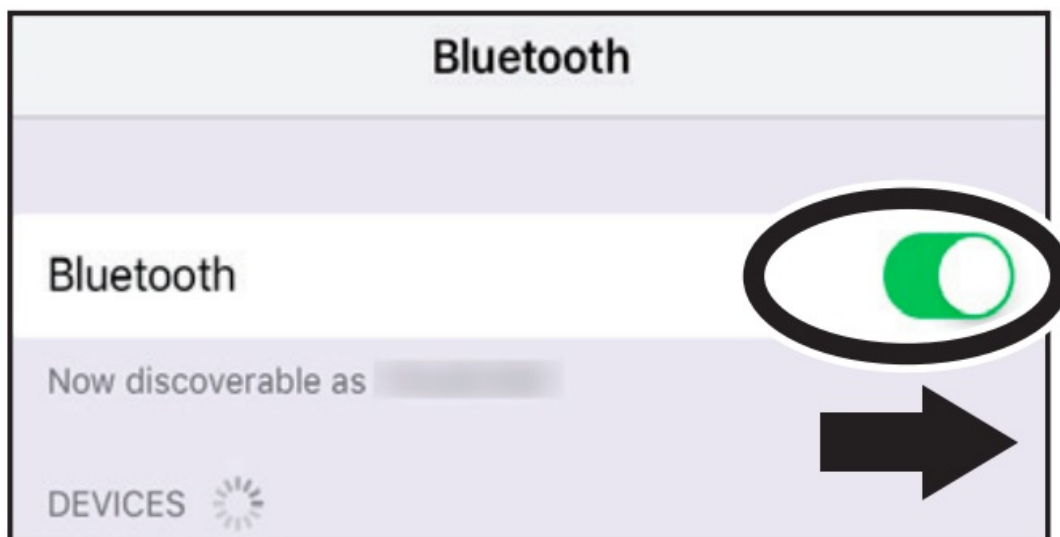

6. Tap "TD-27 AUDIO" that appears in the smartphone's Bluetooth "DEVICES" field. TD-27 and smartphone are paired. When pairing is completed, a display like the following appears. smartphone "TD-27 AUDIO" is added to the "My de
7. . Press the [DRUM KIT] button to return to the DRUM KIT screen.

Connecting an already-paired smartphone

Turn on the Bluetooth function of your smartphone.

This unit and the smartphone are connected wirelessly.

If the above step does not establish a connection, tap "TD-27 AUDIO" that are shown in the "DEVICES" field of the smartphone.

Playing back songs from your smartphone

When you play back a song on your smartphone, you hear the sound from the headphones or amplified speakers that are connected to the TD-27. To adjust the song volume, use the TD-27's [BACKING] knob or make adjustments on your smartphone.

MEMO

The song played back on your smartphone can be recorded along with the sound of your performance on the TD-27 (p. 19).

Performing Along with a Song

All types of music that can be played back by the TD-27, including its built-in songs, audio files saved on an SD card, and performance data recorded to an SD card are collectively called “songs”.

Types of song	Explanation
Built-in songs (INTERNAL)	Demo performances built-into the TD-27 (MIDI data) and songs for backing (audio data)
Songs saved on an SD card (SD CARD)	Audio files (WAV/MP3) saved to an SD card for backing
Songs recorded on an SD card (REC DATA)	A TD-27 performance saved (exported) as audio data to an SD card

Press the [SONG] button

The SONG screen appears.



Turn the dial to select a song.

Each time you press the [F1] button, you cycle between built-in songs (INTERNAL), audio files on the SD card (SD CARD), and songs recorded (exported) to the SD card (REC DATA).

Press the [s] button.

The selected song plays.

Operations during playback

[s] button	Play/stop the song
[][] buttons	Fast-forward [] / Rewind [] the song
[] button	Move to the beginning of the song
Use the [] button to move the cursor to “SPEED”&dial	Make the song’s playback speed faster (rotate right) or slower (rotate left)
[F4](A-B) button	Successively switch between loop playback, normal playback, and A-B repeat (*1).

Specify the interval between A and B, and play back repeatedly.

Setting A-B repeat

1. Press the [F4] (A-B) button for normal playback, and play back the song.
2. At the point where you want repetition to start, press the [F4] (A-B) button (specify A).
3. At the point where you want repetition to end, press the [F4] (A-B) button (specify B).

Reference

For the list of built-in songs, refer to “Data List” (PDF).

SD card folder structure

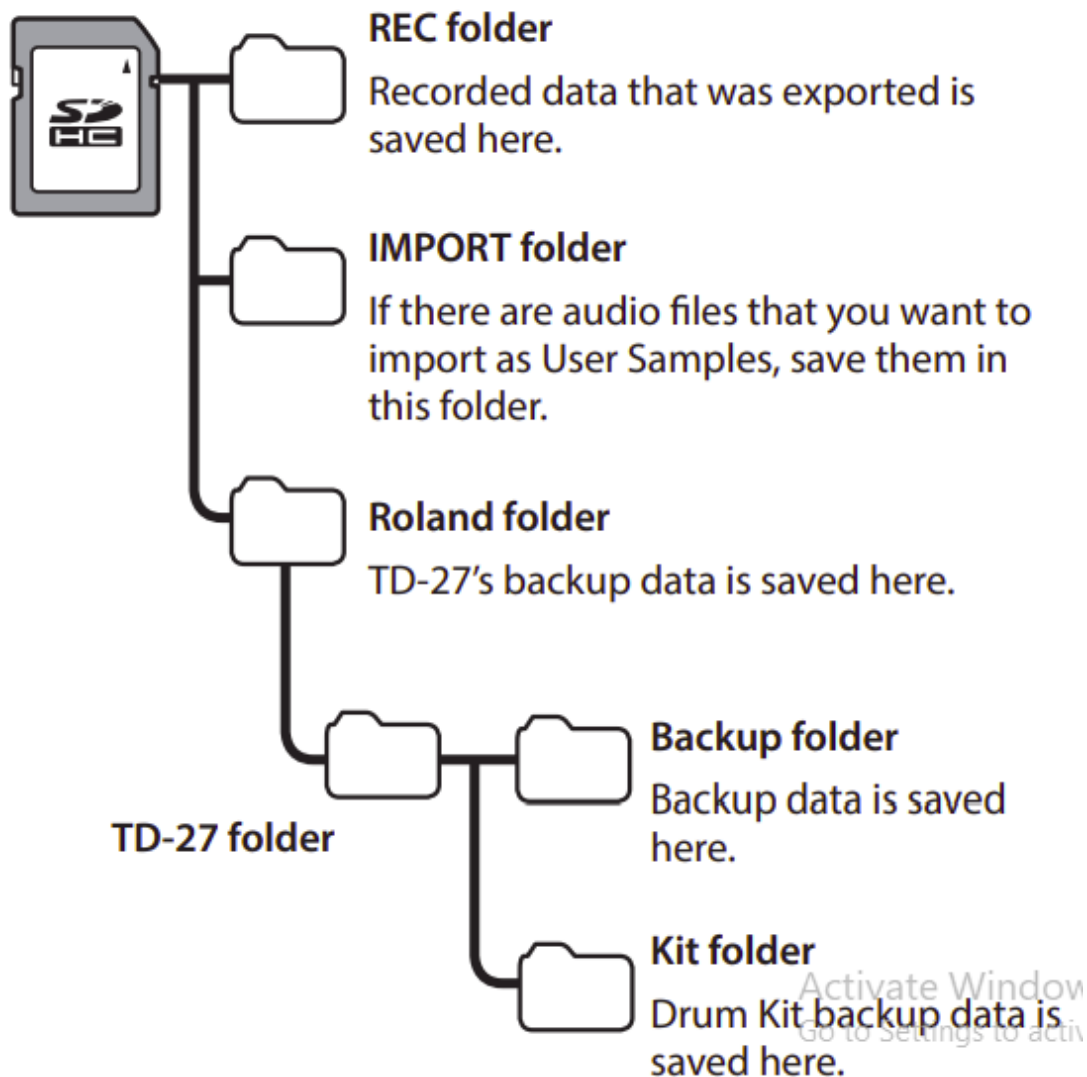

When transferring files from your computer to an SD card

Audio files can be played back from the top level of the SD card. You can put up to 200 song files in a single folder. Keep the song length within one hour per file.

Reference

For details, refer to the “Reference Manual” (PDF).

Audio files that can be played by the TD-27

	WAV	MP3
Format (extension)	WAV (.wav)	MP3 (.mp3)
Sampling frequency	44.1 kHz	44.1 kHz
Bit rate	16, 24-bit	64 kbps–320 kbps

File names or folder names that contain more than 16 characters are not shown correctly. Files and folders using

double-byte characters are also not supported.

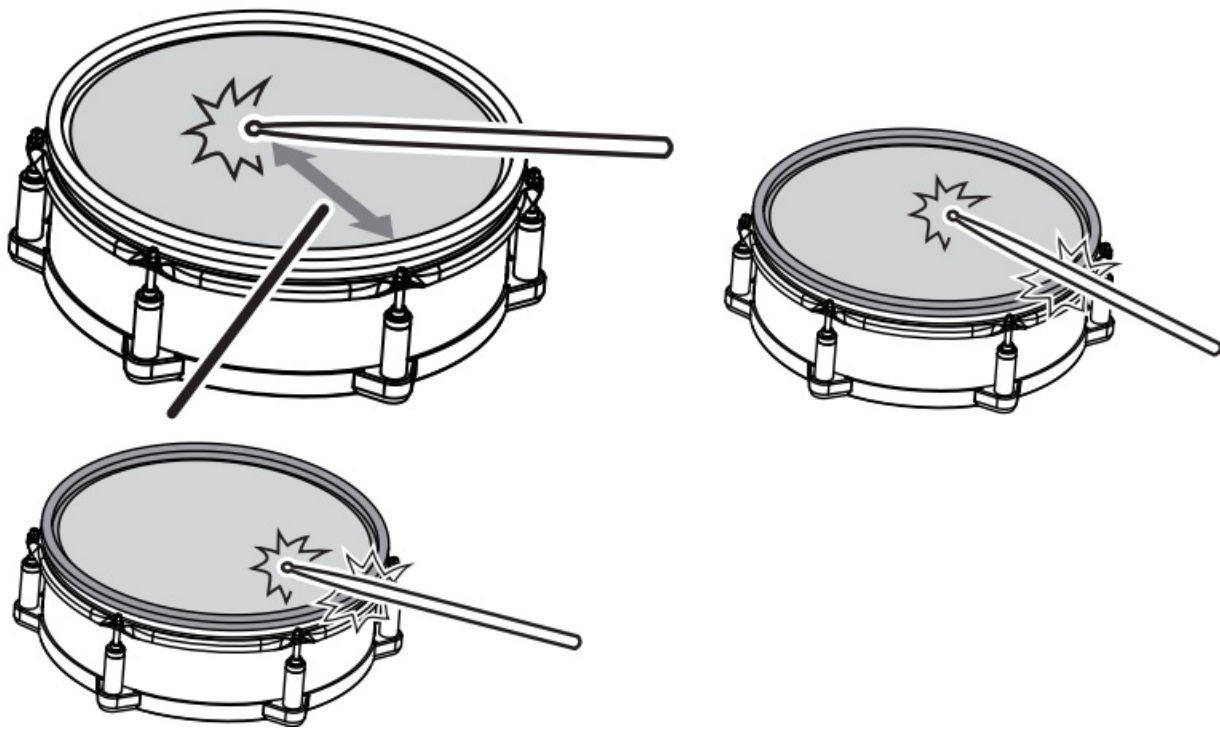

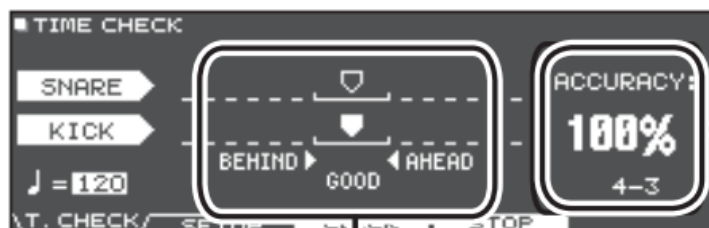

The percentage of your strikes that were played with accurate timing is displayed as a "%" value.

The screen indicates whether your pad strikes match the beat sounded by the click.

BEHIND: Behind the beat

AHEAD: Ahead of the beat



■ QUIET COUNT SETUP

Measures
Quiet

4
1



Q. COUNT \ SETUP / CLICK

■ WARM UPS (10 MINS)

Change-Up



♩ = 120

1-2

W. UPS \ SETUP / CLICK PAUSE

■ WARM UPS (10 MINS)

Auto UP/Down



MIN 122



MAX 260

♩ = 201

23-6

W. UPS \ SETUP / CLICK SET MAX PAUSE

■ WARM UPS (10 MINS)

Time Check



BEHIND ▶ GOOD ◀ AHEAD

♩ = 120

50-1

W. UPS \ SETUP / CLICK PAUSE

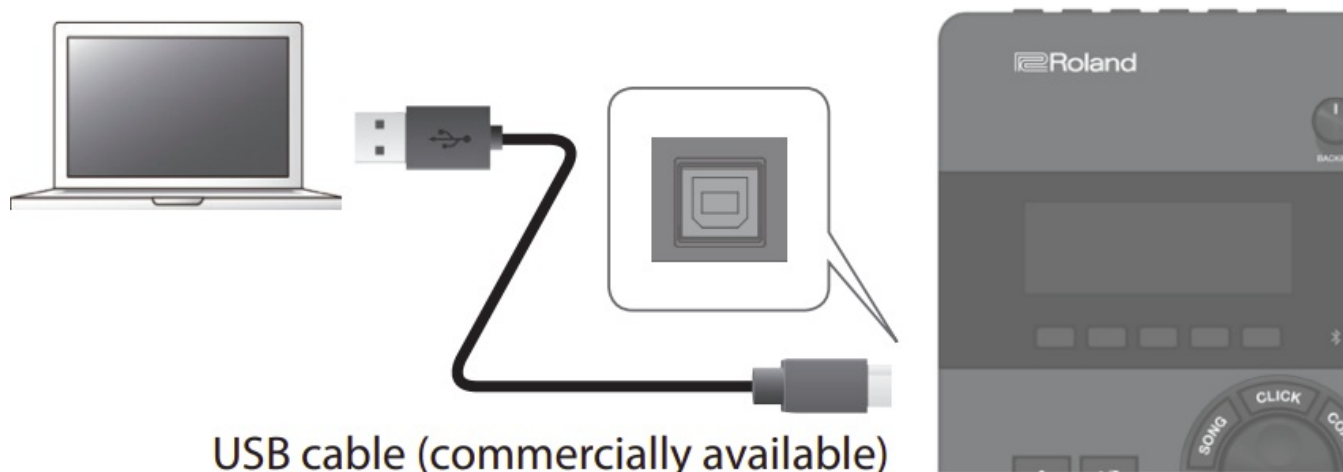

[MUFLING]
knob

Adjusts the decay length (muffling) of the instrument that's selected in the screen.



Pad location (head/rim/bell)

Instrument number

Pad to edit



Instrument group

Instrument name

[LEVEL] knob

Adjusts the volume (level) of the instrument that's selected in the screen.



[TUNING] knob

Adjusts the pitch (tuning) of the instrument that's selected in the screen.

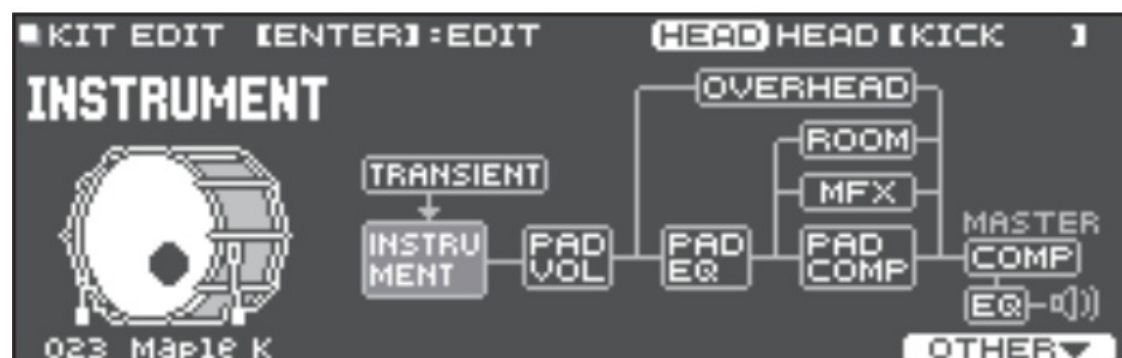
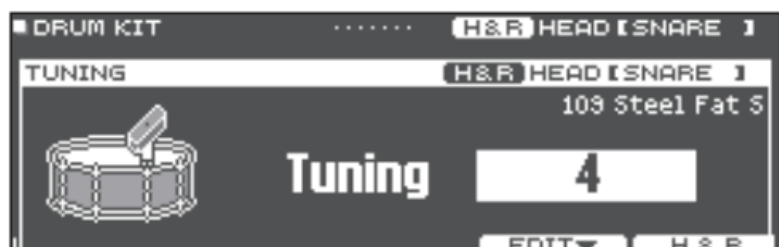

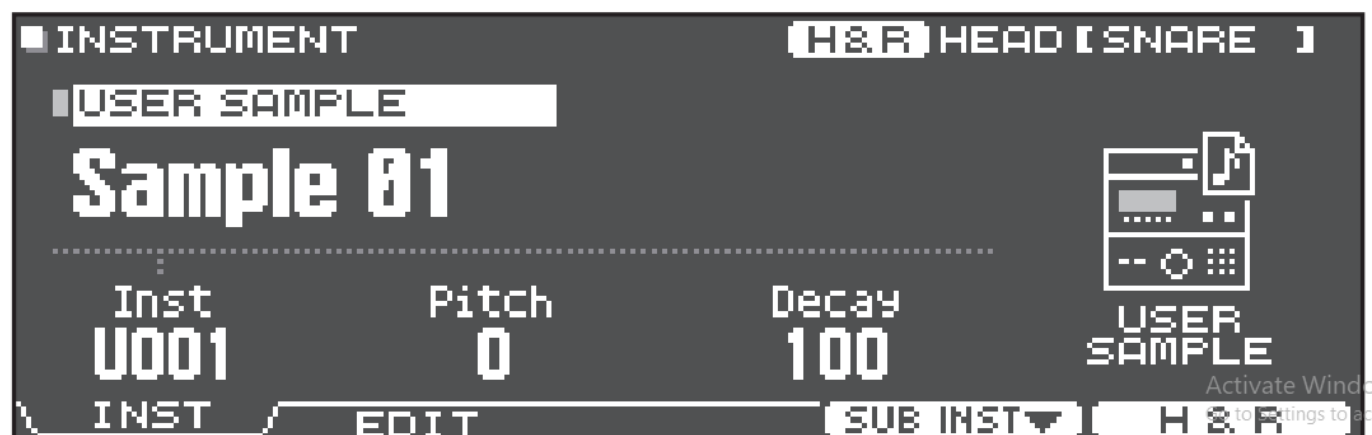

■ SD CARD FORMAT



This will Clear the SD Card.

FORMAT

■ SD CARD FORMAT



Format SD Card.

Are you sure?

CANCEL



OK

FORMAT

■ SD CARD SAVE (BACKUP ALL)



Save All Data to SD Card.

Are you sure?

CANCEL

OK

NAME

EXECUTE

■ SD CARD LOAD (BACKUP ALL)



With User Sample



Bank Number

1

Clear All Data and
Load Backup Data from SD Card.

LOAD

■ SD CARD LOAD (BACKUP ALL)



**Clear All Data and Load
Backup Data from SD Card.**

Are you sure?

CANCEL



OK

LOAD

■ AUTO OFF SETTING



AUTO OFF

Auto Off

4 HOURS

The TD-27 will automatically turn off if not played or used in any way after 4 hours.

■ FACTORY RESET



FACTORY
RESET

Clear All Data and
Load Factory Preset Data.

Reset with User Sample ☐

FACTORY
RESET

■ FACTORY RESET



Factory Reset

This will clear all the internal
memory contents.
Are you sure?

CANCEL

OK





RESET



 Roland

	<p>Roland TD-27 Drum Sound Module [pdf] User Guide</p> <p>TD-27 Drum Sound Module, TD-27, Drum Sound Module, Sound Module</p>
--	---

References

-  [YouTube](#)
-  [Roland - Support](#)
-  [TRON Forum](#)
-  [Manual-Hub.com - Free PDF manuals!](#)
-  [Roland - Support](#)
- [User Manual](#)

Manuals+. [Privacy Policy](#)

This website is an independent publication and is neither affiliated with nor endorsed by any of the trademark owners. The "Bluetooth®" word mark and logos are registered trademarks owned by Bluetooth SIG, Inc. The "Wi-Fi®" word mark and logos are registered trademarks owned by the Wi-Fi Alliance. Any use of these marks on this website does not imply any affiliation with or endorsement.