

Rogersound Labs

## **C34EMKII In-Ceiling Speaker**

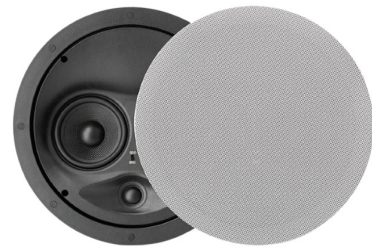

# Rogersound Labs C34EMKII In-Ceiling Speaker User Guide

[Home](#) » [Rogersound Labs](#) » Rogersound Labs C34EMKII In-Ceiling Speaker User Guide 

### Contents

- [1 Rogersound Labs C34EMKII In-Ceiling Speaker](#)
- [2 Introduction](#)
- [3 Mounting Frame](#)
- [4 Installation](#)
- [5 Documents / Resources](#)
  - [5.1 References](#)
- [6 Related Posts](#)

## Rogersound Labs

Rogersound Labs C34EMKII In-Ceiling Speaker



## Introduction

RSL has updated the C34EMKII design to have the baffle separate from the mounting frame to allow for easier and more robust installation. The installer can now clearly see and avoid any possible interference when securing the mounting tabs. This ensures the most secure mounting and ideal orientation. There are (4) hex head screws included in the accessory bag with each speaker.

## Mounting Frame

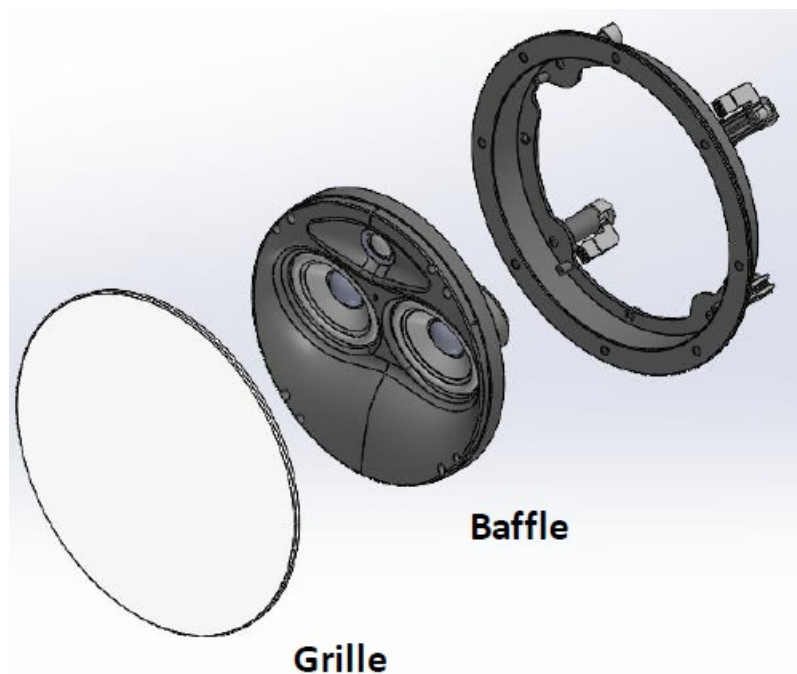

## Installation

### Step 1: Cutting the hole

Use the Included cardboard template to mark and cut the hole for in your drywall. Make sure to avoid obstructions (electrical, beams, ducting, etc...)

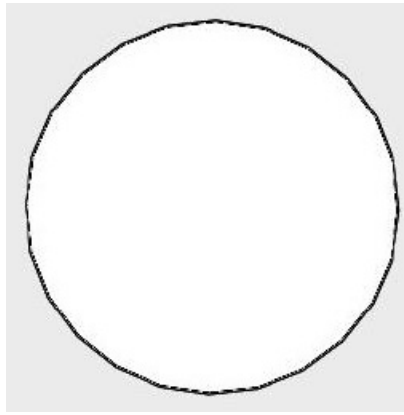

**Step 2a: Install and rotate mounting frame**

Rotate the mounting clamps inward so they can clear the opening when inserting.

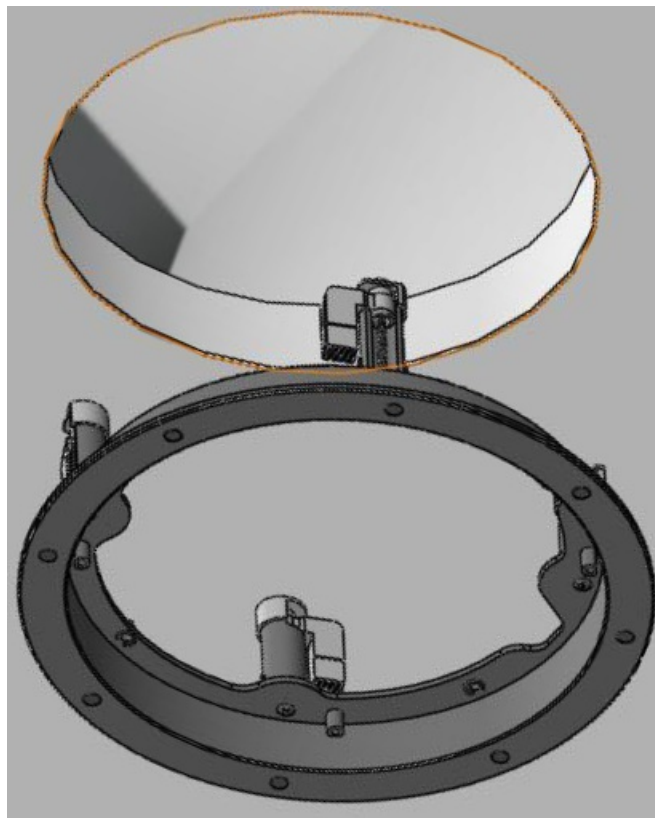

**Step 2b:**

Rotate the mounting frame so this section and corresponding grille attachment magnet are oriented and closest to the listening position and then tighten the mounting screws.

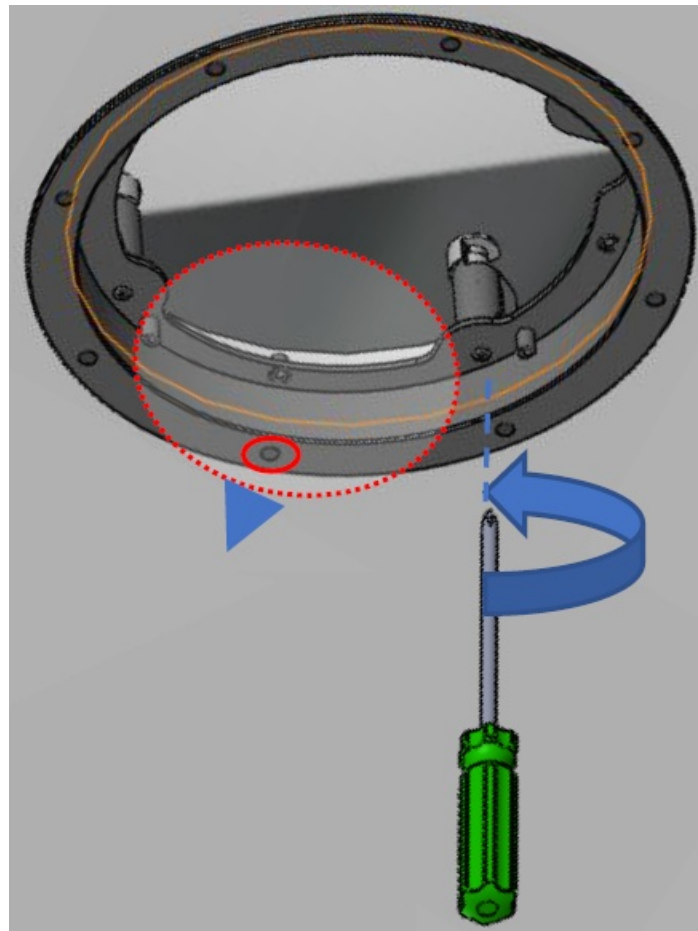

**Step 2b:**  
View behind drywall

Note mounting clamps will rotate outward and clamp to drywall as the mounting screws are tightened

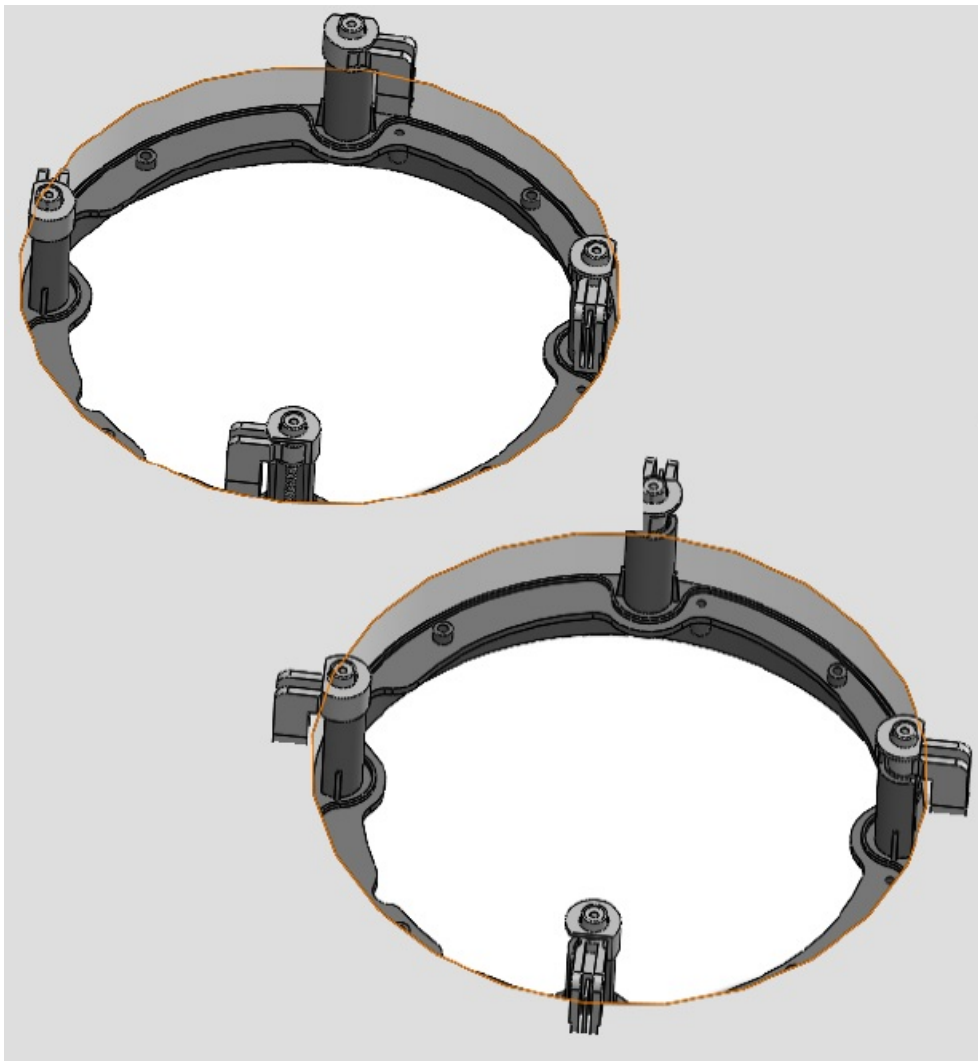

**Step 3: Install the baffle to the mounting frame**

Using the included screws, tighten and secure the baffle to the mounting ring. Attach the grille letting the magnets hold it in place.

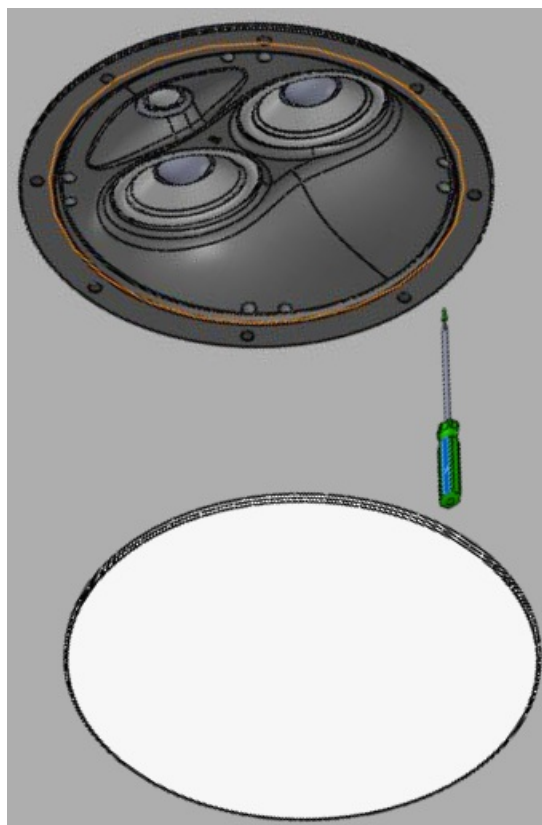

## Documents / Resources



[Rogersound Labs C34EMKII In-Ceiling Speaker](#) [pdf] User Guide  
C34EMKII In-Ceiling Speaker, C34EMKII, In-Ceiling Speaker, Speaker

## References

- [User Manual](#)

[Manuals+](#), [Privacy Policy](#)

This website is an independent publication and is neither affiliated with nor endorsed by any of the trademark owners. The "Bluetooth®" word mark and logos are registered trademarks owned by Bluetooth SIG, Inc. The "Wi-Fi®" word mark and logos are registered trademarks owned by the Wi-Fi Alliance. Any use of these marks on this website does not imply any affiliation with or endorsement.