



Contents [[hide](#)]

[1 ROGER TECHNOLOGY R85-60EAE Key Selector](#)

[2 Models and specifications](#)

[3 Installation of the selector](#)

[4 CONTACT](#)

[5 Documents / Resources](#)

[5.1 References](#)



ROGER TECHNOLOGY R85-60EAE Key Selector



Models and specifications

- **R85/60EAE**
- External selector made of aluminium with a European cylinder
- **R85/60EAS**
- External selector made of aluminium with a standard cylinder
- **R85/60ES**
- External selector made in plastic with a standard cylinder
- **R85/60IAE**
- Built-in selector made in aluminium with a European cylinder
- **R85/60IAS**
- Built-in selector made in aluminium with a standard cylinder
- **R85/60IS**
- Built-in selector made in plastic with a standard cylinder
- **R85/60EAS/TRIX**
- Selector made in aluminium with European cylinder (DIN), for photocell column TRIX
- **R85/60EAE/TRIX**
- Selector made in aluminium with standard cylinder, for photocell column TRIX
- **PROTECTION RATING**
- IP54
- **CURRENT RATING OF CONTACTS**
- 1A 24V

Installation of the selector

- Fix the case of the switch, which predisposes the connecting electrical cables inside the case. Proceed with the electrical connection as figured in the product layout (Figure 1).
- Fix the cover with screws. Put on the plaque screws cover.

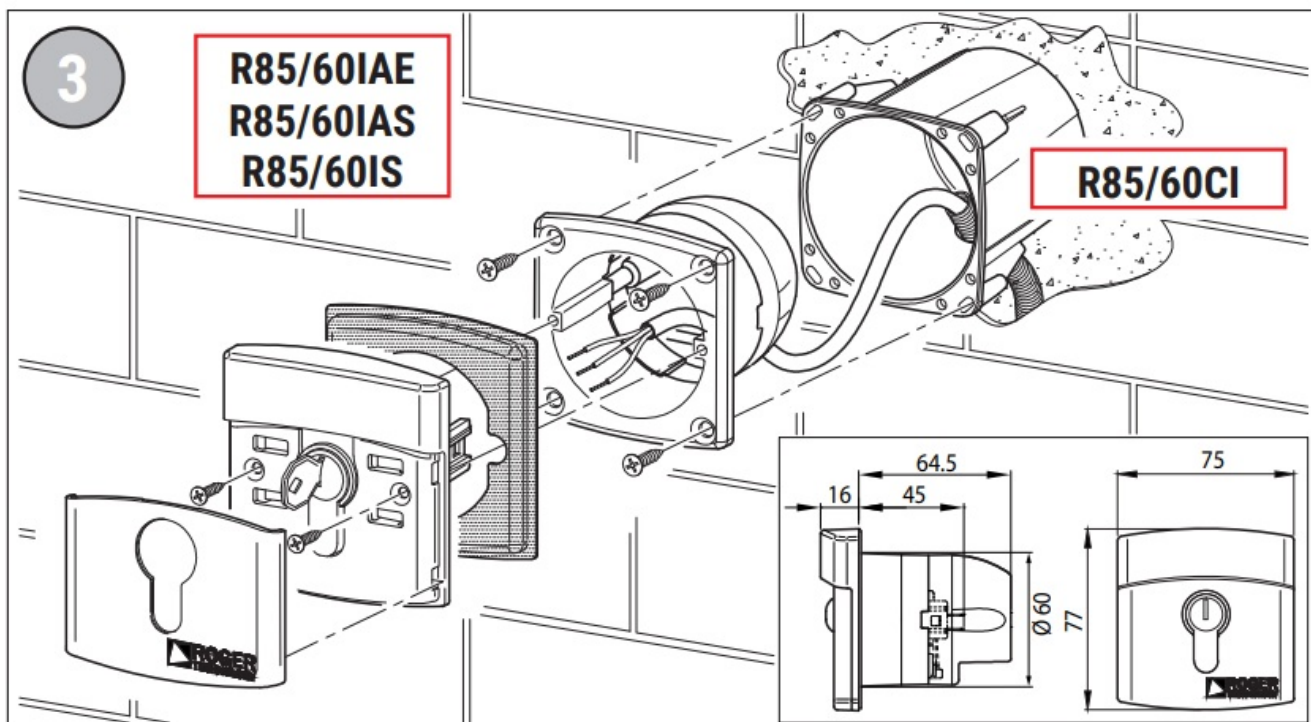

- Figure 4 Selector for photocell column TRIX.
- Declaration of conformity

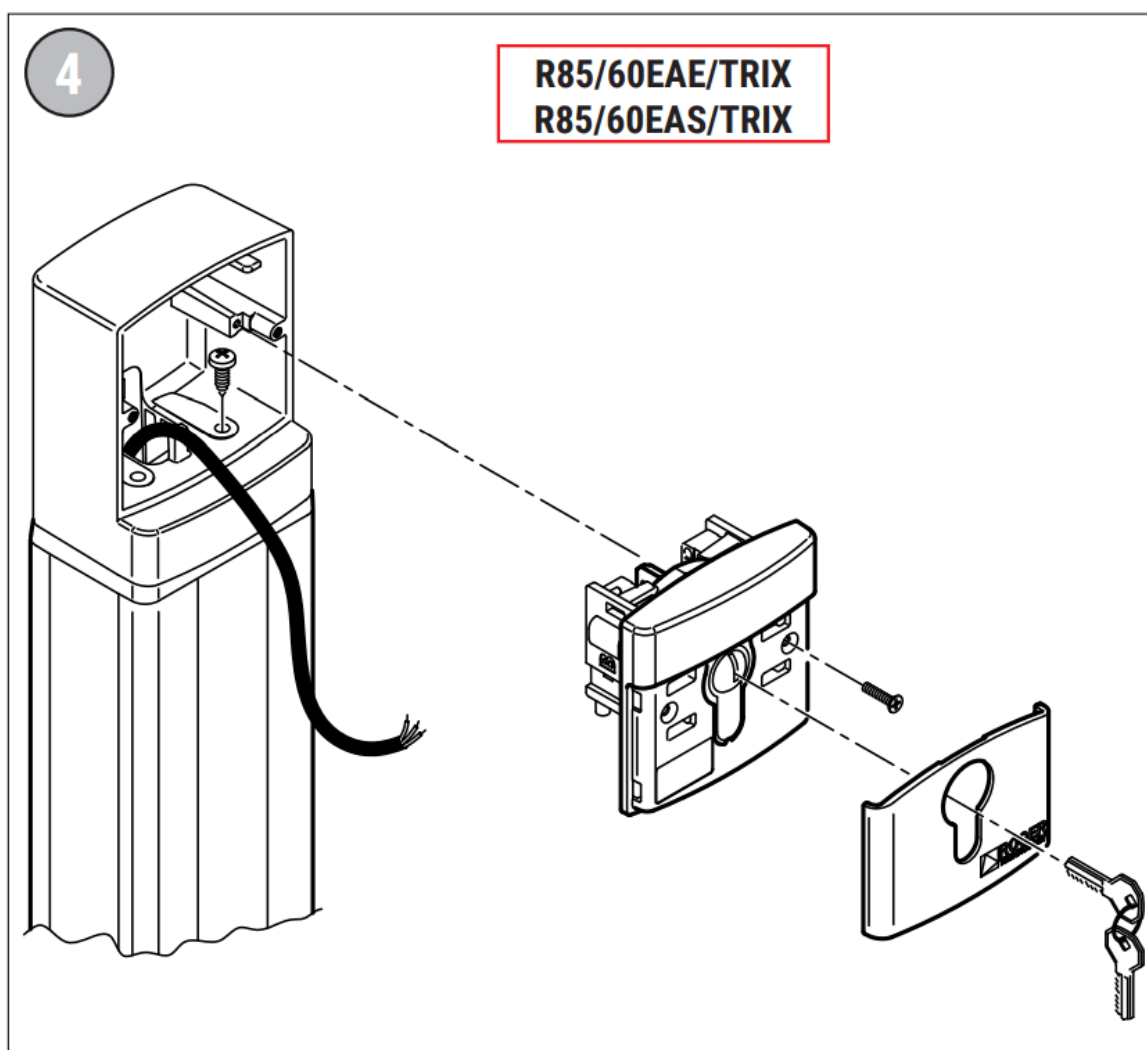

Declaration of conformity

The undersigned, representing the following manufacturer, Roger Technology Via Botticelli 8, 31021 Mogliano V.to (TV) DECLARES that the equipment described below:

Description: Key selector

- Model: R85
- It is in conformity with the legislative provisions that transpose the following directives: 2004/108/CE, 2006/95/CE, 2011/65/UE. And has been designed and manufactured to all the following
- standards or technical specifications: EN 61000-6-3; EN 61000-6-2. The last two figures of the year in which the | mark was affixed are 15. Place: Mogliano V.to
- Date: 03-06-2015 Signature



CONTACT

- Via S. Botticelli 8
- 31021 Bonisiolo di Mogliano Veneto (TV)
- ITALIA
- P.IVA 01612340263
- Tel. +39 041.5937023
- Fax. +39 041.5937024
- info@rogertechnology.com
- www.rogertechnology.com

Documents / Resources

	<p>ROGER TECHNOLOGY R85-60EAE Key Selector [pdf] Instruction Manual</p> <p>R85-60EAE, R85-60EAE Key Selector, Key Selector, Selector</p>
---	--

References

- [User Manual](#)

■ Roger Technology ♦ Key Selector, R85-60EAE, R85-60EAE Key Selector, Roger Technology, Selector

Leave a comment

Your email address will not be published. Required fields are marked *

Comment *

Name

Email

Website

☐ Save my name, email, and website in this browser for the next time I comment.

Post Comment

Search:

Search

[Manuals+](#) | [Upload](#) | [Deep Search](#) | [Privacy Policy](#) | [@manuals.plus](#) | [YouTube](#)

This website is an independent publication and is neither affiliated with nor endorsed by any of the trademark owners. The "Bluetooth®" word mark and logos are registered trademarks owned by Bluetooth SIG, Inc. The "Wi-Fi®" word mark and logos are registered trademarks owned by the Wi-Fi Alliance. Any use of these marks on this website does not imply any affiliation with or endorsement.