



# ROCKLER 62148 Dust Right Click-Connect Router Dust Port and Plate Instruction Manual

[Home](#) » [ROCKLER](#) » ROCKLER 62148 Dust Right Click-Connect Router Dust Port and Plate Instruction Manual



## Contents

- [1 ROCKLER 62148 Dust Right Click-Connect Router Dust Port and Plate](#)
- [2 Product Information](#)
- [3 Product Usage Instructions](#)
- [4 GENERAL SAFETY WARNINGS](#)
- [5 PRODUCT SPECIFIC SAFETY WARNINGS](#)
- [6 Installation on Router Two Options](#)
- [7 Documents / Resources](#)
  - [7.1 References](#)

# ROCKLER®

**ROCKLER 62148 Dust Right Click-Connect Router Dust Port and Plate**



## Product Information

The Click-Connect Router Dust Port and Plate is a product designed for specific applications as defined in the instructions. It should not be modified or used for any manner not described in these instructions. The product is intended to be used with a router for dust collection purposes. It is important to read, understand, and follow all instructions and safety warnings provided in the user manual. The user assumes all risk and responsibility for the proper and safe use of this product and for ensuring product suitability for the intended application. The product is compatible with various routers and can be used with guide bushings. It is recommended to remove the router base from the router when installing the Click-Connect Router Dust Port and Plate.

## Product Usage Instructions

1. Before using the Click-Connect Router Dust Port and Plate, ensure that you have read and understood all instructions and safety warnings provided in the user manual.
2. Always check Rockler.com to confirm that you are using the most recent version of instructions for your product.
3. Ensure that all tools to be used with the product have safety equipment installed and are in proper working order as defined by the tool's owner's manual.
4. Confirm that you are using the most recent version of the instructions and safety warnings for your product by visiting the instructions link on the product page at Rockler.com.
5. When using another tool with this product, always read, understand, and follow the instructions and safety warnings in the owner's manual for that tool. Obtain the owner's manual from the tool's manufacturer if you do not have one.
6. Turn off and unplug your router before installing the Click-Connect Router Dust Port and Plate, changing the bit, adjusting the cutting depth, or attaching an accessory.
7. If using a guide bushing with the Click-Connect Router Dust Port and Plate, ensure that the guide bushing's lock nut is fully tightened before routing.

8. If possible, remove the router base from the router when installing the Click-Connect Router Dust Port and Plate.
9. Keep hands and fingers away from the spinning router bit at all times to avoid serious injury.
10. Avoid inhaling wood dust when drilling, sawing, sanding, or machining wood products. Use a dust mask or other safeguards for personal protection. For more information, visit [www.P65Warnings.ca.gov/wood](http://www.P65Warnings.ca.gov/wood).
11. Ensure that anyone you allow to use this product reads and complies with all instructions and safety precautions outlined in the manual prior to use.

Review full instructions prior to use for important safety information. Always check [Rockler.com](http://Rockler.com) to confirm that you are using the most recent version of instructions for your product.

## GENERAL SAFETY WARNINGS

This product is designed only for specific applications as defined in the instructions and should not be modified or used for any manner not described in these instructions. Use only recommended accessories. Before using the Click-Connect Router Dust Port and Plate Instructions: READ, UNDERSTAND and FOLLOW ALL INSTRUCTIONS AND SAFETY WARNINGS. KEEP THESE INSTRUCTIONS READILY AVAILABLE FOR FUTURE REFERENCE.

- Always confirm that you are using the most recent version of the instructions and safety warnings for your product (see the instructions link on the product page at Rockler.com).
- Before using another tool with this product, always read, understand and follow the instructions and safety warnings in the owner's manual for that tool. If you do not have the owner's manual, obtain one from the tool's manufacturer before using it with this product.
- Before using any chemical with this product, always read, understand and follow all safety warnings and guidelines in the manufacturer's Safety Data Sheet (SDS; formerly called "MSDS"), especially regarding:
  - How to safely use the chemical, including potential hazards and recommended first aid measures;
  - Personal safety equipment required to safely use the chemical (e.g. gloves, eye protection, mask/respirator, etc.);
  - Proper and safe handling, storage and disposal of the chemical.
- Before using this product, review and verify that all tools to be used with it have safety equipment installed and are in proper working order as defined by the tool's owner's manual.
- Do not use this product until you have read and are confident you understand:
  - Product Specific Safety Warnings (p. 3);
  - Mounting Holes Diagram (p. 4);
  - Installation on Router: Two Options (pp. 5 – 7);
  - Connecting a Hose (p. 7);
  - Using with Rockler Jigs (p. 7).
- The user assumes all risk and responsibility for the proper and safe use of this product and for ensuring product suitability for the intended application.
- It is the sole responsibility of the purchaser of this product to ensure that anyone you allow to use this product reads and complies with all instructions and safety precautions outlined in this manual prior to use.
- Follow all standard shop safety practices, including:
  - Keep children and bystanders away from the tool operating area;
  - Do NOT use power tools in explosive environments, or in the presence of flammable liquids, fumes or

dust;

- TURN OFF AND UNPLUG all power tools BEFORE making any adjustments or changing accessories;
  - Remain alert and use good judgment. Do not use this product if you are in any way impaired by medications, alcohol, drugs or fatigue;
  - Keep your work area well lit and clean;
  - Dress appropriately. Secure loose clothing, remove all jewelry and tie up long hair before using this product;
  - ALWAYS wear safety glasses, hearing protection and respiratory protection that complies with NIOSH/OSHA/ANSI safety standards;
  - Use dust collection tools and dust face masks to reduce exposure to dust;
  - Use safety equipment such as featherboards, push sticks and push blocks, etc., when appropriate;
  - Maintain proper footing at all times and do not overreach;
  - Do NOT force woodworking tools.
- These warnings and instructions do NOT represent the total of all information available regarding tool safety, use, and technique. Always seek out opportunities to learn more and improve your skills and knowledge.

## WARNING

Drilling, sawing, sanding or machining wood products can expose you to wood dust, a substance known to the State of California to cause cancer. Avoid inhaling wood dust or use a dust mask or other safeguards for personal protection. For more information go

[www.P65Warnings.ca.gov/wood](http://www.P65Warnings.ca.gov/wood).

- **Danger** indicates a hazardous situation that, if not avoided, will result in death or serious injury.
- **Warning** indicates a hazardous situation that, if not avoided, could result in death or serious injury.
- **Caution** indicates a hazardous situation that, if not avoided, may result in minor or moderate injury or property damage.
- **Notice** indicates important or helpful information and/or user tips.

## PRODUCT SPECIFIC SAFETY WARNINGS

### DANGER



- To avoid serious injury, keep hands and fingers away from spinning router bit. Maintain awareness of the bit at all times.
- Turn off and unplug your router before installing the Click-Connect Router Dust Port and Plate, changing the bit, adjusting the cutting depth or attaching an accessory.

## WARNING

- If using a guide bushing with the Click-Connect Router Dust Port and Plate, always make sure the guide bushing's lock nut is fully tightened before routing.
- If possible, remove the router base from the router when installing the Click-Connect Router Dust Port and Plate.

## Bottom View Shown

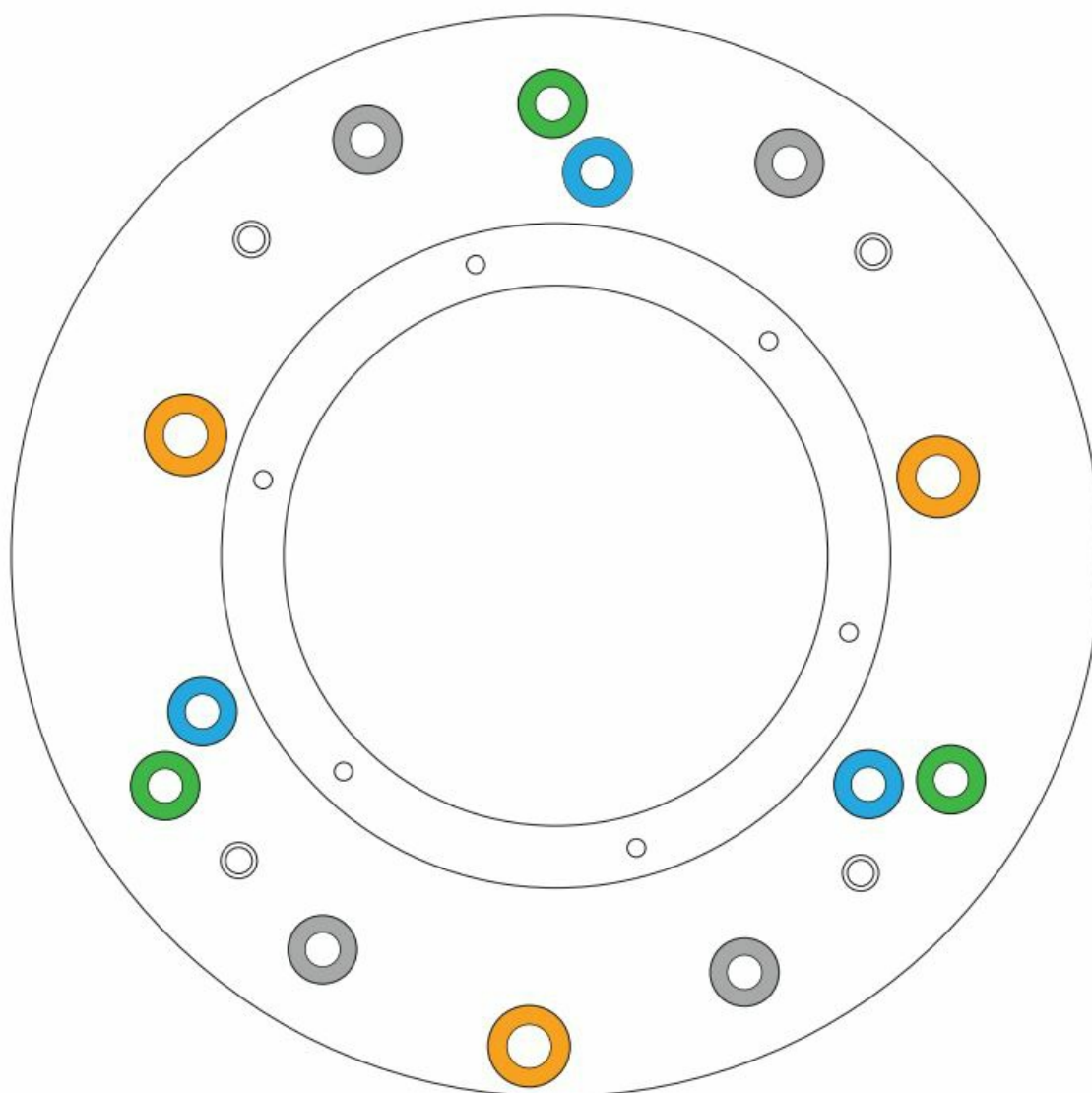

## ROUTER MOUNTING HOLE KEY

			
Porter-Cable 100, 690 series, 890 series, 7529 and 8529; Makita 1100 series; Hitachi M12VC; DeWalt DW616 and DW618; Bosch 1617 and 1618	Skil RT1322-00 and RT1323-00	Bosch 1619 and 1619EVS	DeWalt DW625

## Installation on Router Two Options

## NOTICE

Designed for use with Dust Right® FlexiPort Power Tool Hose Kits (sold separately) with Click-Connect functionality. A hose with a Click-Connect Hose Adapter (sold separately) is required.

The Click-Connect Router Dust Port and Plate can be configured in two ways, depending on the routing application.

### **If you will be using a guide bushing with your router**

for example, to do template routing – you will mount the Rotary Mechanism to the top face of the Click-Connect Baseplate and the Bushing Insert to the bottom of the Click-Connect Baseplate. Fig. 1.

1. With your router turned off and disconnected from the power source, remove the base from the router motor, if possible. Then remove the baseplate that came with the router from the bottom of the base. Keep track of the screws that held the baseplate to the base. Depending on the shape of the screw heads, you might be able to use the screws to attach the Click-Connect Baseplate. (If not, screws fitting the most popular routers are provided with the baseplate.)
2. Orient the Click-Connect Baseplate so the bottom face is down. (Look at the holes to distinguish between the faces: The holes are countersunk on the bottom face so flathead mounting screws will sit flush.) Set the Rotary Mechanism in the center recess in the top face of the Click-Connect Baseplate and attach it loosely with three #6 – 32 x 3/16" Flathead Screws through the slots and into alternating holes in the baseplate. Do not tighten the screws.
3. Look at the bottom face of the Click-Connect Baseplate and identify which mounting holes match your router base.
4. Bring the Click-Connect Baseplate/Rotary Mechanism assembly to the router base and orient it to roughly align the mounting holes in the baseplate with the mounting holes in the router base. Fit the outlet end of the Rotary Mechanism through the large bottom opening of the base and then through one of the side openings. At this point, the Click-Connect Baseplate should rest flat on the bottom of the router base. If it doesn't rest flat on the base, rotate the Rotary Mechanism on its threads to raise or lower it to fit through the side opening.
5. Rotate the Click-Connect Baseplate/Rotary Mechanism assembly to align the mounting holes in the baseplate with the holes in the router base. If you're not able to rotate the assembly far enough to align the holes, you might need to lift it out and fit the outlet end of the Rotary Mechanism through another of the router base's side openings.
6. Once the mounting holes are aligned and the outlet of the Rotary Mechanism fits through the router base's side opening, hold the Rotary Mechanism and Click-Connect Baseplate together to keep them from shifting as you lift them out of the router base. Then tighten the three #6 – 32 x 3/16" Flathead Screws to secure the Rotary Mechanism to the Baseplate.
7. Return the Click-Connect Baseplate/Rotary Mechanism assembly to the router base and attach it with the appropriate mounting screws for the base. Screws fitting the most popular routers are provided with the baseplate.

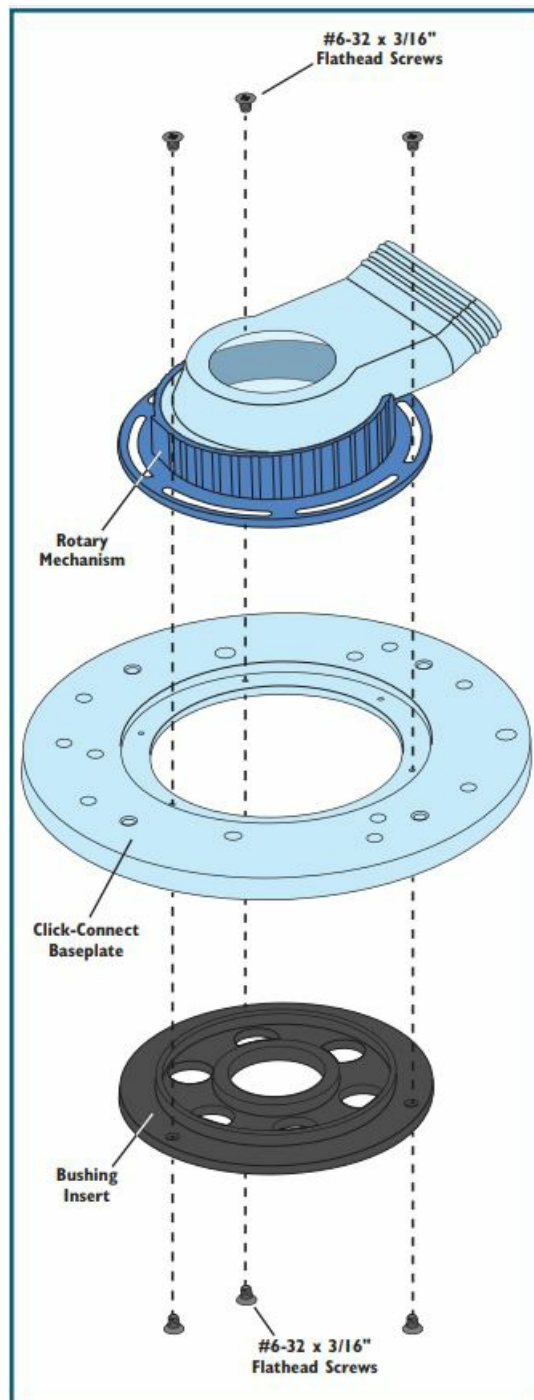

Fig. 1

## NOTICE

To install a guide bushing on the Bushing Insert after the Bushing Insert has been installed, simply remove the Insert, install the bushing and then reinstall the Insert.

8. Fit the Bushing Insert into the recess in the bottom face of the Click-Connect Baseplate, making sure to orient it correctly, and secure it with three #6 – 32 x 3/16" Flathead Screws in the three remaining open holes in the baseplate.
9. Fit the rubber Click-Connect FlexiPort onto the dust outlet of the Rotary Mechanism. Fig. 2.

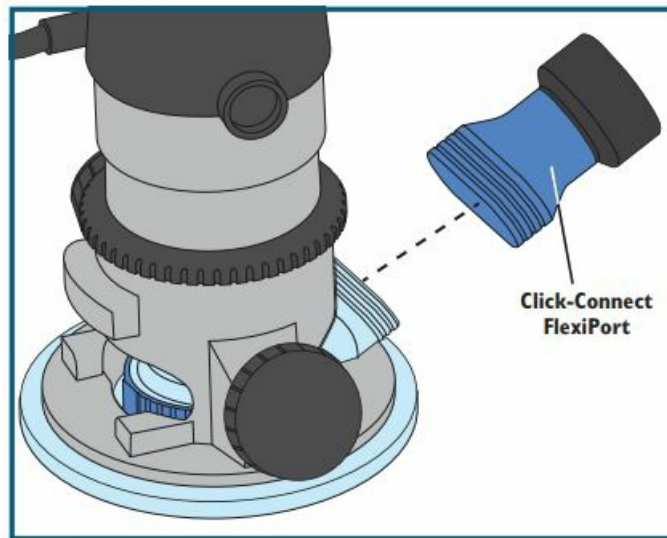

Fig. 2

If you won't be using a guide bushing, it's advantageous to mount the Rotary Mechanism to the bottom face of the Click-Connect Baseplate, as shown in Fig. 3. This allows more of the bit to be surrounded by the mechanism, improving dust collection. It also provides slightly more support surface to the Click-Connect Baseplate.

1. With your router turned off and disconnected from the power source, remove the base from the router motor, if possible. Then remove the baseplate that came with the router from the bottom of the base. Keep track of the screws that held the baseplate to the base. Depending on the shape of the screw heads, you might be able to use the screws to attach the Click-Connect Baseplate. (If not, screws fitting the most popular routers are provided with the baseplate.)
2. Orient the Click-Connect Baseplate so the bottom face is up. (Look at the holes to distinguish between the faces: The holes are countersunk on the bottom face so flathead mounting screws will sit flush.)
3. Fit the dust outlet of the Rotary Mechanism through the center opening of the Click-Connect Baseplate and lower the mechanism until its flange sits in the circular recess in the bottom face of the baseplate. Attach it loosely with three #6 – 32 x 3/16" Flathead Screws through the slots and into alternating holes in the Click-Connect Baseplate. Do NOT tighten the screws.
4. Look at the bottom face of the Click-Connect Baseplate and identify which mounting holes match your router base.
5. Bring the Click-Connect Baseplate/Rotary Mechanism assembly to the router base and orient it to roughly align the mounting holes in the baseplate with the mounting holes in the router base. Fit the outlet end of the Rotary Mechanism first through the large bottom opening of the base and then through one of the side openings. At this point, the Click-Connect Baseplate should rest flat on the bottom of the router base. If it doesn't rest flat on the base, rotate the Rotary Mechanism on its threads to raise or lower it to fit through the side opening.
6. Rotate the Click-Connect Baseplate/Rotary Mechanism assembly to align the mounting holes in the baseplate with the holes in the router base. If you're not able to rotate the assembly far enough to align the holes, you might need to lift it out and fit the outlet end of the Rotary Mechanism through another of the router base's side openings.
7. Once the mounting holes are aligned and the outlet of the Rotary Mechanism fits through the router base's side opening, tighten the three #6 – 32 x 3/16" Flathead Screws to secure the Rotary Mechanism to the Click-Connect Baseplate.



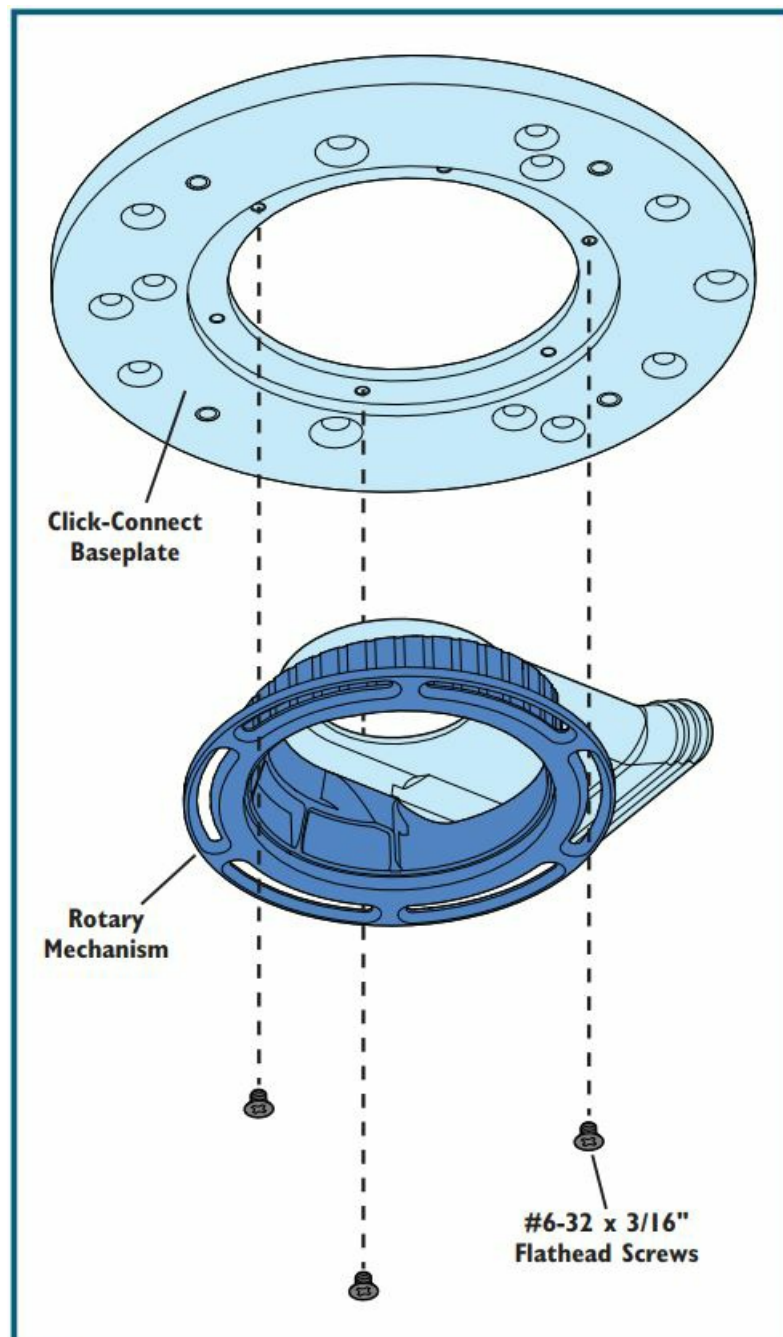

Fig. 3



Fig. 4

8. Fit the rubber Click-Connect FlexiPort onto the dust outlet of the Rotary Mechanism. Fig. 2.

### Connecting a Hose

The dust port of Click-Connect Router Dust Port and Plate is specifically designed for use with the FlexiPort Click-Connect Power Tool Hose system. You must use a FlexiPort Click-Connect Power Tool Hose Kit (68966 or 66169, sold separately) or a hose equipped with a Click-Connect Hose Adapter (sold separately) to connect to the Click-Connect Router Dust Port and Plate. Fig. 4. Hose Adapters are available individually: Click-Connect Hose Adapter for FlexiPort Expandable Hose (68066, sold separately); Click-Connect Hose Adapter for FlexiPort Fixed-Length Hose (61118, sold separately); and Click-Connect Hose Adapter for Shop Vacuum Hoses (69290, sold separately).

### Using with Rockler Jigs

The Click-Connect Router Dust Port and Plate also works in tandem with most Rockler router jigs. Depending on your router and the mounting hole pattern on the particular jig, you might need to drill mounting holes for your router in the jig. Rockler also offers a Router Hole Pattern Drilling Template (68547, sold separately) to simplify the process and improve accuracy. Fig. 5. You also might need to obtain longer mounting screws to span the jig base and the Click-Connect Router Dust Port and Plate and extend into the router base. You typically can find these at most home centers.



Fig. 5

Check Rockler.com for updates. If you have further questions, please contact our Technical Support Department at 1-800-260-9663 or [support@rockler.com](mailto:support@rockler.com)

Distributed by Rockler Companies, Inc. 4365 Willow Dr. Medina, MN 55340

- 1-800-279-4441
- [www.rockler.com](http://www.rockler.com)

## Documents / Resources



[ROCKLER 62148 Dust Right Click-Connect Router Dust Port and Plate](#) [pdf] Instruction Manual

62148 Dust Right Click-Connect Router Dust Port and Plate, 62148, Dust Right Click-Connect Router Dust Port and Plate, Right Click-Connect Router Dust Port and Plate, Click-Connect Router Dust Port and Plate, Router Dust Port and Plate, Dust Port and Plate, Port and Plate, Plate

## References

- [Woodworking Tools, Hardware, DIY Project Supplies & Plans - Rockler](#)
- [P65Warnings.ca.gov/wood](https://www.p65warnings.ca.gov/wood)
- [Woodworking Tools, Hardware, DIY Project Supplies & Plans - Rockler](#)

