



ROCK RSD0624 AX1800 WiFi 6 Mesh System Installation Guide

[Home](#) » [ROCK](#) » ROCK RSD0624 AX1800 WiFi 6 Mesh System Installation Guide 

ROCK RSD0624 AX1800 WiFi 6 Mesh System Installation Guide



Contents

- [1 Meet Your Router](#)
- [2 LED Status](#)
- [3 Set Up Your Mesh Wi-Fi System](#)
- [4 Add A Node](#)
- [5 FAQ](#)
- [6 FCC Statement](#)
- [7 Documents / Resources](#)
 - [7.1 References](#)
- [8 Related Posts](#)

Meet Your Router

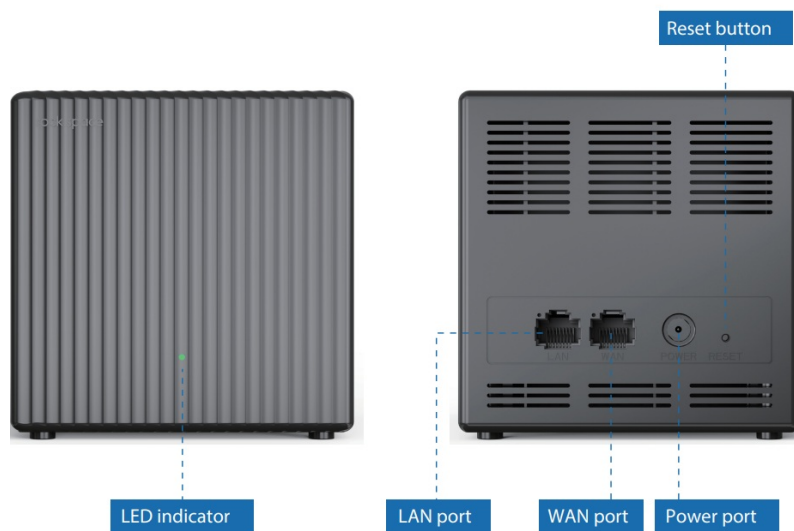

Reset button: Press for 2 second to reset your router to factory default settings.

LED Status

- **Primary node**
- **Pulsing green:** Connecting to the Internet
- **Solid green:** Connection succeeded
- **Pulsing red:** Connection failed
- **Blinking five times:** Resetting

Secondary node

- **Pulsing green:** Connecting to the primary node
- **Solid green:** Connection succeeded, good signal strength
- **Solid yellow:** Connection succeeded, fair signal strength
- **Pulsing red:** Connection failed

Set Up Your Mesh Wi-Fi System

Connect your router

1. Power the router on using the included power adapter and plug it into an outlet. The light turns solid green to indicate that it's on and ready for setup.
2. Connect your modem or your main Ethernet cable (if your Internet connection does not require a modem) to the WAN port on your router using an Ethernet cable. The WAN LED indicator turns on.

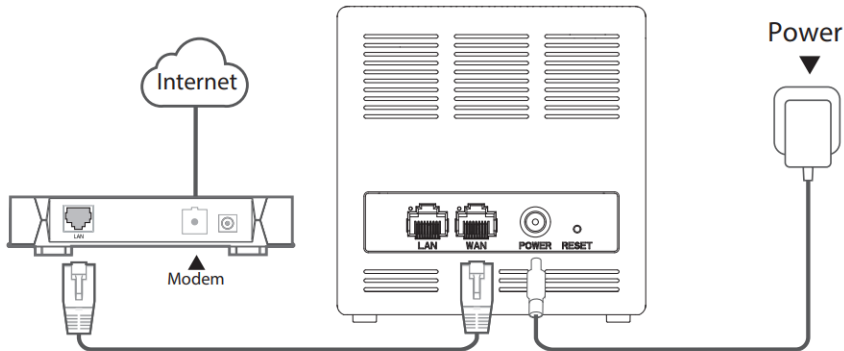

Set up the primary node

Method 1: Via the ROCK WIFI App

1. Download the ROCK WIFI app.

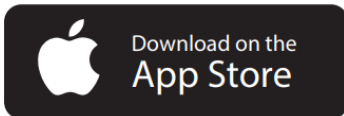

Note: If you are a new user, follow the onscreen instructions to register first. With this App, you can manage your network easily and conveniently no matter where you are.



2. Connect your smart phone to the router.
3. Open the ROCK WIFI app. Select your router model: RSD0624 AX1800 Mesh. Select any of the nodes to connect. The default SSID (network name) is printed on the label at the bottom of the router.

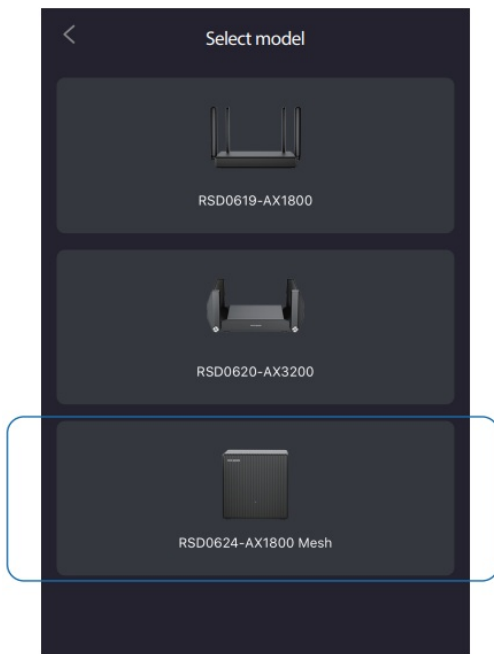

4. The App detects your connection type automatically. If detection fails, choose your connection type manually. There are 3 connection types supported, please refer to FAQ > Q1 below.

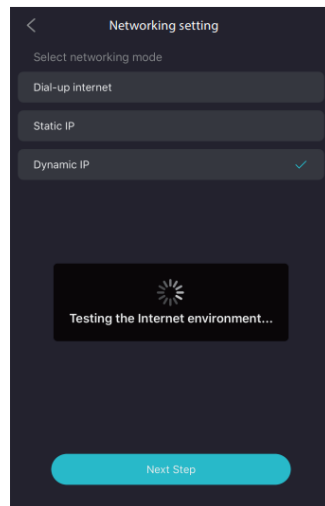
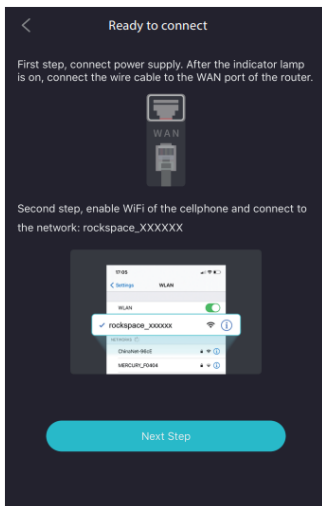

5. Set your Wi-Fi Name and Wi-Fi Password.

< Configure WiFi

WiFi name rockspace-112233

WiFi password 12345678

☒ Use WiFi password as the router administrator password

OK

6. Primary node setup complete.

Configuration completed

✓ Configuration is successful. The router is rebooting.
Please turn on your cellphone to set connecting to the set WiFi.

2.4GHz

WiFi name rockspace-112233

WiFi password 12345678

5GHz

WiFi name rockspace-112233_5G

WiFi password 12345678

Administrator password 12345678

Next Step

Method 2: Via a Web Browser

1. Connect to your router (wireless or wired).

- **Wireless** Find the SSID (network name) printed on the bottom label of the router and select the SSID from your network list to connect your device to the network



- **Wired** Connect your computer to the LAN port on your router via an Ethernet cable.

2. Connect the router to the Internet

1. Launch a web browser and enter 192.168.0.1 or www.rockspacewifi.com in the address bar to log into the router's web interface.

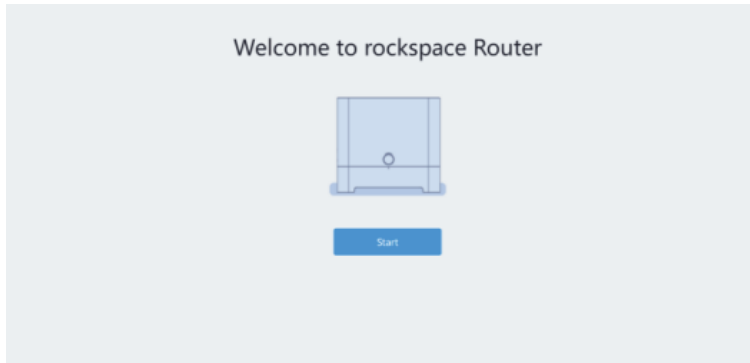

2. The webpage detects your connection type automatically. If detection fails, choose your connection type manually. There are 3 connection types supported, please refer to FAQ > Q1 below.

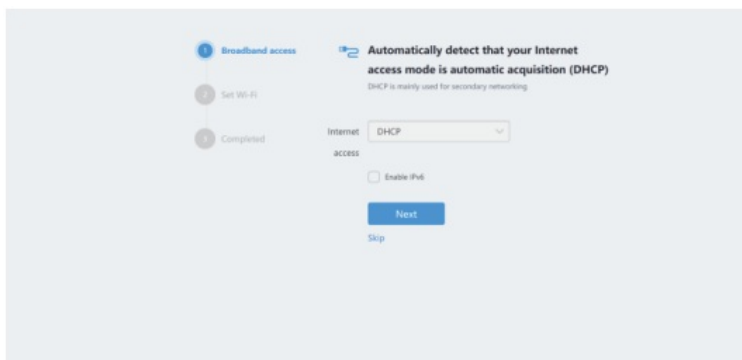

3. Set your Wi-Fi Name, Wi-Fi Password and Login Password.

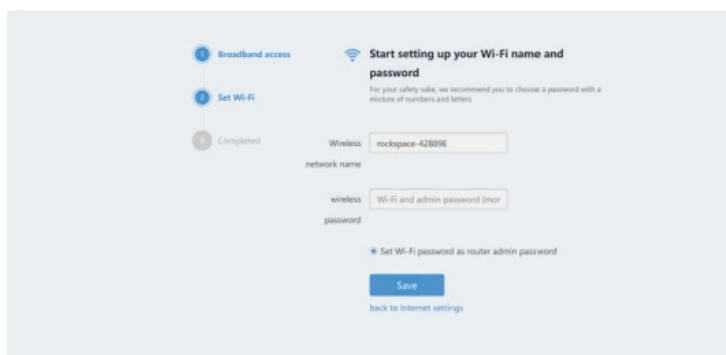

4. Primary node setup complete.

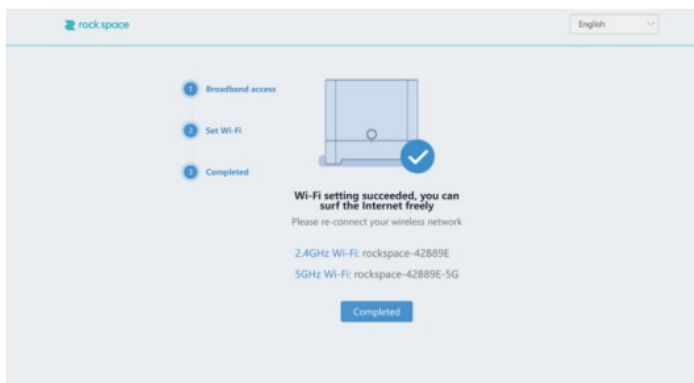

Add the secondary nodes

After setting up the primary node, the other two nodes in the kit will automatically be added to the mesh network after plugging it in.

Add A Node

ROCK mesh Wi-Fi nodes can be added to the network you've created with your router. All additional Wi-Fi devices added are considered nodes in the mesh network. You can choose one of the following method to add

Method 1: Via the ROCK WIFI App

1. Open the ROCK WIFI app.
2. Tap the device > More settings > Add a secondary node

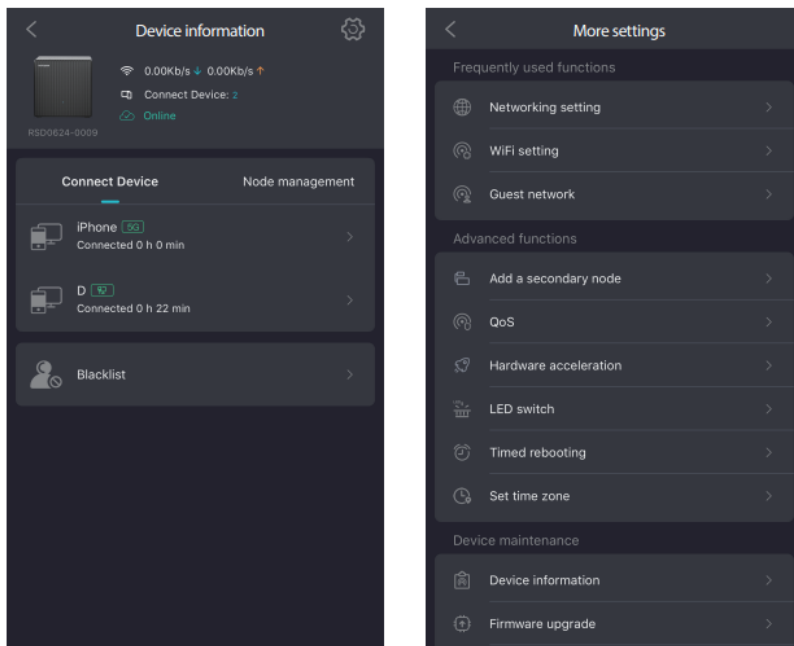

3. Scan QR code of secondary nodes (labeled on the bottom of the mesh box).

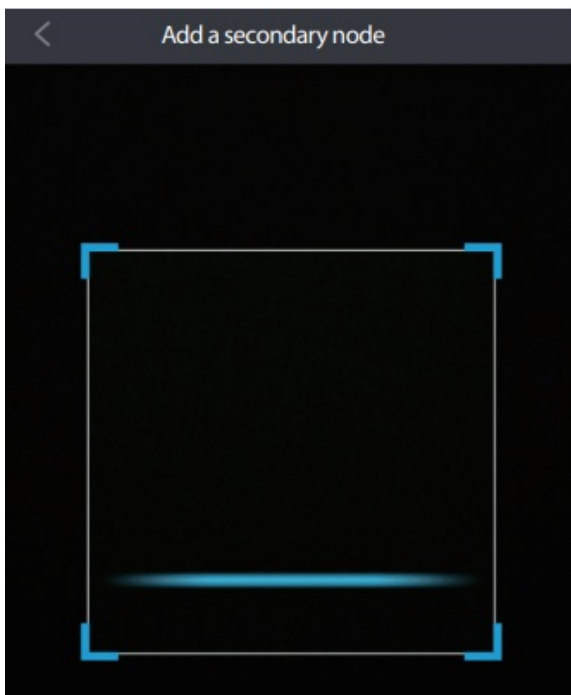

4. The node will now connect.
5. If you'd like to add another node, repeat these steps for additional nodes.

Method 2: Via a Web Browser

1. Connect the Ethernet cable to your primary node's LAN port. Then, connect the other end to the secondary node's WAN port.
2. Log in to the router's web management page.
3. Tap Add +. Choose "wired connection". Tap Next.

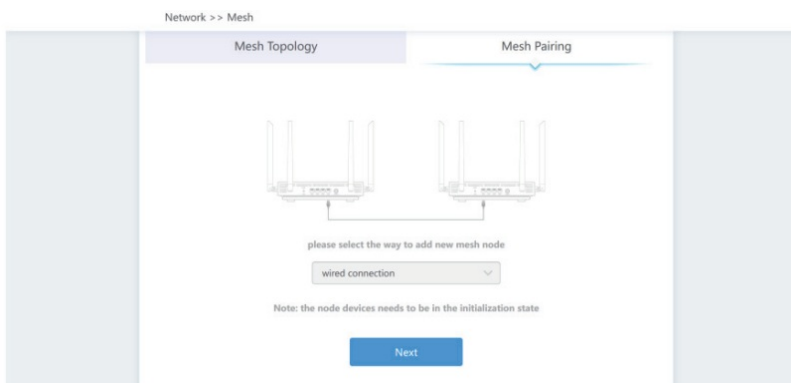

4. Follow the instructions to complete setup.

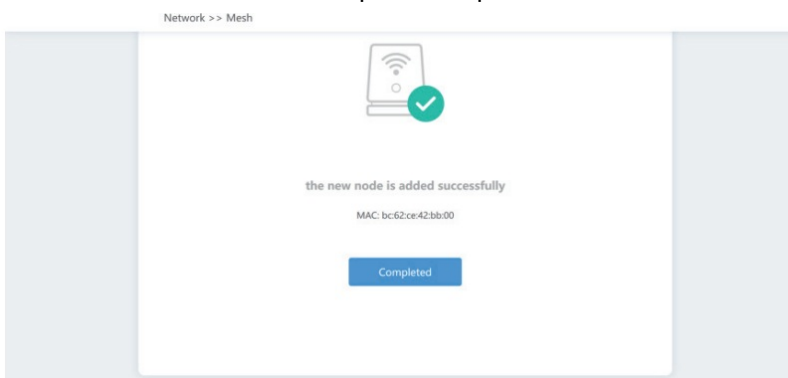

5. After successful setup, you can relocate the node to achieve wider Wi Fi coverage. Just plug it into a wall outlet, the node will connect. The LED indicator on your mesh router shows the status of your device.

6. If you'd like to add another node, repeat these steps for additional nodes.

To check the full list of ROCK Wi-Fi devices, scan the QR code or visit <https://rockspaceworld.com/>



Enjoy the internet!

FAQ

Q1: What connection type should I choose if the router fails to detect automatically?

Dynamic IP (recommended) — Obtain IP address from ISP automatically, choose this option if your ISP does not provide username and password. Static IP — Choose this option if your ISP provided an IP address and other information. PPPoE — Choose this option if your Internet Service Provider (ISP) provided PPPoE username and password.

Q2: How can I change my SSID and password?

A2: First, open the ROCK WIFI app, and select More settings, then click WiFi setting. Now you can try to edit the SSID and password, after you change the password and SSID, tap save. To use the Wi-Fi, you need to reconnect to it.

Q3: How to restore my network to factory settings?

A3: With the nodes powered on, press and hold the reset pinhole on the back of the primary node using a paper clip or something pointed, release when the LED indicator blinks fast. Your network is reset successfully when the LED indicator lights solid on then blinks again. And all nodes are restored to factory settings.

Note: After the primary node is reset and reconfigured, please power of the other two secondary nodes in case of abnormality display on the App

Q4: Why cannot my device connect to the 5GHz Wi-Fi signals?

A4: Please make sure that your 5GHz band is on and not be hidden. In this case, you can check the status of 5GHz through ROCK WIFI app > More Setting > NETWORK SETTINGS > MAIN WIFI SETTING. Turn on the 5GHz band if it's off. Otherwise, you should make sure the your devices are supporting 5GHz signals. Only those support 5GHz signals could be detected and connected.

Q5: What if the app could not recognize the device or connect to the device?

A5: First please make sure that your Ethernet cable with Internet connection is securely plugged into the WAN port rather than the LAN port. Second, make sure the mesh system is set up correctly according to the Quick Installation Guide.

FCC Statement



This equipment has been tested and found to comply with the limits for a Class B digital device, pursuant to Part 15 of the FCC Rules. These limits are designed to provide reasonable protection against harmful interference in a residential installation. This equipment generates, uses and can radiate radio frequency energy and, if not installed and used in accordance with the instructions, may cause harmful interference to radio communications. However, there is no guarantee that interference will not occur in a particular installation. If this equipment does cause harmful interference to radio or television reception, which can be determined by turning the equipment off and on, the user is encouraged to try to correct the interference by one or more of the following measures:

- Reorient or relocate the receiving antenna.
- Increase the separation between the equipment and receiver.
- Connect the equipment into an outlet on a circuit different from that to which the receiver is connected.
- Consult the dealer or an experienced radio/TV technician for help.

This device is restricted to be used in the indoor.

Operation is subject to the following two conditions:

1. this device may not cause harmful interference, and
2. this device must accept any interference received, including interference that may cause undesired operation.

Radiation Exposure Statement

This device complies with FCC radiation exposure limits set forth for an uncontrolled environment and it also complies with Part 15 of the FCC RF Rules. This equipment should be installed and operated with minimum distance 20cm between the radiator & your body

Caution:

Any changes or modifications not expressly approved by the party responsible for compliance could void the user's authority to operate this equipment. This transmitter must not be co-located or operating in conjunction with any other antenna or transmitter

NOTE:

1. The manufacturer is not responsible for any radio or TV interference caused by unauthorized modifications to this equipment.
2. To avoid unnecessary radiation interference, it is recommended to use a shielded RJ45 cable.

All transmission frequencies of U-NII-1 and U-NII-3 comply with 47 CFR FCC Part15.407(g) and the manufacturer declares that their transmission is maintained within the U-NII-1 and U-NII-3 bands.

Hot-line: +1 (833) 816-6558

Email: techsupport@rockspace.cc

Service Time: EST 10:00-21:00 from Monday to Friday

Documents / Resources

 The image shows the front cover of a 'Quick Installation Guide' for the 'ROCK RSD0624 AX1800 WiFi 6 Mesh System'. The cover is white with the 'ROCK' logo at the top. Below the logo, the title 'Quick Installation Guide' is printed, followed by 'AX1800 WiFi 6 Mesh System' and 'RSD0624 AX1800 WiFi 6 Mesh System'. A QR code is located in the bottom left corner, and some small text is visible at the bottom right.	<p>ROCK RSD0624 AX1800 WiFi 6 Mesh System [pdf] Installation Guide</p> <p>RSD0624, AX1800 WiFi 6 Mesh System, RSD0624 AX1800 WiFi 6 Mesh System, WiFi 6 Mesh System</p>
--	---

References

- [rockspace Official: re.rockspace.local Extender Setup](#)
- [rockspace Official: re.rockspace.local Extender Setup](#)

Manuals+.