

  
roborock  
**Q Revo MaxV**  
**Robot**  
**Vacuum**



# Roborock Q Revo MaxV Robot Vacuum Instruction Manual

[Home](#) » [Roborock](#) » Roborock Q Revo MaxV Robot Vacuum Instruction Manual 

## Contents

- [1 Roborock Q Revo MaxV Robot Vacuum](#)
- [2 Product Usage Instructions](#)
- [3 FAQs](#)
- [4 OVERVIEW](#)
- [5 CAUSATION](#)
- [6 INSTALLATION](#)
- [7 Documents / Resources](#)
  - [7.1 References](#)
- [8 Related Posts](#)

  
roborock

**Roborock Q Revo MaxV Robot Vacuum**



## Product Usage Instructions

### Setup:

1. Unbox the product carefully and ensure all components are \included.
2. Refer to the user manual for specific assembly instructions.
3. Connect the power source following the provided guidelines.

### Operation:

1. Press the power button to turn on the device.
2. Follow the on-screen prompts for the initial setup.
3. Use the control panel to navigate through different settings.

### Maintenance:

1. Regularly clean the product using a soft cloth and mild detergent.
2. Avoid exposing the product to extreme temperatures or moisture.
3. Refer to the maintenance section in the user manual for detailed care instructions.

## FAQs

### Q: How do I reset the device?

A: To reset the device, locate the reset button on the back and hold it down for 10 seconds.

**Q: What should I do if the product stops working suddenly?**

A: Check the power source and connections. If the issue persists, contact customer support for further assistance.

**Q: Can I use third-party accessories with this product?**

A: It is recommended to use accessories approved by the manufacturer to ensure compatibility and safety.

## OVERVIEW

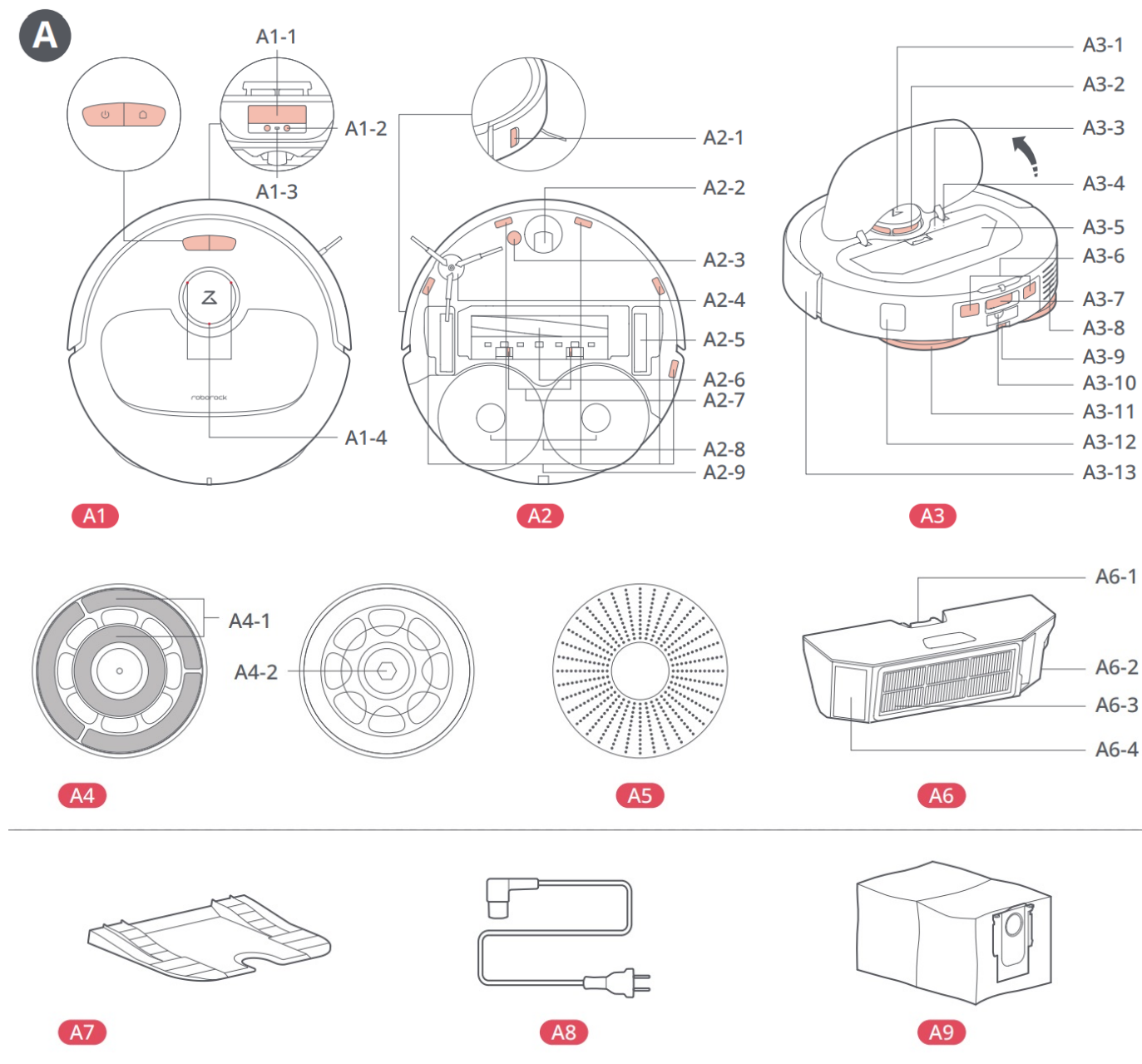

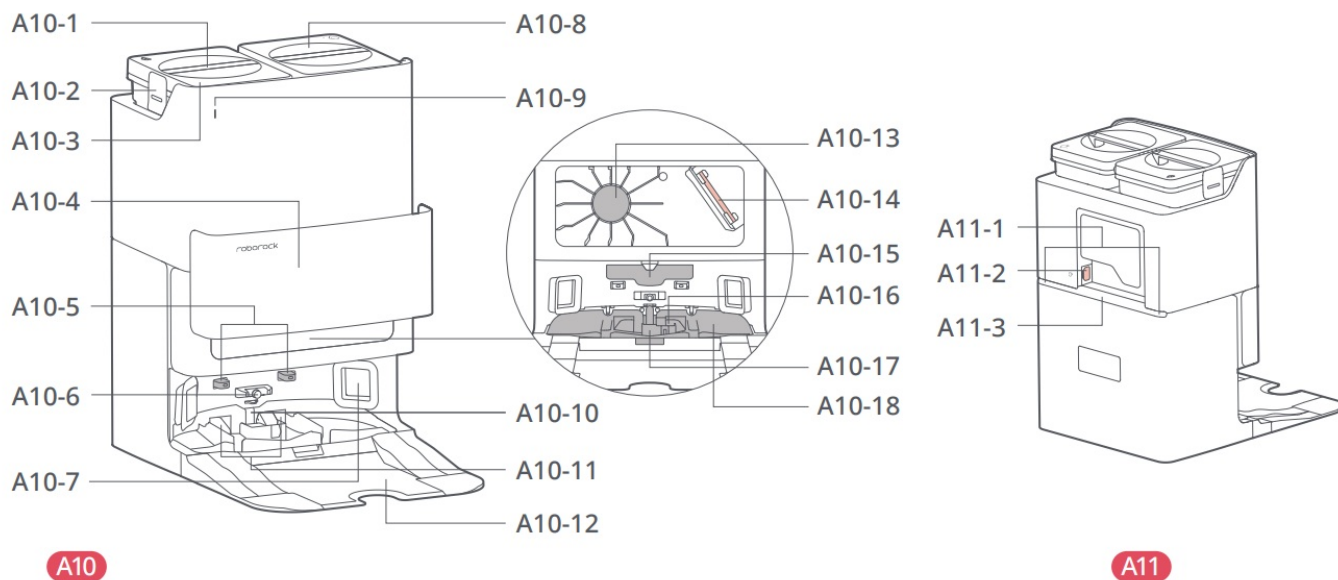

## CAUSATION

**B**

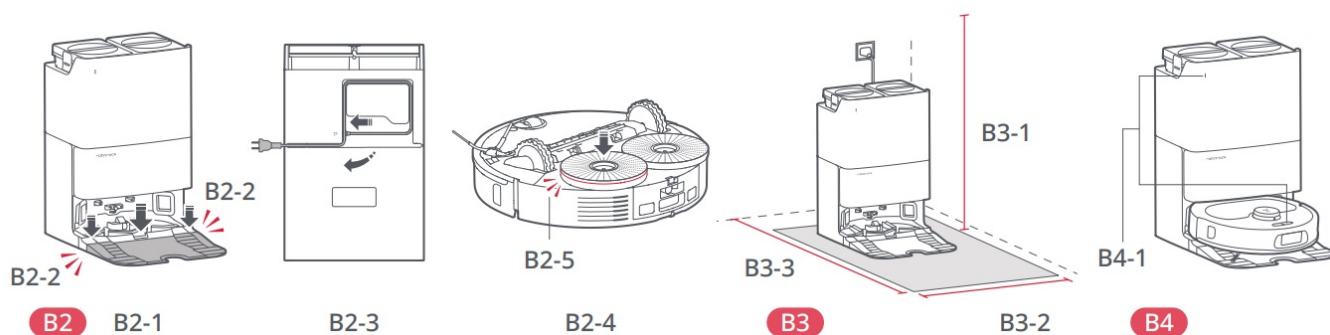
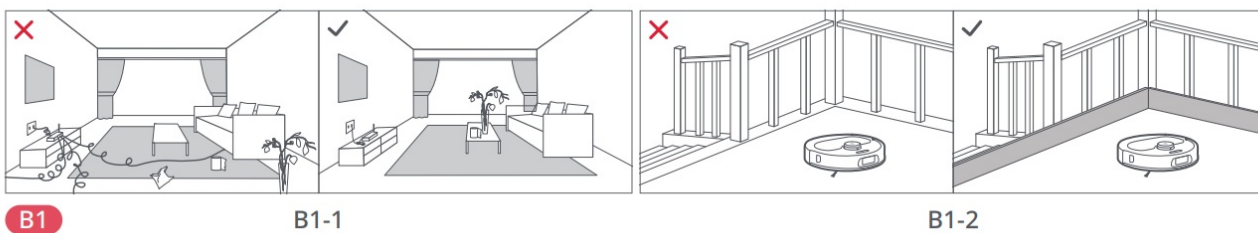

## INSTALLATION

C

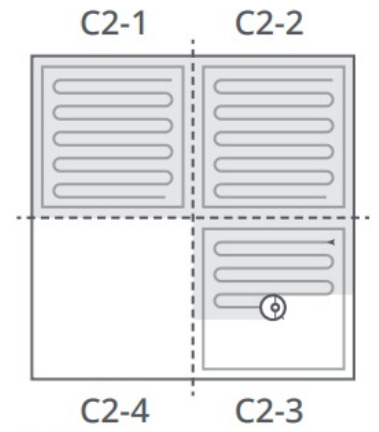
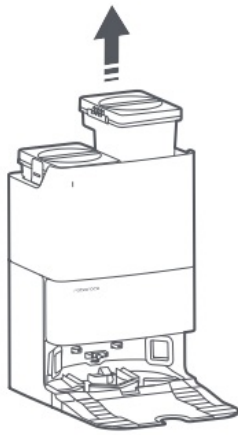

C1

C2

D

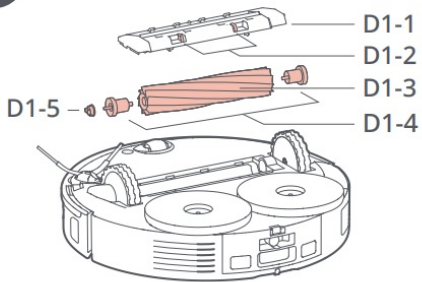

D1

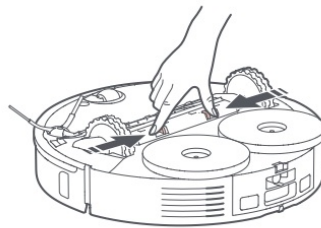

D1-6

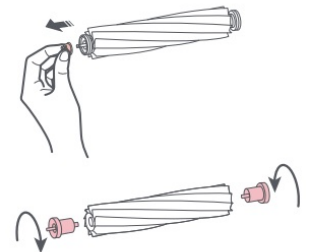

D1-7

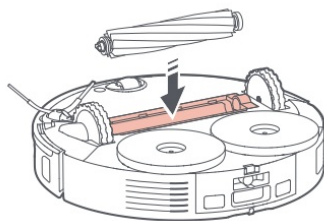

D1-8

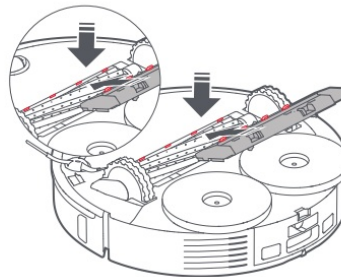

D1-9

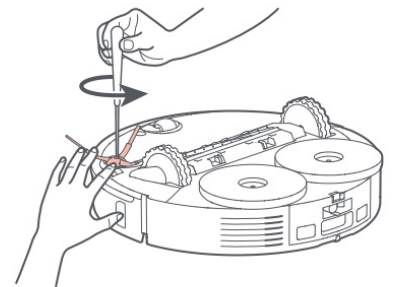

D2

D

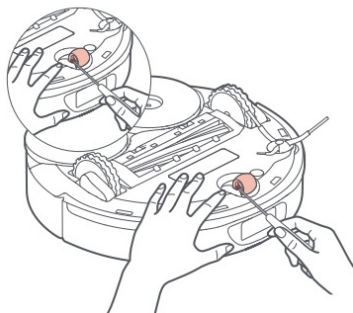

D3

D3-1



D3-2

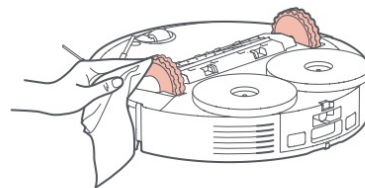

D4

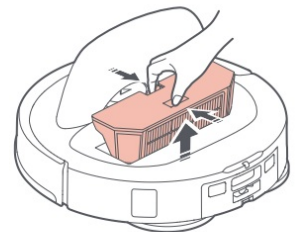

D5

D5-1

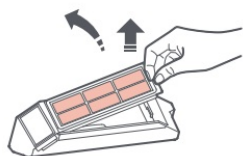

D5-2

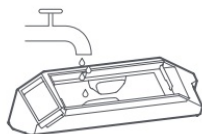

D5-3

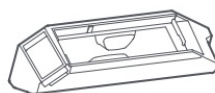

D5-4

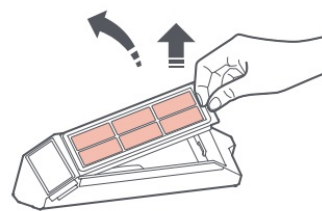

D6-1

D6

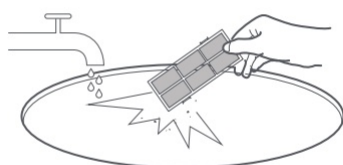

D6-2

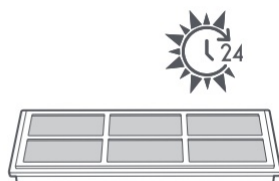

D6-3

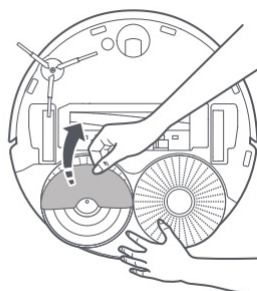

D7-1

D7

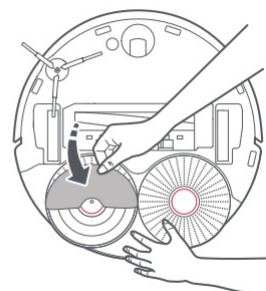

D7-2

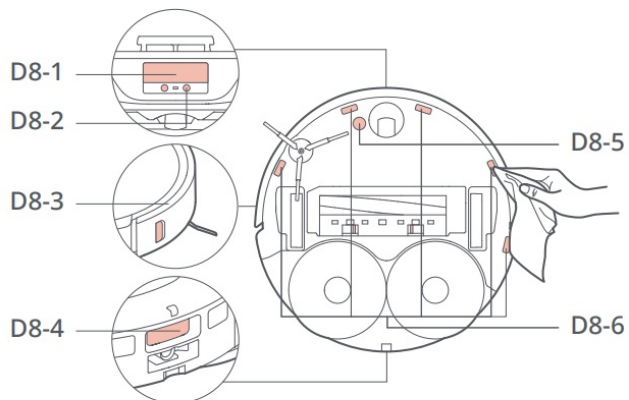

D8

D

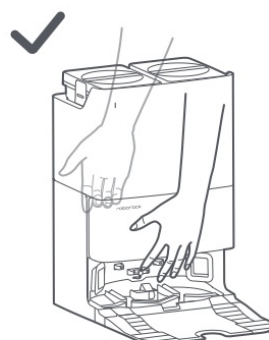

D9

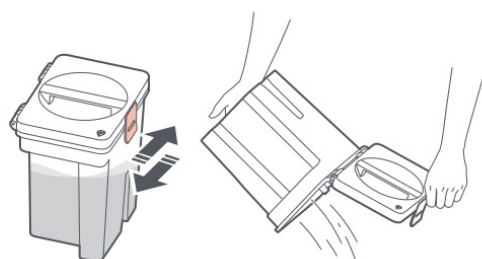

D10

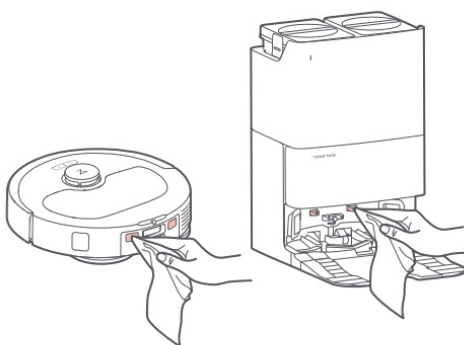

D11

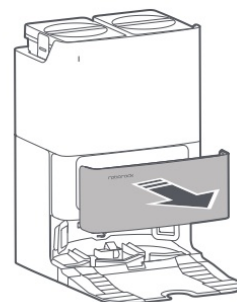

D12

D12-1



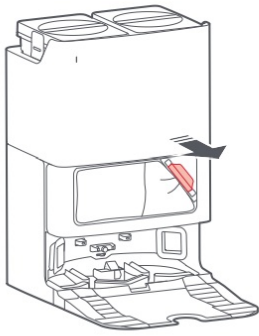

D12-2

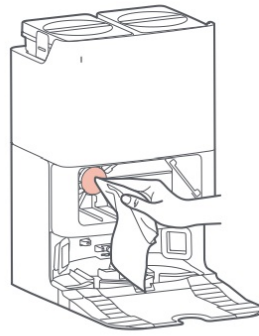

D12-3

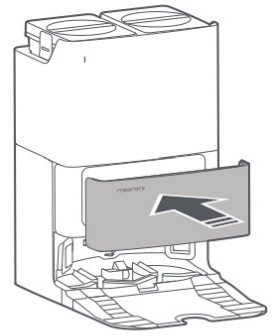
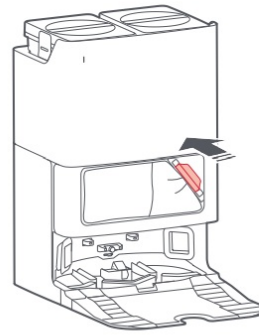

D12-4

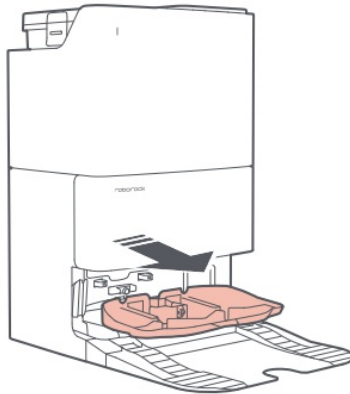

D13

D13-1

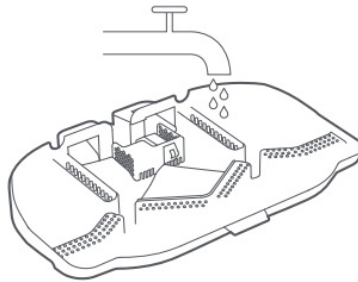

D13-2

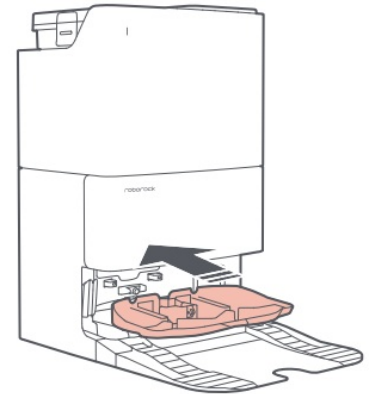

D13-3

## QR CODE



## Documents / Resources

	<p><a href="#">Roborock Q Revo MaxV Robot Vacuum</a> [pdf] Instruction Manual</p> <p>A1, A2, A3, A4, A5, A6, A7, A8, A9, A10, A11, B1, B2, B3, B4, C1, C2, D1, D2, D3, D4, D5, D6, D7, D8, D9, D10, D11, D12, D13, Q Revo MaxV Robot Vacuum, Q Revo MaxV, Robot Vacuum, Vacuum</p>
--	--

## References

- [User Manual](#)

[Manuals+](#), [Privacy Policy](#)

This website is an independent publication and is neither affiliated with nor endorsed by any of the trademark owners. The "Bluetooth®" word mark and logos are registered trademarks owned by Bluetooth SIG, Inc. The "Wi-Fi®" word mark and logos are registered trademarks owned by the Wi-Fi Alliance. Any use of these marks on this website does not imply any affiliation with or endorsement.