



roborock EWFD01LRR Empty Wash Fill Dock User Manual

[Home](#) » [Roborock](#) » roborock EWFD01LRR Empty Wash Fill Dock User Manual 



Roborock Empty Wash Fill Dock User Manual

Read this user manual carefully before using this product and store it properly for future reference.

Contents

- [1 IMPORTANT SAFETY INSTRUCTIONS](#)
- [2 WARNING](#)
- [3 FCC/IC Statement](#)
- [4 Parts List](#)
- [5 Product Overview](#)
- [6 Installation](#)
- [7 Instructions for Use](#)
- [8 Routine Maintenance Frequency](#)
- [9 Routine Maintenance](#)
- [10 Basic Parameters](#)
- [11 Troubleshooting](#)
- [12 Documents / Resources](#)
 - [12.1 References](#)
- [13 Related Posts](#)

IMPORTANT SAFETY INSTRUCTIONS

When using an electrical appliance, basic precautions should always be followed, including the following: READ ALL INSTRUCTIONS BEFORE USING (THIS APPLIANCE). Failure to follow the warnings and instructions may result in electric shock, fire and/or serious injury.

WARNING

To reduce the risk of fire, electric shock, or injury:

- Do not use outdoors or on wet surfaces.
- Do not allow to be used as a toy. Close attention is necessary when used by or near children, pets or plants.
- Use only as described in this manual. Use only manufacturer's recommended attachments.
- Do not use with damaged cord or plug. If appliance is not working as it should, has been dropped, damaged, left outdoors, or dropped into water, return it to a service center.
- Do not pull or carry by cord, use cord as a handle, close a door on cord, or pull cord around sharp edges or corners.
- Do not run appliance over cord. Keep cord away from heated surfaces.
- Do not unplug by pulling on cord. To unplug, grasp the plug, not the cord.
- Do not handle charger, including charger plug, and charger terminals with wet hands.
- Do not put any object into openings. Do not use with any opening blocked; keep free of dust, lint, hair, and anything that may reduce air flow.
- Keep hair, loose clothing, fingers, and all parts of body away from openings and moving parts.
- Do not use to pick up flammable or combustible liquids, such as gasoline, or use in areas where they may be present.
- Do not pick up anything that is burning or smoking, such as cigarettes, matches, or hot ashes.
- Do not use without dust bag.
- Unplug the appliance before making any adjustments, changing accessories, or storing appliance. Such preventive safety measures reduce the risk of starting the appliance accidentally.
- Do not carry the product using dock base or dustbin.
- Do not use the product when the ambient temperature is higher than 40°C (104°F), lower than 4°C (39°F).
- Place the dock on a flat floor away from fire, heat, and water. Avoid narrow spaces or locations where the robot may be suspended in the air.
- The product must be switched off and the plug must be removed from socket outlet before cleaning or maintaining the product.
- This product can be used by children aged from 8 years and above and persons with reduced physical, sensory or mental capabilities or lack of experience and knowledge if they have been given supervision or instruction concerning use of the product in a safe way and understand the hazards involved. Children shall not play with the product. Cleaning and user maintenance shall not be made by children without supervision.
- Do not use wet cloth or liquids for cleaning the charging contacts.
- Do not dismantle, repair or modify the battery or charging dock.
- If the dock is placed in an area susceptible to thunderstorms or with unstable voltage, take protection measures.
- Keep the charging dock away from heat (such as radiators).
- Connect to a properly grounded outlet only. See Grounding Instructions.



PROTECTIVE EARTH

SAVE THESE INSTRUCTIONS

Household use only.

GROUNDING INSTRUCTIONS

This appliance must be grounded. If it should malfunction or breakdown, grounding provides a path of least resistance for electric current to reduce the risk of electric shock. This appliance is equipped with a cord having an equipment-grounding conductor and grounding plug. The plug must be inserted into an appropriate outlet that is properly installed and grounded in accordance with all local codes and ordinances.

WARNING – Improper connection of the equipment-grounding conductor can result in a risk of electric shock. Check with a qualified electrician or service person if you are in doubt as to whether the outlet is properly grounded. Do not modify the plug provided with the appliance – if it will not fit the outlet, have a proper outlet installed by a qualified electrician.

This appliance is for use on a nominal 120-V circuit and has a grounding attachment plug that looks like the plug illustrated in sketch A in Grounding methods. Make sure that the appliance is connected to an outlet having the same configuration as the plug. No adaptor should be used with this appliance.

Grounding methods

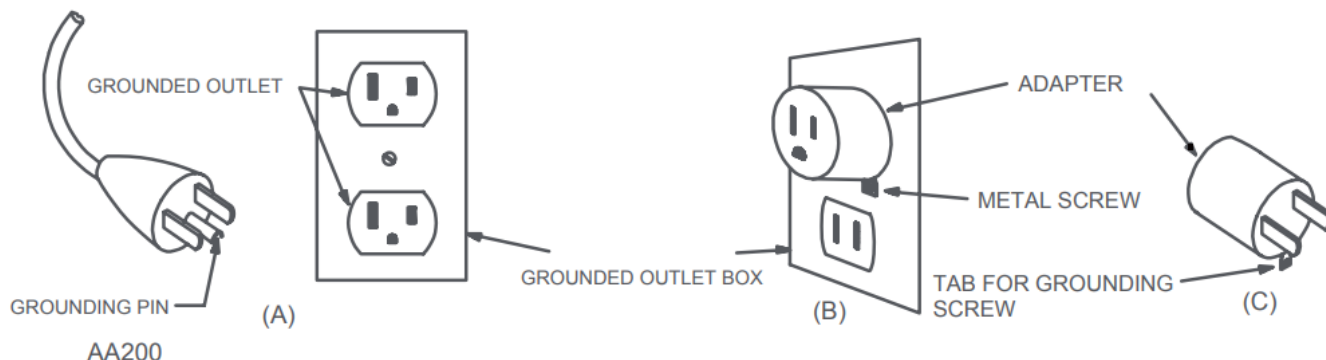

FCC/IC Statement

Compliance Information	
Product Name	Empty Wash Fill Dock
Product Model	EWFDO1LRR, EWFDO2LRR
Compliance Statement	<p>This device complies with Part 15 of the FCC Rules. Operation is subject to the following two conditions:</p> <p>(1) this device may not cause harmful interference, and</p> <p>(2) this device must accept any interference received, including interference that may cause undesired operation.</p> <p>This device contains licence-exempt transmitter(s)/receiver(s) that comply with Innovation, Science and Economic Development Canada's licence-exempt RSS(s). Operation is subject to the following two conditions:</p> <p>(1) This device may not cause interference.</p> <p>(2) This device must accept any interference, including interference that may cause undesired operation of the device.</p>
Correspondence of the responsible party in USA	
Company	Roborock Technology Co.
Address	108 West 13th Street, Wilmington, Delaware 19801.
Email	support@roborock.com

FCC/IC Statement

Warning

Any changes or modifications to this unit not expressly approved by the party responsible for compliance could void the user's authority to operate the equipment.

This equipment has been tested and found to comply with the limits for a Class B digital device, pursuant to part 15 of the FCC Rules. These limits are designed to provide reasonable protection against harmful interference in a residential installation. This equipment generates, uses and can radiate radio frequency energy and, if not installed and used in accordance with the instructions, may cause harmful interference to radio communications. However, there is no guarantee that interference will not occur in a particular installation. If this equipment does cause harmful interference to radio or television reception, which can be determined by turning the equipment off and on, the user is encouraged to try to correct the interference by one or more of the following measures:

- Reorient or relocate the receiving antenna.
- Increase the separation between the equipment and receiver.
- Connect the equipment into an outlet on a circuit different from that to which the receiver is connected.
- Consult the dealer or an experienced radio/TV technician for help.

Parts List

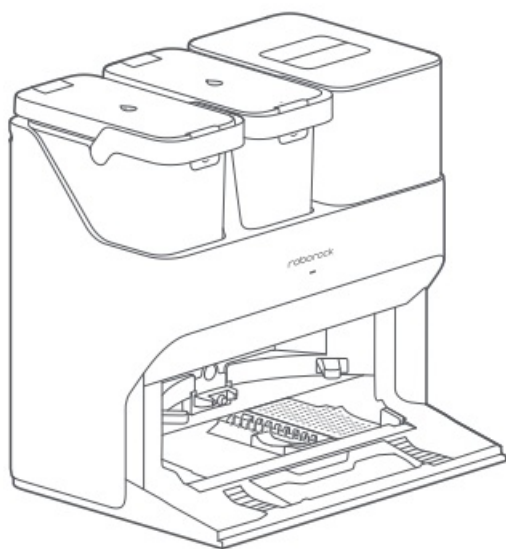

Dock
(Disposable Dust Bag
Pre-Installed)

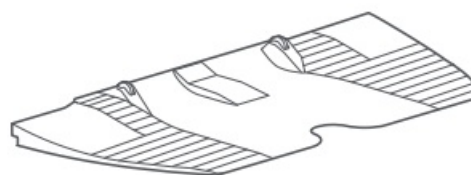

Dock Base

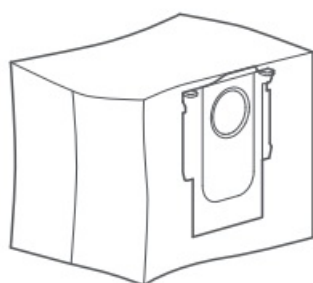

Disposable Dust Bag

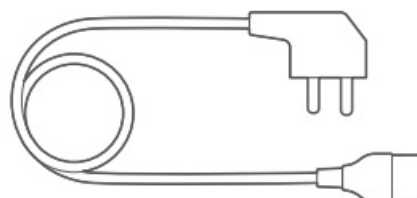

Power Cable

Product Overview

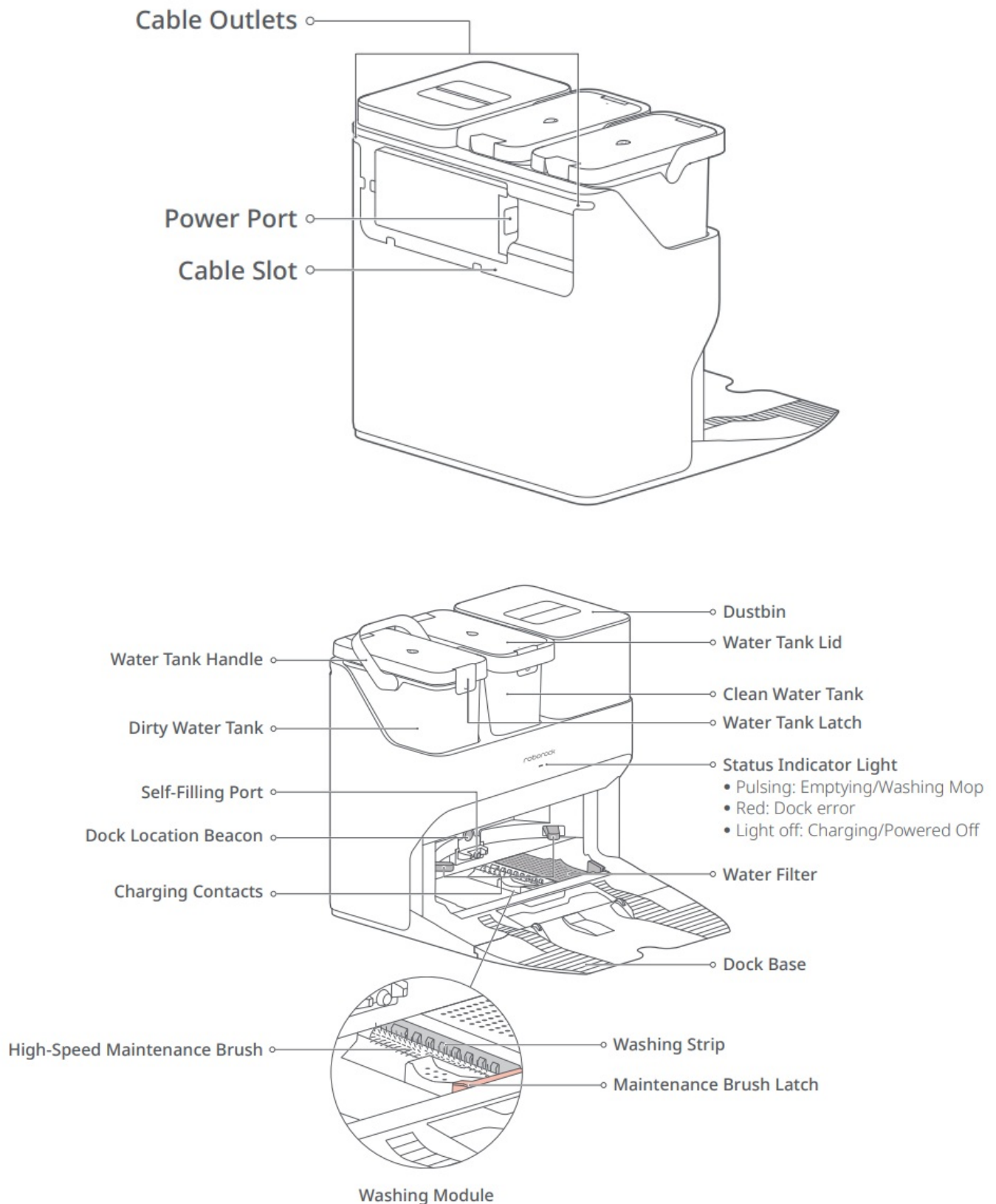

Installation

Assembly

1. Place the dock on a hard and flat floor, and remove the foam used to secure the high-speed maintenance brush components in shipment at the bottom.

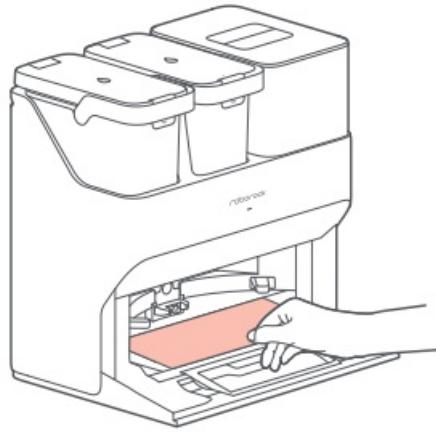

2. Attach the base by pressing down both sides of the base firmly, and then pressing the connecting part in the middle until you hear a click.

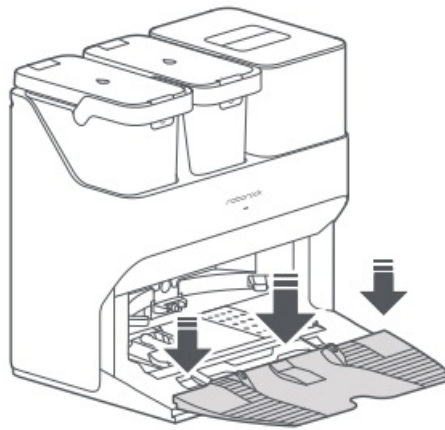

Note: Remove the water tanks and the dustbin before moving the dock.

3. Connect the power cable to the back of the dock, and keep excess cable inside the storage slot.

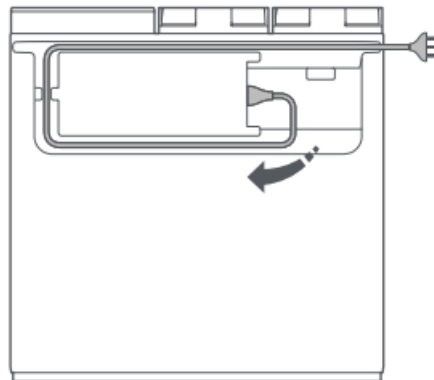

Note: Power cable can exit at either side.

Placement of the Dock

Place the dock on a hard and flat floor (wood/tile/concrete etc.), flat against a wall. Keep at least 0.5 m (1.6 ft) of clearance on either side, 1.5 m (4.9 ft) in front, and 1 m (3.3 ft) above. Make sure the location has good WiFi for a better experience with the mobile app, and then plug it in.

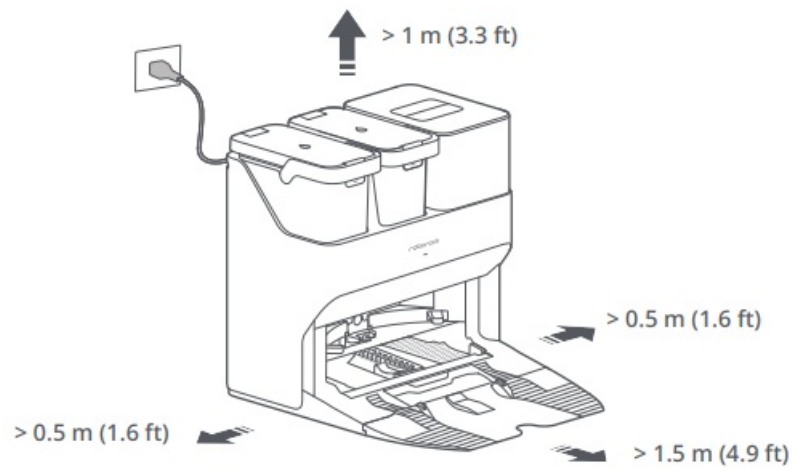

Notes:

- If the power cable hangs vertically to the ground, it may be caught by the robot, causing the dock to be moved or disconnected.
- The dock indicator is on when the dock is powered on, and off when the robot is charging.
- The dock indicator turns red if an error occurs.
- Place the dock on a flat floor away from fire, heat, and water. Avoid narrow spaces or locations where the robot may be suspended in the air.
- Placing the dock on a soft surface (carpet/mat) may cause the dock to tilt over and cause problems docking and departing.
- Keep the dock away from direct sunlight or anything that may block the dock location beacon; otherwise, the robot may fail to return to the dock.
- Do not use the dock without clean water tank, dirty water tank, high-speed maintenance brush, dustbin, dust bag or water filter.
- Maintain the dock according to the maintenance instructions. Do not clean the dock with a wet cloth or tissue.
- All docks are subject to water-based tests before leaving the factory. It is normal that a small amount of water remains in the waterway of the dock.

Preparing for Auto-Emptying

1. When auto-emptying for the first time or if the dock has not emptied for an extended period, empty the robot dustbin manually and clear the air inlet of any debris to ensure optimum performance.

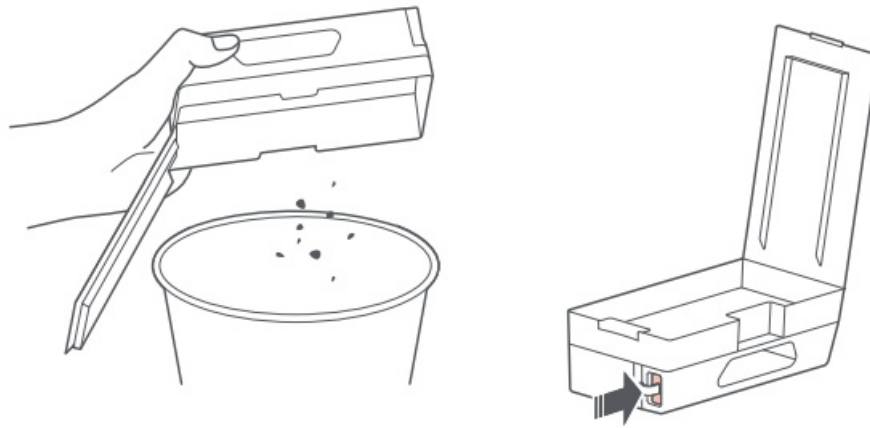

2. Remove the plate covering the air inlet in the robot.

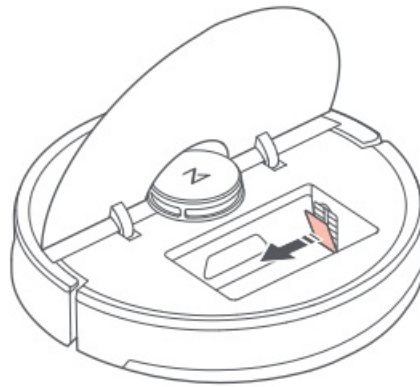

Powering On & Charging

Press and hold the  button to power on the robot. Wait until the power light is steady, and then place the robot on the dock to charge. The robot is equipped with a high-performance lithium-ion rechargeable battery pack. To maintain battery performance, keep the robot charged during normal use.

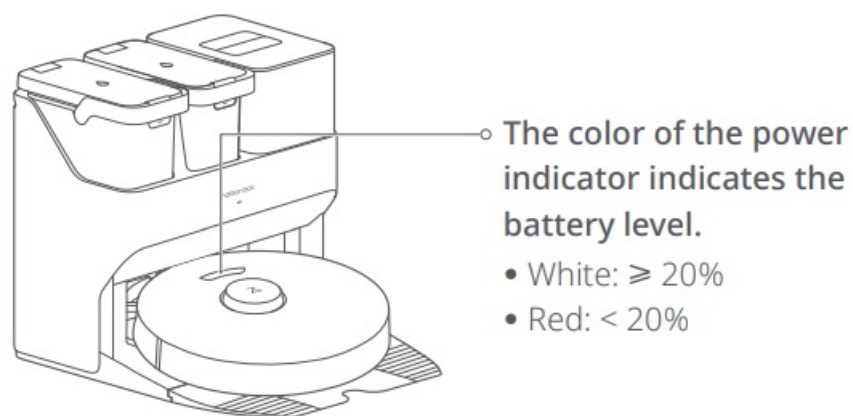

Note: The robot may not be turned on when the battery is low. In this case, connect the robot to the dock.

* Images are for illustration purposes only and may not exactly represent the product.

Instructions for Use

Filling the Water Tank

Open the clean water tank. Fill with water until the Max line. Close the lid, lock the latch, and fit the tank back in place.

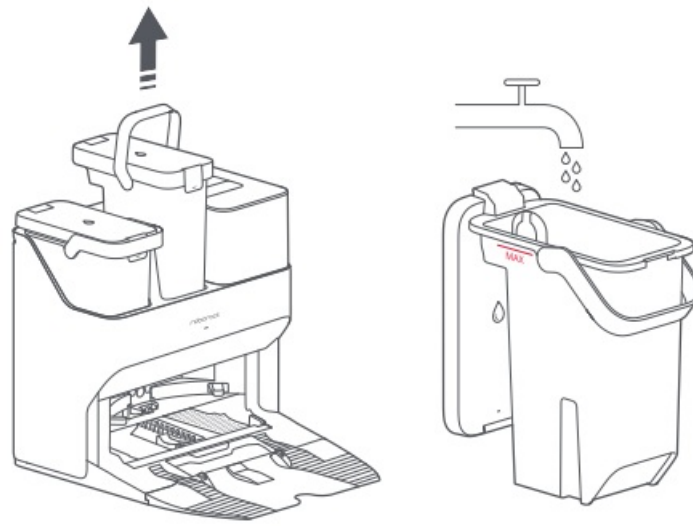

Notes:

- To prevent corrosion or damage, only use the Roborock branded floor cleaner in the water tank.
- To avoid water tank deformation, do not place hot water in the tank.
- If water marks remain on the water tank, wipe them clean before reinstallation.

Auto Mop Washing

During cleaning, the robot automatically determines when it should return to dock for mop washing and water tank refilling to maximize its mopping performance.

Note: To allow the robot to wash the mop automatically, start the robot from the dock once it is fully charged. Do not move the dock during cleaning.

Manually Activated Mop Washing

During cleaning, press any  button to pause, then press and hold the button to send the robot back for mop washing.

Auto-Emptying

Auto-emptying will begin when the robot returns to the dock after cleaning.

Notes:

- If the dock has not emptied for an extended period, empty the robot dustbin manually and clear the air inlet of any debris to ensure optimum performance.
- If necessary, auto-emptying can be disabled in the app.

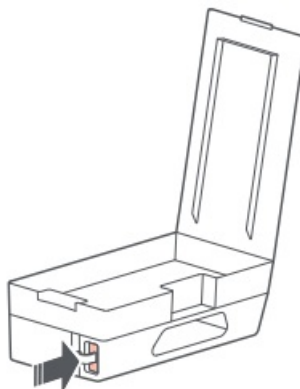

Manually Activated Emptying

Emptying can be triggered manually by pressing the button while the robot is charging.

Note: Avoid frequent manual emptying.

Stopping Emptying

Press any button to stop emptying.

Charging

After cleaning, the robot will automatically return to the dock to charge.

The power indicator will pulse as the robot charges.

Note: If the robot fails to find the dock, it will automatically return to its starting location. Place the robot on the dock manually to recharge.

Routine Maintenance Frequency

To ensure optimal performance of the dock, refer to the following table for routine maintenance:

Parts	Clean Frequency	Replacement Frequency
Water Filter	Clean as needed	/
Clean Water Tank and Dirty Water Tank	Clean as needed	/
High-Speed Maintenance Brush	Clean as needed	Every 6-12 months
Disposable Dust Bag	/	Every 1-2 months
Dock Charging Contacts, Location Beacon , and Robot Body	Clean every month	/

Routine Maintenance

Moving the Dock

Remove the water tanks and the dustbin before moving the dock. Grip the handle on the back with one hand and the inner side of the front, as shown. Do not grip the base because as it is not designed for lifting.

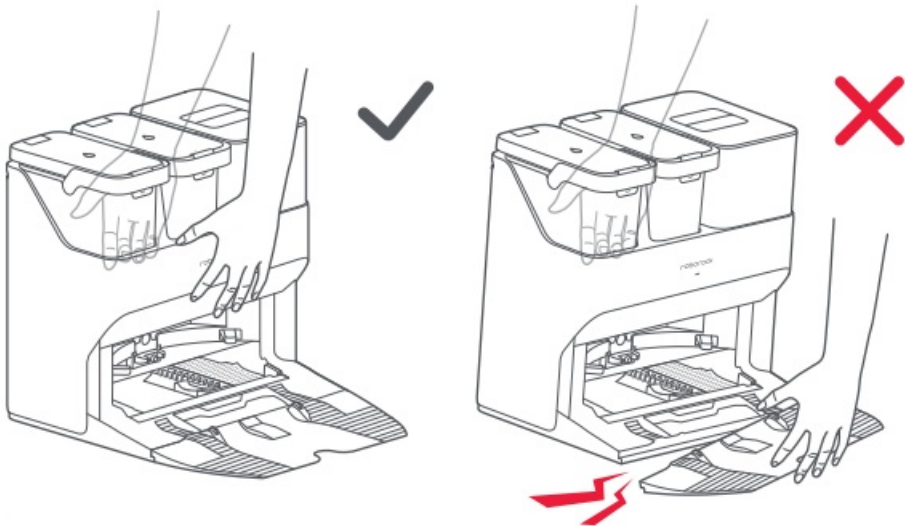

Water Tank

Clean the dirty water tank as needed. Open the dirty water tank lid and pour out the dirty water. Fill the tank with clean water, close the lid, lock it, and shake. Pour out the dirty water. Close the lid and then re-install.

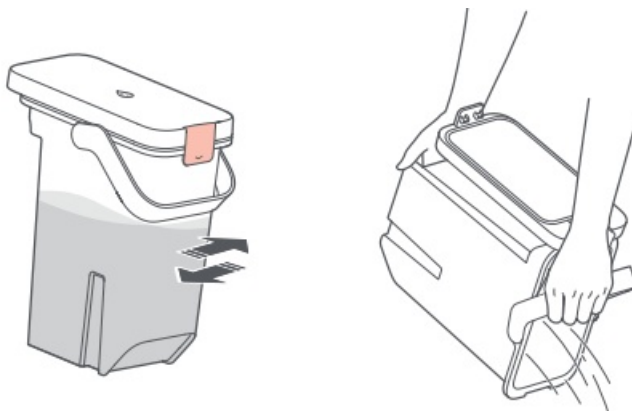

Charging Contact Areas

Use a soft, dry cloth to wipe the charging contacts on the dock.

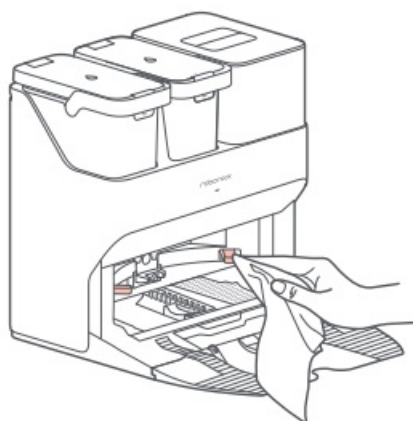

High-Speed Maintenance Brush

1. Lift the high-speed maintenance brush latch and remove the brush, as shown below.

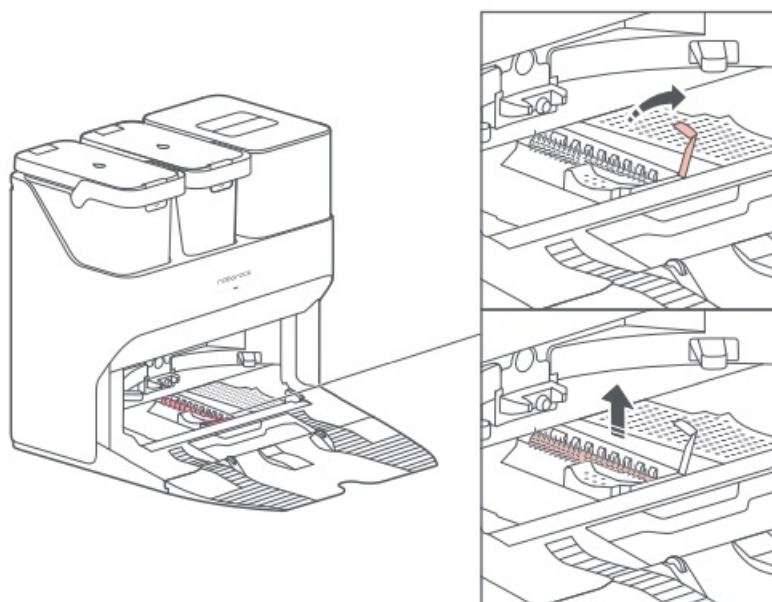

2. Remove any entangled objects in the high-speed maintenance brush and rinse it clean. Reinstall the brush and

latch it in place.

Water Filter

Unlock the water filter and remove it for washing. Use a soft, dry cloth to wipe the cleaning tank, and then reinstall the filter. Press down the filter until you hear it lock with a click.

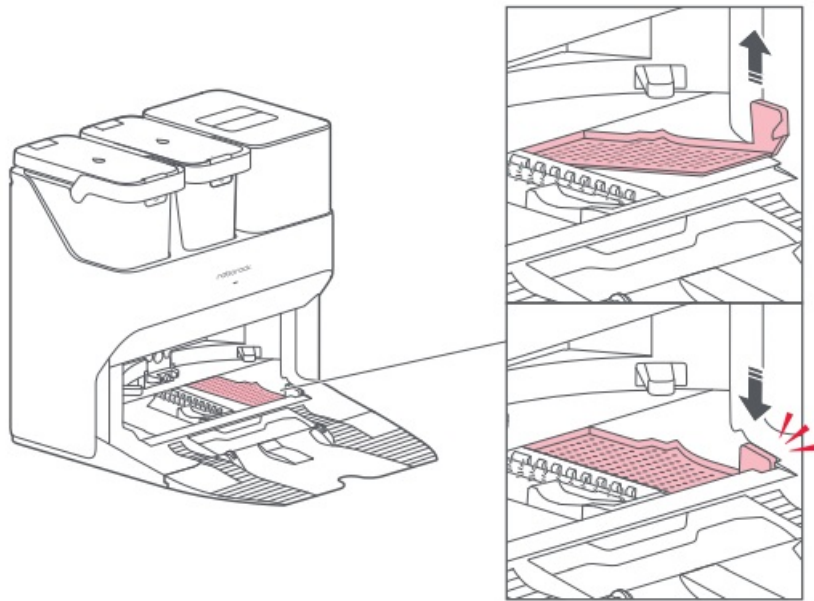

Replacing the Disposable Dust Bag

Note: Replace the disposable dust bag when it is full.

1. Lift the dustbin.
2. Remove the bag vertically as shown.

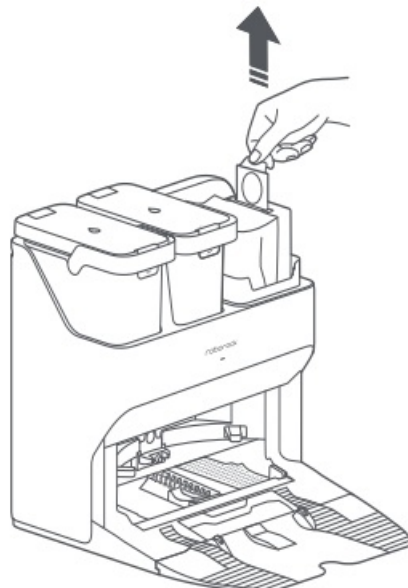

Note: Pulling the dust bag handle to remove the bag will seal the bag to prevent leakage.

3. Discard the dust bag.
4. Clean around the filter with a dry cloth.

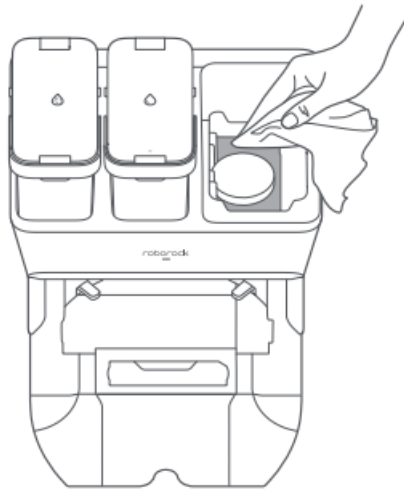

5. Slot in a new disposable dust bag as shown. Slide until it reaches the bottom of the slot.

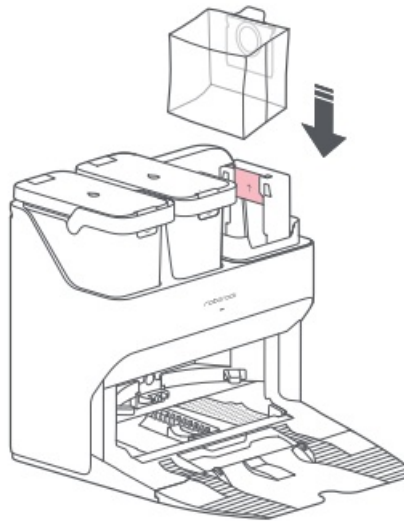

6. Reinstall the dustbin securely.

Note: Always install a dust bag before putting back the dustbin top lid to avoid autoemptying without the bag. You can also disable auto-emptying in the app.

Cleaning the Air Duct

Follow the following steps to clean the air duct and avoid blockages.

1. Remove the clean water tank, dirty water tank, and dustbin.

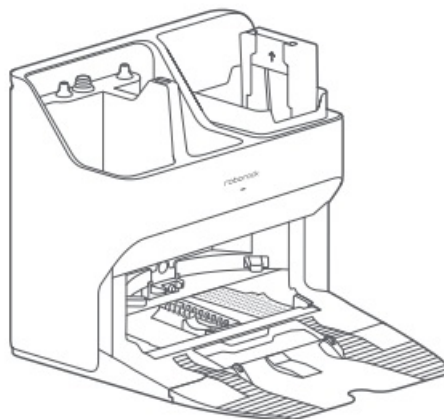

2. Remove the water filter and wipe off any water marks with a cloth.

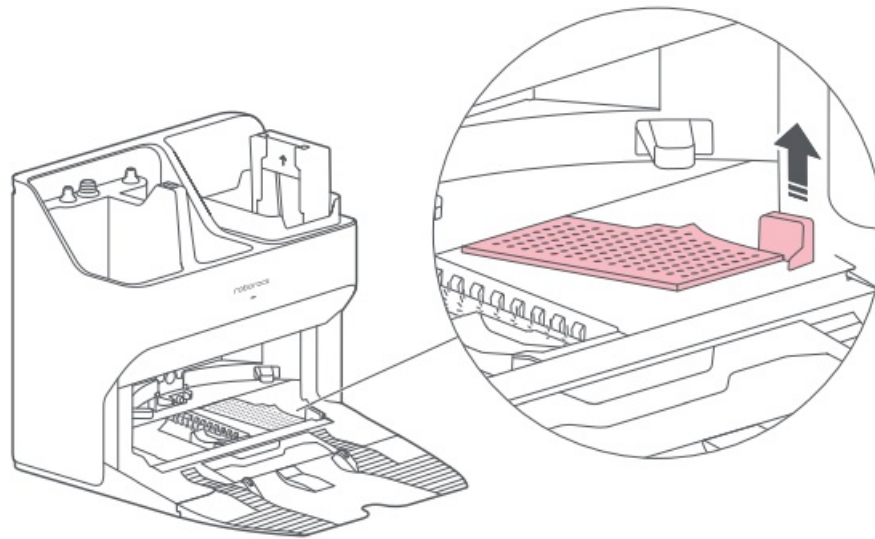

3. Carefully place the the dock upside down on a hard floor covered with a soft towel.

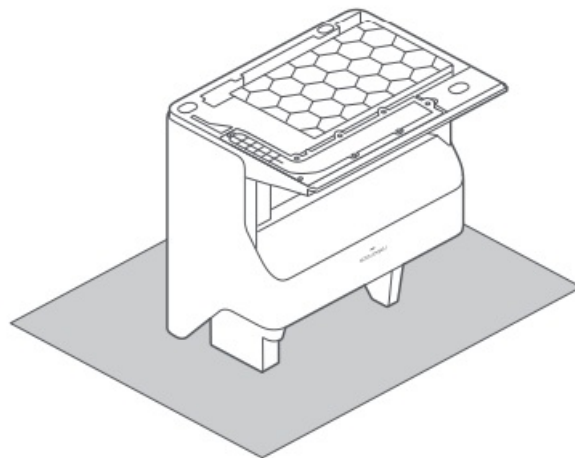

4. Unscrew the eight screws and remove the cover.

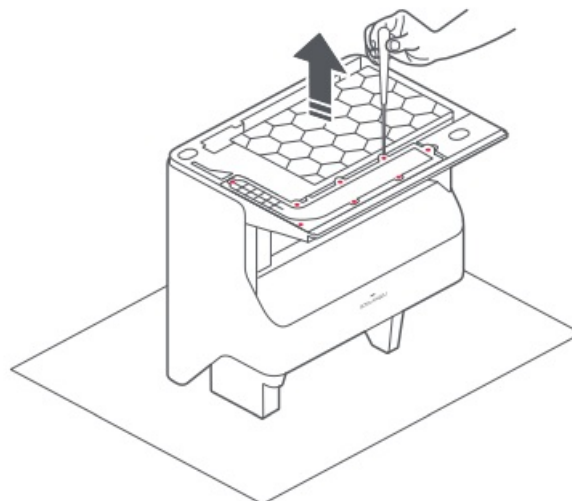

5. Wipe the air duct and duct cover with a dry cloth.

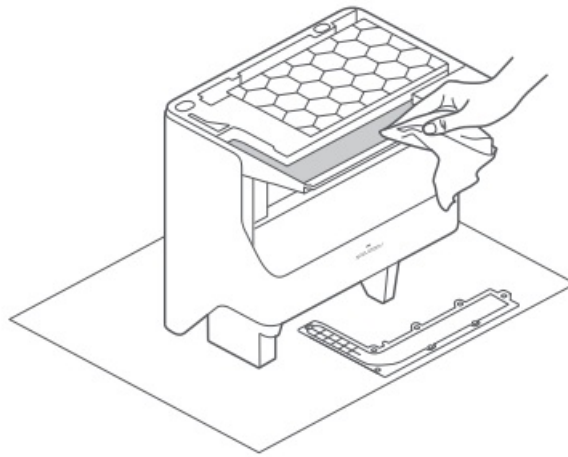

6. Re-install the cover and screw it back in place.

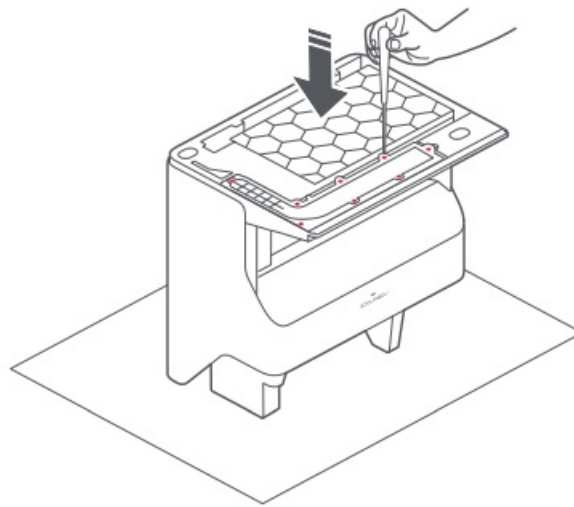

Basic Parameters

Empty Wash Fill Dock	
Name	Empty Wash Fill Dock
Model	EWFD01LRR, EWFD02LRR
Rated Input Voltage	120VAC
Rated Frequency	50-60Hz
Rated Input (Charge)	9.5A
Rated Output	0.75A
Charging Battery	20VDC 1.8A
Rated Input (Dust Collection)	14.4V/5200mAh lithium-ion battery

Troubleshooting

Dock Error

The dock indicator will be steady red. Follow the robot voice instructions and the prompts in the app for troubleshooting.

Conditions	Possible Causes & Solutions
The LED status indicator light is steady red.	<ol style="list-style-type: none"> 1. The dustbin or dust bag is not in place. Check and correct installation. 2. Voltage error. Check that local voltage meets the requirements listed on the dock. 3. Check clean water tank placement or refill as required. 4. Check dirty water tank placement or empty as required. S. Check that the water filter has been correctly installed.
Reduced emptying performance or unusual noise when emptying.	<ol style="list-style-type: none"> 1. The robot dustbin has not been replaced with the auto-empty dustbin. Use the auto-empty dustbin. 2. The plate covering the air inlet has not been removed. Remove the plate. 3. The main brush or main brush cover is not properly installed. Check and correct installation. 4. The filter, air duct, suction inlet, air inlet, or dustbin is blocked. Clean to remove blockages.
Robot voice alert: Error 42. Maintenance brush jammed. Clean it and remove blockages.	<ol style="list-style-type: none"> 1. If the brush stops at the left side, it may be jammed. Remove any items jamming it. 2. If the brush stops at the right side, the filter may be blocked or is not installed in place. Clean and correct installation.
Reduced mop washing performance.	<ol style="list-style-type: none"> 1. The mop is not attached properly. Reinstall. 2. The floor is dirty. Change the mop washing mode to "Deer in the app for better cleaning.
Auto-emptying is not working.	<ol style="list-style-type: none"> 1. Auto-emptying is disabled. Check in-app settings. 2. Dock dustbin is not installed. Check and install. 3. Auto-emptying will not be triggered if the robot returns to the dock without cleaning. 4. The robot will not auto-empty after returning to the dock in Do Not Disturb (DND) mode. Adjust cleaning or DND duration, or start emptying manually.

The mop is not washed.	<ol style="list-style-type: none"> 1. The mop will not be washed if not used. 2. The robot will not return to the dock for mop washing if it does not start from the dock or no dock is found on the app map. 3. Check tank placement and refill or empty as required. 4. Check that the water filter has been correctly installed.
------------------------	---

If the problem persists after using the recommendations in the table above, contact our support team at:
support@roborock.com (United States/Canada/Non-Europe)
1-855-960-4321 (United States only)
1-833-421-1915 (Canada only)

Disposal

Correct disposal of this product, should not be disposed with other household wastes. To return your used device, please use the return and collection systems or contact the retailer where the product was purchased. They can take this product for environmentally safe recycling.

Empty Wash Fill Dock
Product Model: EWFD01LRR, EWFD02LRR
Manufacturer: Beijing Roborock Technology Co., Ltd.
Address of Manufacturer: Floor 6, Suite 6016, 6017, 6018, Building C, Kangjian Baosheng Plaza,
No.8 Heiquan Road, Haidian District, Beijing, P.R. China
For more product information, visit our website: www.roborock.com
For after-sales support, contact our support team at:
support@roborock.com (United States/Canada/Non-Europe)
1-855-960-4321 (United States only)
1-833-421-1915 (Canada only)



4.03.0411V6.0

Documents / Resources

	roborock EWFD01LRR Empty Wash Fill Dock [pdf] User Manual EWFD01LRR, Empty Wash Fill Dock, Wash Fill Dock, Empty Fill Dock, Fill Dock, Dock
---	--

References

- [Roborock US Official Site | Intelligent Robot Vacuum Cleaner and Mop](#)