

[Skip to content](#)

Manuals+

User Manuals Simplified.



T11 Profile MFS Handles



ROBIN T11 Profile MFS Handles User Manual

[Home](#) » [ROBIN](#) » ROBIN T11 Profile MFS Handles User Manual 

Contents

[1 ROBIN T11 Profile MFS Handles](#)

[2 Product Information](#)

[3 Product Usage Instructions](#)

[4 Frequently Asked Questions](#)

[5 Safety instructions](#)

[6 Parts](#)

[7 Installation](#)

[8 FollowSpot mode](#)

[9 Technical Specifications](#)

[10 Accessories](#)

[11 Documents / Resources](#)

[11.1 References](#)

[12 Related Posts](#)



ROBIN T11 Profile MFS Handles



Product Information

Specifications:

- Model: Robin T11 Manual FollowSpot (MFS) handles
- Version: 1.4
- Intended Use: Professional indoor use only

Product Usage Instructions

Safety Instructions

CAUTION! The Robin T11 MFS handles are designed for indoor professional use only. Do not use for household purposes. Ensure two workers install the T11 fixture on the assembled tripod for safety.

Parts of the Robin T11 MFS handles

The parts include: Modified gel frame adaptor, Modified yoke, Side handle with fader, Rear handle, Securing part with weight, Spigot with locks.

Installation

1. Disconnect the fixture from mains before installation.
2. Remove the original gel frame adaptor and screw the modified gel frame adaptor in place.
3. Position the modified gel frame adaptor to determine the handle position.
4. Replace the original yoke with the new yoke ensuring correct orientation.
5. Adjust the tripod height and leg distance using the adjusting locks.
6. Install the spigot to the tripod and fasten the T11 fixture using the new yoke.

Installation Detailed Steps:

1. Insert spigot with adaptor to the tripod.
2. Secure spigot position and insert washer on the pin.
3. Ensure all locks are tightened and peg is in the correct position before placing the fixture on the tripod.
4. Fasten the T11 fixture on the adaptor using quarter-turn locks and secure with a nut.

Frequently Asked Questions

- **Q: Can the Robin T11 MFS handles be used outdoors?**
 - A: No, the handles are designed for indoor professional use only.
- **Q: How many workers are recommended for installing the T11 fixture on the tripod?**
 - A: It is recommended to have two workers for installing the T11 fixture for safety reasons.

FOR YOUR OWN SAFETY, PLEASE READ THIS USER MANUAL CAREFULLY BEFORE YOU INSTALL THE PRODUCT.

Safety instructions

CAUTION!

- The ROBIN T11 MFS handles were designed for indoor use only.
- The product is for professional use only, it is not for household use.
- This product has left our premises in absolutely perfect condition. In order to maintain this condition and to ensure a safe operation, it is absolutely necessary for the user to follow the safety instructions and warnings written in this manual.
- The manufacturer will not accept liability for any resulting damages caused by the non-observance of this manual or any unauthorized modification to the product.
- Refer servicing to qualified service personnel.
- Operate the ROBIN T11MFS handles only after having familiarized with their functions. Do not permit operation by persons not qualified for operating the ROBIN T11 MFS handles. Most damages are the results of unprofessional operation!
- Please use the original packaging if the ROBIN T11 MFS handles are to be transported.
- Please consider that unauthorized modifications on the fixture are forbidden due to safety reasons!

Warning!

Two workers should install the T11 fixture on the assembled tripod.

Parts

Parts of the Robin T11 MFS handles

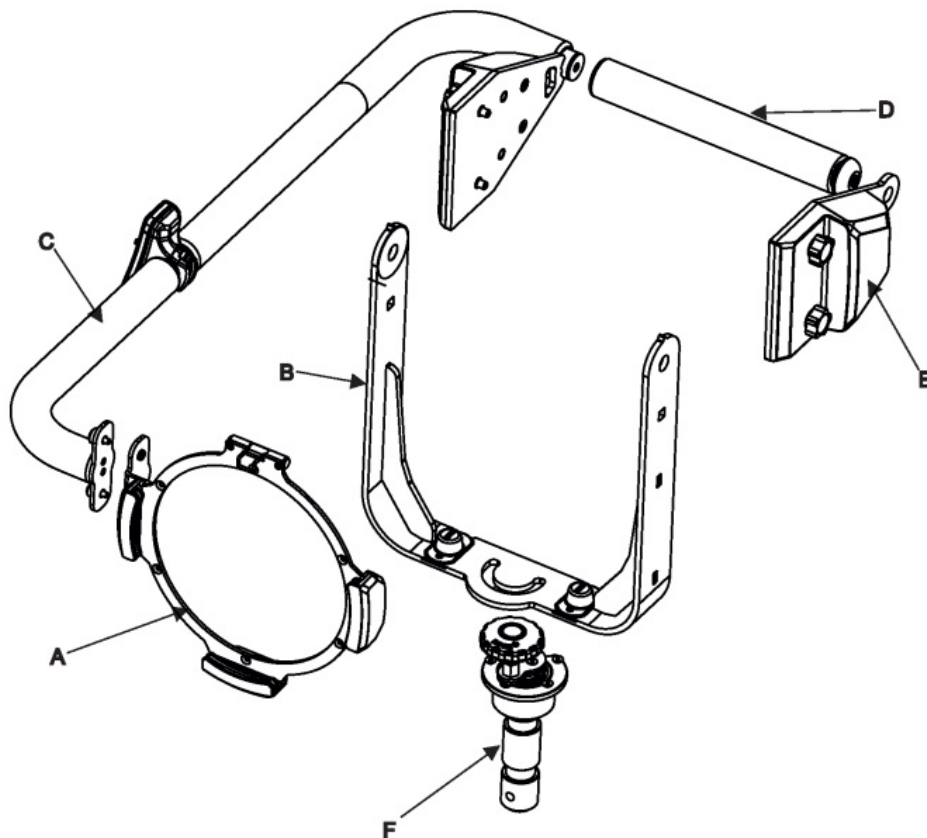

- A – Modified gel frame adaptor
- B – Modified yoke
- C – Side handle with fader
- D – Rear handle
- E – Securing part with weight
- F – Spigot with locks

Installation

The Robin T11 MFS handles have to be installed by qualified workers on the Robin T11 fixture (Profile, PC/Fresnel) only.

Important!

Disconnect the Robin T11 fixture from the mains before installing the Robin T11 MFS handles.

Note: The MFS handles can be installed on both sides of the Robin T11 fixture – position of MFS handles depends on the orientation of the modified gel frame adaptor (A).

1. Disconnect the fixture from the mains.
2. Remove the original gel frame adaptor (1) by unscrewing four screws (2) and screwing the modified gel frame adaptor (A). Use the same screws (2) from original gel frame adaptor. The modified gel frame adaptor (A) can be turned over to get it to the desired orientation. The orientation of the modified gel frame adaptor (A) determines the position of the side handle (C).
3. Check that all crews are fully tightened

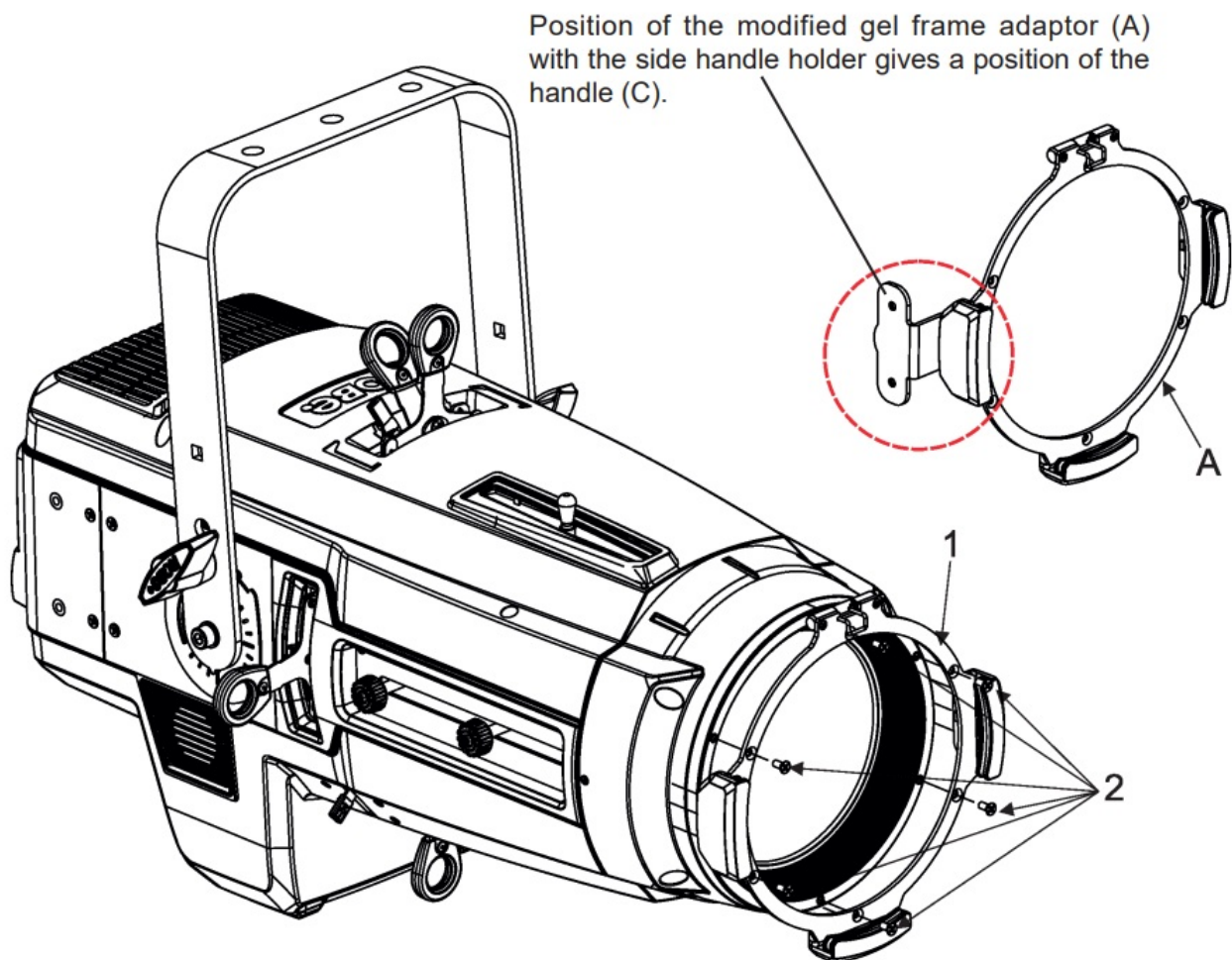

4. Remove the original yoke (3) by unscrewing two tilt locks (4) with washers (5) and bolts M8 (6) and two hexagon socket screws M8x16 (7) with washers (8) and spacers (9).
5. Insert and screw the new yoke (B) by means of the same parts (4)-(9) which were used for the original yoke (3).
Important! The semi-circular slot (10) in the new yoke (B) has to be oriented to the front lens of the fixture as shown on the

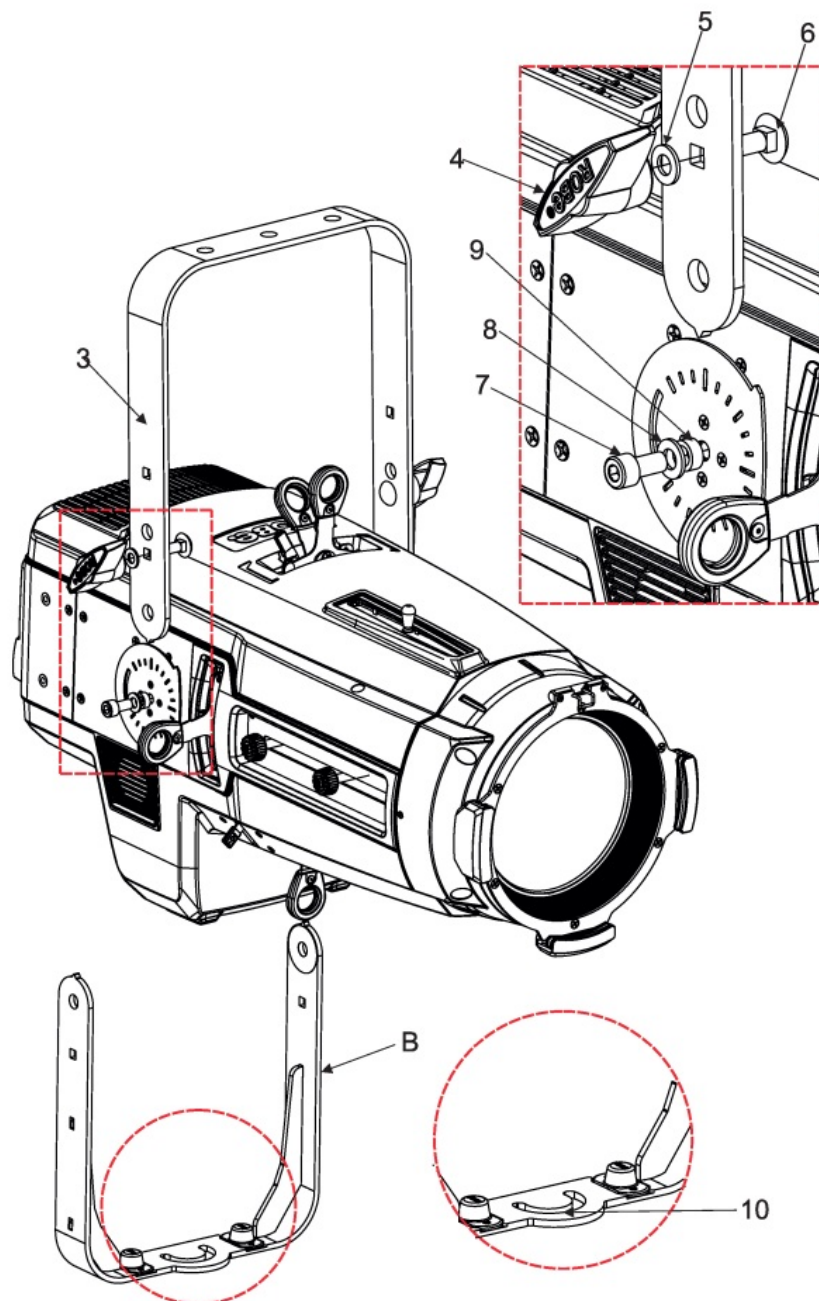

picture below.

6. Unfold and adjust height of the tripod and distance of legs (11) by means of adjusting locks (12,13, 14,15, 16). Check that all locks (12, 13, 14, 15, 16) are fully tightened before placing the Robin T11 fixture on the tripod.

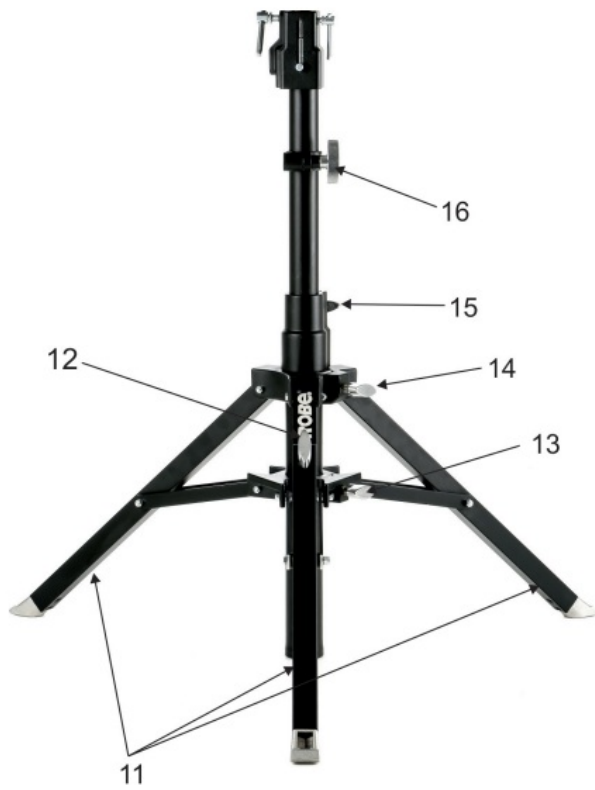

7. Install the spigot (F) to the tripod and fasten the T11 fixture on the spigot by means of the new yoke (B). As the T11 fixture is heavy, to workers should place and secure the T11 fixture on the tripod. Detailed procedure is described below.

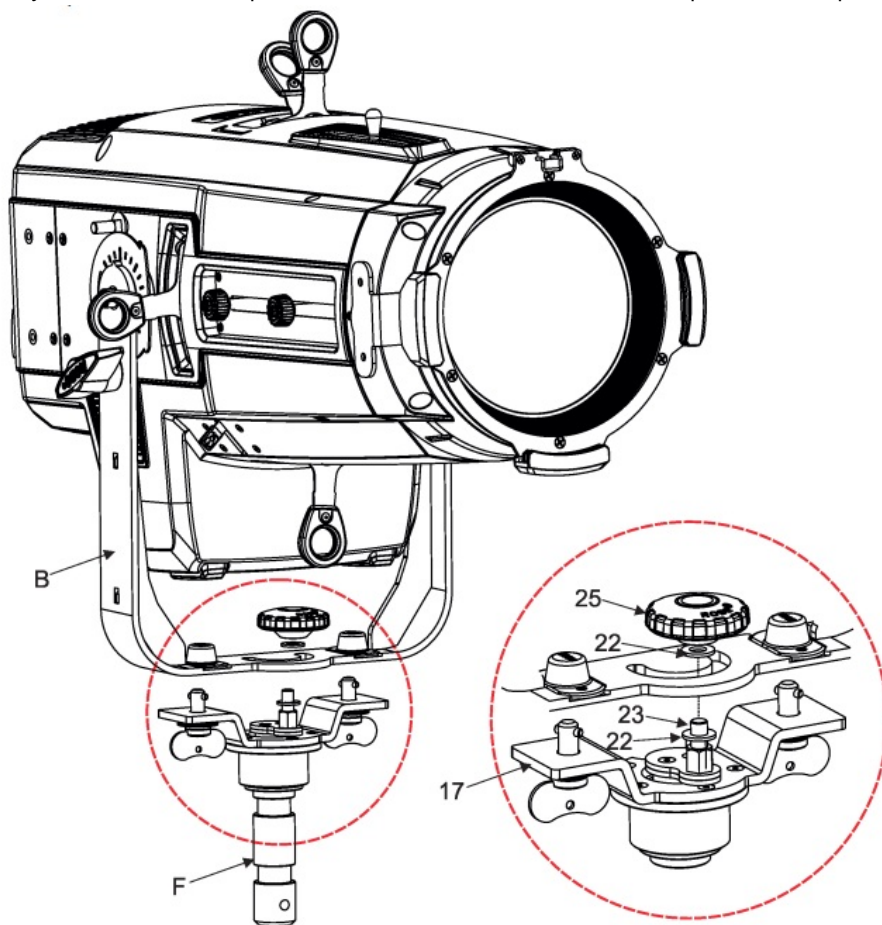

- Insert the spigot (F) with adaptor (17) to the tripod. The opening (18) has to be oriented as shown on the picture.

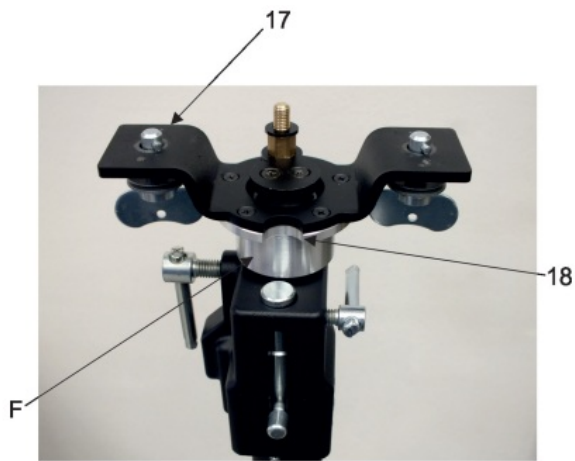

- Move the peg (21) up and secure its position by means of the lock (20). Secure the spigot in the tripod by means of the lock (19).
- Insert the washer (22) on the pin (23). Check that locks (19, 21) are fully tightened and the peg (21) is in the upper position

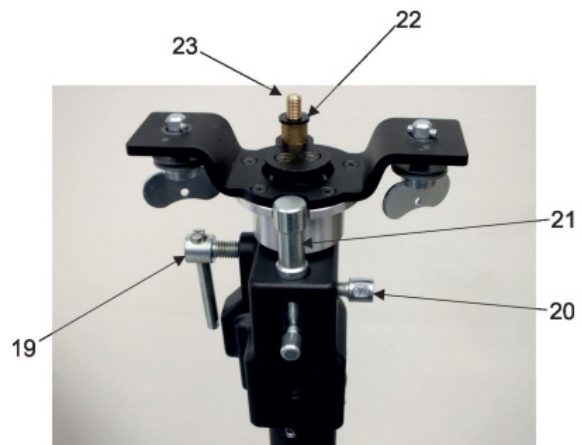

before placing the Robin T11 fixture on the tripod.

- Place the T11 fixture with installed new yoke (B) on the adaptor and fasten it by means of two quarter-turn locks (24).

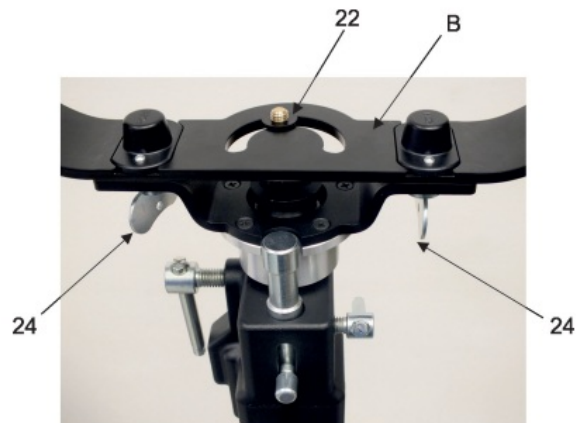

- Insert the washer (22) on the pin (23).

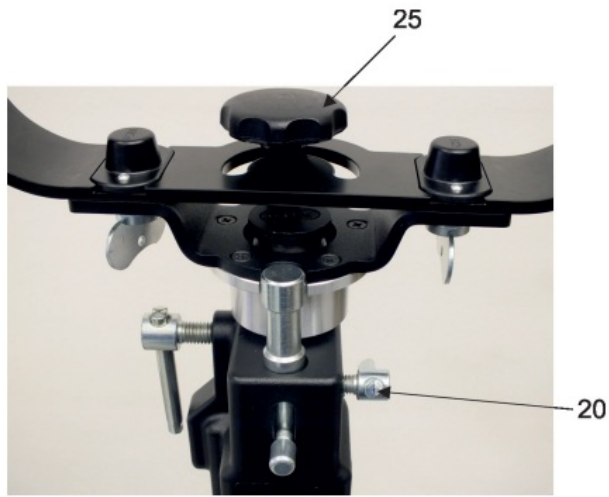

- Screw the nut (25) on the pin (23).



- Release the lock (20) and move the peg (21) down.

Note: The T11 fixture with installed new yoke (B), spigot (F) and adaptor (17) can be installed in a hanging position on a truss (without tripod). Use a suitable professional coupler for 28.8 mm spigot. During installation please proceed in accordance with the coupler producer instructions.

8. Screw the side handle (C) to the T11 fixture by means of two screws (27) and by means of two screws (26) to the gel frame

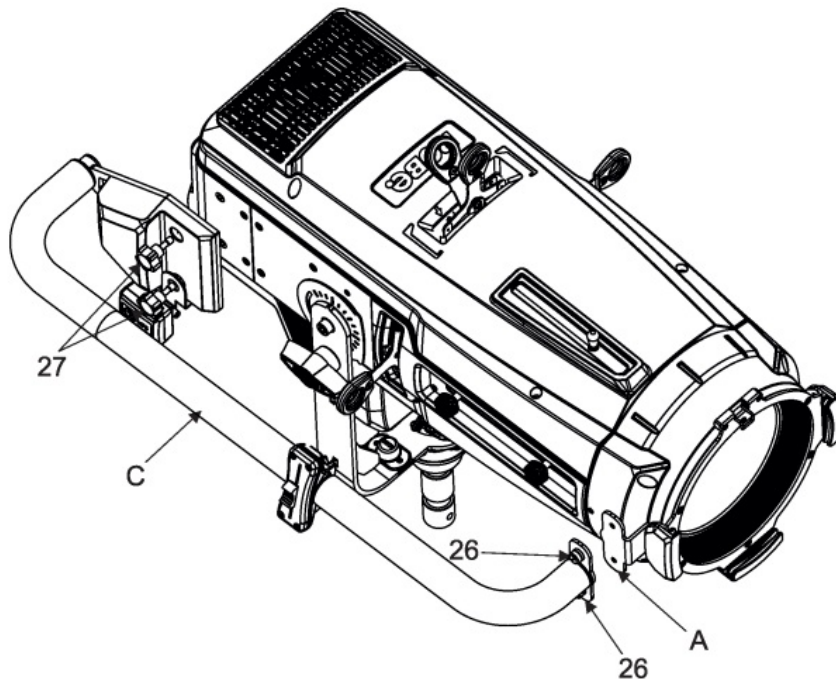

adaptor (A).

9. Screw the rear handle (D) to the side handle (C). Unscrew the screw (28) and remove the cap (29).

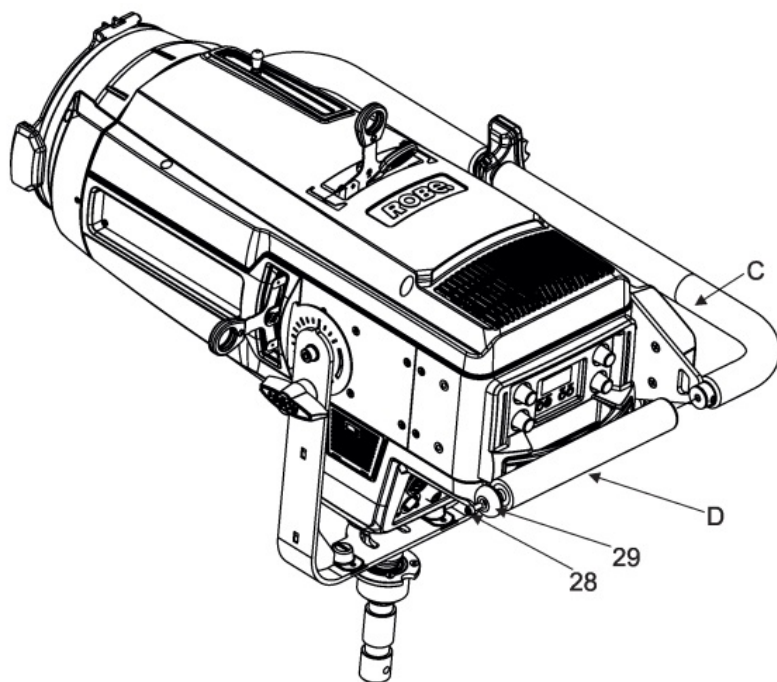

10. Screw the part with weight (E) on the rear side of the T11 fixture by means of two screws with plastic heads (33). Screw the cap (29) back to the rear handle (D) by means of the screw (28).

Note: If you have an older version of the T11 fixture, there are not holes with thread in the housing of the T11 fixture for two screws with plastic heads (33) of the part with weight (E). In this case you have to remove the rear part (31) of the part with weight (E) by unscrewing two screws (32) and two screws with plastic heads (33) from the part with weight (E). From the fixture housing, unscrew two screws (30) and used them to screw the rear part (31) on the housing. Screw the cap (29) back to the rear handle (D) by means of the screw (28). Fasten the weight to the rear part (31) by means of two screws (32) and screw two

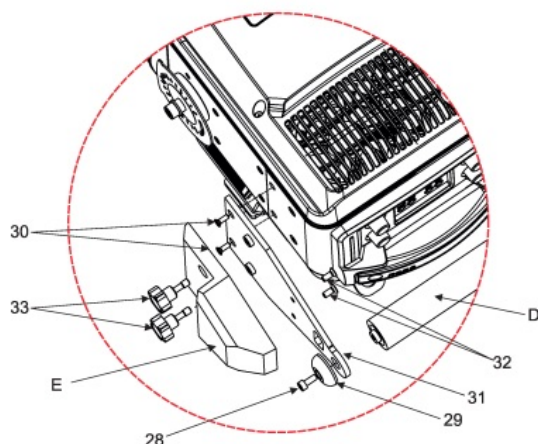
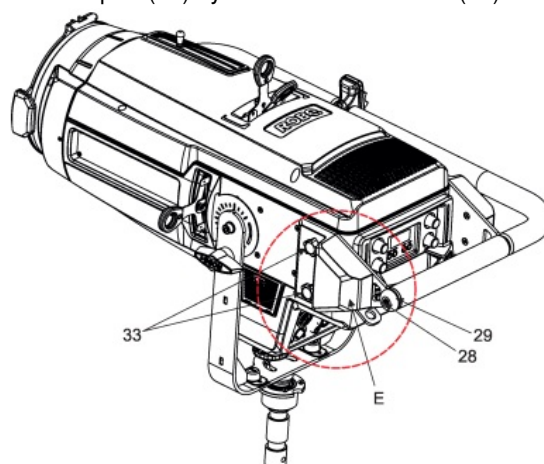

screws with plastic heads (33) back to the weight (E).

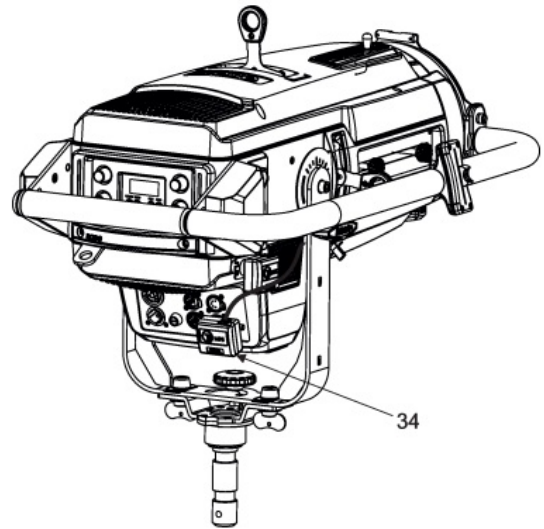

11. Connect the MFS box with cable (34) to the DMX input of the fixture

FollowSpot mode

The T11 device can be switched to the FollowSpot mode to make easier control of the fixture with the ROBIN T11 MFS handles installed on the fixture. In the FollowSpot mode, the fixture is controlled by means of four control knobs and the fixture's effects cannot be controlled by DMX. To enter the FollowSpot mode, press any three control knobs at the same time for two seconds and the first page of the FollowSpot mode will be displayed on the screen with controllable items next to corresponding knobs. After pressing any knob, its blinking value will be displayed and can be changed by the knob. Adjusted value can be saved by pressing the knob. To switch to the second page, press the NEXT button. To return back, press the PREV button.

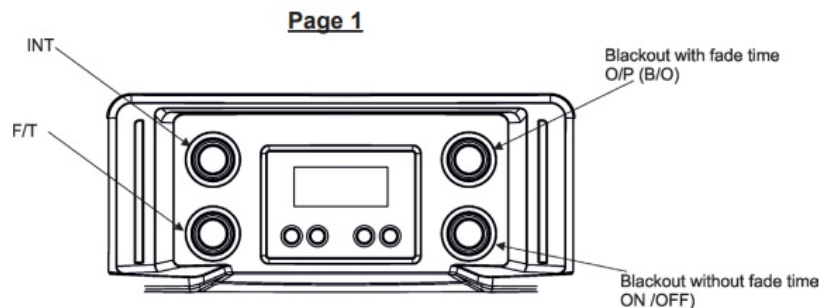

Control pages overview:

- INT (Max. Light Intensity), values: 0%-99%, Blackout on/off with fade time, values: B/O (blackout) O/P (open) MAX Default=B/O
 - Default = MAX The knob works as switch – blackout ON, blackout OFF
- F/T (Fade Time*), values: 0; 0.5; 1.0....10 sec. Blackout on/off without fade time, values: ON, OFF
 - Default=0 Default=OFF
- Fade Time – set time will effect the blackout knob O/P (B/O) in both directions (from open to close and from close to open).

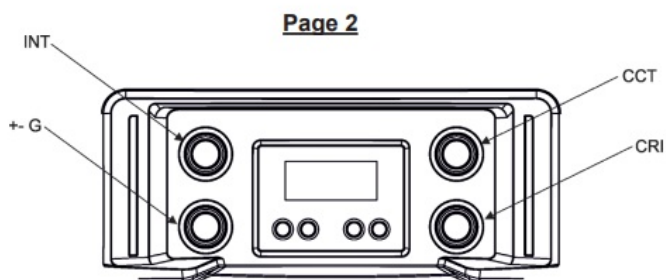

- INT – the knob is without function CCT (Correlated Color Temperature), values: 2700K-8000K
 - Default=2700
- +/- G (Green correction), values: -99 – +99 CRI (Colour Rendering Index), values: MIN, MAX, OPT

Page 3

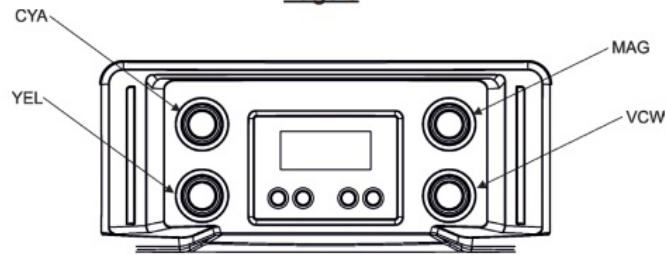

- Default=0 Default=MIN
- CYA (Cyan), values:0%-99%, MAX MAG (Magenta), values:0%-99%, MAX
 - Default=0% Default =0%
- YEL (Yellow), values:0%-99%, MAX VCW (Virtual Colour Wheel), 4, 10, 19...793, NOF
 - Default =0% Default=NOF (no function)

Page 4

Page 4

(If Drop-in gobo and iris module is used)

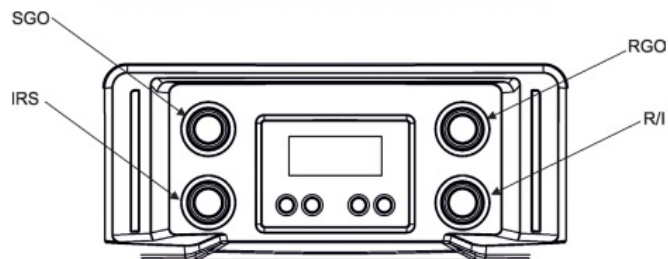

(If Drop-in gobo and iris module is used)

- SGO (Static Gobo), values: OPEN, 1,2,3 RGO (Rotating Gobo), values: OPEN , IN1, IN2, RT1, RT2
 - Default=OPEN Default =OPEN
- IRS (Iris), values: OPEN, 1%-99%, CLSD R/I (Gobo Rotation/Indexing), values: STOP, R1%-R99%,
 - Default=OPEN RMAX
 - Default =STOP

Page 5

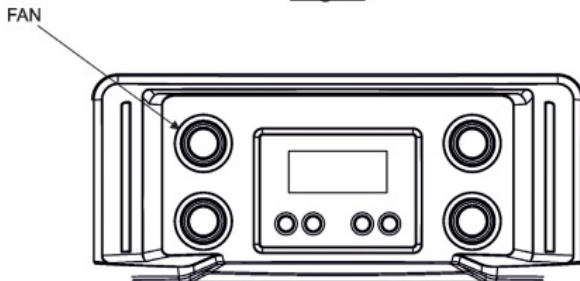

- FAN (Fans Operating Mode), values: 1%-99%, MAX
 - Default=AUTO
- To leave the FollowSpot mode, press any three control knobs at the same time for two seconds or press the ESCAPE button.
- After leaving the FollowSpot mode, the fixture's effects can be controlled by DMX. If you enter the FollowSpot mode again, values saved in last FollowSpot mode will be recalled.
- If the fixture is in the FollowSpot mode switched off and on again, it will remain in the FollowSpot mode.
- By pressing any two knobs for two seconds at the same time you will open a light output and the sign "Fast On" will be displayed. During the action you have to be in the standard display menu (you have to leave the FollowSpot mode before it).
- The fader on the handle allows you to control light intensity of the fixture (the fader is active after 10 seconds from moment of

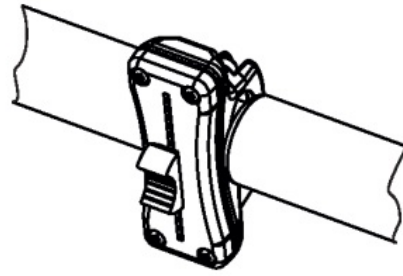

connecting MFS box with cable to the DMX input of the T11 fixture).

Technical Specifications

Supported fixtures

- Robin T11 Profile
- Robin T11 PC
- Robin T11 Fresnel

Weight

- 9.2 kg

Dimensions (mm) – ROBIN T11 MFS handles installed on the fixture

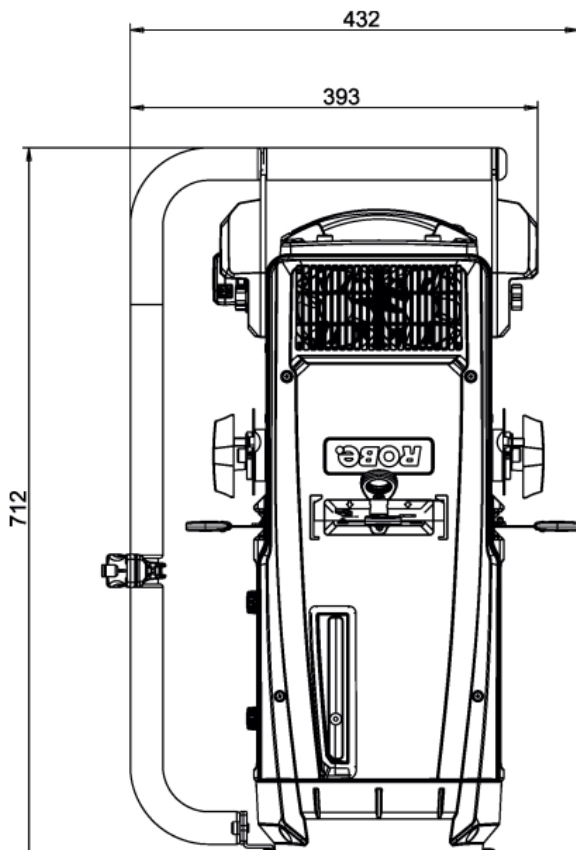

Accessories

- 1 x ROBIN T11 MFS handles
- 1 x Drop-in manual Iris T11 (P/N 10980677)
- 1 x T11 iris lever extension (P/N 10980889) – for sliding it onto iris lever
- 1 x User manual

ChangeLog

This section summarizes changes in the user manual.

A version of the manual	Date of issue	Description of changes
1.1	22/04/2022	Information about the reversible installation of the MFS handles was added.
1.2	12/07/2022	Fader added
1.3	19/09/2022	Iris module added
1.4	05/02/2024	Note about spigot truss installation added

February 5, 2024 Copyright © 2024 Robe Lighting – All rights reserved Specifications are subject to change without notice. Made in CZECH REPUBLIC by ROBE LIGHTING s.r.o. Palackeho 416/20 CZ 75701



QR code for user manual

- ROBE® lighting s.r.o.
- Czech Republic
- www.robe.cz

Documents / Resources



[ROBIN T11 Profile MFS Handles](#) [pdf] User Manual

T11 Profile MFS Handles, T11, Profile MFS Handles, MFS Handles, Handles

References

- [User Manual](#)

[Manuals+](#), [Privacy Policy](#)

This website is an independent publication and is neither affiliated with nor endorsed by any of the trademark owners. The "Bluetooth®" word mark and logos are registered trademarks owned by Bluetooth SIG, Inc. The "Wi-Fi®" word mark and logos are registered trademarks owned by the Wi-Fi Alliance. Any use of these marks on this website does not imply any affiliation with or endorsement.