



Roberts Stream 67L Smart Radio Sound System User Guide

[Home](#) » [ROBERTS](#) » Roberts Stream 67L Smart Radio Sound System User Guide



Stream 67L Smart Radio Sound System User Guide



Contents [[hide](#)]

- [1 Stream 67L](#)
- [2 What is in the Box?](#)
- [3 STEP 1 – Connect to the mains & setup your smart audio system](#)
- [4 STEP 2 – Navigating your smart audio system](#)
- [5 Other information](#)
- [6 Specifications](#)
- [7 Documents / Resources](#)
 - [7.1 References](#)
- [8 Related Posts](#)

Stream 67L

Smart Audio System with Bluetooth, USB and Streaming Services and remote control from iPhone and Android using UNDOK



Please read this guide and safety/warranty guide before use.

What is in the Box?

Smart Audio System, mains lead, remote control with 2 x AAA batteries, quick start guide, safety/warranty guide. Please scan the QR code on the product for the FULL User Guide online.

Features



Scan for full instructions.

<https://roberts.support/stream-67l>

- Internet / DAB+ / FM radio
- Streaming: Spotify, Deezer, Amazon Prime music
- Bluetooth
- CD, CD MP3 / CD WMA compatibility
- Play MP3 or WMA files via USB
- Two mid-treble speakers, two bass speakers (with ported chambers)
- Control via the UNDOK smartphone app (for Apple iOS and Android)
- 10 DAB, 10 FM presets and 40 Internet radio presets
- WiFi and Ethernet connection (Dual-band WiFi and Ethernet)
- 5 equaliser profiles plus User EQ mode
- Clock and dual alarm (wake to Radio / CD / buzzer)
- USB charging of smartphone, tablet or similar devices
- Auxiliary input and headphone socket for private listening

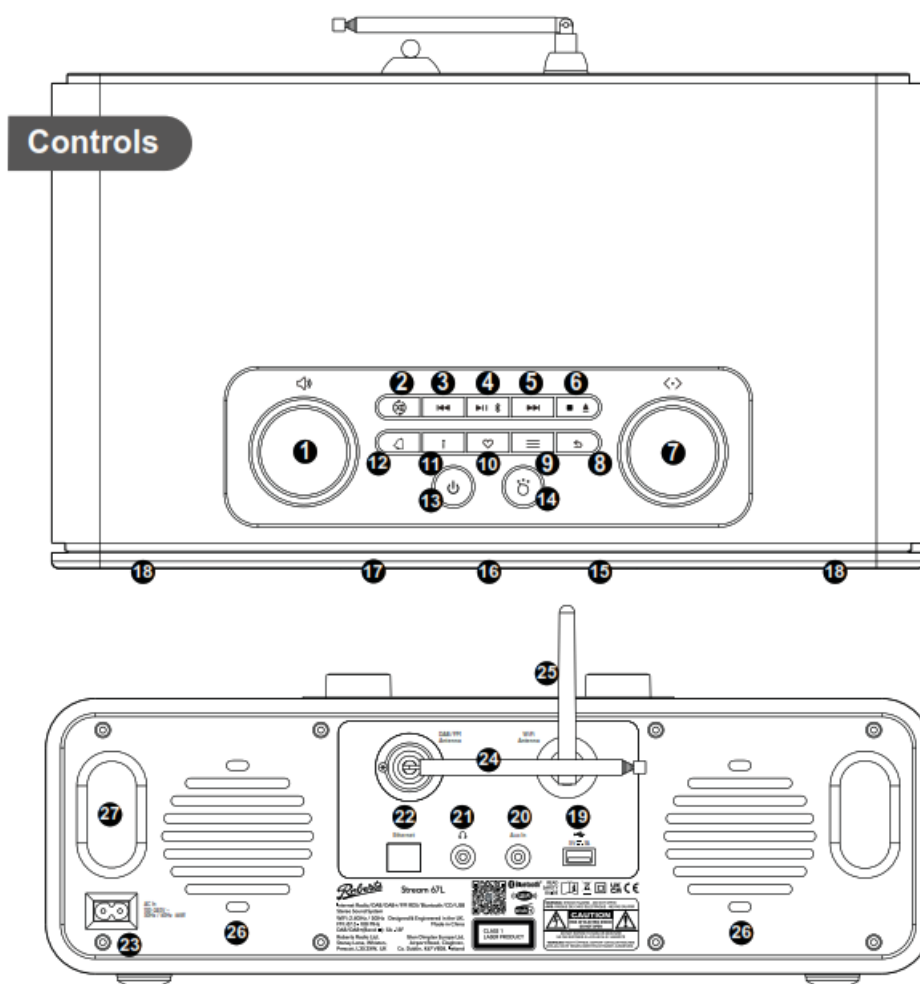

- 1 Volume
- 2 Repeat / Shuffle
- 3 Previous (RW)
- 4 Play/Pause / BT Pair
- 5 Next (FF)
- 6 Stop / Eject
- 7 Tuning / Select / Snooze
- 8 Back
- 9 Menu
- 10 Preset
- 11 Info / Dimmer
- 12 Alarm
- 13 On / Standby / Sleep
- 14 Mode

- 15 IR sensor
- 16 Display
- 17 CD slot
- 18 Mid treble speakers
- 19 USB playback / charge
- 20 Auxiliary input
- 21 Headphone socket
- 22 Ethernet socket
- 23 Power input
- 24 DAB / FM telescopic aerial
- 25 WiFi antenna
- 26 Sub-bass speakers x 2
- 27 Bass reflex ports x 2
- 28 Remote control

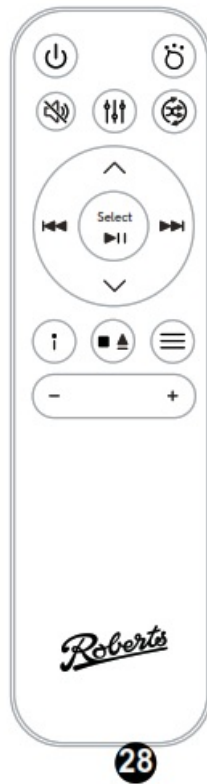

STEP 1 – Connect to the mains & setup your smart audio system

Before you can use your smart audio system you need to have the following:

- For FM/DAB: A suitable location for good radio reception
- For Streaming / Internet Radio : a good WiFi signal or ethernet connection (802.11b, g, n or a) connected to your broadband Internet service provider. You will need the security details to connect the Stream 67L to your WiFi network. Password will not be required for a wired connection.
- For App control: An Android or Apple device with the UNDOK app installed.

A – Connect to the mains

Please read the safety leaflet provided before connecting your smart audio system to the mains. The mains plug is used as the disconnect device, The socket-outlet shall be installed near the equipment and shall be easily accessible.

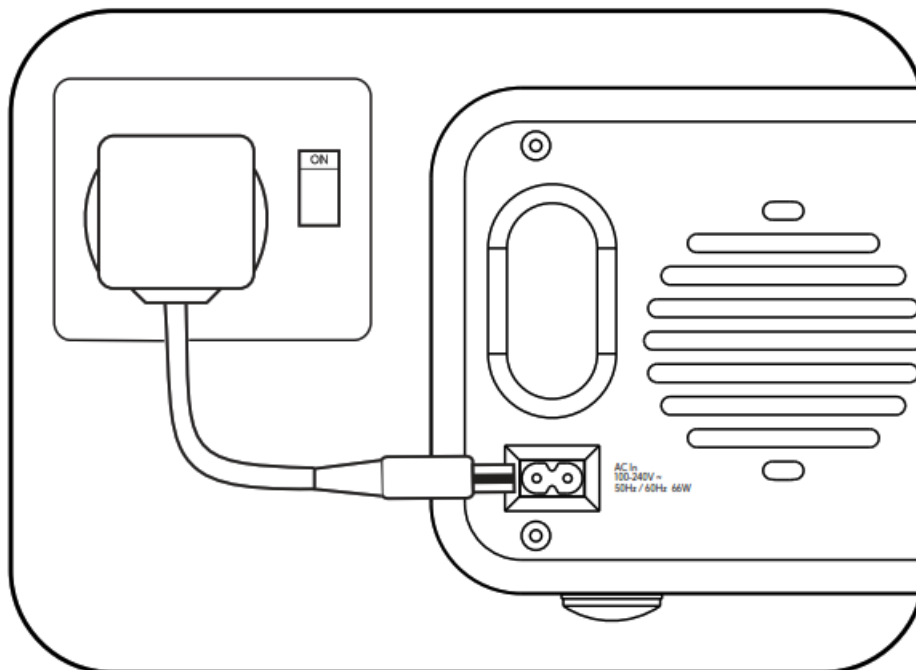

1. Place your audio system on a flat surface.
2. Plug the mains lead into the mains socket on the back of the unit.
3. If you wish to use a wired connection, plug the Ethernet cable into the socket at the back of the unit.
4. Plug the mains lead into a wall socket and switch on the socket.
5. The display on the audio system will show a start up screen for a few seconds. If this is the first time that you use your audio system (or after a Factory Reset) the display will show the language menu.

B – Setup using the audio system or the UNDOK app

Your audio system may be configured using either the display and buttons on the unit or using the UNDOK app. First-time users are recommended to use the audio system's controls.



1. If you wish to use UNDOK to setup your unit, skip to step F now.
2. If you would like to setup using the audio system's controls follow the setup procedure below and choose the desired language.

C – Select language

By default your audio system will display all menus and messages in English.

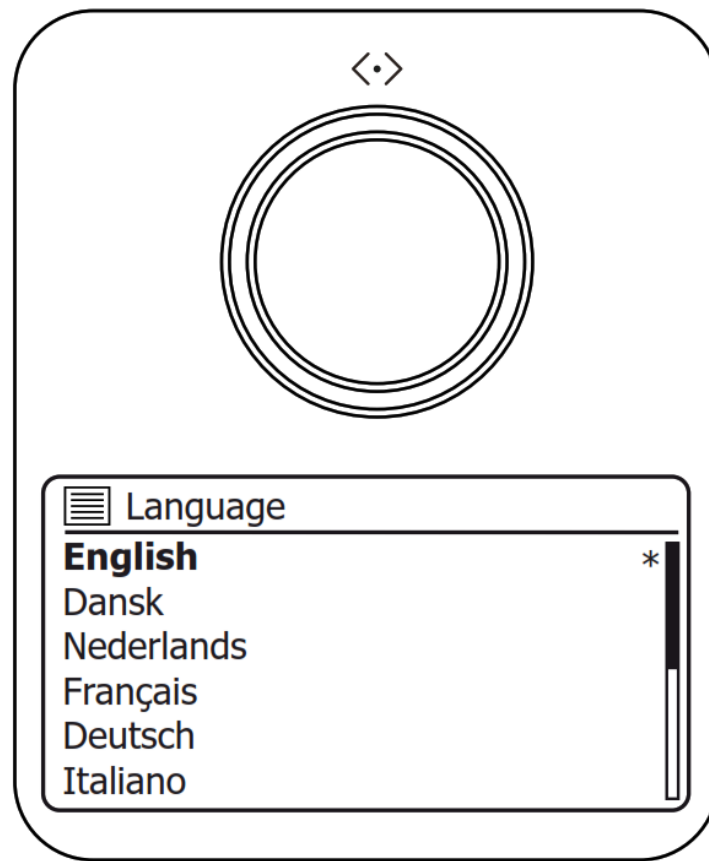

1. Rotate the Tuning/Select control to highlight the desired language.
2. Press the Tuning/Select control to enter the selection.
 - Your audio system will display a privacy policy. Please read the privacy policy and then press the Tuning/Select control to accept the policy.

D – Select clock and time settings

Setup wizard

Start now?

YES NO

Date/Time

12/24 hour format

12 24*

Auto update

Update from DAB

Update from FM

Update from Network *

No update

1. The audio system will show a setup wizard. With 'YES' highlighted press the Tuning/Select control to begin setting up your product.
 - Note: If you wish to go back within a menu or if you make an error at any time, please use the Back button.
2. Choose either the 12 or 24 hour clock display.
3. A menu allowing you to specify the auto-update option for the clock will be shown. Update from network will be the best for most users.
4. Choose the timezone for your region.
5. Choose a daylight saving option. This is also known as Summer/ Winter time (or BST/GMT in the UK).

E – Connect to your network

To stream music or listen to radio from the Internet you must connect your system to your WiFi or use a wired network connection. The Network setup process allows you to do this:

Network settings

Keep network connected?

YES

NO*

Network settings

Network wizard

Scanning... /

SSID

Jones family

[WPS] Paul's network

Smith

Brown

[Rescan]

[Manual config]

WPS Menu

Push Button >

PIN >

Skip WPS >

<.>

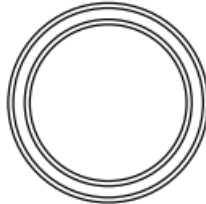

i

Key:

123-jones

0 1 2 3 4 5 6
7 8 9 . - @
, a b c d e
f g h i j k l
m n o p q r s

BACKSP

OK

CANCEL

Network settings

Please wait

Connecting... /

Setup wizard



Setup wizard
completed

Press 'SELECT' to exit

1. Choose 'YES' to keep the unit connected to the network when in Standby. This will allow remote control software to switch on your audio system when needed.
2. A list of the available WiFi networks will then be displayed. If no networks are found then your audio system may be too far from your router.
3. Rotate the Tuning control to navigate the list of available networks and highlight your own Network Name. If your Network Name is not found, then check the router is functioning and that the audio system can in good signal range.
4. If your Network Name (sometimes called SSID) is displayed with "[WPS]" (WiFi Protected Setup), then press the Tuning control and a WPS menu will be displayed, otherwise press the Tuning control and proceed to step 6.
5. Choose one of the WPS menu options as required for your router (WPS may be via push button, or using an identification number): 'Push Button' – the display prompts you to press the WPS button on your router and then the Tuning control on the unit. The two devices should then connect automatically. Proceed to step 10. 'PIN' – the display shows an identification number which you must enter into your router using a web browser (refer to your router's user documentation). You should then press the Tuning control on the unit. Proceed to step 9. 'Skip WPS' – if you wish to enter your password or if your password was previously entered.
6. If you are prompted to enter a password (or key), enter each character by rotating the Tuning control to highlight it, then pressing the Tuning control. If you are not prompted for a password then proceed to step 9.
7. The three controls on the right-hand side of the password key screen have special functions. You can quickly access these by pressing the Info button and then using the Tuning control as needed: Select 'BKSP' – Select to erase a character (long press to clear). Select 'OK' – When the complete password has been entered. Select 'CANCEL' – To cancel and re-run the Network Wizard.
8. After the final character of the password has been entered, highlight the 'OK' symbol and press the Tuning control.
9. The screen will show 'Connecting..' and then 'Setup wizard completed'. Press the Tuning control to exit the setup wizard. The audio system should now be able to connect to the network. Your audio system will display the Main mode menu.

F – Use the UNDOK app to setup your audio system



1. If you wish to setup your audio system using the UNDOK app download and install the UNDOK app on to your Android or iOS device.
2. Follow the on-screen instructions or see the full user guide on-line (scan the QR code on this document with

your phone).

- If you already have the UNDOK app installed on your device ensure that you have the latest version.

STEP 2 – Navigating your smart audio system

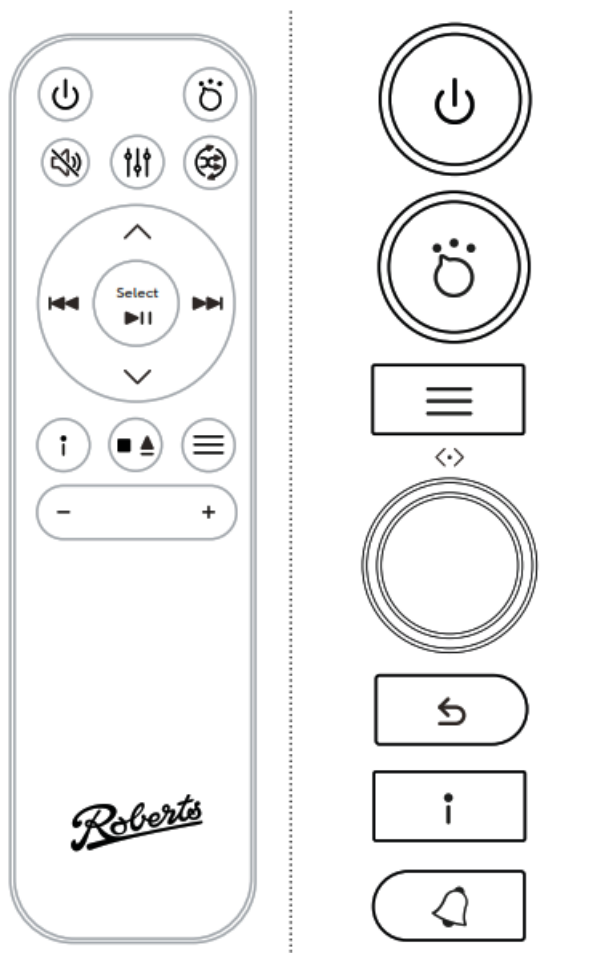

A short press will switch your audio system On or to Standby.

A long press will access the sleep timer (on the unit) when playing.

A short press will cancel an active alarm.



A short press will access each operating mode in turn.

Turn the tuning dial to skip through the modes more quickly.

A short press will access or exit the current menu system.

Rotate clockwise or anti-clockwise to scroll menu items or Left / Up / Right / Down buttons on remote control.

A short press on Tuning/Select or the select button (remote control) will select highlighted menu items.

A short press on Tuning/Select or the select button (remote control) will access snooze when an alarm sounds.

Press the Back button (or menu on remote) to go back to a higher level menu or if an error is made.

A short press will display information relating to the music being played.
 Long press to adjust the brightness of the display (short press when in standby to adjust brightness).
 A short press will change alarm status when the unit is in standby or playing.
 A long press will access alarm settings when the unit is in standby or playing.

STEP 3 – Operating your smart audio system

Select music mode

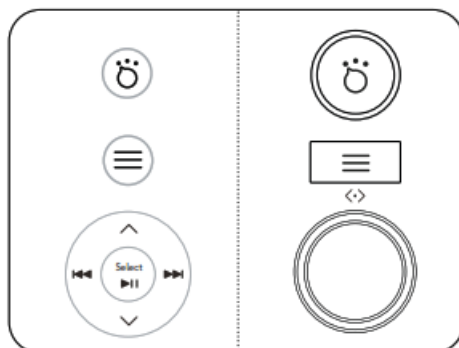

Choose a listening mode:

1. Pressing Mode gives you access to each of the operating modes. Press again or turn the select control to select a new mode. Push the tuning dial to select a mode and return to the main screen.
2. Press Menu to access the full menu for the current operating mode.

Internet radio	– Listen to internet radio
DAB radio	– Listen to DAB radio
FM radio	– Listen to FM radio
CD	– Play music from CD
Auxiliary input	– Connect to other devices
Spotify	– Play music from Spotify
Amazon Music	– Play music from Amazon Music
Deezer	– Play music from Deezer
Bluetooth	– Stream music using your smart device
USB	– Play music from USB

System settings

You can access 'System settings' from the current menu. The system settings include Equaliser, Subwoofer, Streaming audio quality, Network, Time/Date, Brightness, Inactive standby, Language, Factory reset, Software update, Setup wizard, Info and Privacy policy.

Play Internet, DAB or FM radio

Internet – You can search for a radio station or podcast by location, genre or by the station name. You can also store preset stations or add a station to your favourites list.

DAB – Carefully, extend the telescopic aerial. A scan of the Band III DAB channels will be carried out. Rotate the Tuning control to access the full station list. Press the Tuning control to select the highlighted radio station.

FM – Extend the telescopic aerial. Rotate the Tuning control clockwise or clockwise and then press the Tuning control to scan low to high or high to low frequency.

USB Player

Play your music collection from a USB memory device.

Choose 'USB playback' to playback a USB memory device.

The USB socket can also be used to charge your smartphone, tablet or similar devices.

Bluetooth

1. Ensure Bluetooth is enabled on your smart device.
2. Press Mode to select Bluetooth mode on your audio system.
3. The Bluetooth indicator will flash and your audio system will show that it is 'discoverable'. On your smart device select 'Stream 67L'. Once the connection is established the indicator will remain steady. You may now play your music.
4. To connect a different device, apply a long press on the Bluetooth Pair button on your audio system. Your audio system will become discoverable by other devices.

Media playback controls

Control media playback using the previous, next, play/pause or stop buttons.

Note: These features are dependent on the music being played and will not always be available.



Other information

Play CD / CD MP3 / WMA discs

Your audio system can playback standard CDs and CD-R/CD-RW discs with standard audio or compatible audio files. Use only full size standard CDs. Mini CDs (8cm diameter) are not compatible with the player and may jam the CD mechanism.



1. Press Mode to switch the unit to CD mode.
2. To eject or reload a CD give a long press on the CD Stop/Eject button.
3. Press the Play/Pause button to start playing the disc. Adjust the volume. To pause or resume playback press Play/Pause.
4. To stop playback press the CD Stop/Eject button.
5. While the CD is playing select skip tracks with the Previous and Next buttons.
6. When playing an MP3/WMA disc you can skip to another folder using the Up or Down buttons on the remote control. Pressing Menu will allow access to the browse file option.
7. Use the Repeat/Shuffle button to alter the playback order or repeat behaviour.



Preset radio stations

Your radio has 40 Internet radio, 10 DAB and 10 FM presets which can be set to store a radio station or (for Internet radio, a podcast).

1. Tune to the required radio station. Apply a long press on the Preset button 'Save to preset' will be displayed.

- Use the Tuning control to scroll to an unused preset or a preset you wish to change. Press Tuning to store.
2. To recall a preset station, choose Internet, DAB or FM mode. Give a short press on the Preset button 'Recall from preset' will be displayed. Use the Tuning control to select the desired preset station.

Remote control battery replacement

Please read the safety leaflet provided before using batteries.

1. Remove the battery cover on the rear of your remote control by pulling the small slot on the side of the remote body.
2. Insert 2 x AAA size batteries into the spaces in the compartment. Take care to ensure the batteries are inserted in the right direction as shown inside.
3. Replace the cover. If the remote is not to be used for an extended period of time it is recommended that the batteries are removed.

Caution: Replace batteries only with the same or equivalent type. Danger of explosion if the batteries are incorrectly replaced.

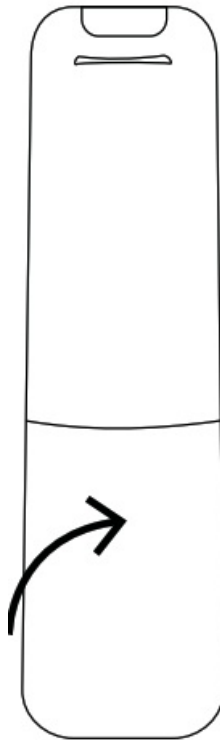

If you wish to completely reset your audio system to its initial state perform a factory reset. Press Menu. Choose 'System settings', 'Factory Reset' then 'YES'. All user entered settings will be erased.

In order to minimise its energy consumption when not in use, your audio system will go into standby if it detects that it is no longer being used. By default this period is set to 8 hours but you may change it if you wish. With your audio system switched on, press Menu, choose 'System settings' then 'Inactive Standby' and then choose from 2, 4, 6, 8 hours or Off. Your audio system will go into standby after the selected time has expired.

Specifications

Power requirements	
Mains	100 – 240V 50/60Hz
Remote control batteries	2 x AAA size
USB output	5V / 1A
Connectivity	0/100M bits/sec via RJ-45 connector
Wired Ethernet WiFi	802.11 b, g, n or a supported with WEP and WPA / WPA2 encryption

Compatible with 2.4 GHz and 5 GHz WiFi bands.

5 GHz Wi-Fi function: 5150-5350 MHz, 5470-5725 MHz and 5725-5875MHz Use restriction: This device is authorised in the following countries for indoor use only when used with 5GHz WIFI (5150 to 5350 MHz; channels 36 to 64):

2.4GHz WiFi EIRP POWER (MAX.) 19.76dBm

5GHz WiFi EIRP POWER (MAX.) 18.89dBm

Circuit features

	AT	BE	BG	HR	CY	CZ	DK
	EE	FI	FR	DE	EL	HU	IE
	IT	LV	LT	LU	MT	NL	PL
	PT	RO	SK	SI	ES	SE	UK

3.5mm Headphone socket, 3.5mm Aux In.

Aerial System WiFi antenna, DAB/FM Telescopic aerial

Bluetooth standards A2DP, AVRCP, Bluetooth codecs supported SBC Bluetooth EDR EIRP POWER (MAX.) – 10.26dBm

Frequency coverage FM 87.5 – 108MHz, DAB 174.928 – 239.200MHz

Bluetooth 5.0 frequencies 2.402 – 2.480GHz

Operating temperature range +5°C to +40°C

Product markings



This symbol indicates AC voltage.



This symbol indicates Class II equipment.

The name plate is located on the rear of the audio system.

The company reserves the right to amend the specification without notice.

Designed & Engineered in the UK

Made in China



Issue 1

2022-06-13

ROBERTS RADIO LIMITED

www.robertsradio.com

© 2022 Roberts Radio Limited



[Roberts Stream 67L Smart Radio Sound System](#) [pdf] User Guide
Stream 67L, Smart Radio Sound System, Radio Sound System, Smart Radio Sound, Radio Sound, Sound System

References

- [📖 Official Roberts Radio Online Shop | British Audio](#)