

Roberts 95i Stream Portable Smart Speaker



# Roberts 95i Stream Portable Smart Speaker Owner's Manual

[Home](#) » [ROBERTS](#) » Roberts 95i Stream Portable Smart Speaker Owner's Manual 

## Contents

- [1 Roberts 95i Stream Portable Smart Speaker](#)
- [2 Product Usage Instructions](#)
- [3 Key Features](#)
- [4 Control & Navigation](#)
- [5 Get Started](#)
- [6 General Safety](#)
- [7 Product Markings](#)
- [8 Warranty](#)
- [9 Documents / Resources](#)
  - [9.1 References](#)
- [10 Related Posts](#)

The Roberts logo, featuring the word "Roberts" in a stylized, cursive script font with a thick underline.

**Roberts 95i Stream Portable Smart Speaker**



## Specifications

- Model: Stream 95i
- Features: Portable smart speaker with DAB+ and FM RDS radio, Bluetooth, Streaming Services
- Power Input: 5V 2A

## Product Usage Instructions

### Power On

1. Plug the mains adapter into the power port on the base of the unit then into a power outlet.
2. Press the Power/ Volume dial.
3. The display on the audio system will show a start-up screen for a few seconds. The system will resume the last used audio mode (default is DAB radio).

### Control & Navigation

The device features various controls and navigation options such as Power/Volume, Mode, Favourites, and more. Refer to the manual for detailed functions of each button.

### Get Started

1. Press the Power/ Volume dial to turn the unit on.
2. Press Mode to access the source screen and turn the Tuning dial to choose a new mode. Press the Tuning dial to select a new mode.

### DAB & FM Radio:

Ensure the aerial is fully extended. Press the MODE button and turn the TUNING/ SELECT dial to choose between DAB or FM Radio. Follow the instructions for scanning and selecting stations for both modes.

## WiFi Streaming

1. Download the Roberts app on your phone.
2. Press the MODE button to switch the unit to WiFi mode and hold the ACTION button until WiFi setup starts.
3. Open the Roberts app on your phone and add the device to your WiFi network.

## FAQ

- **How do I set up WiFi streaming on the Roberts Stream 95i?**

To set up WiFi streaming, download the Roberts app on your phone, switch the unit to WiFi mode by pressing the MODE button, and follow the on-screen instructions in the app to connect your device to your WiFi network.

- **Can I use Amazon Alexa with the Stream 95i?**

Yes, you can use Amazon Alexa with the Stream 95i. Enter the settings page within the Roberts app, choose 'Amazon Alexa' settings, and sign in to enable Alexa commands on your radio.

## Stream 95i

Portable smart speaker with DAB+ and FM RDS radio, Bluetooth, Streaming Services and app control from iPhone and Android

Please read this Quick Start Guide & safety/warranty leaflet before use. Scan for full instructions

[www.roberts.support/stream95i](http://www.roberts.support/stream95i)



## Key Features

- Internet / DAB+ / FM RDS radio with full-colour display
- Spotify Connect, Deezer, Amazon music, TIDAL, Qobuz, TuneIn and iHeartRadio (Third-party streaming services may require a subscription)
- Alexa voice assistant with physical mute switch for privacy
- Chromecast built-in to stream favourite music and pps from smartphone/tablet
- Stream music from your smartphone / tablet via Bluetooth
- Play MP3 / WMA / AAC / FLAC / ALAC files via DLNA or from USB
- 2.1 stereo system with tuned bass reflex enclosure
- Full control via the Roberts smartphone app (for Apple iOS and Android)
- 30 presets for radio or streaming sources
- Ethernet and WiFi connection (2.4 and 5GHz)
- Equaliser profiles plus custom bass/treble option in custom user EQ setting
- USB charging of smartphone, tablet or similar devices

- Auxiliary input
- Headphone/line output
- Multiroom streaming capable

## Power On

1. Plug the mains adapter into the power port on the base of the unit then into a power outlet.
2. Press the Power/Volume dial.
3. The display on the audio system will show a start up screen for a few seconds. The system will resume the last used audio mode (default is DAB radio).

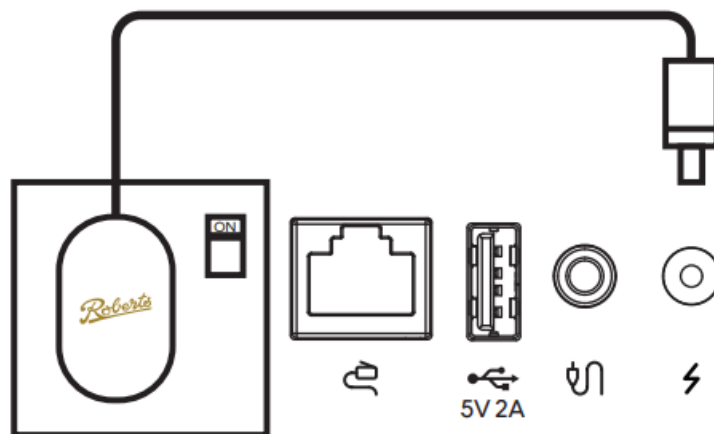

## Control & Navigation

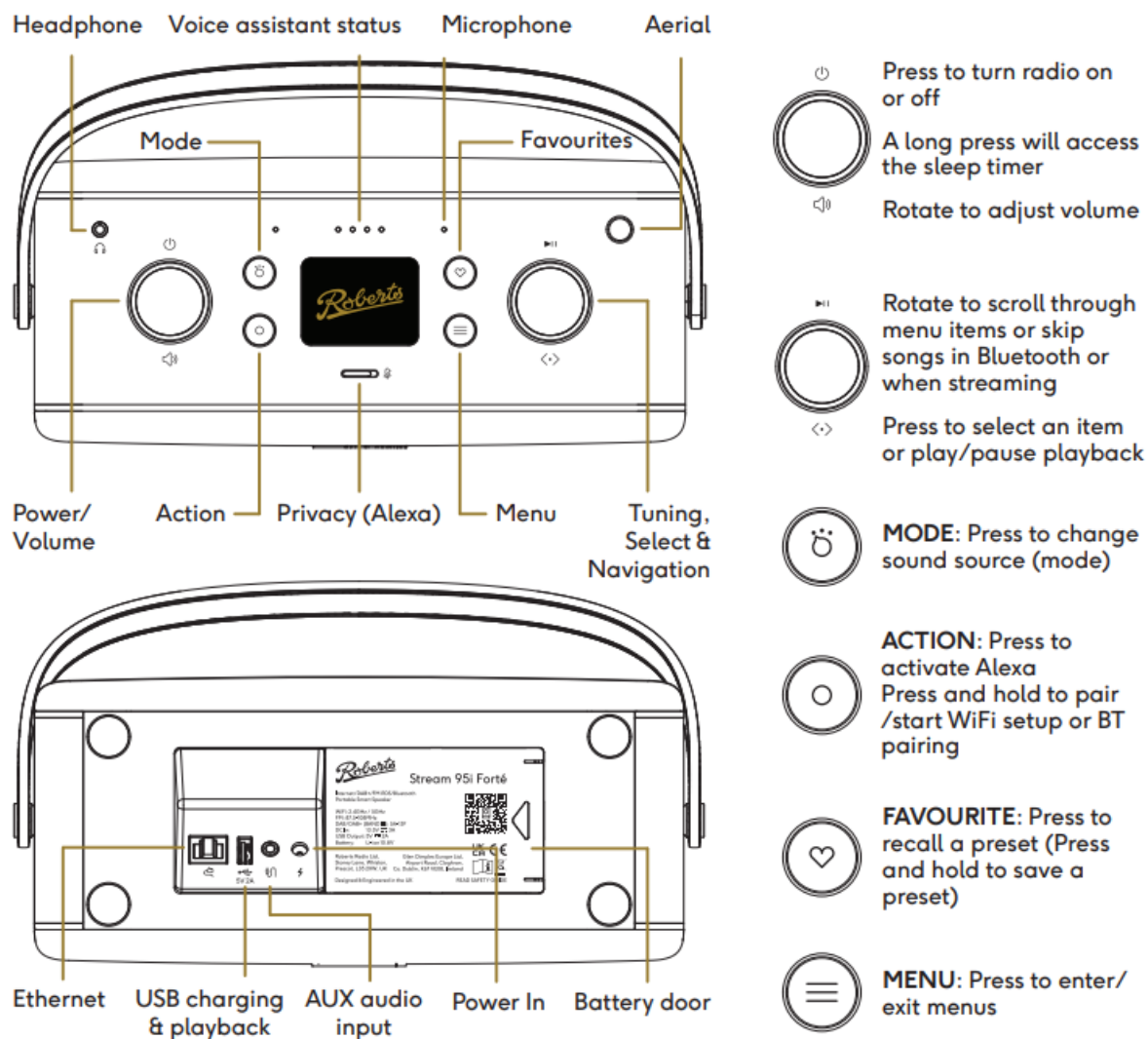

## Get Started

The Roberts Stream 95i allows you to listen to a world of audio. To do this, switch it on, and select the audio source as follows:

1. Press the Power/ Volume dial to turn the unit on.
2. Press Mode to access the source screen and turn the Tuning dial to choose a new mode. Press the Tuning dial to select a new mode.

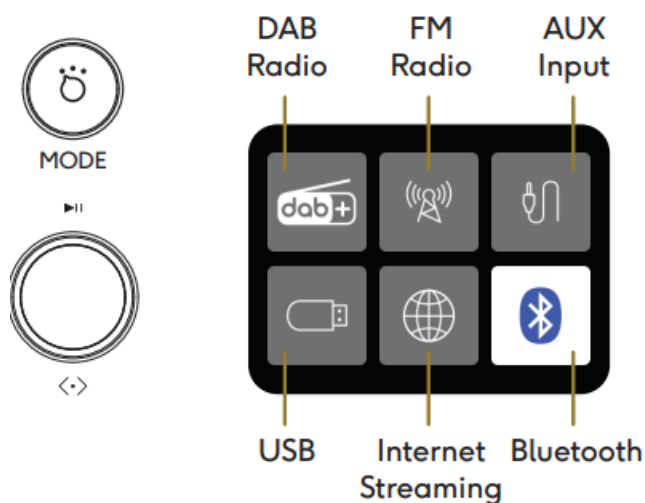

## DAB & FM Radio

Ensure the aerial is fully extended.

Press the MODE button and turn the TUNING/SELECT dial and push to choose DAB or FM Radio.

## DAB

When you use DAB for the first time, the radio will scan for radio stations. When the scan is complete, you can turn the tuning dial to select a station to listen to and press to choose it.

## FM:

Turn the Tuning dial to change the frequency. Push the dial to scan to the next radio station.

## Favourites (Presets):

You can use the Favourite button to store and recall your favourite DAB/FM stations. Press and hold to store a station. Short press the button to recall a station.



## WiFi Streaming

To listen to internet radio, stream music, use Alexa voice commands or Chromecast, the unit must first be connected to your WiFi network.

1. Use your phone to download the Roberts app.
2. Press the MODE button to switch the unit to WiFi mode. Then press and hold the ACTION button until WiFi set up starts.
3. Open the Roberts app on your phone and choose the '+' button to add a device to your WiFi network.
4. When the device is connected, apps will be able to stream directly to your radio.

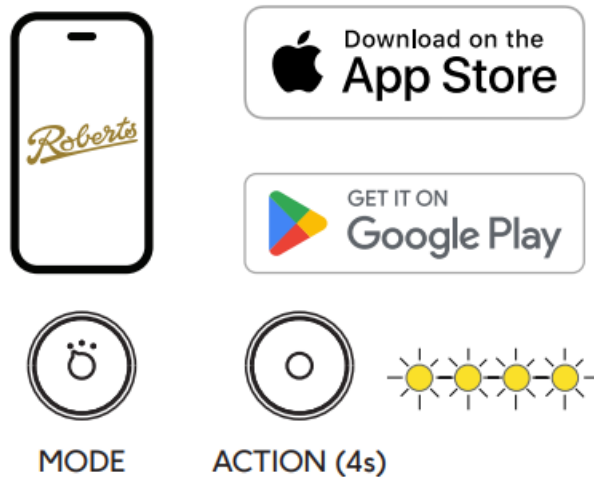

The Spotify Software is subject to third party licenses found here:

<https://www.spotify.com/connect/third-party-licenses> Use your phone, tablet or computer as a remote control for Spotify. Go to [spotify.com/connect](https://www.spotify.com/connect) to learn how.

Amazon Alexa – to use the Alexa voice assistant, you need to enter the settings page within the Roberts app, and choose 'Amazon Alexa' settings, and sign in. This allows your radio to respond to Alexa commands. Say 'Alexa' and your device should respond.

## Bluetooth

1. Ensure Bluetooth is enabled on your smart device.
2. Press Mode to select Bluetooth mode on your audio system.
3. The Bluetooth indicator will flash blue when your radio is 'discoverable'.
4. On your smart device select, enter Bluetooth settings and look for 'Icon —' (where — is a unique code for your radio). Choose this device and your phone should pair and connect. Whilst paired, you can stream from any audio app on your phone to the radio.
5. To connect a different device, long press the ACTION button. This will cause the radio to disconnect from the connected device and become discoverable to a new device.

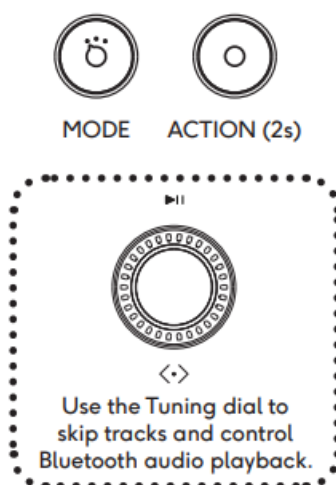

Please note: when you enter Bluetooth mode, the radio will attempt to pair automatically with the last available paired device.

## USB Player & AUX Input

You can plug in a USB memory device in to the USB socket to play back compatible media files. The USB stick should be formatted on a PC (Fat 32). Check online for details of compatible media formats – mp3 is the most commonly used for this purpose.

The AUX input is a 3.5mm stereo input calibrated to normal -10dB line level. Use this to connect the radio as a speaker to external equipment such as a CD player or TV.



## Battery Not Included

To connect the optional Lithium Ion battery pack,

1. Disconnect the unit from power.
2. Slide and rotate open the battery door.
3. Connect the battery cable to the socket inside.
4. Position the cable under the battery and close door.

## Safety and Warranty information

### General Safety

- Your product, AC/DC adaptor or mains cable should not be exposed to liquids, steam, sand, dripping or  splashing and no objects filled with liquids, such as  vases, shall be placed on the product, adaptor or mains cable.
- It is recommended to operate the product such that there is a minimum distance (10cm recommended) to adjacent objects in order to ensure good ventilation.
- The ventilation of the product should not be restricted by covering it or its ventilation openings with items such as newspapers, tablecloths, curtains etc.
- No naked flame sources such as lighted candles should be placed on the product.
- It is recommended to avoid using or storing the product at extremes of temperature. Avoid leaving the unit in cars, on window sills, in direct sunlight etc.
- There are no user serviceable parts inside this product.
- Do not attempt to disassemble any part of the product.
- The product must be used in a moderate climate.
- Operating temperature range +5°C to +40°C
- For products with WiFi – To maintain the compliance with the WiFi RF exposure requirement, place the product at least 20 cm (8 inches) from nearby persons except when operating the controls.

### Mains powered products

**IMPORTANT:** The mains adaptor / mains cable is used as the means of connecting the product to the mains supply. The mains socket and any multi-way mains block used for the product must remain accessible during normal use. In order to disconnect the product from the mains, the mains adaptor / mains cable should be removed from the mains socket outlet completely.

Use only the mains adaptor / mains cable provided with the product, or a genuine replacement provided by Roberts Radio. The use of alternative adaptors / mains cables will invalidate the guarantee.

### Headphones

**IMPORTANT:** Excessive sound pressure from earphones and headphones can cause hearing loss.

To prevent possible hearing damage, do not listen at high volume levels for long periods.



**For products with WiFi**

Use restriction: This device is authorised in the following countries for indoor use only when used with 5GHz Wi-Fi (5150 to 5350MHz; channels 36 to 64):



AT	BE	BG	CH	CY	CZ	DE
DK	EE	EL	ES	FI	FR	HR
HU	IE	IS	IT	LI	LT	LU
LV	MT	NL	NO	PL	PT	RO
RS	SE	SI	SK	TR	UK	

**Electro-magnetic compatibility advice**

In the event of a malfunction due to electrostatic discharge, mains power supply transients or short interruptions, reset the product to resume normal operation. If you are not able to perform the reset operation, removal and reconnection of the power supply and batteries may be required.

If the product is used in an environment with any ESD Immunity / Radiated Immunity / Conducted Immunity disturbance, the product may malfunction. It will automatically recover to normal when the ESD Immunity / Radiated Immunity / Conducted Immunity disturbance is stopped.

**Product Markings**

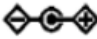
~ This symbol indicates AC voltage.  Polarity of d.c. power connector.

 This symbol indicates Class II equipment.  This symbol indicates energy efficiency marking.

 For indoor use only.  This symbol indicates DC voltage.

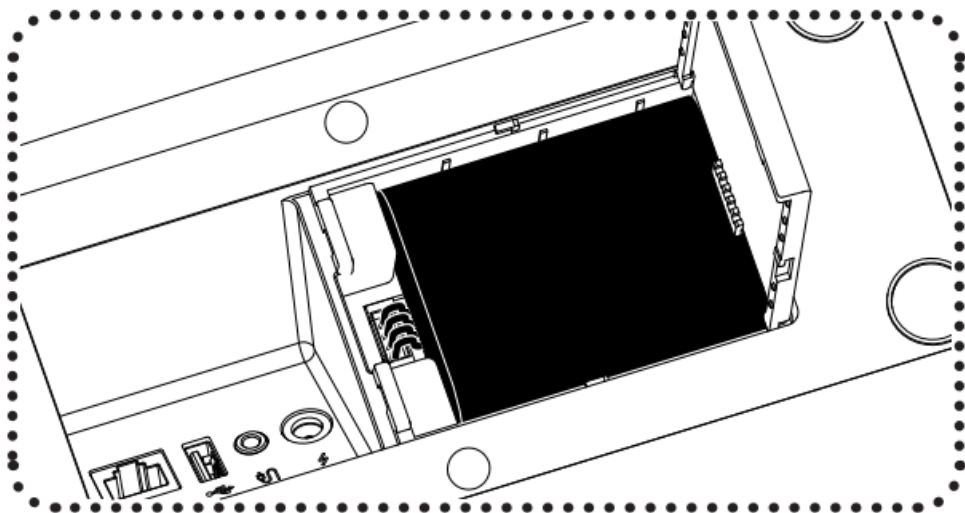

## Battery Safety (General)

**IMPORTANT:** The batteries (battery pack or installed batteries) should not be exposed to excessive heat such as from direct sunshine, fire or the like. After use, disposable batteries should if possible be taken to a suitable recycling centre. On no account should batteries be disposed of by incineration. **IMPORTANT:** Danger of explosion if batteries are incorrectly replaced. Replace batteries only with the same or equivalent type. Do not replace the battery with an incorrect type which could void protection or which does not provide protection (e.g. certain types of lithium batteries).

Improper use of batteries may result in leakage of fluid, overheating or explosion. Battery fluid is corrosive and may also be toxic. Battery fluid can cause skin burns, can damage the eyes, and can be harmful if swallowed.

1. Keep batteries out of the reach of children. They can be a choking hazard.
2. Do not heat, open, puncture, mutilate or dispose of batteries by burning.
3. Do not mix different battery types or old and new batteries. Always replace all the batteries at the same time.
4. Do not carry or store batteries such that metal objects may contact the end caps.
5. Remove batteries from the product if they are worn out or if you are storing it for a long time.
6. Remove old or worn out batteries promptly, and recycle or dispose of them according to the regulations applicable to your location.
7. If a battery does leak, remove all batteries from the product, taking care to avoid directly touching the leaked fluid. If the fluid contacts skin or clothes wash with water immediately. Before inserting new batteries, thoroughly clean the battery compartment with a damp paper towel, or follow the battery manufacturer's advice for clean up.

Batteries must never be discarded by incineration, by fire, in a hot oven, by cutting or mechanically crushing, which could cause an explosion. Do not leave a battery in an extremely high temperature surrounding environment which may cause explosion or leakage of flammable liquid or gas. Do not leave a battery under extremely low air pressure which could cause an explosion or leakage of flammable liquid or gas.

## Recycling

This product bears the selective sorting symbol for Waste Electrical and Electronic Equipment (WEEE). This means that this product must be handled pursuant to European directive 2012/19/EU in order to be recycled or dismantled to minimize its impact on the environment. The user has the choice to give the product to a competent recycling organization or to the retailer when buying a new electrical or electronic equipment.

Hereby, Roberts Radio, declares that this product is in compliance with the essential requirements and other relevant provisions of Directive 2014/53/EU. The full text of the EU declaration of conformity is available at the following internet address: [www.robertsradio.com](http://www.robertsradio.com)



## Warranty

This product is guaranteed for twenty four months from the date of purchase by the original owner against failure due to faulty workmanship or component breakdown, subject to the procedure stated below. Should any component or part fail during this guarantee period it will be repaired or replaced free of charge.

The guarantee does not cover: 1. Damage resulting from incorrect use. 2. Consequential damage. 3. Product with removed or defaced serial numbers.

N.B. Damaged or broken aerials will not be replaced under guarantee.

Procedure: Any claim under this guarantee should be made through the dealer from whom the product was purchased. It is likely that your Roberts dealer will be able to attend to any defect quickly and efficiently, but should it be necessary the dealer will return the product to the company's service department for attention. In the event that it is not possible to return the product to the Roberts dealer from whom it was purchased, please contact

Roberts Radio using the contact details on the [www.robertsradio.com](http://www.robertsradio.com) website.  
For product repairs falling outside the guarantee period, please refer to the 'Customer care' tab on the [www.robertsradio.com](http://www.robertsradio.com) website. These statements do not affect the statutory rights of a consumer.

Roberts Radio Ltd, Stoney Lane, Whiston, Prescot, L35 2XW, UK  
Glen Dimplex Europe Ltd, Airport Road, Cloghran, Co. Dublin, K67 VE08, Ireland  
[hello@robertsradio.com](mailto:hello@robertsradio.com)  
[www.robertsradio.com](http://www.robertsradio.com)

© 2023 Roberts Radio Limited  
Issue 8 2023-11-01



## Documents / Resources

	<a href="#">Roberts 95i Stream Portable Smart Speaker</a> [pdf] Owner's Manual 95i Stream Portable Smart Speaker, Stream Portable Smart Speaker, Portable Smart Speaker, Smart Speaker, Speaker
--	--

## References

- [🔗 Official Roberts Radio Online Shop | British Audio](#)
- [🎧 Third Party Licenses | Spotify for Developers](#)
- [User Manual](#)

### Manuals+, Privacy Policy

This website is an independent publication and is neither affiliated with nor endorsed by any of the trademark owners. The "Bluetooth®" word mark and logos are registered trademarks owned by Bluetooth SIG, Inc. The "Wi-Fi®" word mark and logos are registered trademarks owned by the Wi-Fi Alliance. Any use of these marks on this website does not imply any affiliation with or endorsement.