



RISE F170 Macro Aiming System Light Installation Guide

[Home](#) » [RISE](#) » RISE F170 Macro Aiming System Light Installation Guide 

RISE F170 Macro Aiming System Light



Contents

- 1 FREEDOM TO CREATE™
- 2 INCLUDED
- 3 OPTIONAL ITEMS
- 4 PLAN THE INSTALLATION
 - 4.1 Verify the Electrical Plan
 - 4.2 Direct to Junction Box
- 5 INSTALL THE FIXTURES
 - 5.1 Select Mounting Option
 - 5.2 MOUNT ON A JUNCTION BOX*
 - 5.3 NON-ECOSENSE CANOPY
 - 5.4 ECOSENSE CANOPY
 - 5.5 MOUNT TO SURFACE
 - 5.6 MOUNT TO POLE OR POST
- 6 OPTIONAL INSTALL-F170 INTERCHANGEABLE LENS
- 7 OPTIONAL INSTALL-F170 SNOOTS
- 8 INSTALLATION CONSIDERATIONS
- 9 Customer Support
- 10 Documents / Resources
 - 10.1 References
- 11 Related Posts

FREEDOM TO CREATE™



Read the following instructions before operating the luminaire.

EcoSense Lighting fixtures must be installed by a qualified electrician.

EcoSense Lighting, Inc. is not responsible if its fixtures are not installed in accordance with all national and local safety standards.

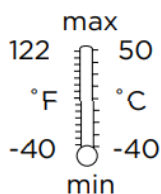

IP66



IK10



Surge Protection Devices with a minimum discharge current rating of 20kA, that meet UL1449, CSA C22.2 No. 269.1, and IEC TR 62066, should be installed on each branch circuit

INCLUDED

RISE F170 Installation Guide

Every lighting fixture includes firmware that facilitates electronic dimming control.

*For other RISE Installation Guides visit <https://www.ecosenselighting.com/resources/#rise>.

OPTIONAL ITEMS

- Interchangeable Lens
- Color Filter
- Snoot/Half Snoot
- Canopy/Junction Box Cover
- EcoSpec® LDCM 0-10V Module

*For more accessories visit <https://www.ecosenselighting.com/products/#rise-accessories>

NOTES

Screw Torque Settings:

Screws to replace the Lens and Bezel
Screws for MACRO™ Lock Pan and Tilt
IC Cable Length
EC Cable Length
NPT Fitting Height
Wire Color Description

1.25 Nm \pm 0.25 N
27.0 Nm \pm 2.0 Nm
0.48 m (19 in)
3.048 m (10 ft)
12.7 mm (0.5 in)
Brown = Line
Blue = Neutral
Green/Yellow = Ground

PLAN THE INSTALLATION

Verify the Electrical Plan

Fixture-to-Fixture Runs: UL ONLY

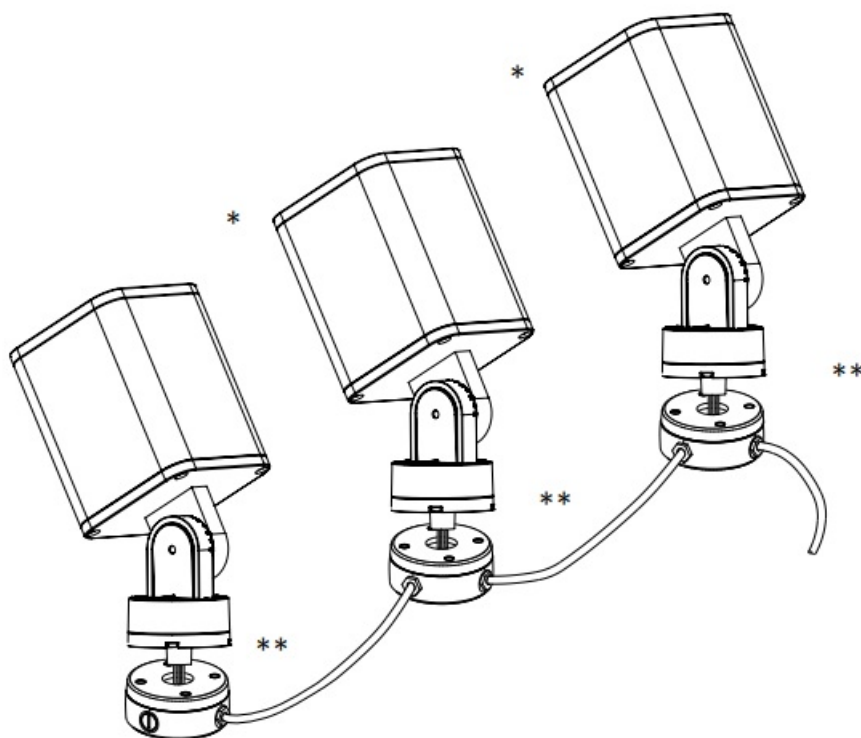

- Fixtures are UL Listed.
- Fixture mounting and wiring to junction box must be done in accordance to local code.

Direct to Junction Box

UL ONLY

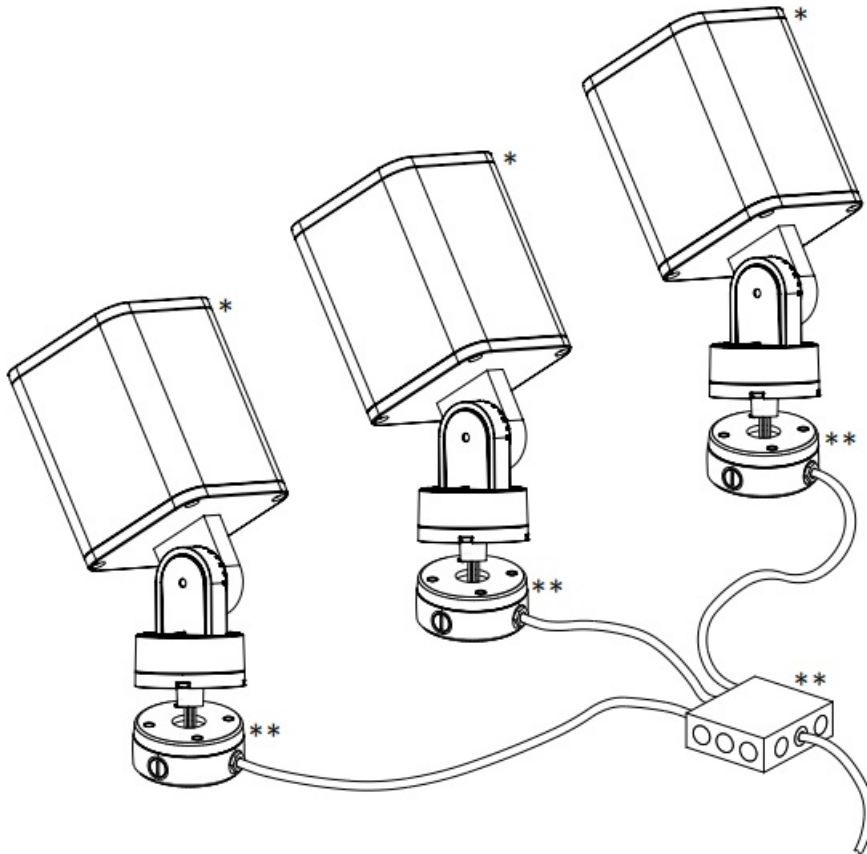

CAUTION: Luminaires should not be installed such that they are looked into directly for long periods of time.

INSTALL THE FIXTURES

Select Mounting Option

Choose method best suited for mounting surface and installation application



Ensure power is OFF.

MOUNT ON A JUNCTION BOX*

UL ONLY

IC – Internal Cable (19 in/48.26 cm Flying Leads)

Optional canopy accessory parts are sold separately

1. Choose junction box* type, and secure to mounting surface.
2. Mount fixture via 1/2 inch NPT fitting and 1/2 inch NPT lock nut to the architectural junction box* canopy and seal the screw holes and side gasket using RTV and Seal tape. Run wires through the junction box* cover or canopy sealing and gasket ring.
3. Create secure wire connections to the main power cables through wire nuts or wiring block as per local electrical code. (Refer to images for both flying leads exiting the fixture and external rated cable.)
4. Fasten architectural junction box canopy to the junction box. (For damp or wet locations, use an exterior rated junction box and install per manufacturer instructions.)

NON-ECOSENSE CANOPY

WIRE COLORS	
Brown = Line Blue = Neutral Green/Yellow = Ground	

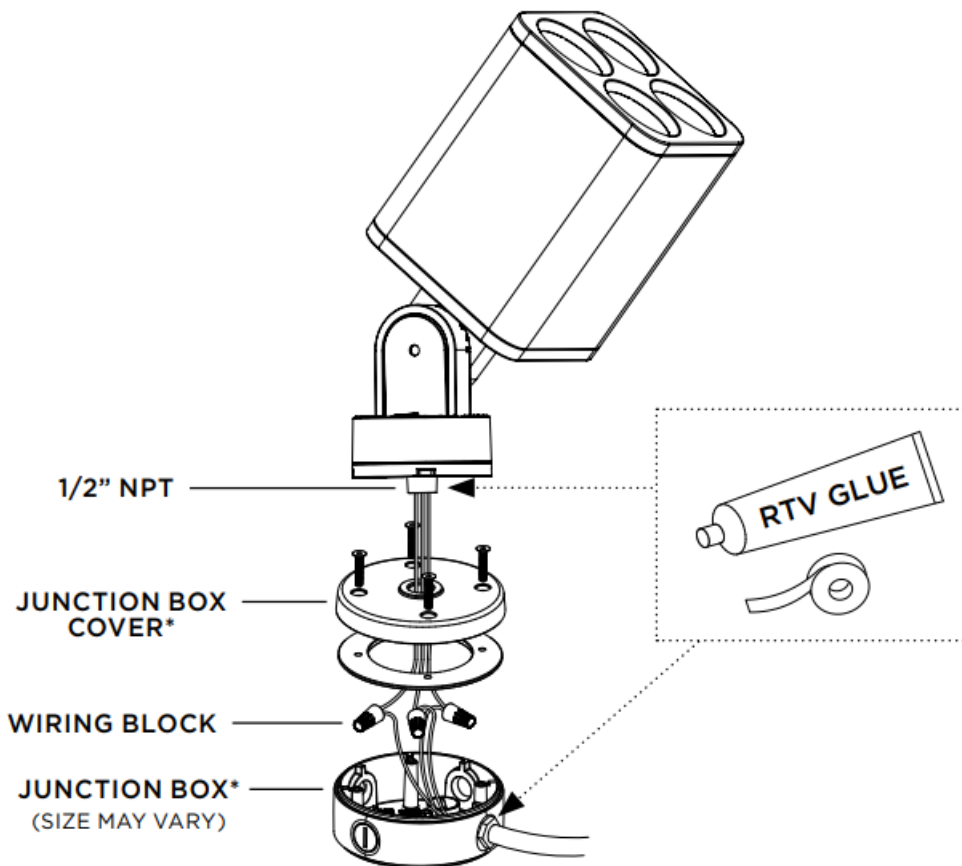

**Supplied by others*

ECOSENSE CANOPY

Sold Separately

WIRE COLORS

Brown = Line
Blue = Neutral
Green/Yellow = Ground

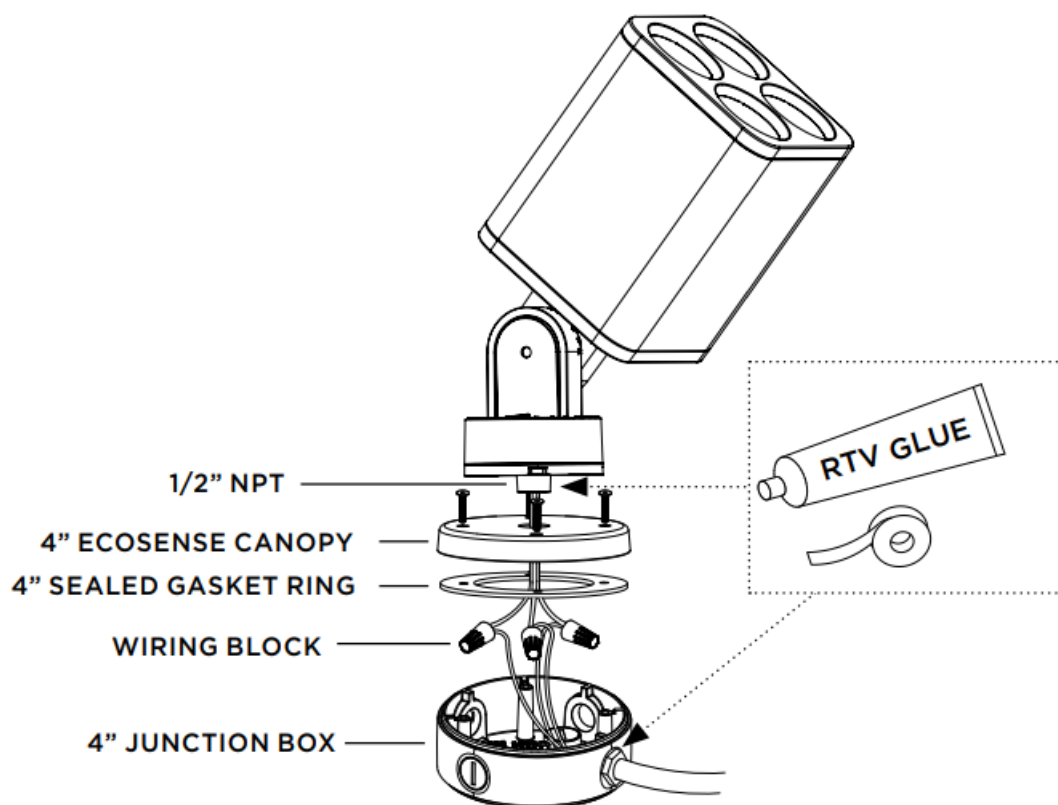

*See specific installation instructions of EcoSense Canopy/Junction Box Cover

MOUNT TO SURFACE



Ensure power is OFF.

Surface Mount Bracket accessory included with EC versions

EC – Exterior-Rated/External Cable Side Exit and External Cable Bottom Exit.

1. Fasten Surface Mount bracket to the base of the fixture using the four M3 screws provided.
2. Mount fixture to Surface using two 1/4 inch or M6 flat head screws.
3. Create secure wire connections between the EC Cable and the main power cables through wire nuts or wiring block as per local electrical code.
4. For damp or wet locations, use an exterior rated junction box and install per manufacturer instructions.

SURFACE MOUNT

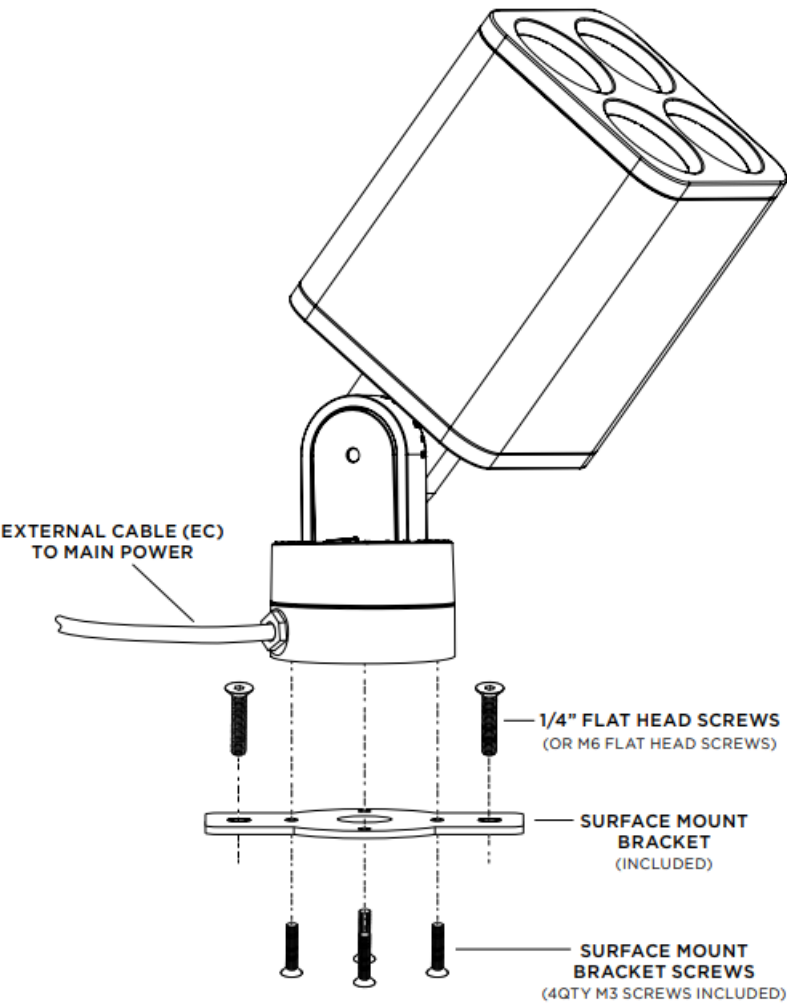

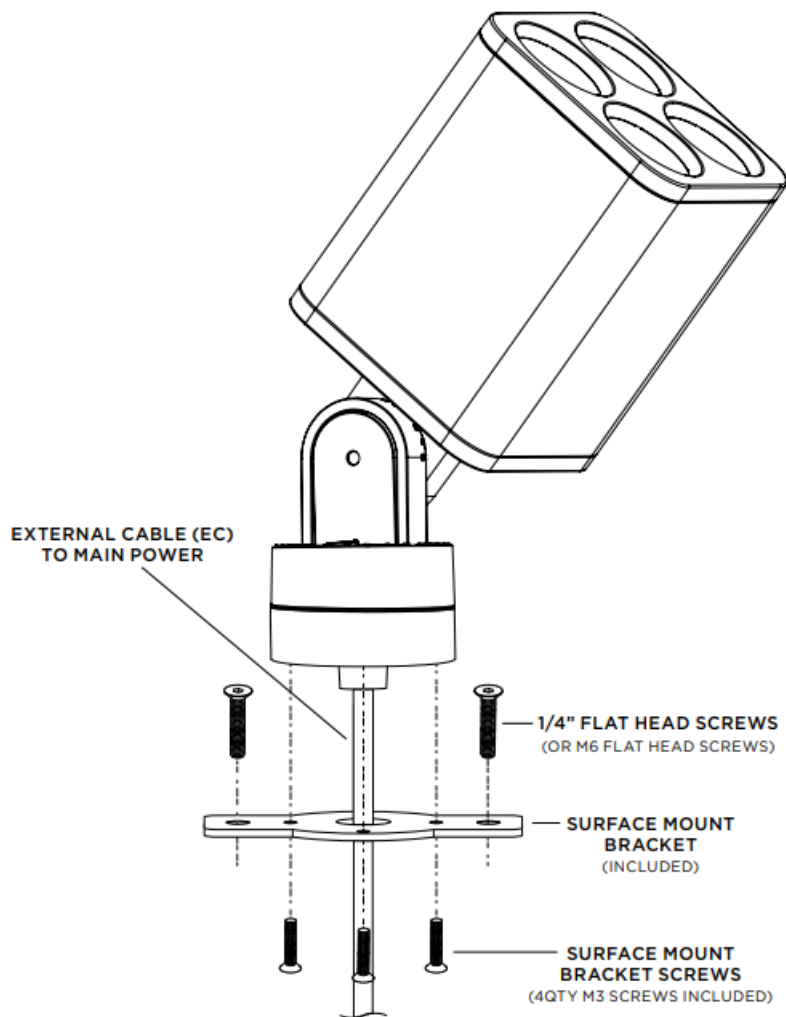

MOUNT TO POLE OR POST

Post Cap accessory sold separately

1. Fasten Pole Cap accessory to the fixture via 1/2 inch NPT fitting.
2. For internal cable option, feed cable through Pole or Post to termination location.
3. For external cable option, route cable to Junction Box*.
4. Mount fixture with pole cap accessory to Pole or Post and secure via two set screws.
5. Create secure wire connections between the EC Cable and the main power cables through wire nuts or wiring block as per local electrical code.
6. For damp or wet locations: For UL, use an exterior rated junction box and install per manufacturer instructions. For CE use recommended junction box WISKA COMBI 308.

• INTERNAL CABLE

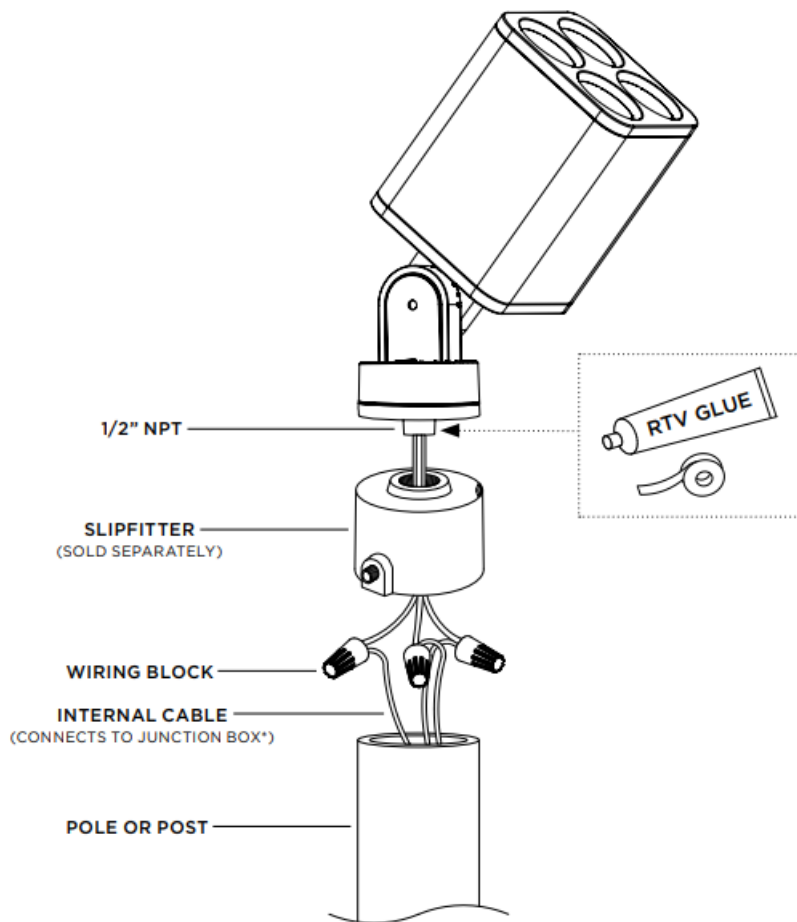

**Supplied by others*

- **EXTERNAL CABLE**

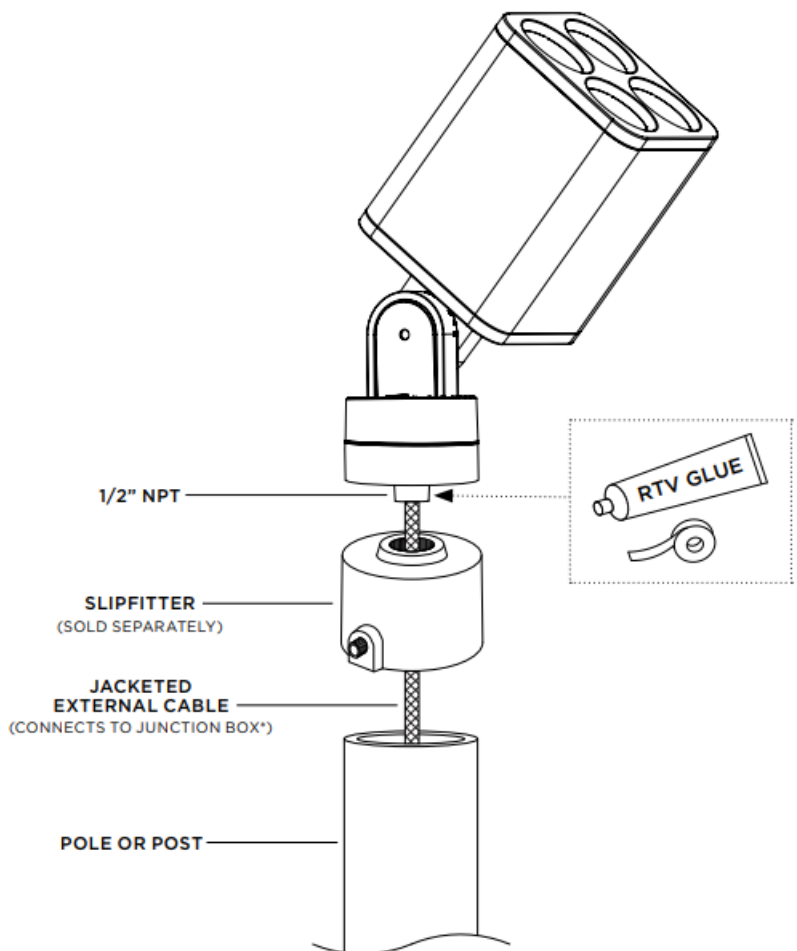

OPTIONAL INSTALL-F170 INTERCHANGEABLE LENS

1. Loosen the four screws on the Back Bezel with a 3 mm hex driver or key until the Front Bezel comes off.
Screws are captive and will not fully disengage.
2. Remove the center screw using a 3 mm hex driver or key from the lens.
3. Remove the old lens, and install the new lens. Refer to Lens Installation Instructions for specifics.
4. Replace the new Lens and then re-fasten the Center Screw to 1.5 Nm.
5. Secure the Front Bezel and tighten with the four screws from the back to 1.5 Nm.

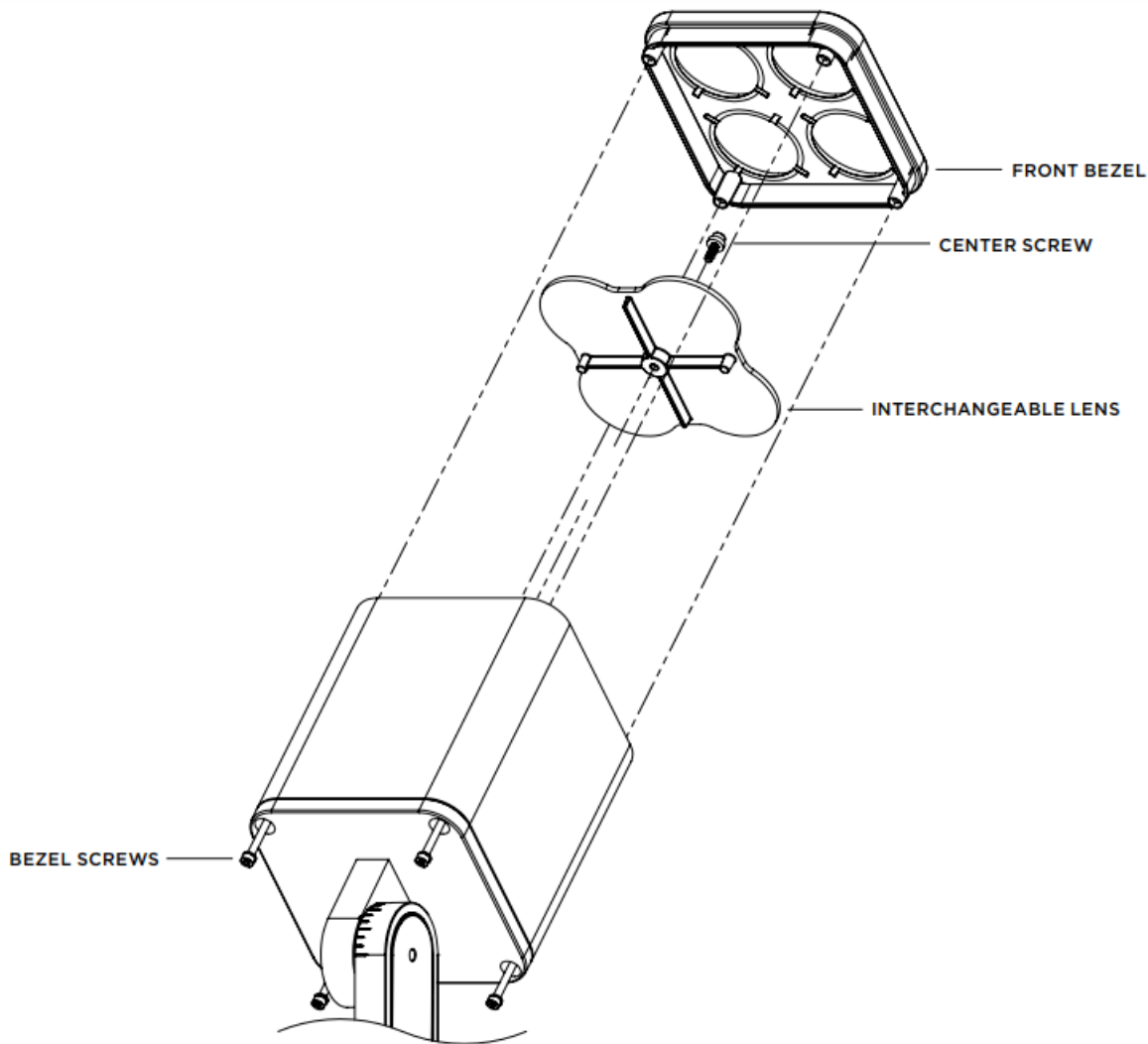

OPTIONAL INSTALL-F170 SNOOTS

1. Loosen the four screws on the Back Bezel with a 3mm hex driver or key until the Front Bezel comes off.
2. Place the Snoot on and then tighten the four screws from the back to 1.5 Nm.

• FULL SNOOT

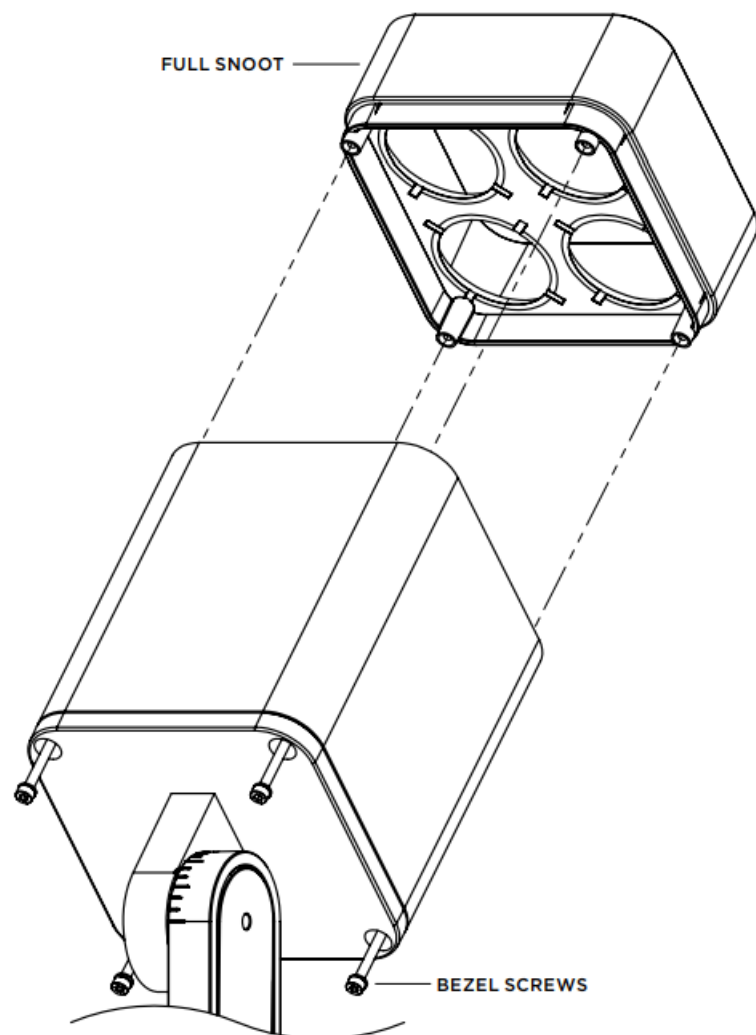

- HALF SNOOT

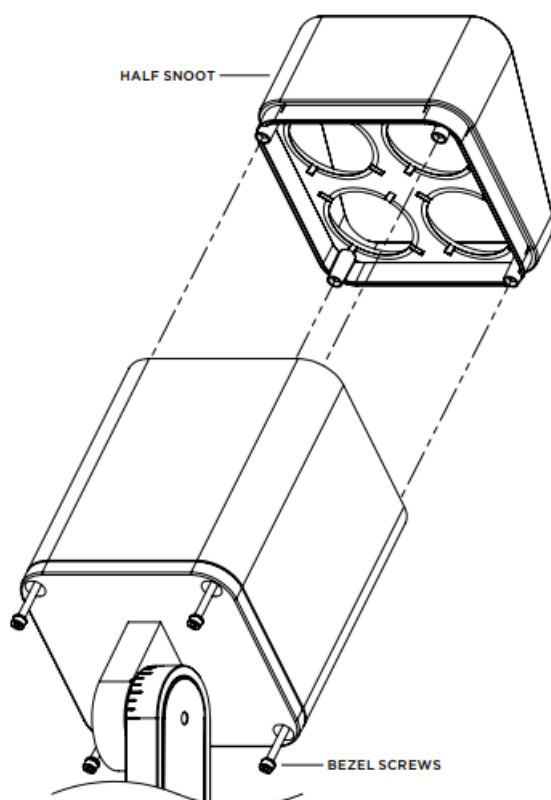

INSTALLATION CONSIDERATIONS

POWER CONSUMPTION	13 W / 25 W / 38 W
OPERATING TEMPERATURE	–40 °C to 50 °C
OPERATING VOLTAGE	120–277VAC, 50–60 Hz
OPERATING AMPERAGE	See the electrical characteristics on the product label
WEIGHT	6.5 lbs ; (2.95 kg)
DIMENSIONS	W 5.2" x H 12.07" x L 5.2" ; (131.98 mm x 306.65 mm x 131.98 mm)

***NOM Only:** Refer to electrical rating marked on the luminaire

- Read and understand the installation instructions before attempting to install or use the fixture
- Only use fixtures with voltage for which it is rated. Do not exceed the specified voltage and current input.
- Do not use fixture if the housing, lens, or power cable are damaged.
- Ensure that main power supply is off before installing or wiring a fixture.
- Hazardous live parts shall not be accessible after installation, and it is the installer's responsibility to ensure that the installation/connections are in compliance with national and local electrical codes and regulations.
- The wire connection method shall be determined by local electrical codes and regulations, typically using either wire nuts or screw terminal blocks.
- Possibly hazardous optical radiation emitted from this product.
- Polycarbonate Chemical Warning: Please contact an EcoSense sales representative for a complete list of chemicals that can cause damage to polycarbonate lenses and silicone gaskets. EcoSense must not be held responsible for damage to, or failure of, fixtures where any of these, or chemicals of similar nature and makeup, are applied intentionally or inadvertently to EcoSense's fixtures.
- Earth leakage Statement: Please contact an EcoSense factory representative for full information on the earth leakage properties of fixtures when installed according to all local electrical codes and proper installation techniques.
- EcoSense Inrush Current Statement: Please contact an EcoSense Lighting sales representative for a complete list of Inrush Current Peak (A) at specific product Voltage, and Inrush Current Duration/Width (ms), for each EcoSense product.
- The external flexible cable of this luminaire cannot be replaced; if the cord is damaged, the luminaire shall be destroyed.
- The light source contained in this luminaire shall only be replaced by the manufacturer or his service agent or a similar qualified person.

This equipment has been tested and found to comply with the limits for a Class B digital device, pursuant to part 15 of the FCC Rules. These limits are designed to provide reasonable protection against harmful interference in a residential installation.

This equipment generates, uses and can radiate radio frequency energy and, if not installed and used in accordance with the instructions, may cause harmful interference to radio communications. However, there is no guarantee that interference will not occur in a particular installation.

If this equipment does cause harmful interference to radio or television reception, which can be determined by turning the equipment off and on, the user is encouraged to try to solve the problem by one of the following methods:

- Reorient or relocate the receiving antenna.
- Increase the separation between the equipment and receiver.
- Connect the equipment into an outlet on a circuit different from that which the receiver is connected.
- Consult the dealer or experienced radio/ TV technician for help.

Modifications:

Changes or modifications not expressly approved by the party responsible for compliance could void the user's authority to operate the equipment.

Customer Support

ECOSENSE LIGHTING INC.
837 NORTH SPRING STREET
SUITE 103
LOS ANGELES, CA 90012

P • 310.496.6255
F • 310.496.6256
T • 855.632.6736 | 855.6.ECOSEN

SPECIFICATIONS SUBJECT TO CHANGE WITHOUT NOTICE.

VISIT ECOSENSELIGHTING.COM FOR THE MOST CURRENT SPECIFICATIONS.

FOR A LIST OF PATENTS VISIT ECOSENSELIGHTING.COM/IP-PORTFOLIO/

©2019 ECOSENSE LIGHTING INC. ALL RIGHTS RESERVED. ECOSENSE, THE ECOSENSE LOGO, TRoV, TROV AND ECOSPEC ARE REGISTERED TRADEMARKS OF ECOSENSE LIGHTING INC.

RISE™, SLIM COVE™, FREEDOM TO CREATE™, MACRO™, FLIP-TO-FLAT™ ARE TRADEMARKS OF ECOSENSE LIGHTING INC.

ECOSENSE®

RISE™

Documents / Resources

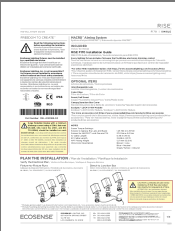
	RISE F170 Macro Aiming System Light [pdf] Installation Guide F170, Macro Aiming System Light, Aiming System Light, Macro Light, Light
---	--

References

- [E Ecosense Lighting: LED Technology | Linear and Flood LED Lighting](#)
- [E Ecosense Lighting: LED Technology | Linear and Flood LED Lighting](#)
- [E Products - Ecosense Lighting](#)
- [E Products - Ecosense Lighting](#)
- [E Downloads - Ecosense Lighting](#)

Manuals+.