



RIPTUNES SM-128 White Noise Sound Machine User Guide

[Home](#) » [RIPTUNES](#) » RIPTUNES SM-128 White Noise Sound Machine User Guide 

Contents

- [1 RIPTUNES SM-128 White Noise Sound Machine](#)
- [2 INTRODUCTION](#)
- [3 SAFETY PRECAUTIONS](#)
- [4 GENERAL INFORMATION](#)
- [5 PACKAGE INCLUDES](#)
- [6 TECHNICAL SUPPORT](#)
- [7 LIMITED WARRANTY](#)
- [8 Documents / Resources](#)
 - [8.1 References](#)
- [9 Related Posts](#)

RIPTUNES

RIPTUNES SM-128 White Noise Sound Machine



INTRODUCTION

Congratulations on your new purchase! We hope you'll enjoy your SM-128 White Night White Noise Sound Machine! It is important to read the provided instructions carefully, to ensure maximum performance of your sound machine and for your personal safety

SAFETY PRECAUTIONS

IMPORTANT: PLEASE READ THIS MANUAL CAREFULLY BEFORE OPERATING YOUR SOUND MACHINE AND SAVE IT FOR FUTURE REFERENCE. REFER BACK TO THIS MANUAL FOR OPERATING INSTRUCTIONS AND SAFETY TIPS

1. **WARNING:** To reduce the risk of electric shock or damage to the sound machine, DO NOT disassemble or replace any parts of this device. If the sound machine becomes damaged or in need of repair, please contact a qualified service center for assistance.
2. **WARNING:** To prevent fire or electric shock hazards, do not expose the sound machine to dust, rain, water, or liquids of any kind (including drips or splashes) while the multipurpose port cover is open. Do not submerge the sound machine in water. Do not place any objects filled with liquids, (i.e., vases and water bottles) on or near the sound machine.
3. **WARNING:** Do not expose the sound machine or its batteries to excessive heat, such as direct sunlight, fire, or other heat sources.
4. **WARNING:** This is a unit that plugs into an electrical outlet. There are no attachments or accessories included. You may use headphones designed to fit the plug in the back of the unit. Do NOT modify or use any other accessories or attachments with this sound machine.
5. Do not place objects on top of the sound machine.
6. Do not place the sound machine on an unstable table, stand, tripod, bracket, or cart. The sound machine may fall, resulting in damage to the machine or possible damage or injury to yourself or others.
7. Do not use objects other than your finger or the eraser of a pencil to operate the buttons on the sound machine.
8. Do not allow children to use this sound machine without proper adult supervision.
9. When using the sound machine, only use the provided power adapter and power cable when plugging into an outlet. Use an outlet with voltages between 110VAC and 220VAC. Do not place in direct sunlight or an area that is damp, dusty, or vibrating. Do not place near a radio or TV as these could interfere with connectivity.
10. Clean the machine with a dry, soft cloth, or a minimally damp cloth. Do not use any corrosive solvent or cleaning agent.
11. Dispose of the sound machine properly, respecting your local electronics and battery disposal laws.

GENERAL INFORMATION

FEATURES

- Power ON/OFF Button
- DC 5V Power Input Port
- Easy push-button operation
- Volume Control
- Headphone Jack

- 28 different sounds
 - 12 unique non-repeating fan sounds
 - 12 unique non-repeating white noise sounds
 - 4 other sound options
- 5 timer options with automatic shutdown after 15, 30, 60, or 90 minutes, or the option for continuous play

TECHNICAL SPECS

- **Output:** 2*3W
- **Max Volume:** 80dB
- **Working Current:** <= 200mA
- **Working Voltage:** DC5V
- **Adapter:** Input 100-240V AC 50/60Hz, Output DC5V 1A

PACKAGE INCLUDES

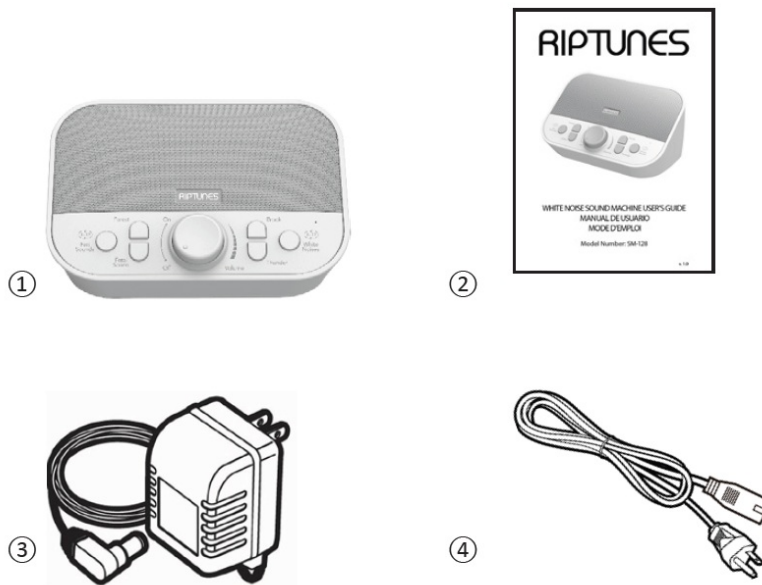

1. White Noise Machine (1)
2. User Manual (1)
3. Power Adapter (1)
4. Power Cable (1)

FRONT CONTROLS

A set of seven buttons on the top of the machine controls how the white sound machine operates.

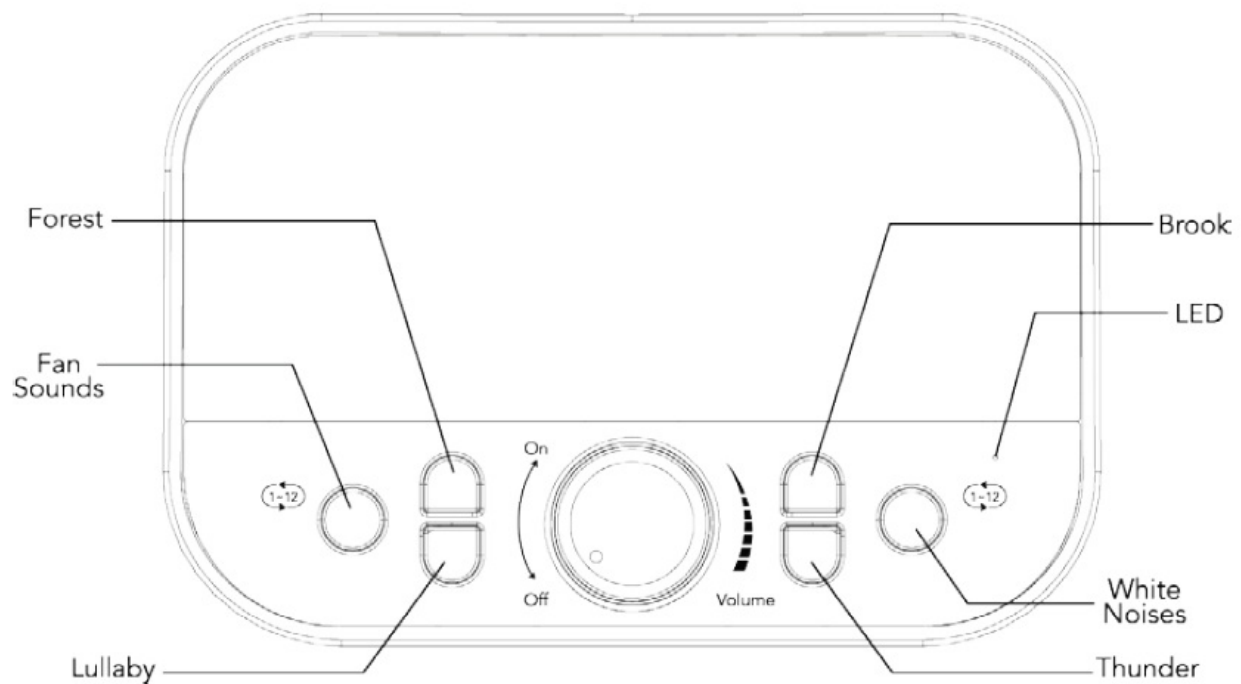

Power and Volume Buttons

1. Plug in the Power Adapter into the Power Input Port on the back of the machine.
2. Plug the Power Cable into a power outlet.
3. Rotate the dial on the top of the sound machine clockwise to turn the machine on. You will hear a click when the device is on. Keep turning the dial clockwise increase the volume.
4. To reduce the volume, turn the dial counterclockwise.
5. To turn the sound machine off, turn the dial counterclockwise until you hear a click.

Sound Buttons

Each sound has its own button. To choose a sound, press one of the six buttons once. To change sounds, click on another sound button. Fan Sounds and White Noise Sounds have different options. Press these buttons repeatedly to choose from 12 unique non-repeating sounds.

Fan Sounds	Press once to start fan sounds. Press again to play the next fan sound. There are 12 unique, non-repeating fan sounds.
Lullaby	Press once to play Lullaby.
Forest Sound	Press once to play forest sounds. You will hear birds' singing.
Brook Sound	Press once to play the sound of running water in a stream.
Thunder Sound	Press once to play the sound of thunder.
White Noise Sounds	Press once to play white noise sounds. Press again to play the next white noise sound. There are 12 unique, non-repeating white noise sounds.

BACK CONTROLS

The back of the sound machine is where you plug in the Power Cable or headphones, and where you can control the timer settings.

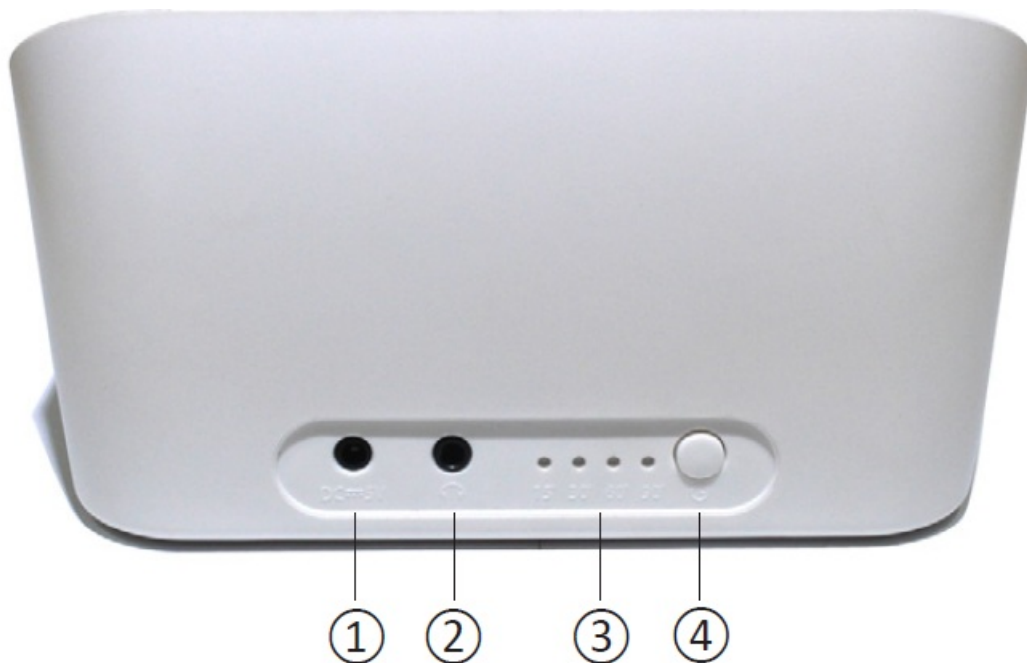

1. Insert the Power Cable into the slot that says DC-5V. Insert the other end of the Power Cable into the Power Adapter. Plug the Power Adapter into the wall to operate the machine
2. Plug in a set of headphones (not included) in this slot for listening without disturbing others.

TIME CONTROLS

Press the Timing Sleeping Button ④ to choose how long the sound machine will play before automatically shutting off. There are 5 options. ③

1. Press the Timing Sleeping Button once and the indicator light above the 15 will glow. This means that the machine will play for 15 minutes and then shut off.
2. Press the button again and the light above the 30 will light up.
3. Press the button again for 60 minutes.
4. Press the button again for 90 minutes.
5. Press the button again and all indicator lights will be dark. At this point the soundmachine will play until you turn it off using the power button on the front.

The sound machine will remember the last timing selection when the machine is turned off.

TECHNICAL SUPPORT

For questions not answered in this manual, or for warranty service, please contact

Riptunes Technical Support:

- **By phone:** 1-888-217-7688 (9:00 AM to 6:00 PM ET)
- **By e-mail:** service@rip-tunes.com
- **Online:** www.rip-tunes.com

LIMITED WARRANTY

Riptunes™ warrants this product against defects in material and workmanship to the original purchaser as specified below provided product is registered online within fourteen (14) days of purchase. PARTS – if the product is determined to have a manufacturing defect, within a period of one (1) year from the date of the original purchase, Riptunes™ will repair or replace the product parts at no charge (for parts) to you in the U.S.A. and Canada. LABOR – if the product is determined to have a manufacturing defect, within a period of ninety (90) Days from the date of the original purchase, Riptunes™ will repair or replace the product at no charge to you in the U.S.A. and Canada. After ninety (90) days it will be the responsibility of the consumer. Shipping costs to and from our warranty service center is the sole responsibility of the consumer. To obtain warranty service by an authorized Riptunes™ service center, please email us at: support@riptunes.com to obtain a Repair and Maintenance Authorization (RMA) number and to locate the service center nearest you. Once authorized, you must mail the product, to the authorized Riptunes™ service center in its original product packaging materials or equivalent, to prevent damage while in transit.

Further, should Riptunes™ determine that the product is outside of the Warranty term, Riptunes™ will return the product to sender at sender's expense without being repaired or replaced, unless authorized by the consumer to service the out of warranty product at consumer's expense. All handling or restocking charges for returns and/or replacements shall be nonrefundable. Riptunes™ specifically excludes from this warranty any non-electric/mechanical attachments, accessories and disposable parts including but not limited to outside case, connecting cables, batteries and AC adaptors. Riptunes™ reserves the right to repair or replace defective products with the same, equivalent or newer models. We reserve the right to either repair or replace product at our discretion. Replacement may beAlso this warranty does not apply if the product has been damaged by accident, abuse, misuse, or misapplication; has been altered or modified without the written permission of Riptunes™; has been serviced by a non-authorized repair center of Riptunes™; has not been properly maintained or operated according to the operation manual; has been used for commercial, non-household purposes; cosmetically damaged; was not imported by Riptunes™; was not manufactured according to specification of the United States market; improper installation or neglect; damaged due to improper packaging in shipment; damaged due to natural disasters; if the serial number for the product has been removed or defaced; or for cosmetic damages.

ALL IMPLIED WARRANTIES, INCLUDING IMPLIED WARRANTIES OF MERCHANTABILITY AND FITNESS FOR A PARTICULAR PURPOSE ARE LIMITED IN DURATION TO ONE (1) YEAR PARTS AND NINETY (90) DAYS LABOR FROM THE DATE OF THE ORIGINAL RETAIL PURCHASE OF THIS PRODUCT. THESE WARRANTIES AND REMEDIES ARE THE SOLE AND EXCLUSIVE WARRANTIES AND REMEDIES IN CONNECTION WITH THE SALE AND USE OF THE PRODUCT. NO OTHER WARRANTIES, ORAL OR WRITTEN, EXPRESSED OR IMPLIED, ARE GIVEN. RIPTUNES™ IS NOT RESPONSIBLE OR LIABLE FOR ANY DAMAGE, WHETHER SPECIAL, INCIDENTAL, CONSEQUENTIAL, DIRECT OR OTHERWISE, OR WHETHER KNOWN OR SHOULD HAVE BEEN KNOWN TO RIPTUNES™, INCLUDING LOST PROFITS, GOODWILL, AND PROPERTY AND PERSONAL INJURY RESULTING FROM ANY BREACH OF WARRANTY, THE INABILITY TO USE THE PRODUCT OR UNDER ANY LEGAL THEORY IN CONTRACT OR TORT. RIPTUNES LIABILITY IS LIMITED TO THE ACTUAL PURCHASE PRICE PAID TO THE RETAIL SELLER OF THE DEFECTIVE PRODUCT. No Riptunes™ dealer, agent or employee is authorized to make any modification, extension, change or amendment to this warranty without the written consent and authorization from Riptunes™. Some states do not allow the exclusion or limitation of implied warranties or liability for incidental or consequential damages, or do not allow a limitation on how long an implied warranty lasts, so the above lim



Riptunes™ USA

- PA 18711
- www.rip-tunes.com
- support@rip-tunes.com

Do not send any returns to this address, as it might get lost and this will delay your repair and service process.

<div><div>RIPTUNES</div><div></div><div><div>WHITE NOISE SOUND MACHINE</div><div>USER'S GUIDE</div><div>MANUAL DE USUARIO</div><div>MODE D'EMPLOI</div><div>Model Number: SM-128</div><div>v. 1.0</div></div></div>	<div>RIPTUNES SM-128 White Noise Sound Machine [pdf] User Guide</div> <div>SM-128, SM-128 White Noise Sound Machine, White Noise Sound Machine, Noise Sound Mac hine, Sound Machine</div>
--	---

References

-  [Search Page](#)
-  [Riptunes](#)